



# NGTeco NG-AD10 Compressed Air Duster User Manual

[Home](#) » [NGTeco](#) » NGTeco NG-AD10 Compressed Air Duster User Manual 

## Contents

- [1 NGTeco NG-AD10 Compressed Air Duster](#)
- [2 Important Notes](#)
- [3 What's in the Box](#)
- [4 Product Overview](#)
- [5 Operating Instructions](#)
- [6 Function Description](#)
- [7 How to Charge](#)
- [8 Specifications](#)
- [9 FREQUENTLY ASKED QUESTIONS](#)
- [10 VIDEO – PRODUCT OVERVIEW](#)
- [11 Related Posts](#)



**NGTeco NG-AD10 Compressed Air Duster**



## Important Notes

### Points to note:

1. The product will run out of power and the working light will flash to remind the user to charge it in time.
2. This machine uses a lithium-ion battery, which can be charged on demand (but does not support charging from the side). You do not have to wait until the battery runs out before charging it. Keeping the battery charged at all times helps to prolong its life.
3. When the product is working, the fan blades will rotate at high speed. It is strictly forbidden to stick foreign matter into the product, otherwise the machine may be damaged.
4. If the working environment temperature of a battery exceeds 60°C or if the battery is squeezed or dissected, the battery life will be severely shortened, and there may even be a risk of leakage or explosion.
5. To ensure the effectiveness and service life of this product, please use the company specified accessories.
6. Due to product upgrades, the content of the document may be slightly inconsistent with the actual product. The document is for reference only, please refer to the actual product.

## What's in the Box



Electric Air Duster\*1

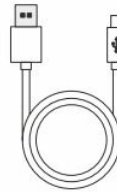

USB Cable\*1



User Manual\*1

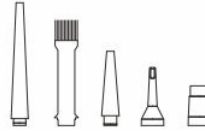

Nozzle\*5



Brushes\*3

- Electric Air Duster\*1
- USB Cable\*1
- User Manual\*1
- Nozzle\*5
- Brushes\*3

## Product Overview

### Front:

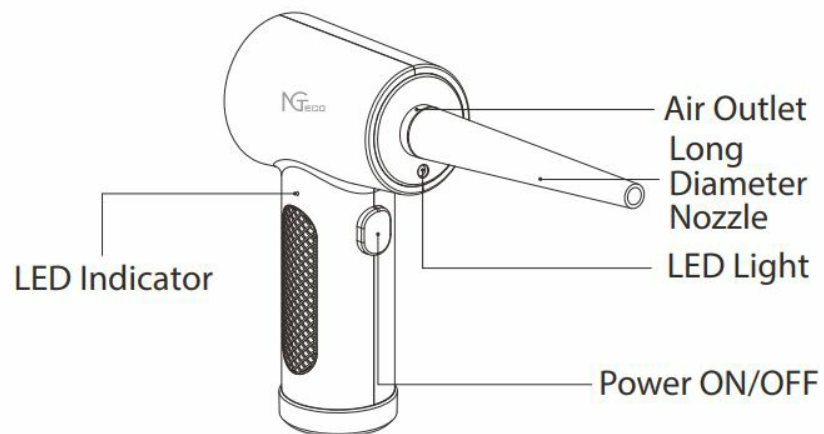

### Back:

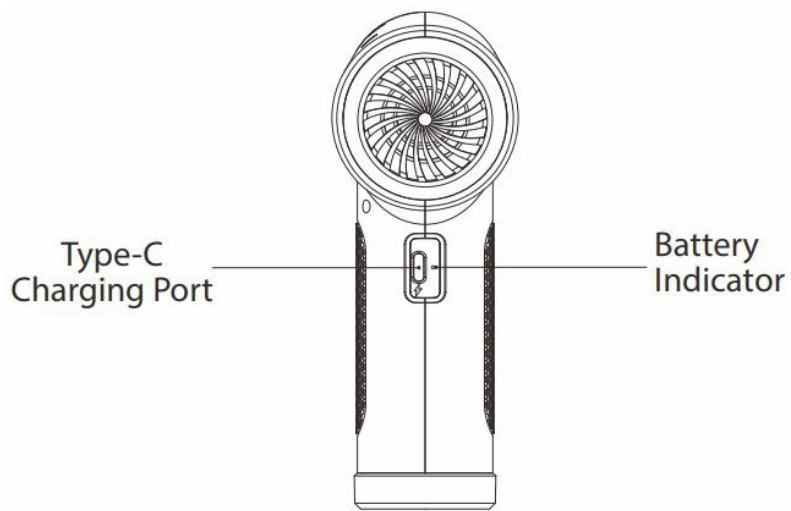

## Operating Instructions

### How to Use

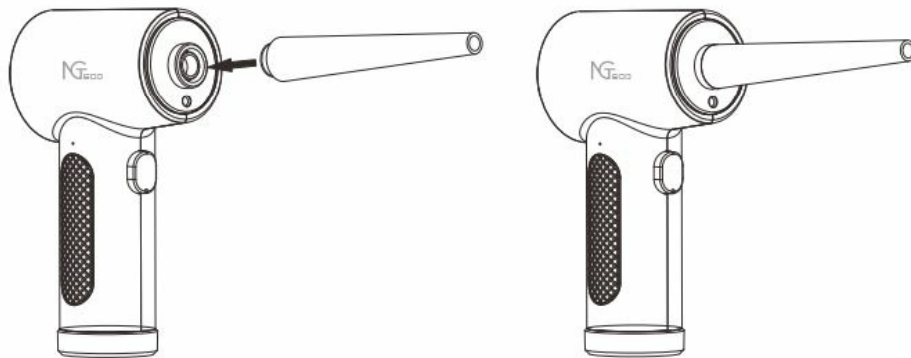

**Note:** When using pressurized air with an air nozzle for inflation, it is important to open the air valve for quick inflation. This is demonstrated below:

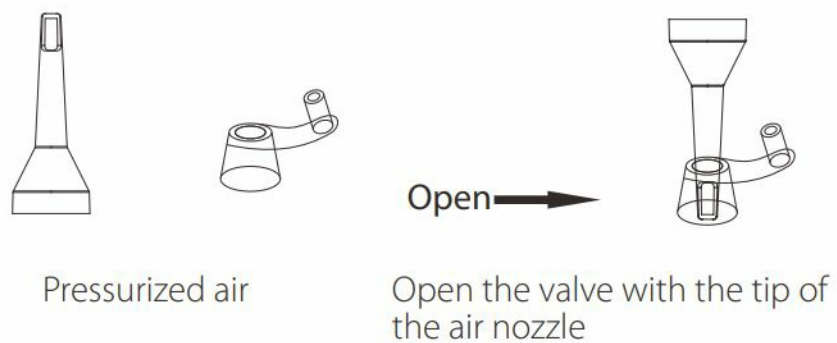

Release the nozzle from the nozzle hole and put it to the air outlet.

## Function Description

The item has 3 levels as follows:

1. Press and hold the switch for 2 seconds to activate the first gear. The indicator light will illuminate to confirm activation.

2. Pressing the switch for a second time will activate the second gear.
3. Press the switch three times to activate the third gear. To turn off, press the switch once more.

**Note:** To turn off the LED light, press and hold the switch for 2 seconds.

## How to Charge

1. To charging the air dust collector, insert the USB cable into its charging port, then connect the other end to a 5V/2A USB outlet, such as a USB charger, mobile phone adapter, laptop, or mobile power supply. To speed up the charging process, we recommend using a 5V/2A adapter.
2. When the device is charging, the indicator light flashes red, and the indicator light is always on when it is fully charged.

### Note:

- It is not recommended to use the product while charging, because it will not hold a charge while working.
- If the air duster stops working after a short period of use, it is recommended to ensure that the battery is kept fully charged. Additionally, it is important to avoid storing the battery in a wet place, as this may shorten its lifespan.
- **Low Power State:** When the battery level is low, the indicator light will flash green until the device automatically shuts off due to a drained battery.

**Tips:** For faster charging, connect the cable to a 5V/2A USB outlet, such as a USB charger or cellphone adapter. Please keep in mind that using USB outlets with low output current may slow down the charging process or prevent charging altogether.

## Specifications

Power Supply	DC 5V
Input	2 A
Rated Power	68 W
Full Charge	Red Light Glint
Motor Rotate Speed	51000 to 91000 RPM
Charging Time	3.5 to 4 h
Battery Working Time (Fully Charged)	20 to 35 min
Working Temperature	14oF to 122oF (-10oC to 50oC)
Storage Temperature	-2oF to 140oF (-10oC to 60oC)
Noise	80 dB
Material	ABS, PP
Cable Length	31.5 in.
Weight	450 to 500 g
Product Dimensions	101*63*165 mm

**1600 Union Hill Road Alpharetta, GA 30005**

• **E-mail:**

- [service.ng@ngteco.com](mailto:service.ng@ngteco.com)
- [www.ngteco.com](http://www.ngteco.com)



Copyright © 2023 NGTECO CO., LIMITED. All rights reserved.

## **FREQUENTLY ASKED QUESTIONS**

What is the NGTeco NG-AD10 Compressed Air Duster?

The NGTeco NG-AD10 Compressed Air Duster is a compact and portable device designed to clean dust and debris from various surfaces and equipment using compressed air.

How does the NG-AD10 Compressed Air Duster work?

The NG-AD10 Compressed Air Duster uses compressed air to blow away dust and particles from surfaces. It's a quick and effective way to clean without the need for chemicals or contact.

What types of surfaces can I clean with the NGTeco NG-AD10?

You can use the NGTeco NG-AD10 Compressed Air Duster to clean a wide range of surfaces, including keyboards, computers, cameras, electronics, and delicate equipment.

Is the NGTeco NG-AD10 safe for cleaning electronics?

Yes, the NG-AD10 is designed to be safe for cleaning electronics. It provides a gentle and non-contact method of removing dust from sensitive electronic components.

Does the NGTeco NG-AD10 require any additional accessories?

The NG-AD10 usually comes with the necessary accessories, such as nozzles and extension tubes, for versatile and efficient cleaning. No additional accessories are required for standard use.

Is the NG-AD10 Compressed Air Duster environmentally friendly?

Yes, the NG-AD10 is an eco-friendly option for cleaning as it doesn't use harmful chemicals or contribute to waste. It solely relies on compressed air.

What is the maximum pressure output of the NGTeco NG-AD10?

The maximum pressure output of the NG-AD10 can vary by model, but it is designed to provide sufficient air pressure for effective cleaning.

Is the NGTeco NG-AD10 suitable for home use?

Yes, the NG-AD10 is suitable for both professional and home use. It offers a convenient way to keep your equipment and surroundings clean.

Can I use the NG-AD10 for cleaning hard-to-reach areas?

Yes, the NG-AD10 often comes with extension tubes or nozzles that allow you to clean tight and hard-to-reach spaces with ease.

Is the NG-AD10 portable and easy to store?

Yes, the NG-AD10 is designed to be compact and portable, making it easy to store and carry with you when needed.

Does the NGTeco NG-AD10 require any maintenance?

The NG-AD10 typically requires minimal maintenance. Regularly clean the nozzles and check for any blockages to ensure optimal performance.

Can the NG-AD10 Compressed Air Duster be used for cleaning cameras and lenses?

Yes, the NG-AD10 is suitable for cleaning cameras and camera lenses. It provides a safe and effective way to remove dust without touching delicate optics.

Is the NGTeco NG-AD10 Compressed Air Duster rechargeable or battery-powered?

The power source for the NG-AD10 can vary by model. Some versions are rechargeable, while others may use disposable batteries or be corded.

Is there a warranty for the NGTeco NG-AD10?

The warranty typically range from 1 year to 2 years.

Can the NGTeco NG-AD10 be used for cleaning delicate art or collectibles?

Yes, the NG-AD10 can be used for cleaning delicate art, collectibles, and other sensitive items where contact cleaning is not advisable.

Can I adjust the air pressure on the NGTeco NG-AD10?

Some models of the NG-AD10 may offer adjustable air pressure settings, allowing you to control the force of the air for different cleaning needs.

## VIDEO – PRODUCT OVERVIEW



[Download the PDF Link: NGTeco NG-AD10 Compressed Air Duster User Manual](#)  
[Compressed-Air-Duster-User-Manual.mp4](#)