



NEXTECH WiFi IP Camera with Alarm User Manual

[Home](#) » [Nextech](#) » NEXTECH WiFi IP Camera with Alarm User Manual 

Contents

- 1 Wi-Fi IP Camera With Alarm
 - 1.1 QC3870 User Manual
- 2 Camera Overview
 - 2.1 1. Install App
 - 2.2 2. Connect the power adapter
 - 2.3 3. Register IP Camera
- 3 4-2. Connect to Camera
 - 3.1 5. Operation
- 4 7. Add Security Sensors
- 5 8. Alarm system setting
- 6 9. Notes
- 7 Documents / Resources
 - 7.1 References
- 8 Related Posts

NEXTECH



Wi-Fi IP Camera With Alarm

QC3870 User Manual

Before using this product, please read the guide carefully to avoid any damages to the product. do not misconfiguration or misuse.

Camera Overview



IR LEDs for Night Vision, Camera,
Infrared Sensor, indicator, Microphone,
Magnetic stand

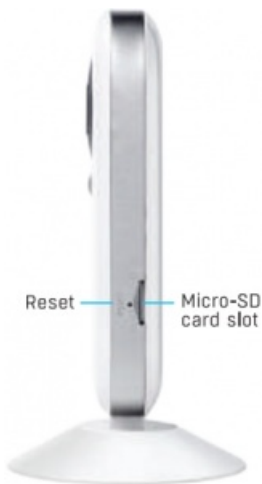

Reset, Micro SD card slot



Mounting the Camera (screws not included)



-2-

1. Install App



Download Nextech SmartCam app on your smartphone or tablet. If you have done so already and you're adding additional cameras, begin at step 2.

2. Connect the power adapter

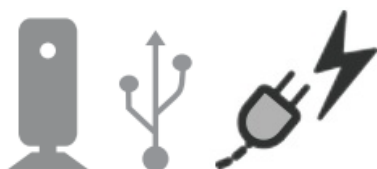

Connect the power adapter to the camera and then plug it into a wall socket. The LED on the front will light up and

the camera will start up.

Different LED colours correspond to a different camera status:

Blue	System start up
Slow blue flash	Syncing mode
Fast blue flash	Connecting to Wi-Fi
Solid blue	Camera working correctly

-3-

3. Register IP Camera

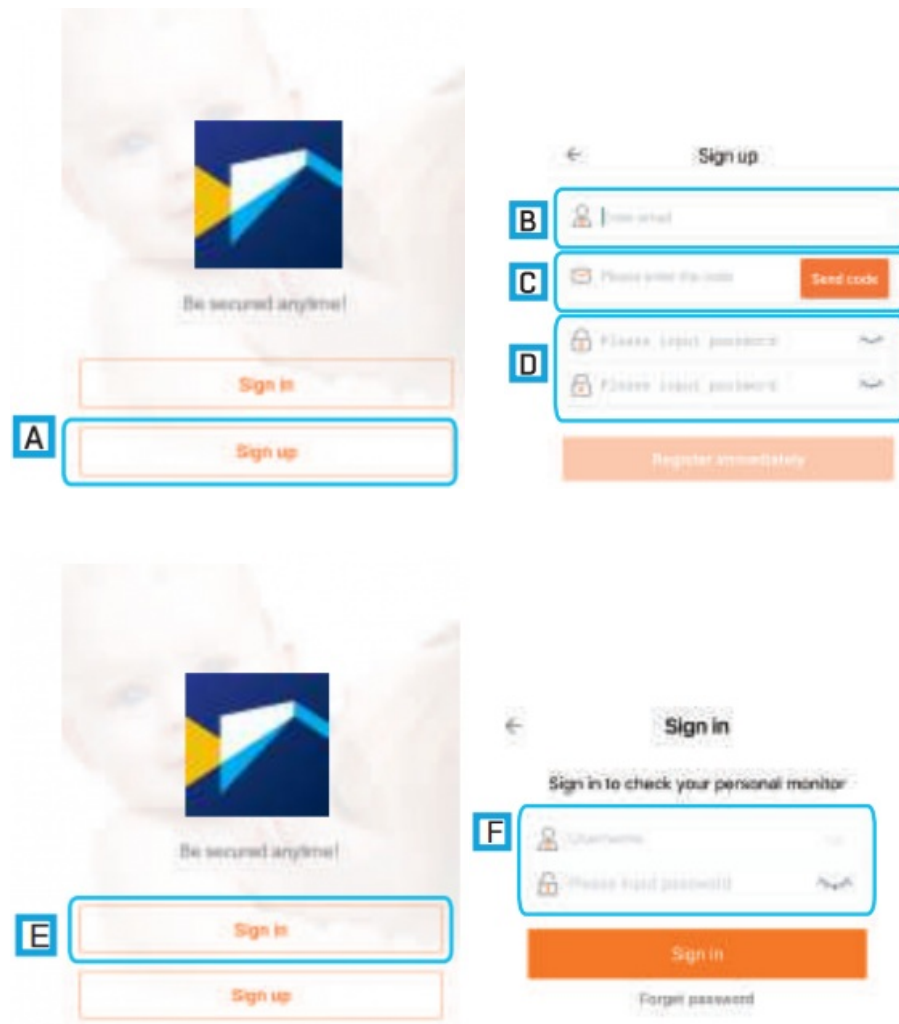

Please **connect your mobile device to 2.4GHz WiFi network** before opening the Nextech SmartCam app on your mobile device. If this is your first time setting up your camera, you will need to create an account. Please follow below.

A: Select “Sign up” tab.

B: Enter your Email ID.

C: Check email, and input the received verification code. Kindly note sometimes the verification mail may be found in spam mailbox.

D: Set password for your account. Press “Register immediately” tab.

E: Select “Sign in” tab.

F: Input email and password of your new created account (or an existing account), select “Sign in” tab

-4-

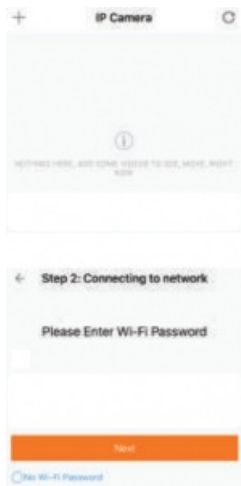

Connecting smart camera

It takes only 30 seconds to complete binding for keeping an eye on children, parents anywhere any time and two-way talking. And more intimate function waiting for you to discover.

-5-

4-2. Connect to Camera

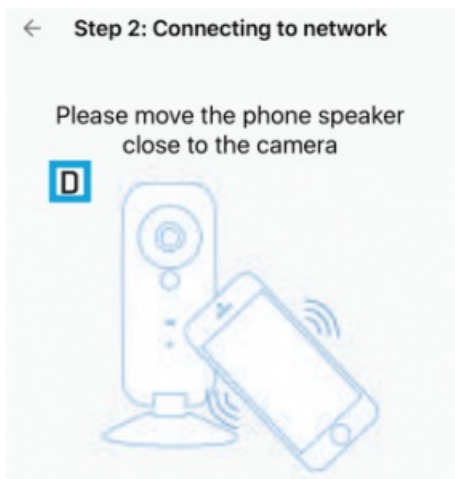

Step 2: Connecting to network, Please move the phone speaker close to the camera



Step 2: Connecting to network, finisher sending and wait for binding successfully voice prompt from camera



Step 2: Connecting to network, Camera is connecting wireless network, 6 seconds later, binding will be finished

D Place speaker of your mobile device in front of the camera closely.

E Press “send sound wave” icon to binding the camera with your mobile device.

F Voice prompt “Binding Successfully” from the camera after it is done. Now the camera connects to the WIFI network automatically.

5. Operation

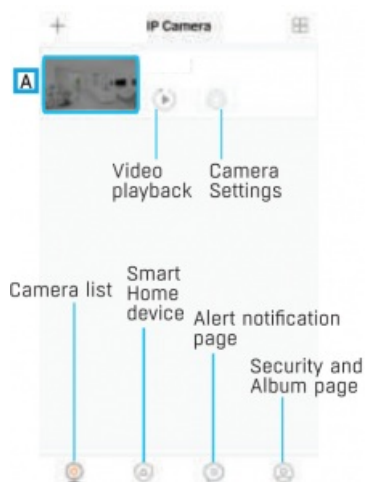

IP Camera, Video playback, Camera Settings, Camera list, Smart Home device, Alert notification page, Security and Album page



Go back to Camera list, Nextech SmartCam, Full screen mode, Listening from Camera on/off, Current date and time, Change video recording quality

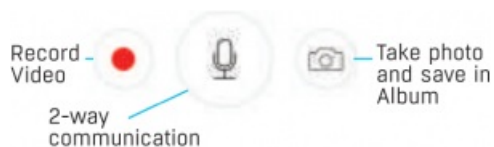

Record Video, Take photo and save in Album, 2-way communication

A The camera will list in the Camera list. To open the video streaming page, press this image.

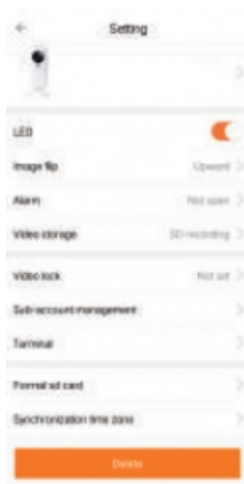

- “Click” camera: Camera information.
- LED: Turn ON/OFF LED light.
- Image Flip: Flip video orientation on displayed device.
- Alarm: Turn ON/OFF Alarm and Alarm Settings.
- Video Storage: Turn ON/OFF Video Storage and Set video quality.
- Video Lock: Create/Disable slide lock for the IP camera.
- Sub-account Management: Add other account so that other mobile devices can access this camera.
- Terminal: Add various security sensors to work with camera
- Format sd card: Formatting SD card to delete videos
- Synchronization time zone: Synchronize IP camera time to local time
- Delete: Delete the IP camera in the app.

7. Add Security Sensors

Press “Terminal”, then the top-right “+” button, then scan the QR code of sensors

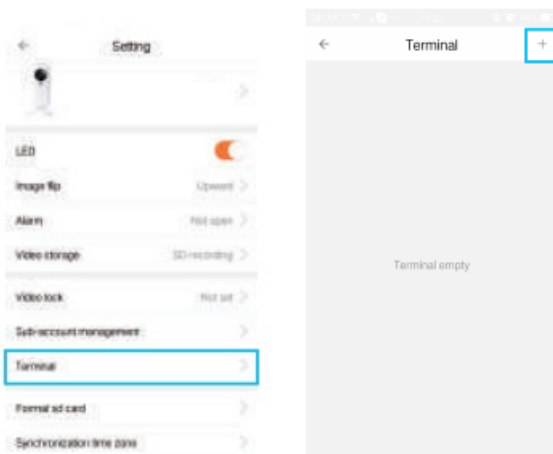

Sensors will be connected successfully as the picture shows



-9-

Kindly note:

There is an on-off switch in PIR and infrared curtain. Please turn on before use



Press sensor icon to rename or delete the sensor

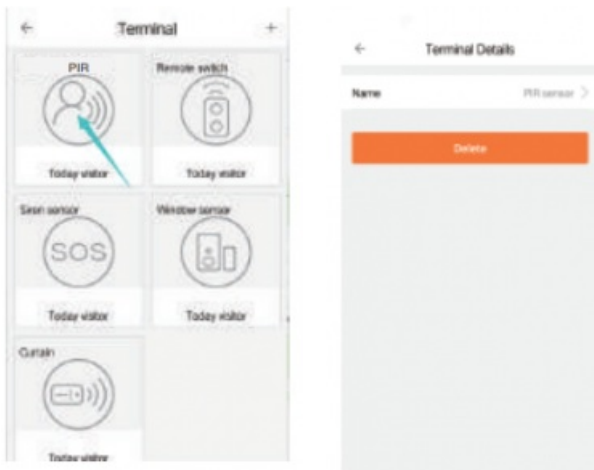

-10-

8. Alarm system setting

Press "Alarm" to open and set

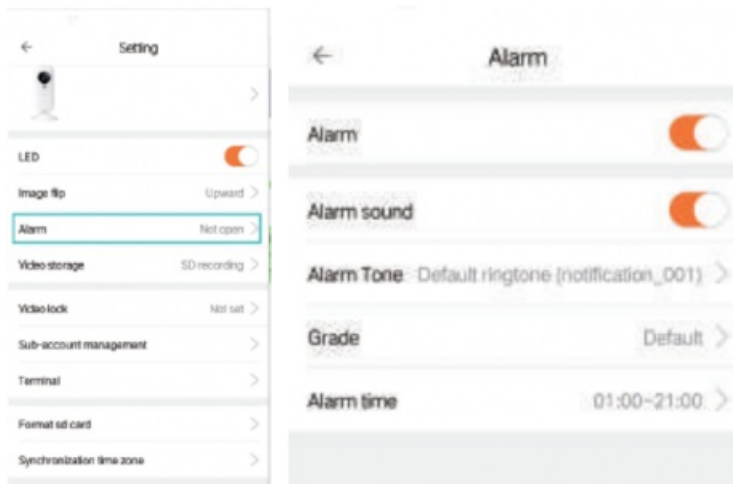

Alarm: Turn on/off alarm system
 Alarm sound: Turn on/off alarm sound of the camera
 Alarm tone: Set prompt tone when receiving APP push notification
 Grade: Set camera alarm sensitivity
 Alarm time: Set alarm system working time

-11-

9. Notes

- Restore Factory Settings
 - Keep the device powered on for at least 30 seconds to complete its normal startup.
 - Find a pin to press the reset button on the camera and hold it for 3-5 seconds.
 - Voice prompt appear saying say system is resetting. The camera will be restored to factory defaults after rebooting.
- Pull-down the screen of your phone to refresh camera list.
- Support a 64GB micro-SD card, and store videos up to 40days.
- Video playback is available 10 minutes after a micro-SD card is installed.
- Maximum 15 accounts to each camera. The first account binding to the camera is default as the administrator account.
- Please bind in a quite environment when using sound wave binding.
- When binding, do not leave the binding page, wait for the camera finish automatically.



Distributed by:
 TechBrands by Electus Distribution Pty. Ltd.
 320 Victoria Rd, Rydalmere
 NSW 2116 Australia

Ph: 1300 738 555
 Int'l: +61 2 8832 3200
 Fax: 1300 738 500

www.techbrands.com

Made in China

Documents / Resources

  Wi-Fi IP Camera With Alarm QC3870 User Manual <small>© 2014 NEXTECH. All rights reserved. No part of this publication may be reproduced without prior written permission from NEXTECH.</small>	<p>NEXTECH WiFi IP Camera with Alarm [pdf] User Manual WiFi IP Camera with Alarm, QC3870</p>
--	--

References

- [🌐 Electus Distribution - Home](#)