



next level RACING Go Kart Plus Racing Cockpit Instruction Manual

[Home](#) » [next level RACING](#) » next level RACING Go Kart Plus Racing Cockpit Instruction Manual 

Contents

- 1 next level RACING Go Kart Plus Racing Cockpit
- 2 YOUR SIM RACING JOURNEY STARTS HERE
- 3 PRE-RACE CHECKS
- 4 IN THE BOX
- 5 MOUNTING LOCATIONS
- 6 INSTALLATION
- 7 Documents / Resources
 - 7.1 References



next level RACING Go Kart Plus Racing Cockpit

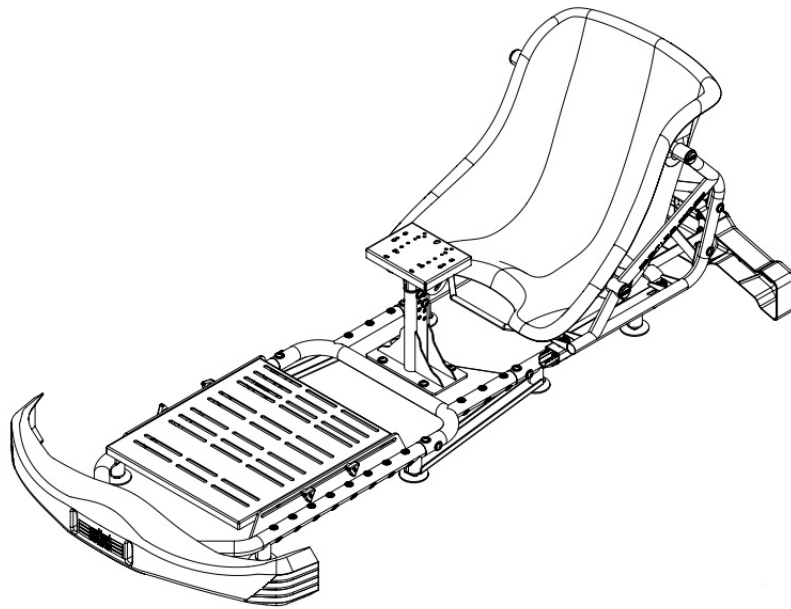

Product Information:

- **Product Name:** Next Level Racing Simulator
- **Manufacturer:** Next Level Racing
- **Website:** nextlevelracing.com
- **Customer Support Email:** support@nextlevelracing.com
- **Social Media Handles:**
- **Instagram:** [@next_level_racing](https://www.instagram.com/next_level_racing)
- **Facebook:** [@nextlevelracingOfficial](https://www.facebook.com/nextlevelracingOfficial)
- **Twitter:** [@nextlvlracing](https://twitter.com/nextlvlracing)

Product Usage Instructions:

Pre-Race Checks

Before using the simulator, make sure to perform the following checks. Contact customer support at support@nextlevelracing.com if you need any assistance.

Assembly

Follow the video instructions provided at bit.ly/nlrbuild for step-by-step assembly guidance. – The product comes with various parts and accessories. Refer to the list below to ensure you have all the components:

- 1 x Left Pedal Frame
- 1 x Right Pedal Frame
- 1 x Pedal Plate
- 1 x Centre Frame
- 1 x Rear Frame
- 1 x Centre Pole Base
- 1 x Centre Pole
- 1 x Wheel Plate
- 1 x Left Seat Frame
- 1 x Right Seat Frame

- 1 x Seat Cross Brace
- 1 x Go Kart Seat
- 1 x Seat Cover
- 2 x Frame Brace
- 1 x Front Bumper
- 1 x Front Bumper Mount
- 1 x Rear Bumper
- 1 x Rear Bumper Mount
- 4 x M8 Knobs
- 9 x Flat Feet
- 5 x Foot Spacer
- 1 x Buttkicker Mount
- 8 x Castor Wheel
- 4 x End Caps
- 8 x M8 20mm Socket Head Bolts
- 1 x M10 20mm Socket Head Bolts
- 2 x M8 12mm Bolts
- 30 x M8 16mm Bolts
- 10 x M8 20mm Bolts
- 2 x M8 30mm Bolts
- 4 x M8 40mm Bolts
- 17 x M8 Flange Nut
- 1 x M10 Allen Key
- 1 x M8 Allen Key
- 1 x M6 Allen Key
- 1 x 13mm Spanner
- 1 x 14mm Wrench
- 8 x Velcro Ties
- 3 x Sticker Sheets

Mounting Locations

The product is compatible with various steering wheels and pedal sets. Refer to the product legend for suitable models.

Follow the instructions provided in the manual for mounting your specific steering wheel and pedal set.

Assembly Steps

The manual provides detailed instructions with numbered parts and corresponding assembly steps.

Each step includes two parts (A and B) with instructions on aligning nut inserts, bolting through, and securing with appropriate bolts, washers, and knobs. – Repeat the steps on the other side when applicable. Note: If using Load Cell Pedals, replace M8 Knobs with M8 20mm Bolts and Washers supplied. For any further assistance or inquiries, contact customer support at support@nextlevelracing.com.

Additional Resources:

Video Instruction: bit.ly/nlrbuild

YOUR SIM RACING JOURNEY STARTS HERE

We know you're eager to start racing! Take your time with the instructions and follow this guide to assemble your product. You'll be setting yourself up for success by following the instruction booklet to fully optimize your product.



TAKE RACING
TO THE NEXT LEVEL
[NEXTLEVELRACING.COM](https://www.nextlevelracing.com)

PRE-RACE CHECKS

WARNING & ASSEMBLY TIPS

- Please do not use power tools for assembly as over tightening can damage your frame.
- Do not force parts together.
- Avoid cross threading threaded items.
- If in doubt consult the installation video (see QR code below or contact us at support@nextlevelracing.com)
- Hand wash Seat Cover separately in cold water only.

If you require any support with your product please contact our friendly team at: support@nextlevelracing.com

WARNING

CHOKING HAZARD – Small parts not for children under 3 years or any individuals who have a tendency to place inedible objects in their mouths.



IN THE BOX

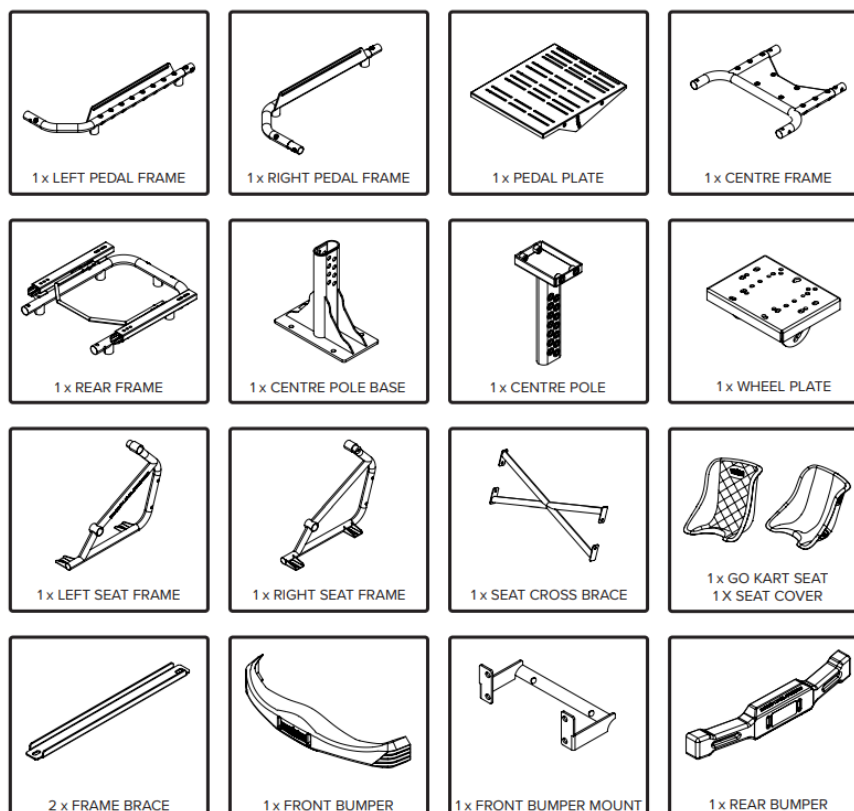



MOUNTING LOCATIONS

WHEEL PLATE

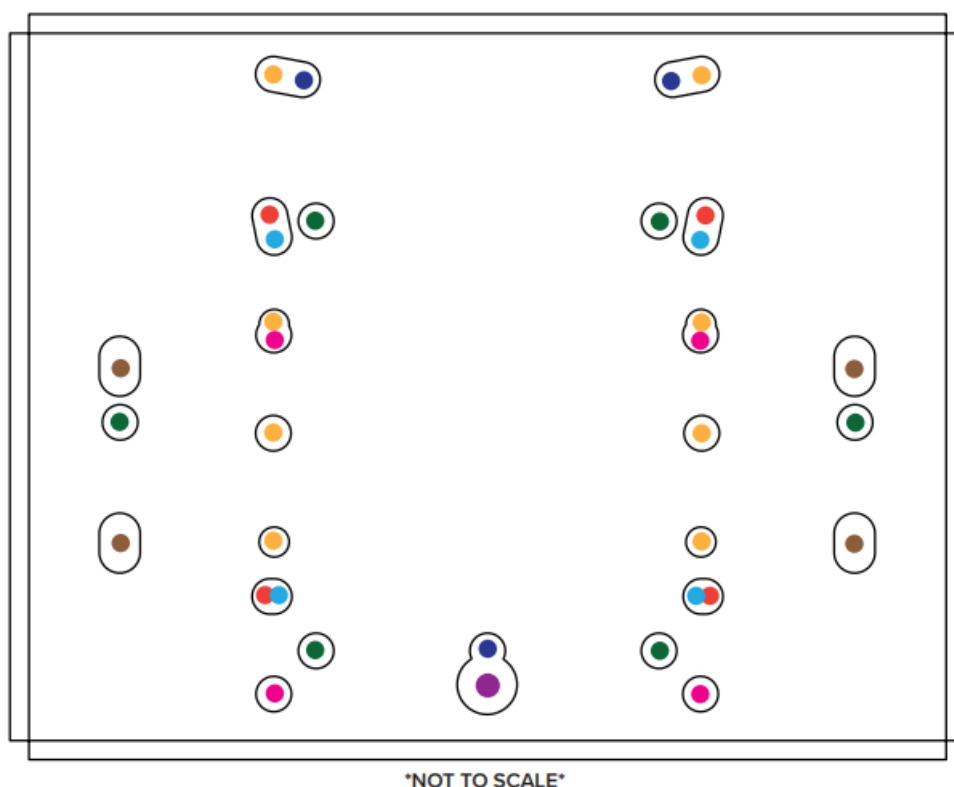

NOT TO SCALE

PRODUCT LEGEND:

- | | |
|--|---|
| ● MOZA R5 / R9 / R16 / R21 | ● Simucube (with bottom mounting bracket) |
| ● Fanatec DD1 / DD2 / CSL DD / DD Pro | ● Simagic Alpha |
| ● Logitech G Pro / G25 / G27 / G29 / G902 / G923 | ● Nintendo Mario Kart |
| ● Thrustmaster T-818 / T500 RS / TGT / TSPC / TX | ● SimXperience Accuforce Pro |

INSTALLATION

- A) Align the nut inserts on the Right Pedal Frame with the mounting holes on the Left Pedal Frame.

B) Bolt through to the nut insert on the underside of frame and secure with 1 x M8 Bolt and Washer.
- A) Align the nut inserts on the Right and Left Pedal Frames with the mounting holes on the Centre Frame. B) Bolt through and secure with 4 x M8 Bolts and Washers.
- A) Align the nut inserts on the Centre Frame with the mounting holes on the Rear Frame.

B) Bolt through and secure with 4 x M8 Bolts and Washers.

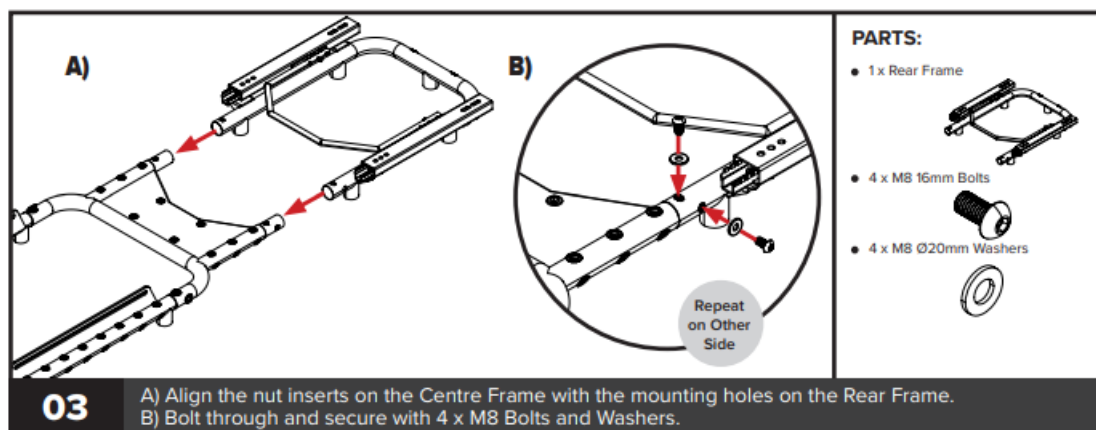
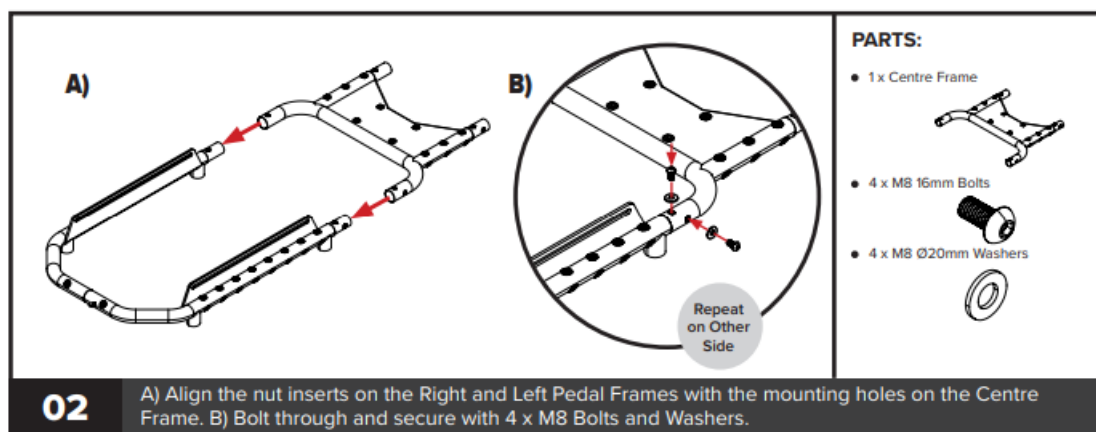
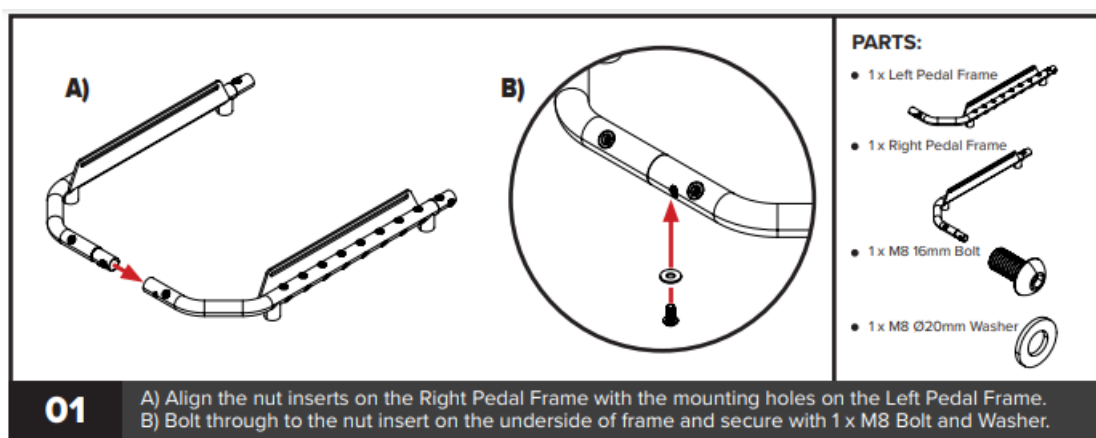

- A) Align the nut inserts on the Pedal Plate with the slots on the Right and Left Pedal Frames.

- B) Bolt through and secure with 4 x NLR Knobs.
5. Flip the assembly upside down. A) Align 5 x Foot Spacers and 2 x Frame Braces with the footing mounts on the bottom of the cockpit. B) Install 9 x Flat Feet or 8 x Castor Wheels into the mounting points.
6. A) Align the mounting holes on the Centre Pole Base with the nut inserts on the Centre Frame. B) Bolt through and secure with 4 x M8 Bolts and Washers.

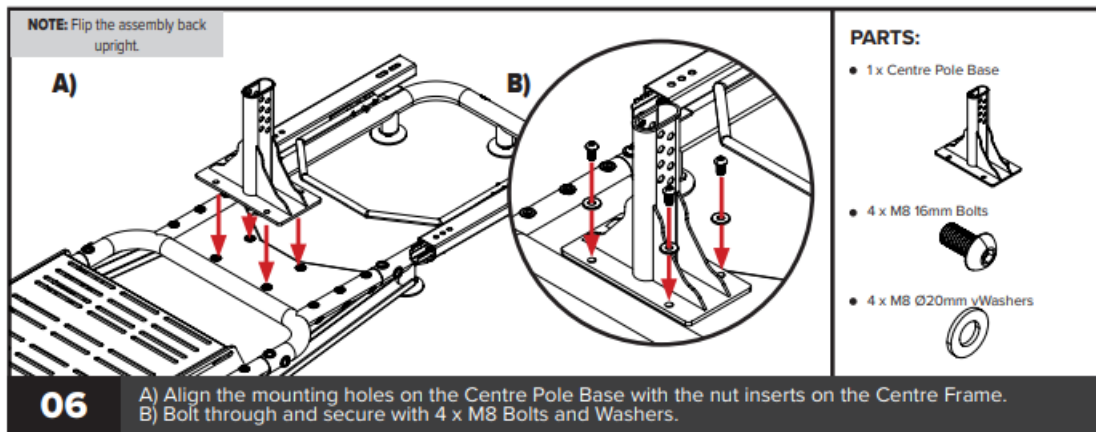
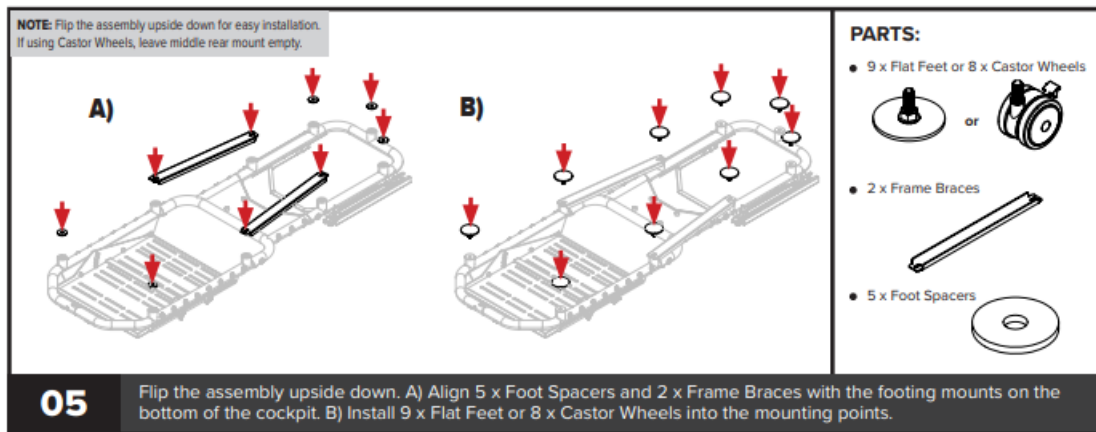
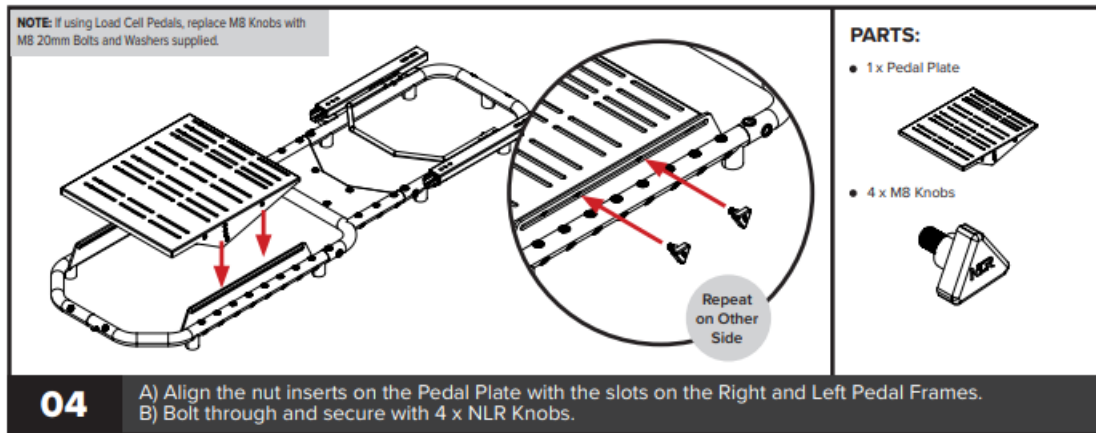

7. A) Align the nut inserts on the Centre Pole with the holes on the Centre Pole Base. B) Bolt through and secure with 4 x M8 Bolts and Washers.
8. A) Align the mounting holes on the Wheel Plate with the nut inserts on the Centre Pole. B) Bolt through and secure with 4 x M8 Bolts and Washers.
9. A) Align the mounting holes on the Left and Right Seat Frames with the nut inserts on the Go Kart Seat. Align 2 x Ø30mm and 2 x Ø35mm washers in between Seat Frames and Seat. B) Bolt through and secure with 4 x M8 Bolts and Ø20mm Washers. (2 x 30mm Bolts for the upper mounts and 2 x 12mm Bolts for the lower mounts).

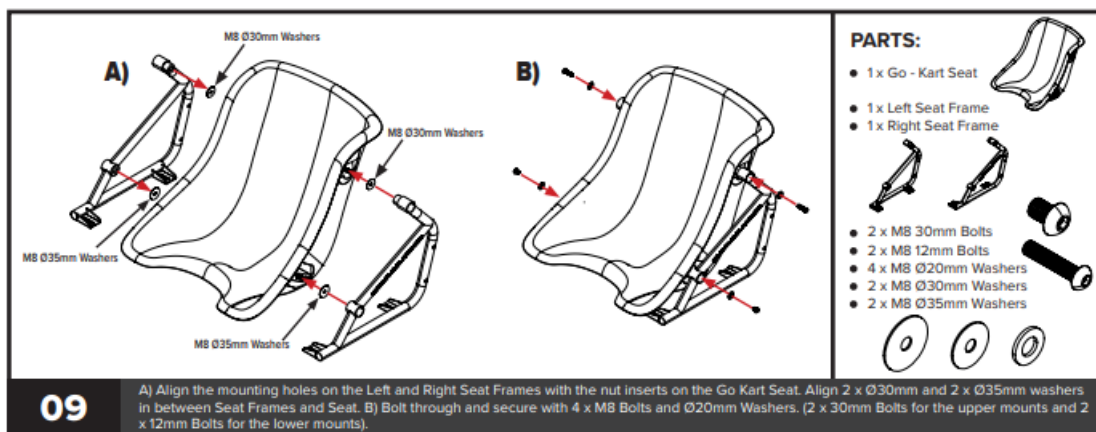
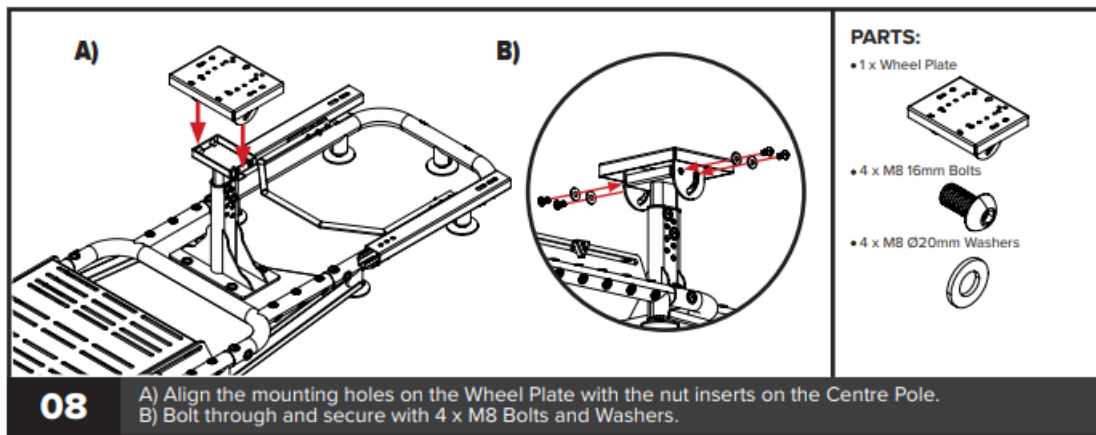
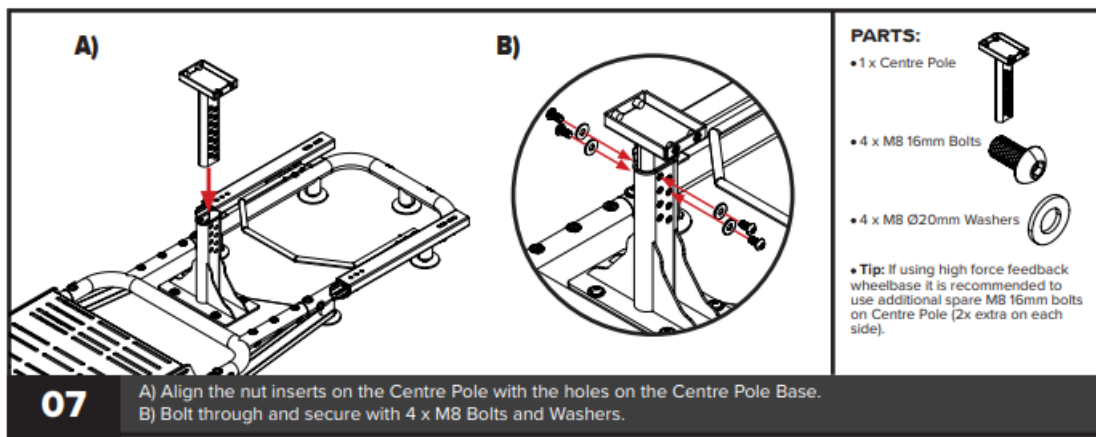

10. A) Align the mounting holes on the Seat Cross Brace with the through holes on the Left and Right Seat Frames.
B) Bolt through and secure with 4 x M8 Bolts, Washers and Flange Nuts.
11. Install 4 x End Caps onto the Left and Right Seat Frames.
12. Pull Seat Slider Handle upwards and slide Seat Slider Assembly forward to access front mounting holes.

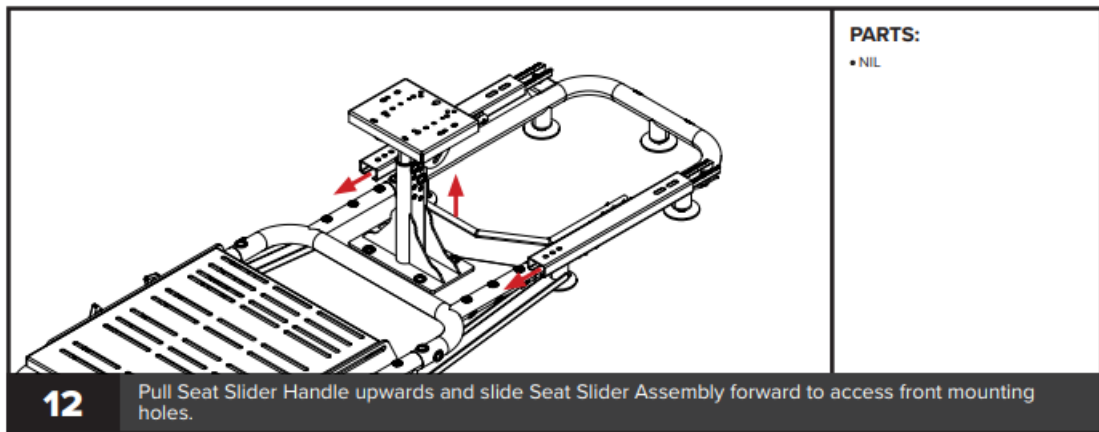
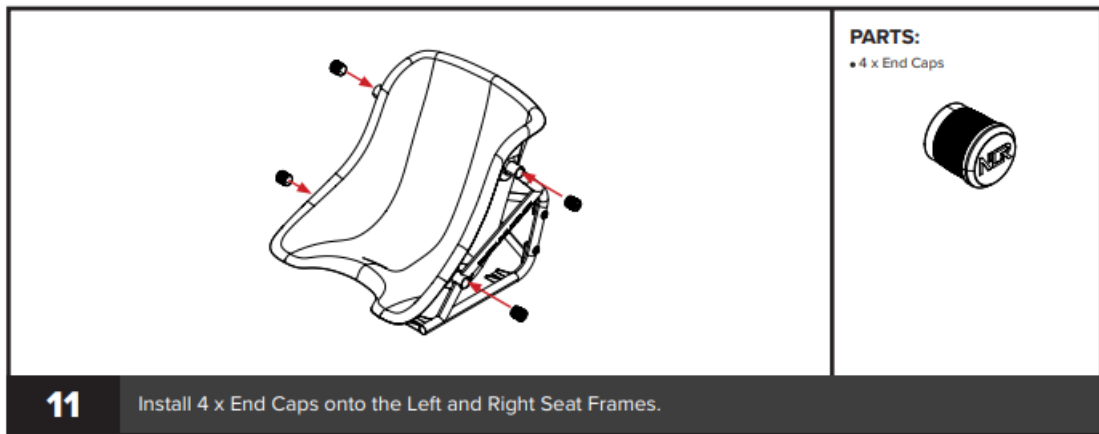
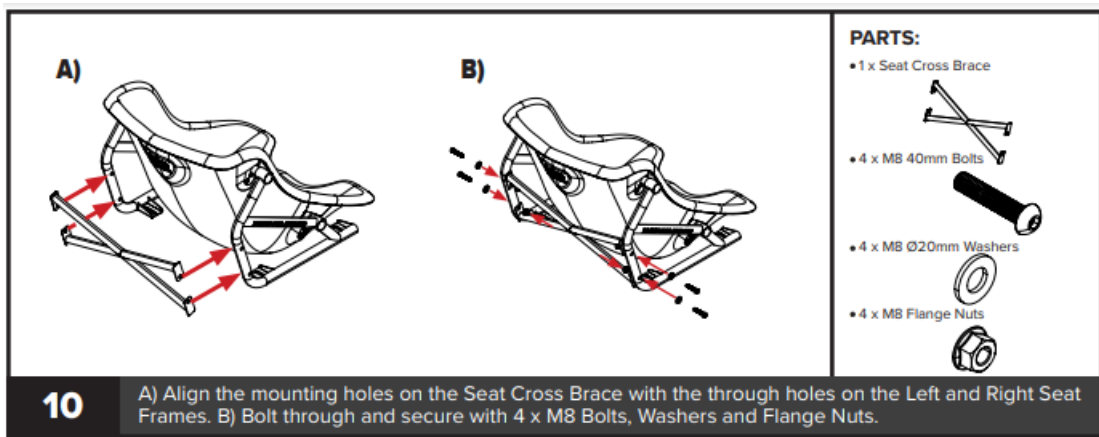

13. Align the mounting slots on the Left and Right Seat Frame with the middle mounting holes on the front of the Seat Slider Assembly.
14. Bolt through the front holes and secure with 2 x M8 Bolts, Washers and Flange Nuts. Pull the Seat Slider Handle upwards and slide the seat backwards when done.
15. Bolt through the rear holes and secure with 2 x M8 Bolts, Washers and Flange Nuts.

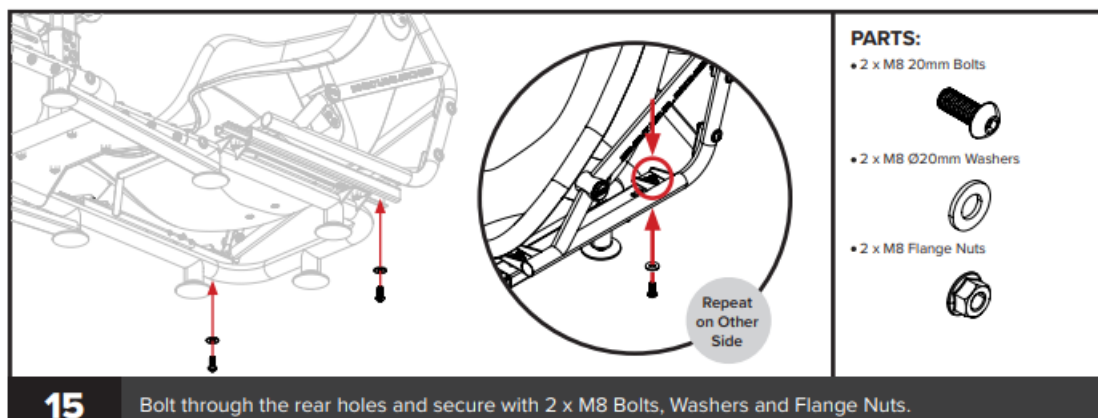
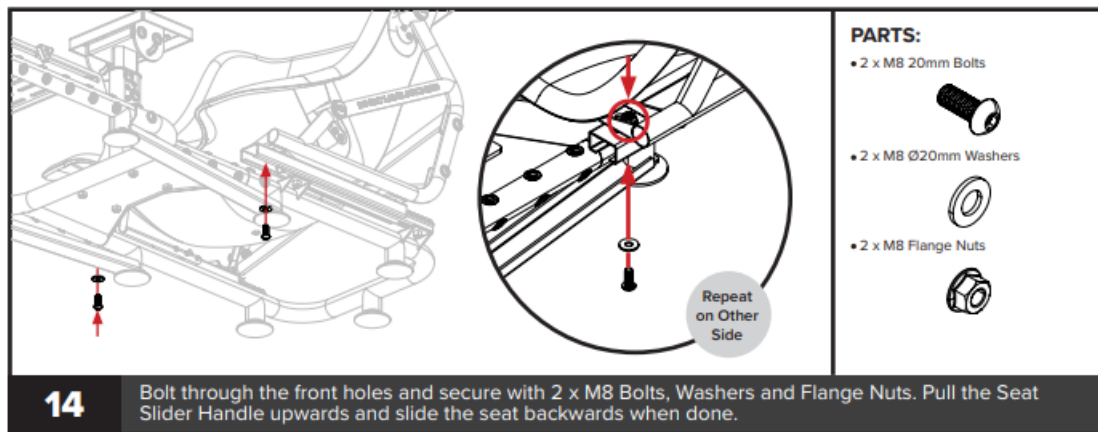
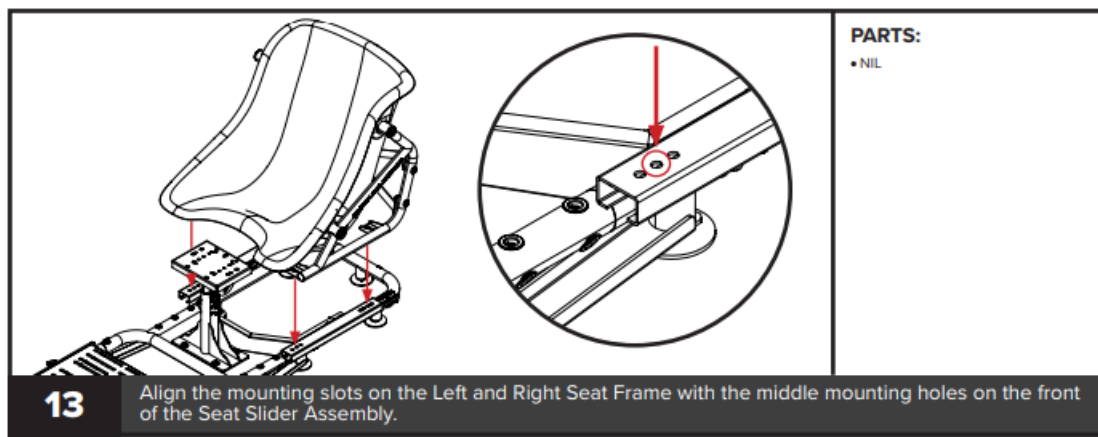

16. A) Align the Front Bumper Mount with the nut inserts on the front of the Pedal Frame.
B) Bolt through and secure with 3 x M8 Bolts and Washers.
17. A) Align the Front Bumper with mounting holes on Front Bumper Mount.
B) Bolt through and secure with 4 x M8 Bolts and Flange Nuts.
18. Align the Rear Bumper Mount with the nut inserts on the Rear Frame.

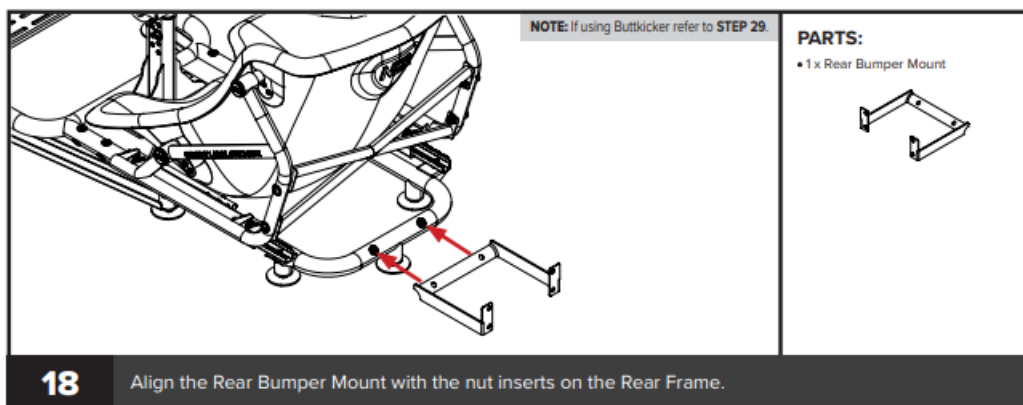
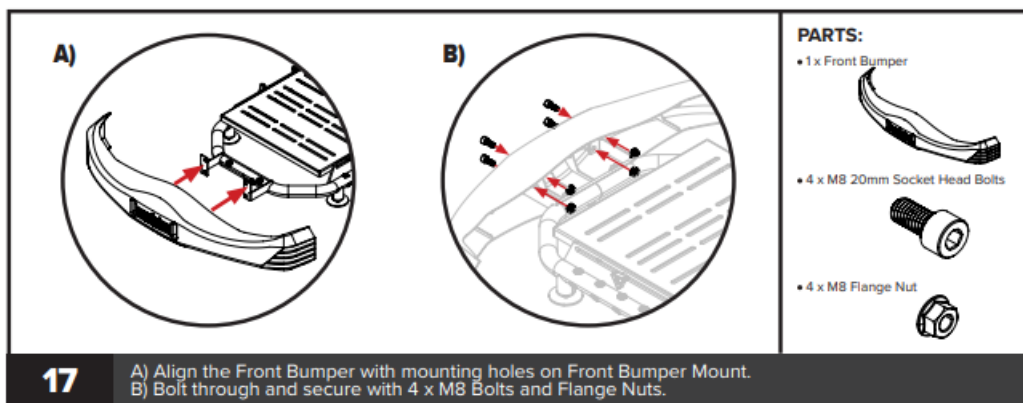
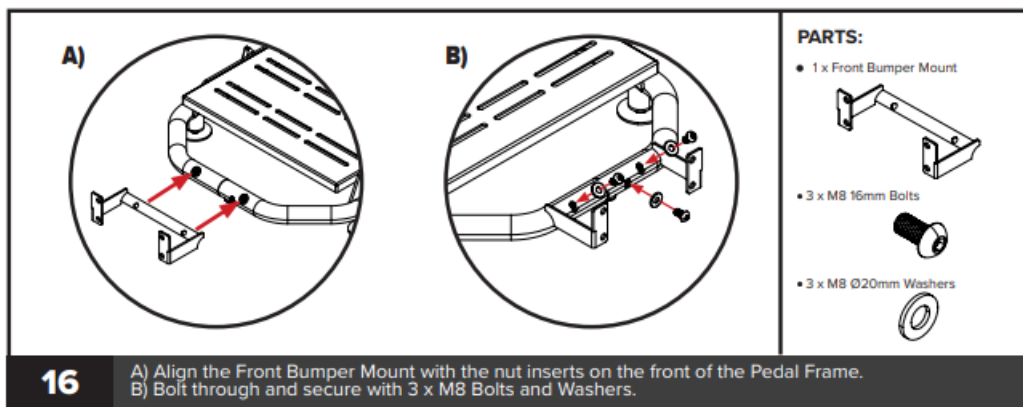

19. Bolt through and secure with 2 x M8 Bolts and Washers.



20. A) Align mounting holes on Rear Bumper with Rear Bumper Mount.

B) Bolt through and secure using 4 x M8 Bolts and Flange Nuts.

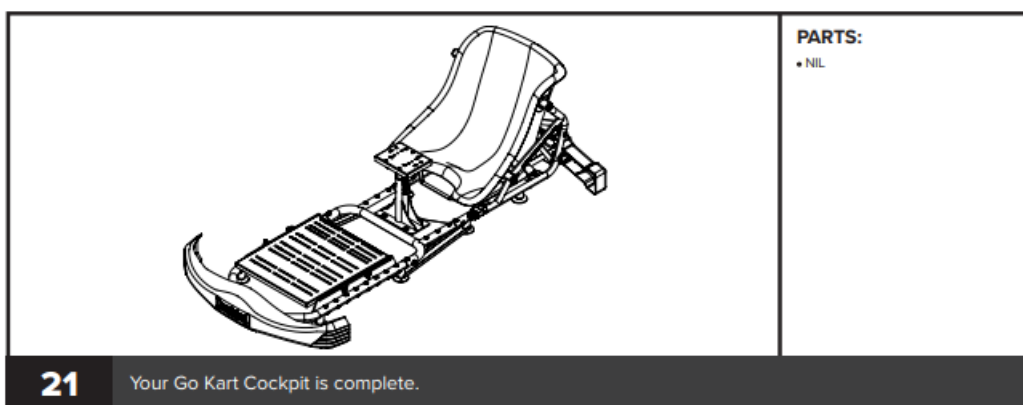
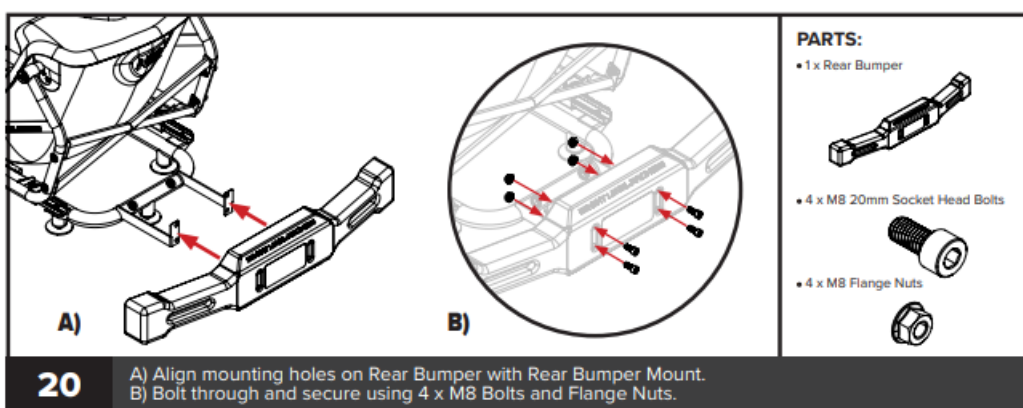
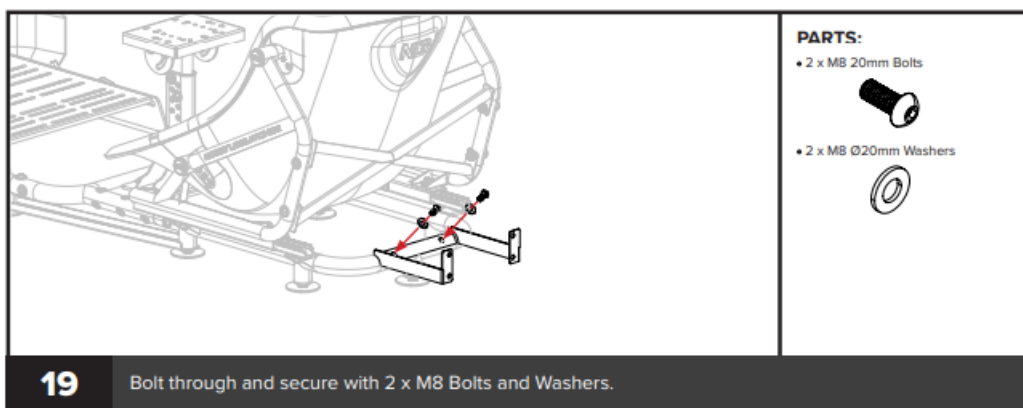
21. Your Go Kart Cockpit is complete.

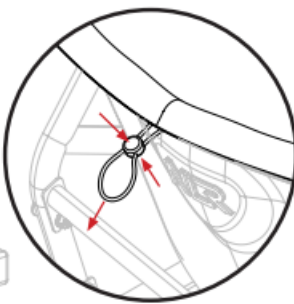

22. Install the Go Kart Seat Cover starting from the bottom first. Wrap the outer lip around the seat. Pinch drawstring release on the back and pull the drawstring to tighten.
23. Loosen the NLR Knobs securing the Pedal Plate to the Pedal Frame. Adjust to the desired position and tighten to lock in place.
24. Remove the front NLR Knobs and loosen the rear NLR Knobs securing the Pedal Plate to the Pedal Frame. Adjust to the desired angle, reinstall the front NLR Knobs and tighten to lock in place.

SEAT COVER INSTALLATION		PARTS:
		<ul style="list-style-type: none"> • 1 x Go Kart Seat Cover 
		<ul style="list-style-type: none"> • Tip: Hand wash Seat Cover separately in cold water only
<p>22 Install the Go Kart Seat Cover starting from the bottom first. Wrap the outer lip around the seat. Pinch drawstring release on the back and pull the drawstring to tighten.</p>		

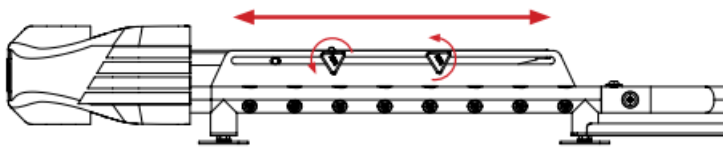
PEDAL PLATE LATERAL ADJUSTMENT		PARTS:
		<ul style="list-style-type: none"> • NIL
<p>23 Loosen the NLR Knobs securing the Pedal Plate to the Pedal Frame. Adjust to the desired position and tighten to lock in place.</p>		

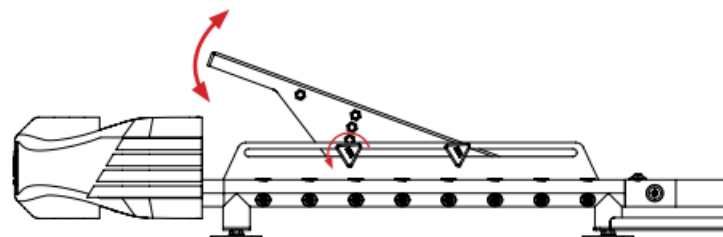
PEDAL PLATE ANGLE ADJUSTMENT		PARTS:
		<ul style="list-style-type: none"> • NIL
<p>24 Remove the front NLR Knobs and loosen the rear NLR Knobs securing the Pedal Plate to the Pedal Frame. Adjust to the desired angle, reinstall the front NLR Knobs and tighten to lock in place.</p>		

25. Uninstall the rear Bolts and Washers, loosen the front Bolts securing the Wheel Plate to the Centre Pole. Adjust to the desired angle, reinstall rear Bolts and tighten to lock in place.
26. Uninstall Bolts and Washers securing the Centre Pole to the Centre Pole Base. Adjust to the desired height. Reinstall Bolts and tighten to lock in place.
27. Remove End Caps and Bolts securing the Go Kart Seat to the Seat Frame.

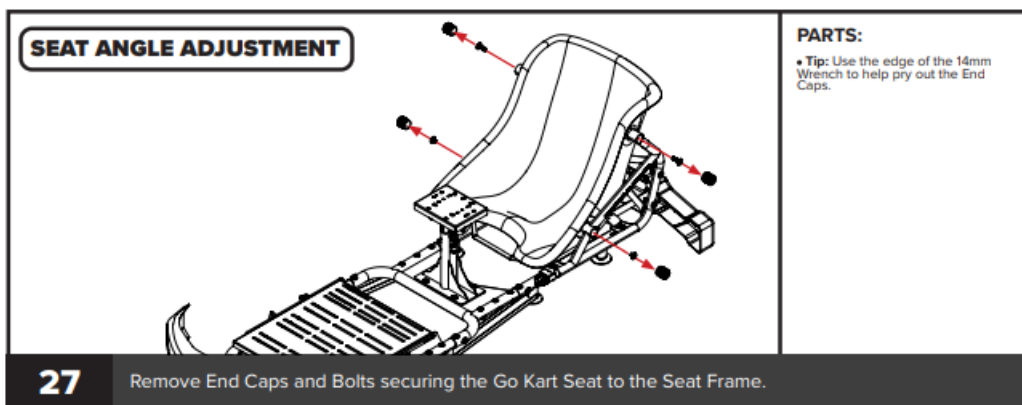
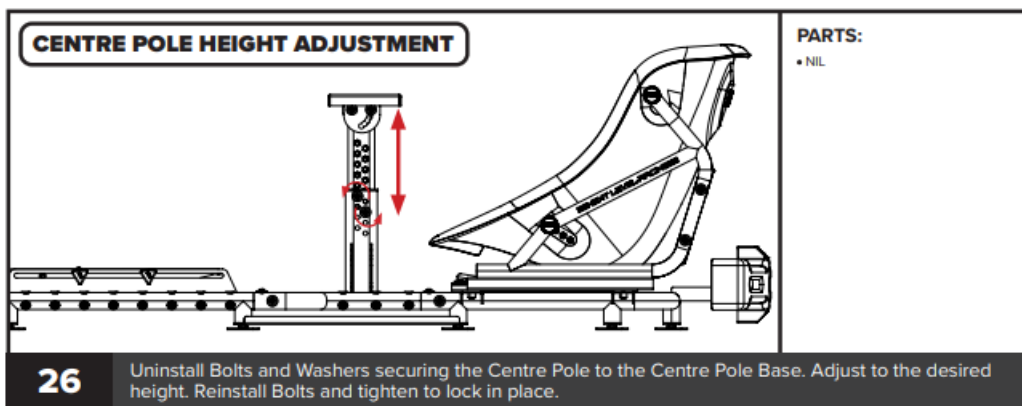
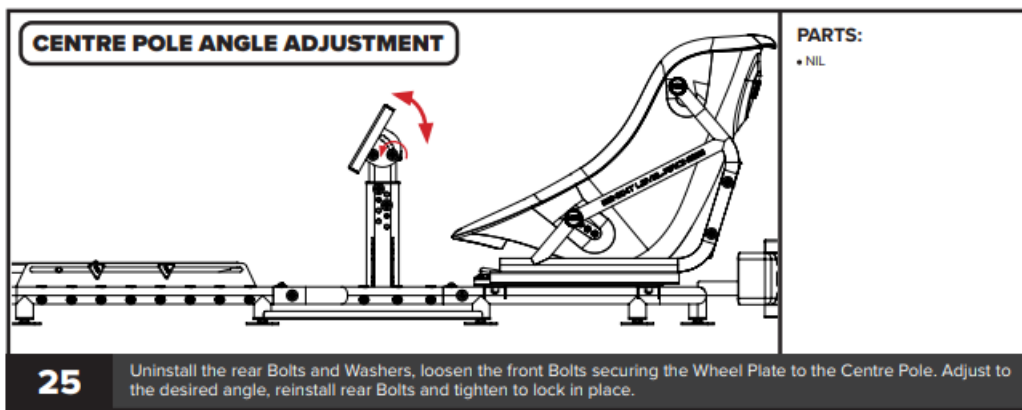

28. Adjust Go Kart Seat to the desired angle. Reinstall Bolts, tighten to lock in place. Reinstall End Caps.

29. A) Uninstall Rear Bumper.

B) Uninstall Bolts and Washers securing Rear Bumper Mount to Rear Frame

30. A) Align Buttkicker Mount with Rear Bumper Mount holes. Reinstall previously removed Bolts and Washers.

B) Reinstall Rear Bumper.

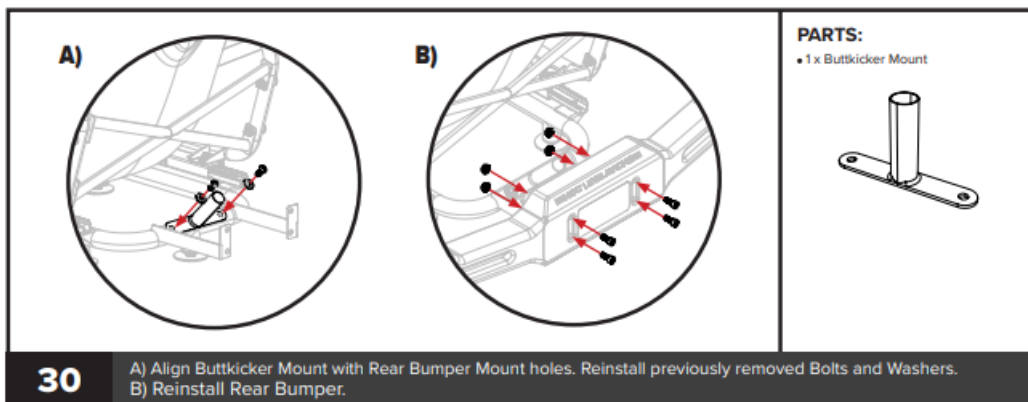
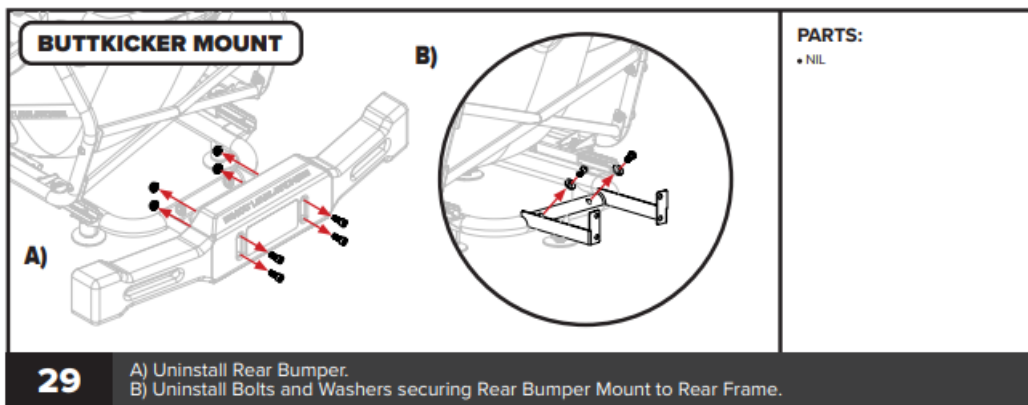
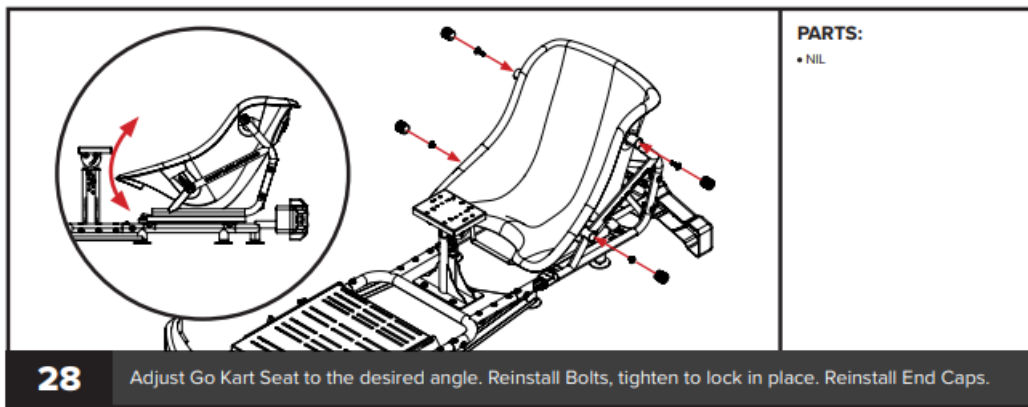

WARNING

- Please do not use power tools for assembly as over tightening can damage your frame.
- Do not force parts together.
- Avoid cross threading threaded items.
- If in doubt consult the installation video (see QR code below or contact us at support@nextlevelracing.com).
- Hand wash Seat Cover separately in cold water only.

NOTES

ASSISTANCE



If you require further support with your product please contact our friendly team at:
support@nextlevelracing.com

Documents / Resources

 The image shows the cover of an instruction manual for the "GO KART PLUS RACING COCKPIT". At the top, it says "TAKE RACING TO THE NEXT LEVEL". Below that is the "GO KART PLUS" logo with a checkered flag. Underneath is "INSTRUCTION MANUAL". A line drawing of the racing cockpit is shown in the center. At the bottom right is the "next level RACING" logo.	<p>next level RACING Go Kart Plus Racing Cockpit [pdf] Instruction Manual Go Kart Plus Racing Cockpit, Go Kart, Plus Racing Cockpit, Racing Cockpit, Cockpit</p>
--	--

References

- [📺 Video Instructions, Tips & Reviews | Next Level Racing](#)