



next level RACING F-GT Elite Keyboard and Mouse Tray Instruction Manual

[Home](#) » [next level RACING](#) » next level RACING F-GT Elite Keyboard and Mouse Tray Instruction Manual 

Contents

- [1 next level RACING F-GT Elite Keyboard and Mouse Tray Instruction Manual](#)
- [2 SIM RACING JOURNEY STARTS HERE](#)
- [3 PRE-RACE CHECKS](#)
- [4 WARNING](#)
- [5 IN THE BOX](#)
- [6 ASSISTANCE](#)
- [7 Read More About This Manual & Download PDF:](#)
- [8 Documents / Resources](#)
 - [8.1 References](#)
- [9 Related Posts](#)

next level RACING F-GT Elite Keyboard and Mouse Tray Instruction Manual

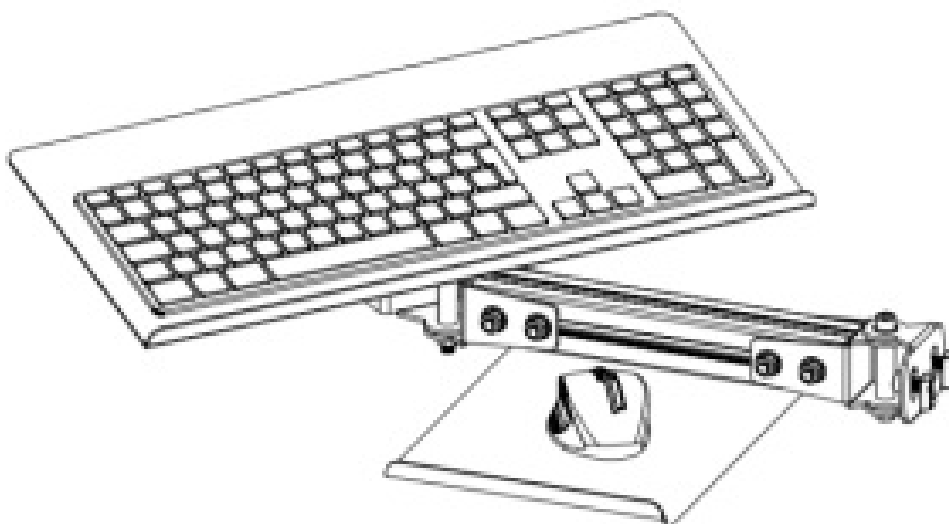

SIM RACING JOURNEY STARTS HERE

We know you're eager to start racing! Take your time with the instructions and follow this guide to assemble your product.

You'll be setting yourself up for success with following the instruction booklet to fully optimize your product.



PRE-RACE CHECKS

WARNING

- Please do not use power tools for assembly as over tightening can damage your frame
- Please ensure T-Nuts are correctly placed within the extrusion
- Do not force parts together
- Avoid cross threading bolts
- If in doubt consult the installation video or contact us on support@nextlevelracing.com
- Beware of sharp edges on the extrusion pieces



If you require any support with your product please contact our friendly team at: support@nextlevelracing.com



IN THE BOX



01 Install 2 x T-nut into the vertical post as shown. (Red dots for T-Nut placement)

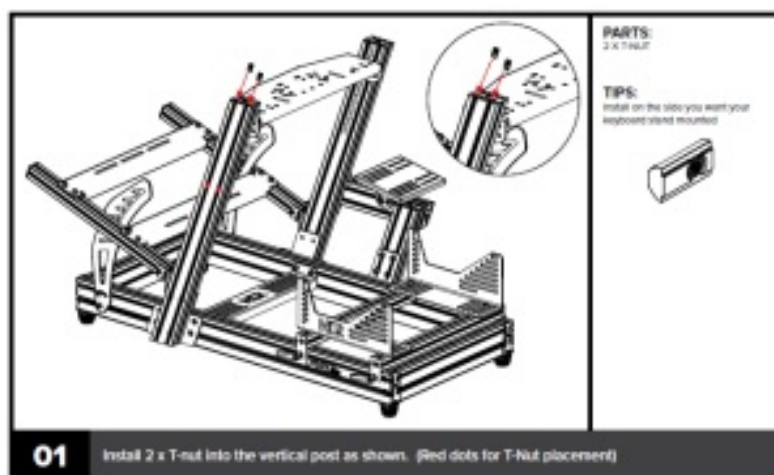

02 Bolt through the mounting bracket into the T-nuts previously installed in step 01.

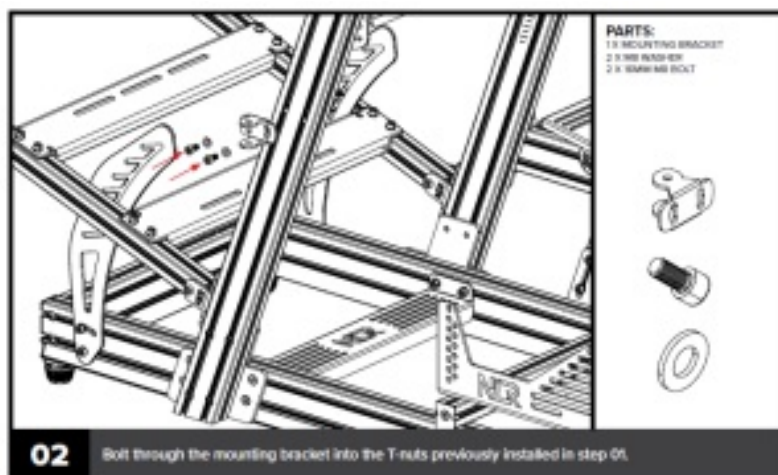

03b Line up holes on the connector bracket with holes on the mounting bracket previously installed in Step 02 and install a barrel spacer between them.

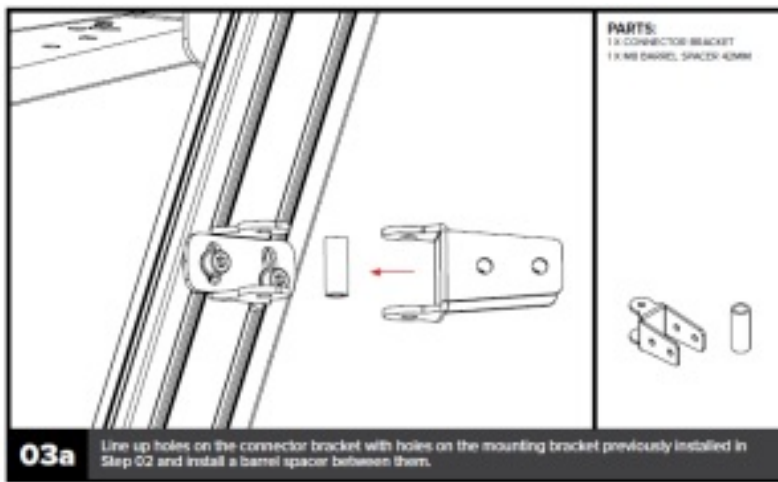

03b Bolt through the lined up holes and secure with a nut.

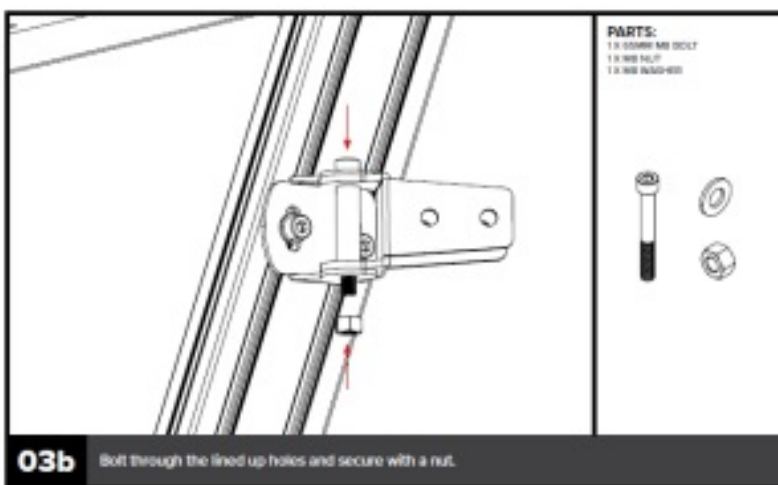

04 Line up pre-drilled holes on the 40x40 extrusion with the holes on the bracket previously installed in step 03B, bolt through and secure with a nut.

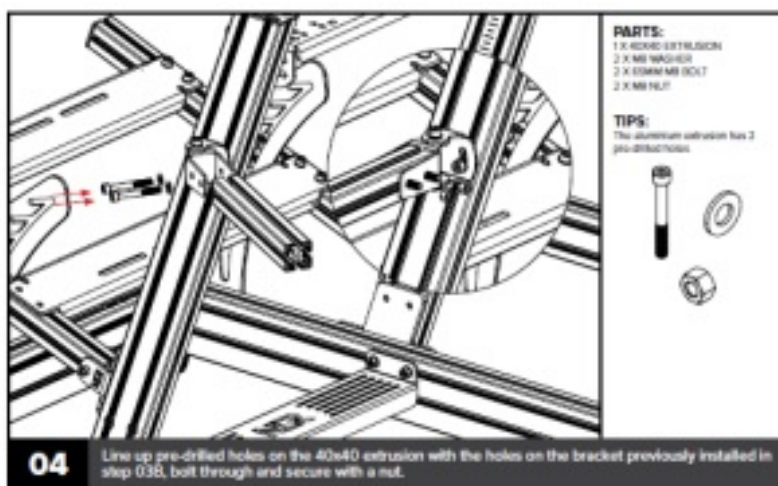

05 Slide 2 x T-nut into the bottom channel of the extrusion

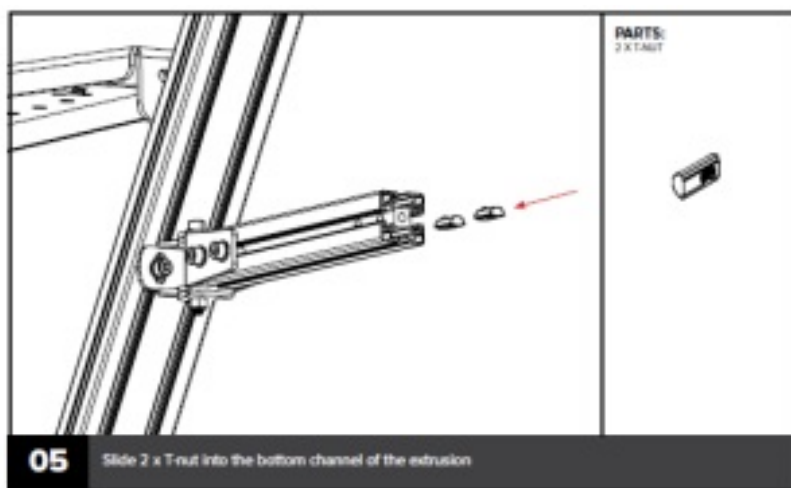

06 Line the holes on the connector bracket with the pre-drilled holes in the 40x40 extrusion then bolt through the bracket and holes with 2x M8 65mm bolts, washers and the nuts.

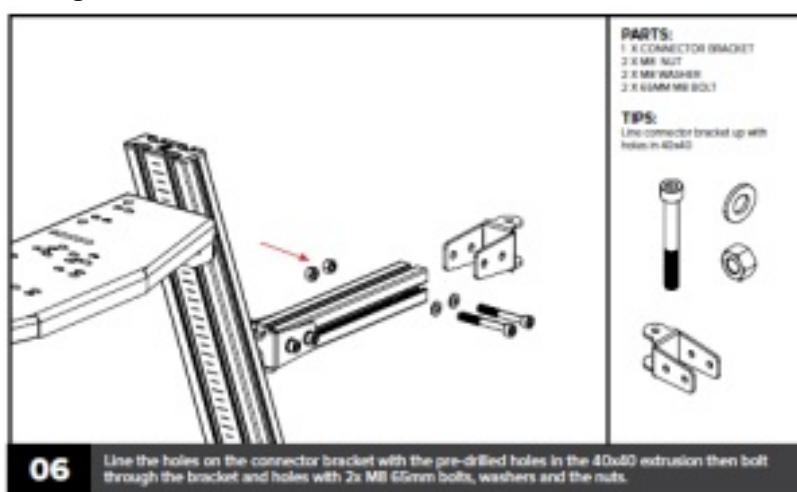

07 Line up holes on the Keyboard connector bracket with the holes on the connector bracket previously installed in

Step 06 and install a barrel spacer between the holes. Bolt through the lined up holes and secure with a nut

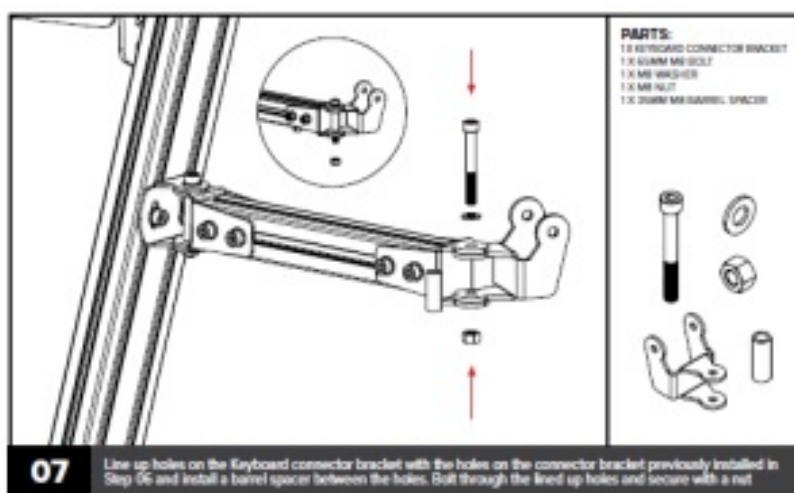

08 Line up the Keyboard tray with the connecting bracket from Step 07 then install M8 barrel spacer between the holes. Bolt through the brackets and spacer securing with an M8 nut.

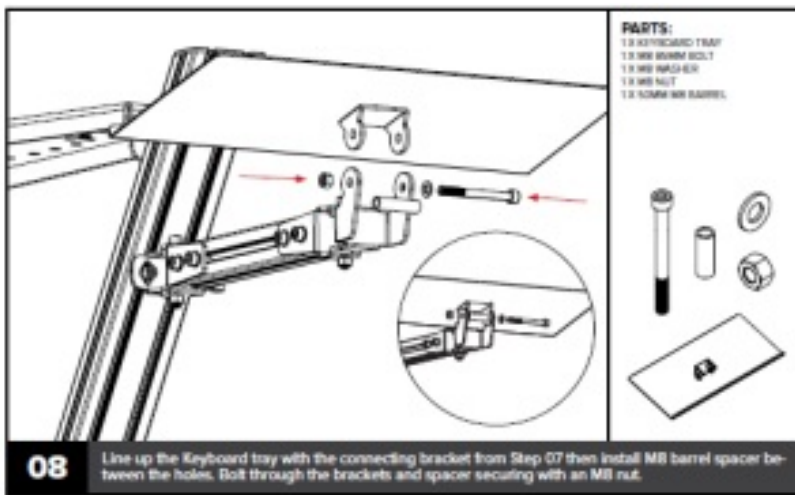

09 Bolt through the Mouse Tray into T-Nuts previously installed in Step 05.

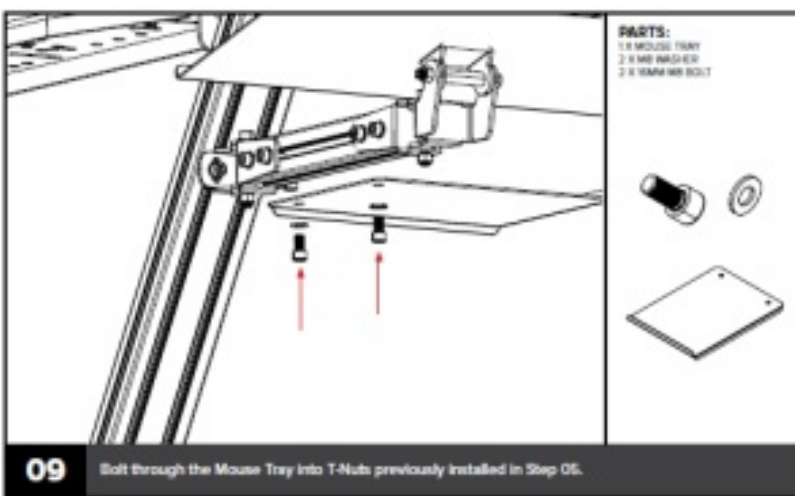



ASSISTANCE



If you require further support with your product please contact our friendly team at: support@nextlevelracing.com

Read More About This Manual & Download PDF:

Documents / Resources

	next level RACING F-GT Elite Keyboard and Mouse Tray [pdf] Instruction Manual F-GT, Elite Keyboard and Mouse Tray
	next level RACING F-GT ELITE Keyboard and Mouse Tray [pdf] Instruction Manual F-GT ELITE, Keyboard and Mouse Tray
	next level RACING F-GT Elite Keyboard and Mouse Tray [pdf] Instruction Manual F-GT Elite Keyboard and Mouse Tray, F-GT Elite, Keyboard and Mouse Tray

References

- [📺 Video Instructions, Tips & Reviews | Next Level Racing](#)