



NEXT audiocom C6 100V Ceiling Speaker User Manual

[Home](#) » [NEXT audiocom](#) » NEXT audiocom C6 100V Ceiling Speaker User Manual 

NEXT audiocom C6 100V Ceiling Speaker User Manual



Contents

1 INTRODUCTION

1.1 GENERAL DESCRIPTION

1.2 UNPACKING

1.3 SAFETY FIRST

2 GETTING STARTED

2.1 CONNECTIONS

2.2 100V LINE INSTALL REQUIREMENTS

3 HANDS-ON

3.1 INSTALLATION

3.2 PREPARATION

3.3 INSTALLATION INSTRUCTIONS

4 PROJECT/SERVICE

4.1 REC. CEILING SPEAKERS SPACING

4.2 TROUBLESHOOTING

4.3 WARRANTY POLICY

4.4 CORRECT DISPOSAL

4.5 TECHNICAL SPECIFICATIONS

5 Documents / Resources

5.1 References

6 Related Posts

INTRODUCTION

GENERAL DESCRIPTION

Thank you for purchasing a NEXT Audiocom C6 ceiling speaker.

This user manual will provide you with useful and important information about your equipment. Please devote some time reading it and keep it at hand for future reference.

The NEXT Audiocom C6 is a frameless in-wall speaker, in compliance with IEC268-5 standard, designed for installation in walls and ceilings. It provides a balanced sound with excellent speech intelligibility. The secure mounting clamps enable a fast and simple assembly. It provides a discreet sound solution ideal for hotels, restaurants, bars, lounges, conference rooms, shopping centers and many others.

ATTENTION! Because of the continuous evolution of techniques and standards, NEXT Audiocom reserves the right to change the specifications of its products without warning. For the most updated version of this manual and general information about this and other products, please visit our website www.nextaudiocom.com.

UNPACKING

NEXT Audiocom's products are built under strict quality guidelines and supervision, according to the highest standards. When unpacking your product, carefully examine it for any signs of possible transit damage and inform your dealer immediately if any such damage has occurred. It is suggested that you retain the original packaging so that the product can be repacked in the future when necessary. Please note that NEXT Audiocom and its authorized distributors cannot accept any responsibility for damage to any returned product using non-approved packaging.

PACKAGING CONTENTS:

- NEXT Audiocom C6

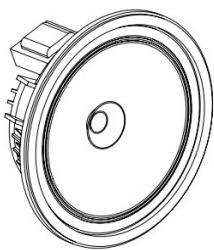

- **Cutout Template**

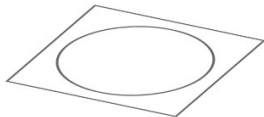

- **User Manual**



SAFETY FIRST

Please take some time to review the following statements concerning safe use of your NEXT Audiocom C6.

- Read these instructions
- Keep these instructions
- Heed all warnings
- Follow all instructions
- Use the equipment only for its intended purpose as instructed in this manual
- Before installing, observe the applicable safety regulations for your country
- Always check if the equipment is installed securely and will not fall
- Never install close to ignition or heat sources such as radiators, ovens or any other apparatus that produce heat.
- Do not use or install the equipment near water or exposed to rain
- If the equipment is not functioning properly or has been damaged in any way, switch it off immediately
- Do not open or try to service the equipment. It may only be repaired by authorized, qualified personnel
- Clean the equipment using only a clean dry cloth
- Do not operate the unit for an extended period with the sound distorting



WARNINGS



CAUTION:

Never remove the cover, because otherwise there may be a risk of electric shock. There are no user serviceable parts inside. Have repairs carried out only by qualified service personnel.

The lightning flash with arrowhead symbol within an equilateral triangle is intended to alert the user to the presence of uninsulated “dangerous voltage” within the product’s enclosure that may be of sufficient magnitude to constitute a risk of electrical shock.

The exclamation mark within an equilateral triangle is intended to alert the user to the presence of important operating and maintenance instructions.

CAUTION:

This equipment is intended for professional use. Therefore, commercial use of this equipment is subject to the respectively applicable national accident prevention rules and regulations. As a manufacturer, NEXT Audiocom is obligated to notify you formally about the existence of potential health risks. Hearing damage due to high volume and prolonged exposure: When in use, this product is capable of producing high sound-pressure levels (SPL) that can lead to irreversible hearing damage in performers, employees, and audience members.

For this reason, avoid prolonged exposure to volumes in excess of 90dB.

GETTING STARTED**CONNECTIONS**

The NEXT Audiocom C6 speaker works in 100V distributed lines. See below for a detailed explanation.

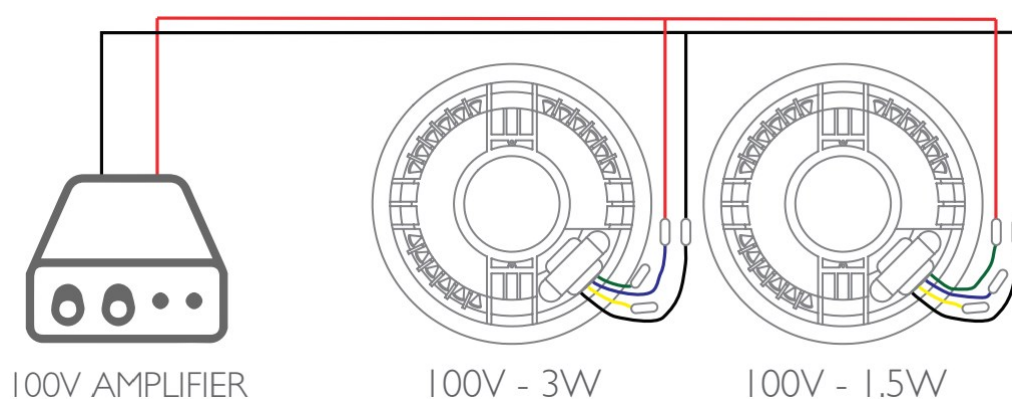
100V DISTRIBUTED LINES

The C6 comes standard with a transformer for 100V distributed lines. It is installed on the backside of the C6. It has a set of wires mounted on a connector for the input coming from the amplifier.

This set is composed of four wires with four different colors (100V Taps). See the table below:

| COMMON | 1.5W | 3W | 6W |
|--------|-------|------|--------|
| BLACK | GREEN | BLUE | YELLOW |

To configure the C6 speaker to work in the 100V distributed line method, connect a suitable 100V amplifier to the connector on the transformer. Connect the negative pole of the amplifier to the black transformer wire and the positive pole of the amplifier to one of the other colored wires that matches your intended power tap.

100V LINE INSTALL REQUIREMENTS**100V POWER AMPLIFIER REQUIREMENTS**

Make sure you have a powerful enough amplifier for your setup of C6 loudspeakers. It must have at least the total sum of power values chosen on your C6 as power tap. Applying the 20% headroom rule, in this case, is the ideal scenario. If you use 15 units of C6 loudspeakers configured to 6W each, you will need at least $15 \times 6 \times 1.2 = 108W$ of amplifier power.

100V LINE SPEAKER CABLE REQUIREMENTS

On the table below you can find the maximum distance a cable can deliver the amplifier full power.

| Power/Section | 0.75mm ² | 1mm ² | 1.5mm ² | 2.5mm ² |
|---------------|---------------------|------------------|--------------------|--------------------|
| 30W | 800m | 1066m | 1600m | 2666m |
| 60W | 400m | 533m | 800m | 1333m |
| 120W | 200m | 266m | 400m | 666m |
| 240W | 100m | 133m | 200m | 333m |

HANDS-ON

INSTALLATION

GENERAL CONSIDERATIONS

The NEXT Audiocom C6 loudspeaker is equipped with specially designed clamps that enable a safe and easy installation of the C6 on walls and ceilings with a thickness between 5 and 35mm. When installing the wires ensure that you leave a minimum 30cm surplus wire to facilitate connection and work in general. This will also prevent pulling the wires in case there is need to take the C6 out for repair or other purposes. The cutout hole must have 80mm free space in depth. The grill on the C6 is secured magnetically, providing aesthetically pleasing as there are no visible screws.

PREPARATION

Listed below is the hardware equipment needed to install the C6.



INSTALLATION INSTRUCTIONS

1. Mark the desired location and make a cutout using the cutting saw. Make sure you picked a structurally reliable location. The cutout hole should be 170mm in diameter. Use a stud finder to check for obstruction present prior to cutting

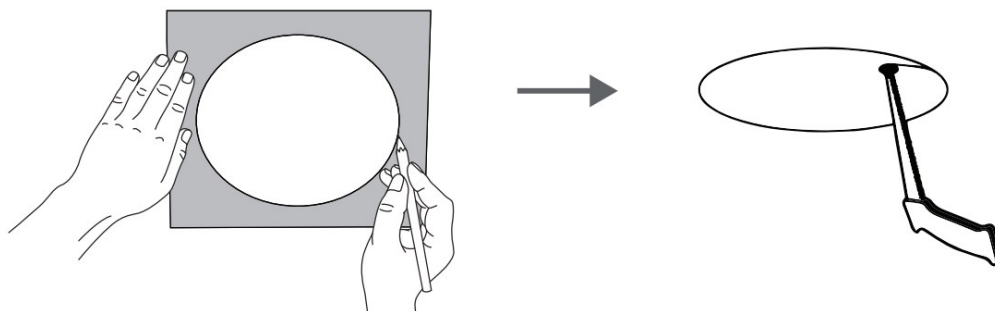

2. Install the necessary wires for the correct speaker operation.

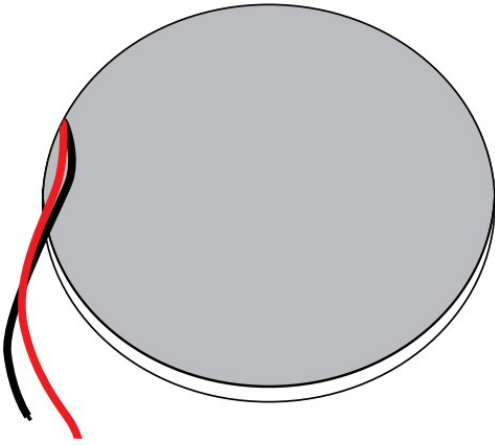

3. Connect the C6 loudspeaker as explained in the connections section of this manual. Take care to not touch the speaker directly to avoid damaging those components. Insert the C6 gently on the cutout previously made while holding the clamps upwards.

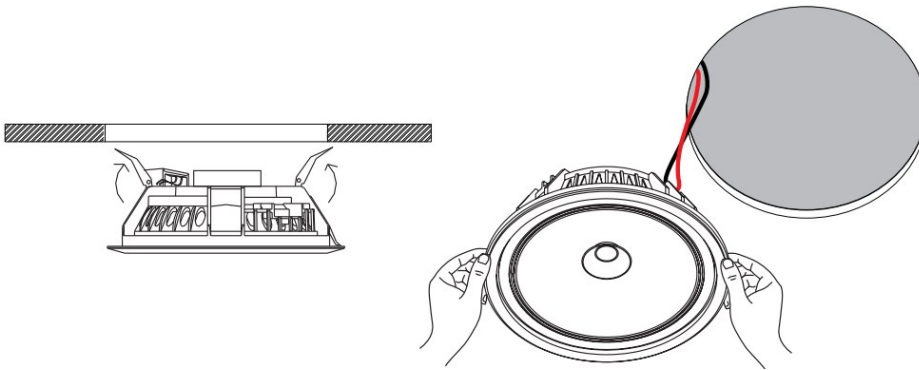

4. After inserting the speaker on the hole the clamps will automatically position themselves and lock to the wall or ceiling. Check that the C6 is secure and will not fall.

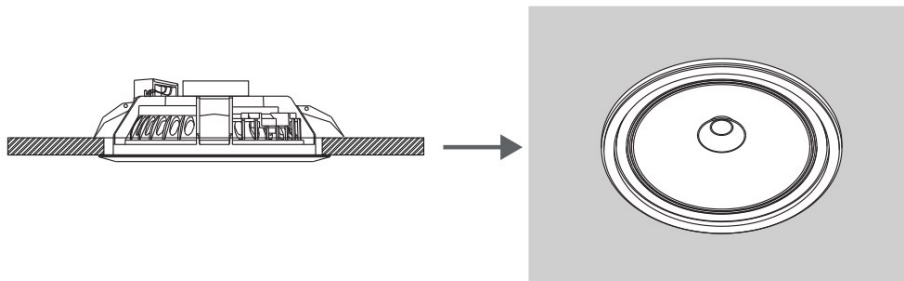

TIPS:

- The logo badge can be removed from the grill, without damaging, if needed.
- Remove the grill from the speaker and paint it to match the room decoration. Remove the grille's inside fabric before painting. Use a Latex or oil-based paint. Spray thinly to ensure the grille holes are not blocked as this will have a negative impact on the sound quality.

NOTE: NEXT Audiocom is not responsible for the quality of adhesion or finish of non-factory-applied paints.

PROJECT/SERVICE

REC. CEILING SPEAKERS SPACING

When making a project for C6, as a rule of thumb, you can use the following table to discover the speaker to speaker spacing according to the ceiling's height and project's budget. Obviously the low budget solution will not

be so efficient, in terms of coverage, as the higher budget solutions.

| Budget/Height | 2.5m | 3m | 4m | 5m |
|---------------|------|-----|------|------|
| LOW | 7.5m | 10m | 15m | 15m |
| MEDIUM | 3.8m | 5m | 6m | 7.5m |
| HIGH | 2.5m | 3m | 4.3m | 5m |

TROUBLESHOOTING

Problem: No sound from speaker

Action to Solution:

- Ensure the wires did not disconnect from the speaker or amplifier
- Check the settings on your amplifier
- Ensure the wires are not touching close to the terminals
- Disconnect the wires from the speaker and connect them to another speaker. If the new speaker works, the installed one needs to be serviced
- The wires may be damaged, replace the wires if nothing else works

Problem: Bass or treble is weak

Action to Solution:

- Check the settings on your amplifier
- Check for gaps between the speaker and the surface of installation
- Connect the speaker to another channel on the amplifier

Problem: Noise from speaker

Action to Solution:

- Check the wires are in good condition and firmly connected both to the speaker and to the amplifier
- Check the connection of your audio source

WARRANTY POLICY

NEXT Audiocom products are warranted, by NEXT Audiocom, against manufacturing defects in materials or craftsmanship over a period of 2 years counting from the date of original purchase for final costumer. The original receipt of purchase is mandatory for warranty validation purposes, and the product must have been bought from a NEXT Audiocom authorized dealer. The warranty can be transferred to a subsequent owner during the warranty period, however, this cannot extend the warranty period beyond the original warranty period of two years from the original date of purchase stated on the NEXT Audiocom's invoice.

During the warranty period NEXT Audiocom will, at its own discretion, either repair or replace a product which prove to be defective provided that the product is returned in its original packaging, shipping prepaid, to an authorized NEXT Audiocom service agent or distributor.

NEXT Audiocom cannot be held responsible for defects caused by unauthorized modifications, improper use, negligence, exposure to inclement weather conditions, act of God or accident, or any use of this product that is not in accordance with the instructions provided by this manual and/or NEXT Audiocom. NEXT Audiocom is not liable for consequential damages. This warranty is exclusive, and no other warranty is expressed or implied. This warranty does not affect your statutory rights.

CORRECT DISPOSAL



When the C6 is to be definitively discarded, take the product to a local recycling plant for a disposal which is not harmful to the environment. This equipment should not be treated as general household waste. Devices marked with this symbol must not be disposed of as household waste. For more information, please contact your retailer or local authorities.

TECHNICAL SPECIFICATIONS

- **Product Type:** 100V Ceiling Speaker
- **Frequency Response (-10dB):** 70Hz – 16kHz
- **Nominal Coverage:** 85°
- **RMS Power:** 6W
- **Nominal Impedance:** 1667Ω | 3333Ω | 6666Ω
- **Sensitivity (1W, 1m):** 90dB
- **Maximum SPL (Calculated):** 97.8dB
- **Transformer Taps:**
 - 100V: 6W, 3W, 1.5W
 - 70V: 3W, 1.5W, 0.75W
- **FR Driver:** 6.5" Dual Cone Woofer
- **Input Connectors:** Quick Release Connector
- **Standards:** In compliance with IEC268-5
- **Grille:** White Frameless Magnetic Grill RAL9003 (Paintable)
- **Dimensions (Ø x D):** 190 x 79mm (7.48 x 3.11")
- **Cutout Diameter:** 170mm (6.7")
- **Mounting Depth:** 80mm (3.15")
- **Wall/Ceiling Thickness:** 5 to 35mm (0.2 to 1.38")
- **Wall/Ceiling Fixation:** Metal Clamp
- **Net Weight:** 0.67kg (1.48lb)
- **Shipping Weight:** 0.96kg (2.12lb)



Rua da Venda Nova, 295 | 4435-469 Rio Tinto, Portugal



info@nextaudiocom.com



www.nextaudiocom.com



[instagram.com/next.audiocom](https://www.instagram.com/next.audiocom)



[facebook.com/nextaudiocom](https://www.facebook.com/nextaudiocom)



Documents / Resources

| | |
|---|---|
|  | <p>NEXT audiocom C6 100V Ceiling Speaker [pdf] User Manual</p> <p>C6 100V Ceiling Speaker, C6, 100V Ceiling Speaker, Ceiling Speaker, Speaker</p> |
|---|---|

References

-  [Homepage | NEXT Audiogroup](#)

[Manuals+](#)