



NEXIGO PJ06 Mini LCD Projector User Manual

[Home](#) » [NEXIGO](#) » NEXIGO PJ06 Mini LCD Projector User Manual 

Contents

- 1 NEXIGO PJ06 Mini LCD Projector
- 2 PROJECTOR DIAGRAM
- 3 WHAT'S IN THE BOX?
- 4 REMOTE CONTROL DIAGRAM AND FUNCTIONS
- 5 CONNECTION INTRODUCTION
- 6 SPECIFICATIONS
- 7 QUICK START
- 8 POWER ON/OFF
- 9 PROJECTOR DISTANCE & SIZE
- 10 MULTI-MEDIA CONNECTIONS
- 11 SETTING MENU
- 12 OTHER SETTING
- 13 FCC REQUIREMENT
- 14 Documents / Resources
 - 14.1 References
- 15 Related Posts



NEXIGO PJ06 Mini LCD Projector



WELCOME TO THE NEXIGO FAMILY

Thank you for choosing the NexiGo PJ06 Mini LCD Projector! You are now part of an exclusive club: the NexiGo family! It's our job to make sure you enjoy your membership. If you have any problems, please contact us any time at cs@nexigo.com for further assistance. This product is automatically covered by our industry-leading one-year manufacturer's warranty. Make sure to register your purchase at nexigo.com/warranty within 14 days of the delivery date, and we will extend your warranty coverage another year, for a total of two years! From all of us here at NexiGo, we want to thank you for your trust in us. We look forward to serving you again in the near future. Sincerely, The NexiGo Team

CONTACT INFORMATION

Website: www.nexigo.com E-mail: cs@nexigo.com. Manufacturer: Nexight INC Tel: +1(458) 215-6088.
Address: 11075 SW 11th St, Beaverton, OR, 97005, US.

PROJECTOR DIAGRAM

BACK

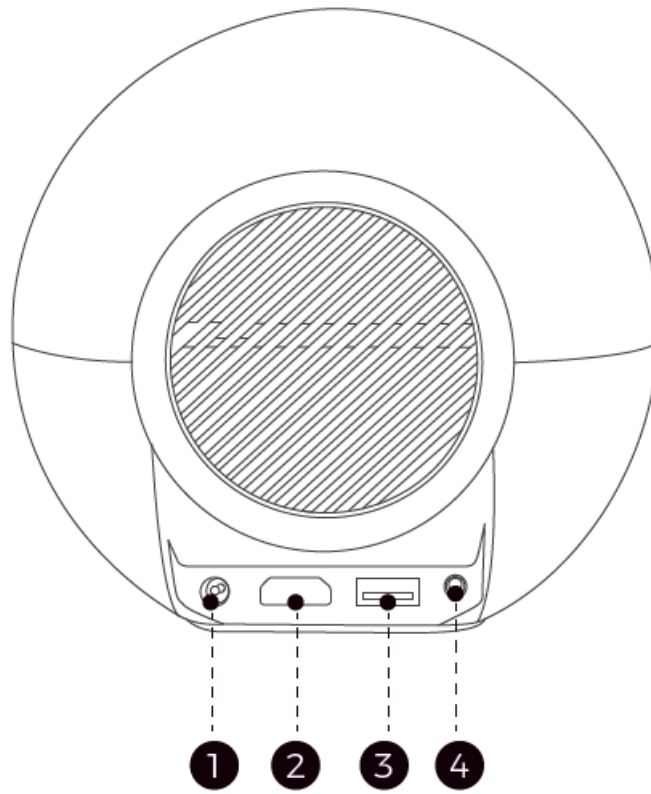

- 1. Power Input Jack
- 2. HDMI Input Port
- 3. USB Input Port
- 4. 3.5mm Audio Jack

TOP

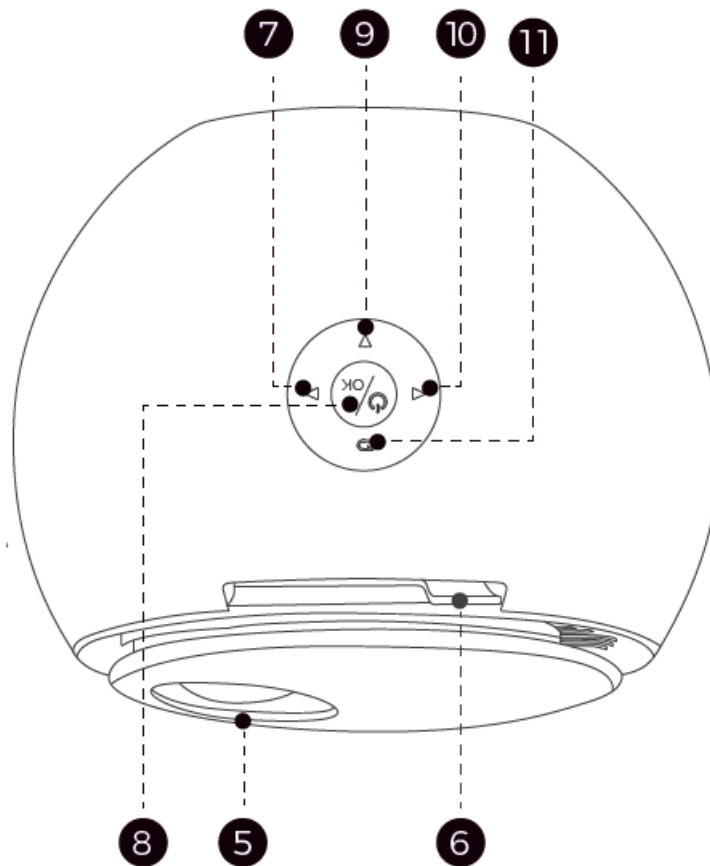

- 5. Lens

6. Focus Adjustment Knob
7. Right
8. OK (Press once)/ Power Switch (Press and hold)
9. Down
10. Left
11. Return

WHAT'S IN THE BOX?

- 1 x Mini LCD Projector
- 1 x User Manual
- 1 x Power Adapter
- 1 x Cleaning Kit
- 1 x Remote (Requires 2 AAA batteries, not included)

REMOTE CONTROL DIAGRAM AND FUNCTIONS

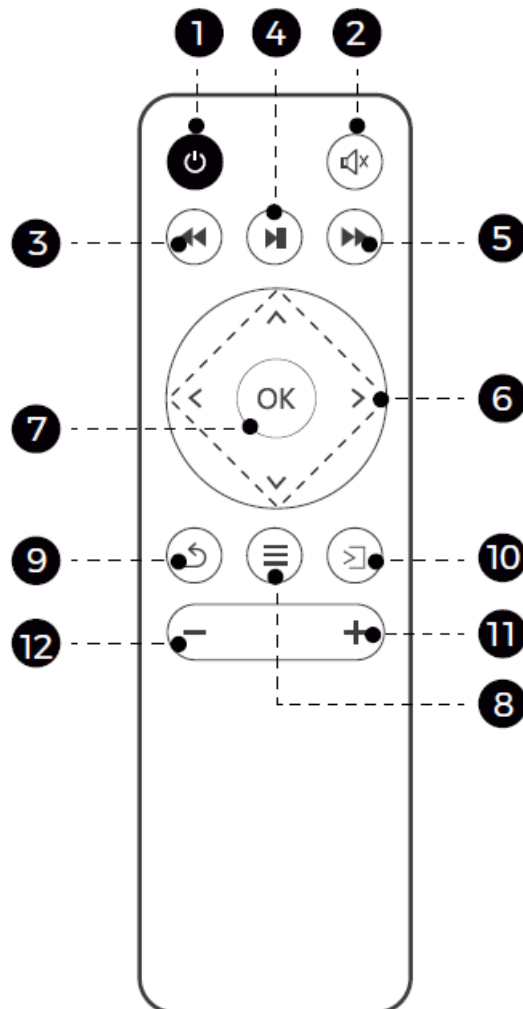

1. Power Switch: Toggles power on and off
2. Mute: Toggles audio on and off
3. Rewind: Go backward in the video/audio
4. Play/Pause: Toggles video pause and play
5. Fast Forward: Skips forward or moves quickly through video/audio

6. Left/Right/Up/Down: Navigates through the onscreen display
7. OK: Selects the current option
8. Menu: Displays the menu
9. Return: Returns to the previous screen
10. Signal Source: Displays the source selection menu
11. Vol +: Increases the volume level
12. Vol -: Decreases the volume level

CONNECTION INTRODUCTION

1. HDMI input for a TV box, TV stick, or computer.
2. USB input for a Hard Drive, USB Drive, or charging a USB device.
3. 3.5mm output for Audio Devices such as headphones and speakers.

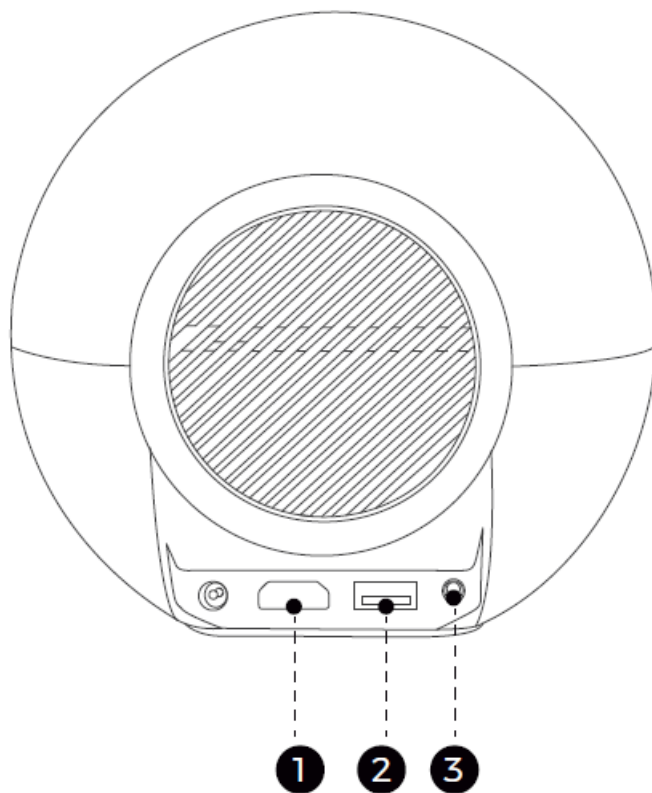

SPECIFICATIONS

Imaging technology	LCD
Light Source	LED
Native Resolution	1280 x 720
Projection Distance	2.62-11.48 ft
Projection Size	24-118 inches
Aspect Ratio	4:3, 16:9
Projection Ratio	1.4:1
Power Input	DC 19V \approx 2.5A
Integrated Watt Use	48W
Input Port	HDMI x 1, USB x 1
Output Port	3.5mm audio jack x 1
Speaker	3W x 1

QUICK START

CHOOSING A LOCATION

The room's size and layout will be the most important factors in choosing where to place the projector. Consider the following when selecting a location:

- The size, shape, and position of your screen.
- Location of a suitable power outlet.
- Ensure the projector has sufficient space around it for airflow.

The projector is designed to be installed in one of four layouts. You can either hang the projector from the ceiling via a standard 1/4" mounting bracket (sold separately) or simply place it on a stable surface. You may need to change the projection mode so the images display correctly. Select Projection Mode under Setting> Picture Setting, then choose your preferred projection mode (see below).

Note:

A specific rear projection screen is required to use the rear projection function.

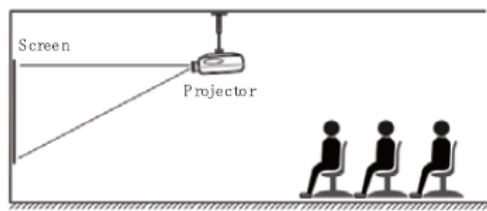

① Ceiling mount (front projection)

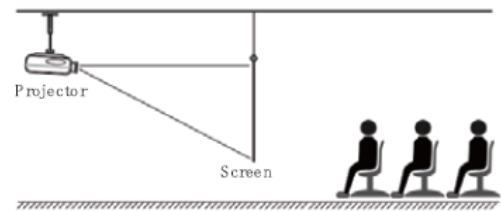

③ Ceiling mount (rear projection)

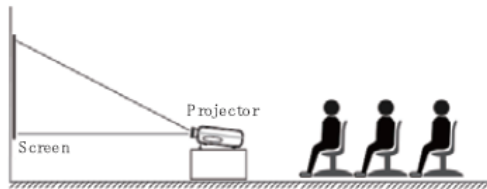

② Desktop mount (front projection)

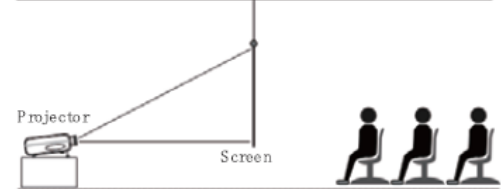

④ Desktop mount (rear projection)

POWER ON/OFF

1. Plug the power adapter into a power outlet.

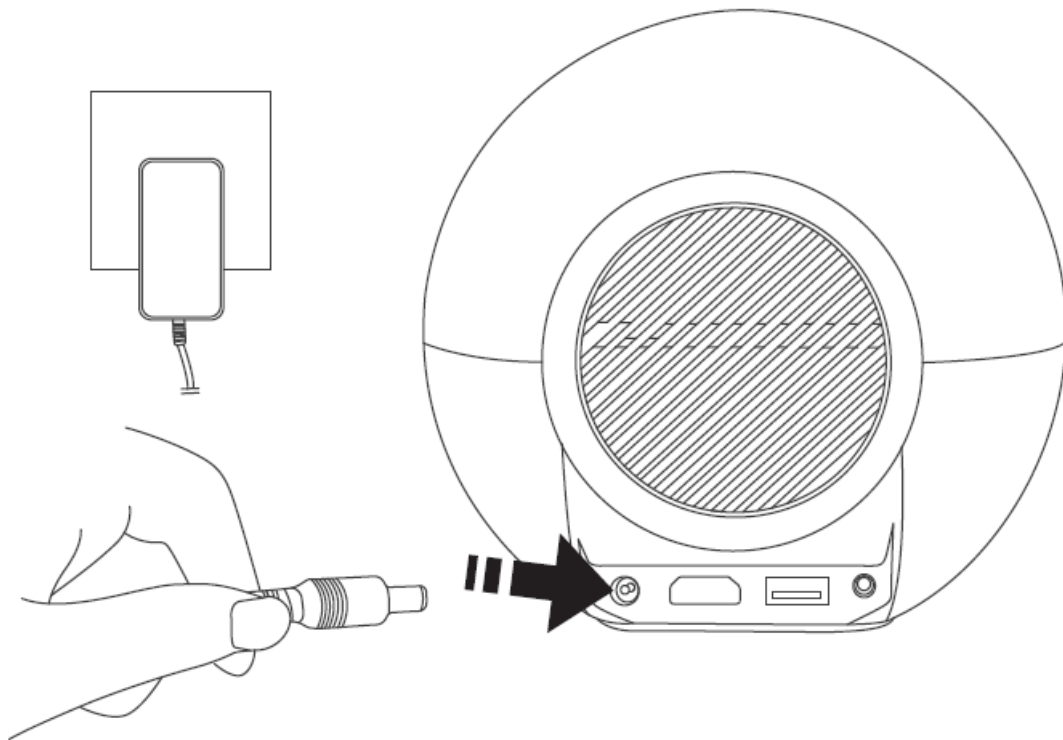

2. Press and hold the Power Switch to turn on the projector. Press the Power Switch to turn off the projector. Alternatively, press the Power Switch on the remote to turn the projector on or off.

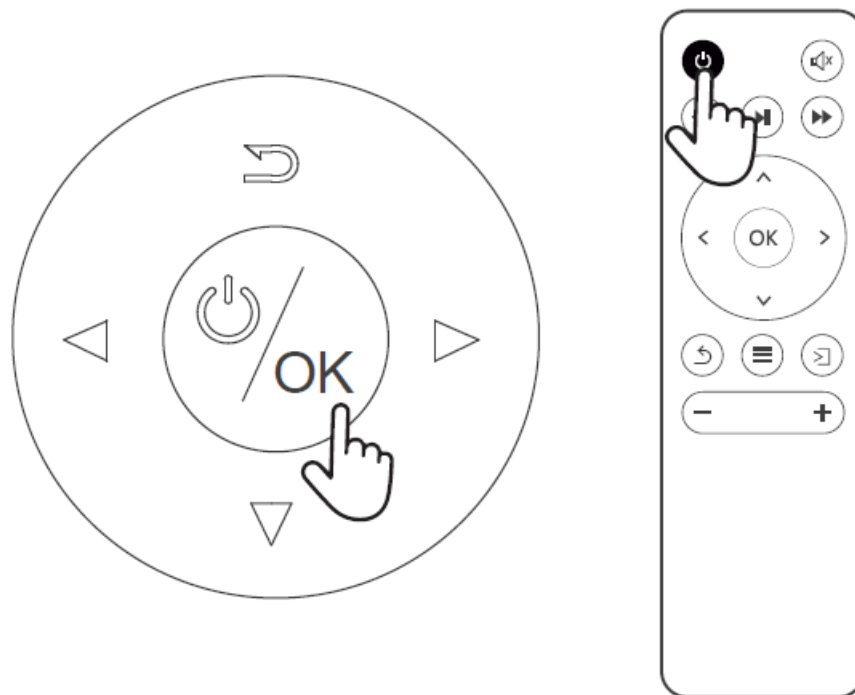

PROJECTOR DISTANCE & SIZE

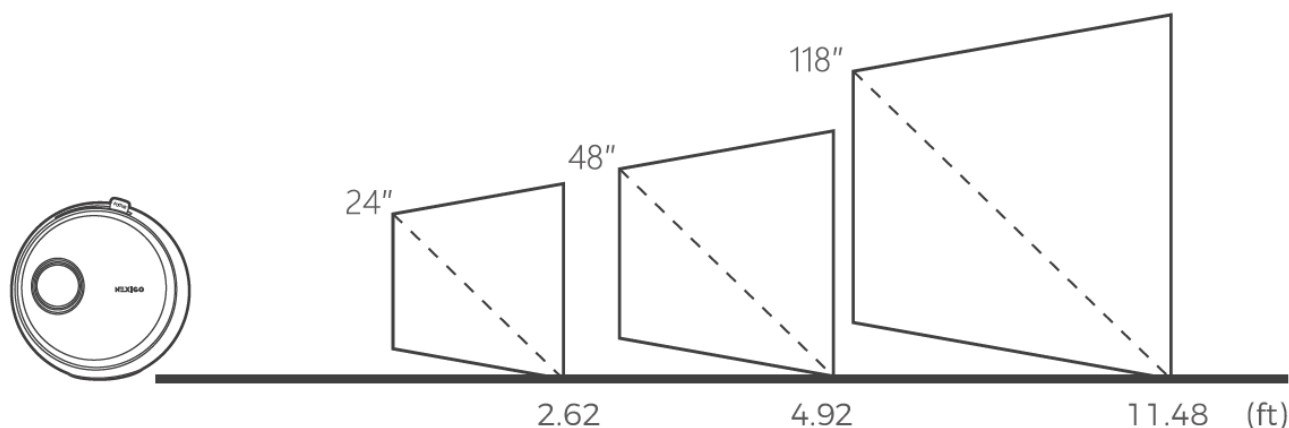

Note:

Due to manufacturing tolerances, there may be variances of up to 3% from unit to unit. The above data is for reference only. Please use actual measurements when installing this device.

FOCUS ADJUSTMENT

Please use the Focus Adjustment Knob to adjust the focus, rotating it left or right until the image becomes clear and sharp. If the image appears blurry, rotate the knob in the opposite direction until the image clears up.



MULTI-MEDIA CONNECTIONS

This section shows you how to connect the projector to other equipment.

USB CONNECTIONS

Insert your USB drive into the USB port shown in the diagram below. In the on-screen menu, choose the type of content you want to open: Movie, Music, Photo, or Text.

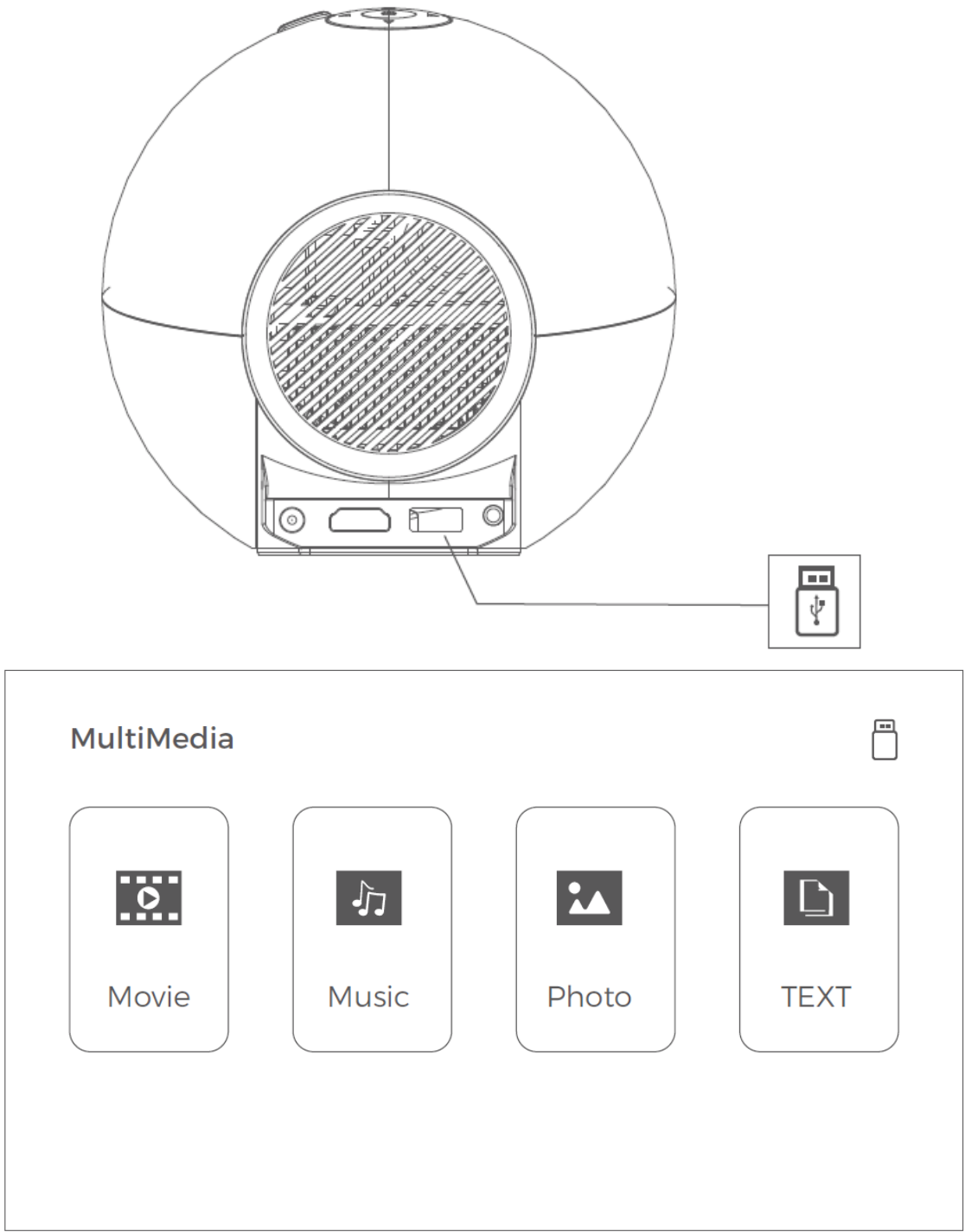

Multi-media Supported F ormat	Audio Format	MP3/AAC/WAV/LOAS/PCM/OGG/ FLAC/AC3
	Photo Format	JPEG/BMP/PNG
	Video Format	DIVX/RM/3GP/AVI/MKV/FLV/MOV/ MP4/MPG/VOB/MPG/RMVB/RM
	Text Format	TXT

HDMI CONNECTIONS

Plug an HDMI cable into the device you want to connect to the projector and then insert the other end of the HDMI cable into the HDMI port as shown in the diagram below. Open the on-screen menu and select the HDMI source in the Input Source tab. This will allow you to display the screen of whatever device has been plugged in.

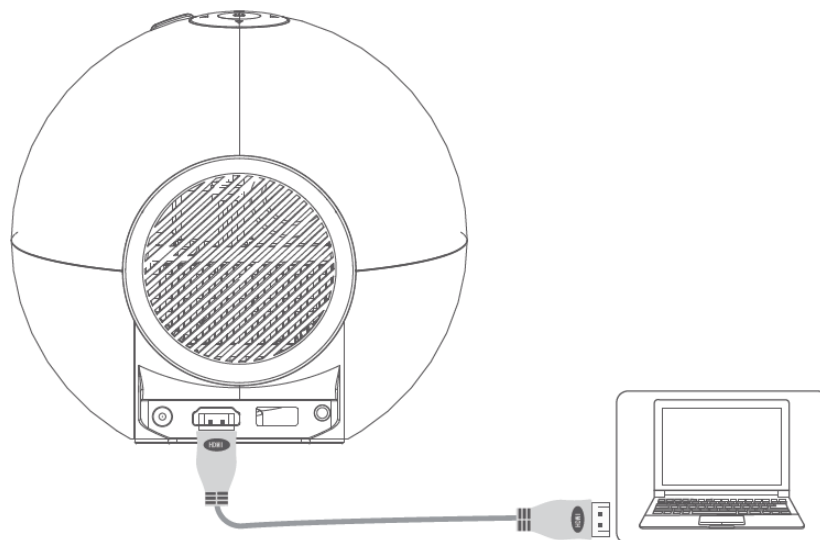

3.5MM AUDIO CONNECTION

To play sound from the source, plug either headphones or speakers into the 3.5mm audio port as shown below.

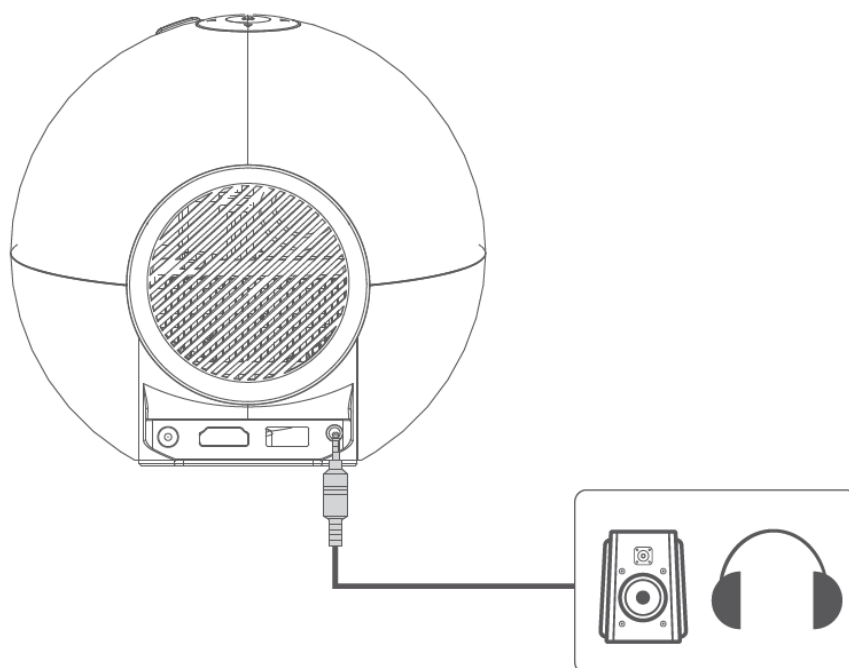

SETTING MENU

PICTURE SETTING

Picture Setting

System Setting

Other Setting

Projection Mode

Image Scaling

Color Range

Aspect Ratio

Picture Mode

Projection Mode:

Shift the model of the projector. The options are Standard, Mirrored, Flipped, and Flipped and Mirrored.

Image Scaling:

Change the size of the objects shown on the screen.

Color Range:

Adjust the color range of the projector.

Aspect Ratio:

The aspect ratio is a figure that identifies the size of an image by its width and height. Common aspect ratios are 4:3 and 16:9.

Picture Mode:

Select one of four modes: Standard, Dynamic, Mild, or User. User mode enables custom settings for contrast, brightness, color, and sharpness.

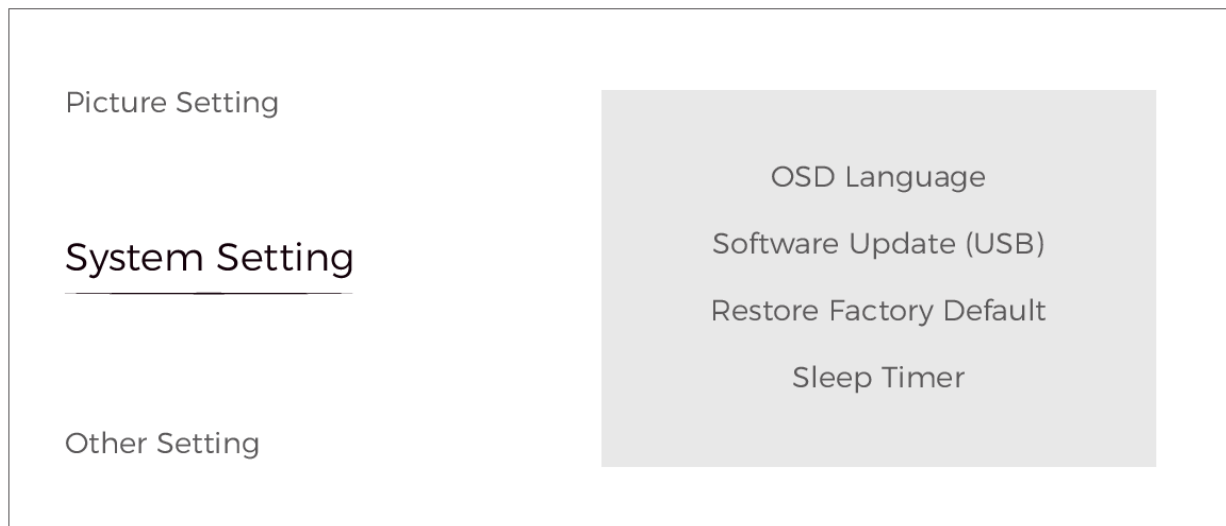
SYSTEM SETTING**OSD Language:**

Choose the language used in the projector menus.

Software Update (USB):

Update the software version on the projector.

1. Please check nexigo.com/support periodically for new firmware downloads.
2. Download the latest firmware to a USB flash drive, then insert the flash drive into a USB port on the projector.
3. In the menu screen, select Setting>System Setting>Software Update (USB).
4. The software will update automatically. Do not try to use or turn off the projector until the update is complete.
Interfering with the update process may damage the projector.

Note:

Updating firmware typically is not required and will only be necessary if instructed to do so by the NexiGo technical support team. The projector will reset after the software updates and all saved settings will be erased.
Restore Factory Default: Reset the projector to factory default settings.

Sleep Timer:

Set the time duration for the projector to shut down automatically.

OTHER SETTING

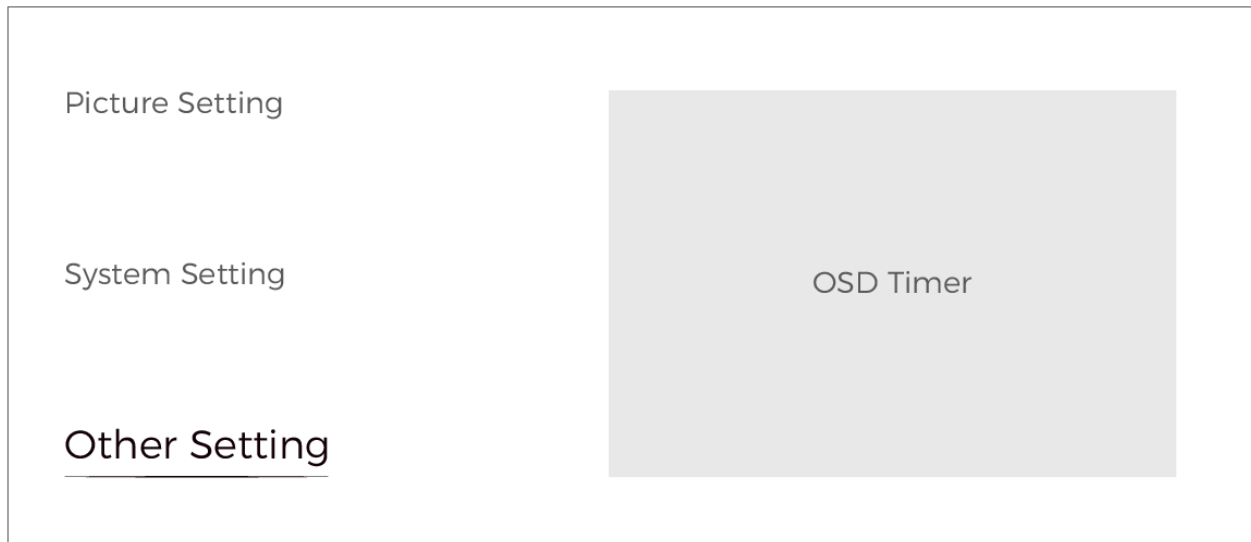

OSD Timer:

Set the time duration for the OSD menu to switch to the home page automatically.

FCC REQUIREMENT

Any changes or modifications not expressly approved by the party responsible for compliance could void the user's authority to operate the equipment. This device complies with Part 15 of the FCC Rules. Operation is subject to the following two conditions:

1. this device may not cause harmful interference, and
2. this device must accept any interference received, including interference that may cause undesired operation.

WARNINGS



1. Read the manual carefully before you use the projector.
2. Unplug immediately if you notice any issues or problems with your projector. If your projector begins to smoke, make unusual noises, or any strange odor is noticed, immediately unplug your projector. Ensure that it is placed in an open area with ventilation, away from any objects that may be a fire hazard. Contact Customer Support for further details.
3. Do not remove the projector cover. This projector contains high voltage circuitry. Inadvertent contact may result in a severe electric shock and could result in death. Do not attempt to service this product yourself. Please contact the manufacturer directly if you have any issues to exercise your warranty.
4. Do not modify this equipment.
5. Avoid dropping or throwing the projector.
6. Do not face the projector lens to the sun.
7. Use only the provided power cable.
8. Do not place the projector on an uneven or unstable surface, or one that is subject to vibration.
9. Do not place this device near another device that produces a strong magnetic field or one with a heavy electrical load.
10. Do not look into the lens when the projector is operational. It may cause permanent eye damage.
11. Do not turn off the main power abruptly or unplug the projector during operation. Wait until the fan has turned off before powering off fully.

12. Do not attempt to use the projector in a vertical orientation.
13. Place the projector within a slope of $\pm 15^\circ$. Any greater slope presents the danger of the unit sliding and falling.
14. Avoid obstructions around the projector air vent as this may cause damage to the unit or create a fire hazard.
15. This unit may be damaged by liquids. Keep liquids away from the unit to prevent damage. Liquid damages are not covered by the warranty.
16. If the projector is unused for a prolonged period of time unplug it from the power source.
17. If there are any mechanical issues with the projector, please contact NexiGo Support to exercise the warranty;
Do not attempt to repair the item yourself.
18. Safe Operational Parameters
 - Operating temperature: between $+41^\circ\text{F}$ ($+5^\circ\text{C}$) and $+95^\circ\text{F}$ ($+35^\circ\text{C}$).
 - Operating humidity: between 30 and 90%.

Documents / Resources

	<p>NEXIGO PJ06 Mini LCD Projector [pdf] User Manual PJ06, Mini LCD Projector, PJ06 Mini LCD Projector</p>
---	---

References

-  [NexiGo Manuals | NexiGo](#)
-  [NexiGo Warranty Registration | NexiGo](#)
-  [NexiGo | Taking Your Video Calls to the Next Level](#)