



NEXIGO B10 Add-On Baby Camera Unit User Manual

[Home](#) » [NEXIGO](#) » NEXIGO B10 Add-On Baby Camera Unit User Manual 



User Manual
NexiGo ADD-ON BABY CAMERA UNIT

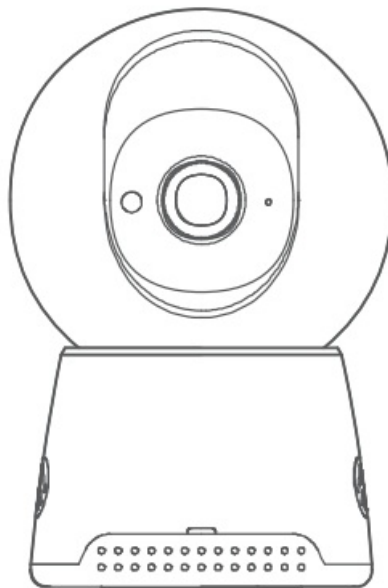

B10



<http://www.nexigo.com/warranty>

Register to get an EXTRA ONE-year warranty. Only valid if registering within 14 days of product delivery. [nexigo.com/warranty](http://www.nexigo.com/warranty)

Contents

- [1 Welcome to the NexiGo Family!](#)
- [2 Contact Information:](#)
- [3 Product Description](#)
- [4 What's in the Box?](#)
- [5 Camera Diagram](#)
- [6 Specifications:](#)
- [7 Setting up the Camera](#)
- [8 Connection Instructions:](#)
- [9 Disconnection Instructions:](#)
- [10 Mounting the Camera:](#)
- [11 Notes](#)
- [12 FCC Requirement](#)
- [13 Documents / Resources](#)
- [14 Related Posts](#)

Welcome to the NexiGo Family!

Thank you for choosing the NexiGo B10 Add-On Baby Camera Unit! You are now part of an exclusive club: the NexiGo family! It's our job to make sure you enjoy your membership. If you have any problems please contact us at cs@nexigo.com at any time for further assistance. This product is covered by our industry-leading 1-year manufacturer's warranty. Make sure to register your purchase at [nexigo.com/warranty](http://www.nexigo.com/warranty) within 14 days of the delivery date to extend your warranty coverage to TWO Years!

From all of us here at NexiGo, we want to welcome you again to the family. We thank you deeply for your trust and for your business. We know you'll love it here. We look forward to serving you again in the near future.

Yours Sincerely, The NexiGo Team

Contact Information:

Website: www.nexigo.com

Manufacturer: Nexight INC

Email: cs@nexigo.com

Tel: +1(458) 215-6088

Address: 11075 SW 11th St, Beaverton, OR, 97005, US

Product Description

The NexiGo 810 ADD-ON BABY CAMERA can be paired with the 6200 Monitor only. It has a night vision mode so even in total darkness you can still see what is going on in the room. And with features like temperature

monitoring, and zoom with pan and tilt options, you can make sure that everything is exactly the way you want in your child's room. Finally, with built-in Lullaby's if you just are not able to get them to go to sleep you can put on the music and leave the room so they are not overstimulated and monitor them from a distance. The Nexigo 810 is here to help your sleep-addled brain and to make sure you always know exactly what is going on in your baby's room.

1 x Video Baby Camera
1 x Camera Wall Bracket
1 x Mounting Screws Pack
1 x 3M Double-Sided Adhesive Tape 1 x Camera Power Adapter (5V / 1A)
1 x Camera Micro-USB Power Cable (3m) 1 x Instruction Manual

What's in the Box?

1. Wide-Angle Lens
2. Microphone
3. Speaker
4. Micro USB Port
5. Pairing Button
6. Temperature Sensor
7. Antenna

Camera Diagram

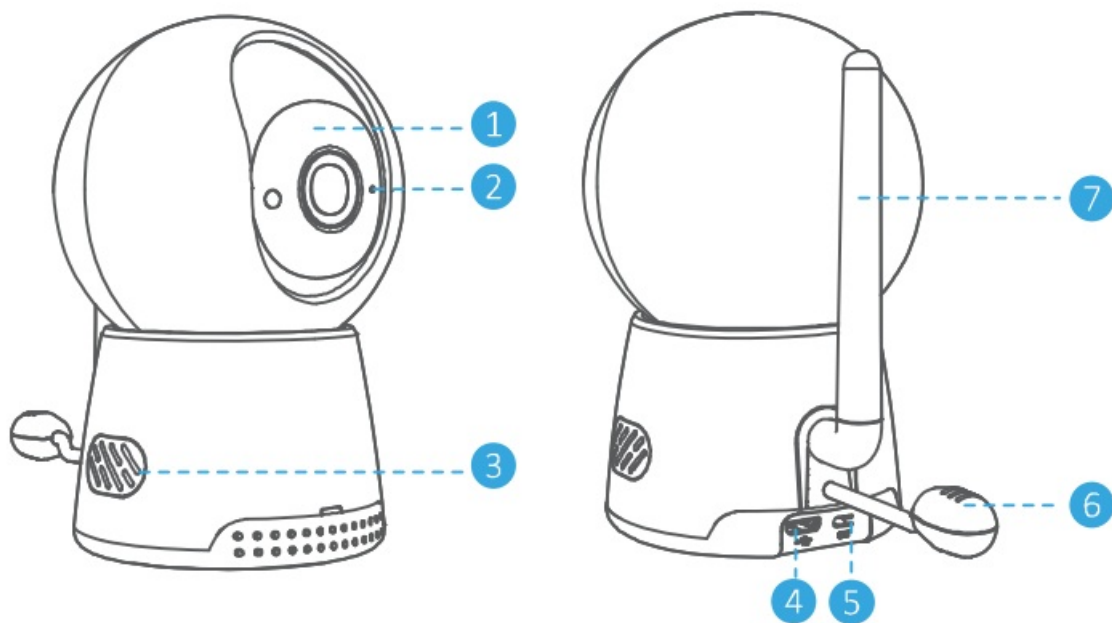

Specifications:

Product Name	NexiGo Add-On Baby Camera Unit
Model	B10
Transmission Range	300~500ft – Inside a standard home; 1000ft – In an open area
Power Input	AC 5V / 1A
Native Resolution	1280 x 720
Working Temperature	-10°C ~ +50°C
Storage Temperature	-20°C ~ +60°C
Speaker	1W

Setting up the Camera

1. Plug the **Camera Micro-USB Power Cable** into the **Camera**, and then insert the other end of the cable into the **Camera Power Adapter**.
2. Plug the adapter into a power outlet. The Camera does not have a battery and requires a power connection to function.

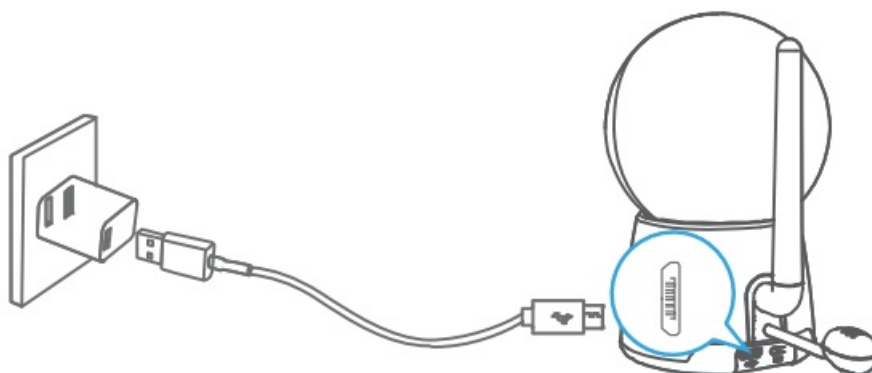

Connection Instructions:

1. Place the **Camera** within the operating range of the **Monitor** you've already had.
2. Press and hold the Power Button on the right side of the Monitor for two seconds to turn it on.

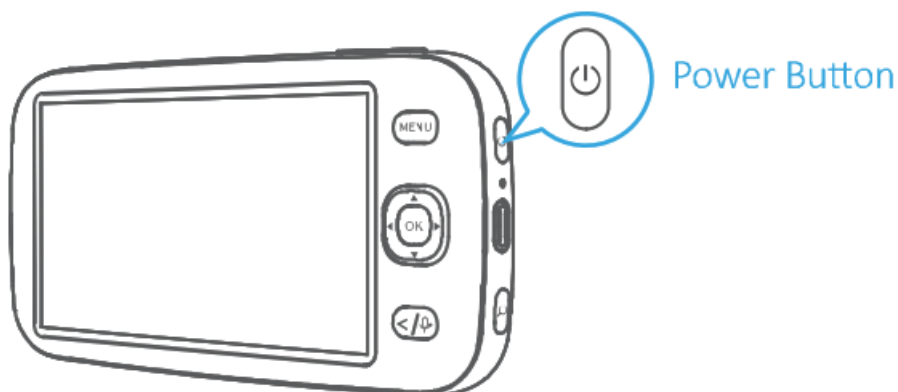

3. Press the **Menu Button** and select **Camera Settings** to enter the corresponding interface.

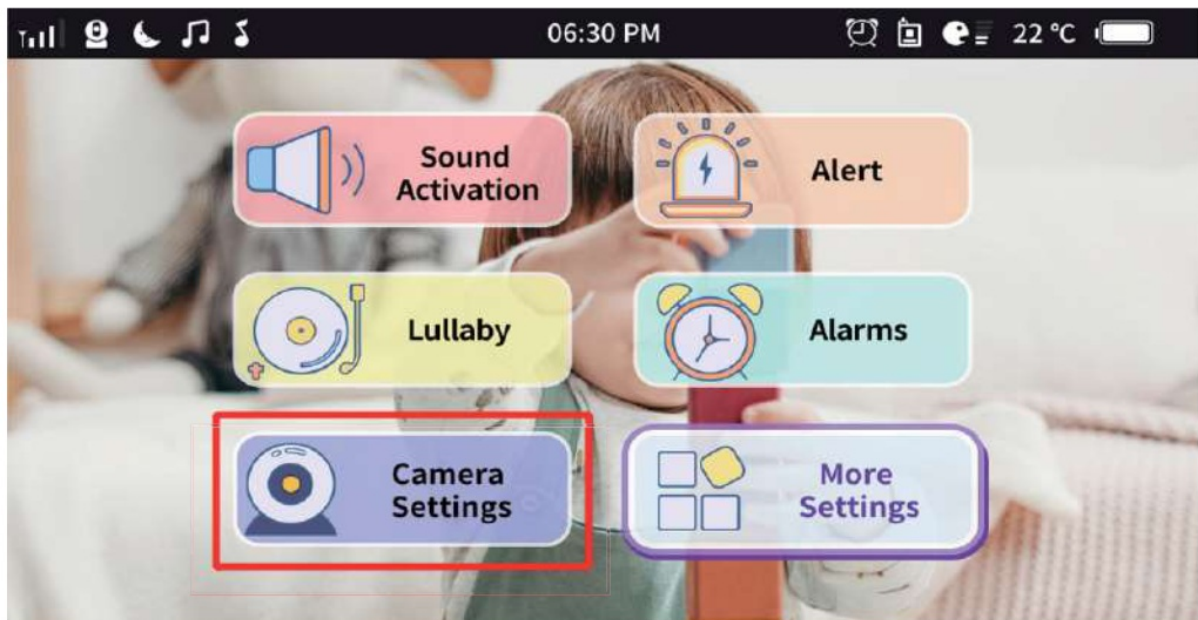

4. Select **Camera Pairing** from the list below. Choose the Camera number you wish to add, then press the **OK Button** to confirm. Select **Add** to begin pairing.

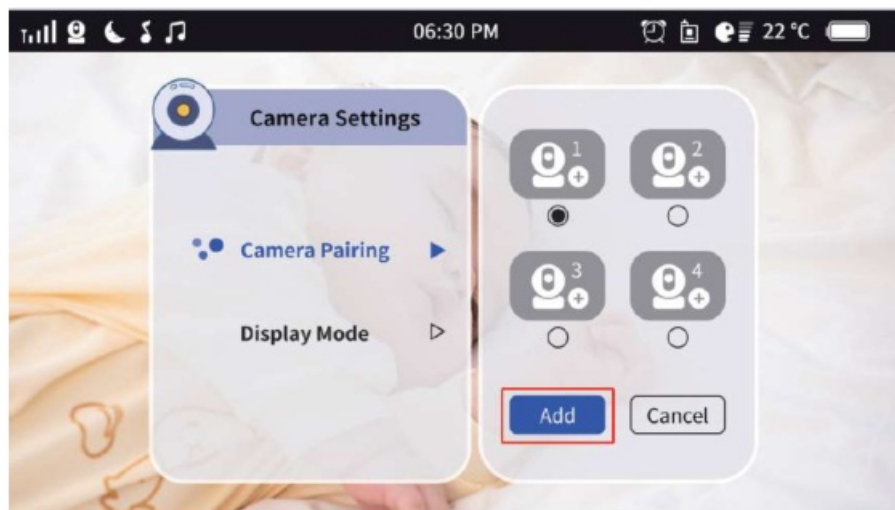

5. Press and hold the **Pairing Button** on the rear of the Camera until a “beep” is heard. You must perform this step within 60 seconds after starting the pairing process.

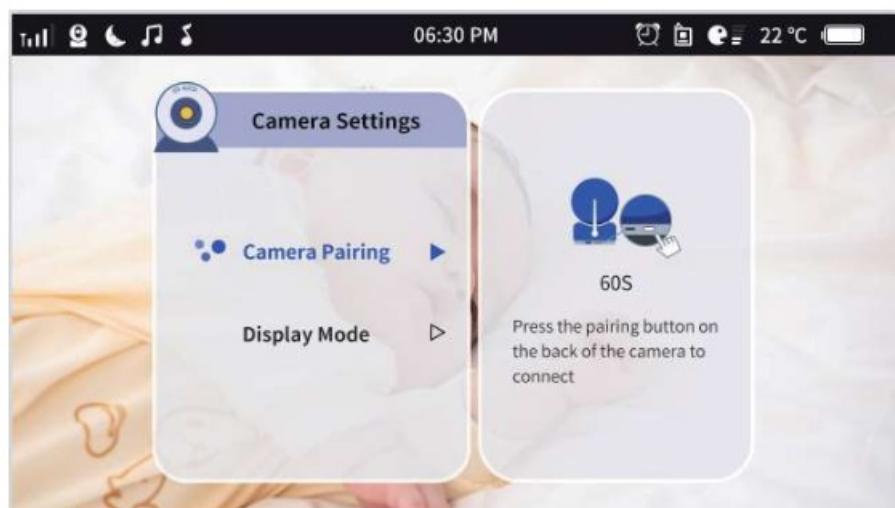

6. A “Camera added successfully” notice will be displayed on the screen. The connection is now active.

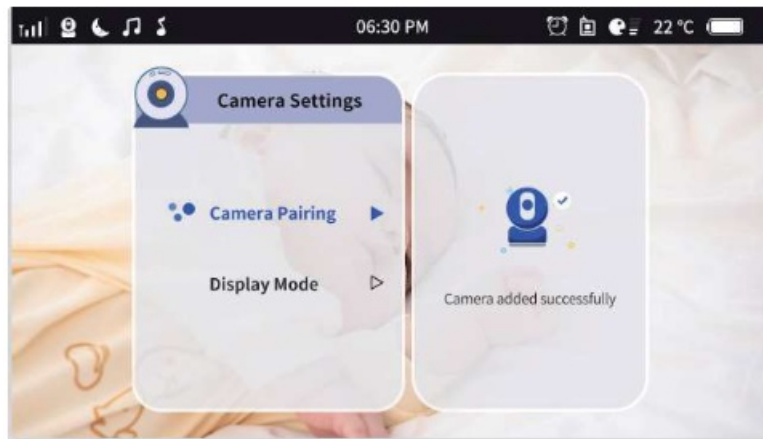

7. You may repeat the process above for up to additional Cameras.

Disconnection Instructions:

1. To disconnect a camera, navigate to: **Menu > More Settings > Camera Settings**. Select the Camera you wish to disconnect, then select **Delete** to disconnect the camera.

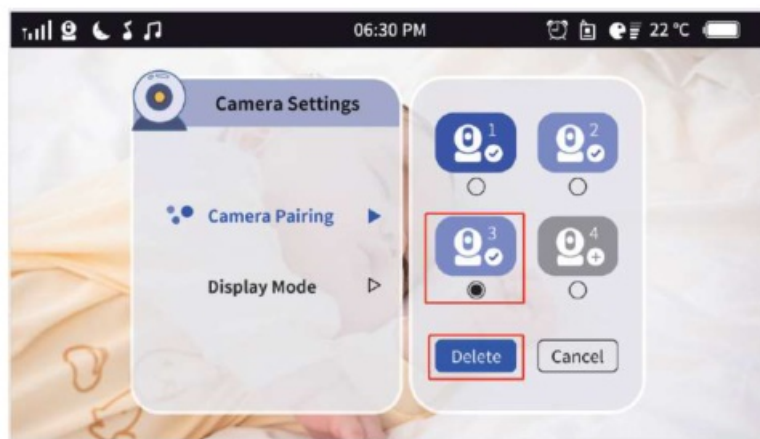

2. If a Camera becomes disconnected unexpectedly for any reason, an alarm tone will play and the image below (or a similar one identifying the specific camera that has been disconnected) will appear on the Monitor alerting you to which Camera has lost its connection. Press any button to stop the alarm.

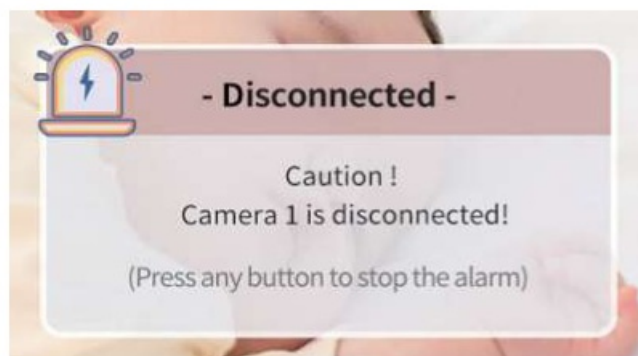

Mounting the Camera:

Option 1- Use screws to secure the Camera Wall Bracket

Consider the following factors when selecting a location to mount the camera:

- The mount can be positioned on a **corner** or on a **flat surface**. Do not mount this from a ceiling, it is not intended to hang and may become detached and fall.

- The camera must have an unobstructed view of the crib or bed from where it is mounted.
- The camera must have a nearby power outlet that can be reached without using an extension cord. When a suitable location has been found that meets these criteria you may then begin the installation process.

1) Position the Camera Wall Bracket where you want it and locate the screw holes in the mount. Mark each hole carefully with a pencil/pen to ensure that the tapping process is accurate.

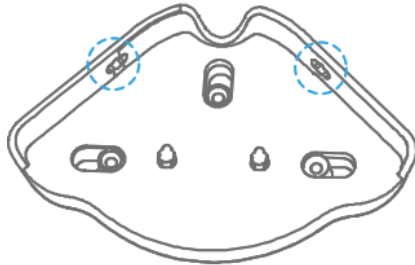

a. For Corner Mounting

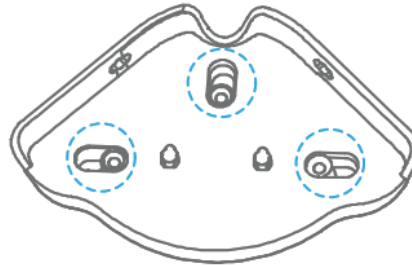

b. For Flat Walls

2) Set aside the bracket and then drill a hole at least 6.0 mm deep at each mark. (Drill and drill bit NOT included.)

3) Insert a plastic wall anchor into each hole and hammer in the anchors so they are nearly flush with the wall surface. (Hammer NOT included.)

4) Place the bracket back on the wall in the chosen location and using the provided screws attach the bracket to the wall. Tighten the screws firmly. Ensure that you do not over-torque or strip the screw heads.

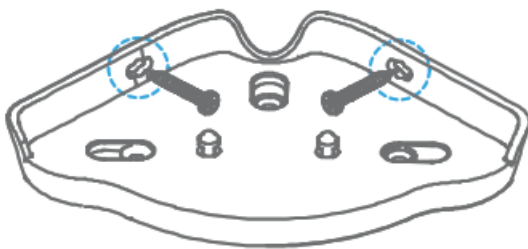

a. For Corner Mounting

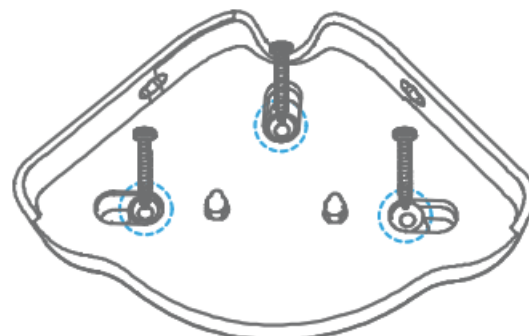

b. For Flat Walls

Note: If mounting on a flat wall please make sure to mount this unit with the notch in the back facing upwards as shown below. DO NOT mount this unit with the notch facing any direction other than up.

5) Align the Slide Locks on the Camera Wall Bracket with the holes on the bottom of the Camera, then push the Camera body forward until it gets stuck to secure it in place.

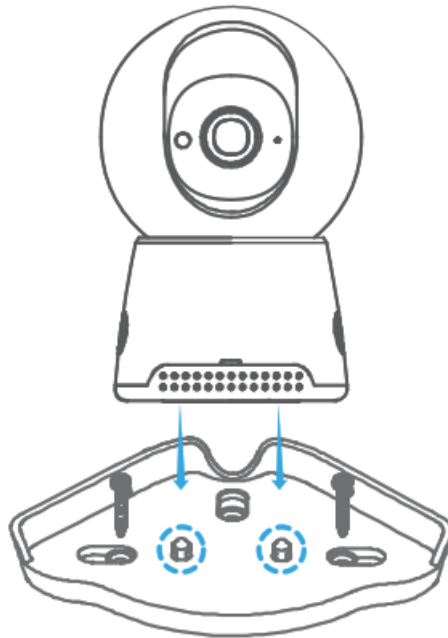

6) Optimize your viewing angle by rotating the Camera manually, or utilize the remote pan and tilt functions with the **Navigation Button** on your Monitor.

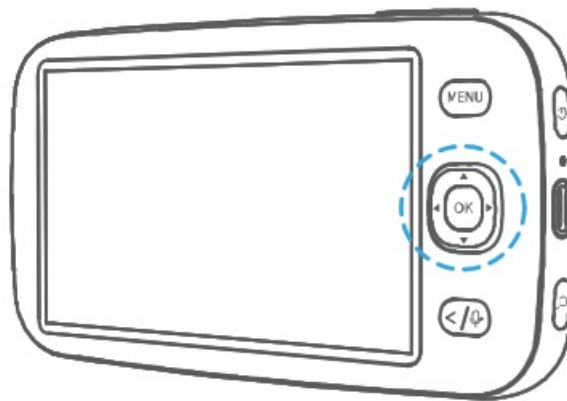

Option 2 – Use 3M Double-Sided Adhesive Tape to secure the Camera Wall Bracket

Consider the following factors when selecting a location to mount the camera:

- The mount can only be positioned in a corner
- The camera must have an unobstructed view of the crib or bed from where it is mounted.
- The camera must have a nearby power outlet that can be reached without using an extension cord. When a suitable location has been found that meets these criteria you may then begin the installation process.

1) Adhere the **3M Double-Sided Adhesive Tape** to both outer sidewalls of the **Camera Wall Bracket** as shown below.

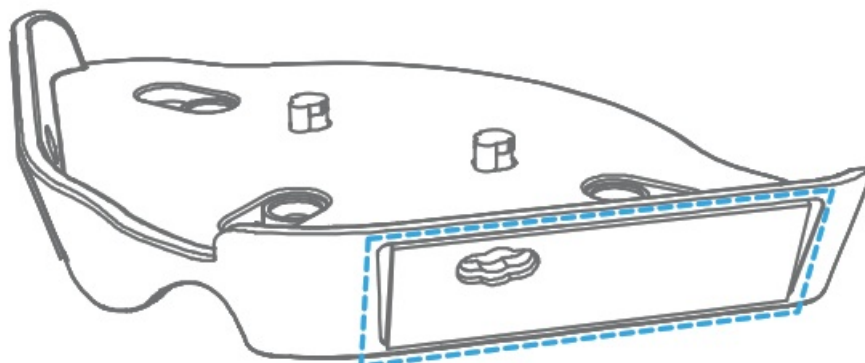

2) Position the Camera Wall Bracket at the desired location and press firmly towards the wall. Ensure that both pieces of the tape are securely touching the wall.

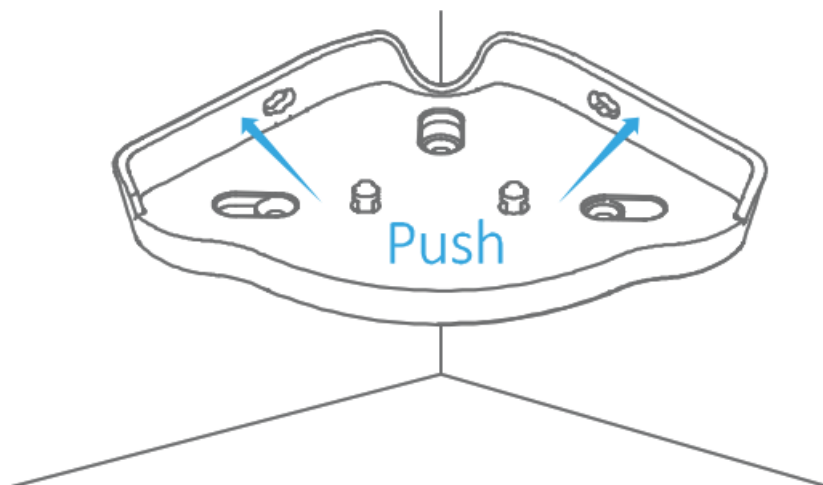

3) Align the Slide Locks on the Camera Wall Bracket with the holes on the bottom of the Camera, then rotate the camera body to secure it in place.

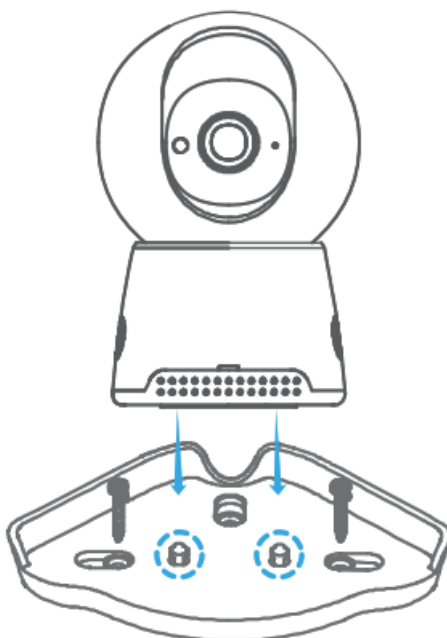

4) Optimize your viewing angle by rotating the Camera manually, or utilize the remote pan and tilt functions with the **Navigation Button** on your Monitor.

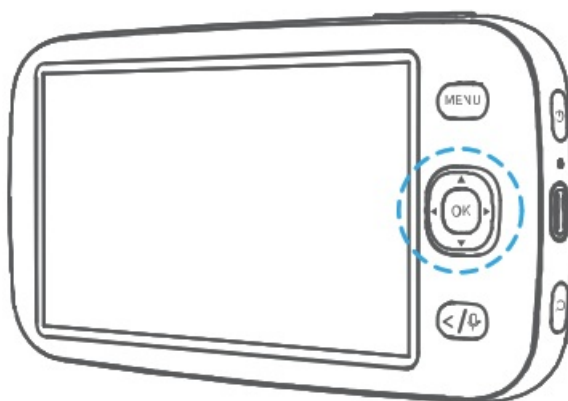

Notes

- Only use the charger provided by the manufacturer. Unauthorized chargers may cause damage to the products

and void any warranty.

- Strangulation Hazard: Cords may be a strangulation hazard and should be properly stored out of reach of children.
- Never use extension cords with AC Adapters.
- Only use the AC Adapters provided with this product.
- Do not use or store the Camera in temperatures below 14°F or above 122°F (-10°C to 50°C).
- This product may be damaged by prolonged exposure to direct sunlight. If in direct sunlight ensure that it is shaded and has appropriate ventilation.

FCC Requirement

Changes or modifications not expressly approved by the party responsible for compliance could void the user's authority to operate the equipment. This device complies with Part 15 of the FCC Rules. Operation is subject to the following two conditions:

(1) this device may not cause harmful interference, and

(2) this device must accept any interference received, including interference that may cause undesired operation.

Note: This equipment has been tested and found to comply with the limits for a Class B digital device, pursuant to Part 15 of the FCC Rules. These limits are designed to provide reasonable protection against harmful interference in a residential installation. This equipment generates, uses, and can radiate radio frequency energy, and if not installed and used in accordance with the instructions, may cause harmful interference to radio communications. However, there is no guarantee that interference will not occur in a particular installation. If this equipment does cause harmful interference to radio or television reception, which can be determined by turning the equipment off and on, the user is encouraged to try to correct the interference by one or more of the following measures:

- Increase the separation between the equipment and receiver.
- Connect the equipment into an outlet on a circuit different from that to which the receiver is connected.
- Consult the dealer or an experienced radio / TV technician for help.

RF Exposure Warning Statements:

This equipment complies with FCC radiation exposure limits set forth for an uncontrolled environment.

This equipment shall be installed and operated with a minimum distance of 20cm between the radiator & body.

Model: 810 FCC ID: 2AWDN-B10  



facebook.com/nexigo1

Get in touch with FREE online services.

Documents / Resources

	NEXIGO B10 Add-On Baby Camera Unit [pdf] User Manual B10, 2AWDN-B10, 2AWDNB10, B10, Add-On Baby Camera Unit
---	--

