

nexHOME
nexHOME Shelf Board Kit



nexHOME Shelf Board Kit Instruction Manual

[Home](#) » [NEXHOME](#) » nexHOME Shelf Board Kit Instruction Manual 

Contents

- [1 nexHOME Shelf Board Kit](#)
- [2 Product Usage Instructions](#)
- [3 Safety Notes](#)
- [4 Included parts](#)
- [5 Tools needed \(not included\)](#)
- [6 Documents / Resources](#)
 - [6.1 References](#)
- [7 Related Posts](#)

nexHOME

nexHOME Shelf Board Kit



Product Specifications

- Product Name: Shelf Board Kit
- Included Parts: Shelf Board, Brackets, 2-inch screws, Anchors, 1/2-inch screws

- Tools Needed (not included): Hammer, Drill, Screwdriver, Level, Pencil, Measuring tape

Product Usage Instructions

Safety Notes

1. Determine the location for installation, using measuring tape for the required height and width.
2. Use a level to draw a line under the shelf board.
3. Align the brackets to the line and mark the spots for drilling holes for screws.
4. Determine if studs are behind the marks with a stud finder.
Drill pilot holes on the marks, double-check that the marks are level and aligned.

Step-by-Step Installation

1. **Step 1:** Use a hammer to insert anchors into the holes without a stud behind. Do not insert anchors if a stud is behind the holes.
2. **Step 2:** Use a screwdriver to fasten the brackets to the wall with the 2-inch screws provided.
3. **Step 3:** Place the shelf board on top of the brackets and secure the board using the 1/2-inch screws provided.

FAQ

Q: Can I use this shelf board kit on drywall?

A: Yes, you can use anchors provided in the kit to securely install the shelf on drywall.

Shelf Board Kit Installation Manual

Safety Notes

- Ensure at least one bracket is securely fastened to a wall stud to support the weight of the shelf and the items it will hold.
- Use appropriate drywall anchors if a stud is not available to prevent the shelf from pulling out of the wall.
- Do not overload the shelf beyond its weight capacity to avoid accidents.

Keep the installation tools and small parts out of reach of children.

- Determine the location for installation, using measuring tape for the required height and width.
- Use a level to draw a line under the shelf board
- Align the brackets to the line and mark the spots for drilling holes for screws.
- Determine if studs behind the marks with a stud finder. Drill the pilot holes on the marks, double check that the marks are level and aligned.

Installation Step

1. Step 1
Use a hammer to insert anchors into the holes without a stud behind.

Do not insert anchors if a stud is behind the holes.

2. Step 2

Using tools (screw driver) to fasten the brackets to the wall with the 2-inch screws provided.

3. Step 3

4. Place the shelf board on top of the brackets and secure the board using the half inch screws provided.

5. Step 4

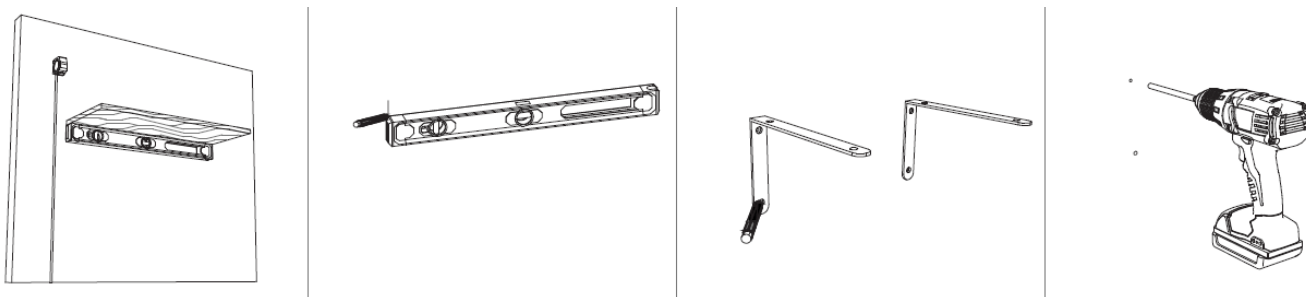

6. Step 5

7. Step 6

8. Step 7

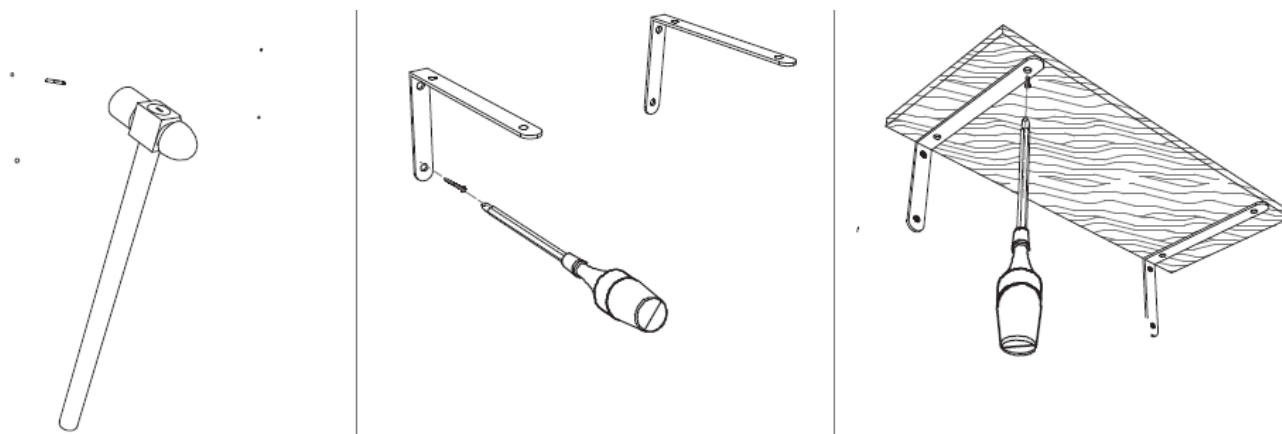

Included parts

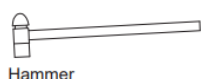

Hammer



Drill



Screwdriver



Level



Pencil



Measuring tape

Tools needed (not included)



Brackets



Shelf Board



2-inch screws



Anchors



1/2-inch screws

Documents / Resources

	<p>nexHOME Shelf Board Kit [pdf] Instruction Manual Shelf Board Kit, Shelf, Board Kit, Kit</p>
---	--

References

- [User Manual](#)

[Manuals+](#), [Privacy Policy](#)

This website is an independent publication and is neither affiliated with nor endorsed by any of the trademark owners. The "Bluetooth®" word mark and logos are registered trademarks owned by Bluetooth SIG, Inc. The "Wi-Fi®" word mark and logos are registered trademarks owned by the Wi-Fi Alliance. Any use of these marks on this website does not imply any affiliation with or endorsement.