



newtech SR232 Freedom Heated Towel Rails Instruction Manual

[Home](#) » [Newtech](#) » newtech SR232 Freedom Heated Towel Rails Instruction Manual

Contents [[hide](#)]

1 newtech SR232 Freedom Heated Towel Rails

2 Instructions

3 SPECIFICATIONS AND DIMENSIONS

4 WALL MOUNTING

5 INSTALLATION

6 CARE &CLEANING

7 Documents / Resources

7.1 References

8 Related Posts



newtech SR232 Freedom Heated Towel Rails



Instructions

This electrical appliance is intended to warm and dry towels and therefore hot to touch. Young children or infirm persons should be supervised to ensure that they do not play with or misuse the appliance. The towel rail has been designed to withstand the loads expected during normal operation as a towel rail. The towel rail is not a ladder and should not be used as such.

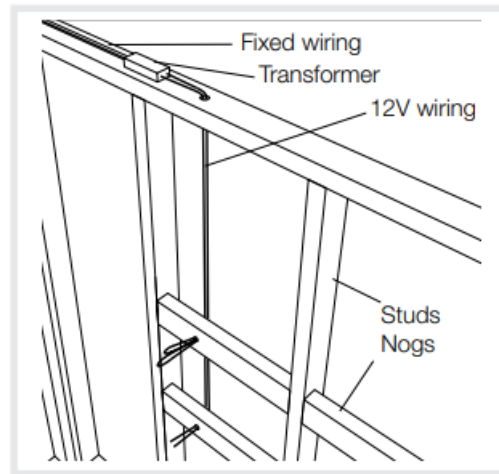

ELECTRICAL

The towel rail must be wired by a registered electrician. An isolating switch must be positioned near the towel rail but out of reach from wet areas like baths and showers. A wall or ceiling cavity must be available to conceal the transformer. All rails must be connected to the 12 Volt transformer in parallel and cannot be connected directly to 240V supply.

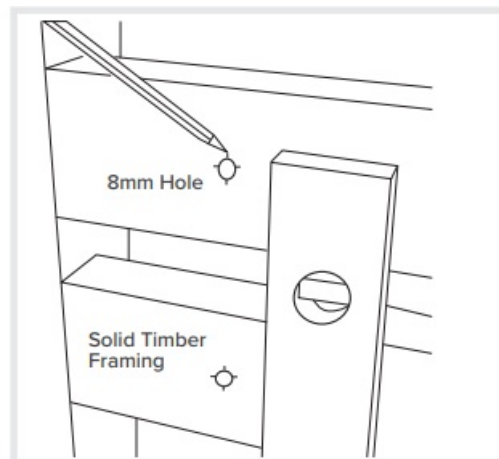

SPECIFICATIONS AND DIMENSIONS

Vera Square (Round Edges) - Widths 432mm, 632mm, 832mm

W432mm x D100mm x H40mm, 13 Watts

Models: SR232, SR232NK, SR232B, SR232GM, SR232BB, SR232CP, SR232MW

W632mm x D100mm x H40mm, 18 Watts

Models: SR230, SR230NK, SR230B, SR230GM, SR230BB, SR230CP, SR230MW

W832mm x D100mm x H40mm, 22 Watts

Models: SR234, SR234NK, SR234B, SR234GM, SR234BB, SR234CP, SR234MW

Toro Round - Widths 432mm, 632mm, 832mm

W432mm x D100mm x H32mm, 12 Watts

Models: SR242, SR242NK, SR242B, SR242GM, SR242BB, SR242CP, SR242MW

W632mm x D100mm x H32mm, 17 Watts

Models: SR240, SR240NK, SR240B, SR240GM, SR240BB, SR240CP, SR240MW

W832mm x D100mm x H32mm, 22 Watts

Models: SR244, SR244NK, SR244B, SR244GM, SR244BB, SR244CP, SR244MW

Largo Square - Widths 432mm, 632mm, 832mm

W432mm x D100mm x H40mm, 13 Watts

Models: SR222, SR222NK, SR222B, SR222GM, SR222BB, SR222CP, SR222MW

W632mm x D100mm x H40mm, 18 Watts

Models: SR220, SR220NK, SR220B, SR220GM, SR220BB, SR220CP, SR220MW

W832mm x D100mm x H40mm, 22 Watts

Models: SR224, SR224NK, SR224B, SR224GM, SR224BB, SR224CP, SR224MW

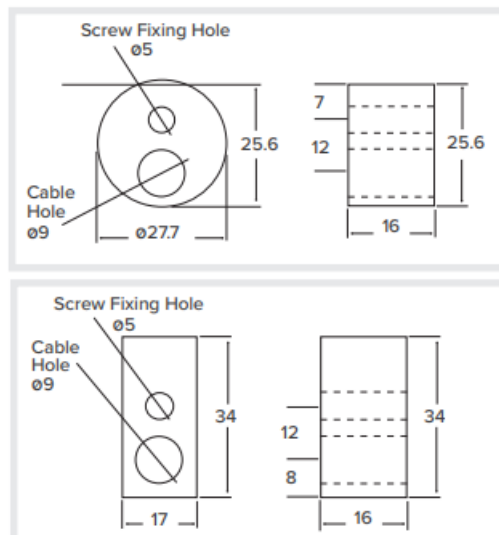

WARNING

These rails have a small footprint against the wall and secureness should be periodically checked. The Allen Key securing the rail may require tightening especially during the settling period. The cable holes and fixing holes must be neatly and accurately drilled. For drilling through hard surfaces eg. porcelain tiles, marble or granite etc, a diamond core drill must be used. Ensure final rail position will conceal wiring hole.

WALL MOUNTING

The towel rail mounting spigot must be fastened to a solid fixing point, eg. timber or brickwork. The mounting face of the towel rail must be fitted against a solid surface eg. tiles (not suitable directly onto gip or plasterboard). Recommended location is 600mm above floor, 300mm from any permanent fixing and 250mm between rails.

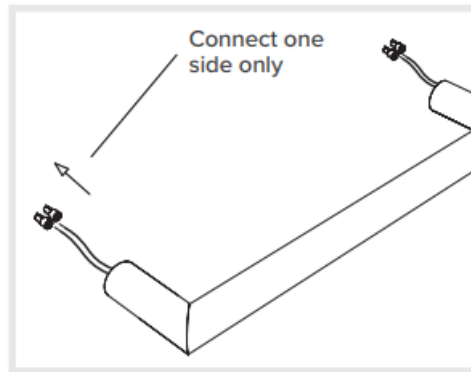

INSTALLATION

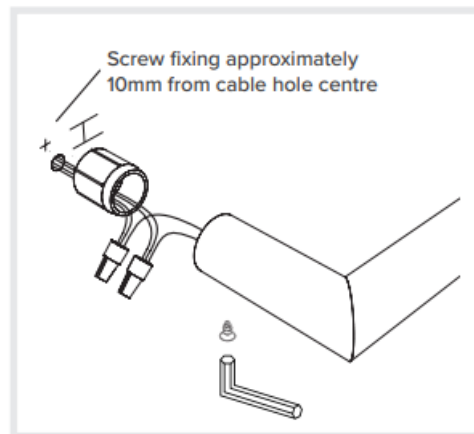

Typical wiring for timber framed walls is the distance from the transformer to the furthest 12V connection should be no more than 2000mm. Make sure that the 12V cabling doesn't cross the 230V mains cable. Insulation should be removed from the vicinity of the transformer to a radius of 150mm. The single bar heated towel rail is designed as dual wire option (left or right hand) - connect one side only.

BEFORE LINING

- Drill 10mm diameter holes in the wall framing first.
- Use a level to make sure that these holes are plumb.
- The recommended vertical distance between rails is 250mm.
- Pull the supplied appliance wire through the 10mm holes and connect to the 12V transformer (also supplied).

AFTER LINING

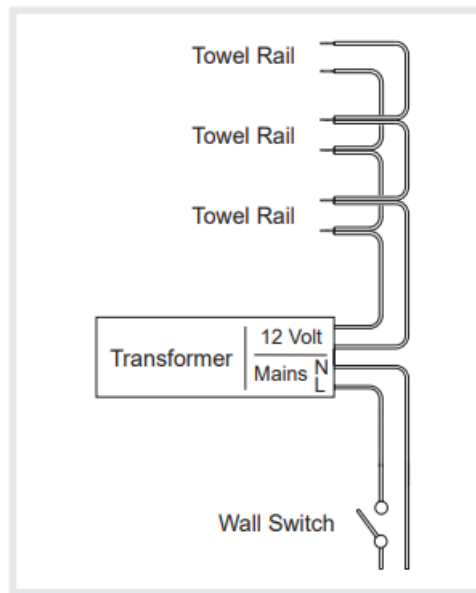

- Fix the top rail first and work downwards.
- Fix the mounting blocks at the cable end first.
- Take care to ensure that the rail, in its final position, will fully conceal the wiring and cable hole.
- Use a level to determine the correct position for the blocks at the non-cabled end
- Fix the mounting blocks at the non-cabled end.
- Connect the appliance wiring to the towel rail element using the wire nuts provided.
- Make sure that there are no white and blue wires Connected as this would create a short circuit.
- DO NOT PULL THE WIRE OUT OF THE TOWEL RAIL THIS WIRE IS CONNECTED TO THE INTERNAL HEATING CABLE. PULLING OUT THE WIRE WILL EXTRACT THE HEATED SEGMENT.
- Push the towel rail onto the mounting spigots until flush with the wall. Fix the towel rail in position using the Allen key provided. Continue to fit the remaining rails using the same procedure.

CARE & CLEANING

- Do not use cream cleaners, abrasive or corrosive cleaners.
- The heated towel rails are best wiped down from time to time with a damp cloth.

Disclaimer: Products in these installation instructions must by regulation be installed by a licensed and registered tradesperson. Newtech cannot be held responsible if the installation and use of the towel rails is not carried out in accordance with these instructions or for materials not supplied by Newtech. The manufacturer/distributor reserves the right to vary specifications without prior notification.

Newtech

- Head Office & Distribution Warehouse | 281 Heads Road, Wanganui
- Phone: 06 349 0194 or 0800 728 662, sales@newtech.co.nz
- Auckland Concept Showroom | 525 Great South Road, Penrose, Auckland
- Phone: 09 930 6200, aucklandshowroom@newtech.co.nz

Documents / Resources



[newtech SR232 Freedom Heated Towel Rails](#) [pdf] Instruction Manual
SR232, Freedom Heated Towel Rails, SR232 Freedom Heated Towel Rails, Heated Towel Rails
, Towel Rails, Rails

References

- [Newtech | Innovative Bathroomware Products & Design in New Zealand](#)