

newline Interactive Replace Battery Owner's Manual



Contents [[hide](#)]

- [1 How to replace battery](#)
- [2 Documents / Resources](#)
 - [2.1 References](#)

How to replace battery

Tools

Screwdriver: PH1, 3.0mm

1. Replace the main-board battery
 - a. Remove the main-board battery case (Using a screwdriver)

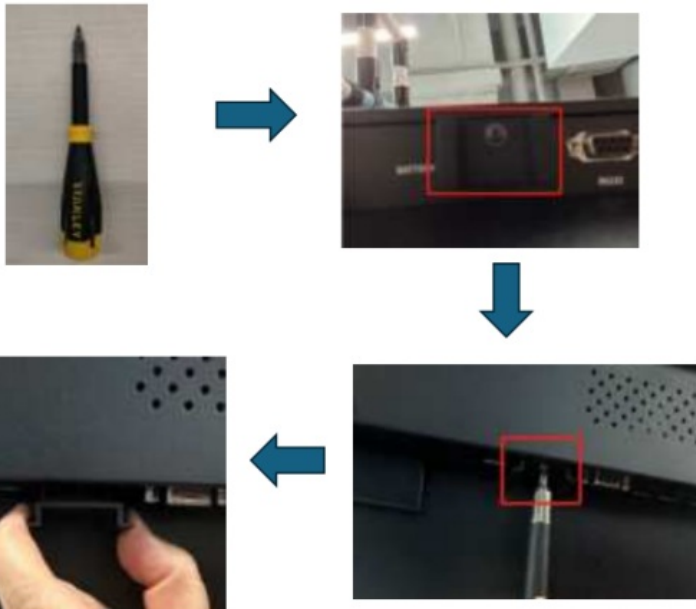

b. Replacing the battery

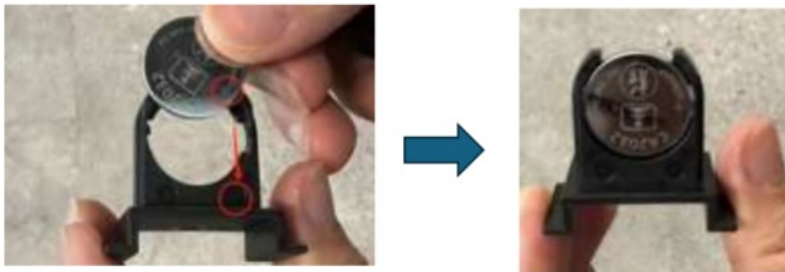

c. Installing the battery



Documents / Resources

	<p>Interactive Replace Battery [pdf] Owner's Manual</p> <p>Interactive Replace Battery, Replace Battery, Battery</p>
-------------------------------------------------------------------------------------	--------------------------------------------------------------------------------------------------------------------------------------

References

- [User Manual](#)

Leave a comment

Your email address will not be published. Required fields are marked *

Comment *

Name

Email

Website

☐ Save my name, email, and website in this browser for the next time I comment.

Post Comment

Search:

e.g. whirlpool wrf535swhz

Search

[Manuals+](#) | [Upload](#) | [Deep Search](#) | [Privacy Policy](#) | [@manuals.plus](#) | [YouTube](#)

This website is an independent publication and is neither affiliated with nor endorsed by any of the trademark owners. The "Bluetooth®" word mark and logos are registered trademarks owned by Bluetooth SIG, Inc. The "Wi-Fi®" word mark and logos are registered trademarks owned by the Wi-Fi Alliance. Any use of these marks on this website does not imply any affiliation with or endorsement.