



# Newell Timer Remote Series Electronic Timer Remotes Instruction Manual

[Home](#) » [Newell](#) » Newell Timer Remote Series Electronic Timer Remotes Instruction Manual 



**Timer Remote Series Electronic Timer Remotes  
Instruction Manual**



**PHOTO ACCESSORY  
OPERATING MANUAL FOR  
ELECTRONIC TIMER REMOTES**

## Contents

- [1 SAFETY INSTRUCTIONS](#)
- [2 DEVICE DESCRIPTION](#)
- [3 SPECIFICATION](#)
- [4 HOW TO USE](#)
- [5 WASTE MANAGEMENT](#)
- [6 WARRANTY](#)
- [7 Documents / Resources](#)
- [8 Related Posts](#)

## SAFETY INSTRUCTIONS

Before using the product, please read the following instruction manual carefully and keep it for future reference. When transferring the product to a third party, it is advisable to include the instructions.

- Do not disassemble or modify the device.
- Do not allow water to penetrate
- Do not use near flammable gases.
- Do not expose to high temperatures.
- Keep out of the reach of children.
- Do not short circuit.
- Switch off/ unplug immediately in the event of a fault.
- Use the batteries in accordance with their instructions for use.
- Insert the batteries with the correct polarity.
- Remove the batteries if you do not plan to use the device for a long time.

## DEVICE DESCRIPTION

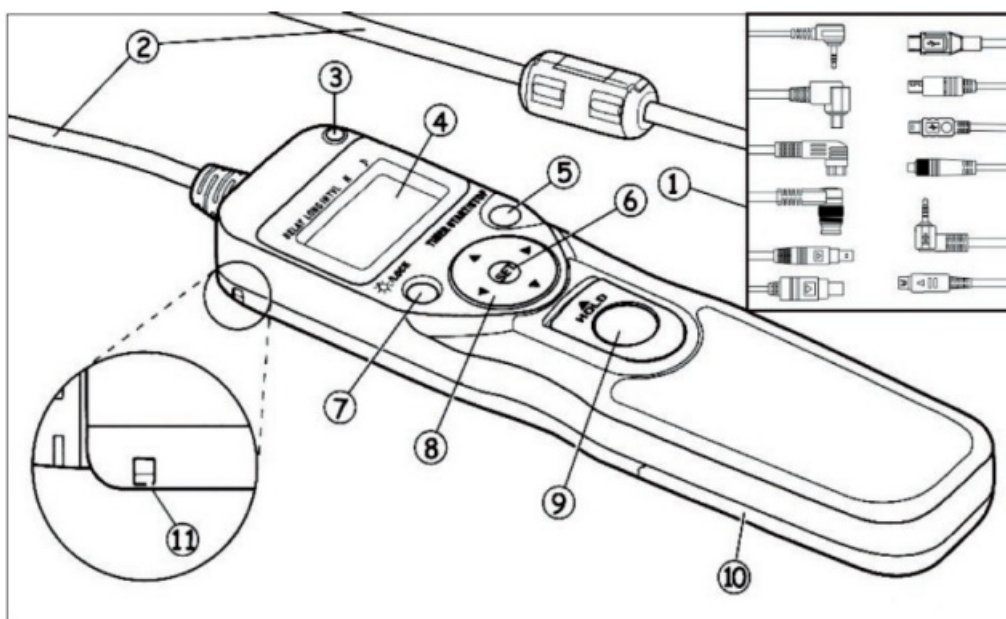

1. Connector 2. Cable 3. Diode 4. Display	5. Start/ stop timer 6. Set 7. Backlight / Lockout 8. Directional arrows	9. Shutt 10. Batt 11. Lan
--	---	---------------------------------



### Display:

1. Cursor 2. Time 3. Lock indicator 4. Low indicator battery levels	5. Timer indicator 6.Sound 7. Set 8. Open shutter 9. Number of photos
--	---

The device is not equipped with a switch. In To save battery power, make sure the TIMER ACTIVE, SET, and RELEASE indicators are turned off.

To switch on the illumination – briefl press the illumination/ lock button.

To lock the buttons – press and hold the light /lock button until the “L” icon appears on the display.

### SPECIFICATION

Supported cameras:	according to the connector fitment
Delay:	0 s to 99 h 59 min 59 sat second intervals
Exposure time:	0 s to 99 h 59 min 59 sat second intervals
Interval:	1 s to 99 h 59 min 59 s at second intervals
Number of photos:	1 do 399, unlimited
Power:	2 x AAA 1.5 V LR03 alkaline
Ambient operating temperature	-209C--+50 C
Dimensions	15,5 cm x 4 cm x 1,8 cm
Weight:	84g
Cable length:	94cm

- Specifications and device design are subject to change without notice.

### HOW TO USE

## In order to connect the cable to the camera:

1. Turn off the camera.
2. Make sure that the TIMER ACTIVE, SET. and RELEASE indicators are off.
3. Connect the cable connector to the socket on the device.

Electronic remote release cable can be used as:

**Timer** — the ability to program a delayed trigger, exposure, intervals, number of photos.

**Manual shutter release** — for manual triggering of remote shutter release.

### 1. Settings on the camera:

- **Exposure mode** –M (manual)
- **Time-Bulb**
- **intervalometer** – off
- **Autofocus mode** – AF – AFC or Manual
- **Burst mode** — off

### 2. Programming the timer

Press SET- the icon starts blinking on the display.



**DELAY** – shutter release delay  
**LONG** – exposure time  
**INTVL** – interval  
**N** – number of photos  
♪ – (frames) - sound on / off

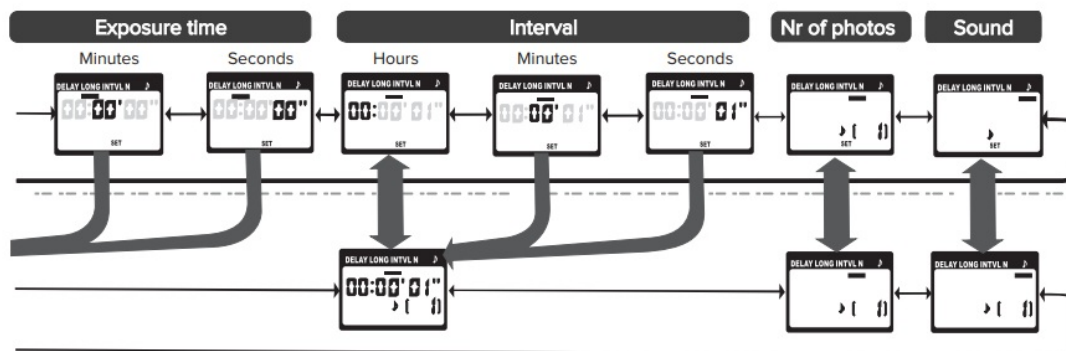

Use the directional arrows to program the timer. Right/ Left for selection, up/ down to change.

The cursor shows the current position. Press SET to confirm.

Delay, exposure and interval settings.

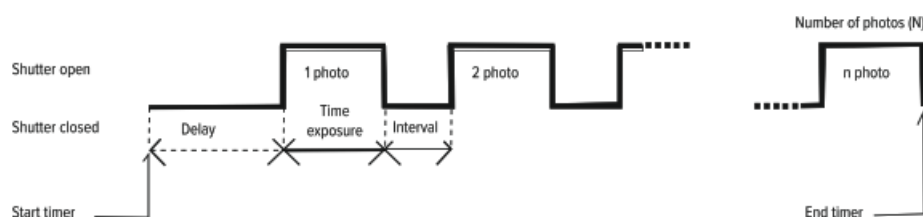

### Connect the cable to the camera.

- Turn on the camera.
- Set the exposure mode, time, autofocus mode and more to ensure correct exposure.
- Press the shutter release button halfway. If the focus and exposure are correct, press the button the rest of the way down to take the picture.

### 3. Starting the program

Press TIMER START/ STOP. The timer will start and the icon on the display will start flashing.

- The display shows the time remaining until the next photo.
- While the camera shutter is open, the display shows the time remaining until the shutter is closed and the RELEASE icon blinks.
- The program will end automatically when the preset number of shots is reached. To stop at any time, press TIMER START/ STOP



To open the shutter in Bulb mode – press and slide to the HOLD position. Slide in the opposite direction to finish.

\*The manufacturer reserves the right to change the information contained in this manual without prior notice.

### WASTE MANAGEMENT



The crossed-out trashcan symbol means that waste electrical and electronic equipment, batteries and packaging's must not be placed with other house hold waste. They must be handed over to **a separate waste collection system**.

### WARRANTY









Newell products are covered by a **40-month manufacturer's warranty**.

# Newell®

Made in China, In China hergestellt, Echo eon China, Fabricator in Cinna, Fabliau~  
eon Chine, Vyrobeno v Cine, yproduloowano w Chinch, Chenango s Krane



### Documents / Resources

     	<a href="#">Newell Timer Remote Series Electronic Timer Remotes</a> [pdf] Instruction Manual Timer Remote Series Electronic Timer Remotes, Timer Remote Series, Electronic Timer Remotes, Timer Remotes, Remotes
--	---

