

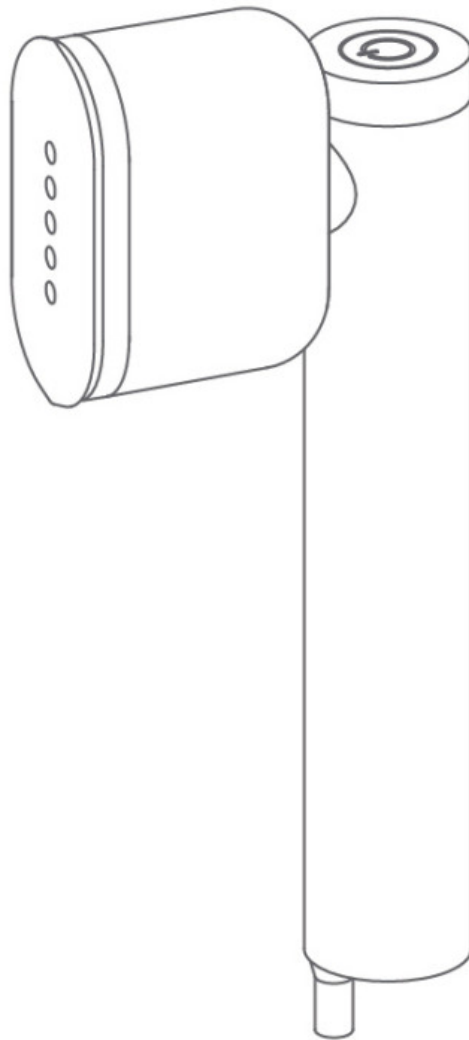

## Newbealer NB31C-PLUS Handheld Clothes Steamer User Manual

[Home](#) » [Newbealer](#) » Newbealer NB31C-PLUS Handheld Clothes Steamer User Manual 

**Newbealer**  
PRO HANDHELD GARMENT  
STEAMER  
NB316C-PLUS



## USER MANUAL

Please read this manual carefully before using and keep this In a safe place for future reference.

### Contents

- 1 safety Instructions
- 2 Parts Identification:
- 3 Specifications
- 4 Before the First Use
- 5 What Water To Use?
- 6 Before Use
- 7 Accessories
- 8 Use
- 9 After Use
- 10 Cleaning
- 11 Storing Your Newbealer Steamer
- 12 Anti Calc
- 13 Warning
- 14 Troubleshooting
- 15 Steaming Tips
- 16 1-Year Warranty
- 17 Documents / Resources
  - 17.1 References

## safety Instructions

- Always unplug ASAP after each use to really turn off the unit.
- This steamer should not be used by children. Only allow dependents to use the steamer when under proper Supervision.
- The voltage of the power source must be compatible with the voltage displayed on the rating plate of this steamer (120V/60HZ).
- Never place heavy or sharp objects on the steamers power cable.
- All cables should be positioned so they cannot be tripped over or become obstructions.
- It is recommended to not plug In any other appliances into the same circuit when the garment steamer is in use to avoid overload.
- If the supplied power cord Is damaged, It should be replaced by a qualified technician.
- Do not expose the steamer to humidity and or use it outdoors.
- Only fill the water tank with demineralized or distilled water. Other liquids may damage the steamer.
- Do not put any adaitives in the water tank. These can damage the steamer.
- Never leave the steamer unattended when it Is not, switched on, or connected to power.
- Do not use the steamer if it has fallen from a high place, or if there are visible signs of damage or leakage.
- The garment steamer provides a thermal safety fuse to protect It from over-heating. However, the steamer should not be left unattended while It Is connected to power. Take care when there are children in the vicinity of the steamer.
- Never use the steamer on clothes that are being worn. Never direct the steamer towards people or animals.
- There may be leakage from the steam head If the steamer's temperature Is not high enough to vaporize water and generate steam. Therefore, make sure the steamer is always preheated for 20s before use.
- Always unplug the steamer before attaching or detaching the attachment brush.
- Before store the appliance, please wait half an nour for the appliance to completely cool down.
- Only use officially provided attachments and accessories.

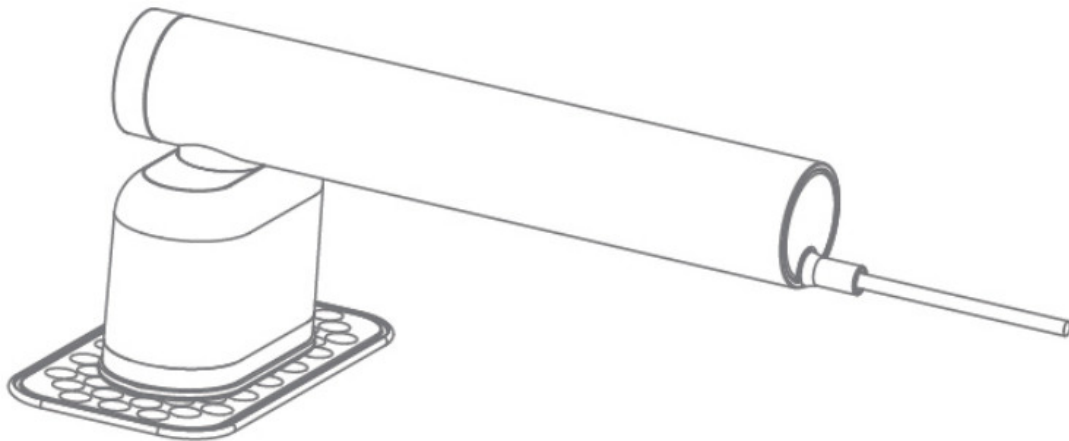

- Safe storage with silicone stand. During or after use, please leave your Iron in the face-down position as the picture shows to avoid scalding the desktop or clothes.

### Parts Identification:

1. Soft Cushion Brush (removable)	6. Hanale
2. steam Heaa	7. Water Tank Inlet Cap
3. 90° Swivel Iron Head	8. Water Tank (removable)
4. Power Button	9. Silicone Rest
5. Cord exit	10. Water Filling Funnel

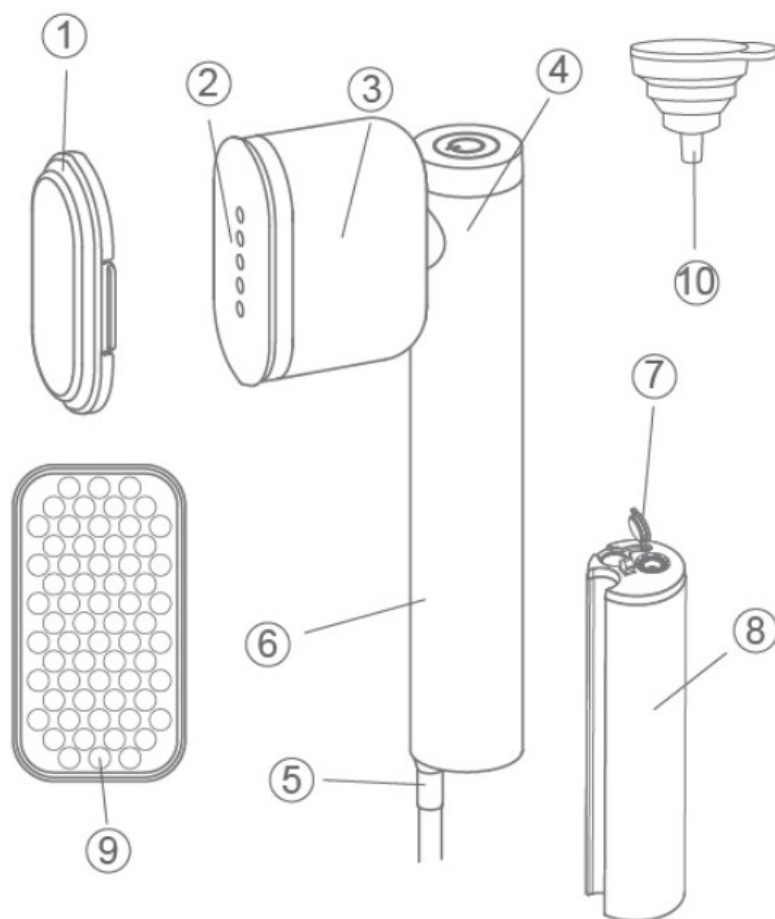

## Included Items

1 x Garment Steamer 1 x Extra Water Tank 1 x Silicone Rest 1 x User Manual	1 x Soft Cushion Brush 1 x Water Filling Funnel 1 x Heat-resistant Glove
---	--

**Note:** When unpacking the garment steamer, check If you have received all the items listed.

## Specifications

Product: Pro Handheld Garment Steamer	Rated Power: 1200W
Model: NB316C-PLUS	Rated Voltage: AC 120V ~ 60Hz
Working Time: 10-20 min	Water Tank Capacity: 4oz (120mL)
Net Weight: 1.65lb (750g)	Dimension: 10.2*1.97*4.7 in

## Before the First Use

When you first use the steamer, some residual water from the testing might be emitted from the steam head. This is normal and will not affect the use of the steamer and will disappear quickly.

## What Water To Use?

It is recommended to use demineralized or distilled water.

Never use water containing additives (starch, perfume, aromatic substances, softeners, etc.), or condensation water (for example water from tumble dryers, water from refrigerators, water from air conditioning units, rainwater). This water contains organic waste materials or minerals that concentrate under the effect of heat and cause spitting, brown coloring or premature ageing of your steamer.

## Before Use

1. Push the water tank in the arrow direction until it pop up. Take the detachable water tank out.

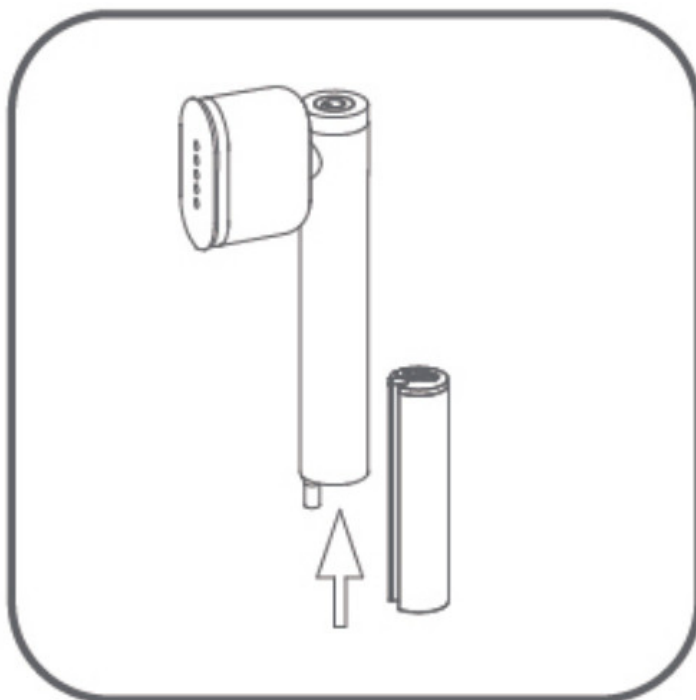

2. Open the water inlet cap. Fill the water tank with water (See section “what water to use”). Never exceed the maximum level.



3. Close the water inlet cap and push the water tank to the end to securely lock .

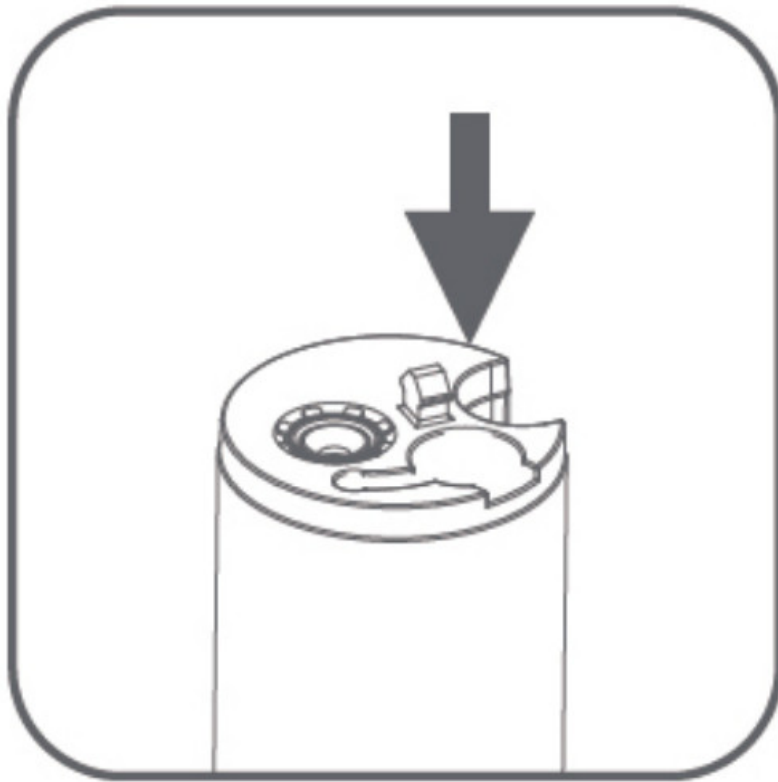

4. With 90° swivel head you can convert it to vertical or horizontal ironing.

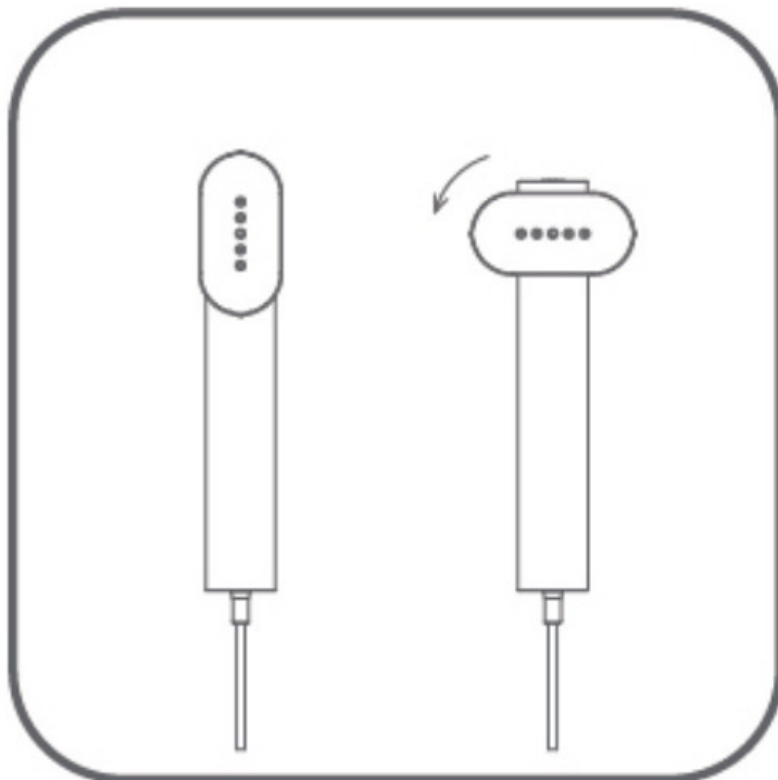

## Accessories

Soft Cushion Attachment is made of high-quality nylon fiber, high temperature-resistance.

As the temperature of sole plate reaches 302°F, you should use this attachment to remove creases from sensitive or delicate fabrics, avoiding damage to these clothes at the same time.

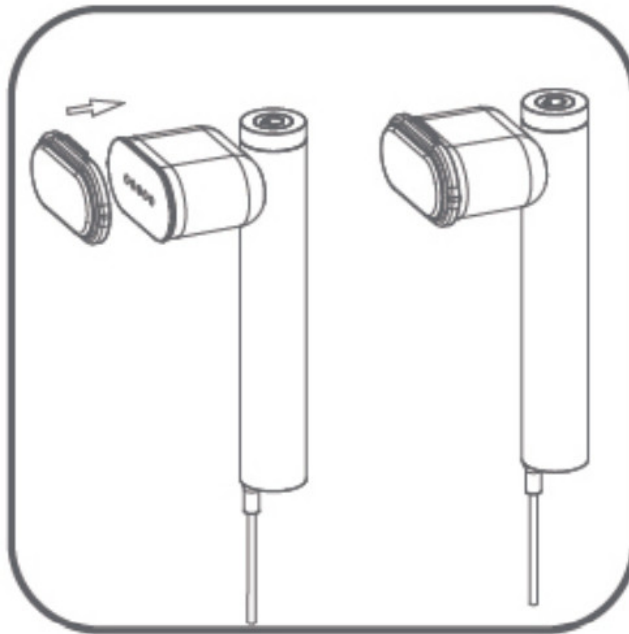

**Warning:** Always unplug the steamer before attaching or detaching the attachment brush.

## Use

1. Plug in the appliance.

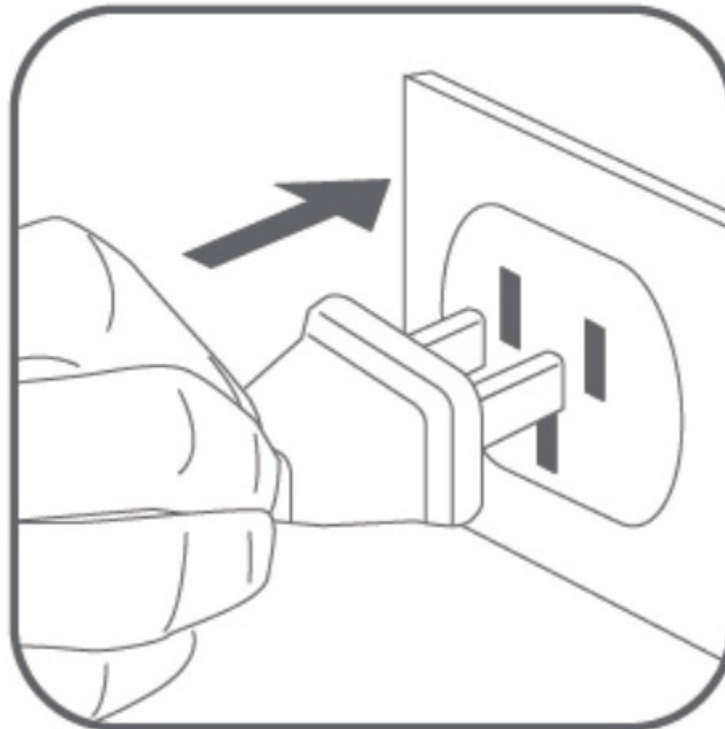

2. Wait at least 20 seconds before pressing the steam button. The power indicator light flashes yellow to indicate that the heating element is working. When the Indicator light flashes red, the steamer is ready to use.

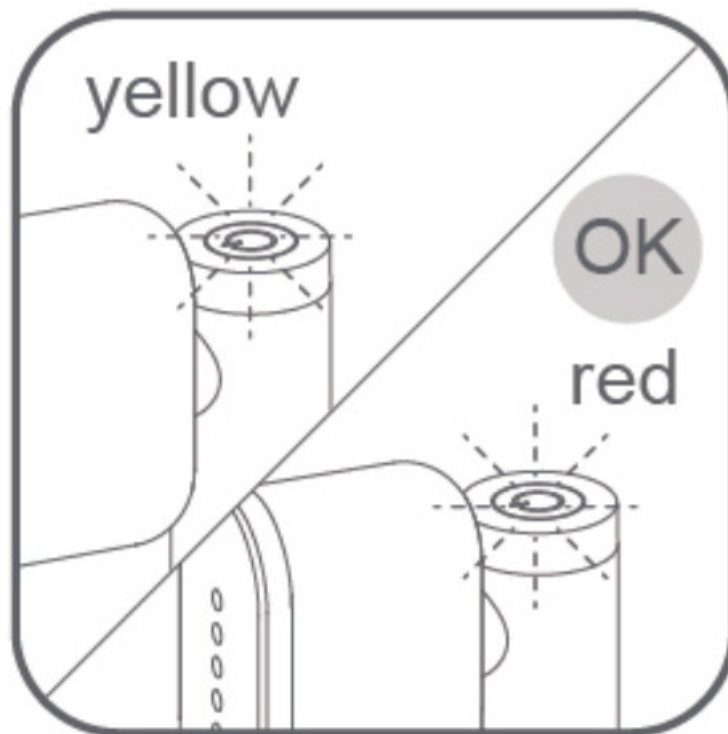

3. Press the steam button with the steam head facing away from you holding it in a vertical position. The indicator light becomes solid yellow which means it steams in low mode.

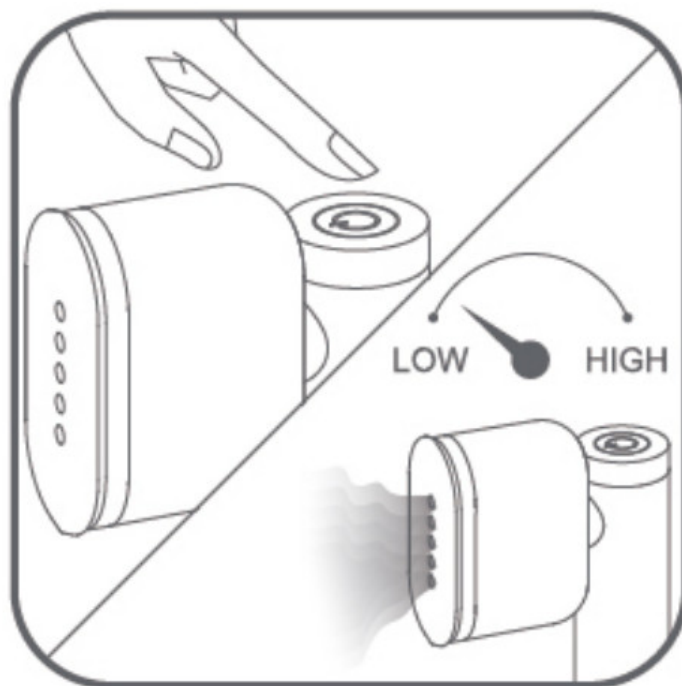

4. Press the steam button again, the indicator light becomes solid red, now the appliance steams in high mode.



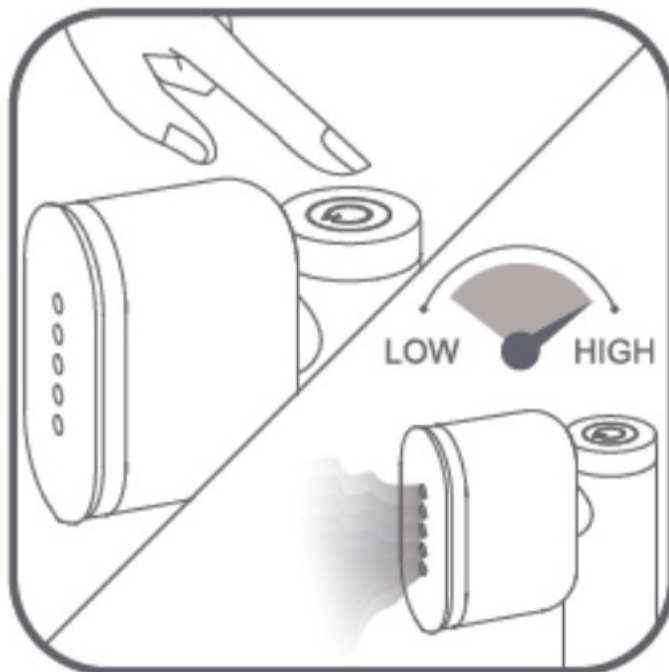

5. For optimal use, move the steam jets over your garment from top to bottom.

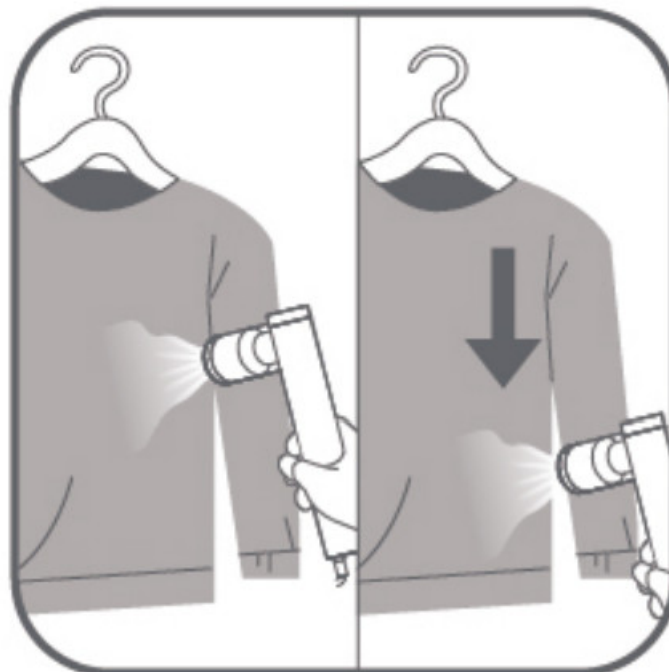

6. Use your free hand to keep the fabric taut and stretched. Steam the garment with slow, downward strokes, Keeping the head of the steamer in contact with the fabric.

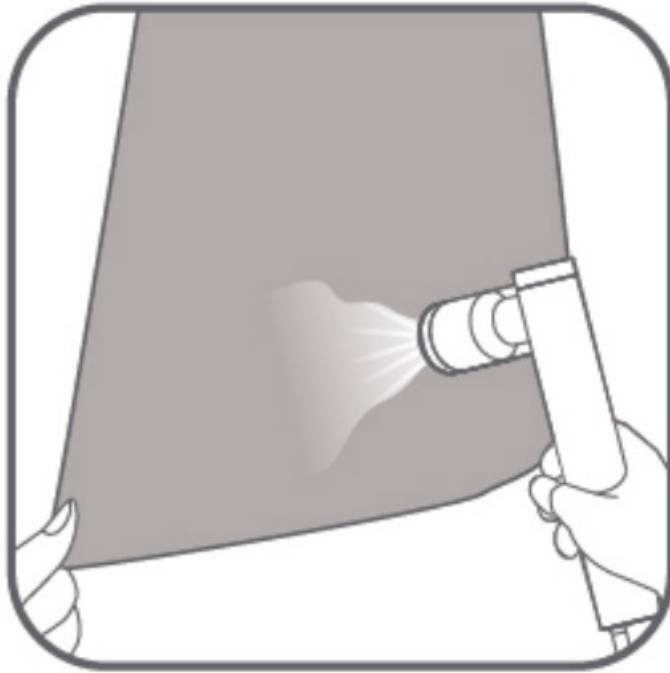

7. With 360° anti-dripping design, this steamer can be used horizontally to steam garments on an Ironing board. suitable for collars and cuffs.



8. Long press the button to switch to Dry Ironing mode. The indicator light flashes red. Specifically useful for fabrics like satin or silk.



9. Two Pointed Tips let you iron the hard area like in-between buttons and corner near collar easily.



**Warning:** Never steam a garment while It is being worn.



**Warning:** Never touch the soleplate of the steamer.



## After Use

1. Long press the button for 2s to stop the steam mode. (The temperature of the soleplate keeps 140-150°C—Dry Ironing)



2. Unplug the appliance.



3. Push the water tank in the arrow direction until it pop up. Take the detachable water tank out.

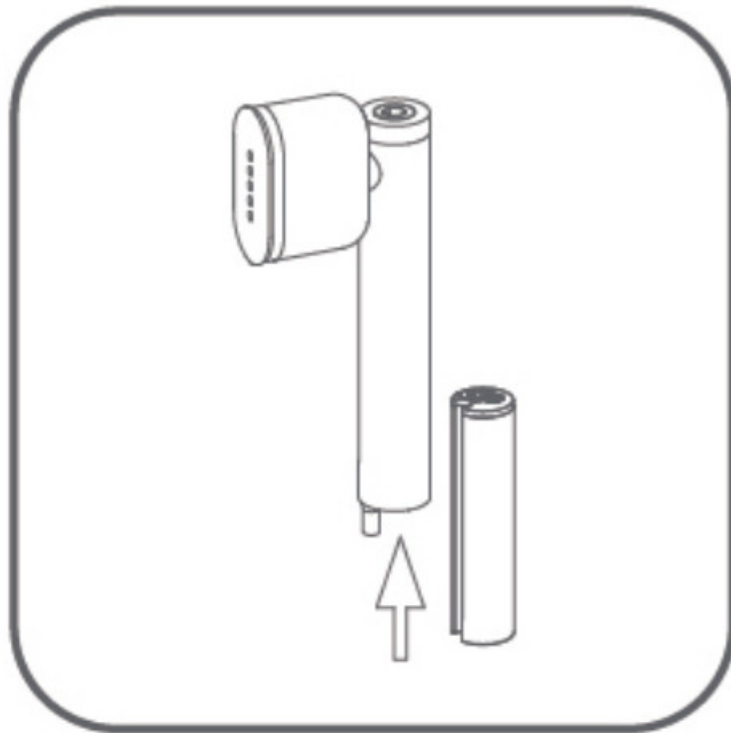

4. To avoid mineral buildup, empty the tank after each use.

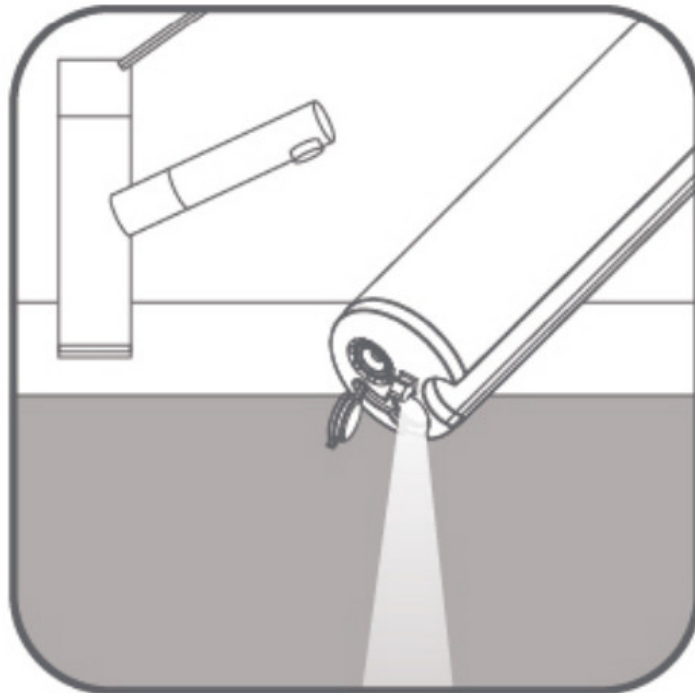

5. Return the water tank to its place on the appliance, make sure it is completely in place. wait for 30 minutes for your appliance to cool before storing

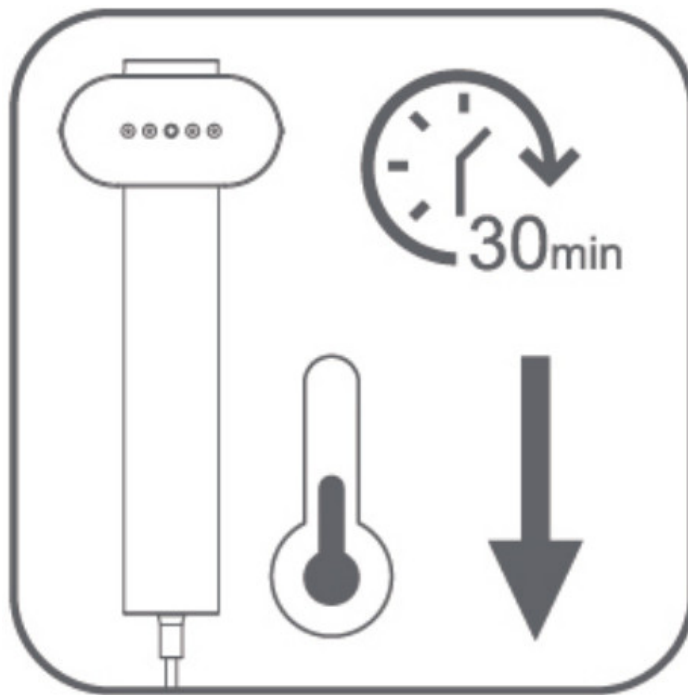

**Warning:** Do not take the water tank out when the appliance is in operation.

## Cleaning

1. Wait half an hour for the appliance to completely cool down.
2. Clean the plastic parts of the appliance with a dry cloth.
3. Never wash or rinse appliance directly over a sink.

## Storing Your Newbealer Steamer

1. Store it in a cool dry place.
2. DO NOT wrap the power cord around the unit, place it loosely.

**NOTE:** Water containing mineral levels will vary depending on the place where you live in. To ensure the continuous operation of the steamer, never store it without cleaning and removing excess water from the water container or tank.

If you fill your steamer with tap water, you may experience mineral build-up due to the high mineral content in the water supply in many cities. Mineral residue inside your steamer's internal heater may cause Intermittent steaming, or in severe cases no steaming at all.

To avoid the problem, only use de-mineralized or distilled water in your steamer. If you are unable to use demineralized or distilled water, we recommend you to follow the cleaning procedure below at least once a month to help avoid mineral pull-up.

## Anti Calc

- Anti-calc operation can be done if you notice your appliance performance has decreased.
- Do this operation in a vented room.

## Steps:

1. Remove the water tank.
2. Fill the water tank with 0.1 oz citric acid (you can also use 50% water and 50% white vinegar).
3. Return the water tank to its place on the appliance. Make sure the water tank is fully set In place.
4. Switch on the appliance.
5. Wait at least 15 seconds before pressing the steam button.
6. Allow the appliance to run until the water tank has completely emptied.
7. Fill the water tank with 100% water and repeat the operation until the water tank is completely empty In order to rinse the appliance.

## **Warning**

- To reduce the risk of contact with hot water coming from steam vents, check the water level and the indicator light on your steamer before each use. Use this appliance for its intended use only.
- To reduce the risk of electric shock, do not Immerse your steamer in water or other liquids.
- Never pull out the cord to disconnect from the outlet, instead, grasp the plug and pull to disconnect completely before putting It away. Place the cord loosely when storing.
- Always keep your steamer disconnected from any electrical outlet when filling it with water, when emptying It, and when It Is not in use.
- Do not operate your steamer when the cord is damaged, or If the appliance has been dropped or damaged.
- To reduce the risk of electric shock, do not disassemble or attempt to repair your steamer if damaged. Return it to the Service Center for repair. An incorrect reassembly or repair could result into a fire, electric shock, or Injury when the appliance is used.
- Never drop or insert any object into the steam vents of the nozzle.
- Do not use the steamer outdoors, operate it where aerosol products are being used or where oxygen is being manipulated.
- The surface of your steamer may get hot when It will be In use. Always use a hanale to avoid burning your skin.
- Do not place the steam nozzle directly on any surface or on the appliance power cord while It is not or plugged in.
- Unplug your steamer before filling or emptying the water tank. Never fill water past the maximum level.
- To reduce the risk of a circuit overload, do not operate another high-voltage appliance on the same circuit.
- Be careful when arranging the cord so It cannot be pulled or tripped over.

## **Troubleshooting**

If your Garment Steamer is not operating properly, please check If it is related to any of the following problems or conaitions. If you are still unable to detect and solve the problem, please contact us for help.



Problems	Possible Causes	Solutions
Not enough steam coming out.	The steamer is not plugged in.	Check that your steamer is correctly plugged in.
	The water level is too low.	Unplug your steamer and refill it.
	The water tank is not fully in place.	Ensure that cover is closed and that the water tank snaps when put into place.
Not enough steam coming out.	There is not enough water in the water tank.	Follow the instructions under the "Before Use" section and fill to Max level.
	The steamer is not heated to full temperature..	Always allow steamer to preheat until the power indicator light flashes red.
Water leaks.	The water tank is not fully in place or the cover is not closed properly.	Ensure that cover is closed and that the water tank snaps when put into place.
	The water tank is overfilled.	Fill the water tank to the Max level, do not overfill.
Water spits.	The steamer is not heated to full temperature before use.	Before steaming, always allow steamer to preheat until the power indicator light flashes red.
	There is remaining water after last use which became condensation water and stored in the steam head.	After each use, empty the water tank.
Steam rate decreases or releases particles.	Calcium build-up.	Refer to 'ANTI CALC' section in instructions for use.
Calcium build-up.	You are using water with additives.	Never add any additive in the water tank.
	The water is too hard.	Read carefully the "What water to use" section.
	The appliance has not been rinsed enough after the descaling operation.	Read carefully the 'ANTI CALC' section in instructions for use.

## Steaming Tips

### To Steam Garments

1. Place the fabric in a dry and ventilated place and at least 20 cm (8 inches) away from any walls (otherwise moisture may cause mildew).
2. Empty garment pockets and straighten turn-ups such as cuffs and hems.
3. Hang the garment from a hanger and stretch the fabric slightly with one hand, making sure there is nothing behind the fabric that could be damaged by the steam.
4. Put the steam head against the garment, moving your arm in an up and down motion, targeting creases on the fabric.

**NOTE:** Do not steam over metal accessories. Use with caution when steaming around metal accessories.



**WARNING:** Do not put your steamer upside down to avoid insufficient water supply.

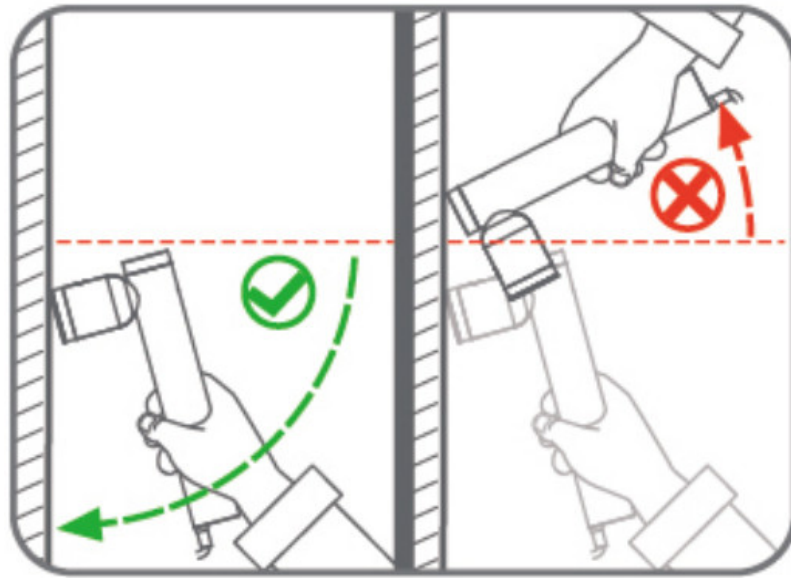

### **To Steam Curtains**

1. Wash and dry the curtains.
2. steam when they are hanging.
3. While steaming, stretch the curtains with one hand to help remove creases more easily

### **To Steam Upholstery**

1. The garment steamer can be used to kill bacteria, remove odors and freshen up furniture upholstery, slip covers, and cushions.
2. Move the garment steamer over the fabric, cushions should be removed for steaming. Allow cushions to dry thoroughly before placing back on furniture.

The appliances packaging is made from environmentally friendly material and can be disposed of at your local recycling plant.

### **1-Year Warranty**

Thank you for your purchase!

#### **WARRANTY:**

Enjoy a warranty for the garment steamer for one year.

#### **REPLACEMENT POLICY:**

Free replacements are based on manufacturing defects but not replaced for the reason of abusing, misusing, or other non-intended usages of the garment steamer. Based on the specific situation of the sample back, we reserve the right for maintenance or replacement.

#### **EXCELLENT CUSTOMER SERVICE:**

If you experience any issues with this product, please contact us, Newbealer is happy to be of service all the time. Any suggestions are also welcome.

# Newbealer

---

## Documents / Resources

 <p>The image shows the cover of the user manual for the Newbealer NB31C-PLUS Handheld Clothes Steamer. The cover is white with black text. At the top, it says 'Newbealer'. Below that, it says 'PRO HANDHELD GARMENT STEAMER' and 'NB31C-PLUS'. In the center, there is a line drawing of the handheld steamer. Below the drawing, it says 'USER MANUAL'. At the bottom, there is a small disclaimer: 'Please read this manual carefully before using the product. It is your responsibility to read the manual.' The entire cover is enclosed in a thin black border.</p>	<p><a href="#">Newbealer NB31C-PLUS Handheld Clothes Steamer</a> [pdf] User Manual NB31C-PLUS Handheld Clothes Steamer, NB31C-PLUS, Handheld Clothes Steamer, Clothes Steamer, Steamer</p>
---	--

## References

- [User Manual](#)