



## NETZERO AA-11-04745-NZ40B Firebox Instruction Manual

[Home](#) » [NETZERO](#) » NETZERO AA-11-04745-NZ40B Firebox Instruction Manual 

### NETZERO AA-11-04745-NZ40B Firebox Instruction Manual



Do not fill while operating



Flammable



Keep away from children

#### **WARNING**

If the information in these instructions is not followed exactly, a fire or explosion may result, causing property damage, personal injury, or loss of life.

## Contents

- 1 IMPORTANT INFORMATION
- 2 EQUIPMENT RECEIVED
- 3 CLEARANCES AND INSTALLATION
- 4 TV and AC INSTALLATION
- 5 HOW TO OPERATE THE BURNER
- 6 MAINTENANCE
- 7 Documents / Resources
  - 7.1 References
- 8 Related Posts

## IMPORTANT INFORMATION

### Certification

This product has been certified by OMNI-Test Laboratories, Inc. to:  
U.S. Certification Standard UL 1370  
Canadian Certification Standard CAN/ULC-S674



ISSUED BY: OMNI-Test Laboratories, Inc.  
13327 NE Airport Way  
Portland, Oregon 97230

### Safety Information

#### WARNING:

1. Risk of explosion
  1. Never use any fuel other than the fuels specifically identified for use in the unvented decorative appliance. Never use gasoline.
  2. Never refill unvented decorative appliance fuel reservoir when appliance is operating or still hot.
  3. Never use unvented decorative appliance in areas where flammable vapors or gas may be present.
  4. Never store or transport the fuel in anything other than a metal or plastic container that is:
    - A) Acceptable for use with the specific fuel
    - B) Non-red in color
    - C) Is in the original container for the specific fuel
2. Never store fuel in the living space or same location as the appliance.
3. Due to high surface temperatures, keep children, clothing, and furniture away.
4. Risk of indoor air pollution – use unvented decorative appliance only in well-ventilated areas. People with breathing problems should consult a physician before using the unvented decorative appliance.
5. Do not use unvented decorative appliance to heat or boil water or use as a cooking appliance.
6. Do not use in a room with oxygen tanks in use

**WARNING:** This appliance has not been tested with an unvented gas log set. To reduce risk of fire or injury, do

not install an unvented gas log set into this appliance.

**WARNING:** This appliance has not been tested for use with doors. To reduce the risk of fire or injury, do not install doors.

- This product is a decorative burner creating real fire.
- Keep the fuel away while the burner is in operation.
- Wipe up fuel spills immediately with a dry cloth or paper towels.
- Do not make any alterations or put any objects or liquids inside the burner.
- Do not touch the filament or other hot elements.
- Do not transport the burner if fueled.
- Do not leave an operating burner unattended.
- Keep the provided USB cable for inspection purposes.
- Do not use the burner in humid or drafty spaces.

### **Locating the Burner**

- Do not move or relocate the appliance while in use.
- For indoor use and in housing only. Minimum temperature of use is 50°F (10°C).
- No heat-sensitive or flammable objects can be placed within a 40 inch radius from, or directly above, the burner.
- Do not place any objects on the top of the burner except attached accessories.
- For service purposes, the surrounding area must allow for easy removal of the burner.
- Keep children, animals, and unauthorized persons at a safe distance at all times and never leave them unsupervised when the appliance is on or hot.
- A Class B fire extinguisher must be located in close proximity to the appliance in case of fire.

### **Ventilation & Required Room Size**

Open fires consume oxygen. Use only in well-ventilated areas and those that are protected from the draft effects of cross ventilation. When selecting a location for the appliance it is important to consider the recommended minimum room sizes and clearances to walls and combustible materials (see Table A). An air exchange rate of 1/hour is recommended.

In a house of typical construction, that is, one that is not of unusually tight construction due to heavy insulation and tight seals against air infiltration, an adequate supply of air for combustion and ventilation is provided through infiltration. The unvented decorative appliance should be installed in a room where at least 200 ft.<sup>3</sup> (5.7 m<sup>3</sup>) of air space is provided for each 1,000 BTU per hour of unvented decorative appliance rating (at maximum burner adjustment). See Table A for recommended minimum room size.

If the burner is installed in a room smaller than the recommended minimum room size, or in a home of unusually tight construction, the door(s) to adjacent room(s) should be kept open or a window to the outside should be opened at least 1 inch (25.4mm) to guard against potential buildup of indoor air pollution.

The decorative appliance may only be installed in a bathroom or bedroom if the room meets the recommended minimum room size.

### **Specifications**

Burner	Fuel Capacity	Heat Output MAX – MIN	Minimum Room Size	Approx. fuel consumption on MAX setting	Approx. fuel consumption on MIN setting	Approx. burn time on MAX setting – MIN setting
	Gallon – (Liter)	BTU/h	ft <sup>3</sup> – (m <sup>3</sup> )	gal/h – (L/h)	gal/h – (L/h)	[h]
NZ40B	3.5 – (13.2)	24,000 – 10,000	4,800 – (136)	0.29 – (1.1)	0.12 – (.46)	12 – 29
NZ48B	4.5 – (17.0)	29,000 – 12,500	5,800 – (164)	0.35 – (1.3)	0.15 – (.58)	13 – 30
NZ60B	5.5 – (20.8)	38,000 – 17,000	7,600 – (215)	0.46 – (1.7)	0.21 – (.78)	12 – 27
NZ72B	7.1 – (26.9)	51,000 – 21,000	10,200 – (289)	0.62 – (2.3)	0.26 – (.97)	11.5 – 28
NZ90B	9.6 – (36.3)	72,000 – 26,500	14,400 – (408)	0.88 – (3.3)	0.32 – (1.2)	11 – 30
NZ108B	12.1 – (45.8)	94,000 – 32,200	18,800 – (532)	1.14 – (4.3)	0.39 – (1.5)	11 – 31.5

## Electrical Requirement

Burners NZ40B, NZ48B, NZ60B, and NZ72B must be connected to a dedicated 115V min.15-amp circuit. Burners NZ90B and NZ108B must be connected to a dedicated 115V min. 20-amp circuit. A junction box for hardwiring the burner must be located in the enclosure under the burner. This is shown in the clearances and installation section of this manual.

## Fuel



Do not use gel or thick fuels. Only use fuels consisting of 86-96.6% ethanol (not dehydrated) by volume. NetZero Fuel is recommended.

EQUIPMENT RECEIVED

Standard Equipment

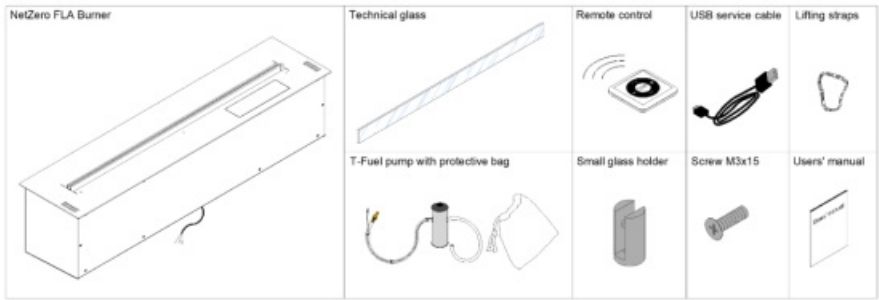

QUANTITY OF STANDARD EQUIPMENT							
Burner Model	Remote control	T-Fuel pump with protective bag	USB service cable	Technical glass holder	Technical glasses	Screw	Lifting straps
						M3x15	
NZ40B	1	1	1	2	1	2	2
NZ48B	1	1	1	2	1	2	2
NZ60B	1	1	1	3	1	3	2
NZ72B	1	1	1	4	2	4	2
NZ90B	1	1	1	4	2	4	2
NZ108B	1	1	1	6	2	6	2

Optional Equipment

Applies to see-through, peninsula and island installations.  
For information on installing the large glass barrier kits reference the large glass barrier kits installation manual.

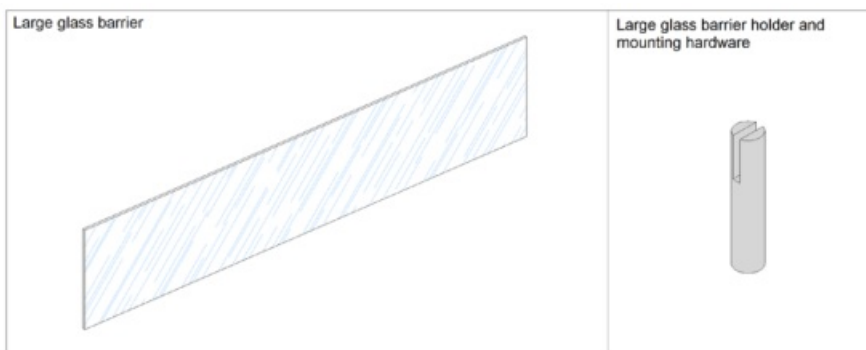

QUANTITY OF OPTIONAL EQUIPMENT			
Burner Model	Large Glass Barrier Kit Part Number	Large Glass Barrier	Glass Barrier Holders
NZ40B	AA-11-04768	2	4
NZ48B	AA-11-04755	2	4
NZ60B	AA-11-04756	2	4
NZ72B	AA-11-04757	2	4
NZ90B	AA-11-04755 (x2)	4	8
NZ108B	AA-11-04756 (x2)	4	8

## CLEARANCES AND INSTALLATION

### Burner Clearances and Cavity Measurements

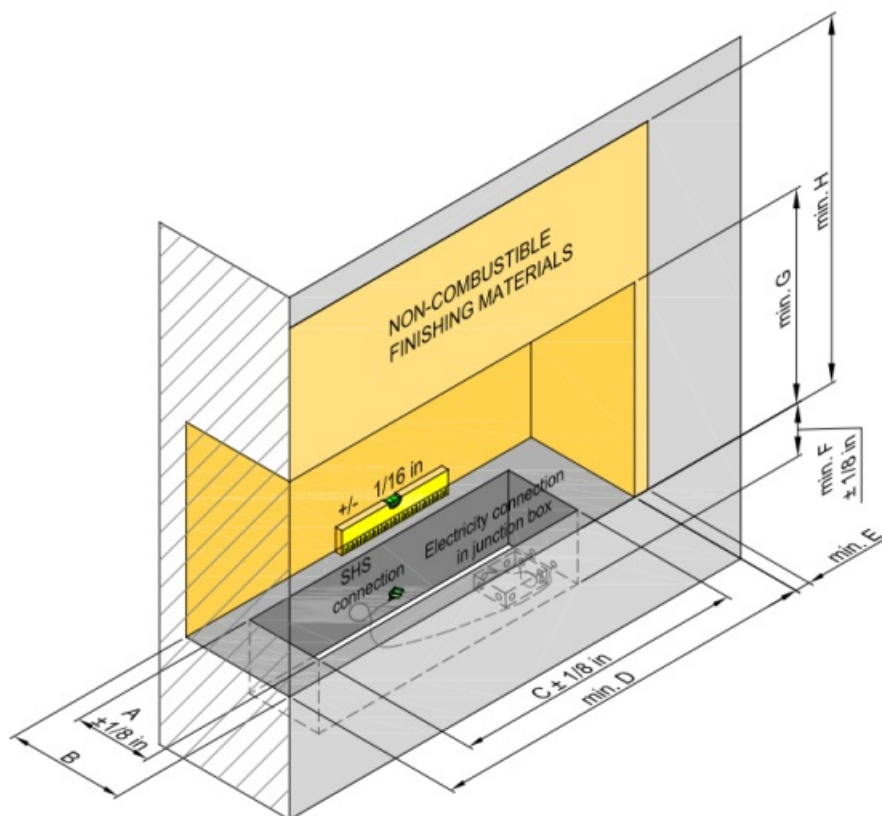

Measurements										
	Burner Model	Electricity connection	SHS connection	A [in]	B [in]	C [in]	D [in]	E [in]	F [in]	H [in]
	NZ40B	115V, 60Hz, min. 15A	4x0.25 mm2 AWG 23	10 1/4"	16"	30 1/2"	40"	2"	14"	20"
	NZ48B					38 1/4"	48"			
	NZ60B					46 1/4"	60"			
	NZ72B	115V, 60 Hz, min. 20A				58"	72"			
	NZ90B					77 1/4"	90"			
	NZ108B					97 1/4"	108"			

- Ensure that burner flame is positioned a minimum of 40 inches away from curtains, flammable materials, and other sources of ignition.
- Be aware of drafts. Do not place in areas where fans, vents or open doors or windows could affect the burner.
- The burner must be installed in accordance with the outlined safety requirements and clearances. Only non-combustible materials can be used in the non-combustible zone shown in yellow.
- Materials used in areas designated as non-combustible must be rated as non-combustible per NFPA 220 Standard on Types of Building Construction, or reported as passing ASTM E 136, Standard Test Method for Behavior of Materials in a Vertical Tube Furnace at 750 Degrees C.

**WARNING:** common finishing materials not approved for use:

- Paper-faced gypsum board (drywall) including Type X Fire Rated board is not a non-combustible material.
- WonderBoard brand boards are commonly used as a backerboard for tile. WonderBoard backerboard is not a non-combustible material.
- Durock brand cement board contains a polymer coated fiberglass mesh. This can smell when heated. For this reason Durock cement board is not approved.

Non-combustible finishing materials shown in yellow must be insulated from any combustible elements of the construction such as wood framing. This can be accomplished by one of the following:

Option 1: Construct the enclosure using only non-combustible finishing materials and framing. Use steel studs and non-combustible material to build the enclosure for the burner.

Option 2: Create an air gap behind the non-combustible finishing material by following the method shown below. The gap between the material can be left open or insulated with mineral wool.

Method for creating an air gap behind non-combustible finishing material.

Hardibacker 500 or other non-combustible rated cement board is recommended for use in constructing the enclosure. Do not use Durock or WonderBoard brand cement board. These boards are not rated as noncombustible materials and will off gas or deteriorate when subjected to heat.

1. Install a 1/2" thick cement board to the wood framing.
2. Cut 2" wide strips of 1/2" thick cement board to use as spacers between the first layer of 1/2" thick cement board and a second layer of 1/2" thick cement board. This will create an air gap between the two boards.
3. Install a second layer of cement board to the strips. The gaps between the strips can be left open or insulated with mineral wool.
4. Install the desired non-combustible finishing material to the second layer of cement board.

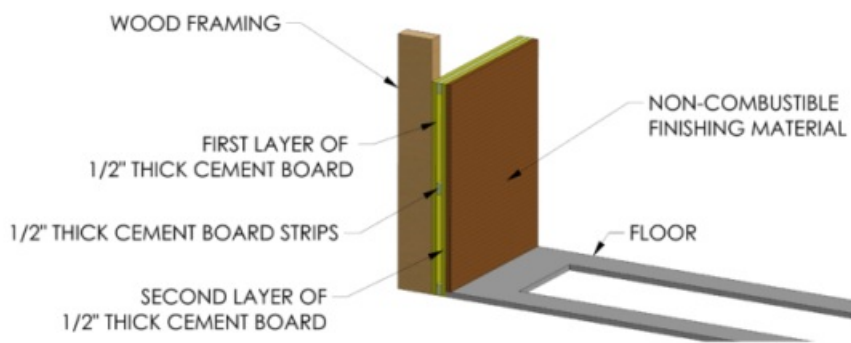

- The bottom of the enclosure that holds the burner and other areas not shown in yellow can be constructed from any construction material including combustible materials.
- In the non-combustible area shown in yellow use only fasteners and adhesives that are resistant to a temperature of 300°F (150°C). For an adhesive, High Temp 450°F silicone adhesive is recommended.
- The minimum F dimension of 14" allows for a 2" tall junction box. If a taller junction box is used increase the depth of the cavity.

## Burner Clearances and Cavity Measurements for Multiple Burners

To create longer, or custom size burners multiple burners can be placed together in the same cavity. Follow the chart below when building a cavity for a multiple burner arrangement. The C and D dimensions will be calculated from the total length of the burners placed together. An example is given below.

Measurements									
Burner Model	L [in]	A [in]	B [in]	C [in]	D [in]	E [in]	F [in]	G [in]	H [in]
NZ40B	31 1/8"	10 1/4"	16"	Total Length of Burners – 5/8"	Total Length of Burners + 10"	2"	14"	20"	40"
NZ48B	39"								
NZ60B	46 7/8"								
NZ72B	58 5/8"								
NZ90B	78 3/8"								
NZ108B	98"								

**Example:** Two burners are placed together.

Burner 1: NZ36B – Length = 31 1/8"



Burner 2: NZ48B – Length = 39"  
 Total Length =  $31 \frac{1}{8}" + 39" = 70 \frac{1}{8}"$   
 $C = 70 \frac{1}{8}" - 5/8" = 69 \frac{1}{2}"$   
 $D = 70 \frac{1}{8}" + 10" = 80 \frac{1}{8}"$

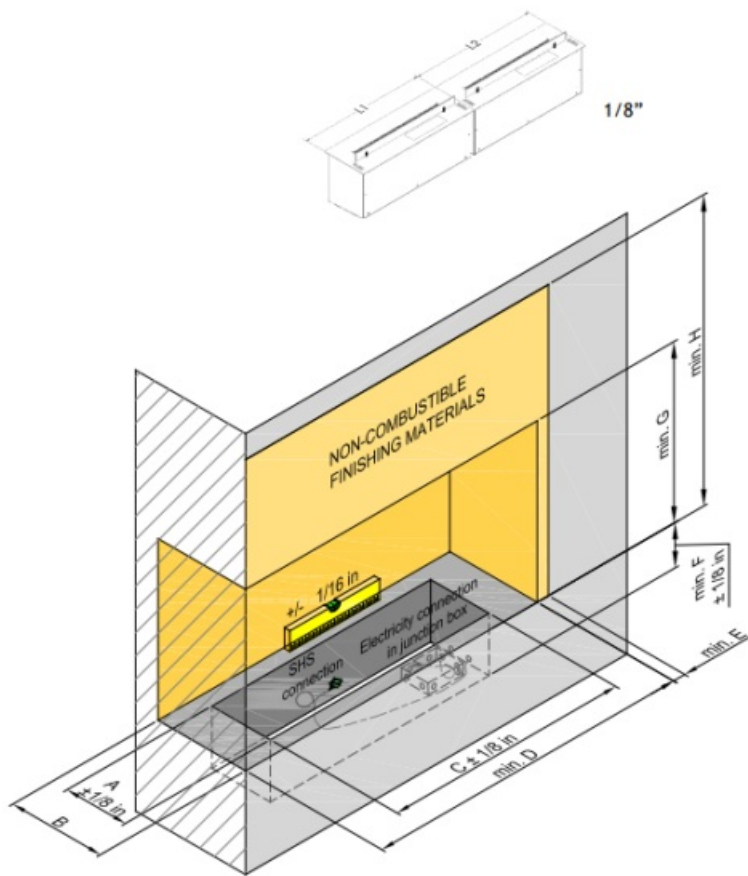

## Placing the Burner

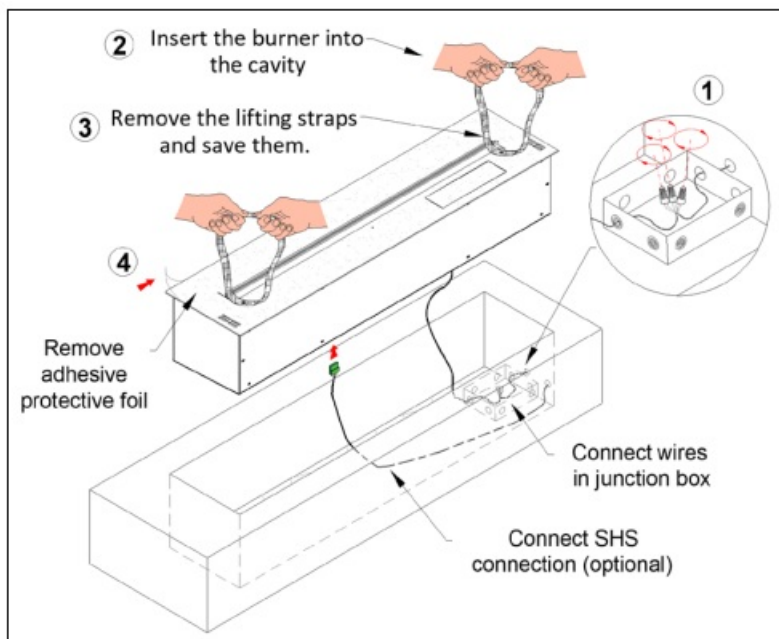

Scan or click to watch the video instruction



<https://www.youtube.com/watch?v=b5dETFNTBW4&feature=youtu.be>

### Installing Technical Glass

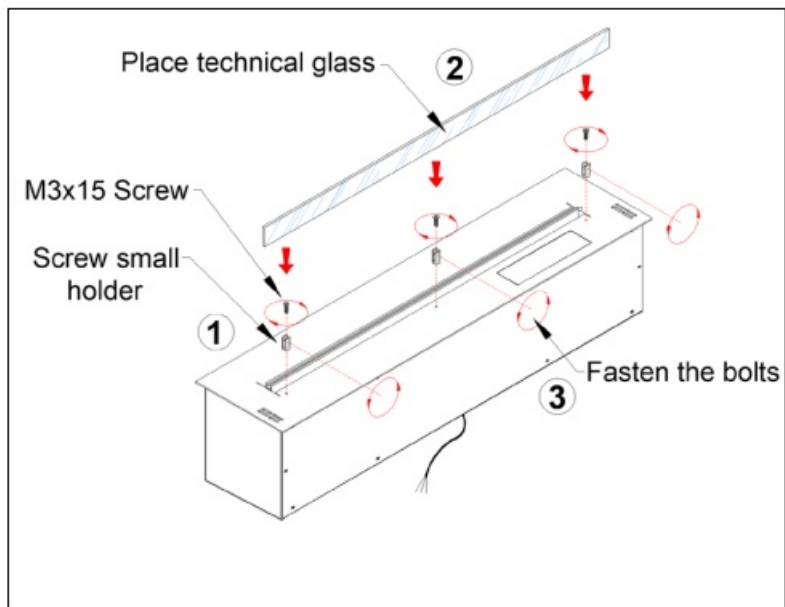

Scan or click to watch the video instruction



<https://www.youtube.com/watch?v=b5dETFNTBW4&feature=youtu.be>

### Recommended Burner Installations

Installation requiring technical glass

Single-Side, Left-Corner, Right-Corner and Three-Sided Installations

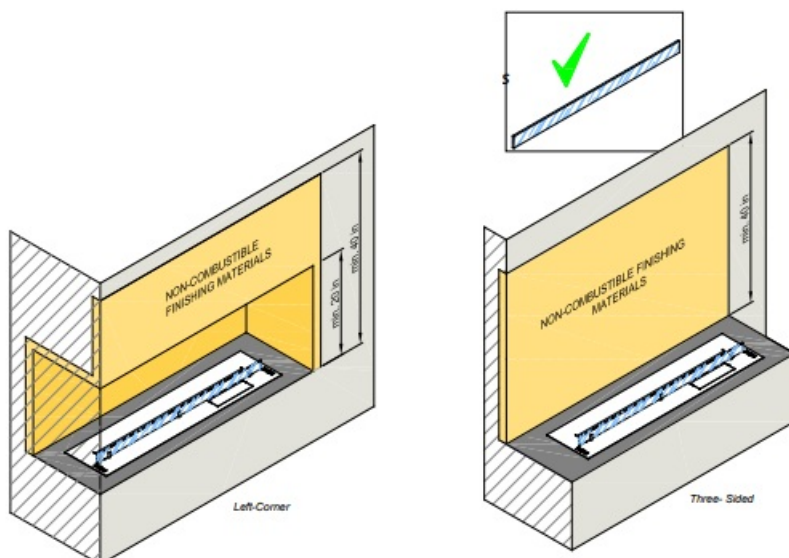

## Installation Requiring Large Glass Barrier Kit See-Through, Peninsula and Island Installations

For these installations, the Large Glass Barrier Kit must be used. For additional information on installing the Large Glass Barrier Kit reference the installation manual for the Large Glass Barrier Kit.

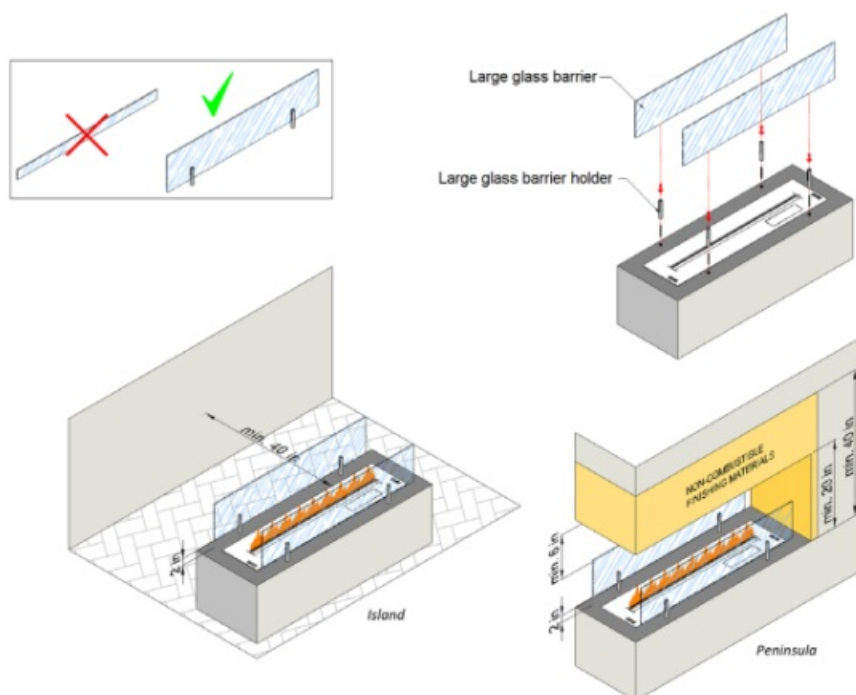

## TV and AC INSTALLATION

A TV can be installed above the burner enclosure by following the methods shown below. Single-Sided, Left-Corner, Right-Corner and Three-Sided Installations

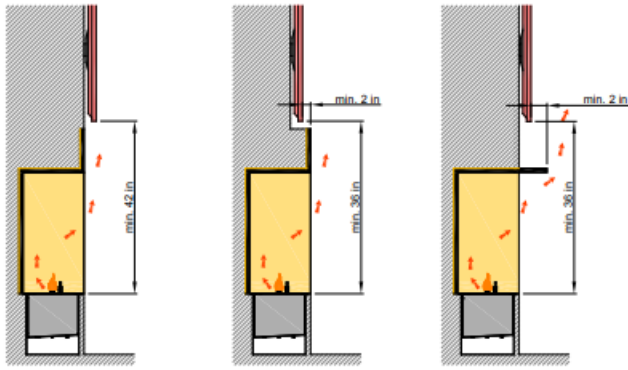

*See-Through and Peninsula Installations*

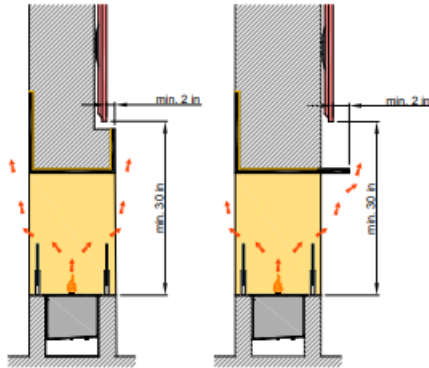

If an air conditioning vent or fan is located near the burner the vent or fan must be positioned to blow away from the burner.

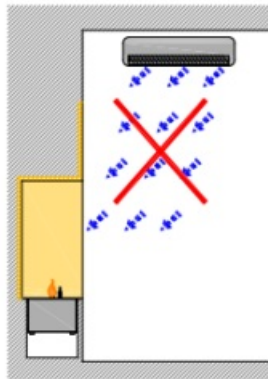
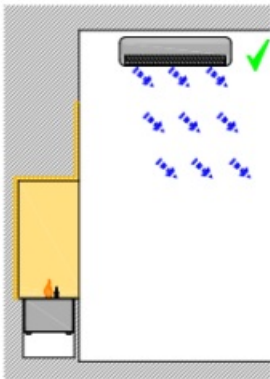

## HOW TO OPERATE THE BURNER

### Components

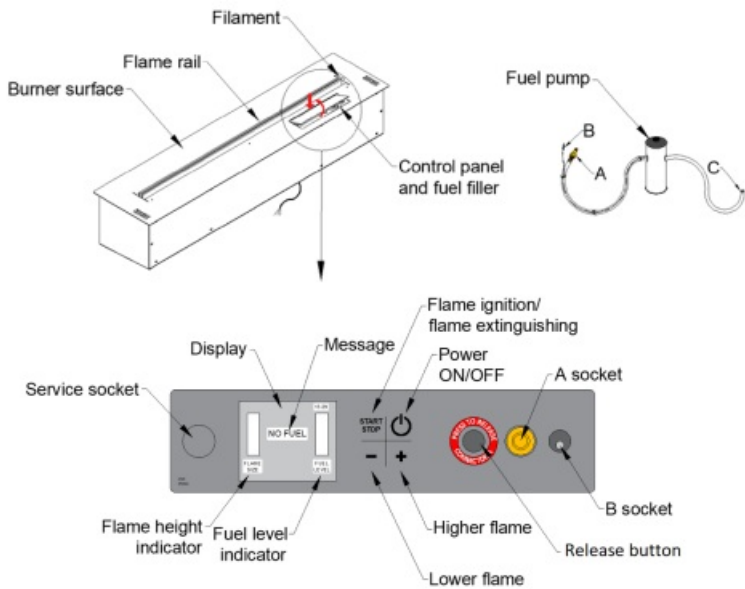

## Filling Fuel

- a) Open the control panel and fuel inlet (I) and turn the burner ON by pressing .
- b) If the tank is empty the message (NO FUEL) is displayed. Open the fuel inlet (I) and firmly connect the pump hose 'A' (click!) and power cable 'B' (II) the message (REFUELLING, PLEASE WAIT) is displayed.

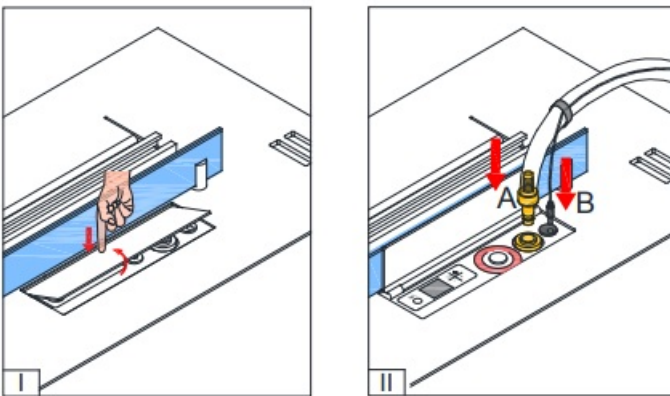

- c) Place the fuel container stably on the floor and insert the pump hose 'C' (III). Press and hold the button on the pump to start refuelling (IV).

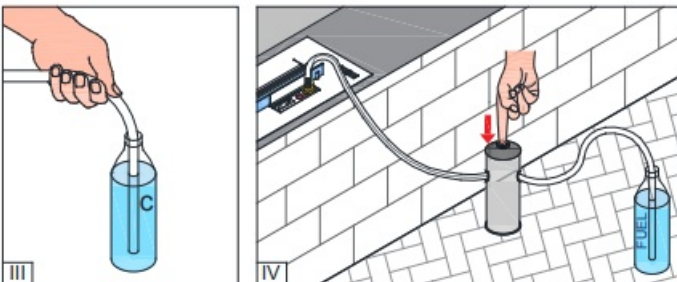

- Once the fuel container has been emptied, replace it with a full one and start the pump again (see point c). The pump will stop when the tank is full and message ("Beep" + RESERVOIR FULL) is displayed.
- d) Disconnect the power cable 'B'. To disconnect the pump, hold the end of the hose 'A' and firmly press the button in the place marked with a sticker (V). Close the fuel inlet.
- e) Shake the remaining fuel from the hose 'C' into the container and place the pump in the bag (VI).

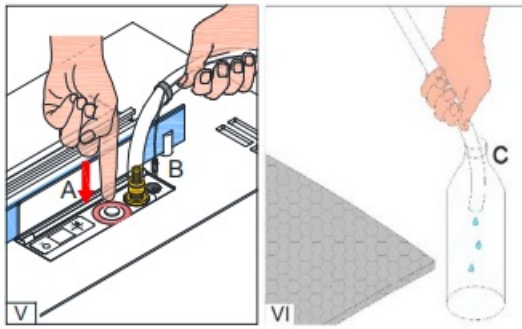

## Menu

The menu is available when message (READY) or (NO FUEL) is displayed. To enter the menu, press and hold + for 8 seconds. Scroll through the settings with + and accept by pressing -. To quit the menu, wait for couple of seconds or press .

SETTING	DESCRIPTION
Device IP	View the IP address to configure wireless connection (only if a Wi-Fi network is configured).
WIFI CONFIG	Wireless control configuration (see the next page).
Lock the device	Control panel lock. Enable by pressing – in the menu. To disable, press and hold <b>START/STOP</b> for 5 seconds.
Child lock	Child lock – flame ignition is initiated by pressing <b>START/STOP</b> for 3 seconds. Choose <b>ON/OFF</b> to enable/disable the function.
Set time	Set the hour by pressing +, next press – and set minutes. Accept with –.
Remote Control	Programming a new remote or connecting one remote with multiple burners. Press – to start the configuration. Press and hold <b>START</b> , <b>STOP</b> , +, – for 1 second, respectively. Message <b>(PROGRAMMING FINISHED)</b> informs that the configuration has been successfully completed.
Display off	If inactive for 1 minute, the display will turn off. Choose <b>ON/OFF</b> to enable or disable the option.
Fast start	Faster flame ignition (enabled by default). The power consumption is 100W higher when the burner is ready for flame ignition. Choose <b>OFF</b> to disable.
Serial number	View the burner serial number.
Software	View the software version.
History	View 40 recent messages.

## Functions

### a) Flame ignition

Message (READY) indicates that the burner is ready to ignite the flame. Press START. Flame ignition will take 2-10 minutes while the message (PLEASE WAIT) is displayed. The message (WORKING) indicates that the flame has been ignited and the burner reached the working temperature.

b) Flame height regulation

When the flame is ignited and the message (WORKING) is displayed, press + or – to make the flame higher or lower in 6 levels. The default flame height is 4.

**ATTENTION!** If the burner temperature is too high, the flame will be automatically lowered and the height regulation blocked. If the temperature keeps increasing, the flame will be extinguished automatically (COOLING THE DEVICE, TEMPERATURE TOO HIGH).

c) Flame extinguishing

To extinguish the flame:

Press  or

Press STOP. In this case, an additional system of fans will be enabled to cool the burner faster.

The message (COOLING THE DEVICE) indicates that the burner is being cooled. You can ignite the flame again when the burner is cooled and the message (READY) is displayed.

d) Turning the burner off

To turn the burner OFF, press . The burner will be turned OFF automatically if an error occurs (see the error table on the next page).

e) Sleep function

The SLEEP function extinguishes the flame after a set period of time (max. 3 hours). To turn on the sleep function: When the flame is ignited and the message (WORKING) is displayed, press and hold + and – for 10 seconds. Then, press + to set the time after which the flame will be extinguished and accept with –. A timer will appear in the right upper corner of the display, indicating the time remaining until the flame is extinguished.



Scan or click to watch the video instruction

<https://www.youtube.com/watch?v=6hnhCXk3UDc>

## Wireless Control Configuration

a) Download Planika N-control app on your mobile device from any app store.

b) To start the configuration, select Wi-Fi CONFIG in the menu. Time to finish the configuration is 5 minutes.

c) Enable the Wi-Fi connection on your mobile device and connect to planika123 network (if the network is not visible on the list, disconnect the power supply from the burner for 10 seconds and start the configuration again). This operation can be done with only one burner at a time. Using more than one burner during configuration can lead to errors.



d) Start the application on your mobile device. The burner will appear in the manager window.

e) Connect to the burner and go to SETTINGS. Choose the connection mode (MODE) and security protocol (SECURITY). Enter the network name (SSID\_NAME) and password (PASSWORD).

f) If static IP is required, enter IP ADDRESS, NETMASK and GATEWAY. For dynamic IP enable DHCP. Accept the settings by pressing SUBMIT.

g) Connect to the selected/created network in the Wi-Fi menu on your mobile device.

h) The application will automatically search for the burner.





MODE	OFF	STA	AP
	Blocks wireless control via Wi-Fi.	Connection with your local network and a router. 	Direct connection between the burner and your mobile device (outside your local network). 
SECURITY	--	Choose the security protocol used in your local network (usually WPA/WPA2).	Choose security protocol WPA (recommended) or WEP.
SSID_NAME	--	Enter the name of your local network.	Create a network name.
PASSWORD	--	Enter your local network password.	Create a network password (min. 8 characters).



## Error Message

If a fault occurs an error message will be displayed, accompanied by an audible tone.

Press START/STOP to mute or turn the burner OFF by pressing  .

ERROR MESSAGE	<b>SOLUTION</b> (contact the Service Department if the solution does not eliminate the error)	
TEMPERATURE TOO HIGH	Wait for the message <b>(READY)</b> to be displayed.	
DEVICE HIT		
DEVICE TILTED		
CO2 LEVEL TOO HIGH	Ventilate the room to reduce the CO2 level. Wait for the message <b>(READY)</b> to be displayed.	
WARNING CLOSE THE LID	Do not fill the fuel. Close the fuel inlet lid.	
ERROR 01	Fuel spillage has been detected. Turn the burner OFF by pressing  and disconnect the pump. Wipe the visible liquid and wait for a min. 1 hour. If the error is not eliminated, wait for min. 24 hours.	
ERROR 05	The burner has been moved. Eliminate the source of shock. Wait for the message <b>(READY)</b> to be displayed.	
ERROR 06/16/17/20	Turn the burner OFF 	, wait for a min. 5 minutes and turn the burner ON.
ERROR 15	Turn the burner OFF 	and level the surface on which the burner is installed.
ERROR 21	Turn the burner OFF 	, wait for a min. 5 minutes and turn the burner ON.
ERROR 02/03/04/10/16/31/32/41/51/61	Contact the Service Department.	

## MAINTENANCE

NetZero burners are considered maintenance free, meaning they do not require regular servicing. To ensure the burner is in proper condition, the manufacturer suggests visually inspecting the condition of the nozzles on the flame rail while the burner is off. The nozzles should be round and regular. Any signs of corrosion on the flame rail, irregular flame pattern or any other erratic behavior of the burner should be immediately reported to the seller or distributor of the burner.

Regularly clean the surface of the burner with a soft, dry cloth. While cleaning, please be aware that due to the design of the burner, the filament protrudes above the burner surface. If put to mechanical stress the filament may break.

NetZero is a distributor of these products, which are designed and manufactured by Planika SP S O O. THERE ARE NO WARRANTIES WHICH EXTEND BEYOND THE DESCRIPTION ON THE FACE HEREOF AND SUPPLIED MANUALS. IMPLIED WARRANTIES OF MERCHANTABILITY, IMPLIED WARRANTIES OF FITNESS, IMPLIED WARRANTIES OF WORKMANSHIP AND OTHER IMPLIED WARRANTIES ARE EXCLUDED BY NETZERO.

## Documents / Resources

	<p><b><a href="#">NETZERO AA-11-04745-NZ40B Firebox</a></b> [pdf] Instruction Manual</p> <p>AA-11-04745 NZ40B, AA-11-04746 NZ48B, AA-11-04747 NZ60B, AA-11-04748 NZ72B, AA-11-04749 NZ90B, AA-11-04745-NZ40B Firebox, AA-11-04745-NZ40B, Firebox, AA-11-04750 NZ 108B</p>
---	---

## References

-  [Ethanol Fireplace by Planika. ? Automatic & Ventless ?](#)