

Netvue Bird Feeder Camera User Guide: Set Up & Installation Manual

[Home](#) » [netvue](#) » **Netvue Bird Feeder Camera User Guide: Set Up & Installation Manual**

The Netvue Birdfy Smart AI Bird Feeder Camera is an innovative device that allows bird enthusiasts to observe and record their feathered friends in real-time. This user guide provides detailed instructions on how to set up and install the camera, including inserting a micro SD card, charging the battery, and installing the antenna. Users will also learn how to turn the camera on and off, as well as how to read the LED indicator. The guide also includes important information on installation, such as finding a good installation spot, drilling holes in the wall, and aligning the screw hole on the back of the camera with the bracket screw. Additionally, users will learn about the Bird Detection feature, which uses AI intelligent recognition algorithms to inform users in real-time “what species of bird is coming” and provide bird knowledge learning. The guide also includes a FAQ section that addresses common questions about the product, such as whether a subscription fee is required and what type of bird food to use. Overall, this user guide provides a comprehensive overview of the Netvue Birdfy Smart AI Bird Feeder Camera and its features, making it easy for users to set up and enjoy their new device.

Contents [[hide](#)]

- [1 netvue Birdfy Smart AI Bird Feeder Camera](#)
- [2 What's In The Box](#)
- [3 Camera Structure](#)
- [4 Insert Micro SD Card](#)
- [5 Battery Charging](#)
- [6 How To Turn On & Off The Camera](#)
- [7 Install The Antenna](#)
- [8 Attach the provided antenna clockwise to the Birdfy camera.](#)
- [9 Set Up With Netvue App](#)
- [10 Installation](#)
- [11 Bird Detection](#)
- [12 FCC STATEMENT](#)
- [13 SPECIFICATION](#)
- [14 FAQs](#)
- [15 VIDEO](#)
- [16 Documents / Resources](#)
 - [16.1 References](#)
- [17 Related Posts](#)

netvue

netvue Birdfy Smart AI Bird Feeder Camera



What's In The Box

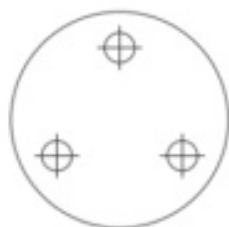

Drilling Template



Power Cable

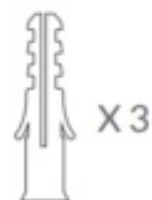

Anchors

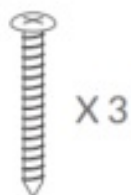

Screws



Quick Guide



Threaded Bracket



Ejector Pin



Screws

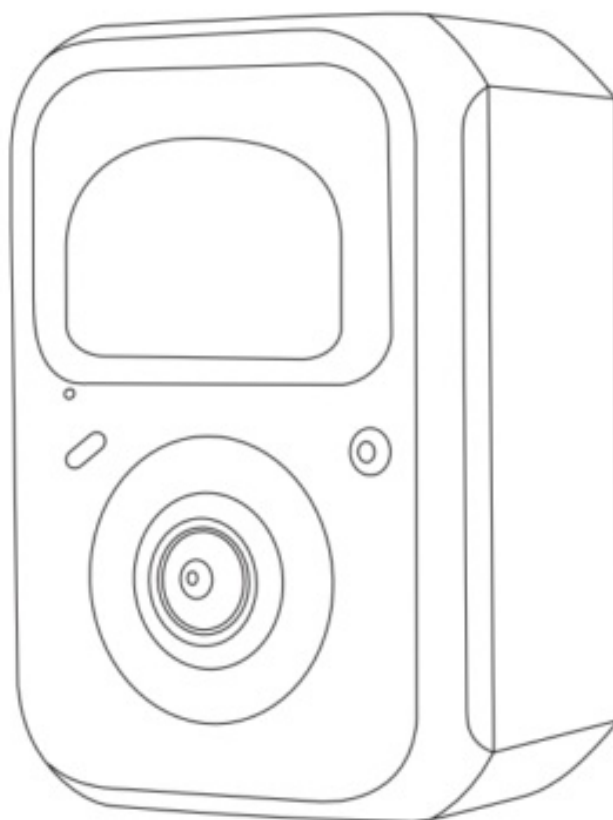

Birdfy Cam

Camera Structure

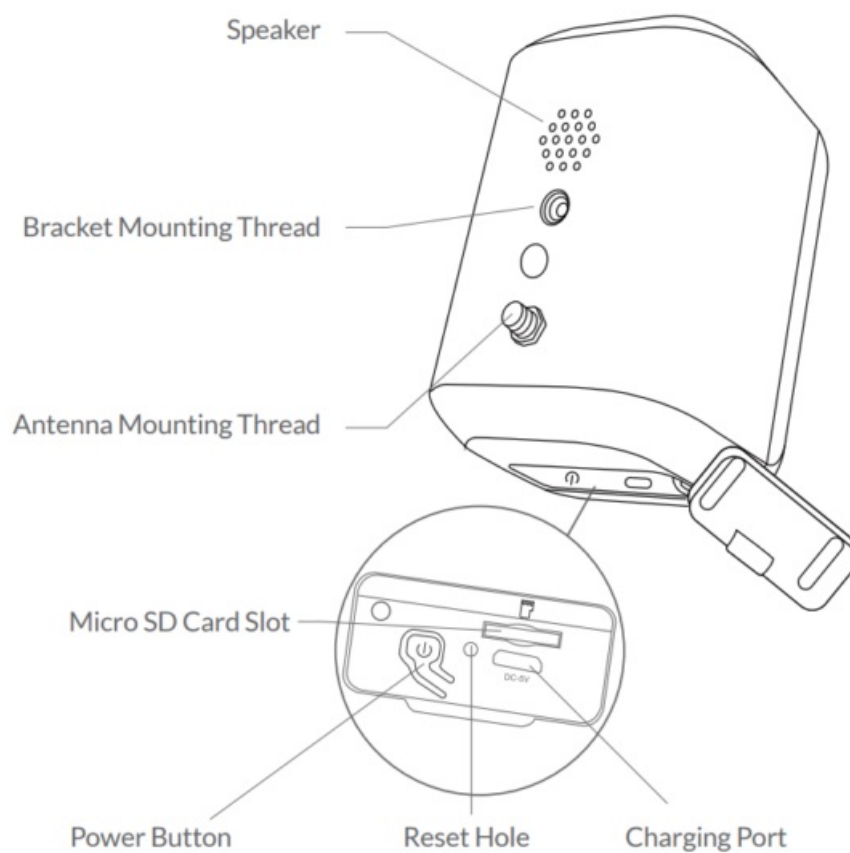
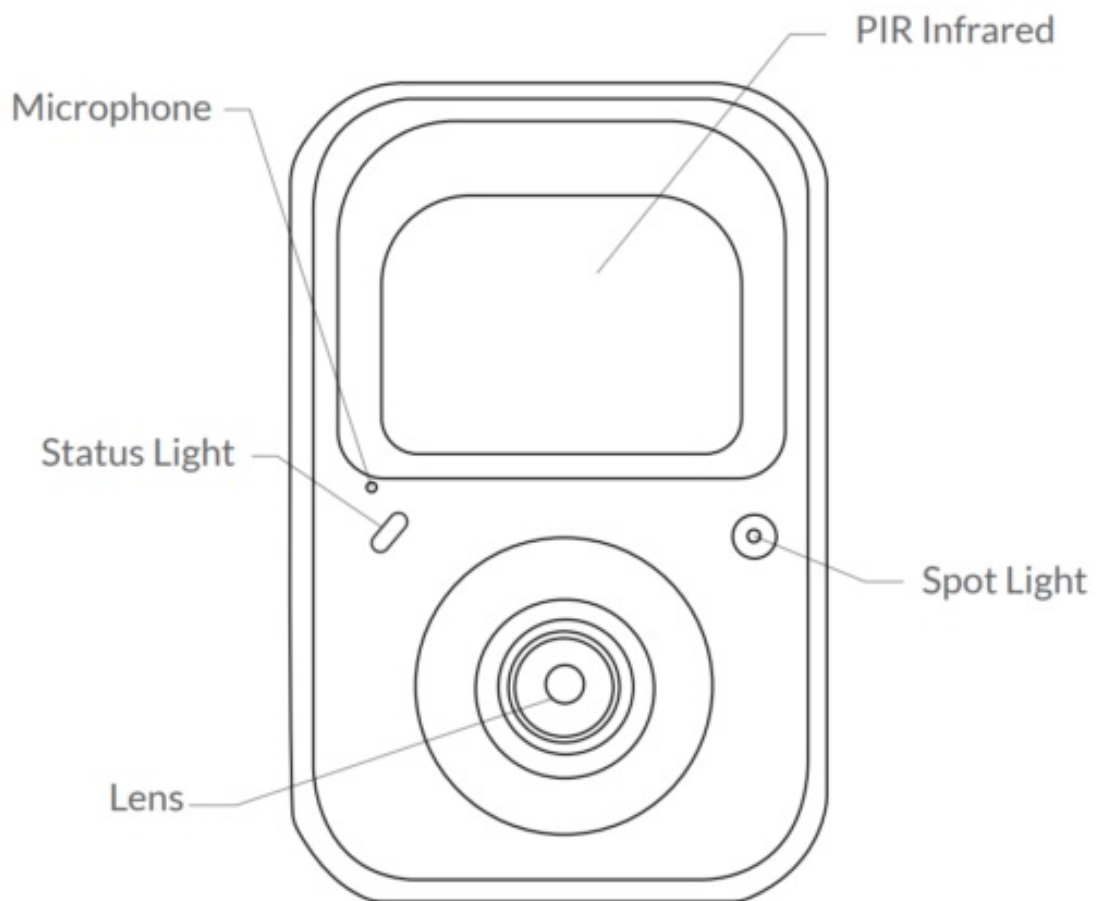

Insert Micro SD Card

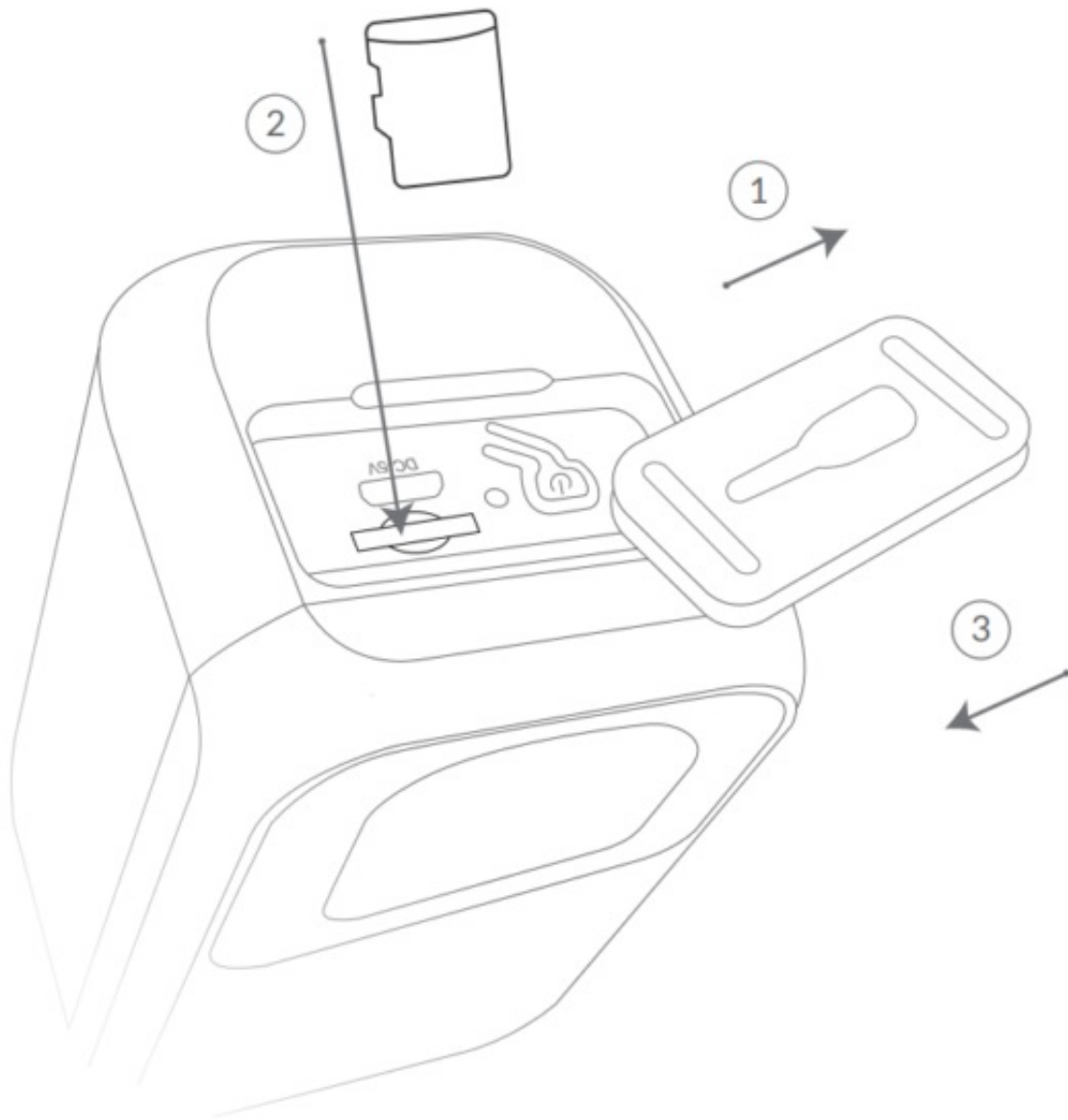

Birthday Cam comes with a built-in card slot that supports up to 128GB Micro SD card. **Step 1:** Open the top silicone plug. **Step 2:** Insert the Micro SD card. Make sure to plug it in the right direction. **Step 3:** Finally, close the silicone plug.

Battery Charging

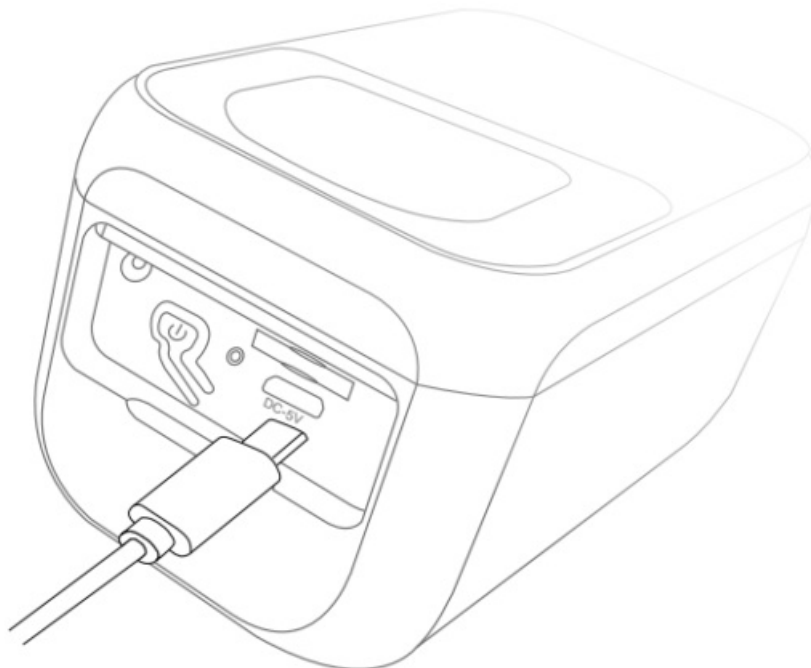

The batteries inside the camera are not fully charged according to the transportation safety regulations. Please fully charge the camera before using it. Please charge the batteries with provided Type C Port Cable (DC5V / 1.5A adapter not included). The status light will be in solid yellow when charging and will turn to solid green when it is fully charged. It takes about 14 hours to fully charge your camera.

How To Turn On & Off The Camera

To turn on the camera: Long press the power button for 3s to turn on the camera. Then the Status Light in the front of the camera will be solid blue. Double click the power button to enter WiFi mode after the prompt tone.

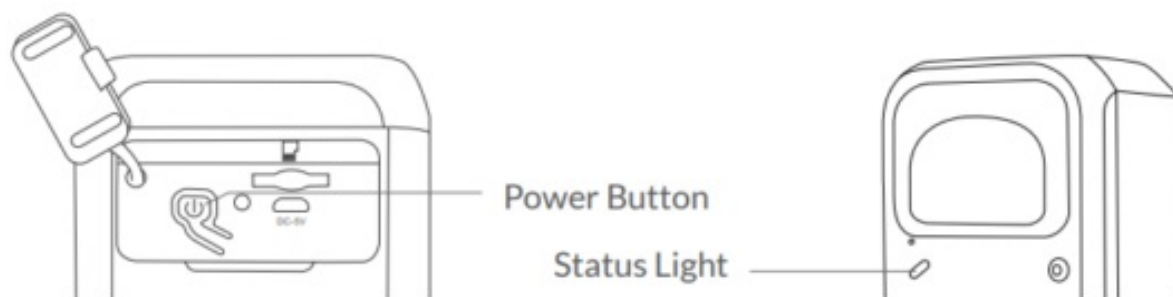

LED Indicator	Description
Solid Blue	Working
None	Sleep/Power Off
Solid Yellow	Charging
Solid Green	Charging Finished

To turn off the camera: Long press the power button for 3s to turn off the camera. Then the Status The light in the front of the camera will be off.

Install The Antenna

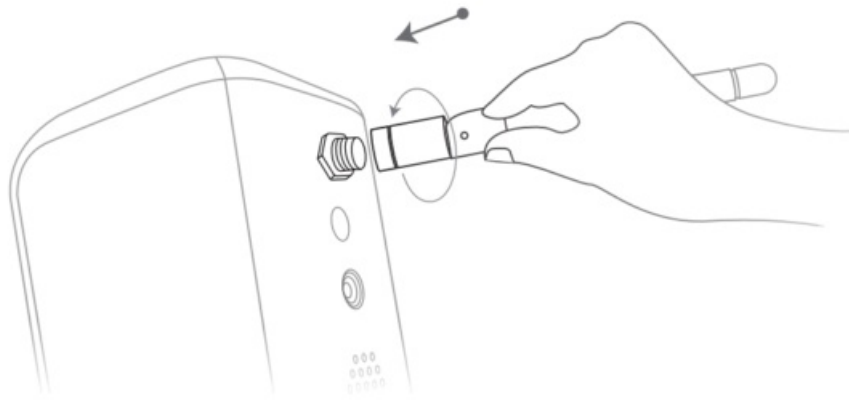

Attach the provided antenna clockwise to the Birdfy camera.

Read Before Installation

1. Keep Birdfy Feeder and all accessories out of reach of children and pets.
2. Make sure the camera has been fully charged (DC5V / 1.5A).
3. Working temperature: -10°C to 50°C (14°F to 122°F) Working relative humidity: 0-95%
4. Please do not expose the camera lens to direct sunlight.
5. The camera has an IP65 waterproof rating, which supports working properly under rain or snow. But it can not be soaked in water.

Note:

1. Birdy Feeder Cam only works with 2.4GHz Wi-Fi.
2. Strong lights may interfere with the device's ability to scan QR codes.
3. Avoid placing the device behind furniture or near microwave products. Try to keep it within range of your Wi-Fi signal.

Set Up With Netvue App



<https://download.netvue.com/>

Download Netvue App from App Store or Google Play. Follow the in-app instruction to complete the entire setup process.

Installation

Check the following things before you drill holes on your wall: Birdfy Cam has been successfully added to your Netvue App and is able to stream video.

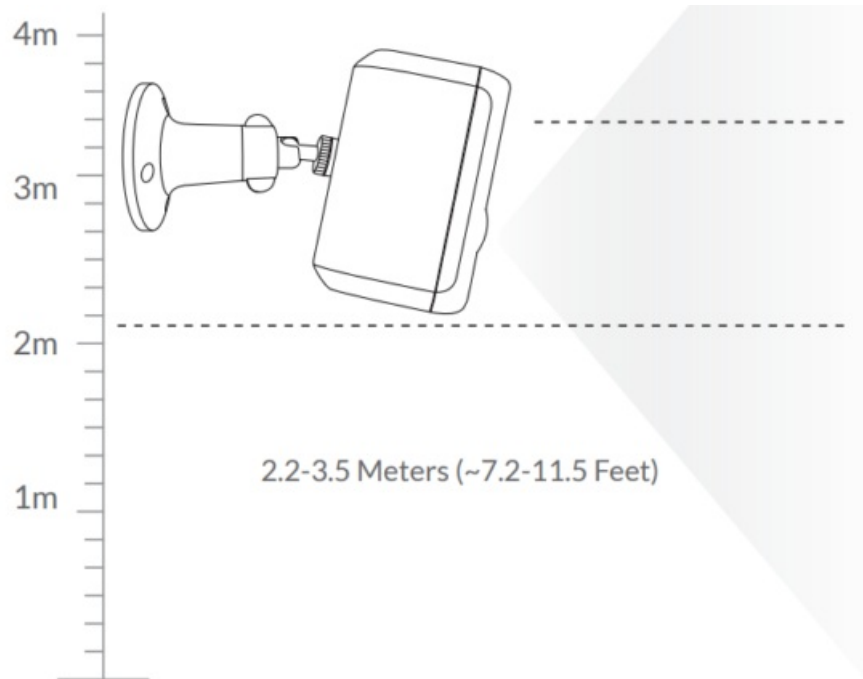

Step 1: Find a good installation spot Please install the camera in a position where its view is not blocked and ensure that it is within the coverage of the Wi-Fi network. We recommend installing it at a height of 2.2-3.5 meters in an open area to make it easier for birds to find it.

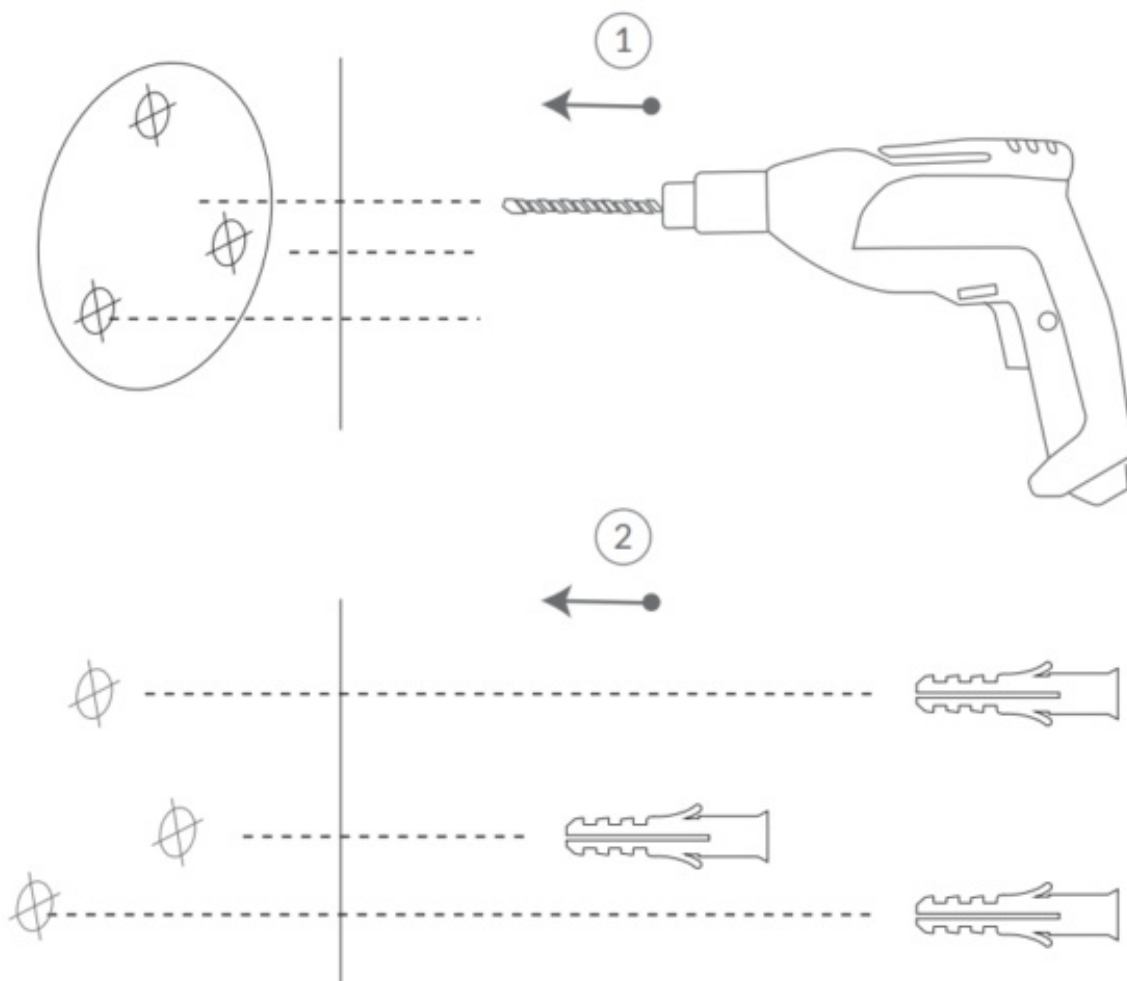

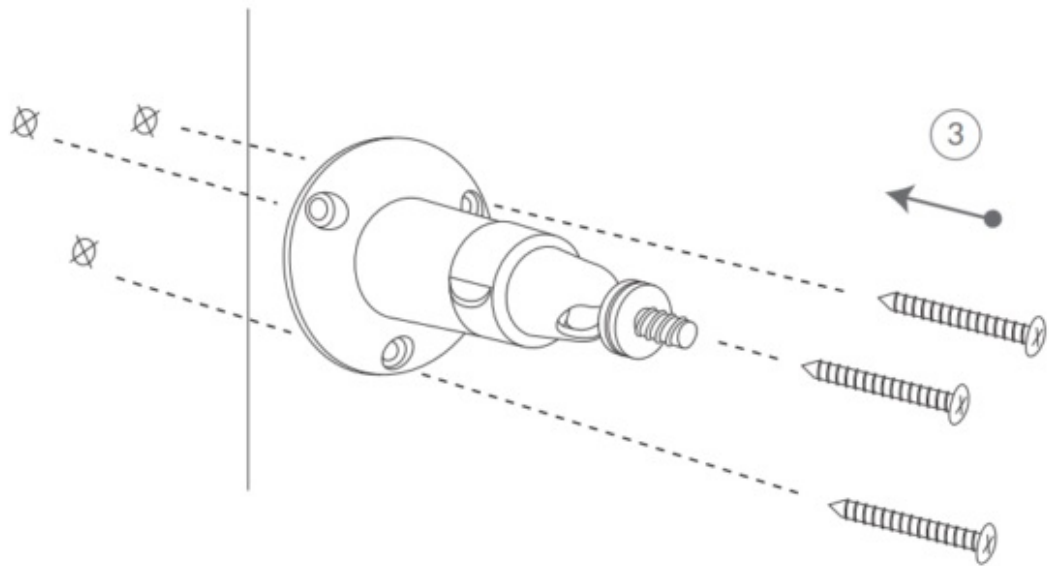

Step 2:

1. Use the provided drilling template to mark the position of holes on your wall. Use a drill bit ($15/64"$, 6mm) to drill three holes.
2. Install anchors to fix the screws.
3. Install the Threaded Bracket on your wall with the screws provided.

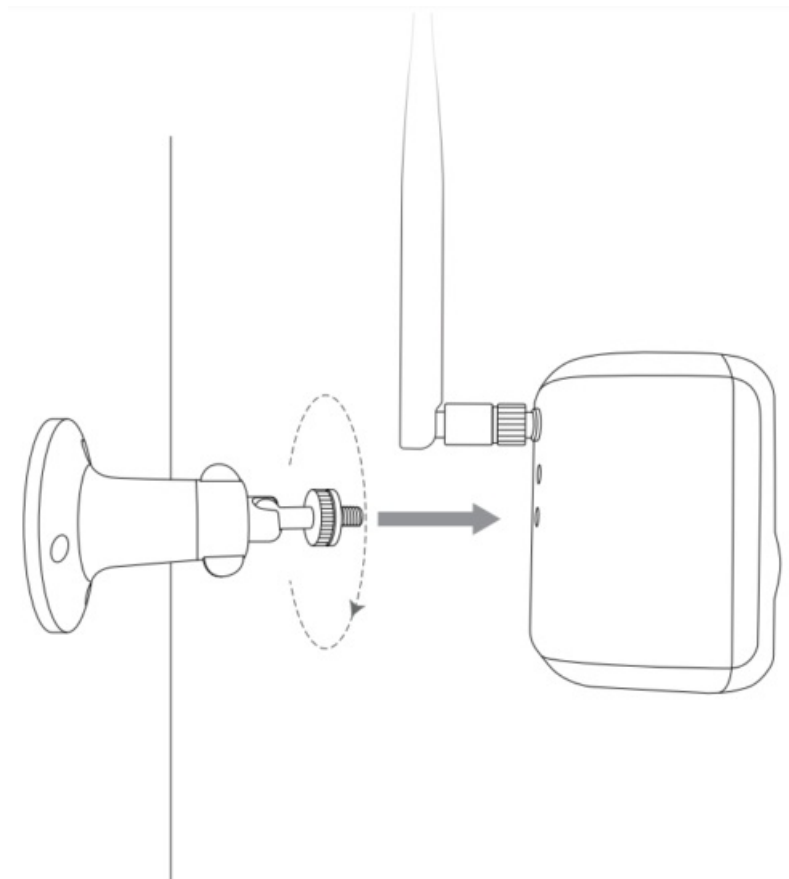

Step 3: Align the screw hole on the back of the camera with the bracket screw, and then turn it clockwise to tighten it.

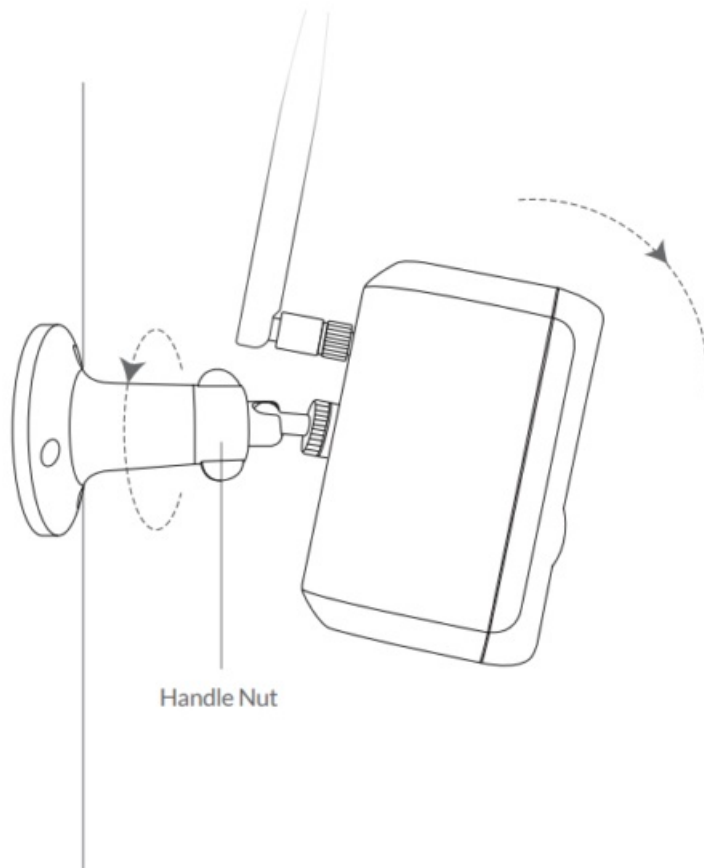

Step 4: Rotate the handle nut on the bracket counterclockwise to loosen and adjust the camera angle to cover the surveillance area. Finally, tighten the handle nut clockwise.

Bird Detection

Protect Plan provides optional advanced features for those with higher security needs, and each plan supports multiple devices. Bird Detection has undergone massive machine learning and uses AI intelligent recognition algorithms to inform you in real-time “what species of bird is coming”, automatically save the bird images/videos data for you, and also provide bird knowledge learning and so on.

FCC STATEMENT

This equipment has been tested and found to comply with the limits for a Class B digital device, pursuant to Part 15 of the FCC Rules. These limits are designed to provide reasonable protection against harmful interference when the equipment is operated in a commercial environment. This equipment generates uses and can radiate radio frequency energy and, if not installed and used in accordance with the instructions, may cause harmful interference to radio communications. The antennas used for this transmitter must be installed to provide a separation distance of at least 20 cm from all persons and must not be co-located for operating in conjunction with any other antenna or transmitter. FCC (USA) 15.9 prohibition against eavesdropping except for the operations of law enforcement officers conducted under lawful authority, no person shall use, either directly or indirectly, a device operated pursuant to the provision of this part for the purpose of overhearing or recording the private conversations of other unless such use is authorized by all of the parties engaging in the conversation. FCC ID 2AO8RNI-8201 **CE RED** This product can be used across EU member states.

CE RED Das Produkt kann in allen EU-Mitgliedstaaten verwendet werden.



https://my.netvue.com/?utm_source=product_manual

Continuous Video Recording Event Video Recording Human Detection Learn more on my.netvue.com

Feel free to contact us for additional help:



Netvue Web Client

https://my.netvue.com/?utm_source=product_manual



support@netvue.com

Netvue Forum



netvue.com/community



in-App Chat



@NetvueTech



1(866)749-0567

netvue.com

240 W Whitter Blvd Ste A, La Habra, CA 90631 © Netvue Inc.

SPECIFICATION

Product Specifications	Description
Supported Micro SD Card	Up to 128GB
Battery Charging Time	About 14 hours
Working Temperature	-10°C to 50°C (14°F to 122°F)
Working Relative Humidity	0-95%
Waterproof Rating	IP65
Wi-Fi Compatibility	2.4GHz
Antenna Installation	Attach clockwise to camera
Bird Detection Feature	Uses AI intelligent recognition algorithms to identify bird species and provide bird knowledge learning
Subscription Fee	Required for advanced features such as bird identification
Recommended Bird Food	Black sunflower seeds or sunflower hearts
Live Feed Viewing	Available on Netvue App
Compatibility with Devices	Compatible with smartphones, tablets, and PCs

FAQS

What is the maximum size of the micro SD card that can be inserted into the camera?

The camera supports up to a 128GB micro SD card.

can you recharge the sloar version from home electricity with a plug or USB? Also is there a subscription charge for anything and how much is it ?

Yes, you even do that before you set it up outside. The camera can be used anywhere if you take it out of the feeder.

How hard is this to clean?

You probably would just have to wipe the Camera Lens a couple times a year.

Will it hold up to rainy weather?

The camera may need to be wiped, but the roof gives the camera more protection and the camera is set back in the plastic food holder

What is the difference between birdfy lite and birdfy ai?

Birdfy Lite does not include bird identifying function, but you can subscribe it monthly on the app. Birdfy AI can permanently identifying the birds.

What kind of bird food would you suggest? I'm buying this for my Mom and would love to include some.

Black sunflower seeds.

What food should I prepare for the bird?

Many birds like sunflower hearts or black oil sunflower seeds. Some like peanuts (unsalted).

Will this support a bald eagle? TY!

Probably not if it's jumping on & off it regularly.

What app does it use for viewing?

the netvue app

Is micro sd card required for the unit to work?

no, it is not required to work. Only to save your videos.

Will this work for viewing hummingbirds?

Only if you have a hummingbird feeder in view of the camera. As far as I know, hummingbirds do not really eat seeds and the like.

some reported a subscription fee of \$50 a year, is that correct? also, can i install the app on a tablet or pc if they don't have a smartphone

The subscription is for the app to help name the types of birds. Yes you should be able to put the app on a tablet or computer.

Can we see birds eating at night?

This camera has a night vision function and thus you can see the birds clearly at night. But generally, birds don't eat at night, instead, you can see them resting.

Can you view live feed on an Alexa Echo Show 8?

Not sure of this, would need to read the owner's manual or maybe ask her.

Can you turn off notifications? We get dozens of birds all day and night. I'd prefer not to have constant notifications.

Yes you can in your settings.

Is this compatible with androids?

Yes. We use it with an Android Samsung tablet.



<https://manuals.plus/wp-content/uploads/2022/05/1639161711850sbv-1.mp4>

Documents / Resources

	netvue Birdfy Smart AI Bird Feeder Camera [pdf] User Guide Birdfy Smart AI Bird Feeder Camera, Birdfy Cam
---	--

References

- my.netvue.com

- netvue [Netvue Security Camera | Best Security Cameras and Bird Feeder Cameras – netvue](#)
- netvue [Netvue Security Camera | Best Security Cameras and Bird Feeder Cameras – netvue](#)