



netvue 4MP Solar Security Cameras

[Home](#) » [netvue](#) » netvue 4MP Solar Security Cameras 

netvue

Vigil Plus 3 User Manual



Contents

- [1 Warning](#)
- [2 What's in the Box](#)
- [3 Camera Structure](#)
- [4 Inserting MicroSD Card](#)
- [5 Battery Charging](#)
- [6 How to Turn on & off the Camera](#)
- [7 Read Before Installing](#)
- [8 Setting up With the Netvue App](#)
- [9 Installation](#)
- [10 Status Light](#)
- [11 Netvue Protect Plans](#)
- [12 Frequently Asked Questions](#)
- [13 Documents / Resources](#)
 - [13.1 References](#)
- [14 Related Posts](#)

Warning

NOTE: This equipment has been tested and found to comply with the limits for a Class B digital device, pursuant to part 15 of the FCC Rules. These limits are designed to provide reasonable protection against harmful interference in a residential installation. This equipment generates uses and can radiate radio frequency energy and, if not installed and used in accordance with the instructions, may cause harmful interference to radio communications. However, there is no guarantee that interference will not occur in a particular installation. If this equipment does cause harmful interference to radio or television reception, which can be determined by turning the equipment off and on, the user is encouraged to try to correct the interference by one or more of the following measures:

- Reorient or relocate the receiving antenna.
- Increase the separation between the equipment and receiver.
- Connect the equipment into an outlet on a circuit different from that to which thereceiver is connected.
- Consult the dealer or an experienced radio/TV technician for help.

The antennas used for this transmitter must be installed to provide a separation distance of at least 20 cm from all persons and must not be co-located for operating in conjunction with any other antenna or transmitter.

FCC (USA) 15.9 prohibition against eavesdropping except for the operations of law enforcement officers conducted under lawful authority, no person shall use, either directly or indirectly, a device operated pursuant to the provision of this part for the purpose of overhearing or recording the private conversations of other unless such use is authorized by all of the parties engaging in the conversation. Changes or modifications not expressly approved by the party responsible for compliance could void the user's authority to operate the equipment.

FCC ID: 2AO8RNI-5133

CE RED

This product can be used across EU member states.

What's in the Box

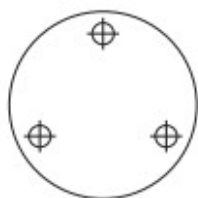

Drilling template



USB charging cable



Mounting screws



Anchors



Quick Guide



Mounting bracket



Ejector pin



Vigil Plus 3 Cam

Camera Structure

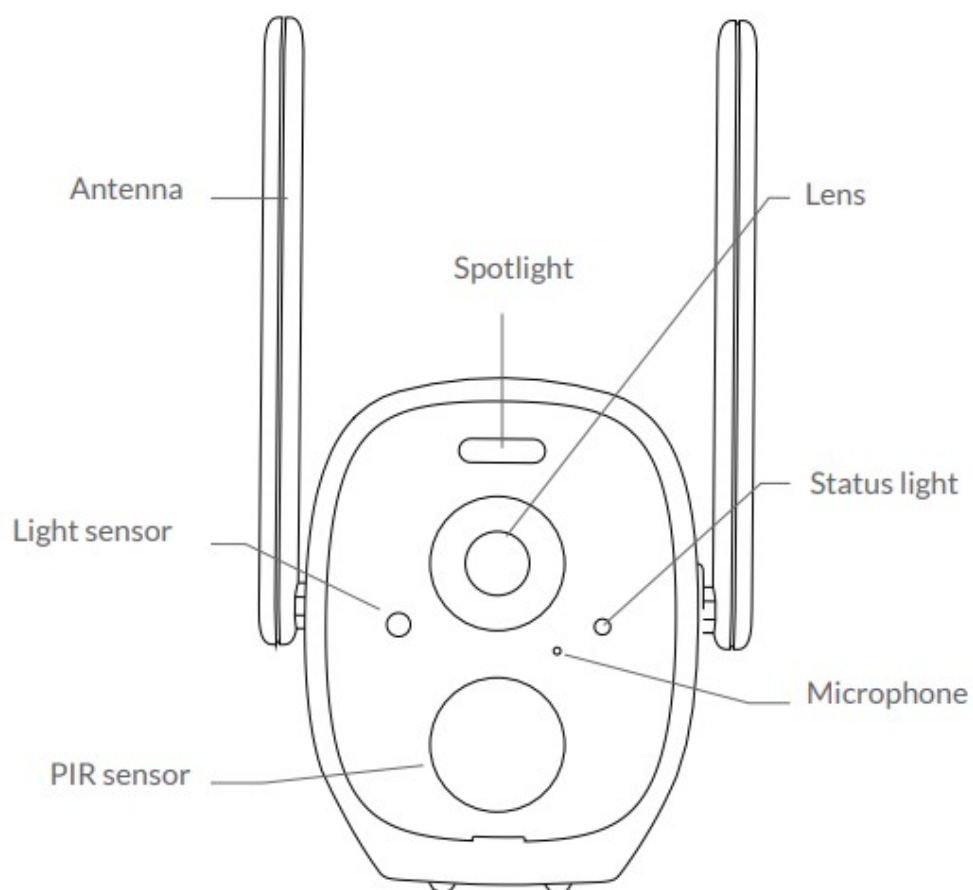

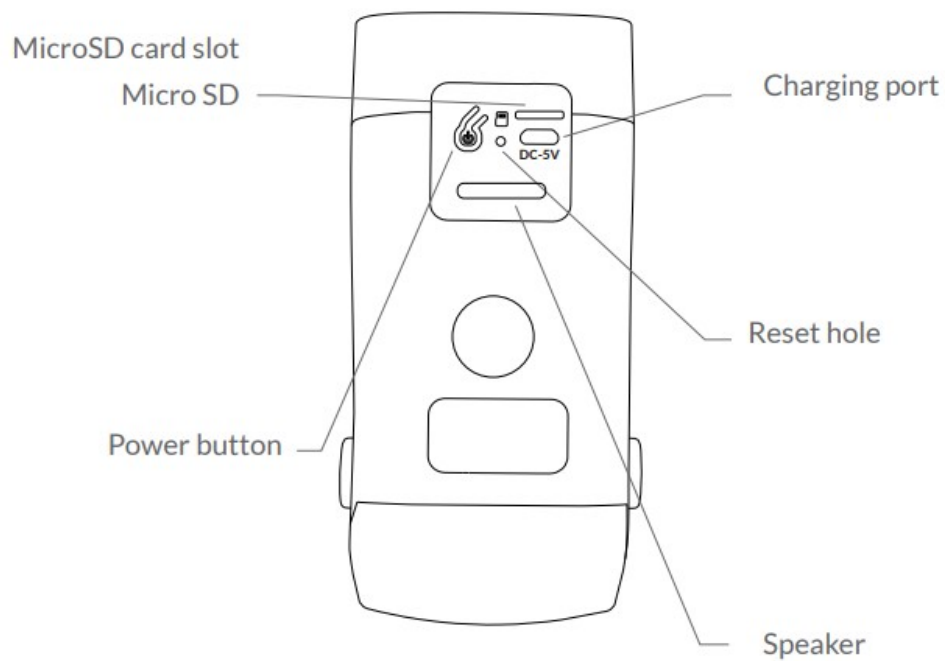

Inserting MicroSD Card

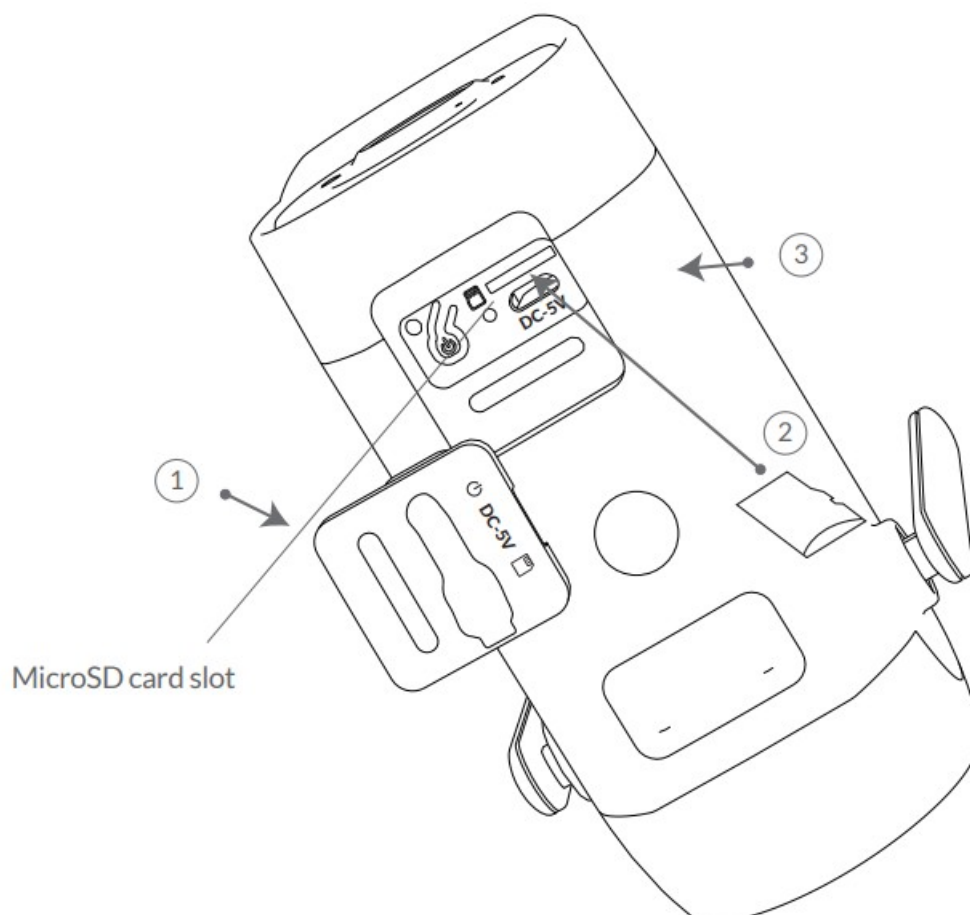

Vigil Plus 3 comes with a built-in card slot which supports Class 10 microSD cards with capacities of up to 128GB.

Step 1: Open the cover.

Step 2: Insert the MicroSD card. Make sure it is properly positioned with the label facing upward.

Step 3: Finally, replace the cover.

Battery Charging

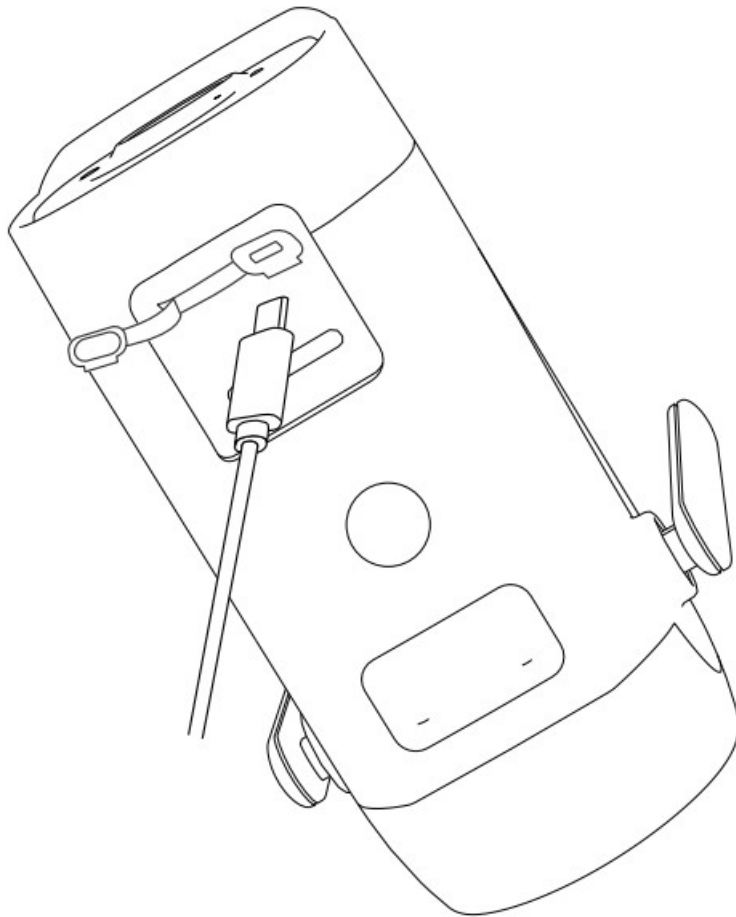

The camera does not come fully charged due to safety regulations. Before using it for the first time, please charge it for 14 hours with the charging cable inside the box.

Status light is solid yellow: charging

Status light is solid green: fully charged

How to Turn on & off the Camera

To turn on the camera:

Press and hold the power button for 3 seconds. Once the camera is on, you'll notice that the status light on the front of the camera will be solid blue.

To enter the WiFi configuration mode, simply double-click the power button after you hear the prompt tone.

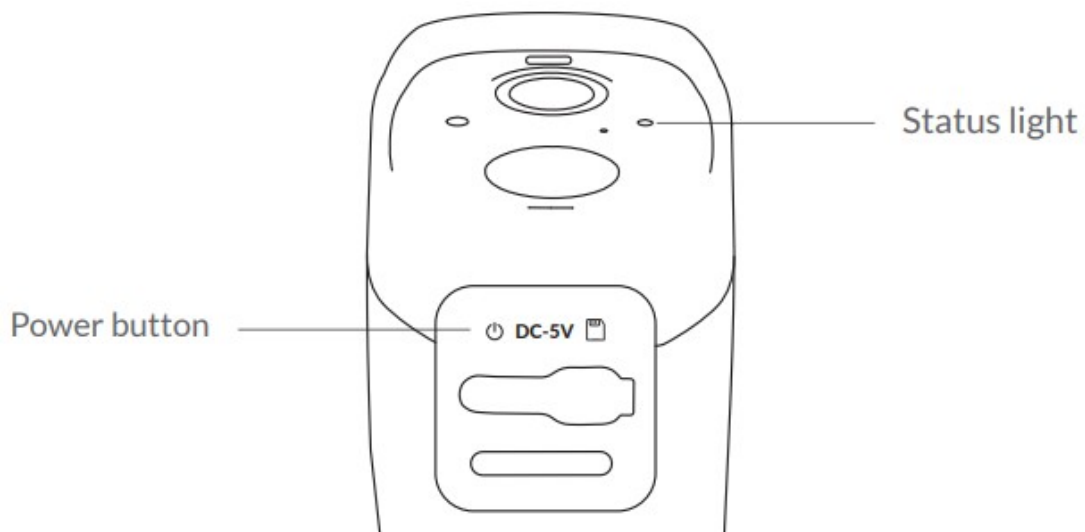

To turn off the camera:

Press and hold the power button for 3 seconds. Once the camera is off, the status light will go off.

Read Before Installing

1. Keep Vigil Plus 3 and all accessories out of the reach of children and pets.
2. Make sure the camera is fully charged (DC5V / 1.5A).
3. Working temperature: -10°C to 50°C (14°F to 122°F) Working relative humidity: 0-95%
4. Please do not expose the camera lens to direct sunlight.

Note:

1. Vigil Plus 3 only works with 2.4GHz Wi-Fi.
2. Strong lights may interfere with the device's ability to scan QR codes.
3. Avoid placing the device behind furniture or near a microwave oven. Please try to keep it in the range of your WiFi signal.

Setting up With the Netvue App



https://download.netvue.com/?product=vigil_plus_3

Please download the Netvue App from the App Store or Google Play and follow the in-app instructions to complete the set-up process.

Installation

Before installing the camera, please ensure that Vigil Plus 3 has been successfully added to your account in the Netvue app and is currently streaming video without any issues.

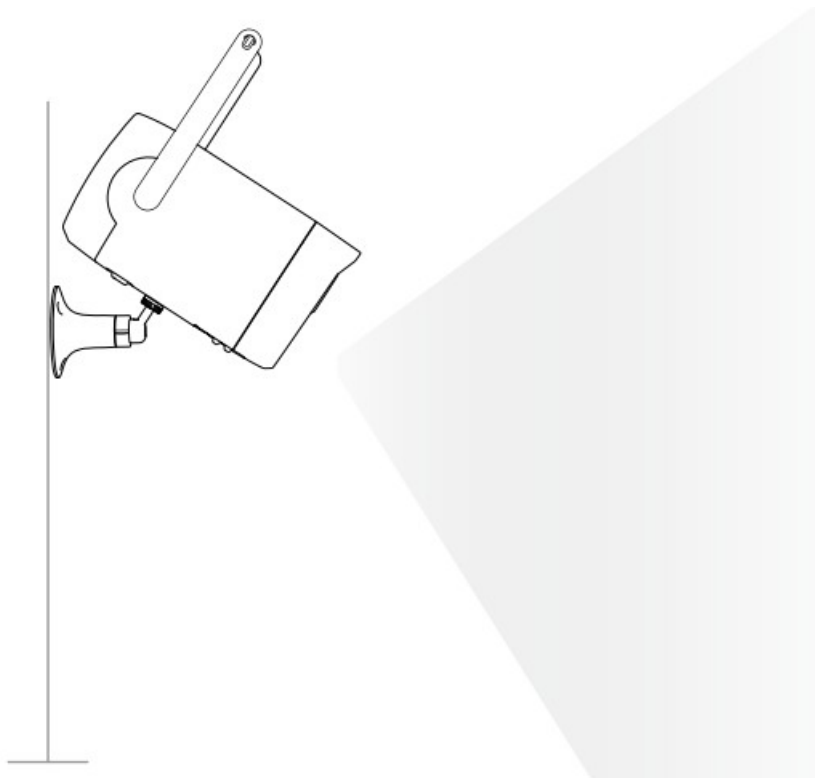

Step 1:

Select a suitable installation spot.

Be sure to choose a location where the camera's view won't be obstructed and ensure that it is within range of your WiFi network's coverage.

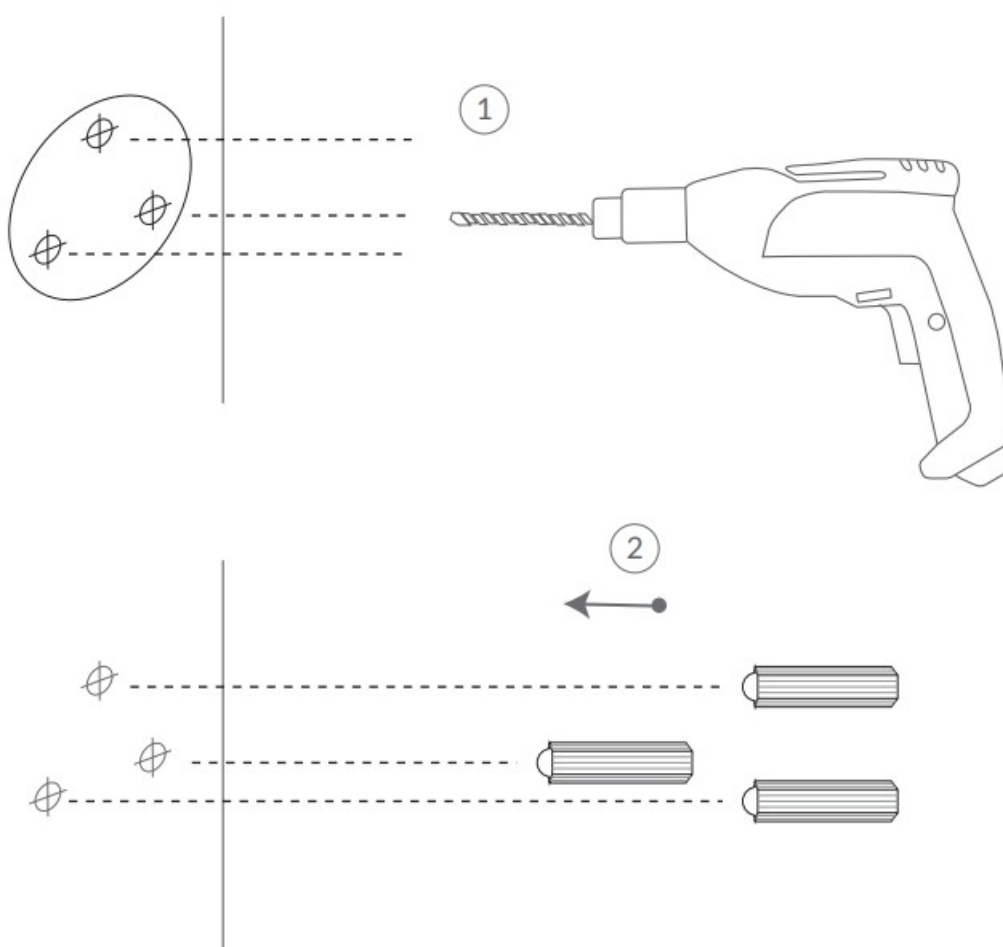

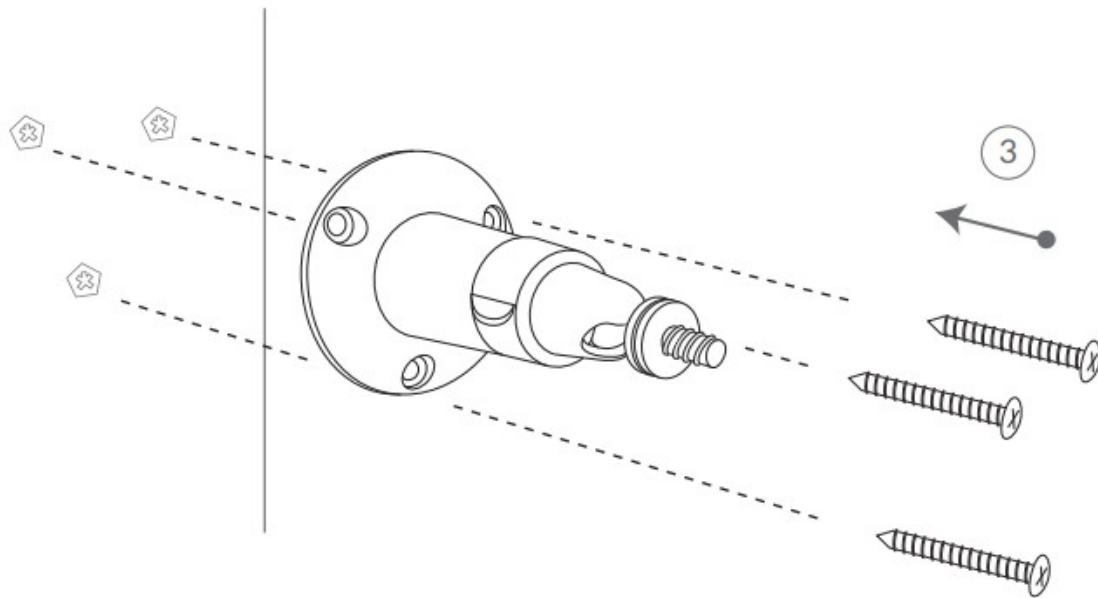

Step 2:

1. Use the provided drilling template to mark the position of the holes on your wall. Use an electric drill ($15/64"$, 6mm) to drill three holes at the marked positions.
2. Drive the provided plastic anchors into the holes. Skip this step if you are mounting on wood.
3. Attach the mounting bracket to your wall using the screws provided.

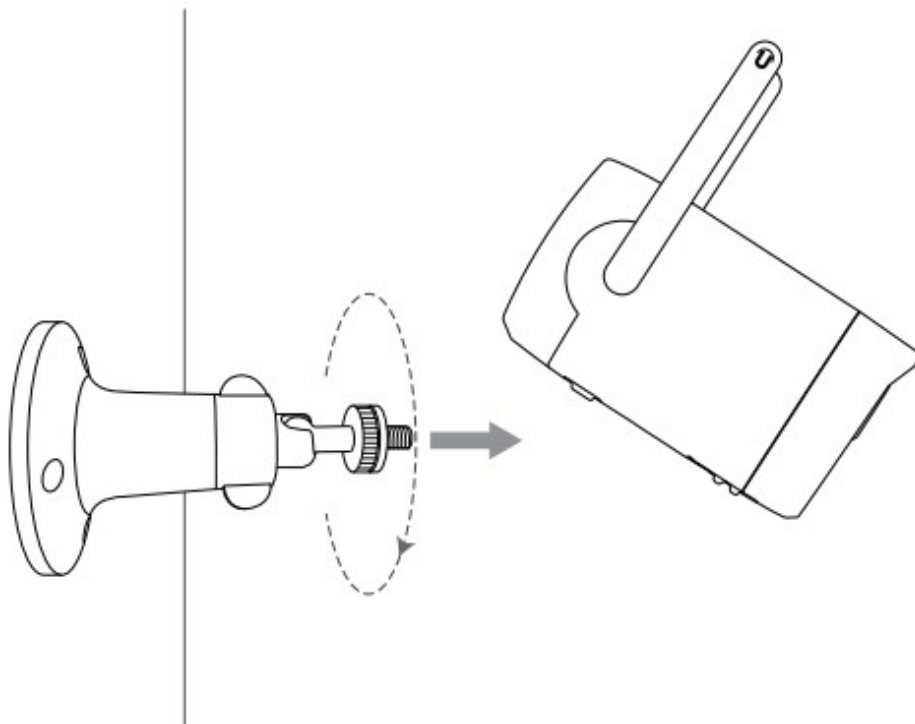

Step 3:

Align the screw hole on the back of the camera with the bracket screw.
Screw the camera onto the mounting bracket.

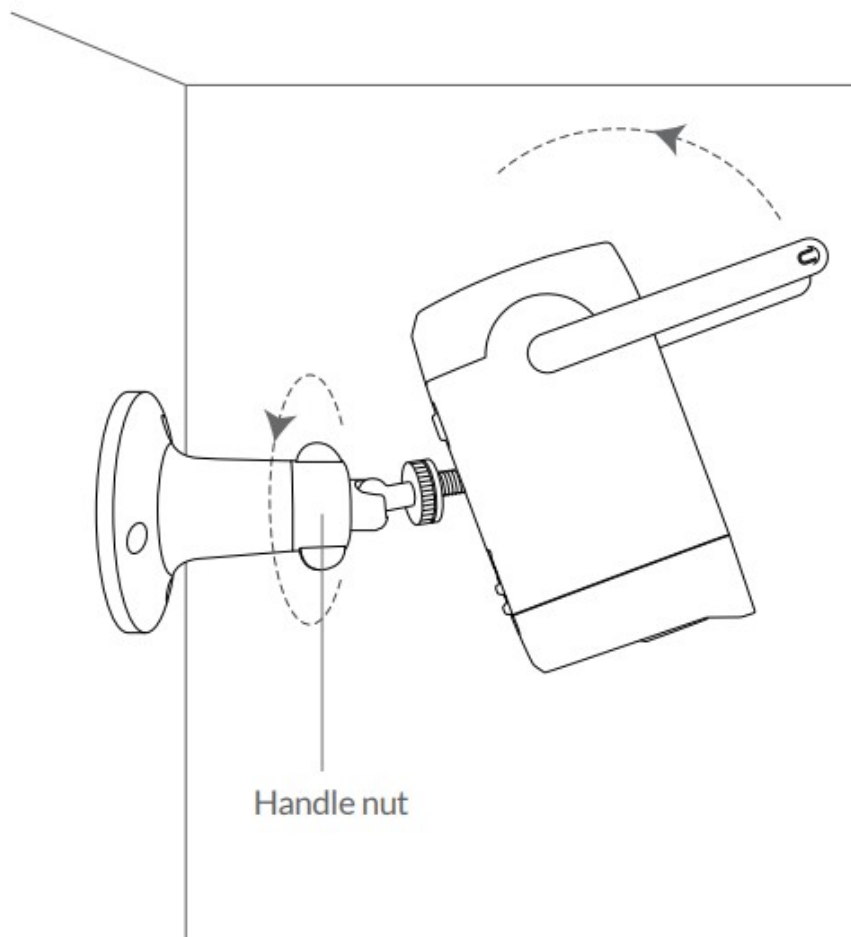

Step 4:

Rotate the handle nut on the bracket counterclockwise to loosen it. Adjust the camera angle to cover the desired surveillance area.

Then, tighten the handle nut by rotating it clockwise.

Status Light

This camera uses status light to communicate.

Status Light	Description
None	Offline
Solid blue	Online
Solid yellow	Charging
Solid green	Fully charged

Netvue Protect Plans

Netvue Protect Plans provide advanced features for those with additional security demands. Each plan supports multiple devices.



https://my.netvue.com/?utm_source=product_manual

Continuous Video Recording

Event Video Recording

Human Detection

Learn more on my.netvue.com

Frequently Asked Questions

Q1: Will the camera emit red lights when the night vision mode is activated?

A1: The camera is equipped with built-in infrared lamp beads that may emit some dim red lights when the night vision mode is activated. However, the image quality will remain clear even in environments with no ambient light.

Q2: What are the requirements for Wi-Fi?

A2: Please use a 2.4GHz wireless network. The device does not support the 5GHz wireless network. Meanwhile, please set the Wi-Fi authentication method to WPA2-PSK or other lower level of security method. A password is required.

Q3: What is the recommended distance between the camera and the router?

A3: Based on our testing, the WiFi connection distance can typically reach up to 220 meters in an open area. However, the actual distance may vary depending on the strength of the WiFi signal and the surrounding environment. If the camera's connection signal is weak or unstable, we recommend placing the camera as close to the router as possible to ensure a stable connection.

Q4: What should I do if the device malfunctions?

A4: Try restarting it by long-pressing the power button for 3 seconds. If there is no response, you can try removing the rubber plug located at the bottom of the camera and press the reboot hole with a pointed object to restart the camera.

Feel free to contact us for additional help:



https://my.netvue.com/?utm_source=product_manual

Netvue Web Client

netvue



support@netvue.com



Netvue Forum



In-App Chat



@NetvueTech



1(866)749-0567

netvue.com

240 W Whitter Blvd Ste A, La Habra, CA 90631

© Netvue Inc.

Documents / Resources

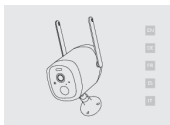

netvue
Vigil Plus 3 User Manual

[netvue 4MP Solar Security Cameras](#) [pdf]

B0CJJJKJXNZ, B0CD29VJCG, B0CD2C1P7D, 4MP, Solar Security Cameras, Security Cameras, Cameras

References

- my.netvue.com
- [netvue Bird Feeder Camera | Baby Monitor and Home Security Camera – netvue](#)