



[Home](#) » [NETUM](#) » **NETUM Q700 PDA Mobile Computer And Data Collector User Manual** 

Contents [[hide](#)]

- [1 NETUM Q700 PDA Mobile Computer And Data Collector](#)
- [2 Main interface](#)
- [3 Setup](#)
- [4 Warehouse](#)
- [5 Take stock](#)
- [6 Documentation](#)
- [7 Frequently Asked Questions](#)
- [8 Documents / Resources](#)
 - [8.1 References](#)



NETUM Q700 PDA Mobile Computer And Data Collector



Main interface

Click on the APP icon IEMS to enter the main menu

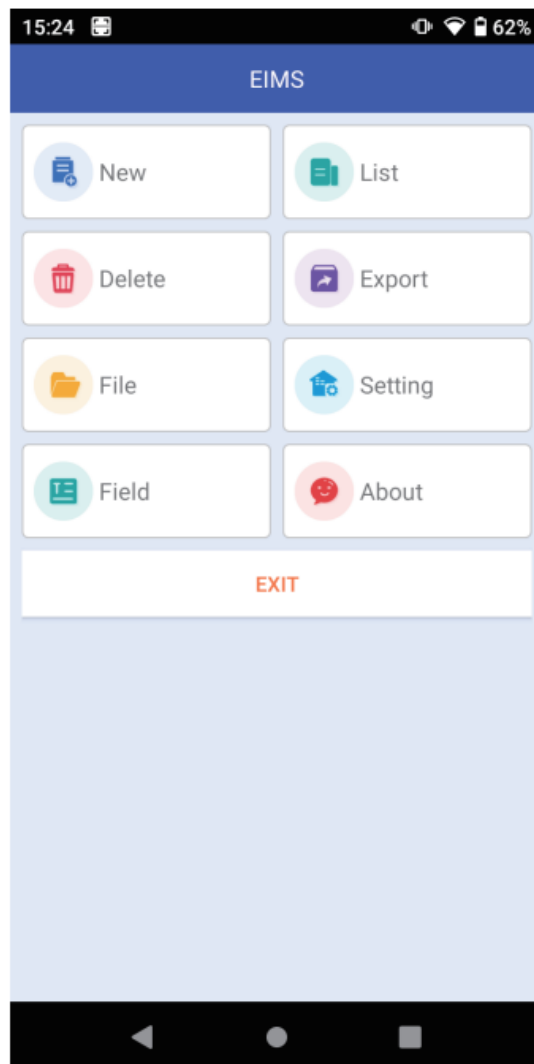

Setup

Inventory setup

Entering the inventory settings page

1. Auto Increment: Automatically add an entry during inventory
2. Allow decimals: Inventory screen numbers can be decimals.
3. Unique control: do not scan the same barcode repeatedly.
4. Export Header: The title of the exported data display.
5. Barcode in quotes: Export data with barcodes in quotes.
6. Delimiter: Export data separator settings.
7. Date Format: The date format style of the inventory interface is set.

15:24 62%

< Inventory mgt sets

Auto Increment ☒

Allow Decimals ☐

Unique Control ☐

Export Header ☐

Barcode with "" ☐

Soft Keyboard ☒

COMM_Anal ☐

File Type ☒ Excel ☐ Txt ☐ Csv

Delimiter ,

Date Format
yyyy-MM-dd HH:mm:ss ▼

Min Barcode Length

CONFIRM

Field settings

Click on the APP icon IEMS to enter the main menu

Export file field selection settings.

15:25 62%

< Export Field Settings

Field One	Barcode	▼
Field Two	Barcode	▼
Field Three	Quantity	▼
Field Four	Date	▼

CONFIRM

Warehouse

New warehouse

1. Enter the warehouse name to create the warehouse.

The screenshot shows a mobile application interface for creating a new warehouse. At the top, a status bar displays the time 15:26, a camera icon, and battery level 62%. Below this is a blue header bar with a back arrow and the title 'New Warehouse'. The main content area has a light blue background. It features a label 'Warehouse Name' followed by a text input field with the placeholder text 'Please enter warehouse name'. Below the input field are two buttons: a dark blue 'CONFIRM' button and a light blue 'CANCEL' button. The bottom of the screen shows the standard Android navigation bar with back, home, and recent apps icons.

2. Warehouse list

- Displays warehouse data. Click to access the inventory screen.

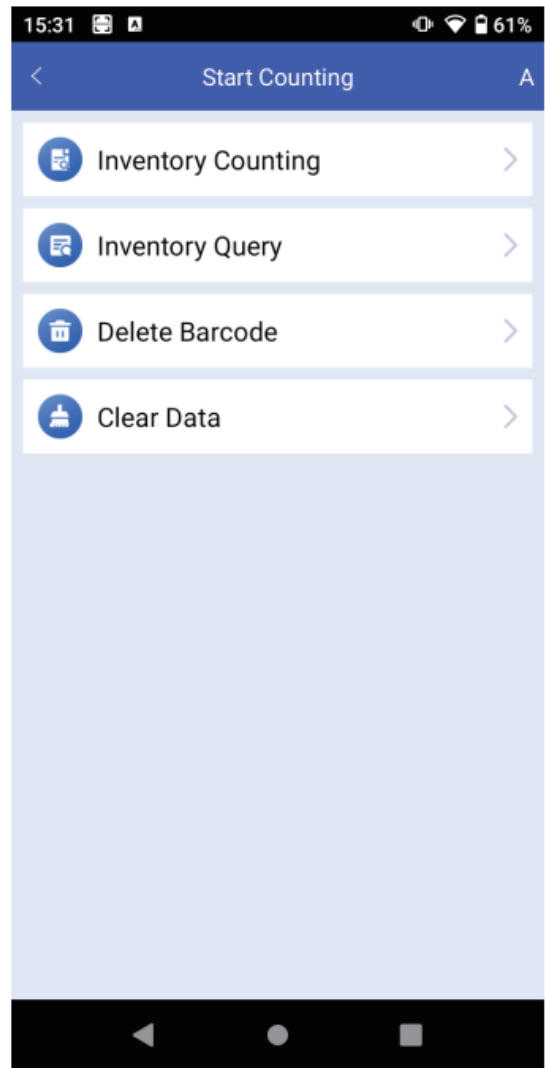
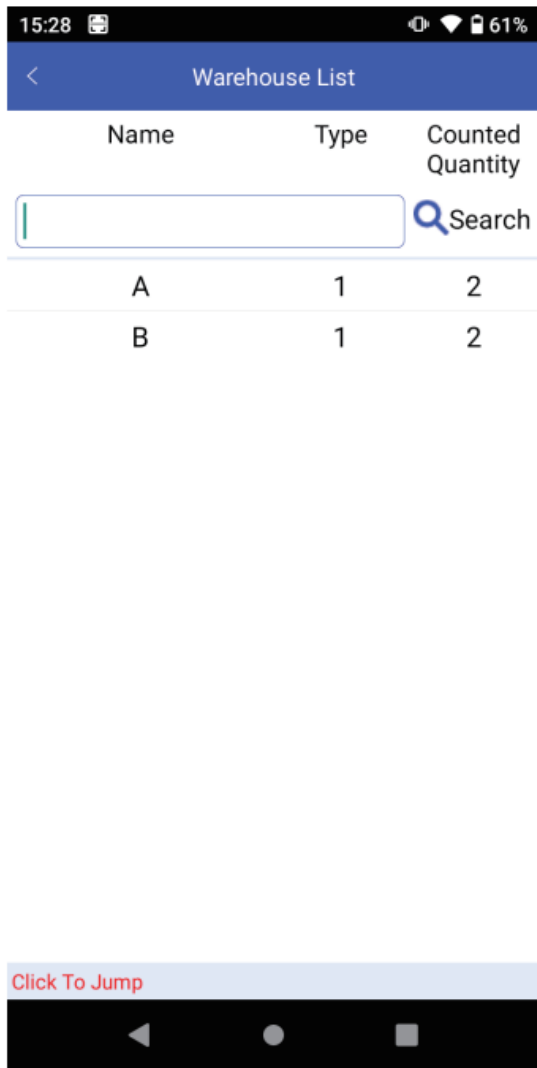

3. Delete warehouse

Click on the warehouse to select Delete.

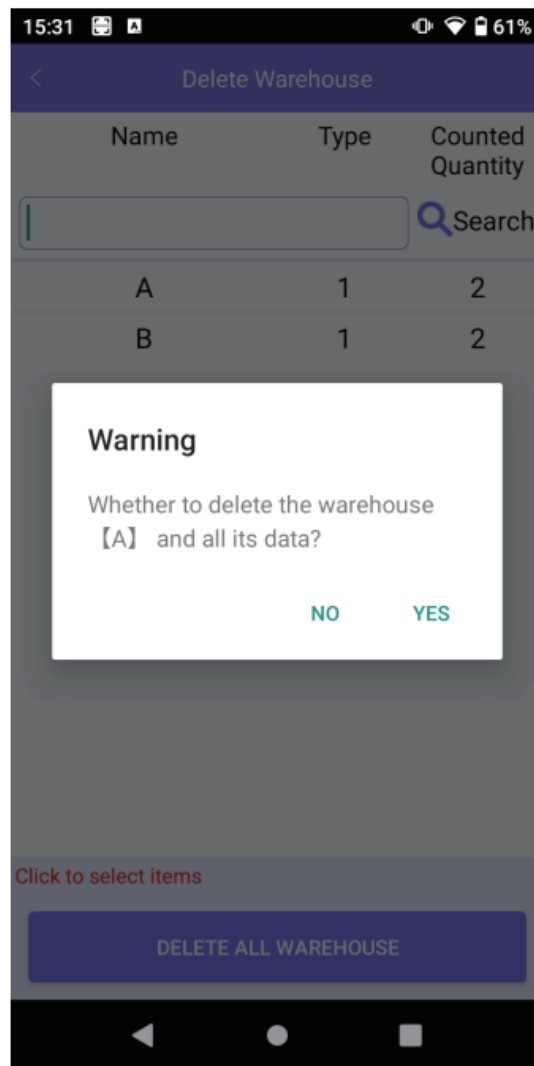

Take stock

1. Inventory

Scanning barcodes for inventory

ACCUM, data overlay.

COVER, data coverage.

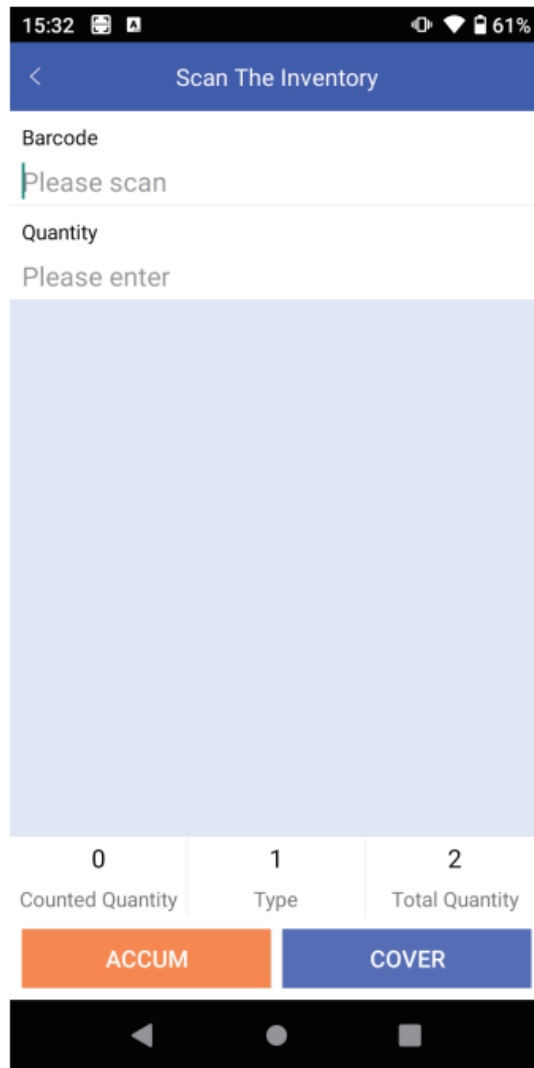

2. Inventory Query

All data can be viewed, or a single piece of data can be scanned.

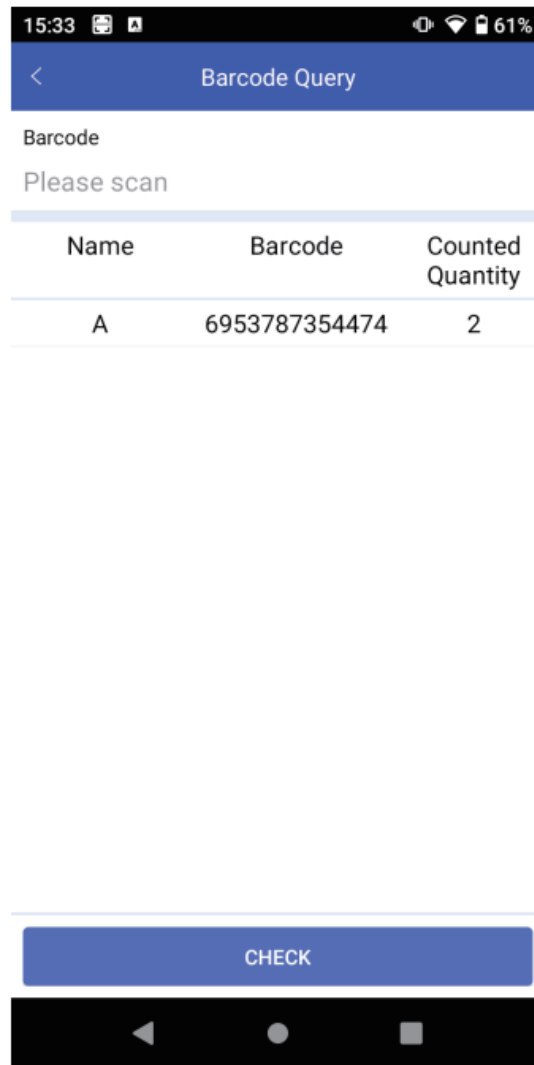

3. Delete data

Scan for deleted data

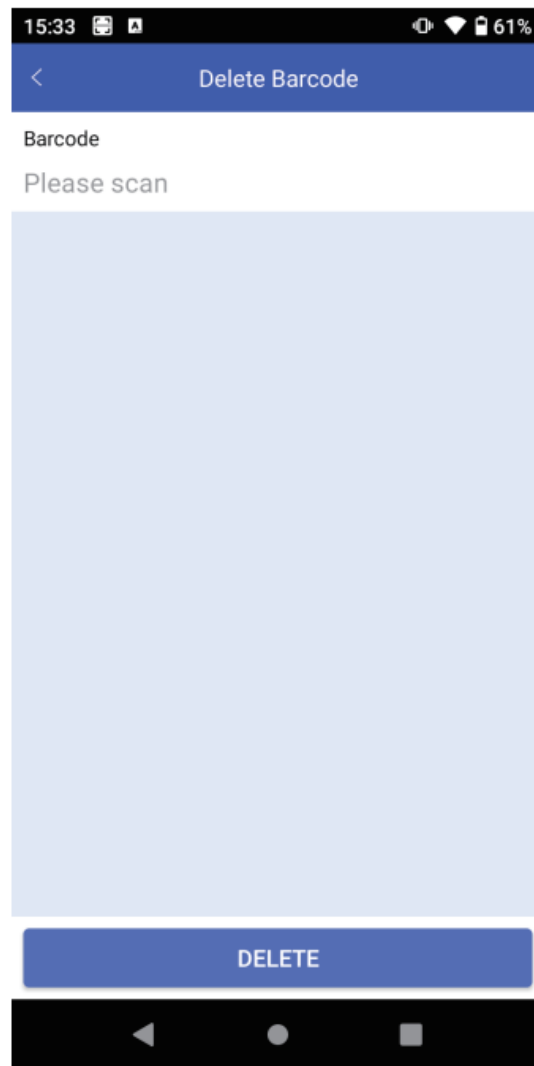

4. Data clearing

Scan for deleted data.

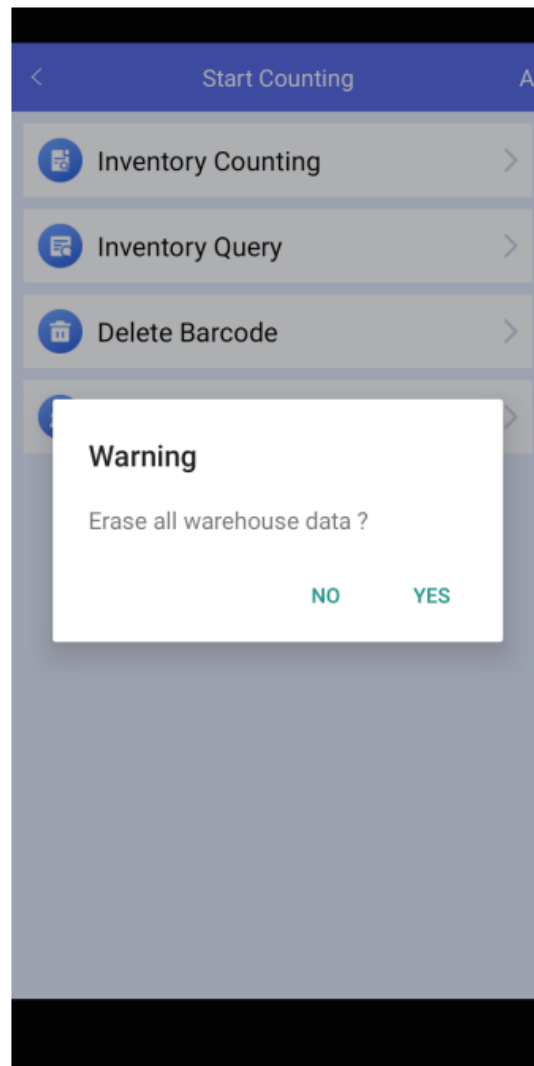

Documentation

1. Export excel file

Choose format of [Export excel by warehouse] or [Consolidate warehouse and export excel]

< Inventory mgt sets

Auto Increment ☒

Allow Decimals ☐

Unique Control ☐

Export Header ☐

Barcode with "" ☐

Soft Keyboard ☒

COMM_Anal ☐

File Type ☒ Excel ☐ Txt ☐ Csv

Delimiter ,

Date Format
yyyy-MM-dd HH:mm:ss ▼

Min Barcode Length |

CONFIRM

EIMS

New List

Delete Export

? export excel

select export format

☐ Export excel by warehouse

☐ Consolidate warehouse and export excel

CANCEL CONFIRM

2. Export txt file

Choose format of [Export txt by warehouse] or [Consolidate warehouse and export txt]

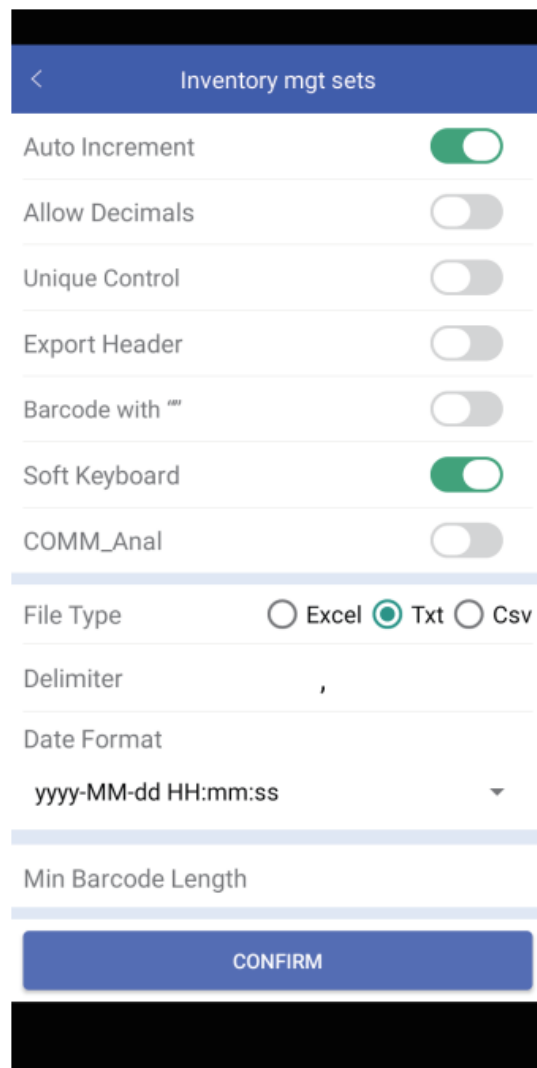
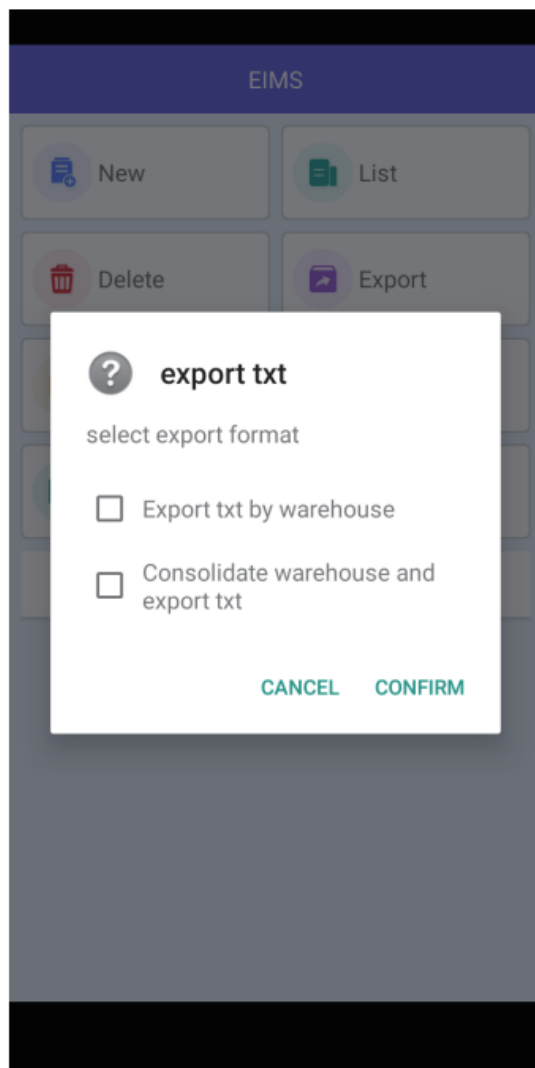

3. Exporting csv files

Choose format of [Export CSV by warehouse] or [Consolidate warehouse and export CSV]

Inventory mgt sets

Auto Increment ☒

Allow Decimals ☐

Unique Control ☐

Export Header ☐

Barcode with "" ☐

Soft Keyboard ☒

COMM_Anal ☐

File Type ☐ Excel ☐ Txt ☒ Csv

Delimiter ,

Date Format
yyyy-MM-dd HH:mm:ss

Min Barcode Length

CONFIRM

EIMS

New List Delete Export

? **export csv**

select export format

☐ Export csv by warehouse

☐ Consolidate warehouse and export csv

CANCEL CONFIRM

Frequently Asked Questions

- **Q: How do I add an entry automatically during inventory?**
 - A: You can enable the Auto Increment option in the inventory setup settings to add entries automatically.
- **Q: Can I export data with barcodes in quotes?**
 - A: Yes, you can choose the Barcode in quotes option in the export settings to export data with barcodes in quotes.

Documents / Resources

Website

☐ Save my name, email, and website in this browser for the next time I comment.

Post Comment

Search:

Search

[Manuals+](#) | [Upload](#) | [Deep Search](#) | [Privacy Policy](#) | [@manuals.plus](#) | [YouTube](#)

This website is an independent publication and is neither affiliated with nor endorsed by any of the trademark owners. The "Bluetooth®" word mark and logos are registered trademarks owned by Bluetooth SIG, Inc. The "Wi-Fi®" word mark and logos are registered trademarks owned by the Wi-Fi Alliance. Any use of these marks on this website does not imply any affiliation with or endorsement.