



NetComm NS-02 CloudMesh Satellite Access Point User Guide

[Home](#) » [NetComm](#) » NetComm NS-02 CloudMesh Satellite Access Point User Guide 



Contents

- [1 NS-02 CloudMesh Satellite Access Point](#)
- [2 WIRELESS BRIDGE](#)
- [3 WIRED MESH](#)
- [4 DOWNLOAD THE CLOUDMESH APP](#)
- [5 Documents / Resources](#)
 - [5.1 References](#)
- [6 Related Posts](#)

NS-02 CloudMesh Satellite Access Point

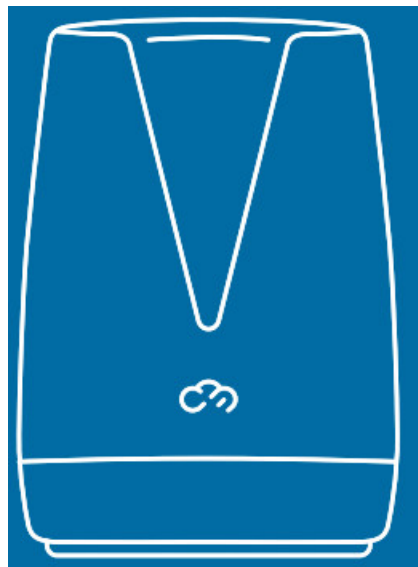

WHAT YOU WILL NEED

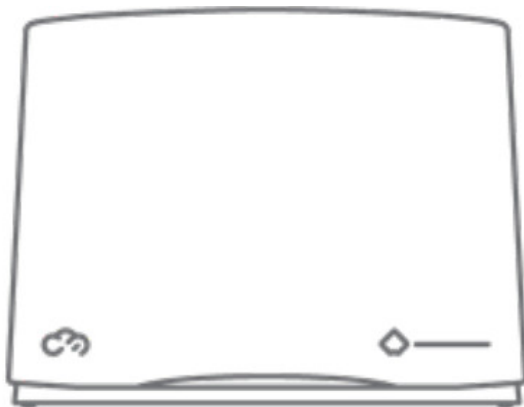

NetComm CloudMesh
Gateway connected
to the Internet

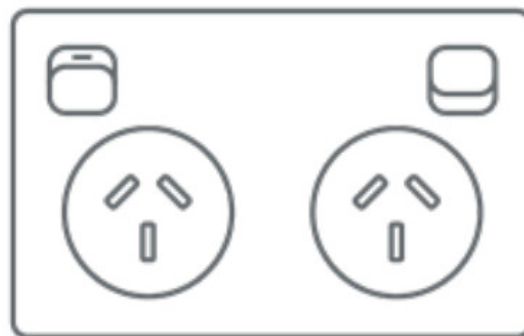

A power point near to where
you want to place
the CloudMesh Satellite



SOURCE CODE – GNU General Public License

This product includes software code that is subject to the GNU General Public License (“GPL”) or GNU Lesser General Public License (“LGPL”). This code is subject to the copyrights of one or more authors and is distributed without any warranty. A copy of this software can be obtained by contacting NetComm.

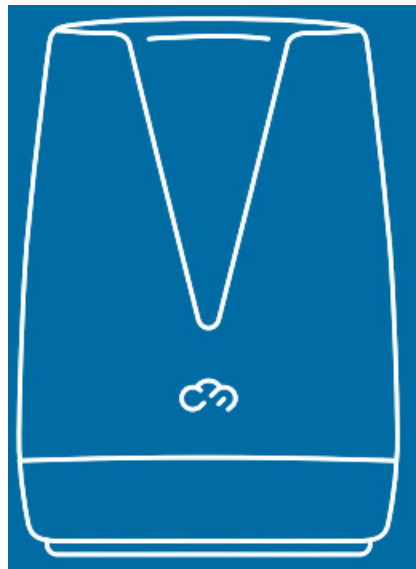

Your CloudMesh Satellite works best when it is placed in a central location to the area you want to cover. Ideally, it should be located no more than two rooms away from the CloudMesh Gateway.

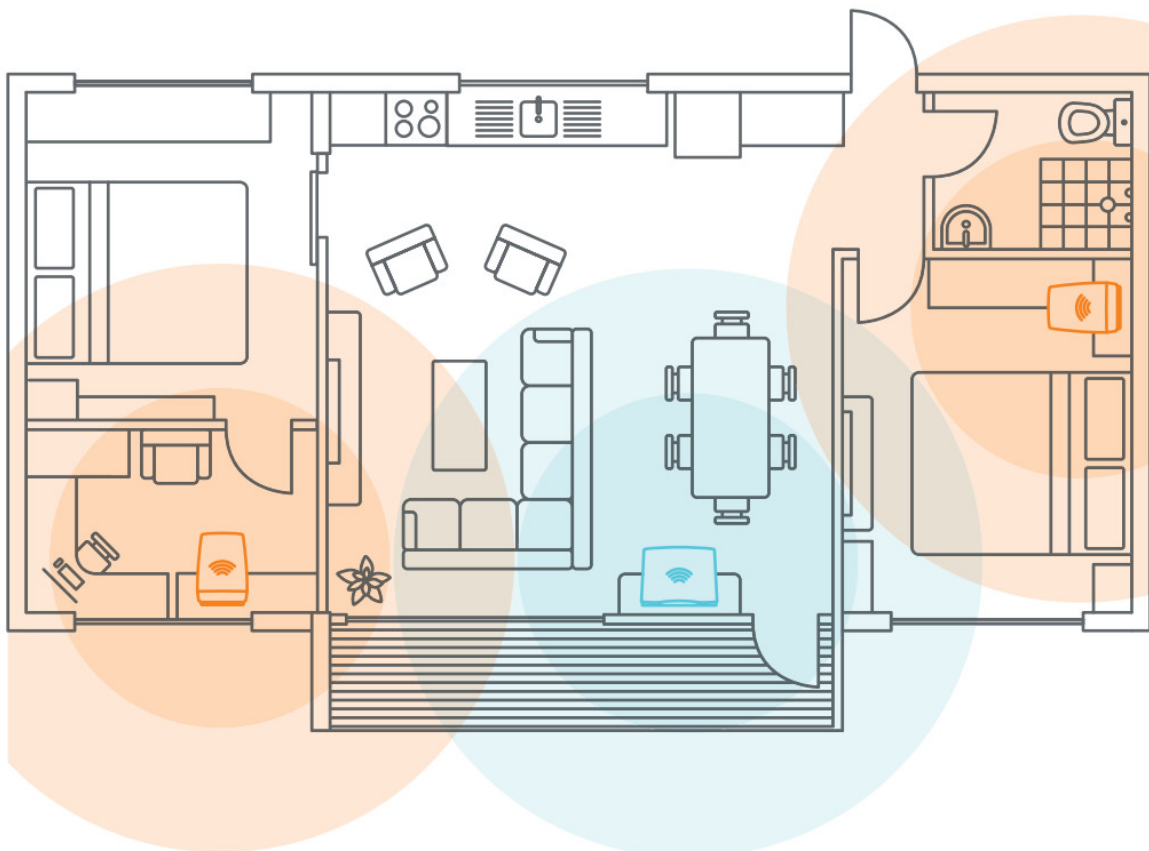

Before you begin, ensure your CloudMesh gateway is connected to the Internet.

1. Connect the Power Adapter to the CloudMesh Satellite. Ensure that the power switch is in the ON position.

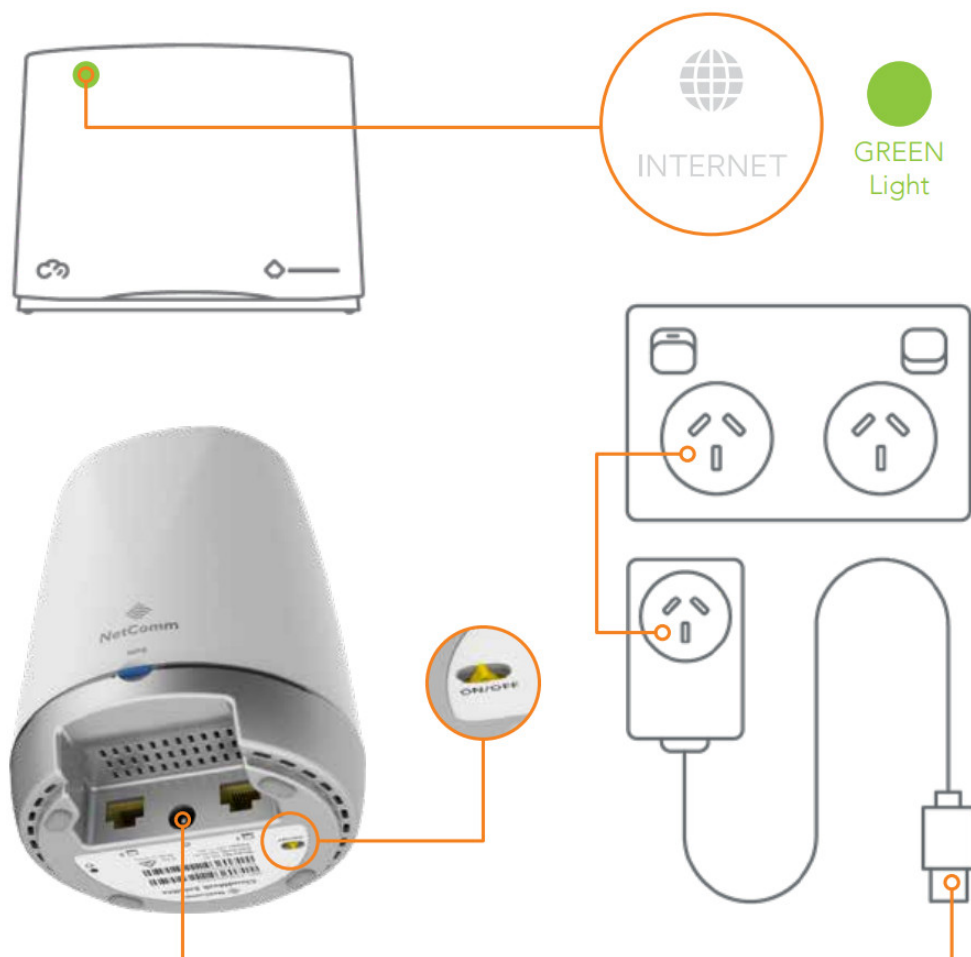

Wait ten minutes for the CloudMesh Satellite to initialize and then check the light status. A solid white or blue light means the satellite has been paired with the Gateway and is ready to use.









2. A solid red light means that the Satellite needs to be moved closer to the Gateway. If after ten minutes, the light is still flashing blue, follow the instructions on page 14.

Your CloudMesh Satellite light follows this sequence when first turned on:

	 Blinking green	P
	 Blinking blue	R

See the next page & page 14 for more instructions

When connected to the CloudMesh Gateway, the light shows the signal strength as follows:

	 Solid white	Good signal
	 Solid blue	Medium signal
	 Solid red	Poor signal
	 Blinking blue	No signal / too far from gateway / to mesh network

You can extend the range of your network using multiple CloudMesh Satellites. These can be wirelessly connected to the CloudMesh Gateway.

Once you have decided where to place the CloudMesh Satellites, always power up the Satellite closest to the CloudMesh Gateway first. Once you have confirmed this Satellite is working, then power up and connect the second CloudMesh Satellite.

The light may also show as:

	 Solid pink	Paired but no
	 Blinking purple	WPS pairing ε
	 Blinking pink	Pairing in prog
	 Solid green	Wired connec

Note: Refer to the User Guide for a full set of light statuses.

You can extend the range of your network using multiple CloudMesh Satellites. These can be wirelessly connected to the CloudMesh Gateway.

3. Once you have decided where to place the CloudMesh Satellites, always power up the Satellite closest to the CloudMesh Gateway first. Once you have confirmed this Satellite is working, then power up and connect the second CloudMesh Satellite.

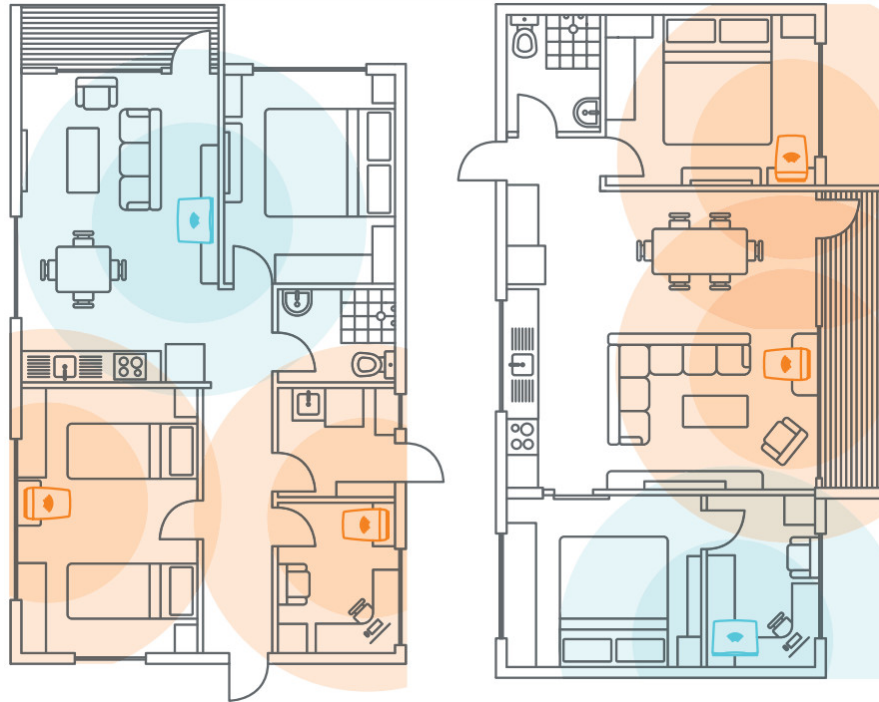

There are multiple ways your CloudMesh Satellites could connect to your CloudMesh Gateway to provide whole home wireless coverage.

If the CloudMesh Satellite light is still blinking blue after five minutes, you will need to pair it with the CloudMesh Gateway.

4. Place the CloudMesh Satellite next to your CloudMesh Gateway. Ensure that the CloudMesh Gateway is connected to the Internet.

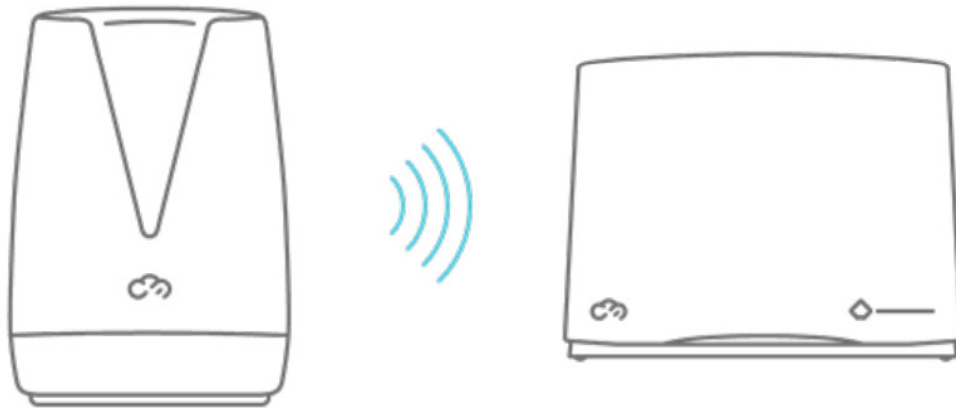

5. Press and release the WPS button on the Satellite, then press and release the WPS button on the Gateway within two minutes.

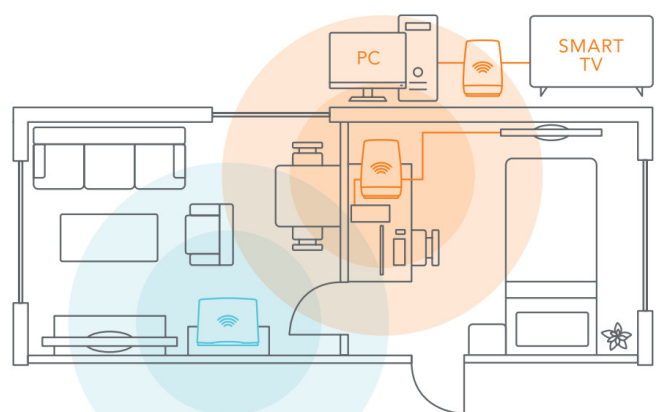

WIRELESS BRIDGE

The CloudMesh Satellite can provide Internet access to devices that are not wireless, such as desktop PCs or Smart TVs. Up to two devices may be connected in this way per CloudMesh Satellite, connecting at the back of the Satellite using the included yellow network cable.

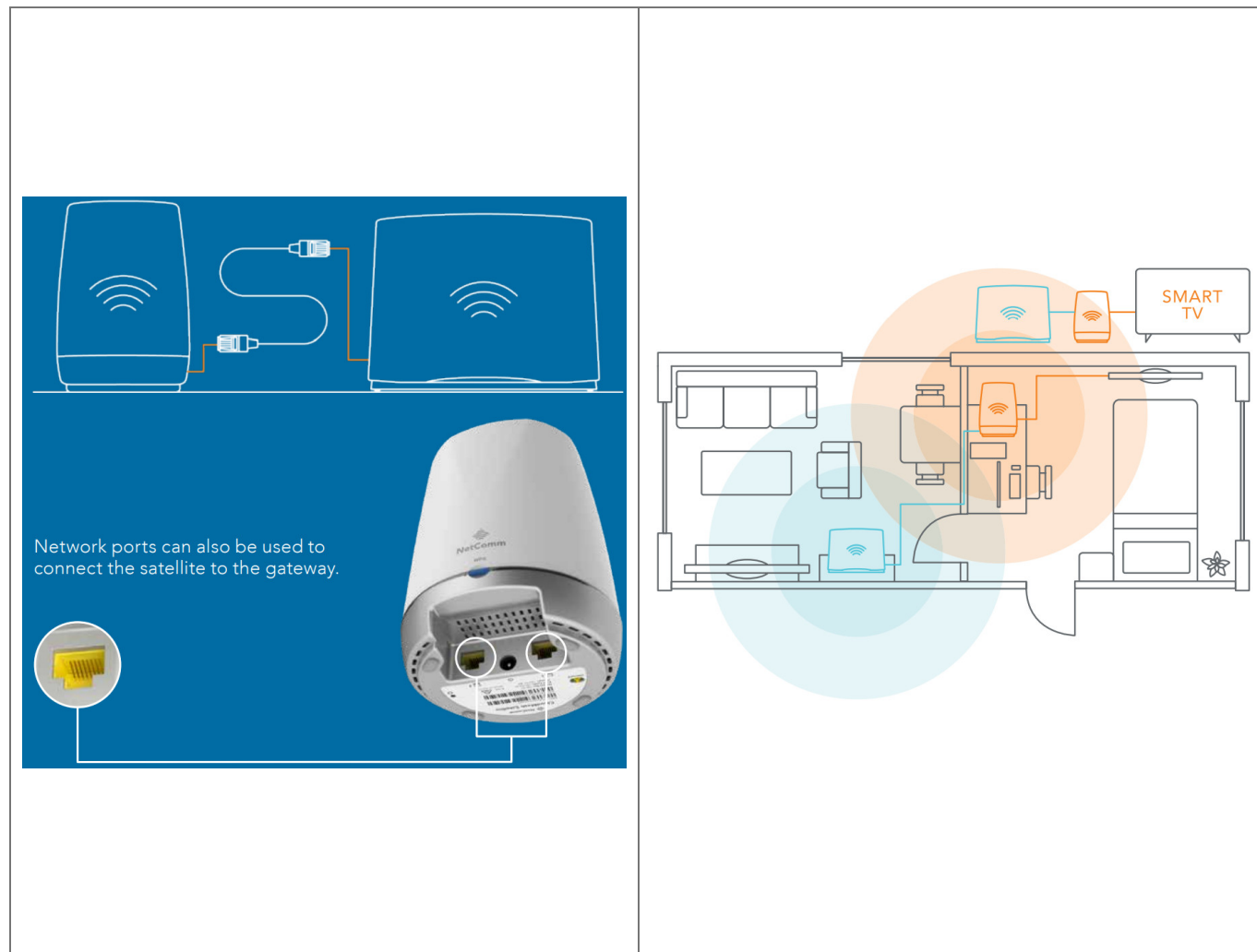

WIRED MESH

For the best possible wireless performance, you can connect the CloudMesh Satellite to your CloudMesh Gateway using an Ethernet cable. This allows you to extend the range of your network when the satellite is not in the wireless range of your gateway.



DOWNLOAD THE CLOUDMESH APP

Finding the best place for your CloudMesh Satellite is easy using the CloudMesh App.

- Satellite placement assistance
- WiFi Analytics
- WiFi Troubleshooting
- Setup does not require the App



<https://apps.apple.com/au/app/cloudmesh/id1510276711>

https://play.google.com/store/apps/details?id=com.casa_systems.cloudmesh&hl=en_AU

Get it on the App Store or Google Play.



NetComm Wireless Limited is part of Casa Systems, Inc.
Casa Systems, the future of NetComm

<p>ANZ HEAD OFFICE SYDNEY Casa Systems Inc. 18-20 Orion Road, Lane Cove NSW 2066, Sydney Australia +61 2 9424 2070 www.netcomm.com</p>	<p>CORPORATE HEADQUARTERS ANDOVER Casa Systems Inc. 100 Old River Road, Andover, MA 01810 USA +1 978 688 6706 www.casa-systems.com</p>
---	--

MPRT-00040-000 – NS-02 – Rev 4

Documents / Resources

	<p>NetComm NS-02 CloudMesh Satellite Access Point [pdf] User Guide NS-02, CloudMesh Satellite Access Point, Satellite Access Point, CloudMesh Satellite, Access Point, Satellite</p>
---	--

References

- [User Manual](#)

[Manuals+](#), [Privacy Policy](#)

This website is an independent publication and is neither affiliated with nor endorsed by any of the trademark owners. The "Bluetooth®" word mark and logos are registered trademarks owned by Bluetooth SIG, Inc. The "Wi-Fi®" word mark and logos are registered trademarks owned by the Wi-Fi Alliance. Any use of these marks on this website does not imply any affiliation with or endorsement.