



NET LED LIGHTING NET-49-09-02 Tilbrook LED Ceiling Light Installation Guide

[Home](#) » [NET LED LIGHTING](#) » **NET LED LIGHTING NET-49-09-02 Tilbrook LED Ceiling Light Installation Guide**



Distributed by
NET LED I. LIGHTING
LED CEILING LIGHT INSTALLATION GUIDE
TILBROOK LED CEILING LIGHT
NET-49-09-01 (8" LED Slim Circular)
NET-49-09-02 (12" LED Slim Circular)

KEY DATA



Light Source:	LED	LED
Size (mm)	ø220*1808MM	ø300*18.8mm
Power	24w	24w
Luminous Flux	2000lm	2000lm
Luminous Efficacy	83lm/w	83lm/w
Colour Temperature	3000k/4000k/5500k	3000k/4000k/5500k
Colour Rendering	>80 CRI	>80 CRI
Housing Material	Aluminum	Aluminum
Diffuser	PS	PS
IP Rating	IP20	IP20
Manufacturer	CREP	CREP

Driver
220-240V AC 50/60 Hz
Fig.1 Mains Input Termination

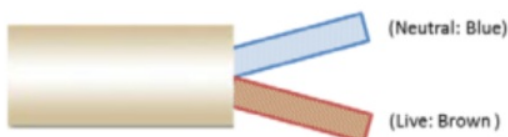

Luminaire
33-38V DC
Fig2. Twist Lock Connectors



UK
CA

CE



Contents

- [1 Safety Information](#)
- [2 PRODUCT DIMENSIONS](#)
- [3 Documents / Resources](#)
- [4 Related Posts](#)

Safety Information

- >All electrical work must be undertaken by a qualified contractor to ensure compliance with the latest edition B57671 and IEE/IET wiring regulations.
- > Before installing a Tilbrook LED Downlight or doing any maintenance, ensure the power supply is turned off at

the circuit breaker or fuse box.

> This product is designed for permanent connection to fixed wiring; the circuit should be protected with the appropriate MCB or fuse.

Environment

>Please DO NOT dispose of electrical items or packaging as unsorted waste. Use the recycling facilities provided by your local authorities.

Non-replaceable light source

>The light source of this luminaire is not replaceable. When the light source reaches its end of life the whole luminaire shall be replaced.

PRODUCT DIMENSIONS

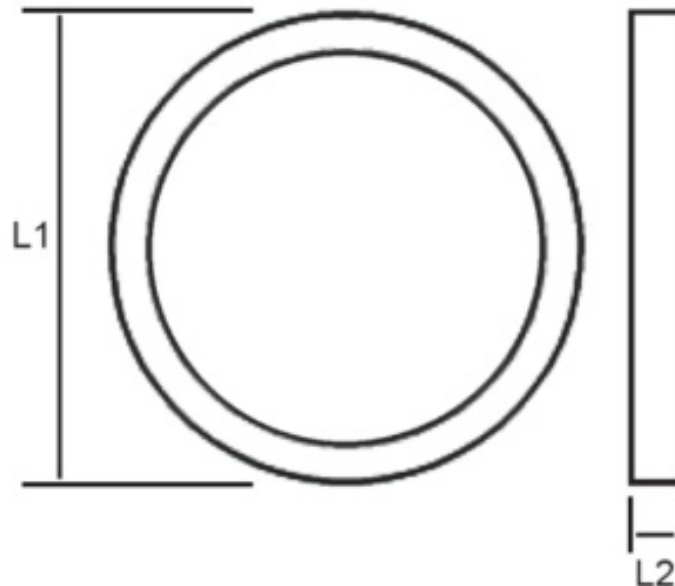

Size(mmmm)	LI	L2
0220×18.8mm	0220mm	18.8mm
0330×18.8mm	0330mm	18.8mm

Installation procedure: Carefully read the installation instructions and ensure the main supply is isolated before installation. Please follow the safety information overleaf before carrying out any installation. Please retain this leaflet for future reference. Important: When installing, leave a space of at least 1.2m between the LED Panel and any heating source/air conditioning unit.

LED Downlight Installation:

Non-replaceable control gear



Non-replaceable light source



Step 1: Secure the mounting bracket to the ceiling or wall with suitable fixing screws.

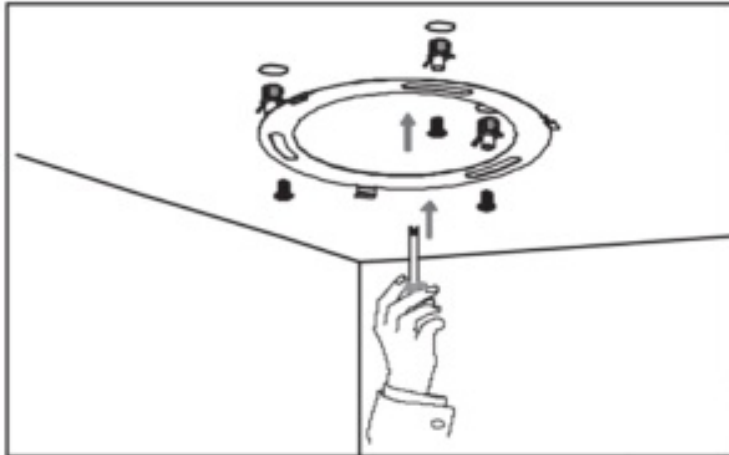

Step 2: Feed the mains AC wires into the driver connector block, connect the surface circular and driver

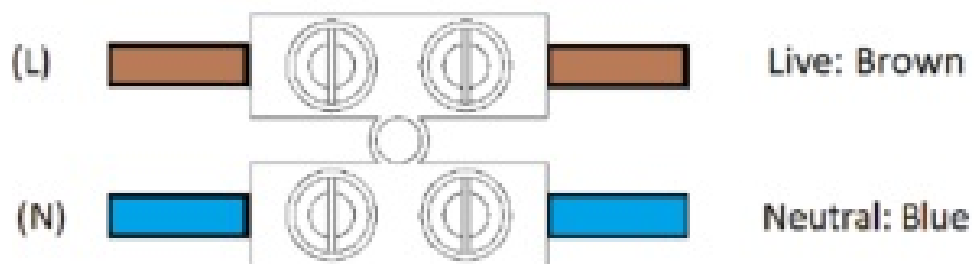
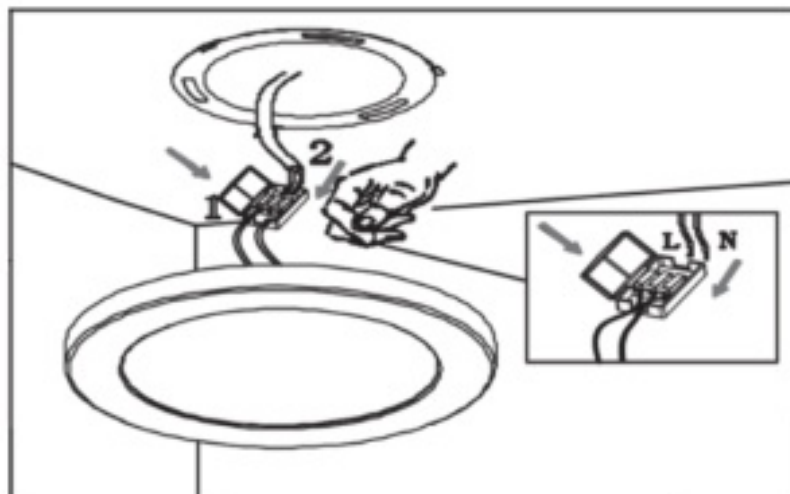

Step 3: Select the desired color temperature on the back of the downlight.

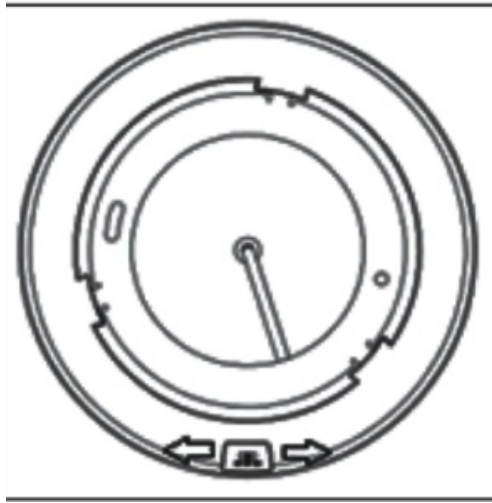

Step 4: Fit LED surface circular onto the mounting bracket

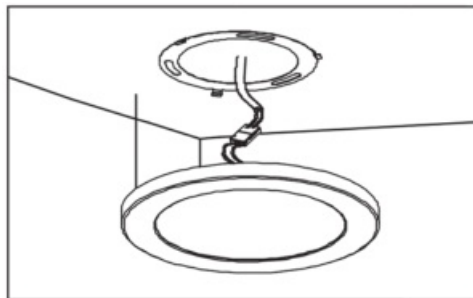

Step 5: Rotate the LED downlight on the mounting bracket to secure position.



3 Hour Emergency Kits

Led downlights are compatible with our 3 Hour Emergency Kits. Units maintain compatible downlights for 3 hours at no less than 3W.

Ensure like Emergency Test Record is completed monthly.

8" LED Slim Circular EM Part No.: NET-49-09-03

12" LED Slim Circular EM Part No.: NET-49-09-04



Part Number:			Installation Date:		contact the Installation Engineers: Tel.					
Luminaire Ref/Location			In case of difficulty,							
Full Recharge Erne 24 Hours			Duration 3 Noun				lamp Type • LEO			
ROUTINE TEST RECORD										
	Year 1		Year 2		Year 3		Year 4		Year 5	
Monthly Test	Signed	Date	Signed	Date	Signed	Date	Signed	Date	Signed	Date
Functional										
Functional										
Functional										
Functional										
Functional										
One Hour										
Functional										
Functional										
Functional										
Functional										
Functional										
Functional			—							
Three Hour										

Example of Emergency Test Record

Important Warranty Information

The Tri-colour Downlight has a 3-year warranty. The registrant must provide the product part number and date of manufacture, which can be found on the label attached to the luminaire housing



Certificate No. FS 571788



Certificate No. EMS 571787

NET LED Ltd. Buckingway Business Park
300 Anderson Road
Cambridge CB24 4UQ
sales@netled.co.uk
www.netled.co.uk

Technical Helpline: 01223 851 505
Email: support@netled.co.uk
www.netled.co.uk/downloads

Documents / Resources

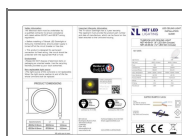

[NET LED LIGHTING NET-49-09-02 Tilbrook LED Ceiling Light](#) [pdf] Installation Guide
NET-49-09-01, NET-49-09-02, Tilbrook LED Ceiling Light

[Manuals+](#).