



Neomounts THINCLIENT-200 CPU Holder Instructions Manual

[Home](#) » [Neomounts](#) » Neomounts THINCLIENT-200 CPU Holder Instructions Manual 

Contents

- [1 Neomounts THINCLIENT-200 CPU Holder](#)
- [2 Introduction](#)
- [3 Dimensions Overview](#)
- [4 Tools and Measurement](#)
- [5 PARTS](#)
- [6 Assembling](#)
- [7 CAUTION](#)
- [8 User Support](#)
- [9 FAQ's](#)
- [10 Related Posts](#)

Neomounts[®]

Neomounts THINCLIENT-200 CPU Holder



Introduction

Solutions for small form factors, mini PCs, and thin clients – You can attach a small computer between a mount and the screen or directly to a monitor arm using NewStar Thin Client mounts. Because it is stored beneath the display and doesn't take up any important desk space, a thin client mount makes for a tidy and clean desk.

Service

Strong (sales) support from resellers, distribution partners, and the company itself is something that Neomounts values highly. We provide a 5-year warranty on all of our mounting options.

Dimensions Overview

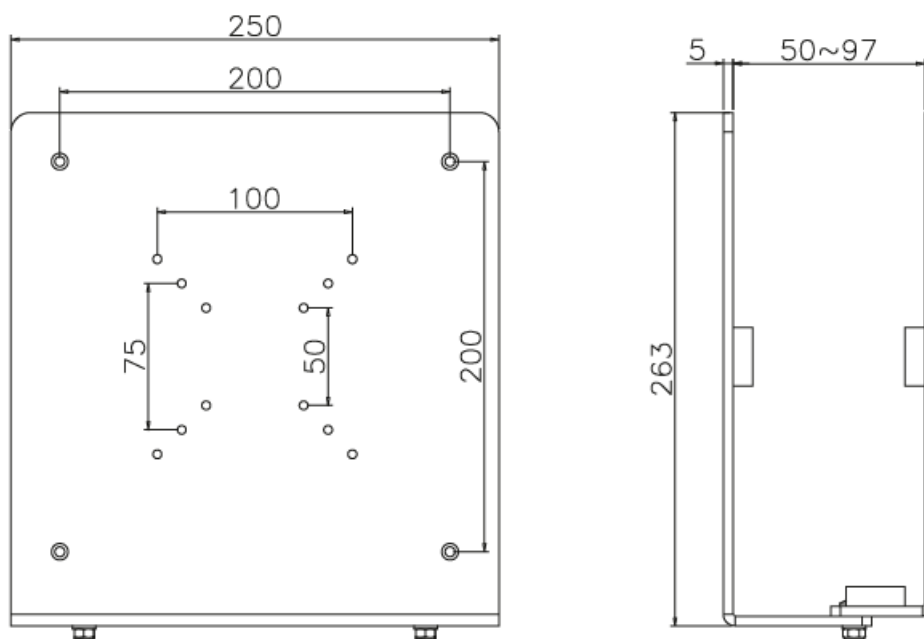

Tools and Measurement



50x50 -
200x200 mm



0-50 kg |
0-15,4 lbs



5-9,7 cm



Tool

PARTS

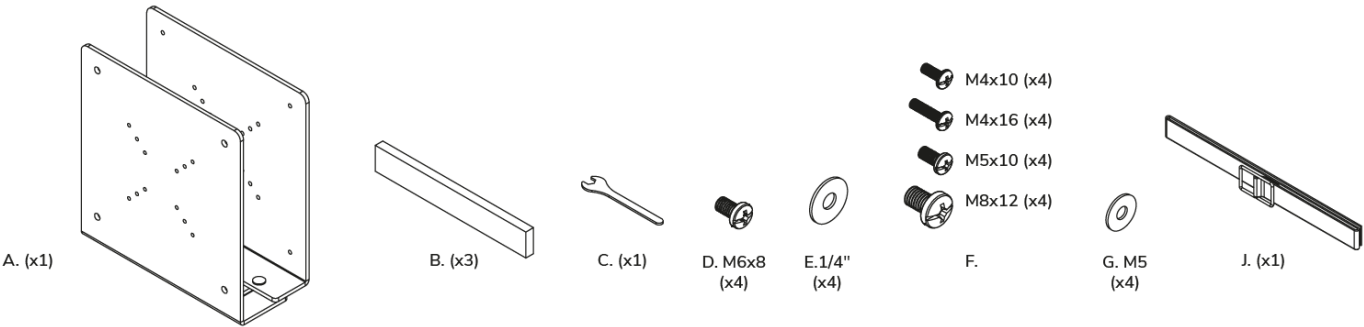

Assembling

STEP 1

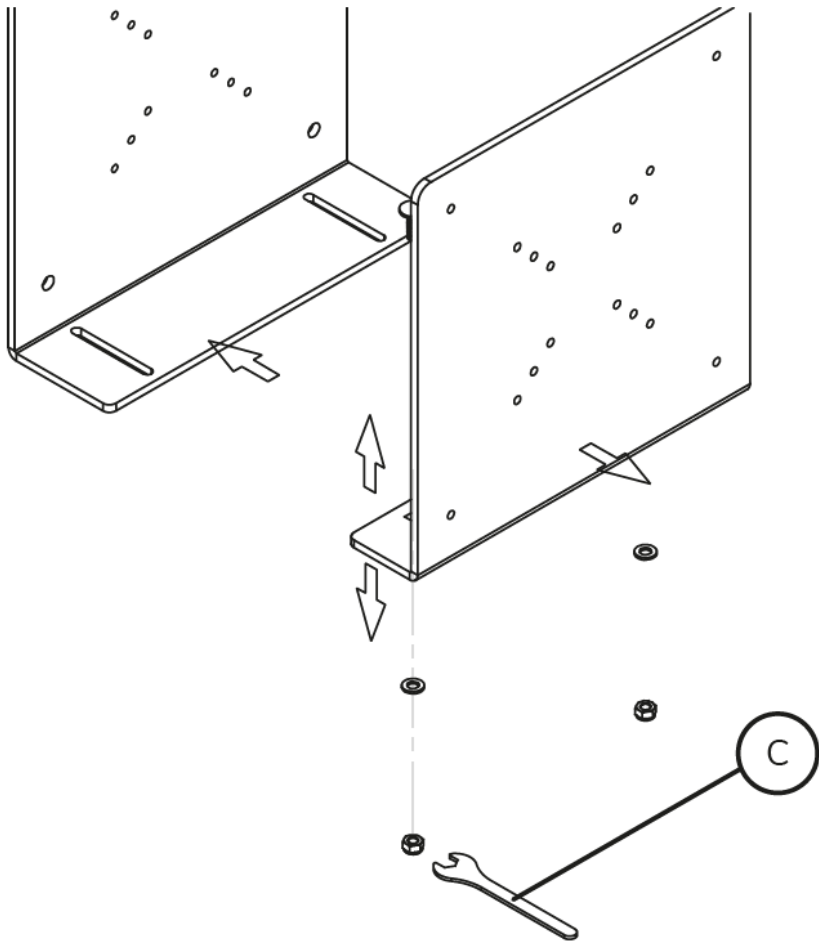

STEP 2

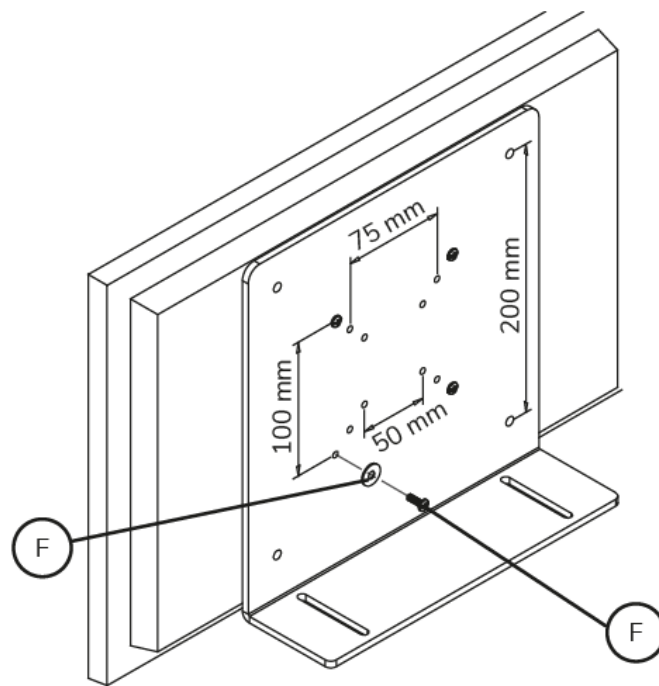

STEP 3

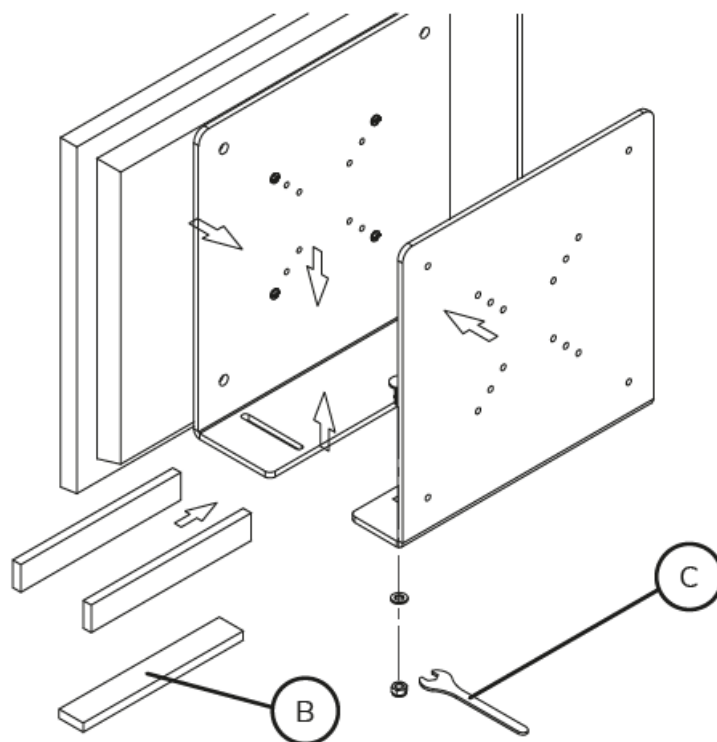

STEP 4

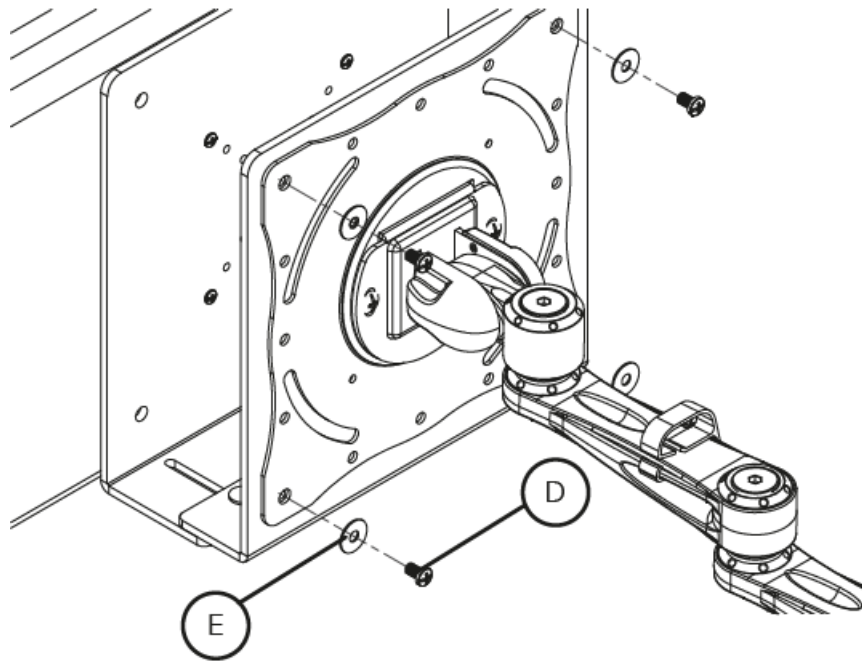

STEP 5

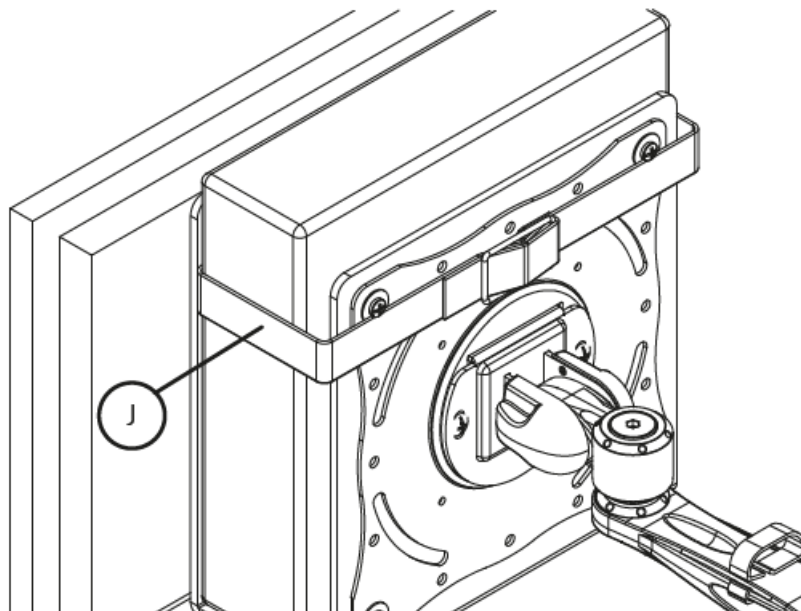

CAUTION

1. To ensure safety, please read this manual carefully before installation and follow the instructions. Store this manual in a secure place for future reference.
2. The manufacturer shall not be legally responsible for any equipment damage or personal injury caused by incorrect installation or operation other than that covered in this manual.
3. The mount is designed for easy installation and removal. The manufacturer shall not be liable for damage to equipment or personal injuries arising out of human factors or acts of nature, such as earthquakes or typhoons.
4. It is recommended that the mount be installed by qualified personnel only.
5. At least two persons are needed to install or remove the product to avoid the hazard of falling objects.
6. **Please carefully inspect the area where the mount is to be installed:**
 - Avoid places that are subject to high temperatures, humidity, or contact with water.
 - Do not install the product near air conditioning vents or areas with excess dust and fumes.

- Only install on vertical walls and avoid slanted surfaces.
 - Do not install in places subject to any shock or vibration.
 - Do not install in places subject to direct exposure to bright light, as it may cause eye fatigue when viewing the display panel.
7. Maintain sufficient space around the display to ensure adequate ventilation.
 8. To ensure a safe installation, first check the structure of the wall, ceiling, or floor and select a secure mounting location.
 9. The wall, ceiling, or floor should be strong enough to sustain a weight of at least four times the display and mount combined. The mounting location must be able to withstand earthquakes or other strong shocks.
 10. Do not modify any accessories or use broken parts. Contact your dealer with any questions.
 11. Tighten all screws (do not exert excessive force to avoid breaking the screw or damaging its thread).
 12. Drill holes and bolts will be left in the wall, ceiling, or floor once the display and bracket are removed. Stains may occur after extended use.
 13. Since the manufacturer has no way to control the wall, ceiling, or floor type and installation of the mount, the warranty of the product shall only cover the body of the mount. The warranty period of the product is 5 years.
 14. Please consult the English language manual for any dispute on conditions.

User Support

- **Address:** Neomounts Computer Products Europa B.V. | Wateringweg 62 | 2031 EJ Haarlem | The Netherlands |
- **Contact no.** +3 1(0)23-5478888
- **Support:** info@neomounts.com
- **Email:** www.neomounts.com

FAQ's

Is there mounting hardware included with the Neomounts THINCLIENT-200 holder?

Yes, all necessary mounting gear is included with the Neomounts THINCLIENT-200 holder for a simple installation.

Is it simple to reach the thin client ports and wires with the holder?

Yes, the holder is made to make it simple to access the thin client ports and wires for upgrades and maintenance.

What's the THINCLIENT-200 holder made of?

Durable steel was used to make the holder.

Which shade does the THINCLIENT-200 holder come in?

The black finish of the holder matches any workspace.

What serves as the THINCLIENT-200 CPU holder from Neomounts?

You may suspend a computer under your desk with Neomounts' THINCLIENT-200 CPU holder, easily saving room underneath. More dust may enter a PC that is resting on the floor, and it will also get in the way if the area under the desk needs to be cleaned.

Are Neomounts THINCLIENT-200 CPU holders required?

A Neomounts THINCLIENT-200 CPU holder has many uses and advantages, but it can also protect your computer if you have one mounted on your desk or workplace. A CPU that is placed on the floor is more likely to get dirt or hair. This is particularly valid when working with carpets.

Where should the THINCLIENT-200 CPU from Neomount be stored?

Ideally, you should have it on the desk. The airflow is crucial. Computers need breathing room to avoid overheating and failure. Because there is nowhere for the air to escape, placing a computer under a desk will encourage the air (and dust) to be sucked in.

What exactly does the phrase “CPU holder for Neomounts THINCLIENT-200” mean?

For improved concentration and productivity, everything must be spotless, especially the workstation. Our central processor unit (CPU) holders are therefore perfect for desktop PCs worldwide.

It is necessary to discuss a Neomounts THINCLIENT-200 CPU caddy.

A rolling caddy keeps a CPU stored beneath a desk to free up desktop space and make it simpler to access front and rear ports and connectors. Several CPUs (with widths ranging from 4.7 to 8.2 inches) are adaptable (11.9 to 20.9 cm) A powder-coated style made of solid metal harmonizes wonderfully with any décor.

Would a Neomounts THINCLIENT-200 CPU holder be useful, in your opinion?

It's crucial to provide your computer's Central Processor Unit (CPU) with efficient support. You can use a CPU holder, sometimes referred to as a CPU support, to hold your processor in place and safeguard the crucial electrical circuitry it contains. Under desks, these gadgets are commonly discovered. By doing this, you can prevent accidents like spills and bumps.

What are the two types of CPU holders for Neomounts THINCLIENT-200?

Neomounts THINCLIENT-200 CPU sockets are available in the Pin Grid Array (PGA) and the Land Grid Array, two popular designs (LGA). In contrast to LGA, which has a socket with pins that you position the processor on, PGA sets the processor's pins and the holes in the socket.

What serves as the THINCLIENT-200 CPU holder from Neomounts?

Your PC is kept away from the floor's surface and a little bit below the desktop by a CPU holder. Your Neomounts THINCLIENT-200 CPU will be better protected from spills and bumps if it is suspended above the ground. As opposed to if it were sitting on the ground, it will also operate and cool more effectively.

Download this PDF Link: [Neomounts THINCLIENT-200 CPU Holder Instructions Manual](#)