



Neomounts THINCLIENT-20 CPU Holder Instructions Manual

[Home](#) » [Neomounts](#) » Neomounts THINCLIENT-20 CPU Holder Instructions Manual 

Contents

- [1 Neomounts THINCLIENT-20 CPU Holder](#)
- [2 Dimensions Overview](#)
- [3 Tools and Measurement](#)
- [4 PARTS](#)
- [5 Assembling](#)
- [6 CAUTION](#)
- [7 User Support](#)
- [8 FAQ's](#)
- [9 Related Posts](#)

Neomounts®

Neomounts THINCLIENT-20 CPU Holder



Dimensions Overview

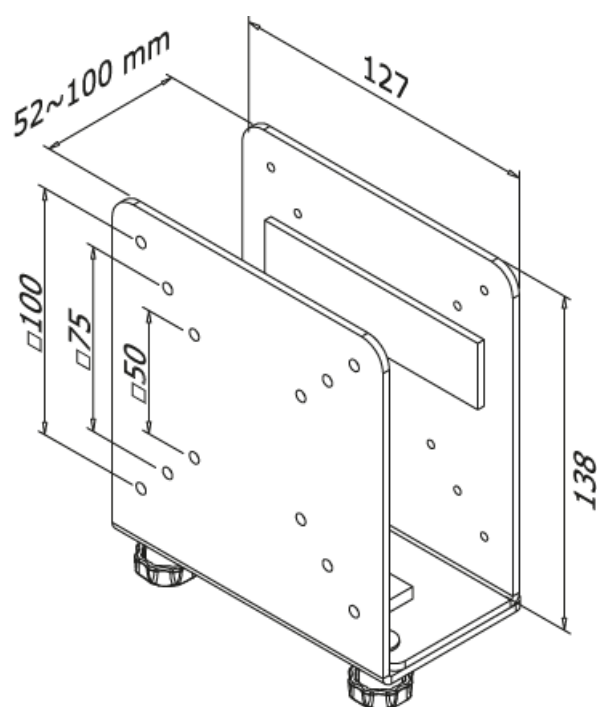

Tools and Measurement



50x50 -
100x100 mm



0-7 kg |
0-15,4 lbs



52-100 mm



Tool

PARTS

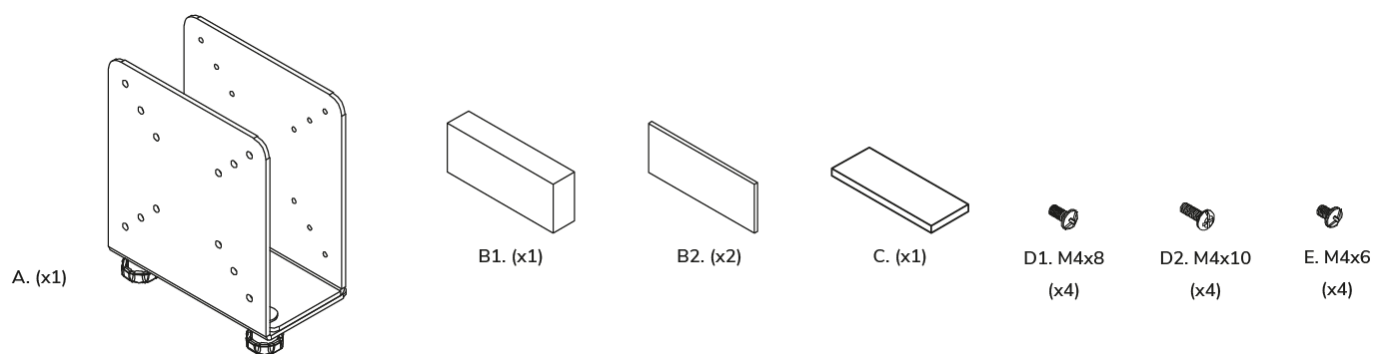

Assembling

STEP 1

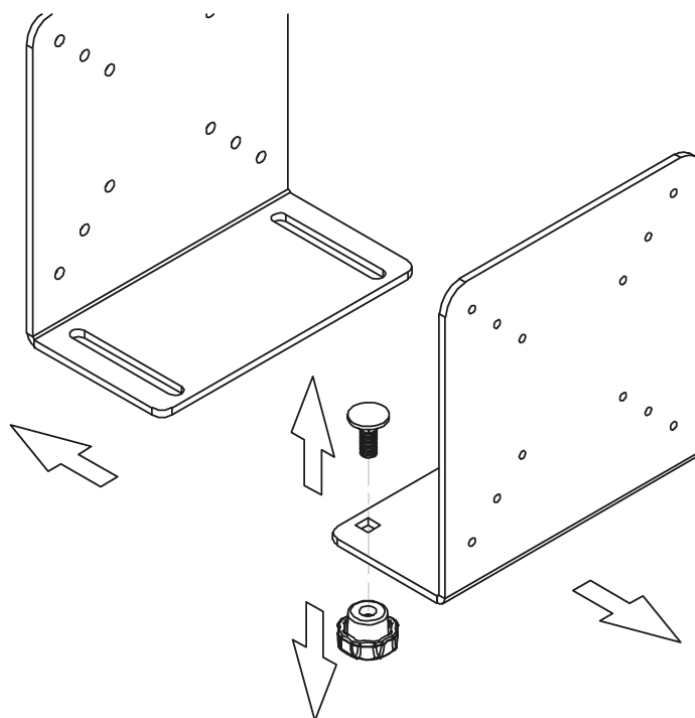

STEP 2

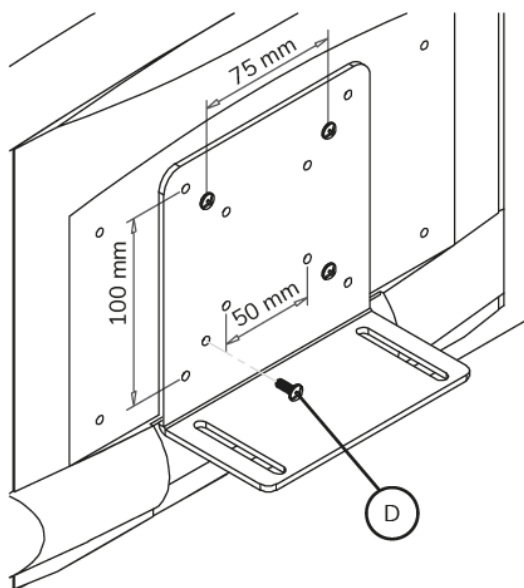

STEP 3

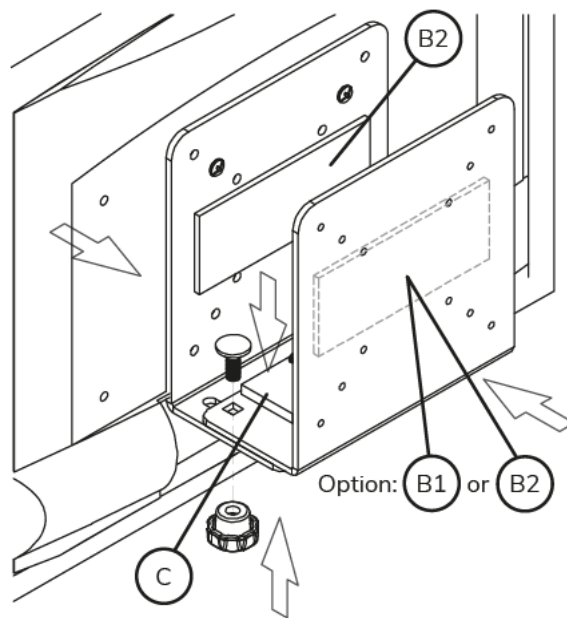

STEP 4

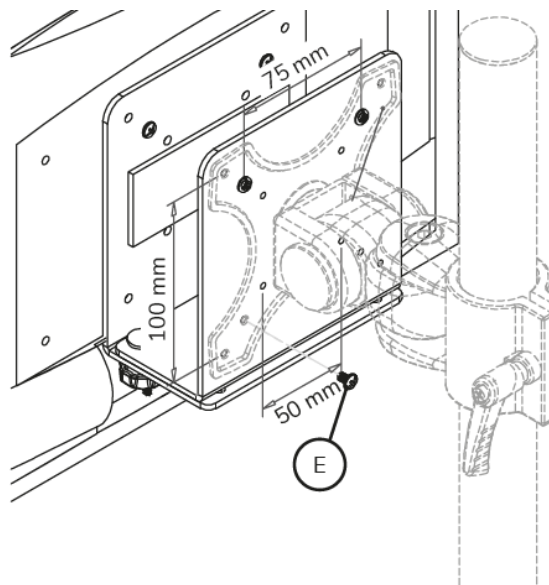

STEP 5

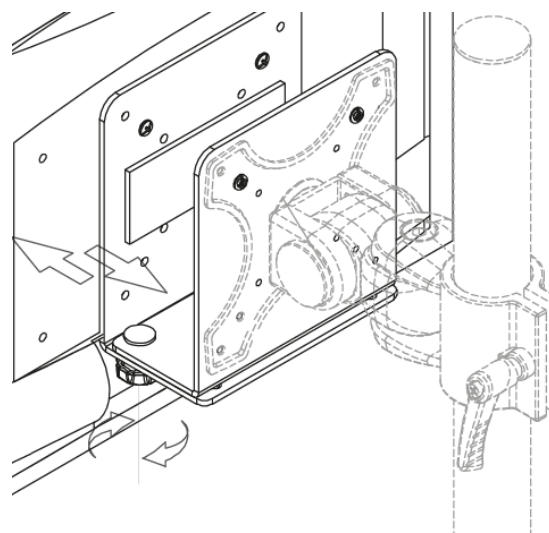

CAUTION

1. To ensure safety, please read this manual carefully before installation and follow the instructions. Store this manual in a secure place for future reference.
2. The manufacturer shall not be legally responsible for any equipment damage or personal injury caused by incorrect installation or operation other than that covered in this manual.
3. The mount is designed for easy installation and removal. The manufacturer shall not be liable for damage to equipment or personal injuries arising out of human factors or acts of nature, such as earthquakes or typhoons.
4. It is recommended that the mount be installed by qualified personnel only.
5. At least two persons are needed to install or remove the product to avoid the hazard of falling objects.
6. **Please carefully inspect the area where the mount is to be installed:**
 - Avoid places that are subject to high temperatures, humidity, or contact with water.
 - Do not install the product near air conditioning vents or areas with excess dust and fumes.
 - Only install on vertical walls and avoid slanted surfaces.
 - Do not install in places subject to any shock or vibration.
 - Do not install in places subject to direct exposure to bright light, as it may cause eye fatigue when viewing the display panel.
7. Maintain sufficient space around the display to ensure adequate ventilation.
8. To ensure a safe installation, first check the structure of the wall, ceiling, or floor and select a secure mounting location.
9. The wall, ceiling, or floor should be strong enough to sustain a weight of at least four times the display and mount combined. The mounting location must be able to withstand earthquakes or other strong shocks.
10. Do not modify any accessories or use broken parts. Contact your dealer with any questions.
11. Tighten all screws (do not exert excessive force to avoid breaking the screw or damaging its thread).
12. Drill holes and bolts will be left in the wall, ceiling, or floor once the display and bracket are removed. Stains may occur after extended use.
13. Since the manufacturer has no way to control the wall, ceiling, or floor type and installation of the mount, the warranty of the product shall only cover the body of the mount. The warranty period of the product is 5 years.
14. Please consult the English language manual for any dispute on conditions.

User Support

- **Address:** Neomounts Computer Products Europa B.V. | Wateringweg 62 | 2031 EJ Haarlem | The Netherlands |
- **Contact no.** +3 1(0)23-5478888
- **Support:** info@neomounts.com
- **Email:** www.neomounts.com

FAQ's

Do you need a CPU holder?

In addition to the practical applications and benefits of a CPU holder, having one installed on your desk or workstation can actually protect your computer. A CPU that sits on the floor is more susceptible to collecting dust or hair. This is especially true when you are working with carpet.

What is the CPU holder called?

In computer hardware, a CPU socket or CPU slot contains one or more mechanical components providing mechanical and electrical connections between a microprocessor and a printed circuit board (PCB). This allows for placing and replacing the central processing unit (CPU) without soldering.

What are the 2 types of CPU holders?

Common types of CPU sockets include the Pin Grid Array (PGA) and the Land Grid Array (LGA).

Is a CPU holder good?

A CPU holder enables you to conveniently relocate your CPU. This is especially critical if you're working at a height-adjustable desk. Additionally, if you purchase a standing desk, you may be advised to purchase a CPU holder.

How to safely carry a CPU?

Remove any mechanical hard drives. Hard Drives In Their Bays On The Right. Secure your CPU Cooler. Most CPU coolers are heavy. Try to keep your case laying on a spongy surface. In some cases, the back seat of the car might be an ideal carrier for your PC case. Remove all heavy add-in cards.

Is there mounting hardware included with the Neomounts THINCLIENT-20 holder?

Yes, all necessary mounting gear is included with the Neomounts THINCLIENT-200 holder for a simple installation.

Is it simple to reach the thin client ports and wires with the holder?

Yes, the holder is made to make it simple to access the thin client ports and wires for upgrades and maintenance.

What's the THINCLIENT-20 holder made of?

Durable steel was used to make the holder.

Which shade does the THINCLIENT-20 holder come in?

The black finish of the holder matches any workspace.

What serves as the THINCLIENT-20 CPU holder from Neomounts?

You may suspend a computer under your desk with Neomounts' THINCLIENT-20 CPU holder, easily saving room underneath. More dust may enter a PC that is resting on the floor, and it will also get in the way if the area under the desk needs to be cleaned.

Are Neomounts THINCLIENT-20 CPU holders required?

A Neomounts THINCLIENT-20 CPU holder has many uses and advantages, but it can also protect your computer if you have one mounted on your desk or workplace. A CPU that is placed on the floor is more likely to get dirt or hair. This is particularly valid when working with carpets.

Download this PDF Link: [Neomounts THINCLIENT-20 CPU Holder Instructions Manual](#)