



## NEMO Fox LED Floor Lamp Instruction Manual

[Home](#) » [NEMO](#) » NEMO Fox LED Floor Lamp Instruction Manual 

# NEMO

Assembly instructions

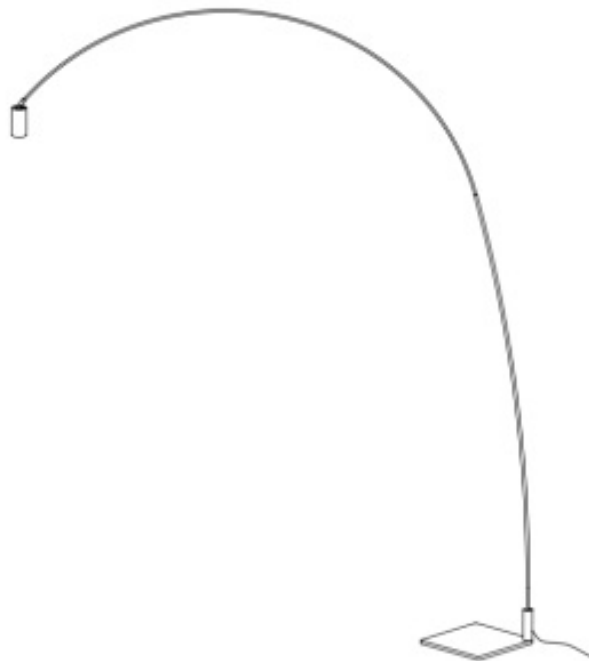

Bernhard Osann  
FOX

## Contents

- 1 Box contents
- 2 Installation
- 3 Accessory
- 4 Movements
- 5 Lamping
- 6 Documents / Resources
- 7 Related Posts

## Box contents

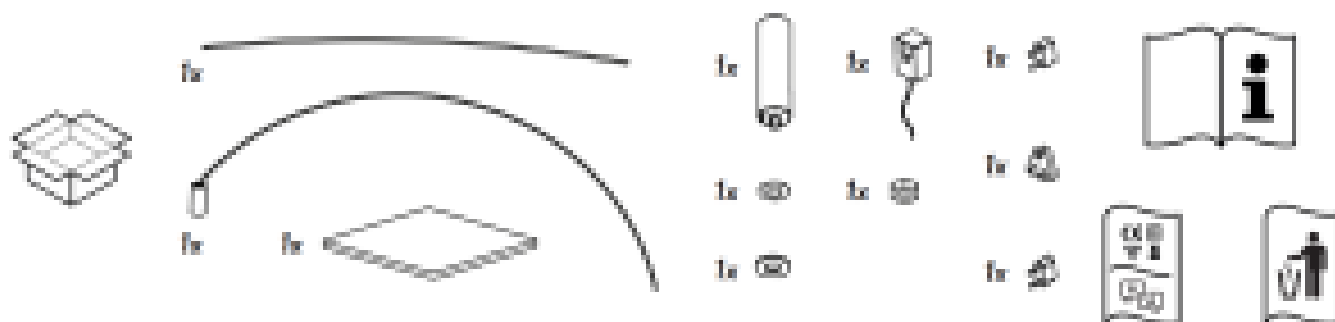

## Installation

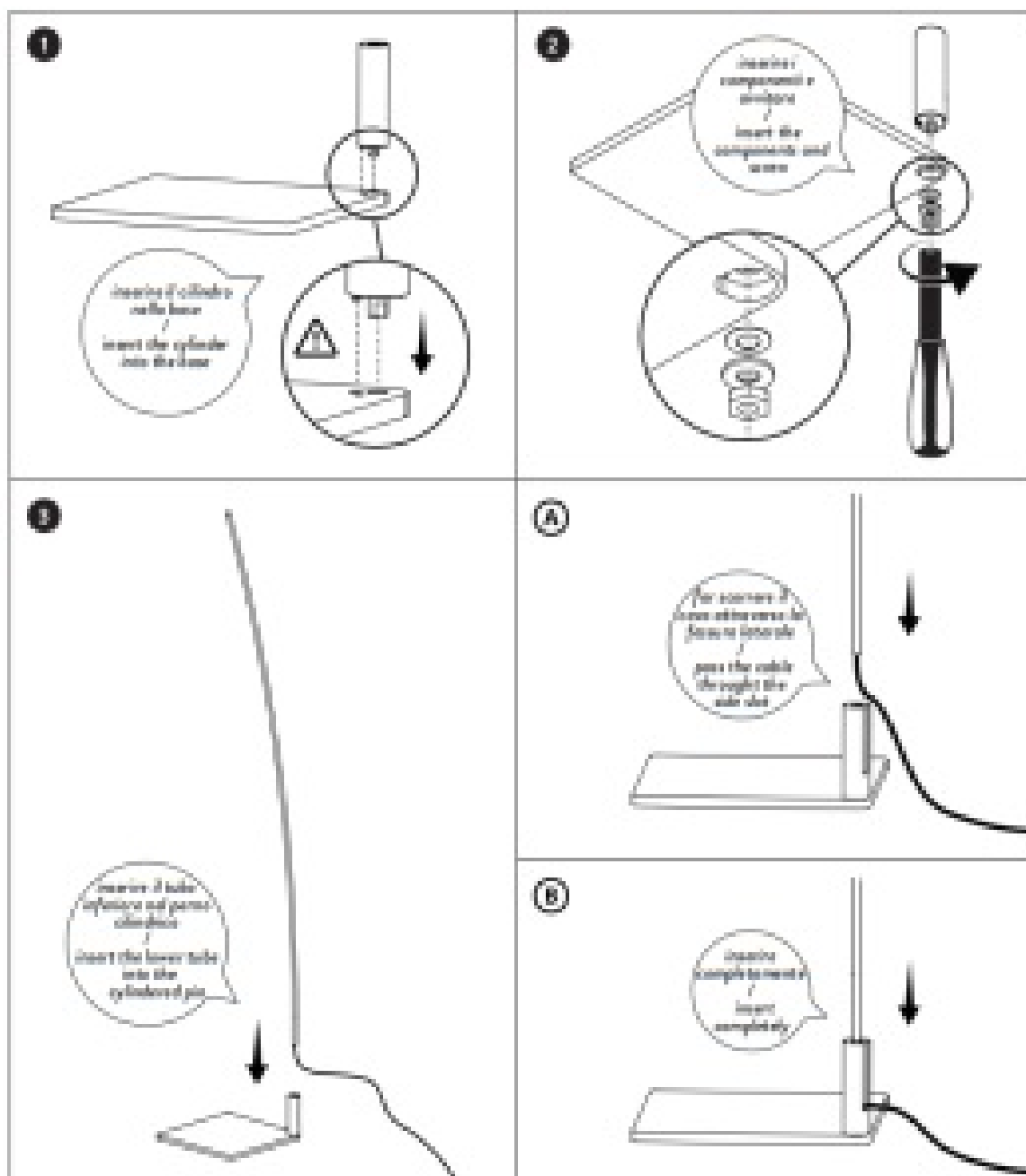

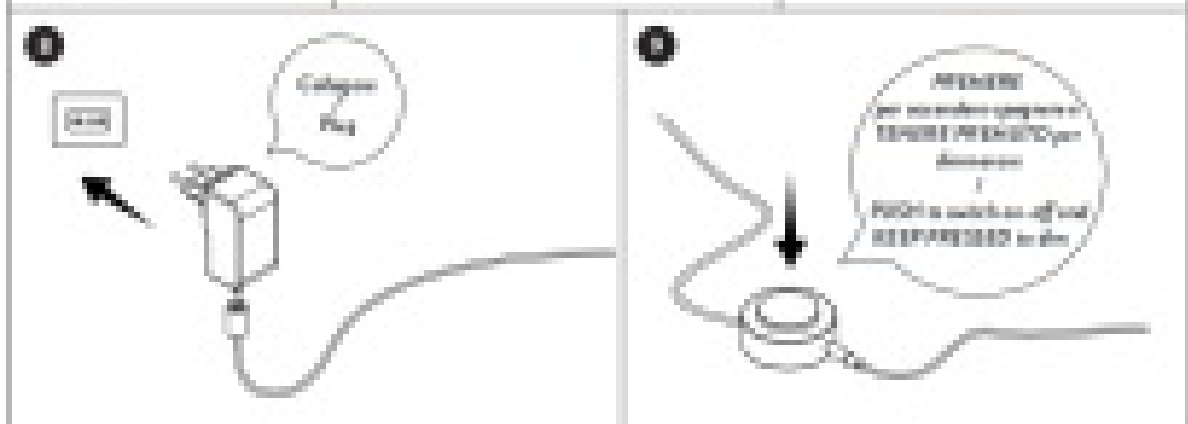
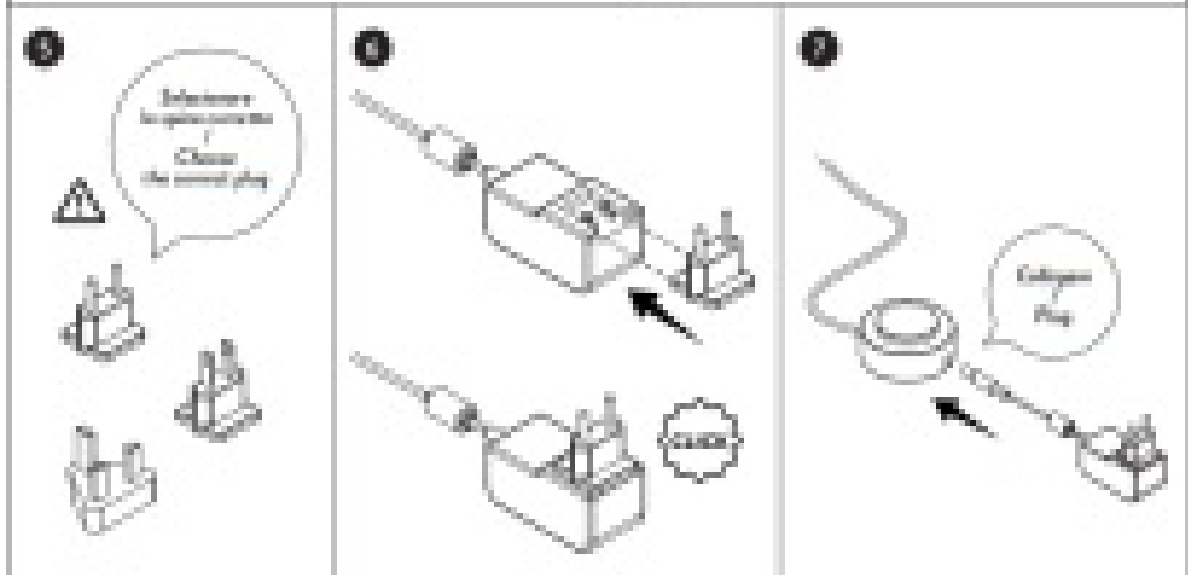
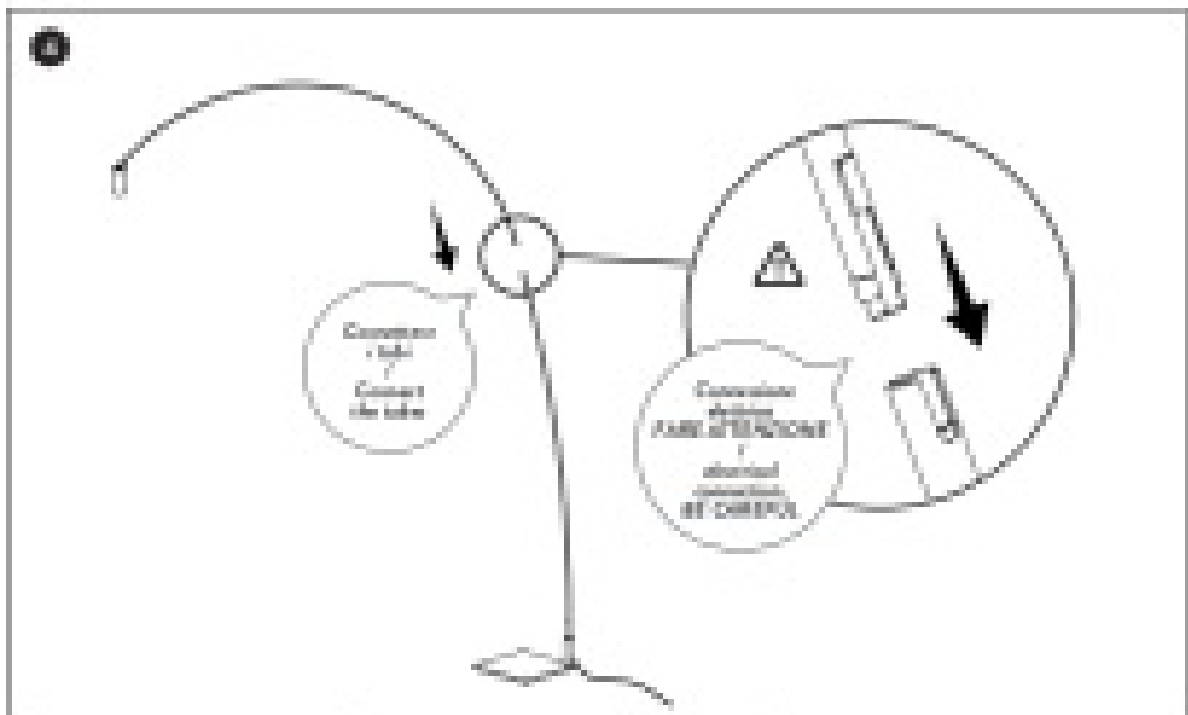

Accessory

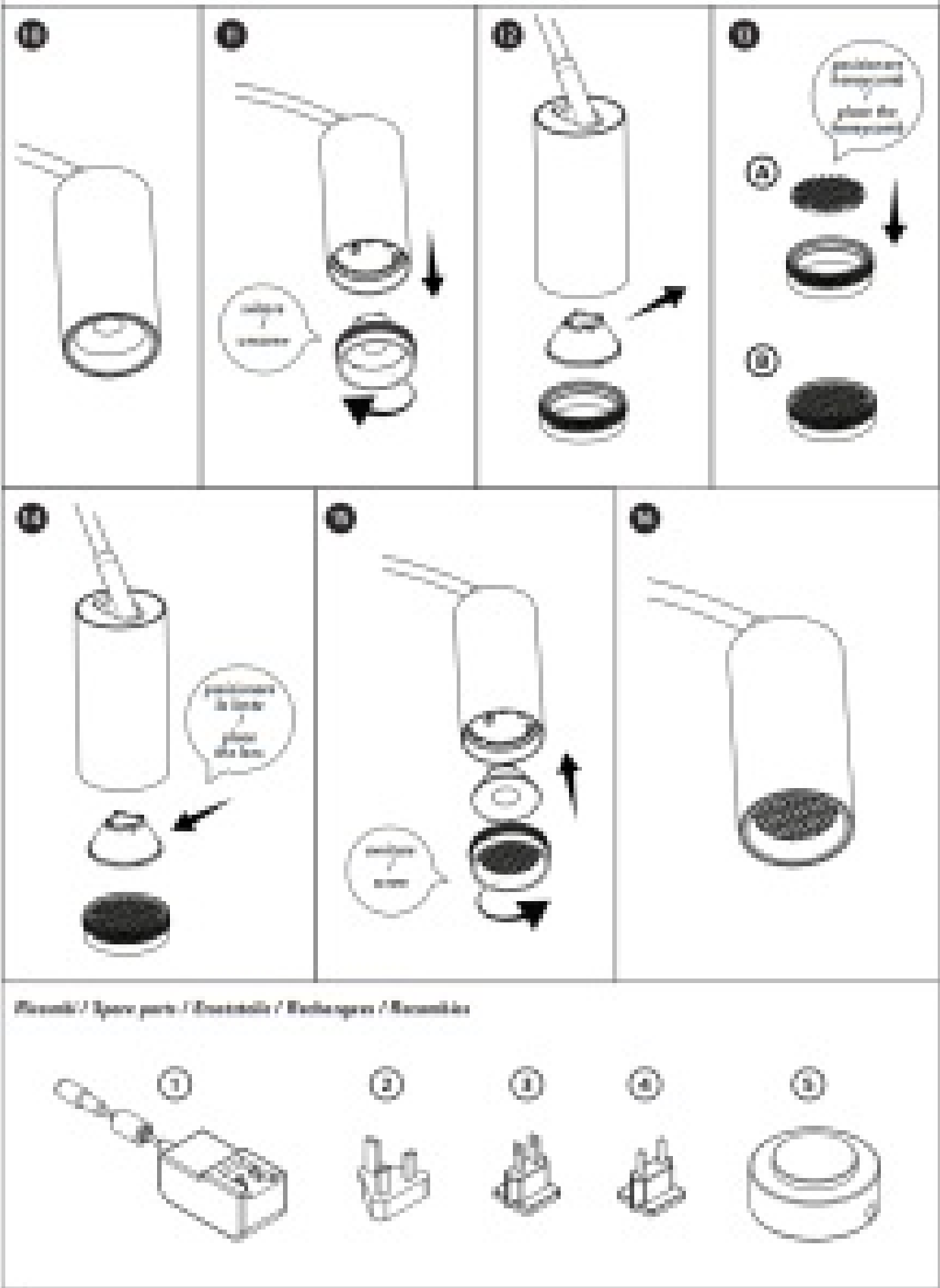

Movements

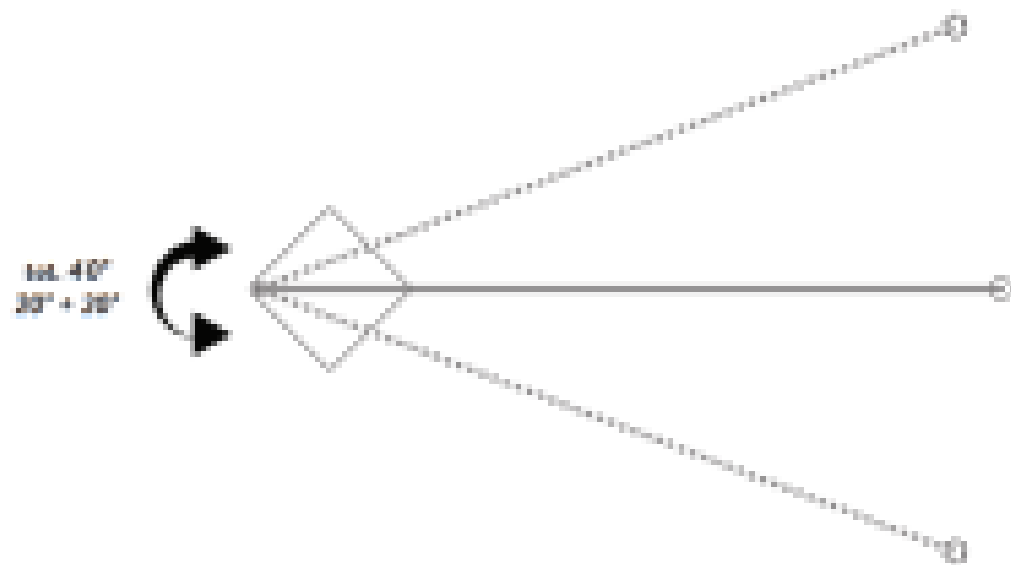
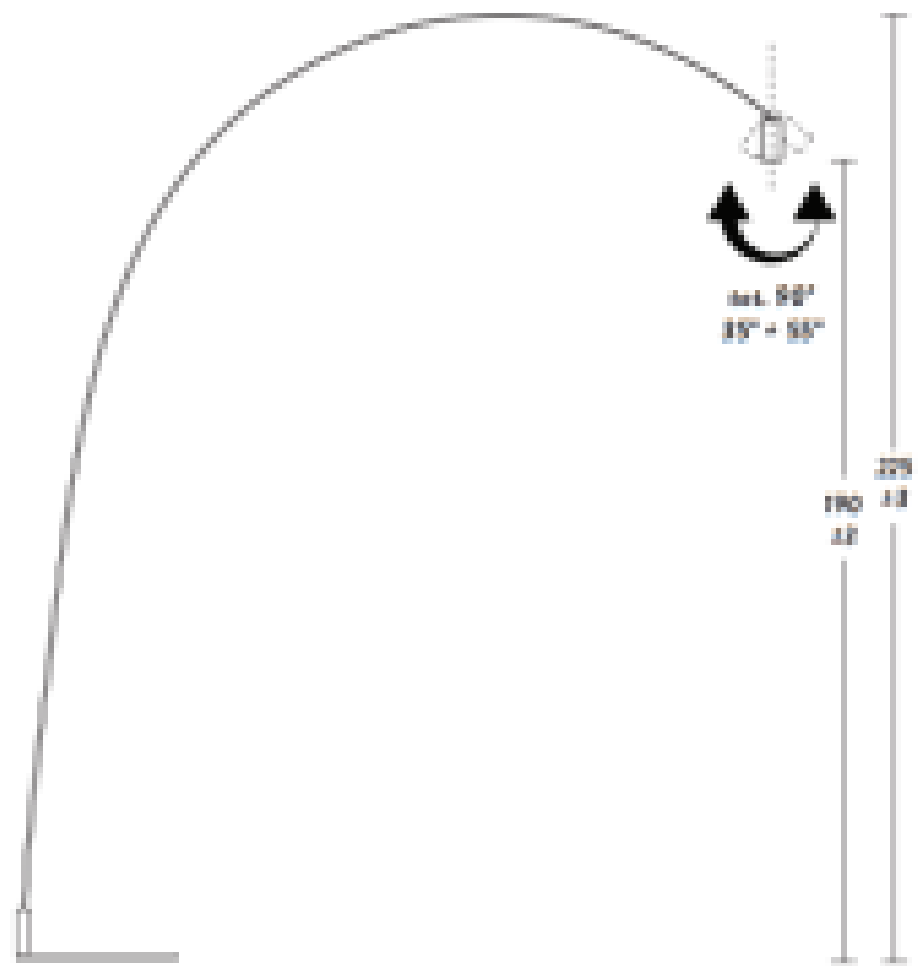

## CAUTION

Symbols and guarantees of the fixture are described in the enclosed sheet./Disconnect power before proceeding with the installation of the fixture./In the absence of the IP symbol, the fixture is only for indoor installation. / Use only bulbs of a suitable type and power specified in the label./Safety is guaranteed only if installation is carried out by a qualified electrician./ Products with anodized finishes could show different color shades due to the industrial galvanic process. Shades have to be considered as aesthetic elements of the product./Polishing process is hand-made. Shades are therefore due to this manual process. / Dimensions of products made with deformations of extrusions could be subject to changes of  $\pm 1\text{cm}$ ./As blown glass is produced by traditional craft techniques, its thickness, color, and finish are subject to variations, a feature that makes each piece unique. / Do not install fixtures in ambiances with the presence of chlorine, salt air or aggressive agents, if not expressly mentioned. / The color temperature (CCT) of LED sources can be different from the declared nominal value between a range of  $\pm 5\%$ . / NEMO reserves the right to make any technical or formal alterations to its products without giving prior notice, especially for LED sources. / We recommend you to keep instructions for further consultations. /



This lamp has been manufactured in conformity with EU Directive 2002/96/EC. The crossed-out wheeled bin symbol marked on the appliance means that it was put on the market after 13th August 2005 and that it must therefore be disposed of separately from household waste. Separate disposal of this product prevents any negative effects to public health and the environment deriving from unsuitable disposal and allows the materials it is made of to be recovered to achieve considerable savings of power and resources. The end-user is responsible for delivering the appliance, at the end of its working life, to a suitable collection facility. Failure to do so will be punished according to the current national legislation. For detailed information on collection systems and methods, please contact the relative office in your town, the local waste disposal service, or the shop where you purchased the product.

## Lamping

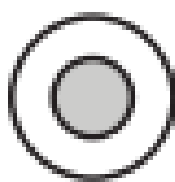

**LED, 15W, 839 lm, 110-240V, 2700K, 50/60Hz dimmable (onboard)**



# NEMO



This luminaire contains built-in LED lamps.

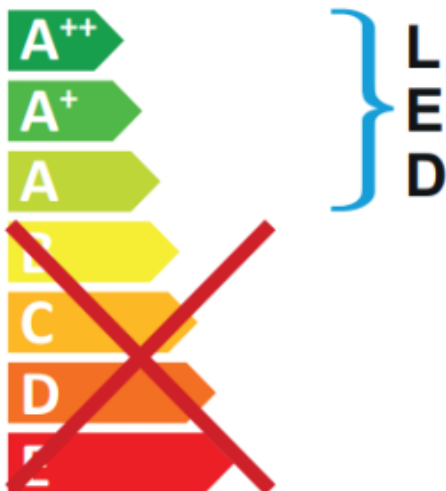

This luminaire is sold with a bulb of the energy class:  
The lamps cannot be changed in the luminaire.

## NEMO Srl

Viale Brianza, 30 – 20823 Lentate sul Seveso (MB) ITALY

Tel +39 0362 166 05 00 – Fax +39 0362 372 996

[info@nemolighting.com](mailto:info@nemolighting.com) – [nemolighting.com](http://nemolighting.com)

Copyright © 2021 NEMO Srl Milano, Italia.

The text and images are protected by copyright.

Unauthorized reproduction.



874/2012

CODE

072FOX000100

12/02/2021

## Documents / Resources

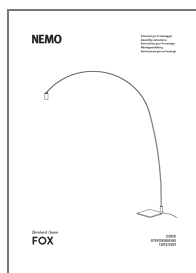

**[NEMO Fox LED Floor Lamp](#)** [pdf] Instruction Manual  
072FOX000100, Fox LED Floor Lamp