

# NEMO 20148834 Riga Transparent Light Strip Instruction Manual

[Home](#) » [NEMO](#) » NEMO 20148834 Riga Transparent Light Strip Instruction Manual 

## NEMO STUDIO

20148834 Riga Transparent Light Strip  
Instruction Manual

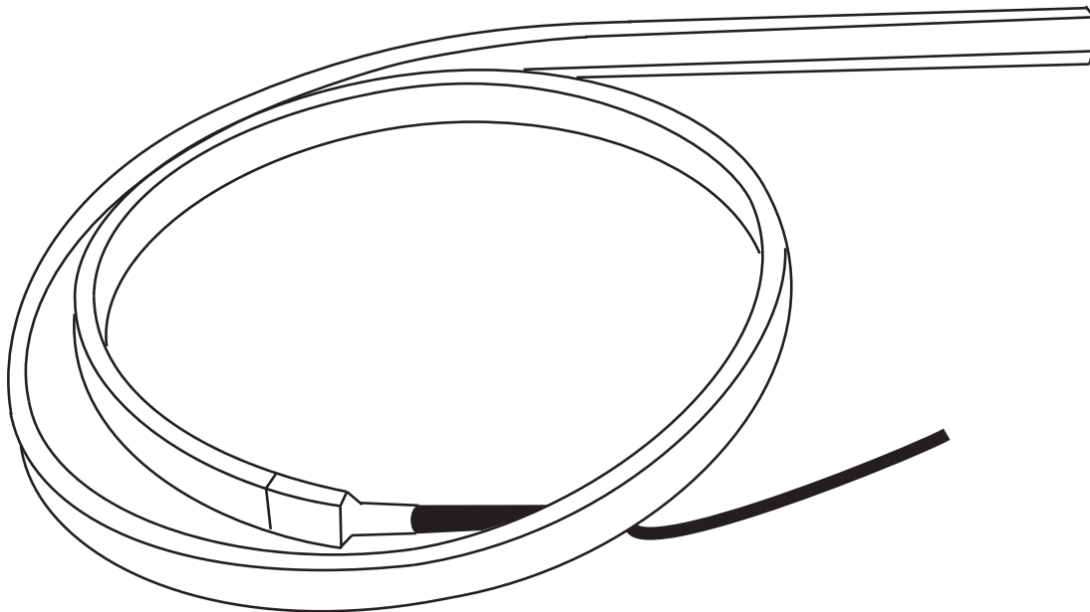

**RIGA TRANSPARENT (g.3)**

Outdoor linear

CODE

MRIG09\_\_035\_\_RE

01/03/22

## Contents

- 1 Box contents
- 2 Installation
- 3 CUTTING
- 4 MAINTENANCE
- 5 ACCESSORIES
- 6 EQUIPMENT DISPOSAL
- 7 LIGHTING CLEANING SAFETY INSTRUCTIONS
- 8 Lamping
- 9 Documents / Resources
- 10 Related Posts

## Box contents

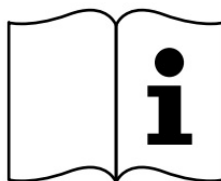
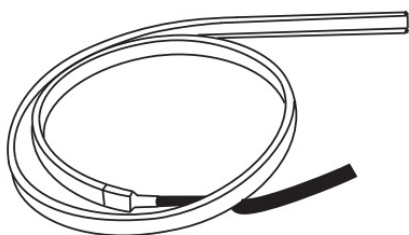

## Installation

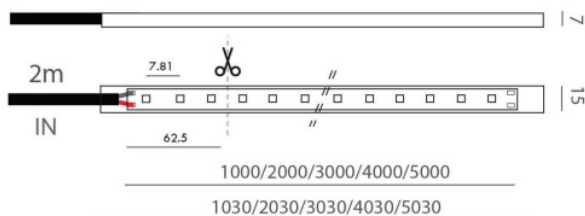
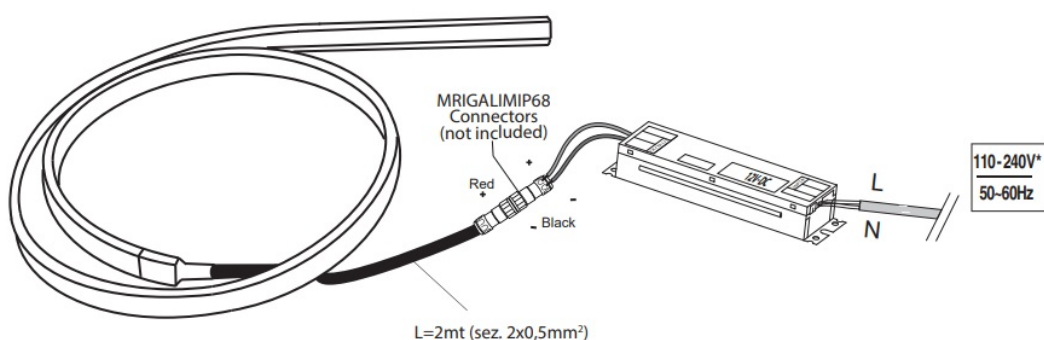

⚠ On average CCT color temperature, this value can vary due to the manufacturing processes.

⚠ Installation should be carried out by a suitable quality installer.

⚠ Make the wiring using a system that guarantees at least the IP grade of the lamp

 Connect the fitting to the feeder and then connect the feeder at 220V.

 LED module itself and all its components must not be mechanically stressed

## CUTTING

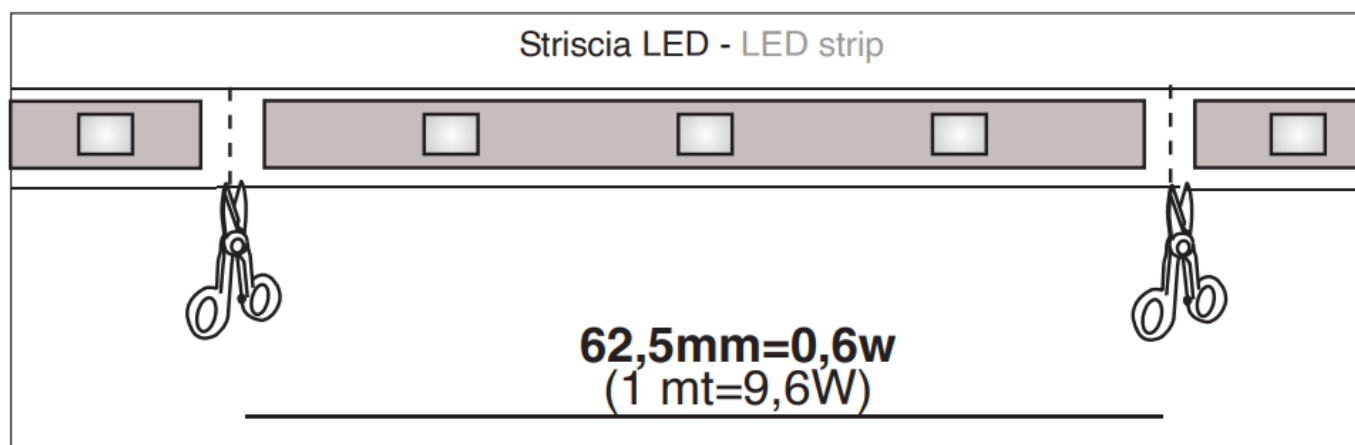

 **Cut only where indicated**

When cutting to size, ensure that the cut is made in one steady motion at 90 ° angle to the strip. This will provide a clean surface for the end cap to slide onto and secure to.

Once the cut has been made, place a small amount of adhesive in the end cap and slide the endcap onto the flex, ensuring a complete seal to maintain its IP rating. Follow the instructions of the adhesive to provide enough time for the adhesive to dry and hold the endcap to the flex.

## INSTALLATION

Per l'installazione della lampada sono necessari/

To install luminaires are needed:

- 2 people
- drill
- screwdriver (electric screwdriver)
- Silicone Glue
- Installation should be carried out by a suitable quality installer.
- Installation must be done by 2 PEOPLE, especially when the product is longer than 2m.

**NOT ALLOWED:**

**NOT ALLOWED:**

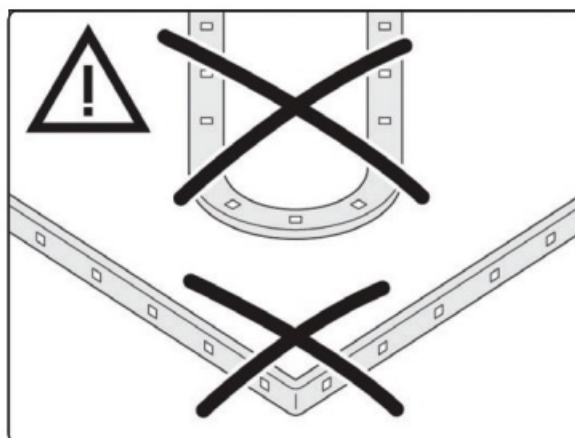
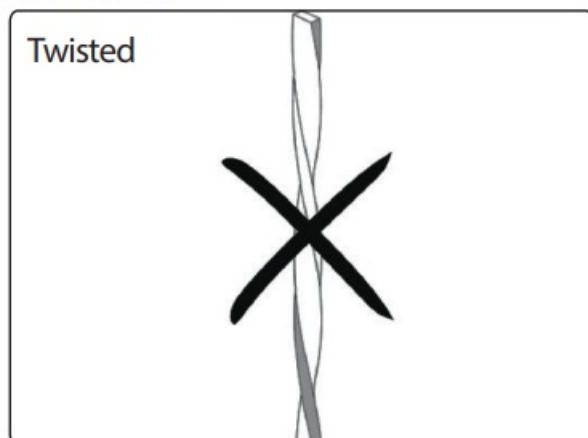

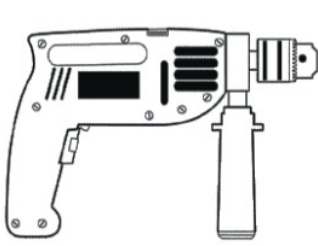
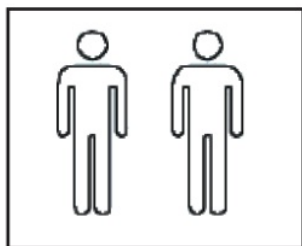

To handle the product very carefully, to avoid damage to the conductor tracks.  
It is allowed to shorten the cable min 50cm.

### **ALLOWED:**

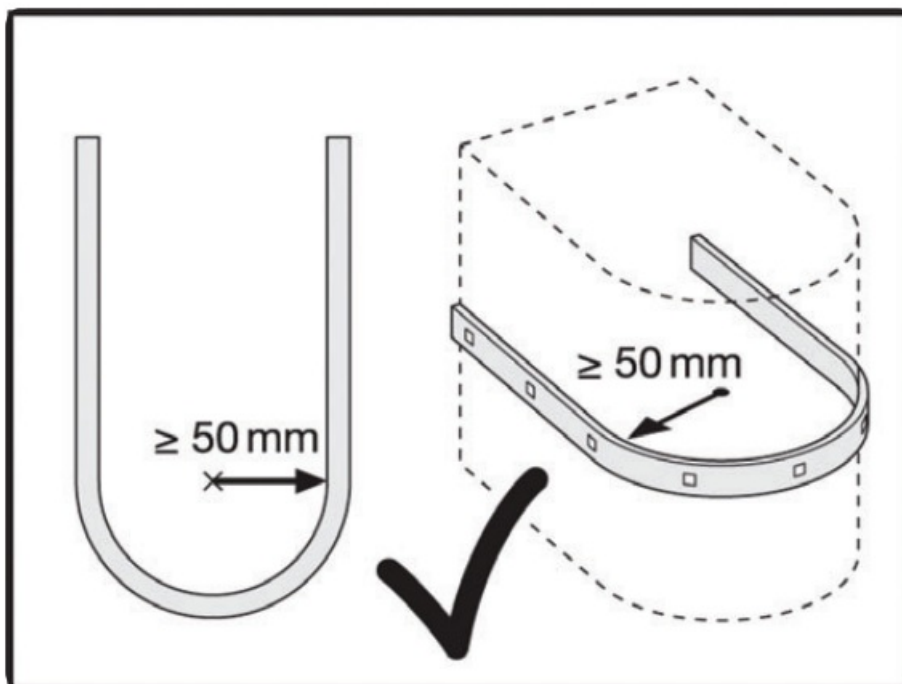

**Example of connection (parallel connection)**

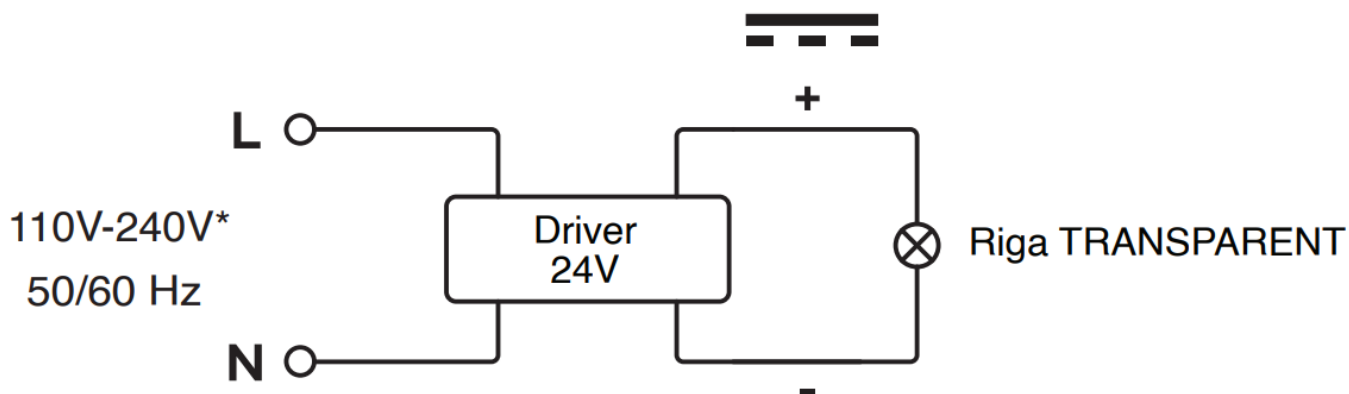

Verify the input tension supported by drivers.

### **MAINTENANCE**

- Disconnect main voltage before maintenance operation.
- It's recommended to regular cleaning of the luminaire not using chemical products.
- Due to production, tolerances in the linear expansion of up to 5 mm are to be expected. In width by up to +/-1mm.
- Exceeding maximum ratings for operating and storage will reduce the expected lifetime or damage the product.
- It's recommended to regular cleaning of the luminaire not using chemical products.

### **LED Drivers (SELV)**

**LED Drivers** not included

**Specifications** DRIVER 24V IN24VDC

**Compatible controls:**



## ACCESSORIES

– End Cap (incluso/included) – to use with silicon glue

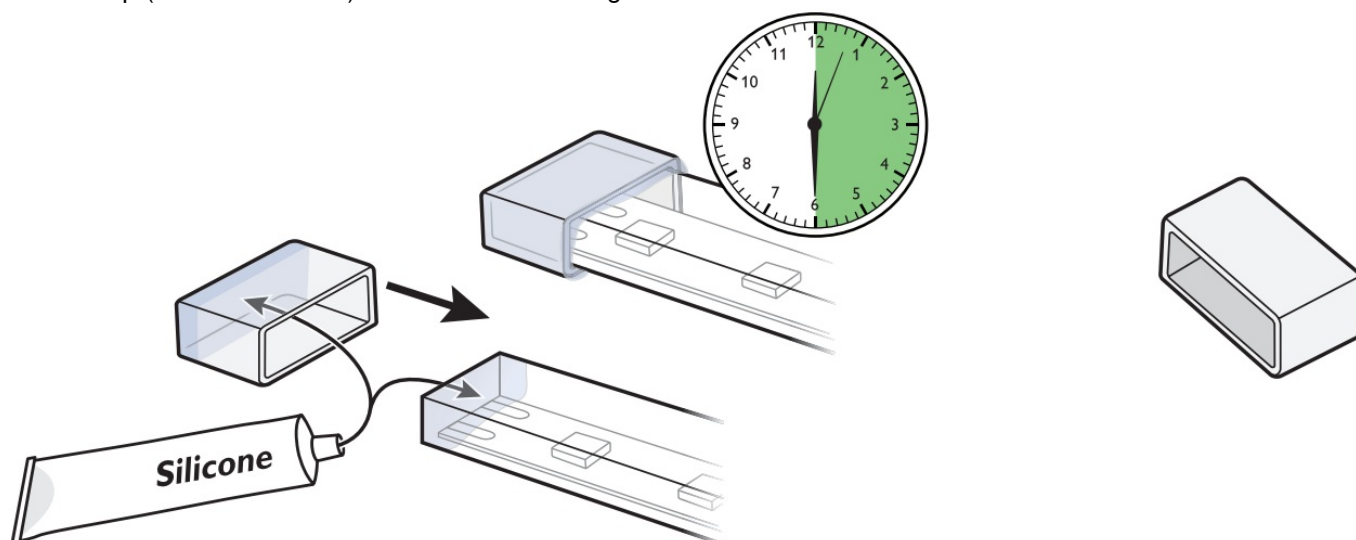

– Clips (included)

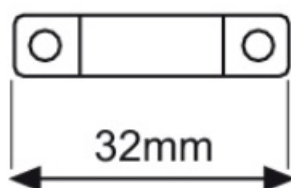
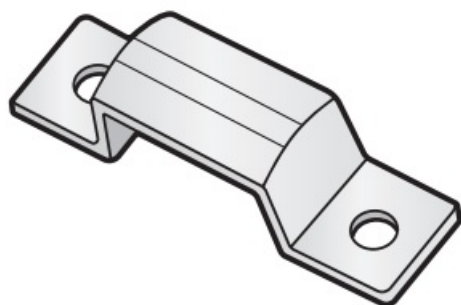

– Fix the brackets

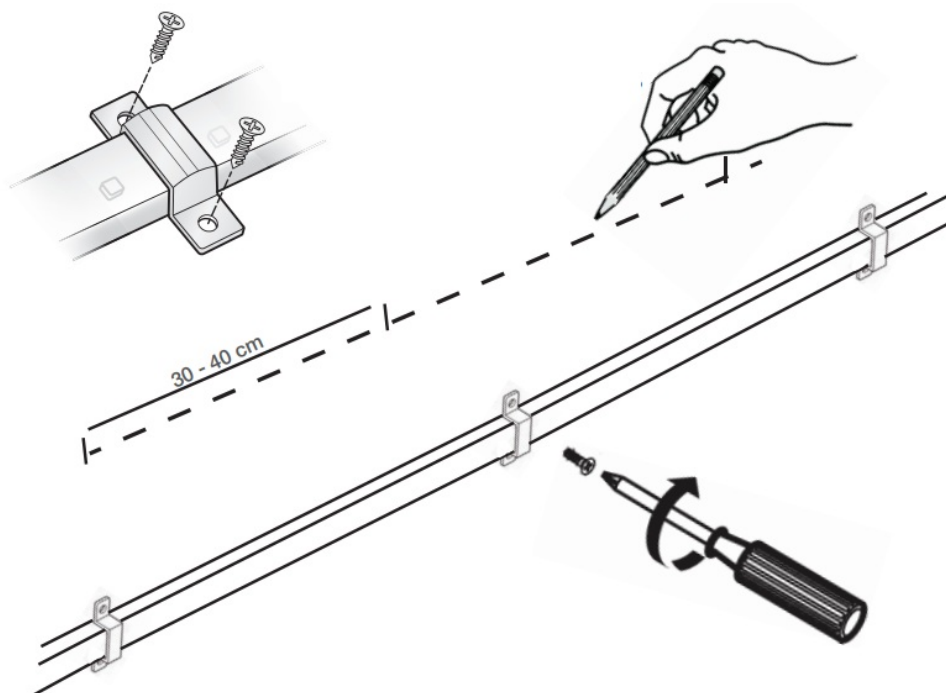

#### CAUTION

#### OUTDOOR LUMINAIRE

Installation should be carried out by a suitable quality installer. / Disconnect main voltage before maintenance operation / All wiring and maintenance must be performed with the main switch in the OFF position / Don't open the luminaire.

Connect the fitting to the power supply only after connecting all LED to the driver (when expected) / In case of failure, upon a return authorization of NEMO Studio, the product will be not either open or dismantled and the cable must be cut leaving at least 10/15cm / Make the wiring using a system that guarantees at least the IP grade of the spot.

Se previsto, use only bulbs of a suitable type and power specified in the label / Do not install fixture in an environment with the presence of chlorine, salt air, or aggressive agents, if not expressly mentioned. / The color temperature (CCT) of LED sources can be different from the declared nominal value within a range of  $\pm 5\%$ . / NEMO reserves the right to make any technical or formal alterations to its products without giving prior notice, especially for LED sources. / We recommend you keep instructions for further consultations.

-For a proper operation, the fitting requires its protective undamaged glass.



#### EQUIPMENT DISPOSAL



This lamp has been manufactured according to Directive EU 2012/19/EU. In accordance with EU Directive WEEE (Waste Electrical and Electronic Equipment), luminaires must not be disposed of with other household waste. At the end of their life, luminaires must be taken to the appropriate local facility available for the disposal or recycling of electronic products.

#### LIGHTING CLEANING SAFETY INSTRUCTIONS



It is essential to clean the luminaire periodically at regular intervals to remove the dust, dirt, limestone, or other contaminations. Before cleaning the luminaire, switch off the power supply and let it cool down. Not maintaining the luminaires may result in malfunctioning. Clean the luminaires using a soft cloth damped in lukewarm water. Do not use cleaning products that contain acidic substances. Do not use cleaner machines. Luminaires must not be used in corrosive environments, and exposure to corrosive substances must always be avoided. Do not use grainy detergent and/or rough or abrasive sponges. Contact NEMO in case of doubts regarding lamp cleaning.

## Lamping



This luminaire contains built-in LED lamps.

The LED and the cables cannot be changed in the luminaire from the end-user. Please contact NEMO STUDIO (the only authorized center).

This product contains a light source of energy efficiency class <E>

Don't look directly at the light source

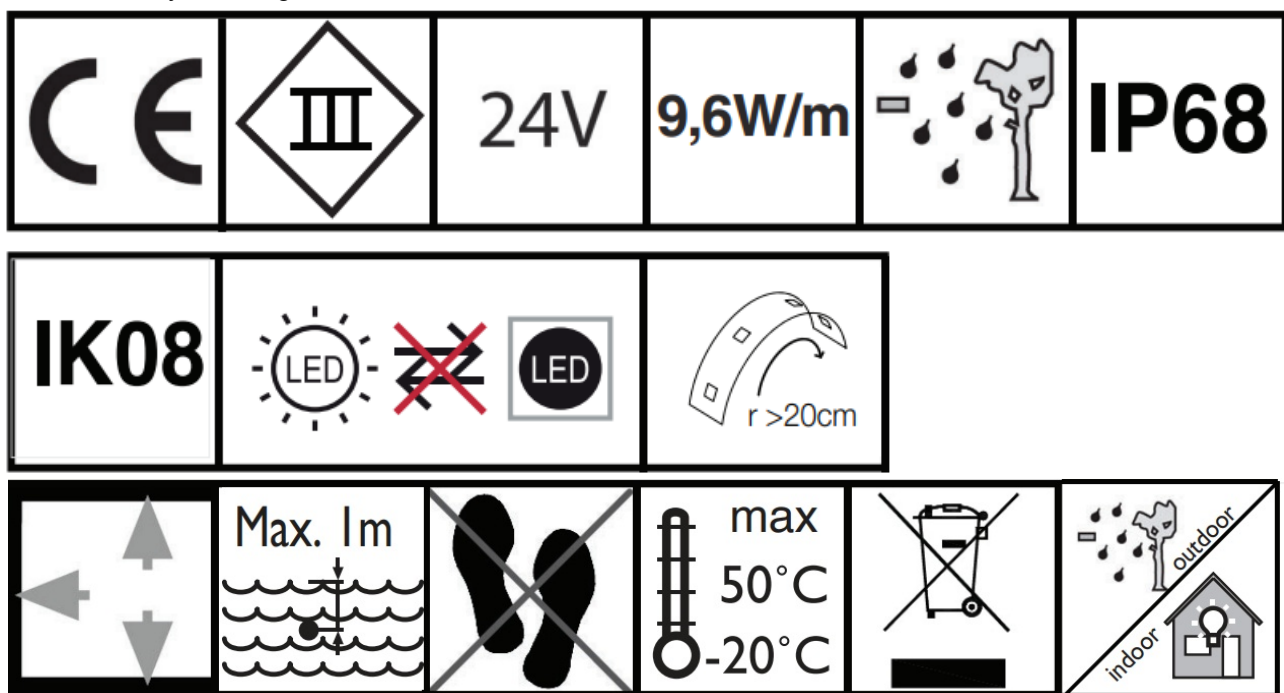

### NEMO Studio

Iliti Luce Srl – Strada Borgata Paradiso 20 – 10036

Settimo Torinese (TO) ITALY

Tel +39 011 7657301

[nemostudio@nemolighting.com](mailto:nemostudio@nemolighting.com) – [nemolighting.com](http://nemolighting.com)

Copyright © 2020 NEMO Srl Milano, Italia.

The text and images are protected by copyright.

Unauthorized reproduction.

## Documents / Resources

[NEMO 20148834 Riga Transparent Light Strip](#) [pdf] Instruction Manual  
20148834, Riga Transparent Light Strip, 20148834 Riga Transparent Light Strip