



NEEWER RT116 Remote Shutter Instruction Manual

[Home](#) » [NEEWER](#) » NEEWER RT116 Remote Shutter Instruction Manual 

Contents

- [1 NEEWER RT116 Remote Shutter](#)
- [2 Product Information](#)
- [3 Product Usage Instructions](#)
- [4 Product illustration](#)
- [5 Replace the battery](#)
- [6 Instructions for use](#)
- [7 Product Specifications](#)
- [8 FCC Statement](#)
- [9 Documents / Resources](#)

NEEWER[®]

NEEWER RT116 Remote Shutter



Product Information

The device is designed to meet general RF (Radio Frequency) exposure requirements. It is important to note that this equipment should be installed and operated while maintaining a minimum distance of 0mm between the radiator (antenna) and your body.

Product Usage Instructions

1. Ensure that the device is properly installed according to the manufacturer's guidelines.
2. Before using the device, make sure that there is no physical obstruction or interference around the radiator (antenna).
3. Maintain a minimum distance of 0mm between the radiator and your body while operating the device.
4. Follow any additional safety instructions mentioned in the user manual for optimal usage.

Please note that maintaining the recommended distance between the radiator and your body helps minimize RF exposure. It is important to adhere to these guidelines for safe and appropriate use of the device.

Product illustration

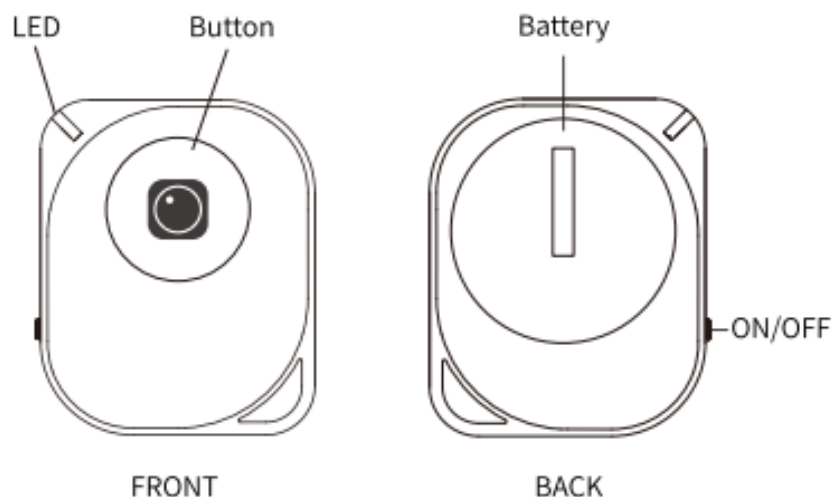

- Smart phone OS update or change in the future might lead to incompatible

Replace the battery

Using a coin or other open tool, rotate the battery cover to the left until it unlocks.

- positive pole upwards to install the battery.

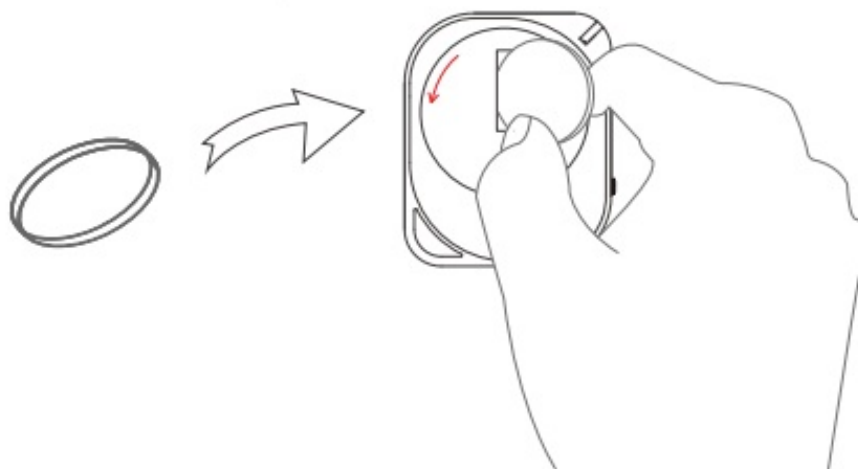

WARNING!

Incorrect rotation position will cause the lid opening to fail.

Instructions for use

Easy to set up, Easy to use



Pairing

- Turn on the shutter by switching the on/off button, the shutter will enter into pairing mode and indicator LED starts flash quickly at the same time.
- Activate the function on your phone and sourcing the devices around.
- Select the device of “NEEWER-Shutter” from the list and pairing will be finished automatically in few seconds.

Product Specifications

Model	RT116
Battery	DC 3V By CR2032 X1
Communication	V5.0
Frequency Range	2402MHz~2480Hz
Communication distance	10M (33ft)
Battery life	CR2032 X1 cell/about 6 months under working in 10 times a day
Weight	About 10 g
Dimension	38mmx31mmx11mm

FCC Statement

This device complies with Part 15 of the FCC Rules. Operation is subject to the following two conditions: (1) this device may not cause harmful interference, and (2) this device must accept any interference received, including interference that may cause undesired operation.

CAUTION: The user is cautioned that changes or modifications not expressly approved by the party responsible for compliance could void the user's authority to operate the equipment.

NOTE: This equipment has been tested and found to comply with the limits for a Class B digital device, pursuant to part 15 of the FCC Rules. These limits are designed to provide reasonable protection against harmful interference in a residential installation. This equipment generates, uses and can radiate radio frequency energy and, if not installed and used in accordance with the instructions, may cause harmful interference to radio communications. However, there is no guarantee that interference will not occur in a particular installation. If this equipment does cause harmful interference to radio or television reception, which can be determined by turning the equipment off and on, the user is encouraged to try to correct the interference by one or more of the following measures: Reorient or the receiving antenna. Increase the separation between the equipment and receiver. Connect the equipment into an outlet on a circuit different from that to which the receiver is connected. Consult the dealer or an experienced radio/TV technician for help.

FCC RF Radiation Exposure Statement:

1. This Transmitter must not be co-located or operating in conjunction with any Other antenna or transmitter.
2. This equipment complies with RF radiation exposure limits set forth for an uncontrolled environment.

The device has been evaluated to meet general RF exposure requirement. The device can be used in portable exposure condition without restriction.

WARNING

KEEP OUT OF REACH OF CHILDREN

Lithium button/coin battery is included. Swallowing can lead to chemical burns, perforation of soft tissue, and death. Severe burns can occur within 2 hours of ingestion. Seek medical attention immediately.

IC Warning Statements

"This device complies with Industry Canada licence-exempt RSS standard(s). Operation is subject to the following two conditions: (1) this device may not cause interference, and (2) this device must accept any interference, including interference that may cause undesired operation of the device." The digital apparatus complies with

Canadian CAN ICES-3 (B)/NMB-3(B). This radio transmitter has been approved by Industry Canada to operate with the antenna types listed with the maximum permissible gain indicated. Antenna types not included in this list, having a gain greater than the maximum gain indicated for that type, are strictly prohibited for use with this device. The device has evaluated to meet general RF exposure requirement. This equipment should be and operated with minimum distance Omm between the radiator & your body

If you have any questions about product , we are glad to help.

- US +1732-623-9777
- UK +44 (0) 3330113494

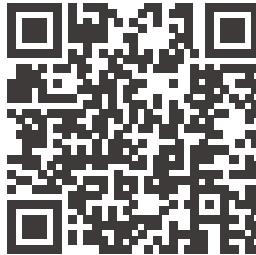

Facebook

- Send us an email
- vip@neewer.com.



Tiktok

- www.neewer.com.



- www.neewer.com.
- **UK IREP**
 - Lingfeng Electronic (I-JK) Ltd International House, 10 Churchill Way, Cardiff, CF10 2HE, United Kingdom
- **EC REP**
 - NW Formations GmbH(for authorities only) Hoferstrasse 9B, 71636 Ludwigsburg, Germany
- Shenzhen Neewer Technology Co.,Ltd.
 - Room 1903, Block A, Lu Shan Building No. 3023 Chunfeng Rd Luo Hu District, Shenzhen Guangdong 518001, China

Documents / Resources



NEEWER RT116 Remote Shutter [pdf] Instruction Manual

2ANIV-RT116, 2ANIVRT116, rt116, RT116 Remote Shutter, RT116, Remote Shutter, Shutter