



# NEEWER PA005E Side Handle with Wireless Control Instruction Manual

[Home](#) » [NEEWER](#) » NEEWER PA005E Side Handle with Wireless Control Instruction Manual 

## Contents

- [1 NEEWER PA005E Side Handle with Wireless Control](#)
- [2 Product Information](#)
- [3 Product Usage Instructions](#)
- [4 Version Control](#)
- [5 Package Contents](#)
- [6 Product Illustration](#)
- [7 Installation Instructions](#)
- [8 Specification](#)
- [9 FCC Statement](#)
- [10 IC Warning Statements](#)
- [11 Contact Information](#)
- [12 Documents / Resources](#)

# NEEWER<sup>®</sup>

**NEEWER PA005E Side Handle with Wireless Control**



## Product Information

The device is designed to meet general RF (Radio Frequency) exposure requirements. It is important to note that RF exposure refers to the level of electromagnetic radiation emitted by the device. It is recommended that the device be installed and operated with a minimum distance of 0mm between the radiator (the part of the device that emits RF radiation) and your body. This distance ensures that you maintain a safe distance from the RF radiation.

## Product Usage Instructions

1. Before using the device, ensure that it is properly installed according to the manufacturer's guidelines.
2. Keep a minimum distance of 0mm between the radiator (the part that emits RF radiation) and your body. This means that you should avoid direct contact or placing the device too close to your body.
3. When using the device, position it in a way that allows for the recommended minimum distance to be maintained at all times.
4. Do not modify or alter the device in any way, as it may affect the RF exposure levels and compromise safety.
5. If you experience any discomfort or health-related issues while using the device, discontinue use immediately and consult a medical professional.
6. Follow any additional safety instructions provided by the manufacturer for optimal usage and to ensure compliance with RF exposure requirements.

It is crucial to prioritize your safety and adhere to these usage instructions to minimize potential RF exposure risks associated with the device.

## Copyright

© 2023 Shenzhen Newer Technology Co., Ltd. All Rights Reserved. This document is the sole property of Shenzhen Newer Technology Co., Ltd and shall not be, reproduced, transmitted, transcribed, stored in a retrieval system or translated in any form, by any means, without prior written permission from Shenzhen Newer Technology Co., Ltd. Shenzhen Newer Technology Co., Ltd reserves the right to change content in this instruction manual at any time and without prior notice.

Version Control

Date	Version number	Description	Issued by
05/30/2023	1.0	Side Handle With Wireless Control Control Manual	NEEWER <sup>®</sup>

Package Contents

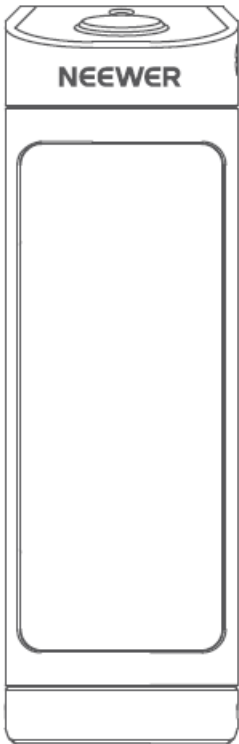

Handle×1

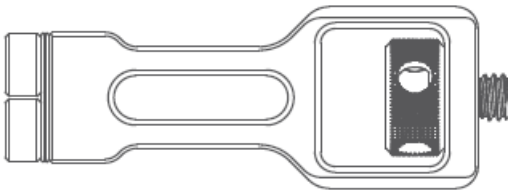

NEEWER Dedicated Phone  
Cage Adapter  
×1

(Compatible with NEEWER PA006, PA011)

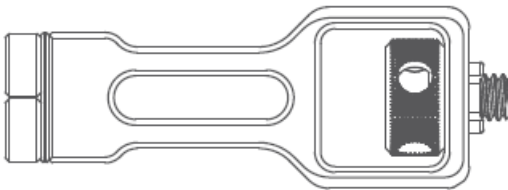

Narrow Positioning Pin  
Phone Cage Adapter  
×1



User  
Manual  
×1

Product Illustration

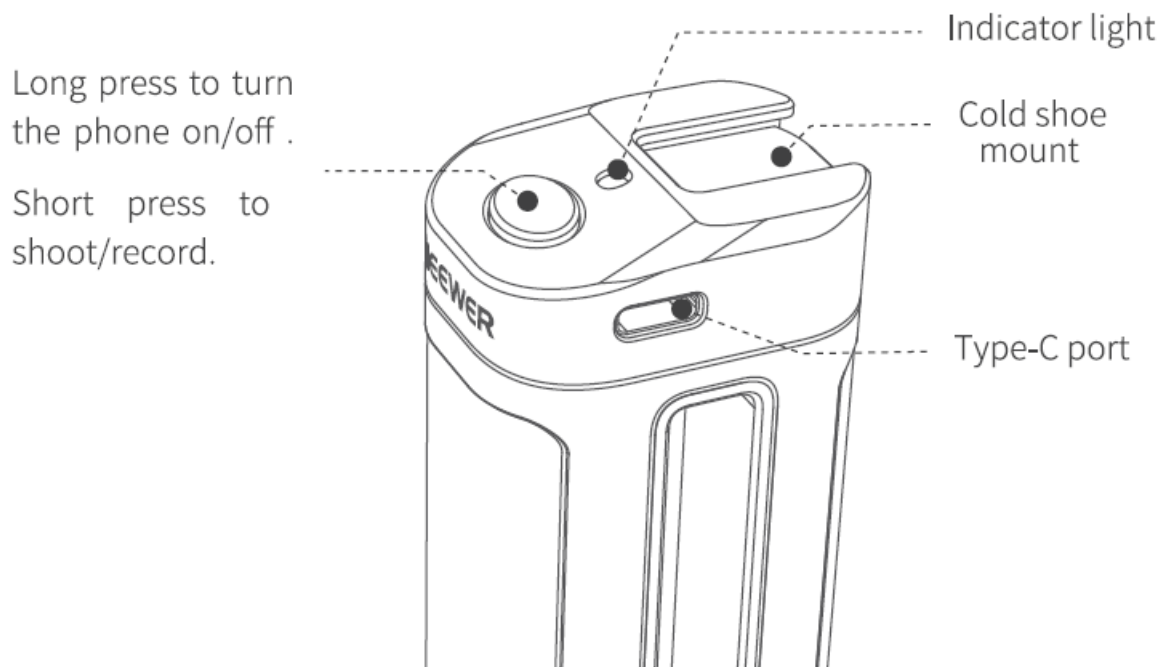

## Installation Instructions

### 1. Installation Instructions for NEWER Universal Phone Cage PA009

1. Remove one of the PA009 handle adapters
  - Remove the original handle adapter using the L shaped hex key.

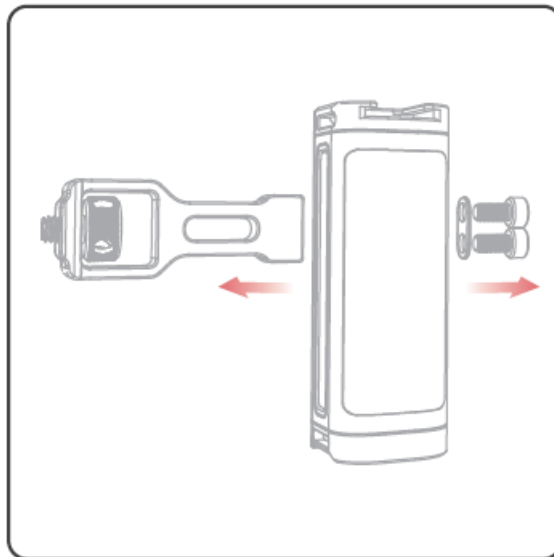

### 2. Install the Bluetooth Side Handle

Attach the removed adapter to the side of the Bluetooth handle using the Lshaped hex key.

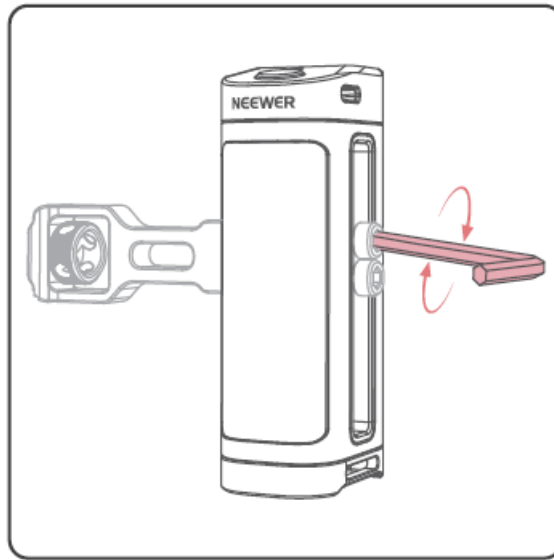

### 3. Install PA009

Tighten the screw partly by hand and secure using the L shaped hex key.

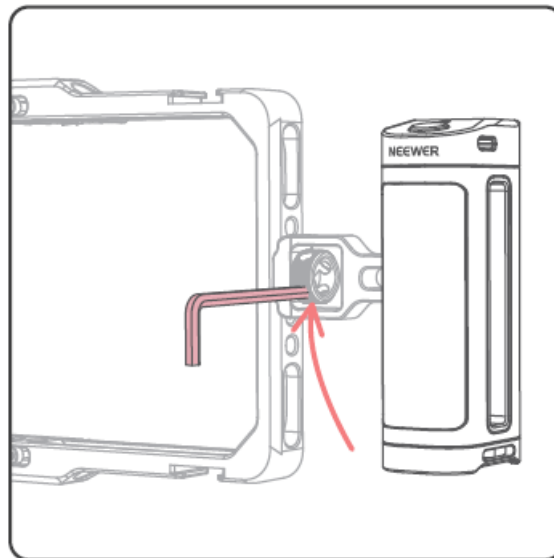

### 4. Expand using an LED light

Use the added cold shoe mount on the top to attach additional equipment such as a LED light or microphone, as needed.

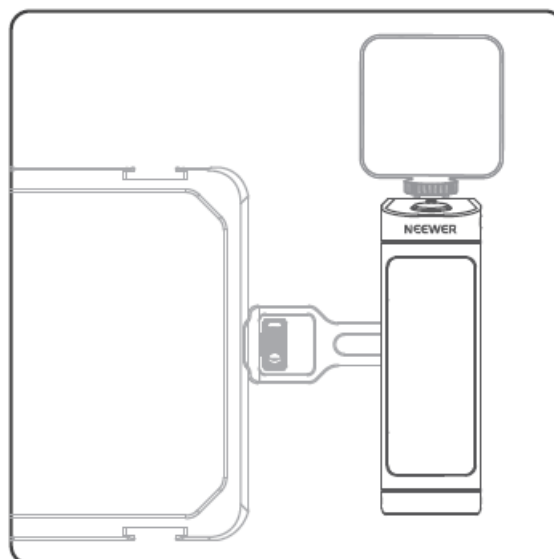

## 2. Installation Instructions for NEWER Dedicated Phone Cage PA006 PA011

### 1. Install the Bluetooth side handle

Attach the NEWER dedicated phone cage adapter to the side of the handle and tighten it with the L

shaped hex key.

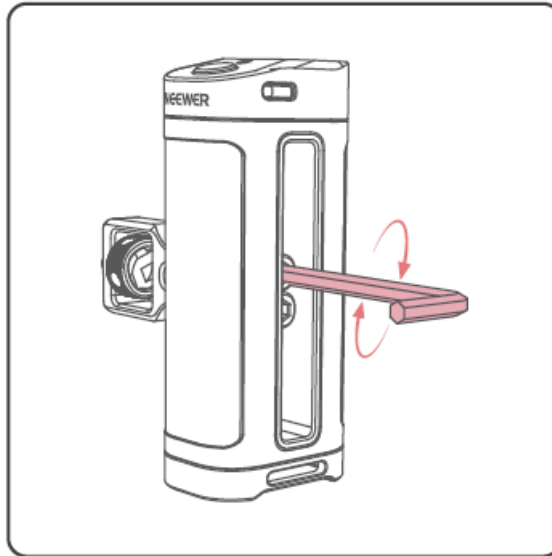

## 2. Install PA006 or PA011

Tighten the screw partly by hand and secure using the L shaped hex key.

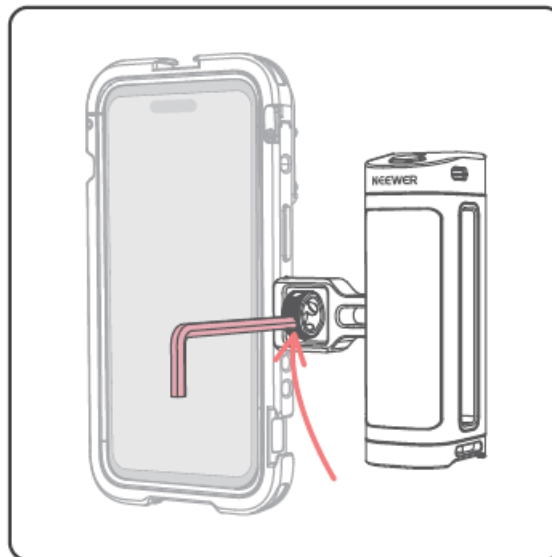

## 3. Installation Instructions for Other Brands of Phone Cages

Choose the narrow positioning pin phone cage adapter and follow the installation instructions mentioned in Step 2.

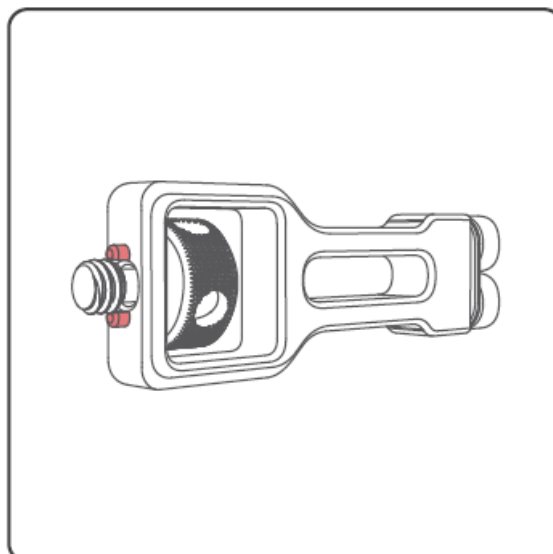

## Specification

Model	PA005E	
Equipment Name	NEEWER-PA005E	
Adaptation System	Android, iOS	
Function	Overview of Functions	<ol style="list-style-type: none"> <li>1. Bluetooth pairing allows control of the phone through the handle button for shooting and recording.</li> <li>2. The Bluetooth handle can be used whilst charging is in progress.</li> </ol>
Power Input	Capacity	100mAh
	Type C Input	5 V
Operation Logic	Power Off Status	Long press to turn on.
	Power On Status -Not Connected to Bluetooth	<ol style="list-style-type: none"> <li>1. After powering on, the blue light will flash quickly for 10 seconds and then automatically turn off after 3 minutes of a slow flashing blue light.</li> <li>2. Long press to turn off the phone directly.</li> </ol>
	Power On Status -Connected to Bluetooth	<ol style="list-style-type: none"> <li>1. The light will go out immediately after a successful Bluetooth connection.</li> <li>2. Short press to trigger the shutter which will cause the blue light to illuminate once.</li> <li>3. Long press to turn off the phone.</li> </ol>
	Charging Status	The red light will remain lit during charging. Once fully charged, the light will change blue until the cable is unplugged.

## FCC Statement

This device complies with Part 15 of the FCC Rules. Operation is subject to the following two conditions: (1) this device may not cause harmful interference, and (2) this device must accept any interference received, including interference that may cause undesired operation.

### CAUTION:

The user is cautioned that changes or modifications not expressly approved by the party responsible for compliance could void the user's authority to operate the equipment.

### NOTE:

This equipment has been tested and found to comply with the limits for a Class B digital device, pursuant to part 15 of the FCC Rules. These limits are designed to provide reasonable protection against harmful interference in a residential installation. This equipment generates, uses and can radiate radio frequency energy and, if not installed and used in accordance with the instructions, may cause harmful interference to radio communications. However, there is no guarantee that interference will not occur in a particular installation. If this equipment does cause harmful interference to radio or television reception, which can be determined by turning the equipment off and on, the user is encouraged to try to correct the interference by one or more of the following measures:

- Reorient or relocate the receiving antenna.
- Increase the separation between the equipment and receiver.
- Connect the equipment into an outlet on a circuit different from that to which the receiver is connected.
- Consult the dealer or an experienced radio/TV technician for help.

#### **FCC RF Radiation Exposure Statement:**

1. This Transmitter must not be co-located or operating in conjunction with any other antenna or transmitter.
2. This equipment complies with RF radiation exposure limits set forth for an uncontrolled environment.

The device has been evaluated to meet general RF exposure requirement. The device can be used in portable exposure condition without restriction.

#### **IC Warning Statements**

##### **Warning Statement**

"This device complies with Industry Canada licence-exempt RSS standard(s). Operation is subject to the following two conditions: (1) this device may not cause interference, and (2) this device must accept any interference, including interference that may cause undesired operation of the device. The digital apparatus complies with Canadian CAN ICES-3 (B)/NMB-3(B).

This radio transmitter has been approved by Industry Canada to operate with the antenna types listed with the maximum permissible gain indicated. Antenna types not included in this list, having a gain greater than the maximum gain indicated for that type, are strictly prohibited for use with this device.

The device has been evaluated to meet general RF exposure requirement. This equipment should be installed and operated with minimum distance Omm between the radiator & your body.

#### **Contact Information**

If you have any questions about product, we are glad to help.

- US +1 732-623-9777
- UK +44 (0) 3330113494

##### **Send us an email**

- [vip@neewer.com](mailto:vip@neewer.com)

- Website: [www.neewer.com](http://www.neewer.com).

#### **UK REP**

##### **Lingfeng Electronic (UK) Ltd**

International House, 10 Churchill Way, Cardiff, CF10 2HE, United Kingdom.

#### **EC REP**

NW Formations GmbH(for authorities only) Hoferstrasse 9B, 71636 Ludwigsburg, Germany.



## Shenzhen Neewer Technology Co.,Ltd.

Room 1903, Block A, Lu Shan Building No. 3023 Chunfeng Rd Luo Hu District, Shenzhen Guangdong 518001, China.

### Follow Us



Facebook



Tiktok



[www.neewer.com](http://www.neewer.com)

[www.neewer.com](http://www.neewer.com).

Shenzhen Neewer Technology Co.,Ltd.

### Documents / Resources

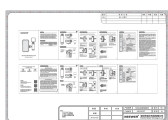

[NEEWER PA005E Side Handle with Wireless Control](#) [pdf] Instruction Manual  
2ANIV-PA005E, 2ANIVPA005E, PA005E, PA005E Side Handle with Wireless Control, Side  
Handle with Wireless Control, Handle with Wireless Control, Wireless Control

[Manuals+](#).