

# nedis WIFIZB10WT Zigbee 3.0 Gateway User Guide



## Contents

- 1 Zigbee Gateway**
  - 1.1 WIFIZB10WT**
  - 1.2 Quick start guide**
    - 1.2.1 Intended use**
    - 1.2.2 Main parts (image A)**
    - 1.2.3 Safety instructions**
    - 1.2.4 Installing the app**
    - 1.2.5 Connecting to the app**
    - 1.2.6 Disposal**
    - 1.2.7 Declaration of Conformity**
- 2 Documents / Resources**
  - 2.1 References**
- 3 Related Posts**

## Zigbee Gateway

To integrate in Nedis SmartLife application

## WIFIZB10WT

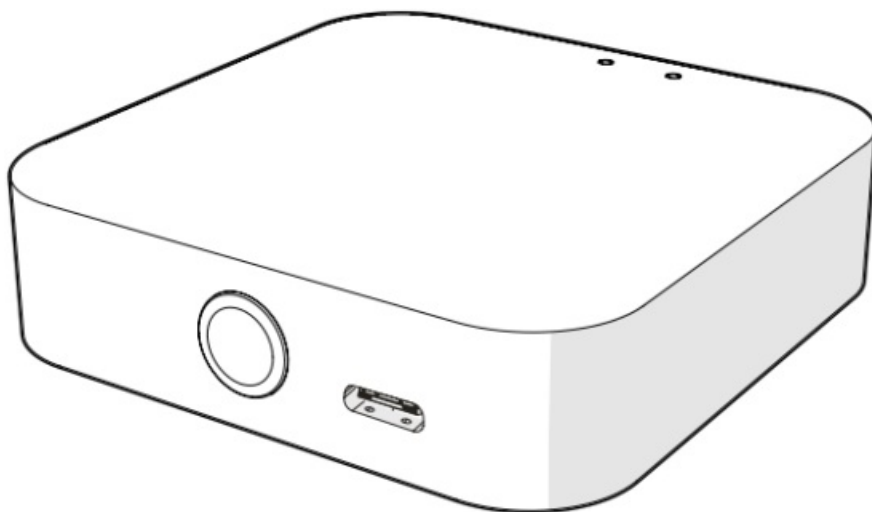

[ned.is/wifizb10wt](https://ned.is/wifizb10wt)



## Quick start guide

[A]

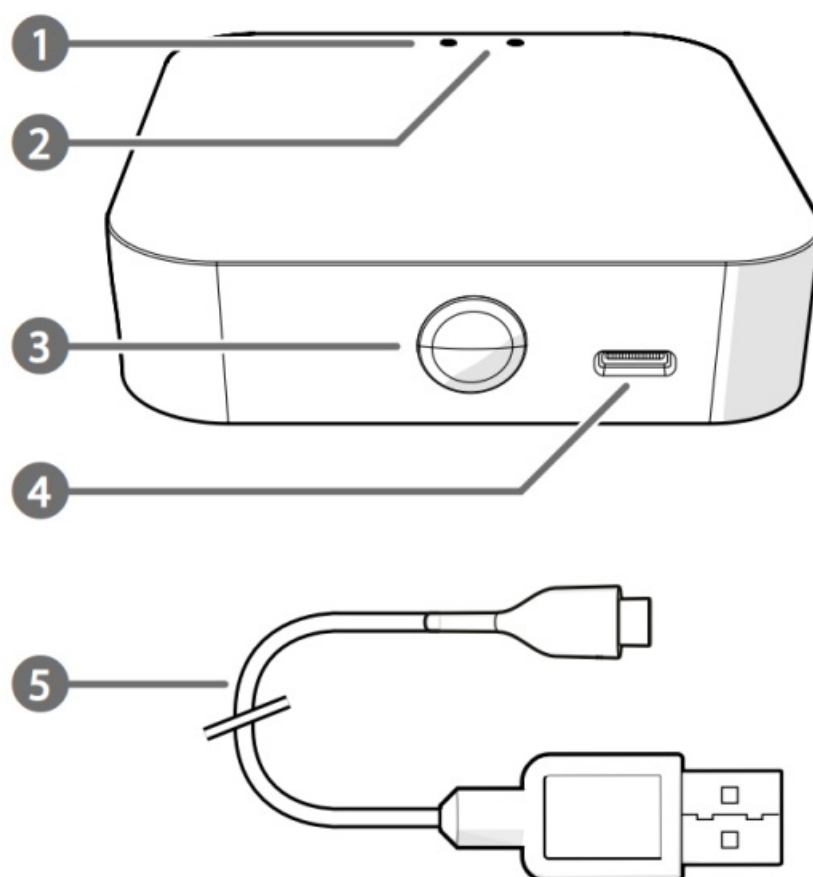

For more information see the extended manual online:  
[ned.is/wifizb10wt](https://ned.is/wifizb10wt)

### Intended use

This product is intended to connect multiple sensors to the Nedis SmartLife app via a wireless Zigbee connection.  
The product is intended for indoor use only.  
The product is not intended for professional use.  
Any modification of the product may have consequences for safety, warranty and proper functioning.

### Main parts (image A)

1. Wi-Fi status LED
2. Zigbee status LED
3. Function button
4. Type-C port
5. Type-C cable

### Safety instructions



WARNING

- Ensure you have fully read and understood the instructions in this document before you install or use the product. Keep this document for future reference.
- Only use the product as described in this document.
- Do not use the product if a part is damaged or defective. Replace a damaged or defective product immediately.
- Do not drop the product and avoid bumping.
- This product may only be serviced by a qualified technician for maintenance to reduce the risk of electric shock.
- Disconnect the product from the power source and other equipment if problems occur.
- Disconnect the product from the power source before service and when replacing parts.
- Do not expose the product to water or moisture.
- Children should be supervised to ensure that they do not play with the product.
- Only power the product with the voltage corresponding to the markings on the product.
- Some wireless products may interfere with implantable medical devices and other medical equipment, such as pacemakers, cochlear implants and hearing aids. Consult the manufacturer of your medical equipment for more information.
- Do not use the product at locations where the use of wireless devices is prohibited due to potential interference with other electronic devices, which may cause safety hazards.

### Installing the app

1. Download the Nedis SmartLife app for Android or iOS on your phone via Google Play or the Apple App Store.
2. Open the Nedis SmartLife app on your phone.
3. Create an account with your mobile phone number or your e-mail address and tap Continue.



You will receive a verification code on your e-mail address.

4. Enter the received verification code.
5. Create a password and tap Done.
6. Tap Add Home to create a SmartLife Home.
7. Set your location, choose the rooms you want to connect with and tap Done.

### Connecting to the app

1. Tap + in the top right corner in the Nedis SmartLife app.
2. Select the product type you want to add from the list.
3. Plug the Type-C cable **A5** into the Type-C port **A4**.
4. Plug the other end of the Type-C cable **A5** into a USB power source.

The Wi-Fi status LED **A1** blinks red to indicate pairing mode is active.



If not, press and hold the function button **A3** for 5 seconds to manually enter the pairing mode.

5. Tap Next step in the app.
6. Enter the Wi-Fi network data and tap Confirm.
7. Type in a name for the product and tap Done.

The product is now ready for use.



For more information on how to connect and use the different sensors with the product, consult the manual of the sensor.

## Disposal



The product is designated for separate collection at an appropriate collection point. Do not dispose of the product with household waste.  
For more information, contact the retailer or the local authority responsible for the waste management.

## Declaration of Conformity

We, Nedis B.V. declare as manufacturer that the product WIFIZB10WT from our brand Nedis®, produced in China, has been tested according to all relevant CE standards and regulations and that all tests have been passed successfully. This includes, but is not limited to the RED 2014/53/EU regulation.

The complete Declaration of Conformity (and the safety datasheet if applicable) can be found and downloaded via:  
[nedis.com/wifizb10wt#support](https://nedis.com/wifizb10wt#support)

## Nedis BV

De Tweeling 28, 5215 MC 's-Hertogenbosch - The Netherlands  
[service@nedis.com](mailto:service@nedis.com)

## Documents / Resources

	<p><a href="#">nedis WIFIZB10WT Zigbee 3.0 Gateway</a> [pdf] User Guide WIFIZB10WT Zigbee 3.0 Gateway, WIFIZB10WT, Zigbee 3.0 Gateway, 3.0 Gateway</p>
--	--

## References

-  [Nedis | Your wholesaler of consumer electronics](#)
- [User Manual](#)

## Manuals+, Privacy Policy

This website is an independent publication and is neither affiliated with nor endorsed by any of the trademark owners. The "Bluetooth®" word mark and logos are registered trademarks owned by Bluetooth SIG, Inc. The "Wi-Fi®" word mark and logos are registered trademarks owned by the Wi-Fi Alliance. Any use of these marks on this website does not imply any affiliation with or endorsement.