



nedis WIFIOFS20FBK Smart WiFi Floodlight with Sensor User Guide

[Home](#) » [nedis](#) » nedis WIFIOFS20FBK Smart WiFi Floodlight with Sensor User Guide 

Contents

- [1 nedis WIFIOFS20FBK Smart WiFi Floodlight with Sensor](#)
- [2 Intended use](#)
- [3 Specifications](#)
- [4 Main parts \(image A\)](#)
- [5 Safety instructions](#)
- [6 Install the mounting bracket](#)
- [7 Replacing the power cable](#)
- [8 Installing the Nedis Smartlife app](#)
- [9 Connecting the app](#)
- [10 PIR sensor control \(WIFILOS20FBK only\)](#)
- [11 Declaration of Conformity](#)
- [12 Documents / Resources](#)
- [13 Related Posts](#)

nedis

nedis WIFILOFS20FBK Smart WiFi Floodlight with Sensor



Intended use

The Ned is Wi-Fi based Floodlight is used to illuminate indoor and outdoor areas. This product is intended for indoor and outdoor use. The product is not intended for professional use. The product can be controlled with the Nedis Smartlife app. Any modification of the product. Any modification of the product may have consequences for safety, warranty, and proper functioning

Specifications

Product	SmartWiFi Floodlight	SmartWiFi Floodlight with sensor
---------	----------------------	----------------------------------

Dimensions (l x w x h)	126 x 142 x 43 1176 x 128 x 59 mmmm	
Power input	220 – 240 VDC; 150 mA	
Light colour	RGB + 3000 – 6500 K	3000 – 6500 K
Wi-Fi transmission protocol	802.11bgn	
Wi-Fi frequency range	2412 – 2484 GHz	
Maximum transmit power	16dB	
Antenna gain	1.5 dB	
Operating temperature	-20 °C – -40 °C	
IP rating	IP65	I Lp44

Main parts (image A)

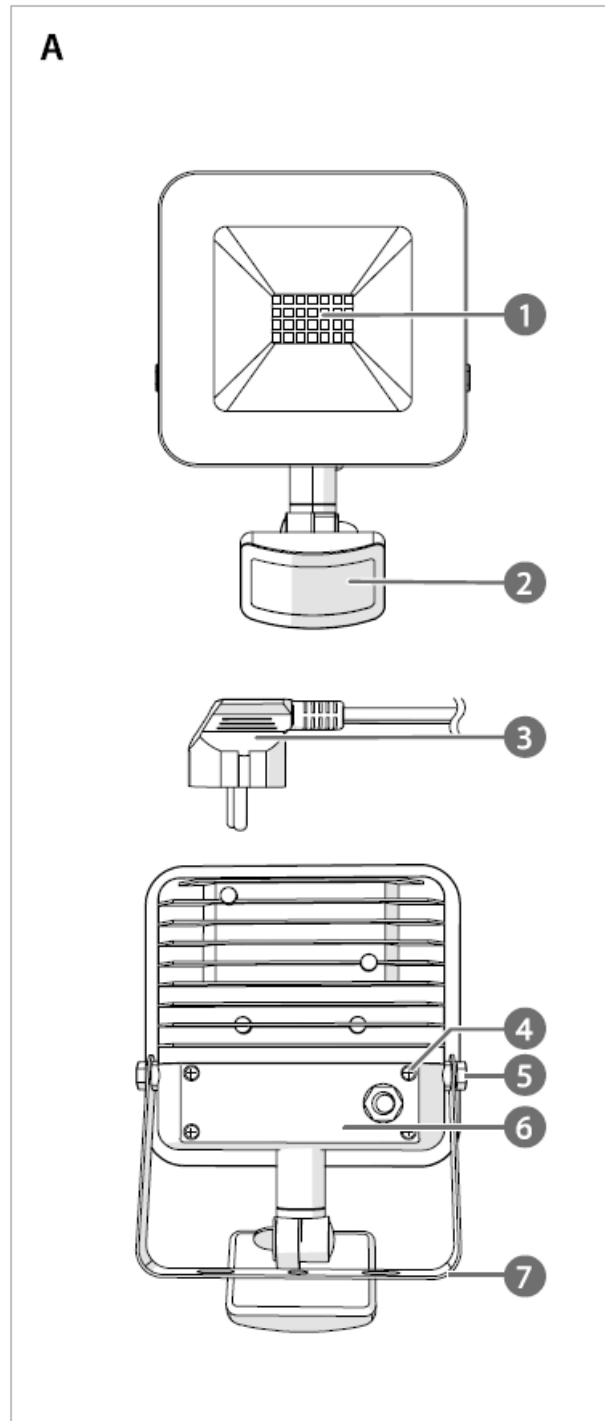

- LEADS
- PIR sensor
- Power cable
- Junction box screws
- Mounting bracket bolts
- Junction box cover
- Mounting bracket
- WIFILOFS20FBK only

Safety instructions

- Ensure you have fully read and understood the instructions in this document before you install or use the

product. Keep the packaging and this document for future reference.

- Only use the product as described in this document.
- Do not use the product if a part is damaged or defective. Replace a damaged or defective product immediately.
- Do not drop the product and avoid bumping.
- This product may only be serviced by a qualified technician for maintenance to reduce the risk of electric shock.
- Disconnect the product from the power source and other equipment if problems occur.
- Disconnect the product from the power source before service and when replacing parts.
- Only use the provided power cable.
- Do not unplug the product by pulling on the cable. Always grasp the plug and pull.
- Children should be supervised to ensure that they do not play with the product.
- The only power the product with the voltage corresponding to the markings on the product.
- Do not look directly into the light, this may cause eye damage.
- Some wireless products may interfere with implantable medical devices and other medical equipment, such as pacemakers, cochlear implants and hearing aids. Consult the manufacturer of your medical equipment for more information.
- Do not use the product at locations where the use of wireless devices is prohibited due to potential interference with other electronic devices, which may cause safety hazards.

Install the mounting bracket

Make sure the power cable is disconnected from the power outlet.

1. Check what plugs and screws are best suited for the intended surface. The maximum diameter of Af) is 4.5 mm.
2. Remove the mounting bracket bolts AC, from the product.
3. Remove the mounting bracket Af) from the product.
4. Use Af) to mark the drill locations with a pencil.
5. Drill the holes.
6. Insert wall plugs.
7. Fasten AO to the wall with screws.
8. Attach the product to AO by fastening AO.

Replacing the power cable

You can replace the power cable with a longer or existing power cable.

1. Make sure the power cable is disconnected from the power outlet.
2. Open the junction box cover AG).
3. Disconnect the live, neutral, and earth wires.
4. Connect the new live, neutral, and earth wires.
5. Close AG).
6. Tighten AC,

Installing the Nedis Smartlife app

1. Download the Ned is a Smartlife app for Android or iOS on your phone via Google Play or the Apple App Store.
2. Open the Nedis Smartlife app on your phone.
3. Create an account with your e-mail address and tap Continue.
4. Enter the received verification code.
5. Create a password and tap Done.
6. Tap Add Home to create a Smartlife Home.
7. Set your location, choose the rooms you want to connect with, and tap Done.

Connecting the app

1. Make sure Bluetooth is enabled on your smartphone.
2. Open the Nedis Smartlife app on your smartphone.
3. Register or log in to your account.
4. Tap+ in the top right corner.
5. Insert the power plug into a power outlet.
6. Select the product type you want to add from the list.
7. The LEDs AO blinks to indicate pairing mode is active. 0 If the LEDs are not blinking, switch on the product, and after 10 seconds, switch the product off and on 3 times to manually enter the pairing mode.

PIR sensor control (WIFILOS20FBK only)

After connecting the device with the app, the control page opens automatically.

1. Tap on Sensor to enter the sensor control menu.
2. Switch the sensor on or off.
3. Set the detection distance.
4. Set the detection sensitivity.
5. Set the light duration after detection.

PIR sensor stand-by light {WIFILOS20FBK only)

1. Activate the Slight bright option in the sensor control menu
2. Set the stand-by light brightness.
3. Set the stand-by light duration.
4. The product enters the stand-by mode after the full light duration.

Declaration of Conformity

We, Ned is B.V. declare as a manufacturer that the product WIFIOFC20FBK/WIFILOFS20FBK from our brand Nedis", produced in China, has been tested according to all relevant CE standards and regulations and that all tests have been passed successfully. This includes, but is not limited to the RED 2014/53/EU regulation. The complete Declaration of Conformity (and the safety datasheet if applicable) can be found and downloaded via:

- nedis.com/wifilofc20fbk#support
- nedis.com/wifilofs20fbk#support
- For additional information regarding the compliance, contact the customer service:
- Web: www.nedis.com
- E-mail: service@nedis.com
- Nedis B.V., de Tweeling 28
- 5215 MC 's-Hertogenbosch, the Netherlands

Documents / Resources

 <p>nedis Smart WiFi Floodlight with Sensor The motion and light sensor WIFILOFS20FBK WIFILOFS20FBK</p>	<p>nedis WIFILOFS20FBK Smart WiFi Floodlight with Sensor [pdf] User Guide WIFILOFS20FBK, Smart WiFi Floodlight with Sensor</p>
--	--