



nedis MAGLE2WT Dimmable Magnifier LED Lamp with Clamp User Guide

[Home](#) » [nedis](#) » nedis MAGLE2WT Dimmable Magnifier LED Lamp with Clamp User Guide 

Contents

- [1 nedis MAGLE2WT Dimmable Magnifier LED Lamp with Clamp](#)
- [2 Product Information](#)
- [3 Product Usage Instructions](#)
- [4 Intended use](#)
- [5 Main parts](#)
- [6 Safety instructions](#)
- [7 Installing the product](#)
- [8 Documents / Resources](#)
 - [8.1 References](#)
- [9 Related Posts](#)

nedis

nedis MAGLE2WT Dimmable Magnifier LED Lamp with Clamp



Product Information

Specifications

- Product Name: Dimmable Magnifier LED Lamp with clamp
- Model: MAGLE2WT
- Intended Use: Magnifying and illuminating work surfaces
- Indoor Use Only

Product Usage Instructions

Safety Instructions

WARNING: Risk of fire.

Installing the Product

1. Fix the desk clamp to the worktop.
2. Insert the pin into the desk clamp.
3. Plug the power cable into the power supply port of the product and the other end into a power outlet.
4. Adjust the lamp head to the desired position using the hinges and wingnuts.
5. Use the power button to switch on the lamp.

Disposal

This product should not be thrown away with other household waste. Please recycle it responsibly to promote the sustainable reuse of raw materials. Contact the store where the product was purchased for recycling options.

Frequently Asked Questions (FAQ)

Q: Can this product be used outdoors?

A: No, this product is intended for indoor use only.

Q: Is this product suitable for professional use?

A: No, this product is intended for consumers only and not for professional use.

Q: How do I adjust the lamp head?

A: You can adjust the lamp head to the desired position by using the hinges and wingnuts provided.

Quick start guide

Dimmable Magnifier LED Lamp with clamp

For more information see the extended manual online: ned.is/magle2wt

Intended use

- This product is intended for magnifying and illuminating a work surface.
- This product is intended for consumers only.
- The product is not intended for professional use.
- The product is intended for indoor use only.
- Any modification of the product may have consequences for safety, warranty, and proper functioning.

Main parts

(image A)

A

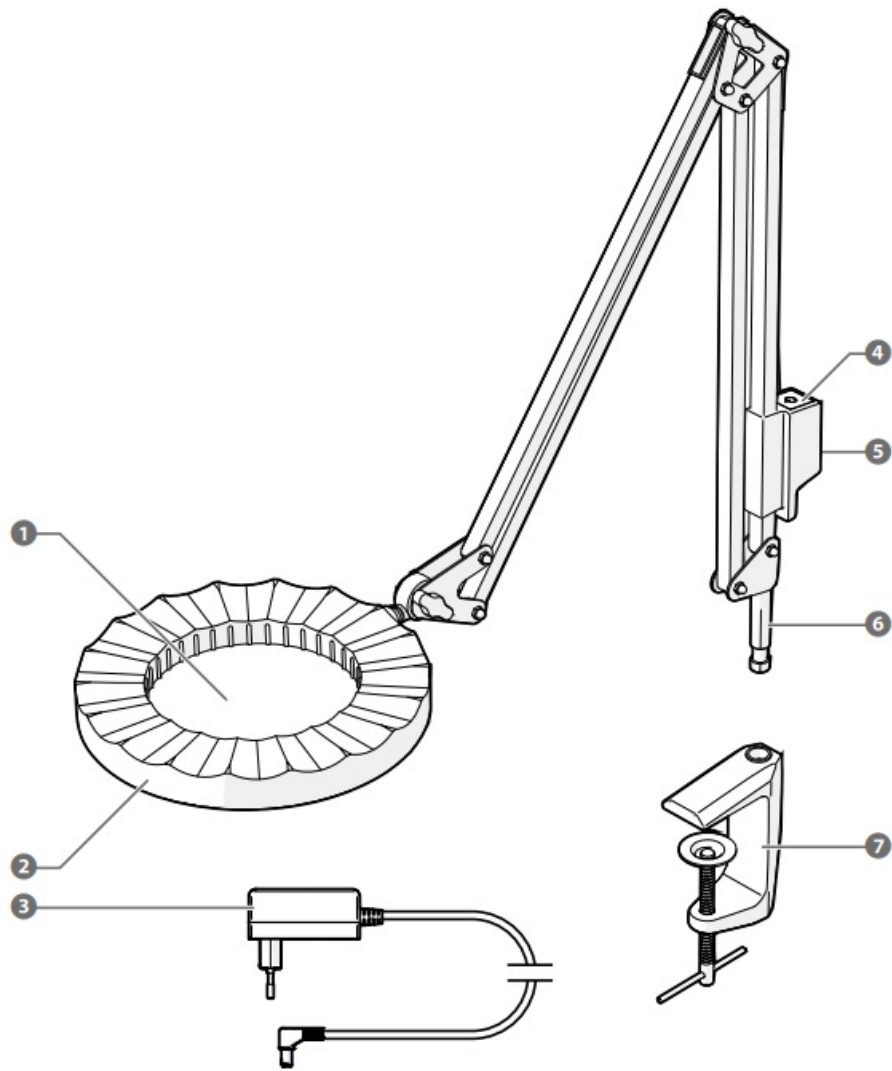

1. Lens
2. Lamp head
3. Power cable
4. Power button
5. Power supply port
6. Pin
7. Desk clamp

Safety instructions

WARNING

- Ensure you have fully read and understood the instructions in this document before you install or use the product. Keep the packaging and this document for future reference.
- Only use the product as described in this document.
- Do not leave the product unattended when switched on.
- Do not use the product if a part is damaged or defective. Replace a damaged or defective product immediately.

- Do not attempt to open, disassemble, repair, tamper with, or modify the product.
- Disconnect the product from the power source before cleaning the product.
- Disconnect the product from the power source before service and when replacing parts.
- Always keep the power cable and the product away from usual walkways.
- Do not drop the product and avoid bumping.
- Do not open the product. There are no user serviceable parts inside.
- This product may only be serviced by a qualified technician for maintenance to reduce the risk of electric shock.
- Do not immerse the product in water or other liquids.
- Do not expose the product to water, rain, moisture, or high humidity.
- Do not leave the lens unattended in direct sunlight to reduce the risk of fire.

Installing the product

(image B)

1. Fix the desk clamp A7 to work top.
2. Insert the pin A6 into the desk clamp A7.
3. Plug the power cable A3 into the power supply port A5 of the product, and the other end into a power outlet.
4. Adjust the lamp head A2 to the desired position, by adjusting the hinges and wingnuts.
5. Use the power button A4 to switch on the lamp.

B

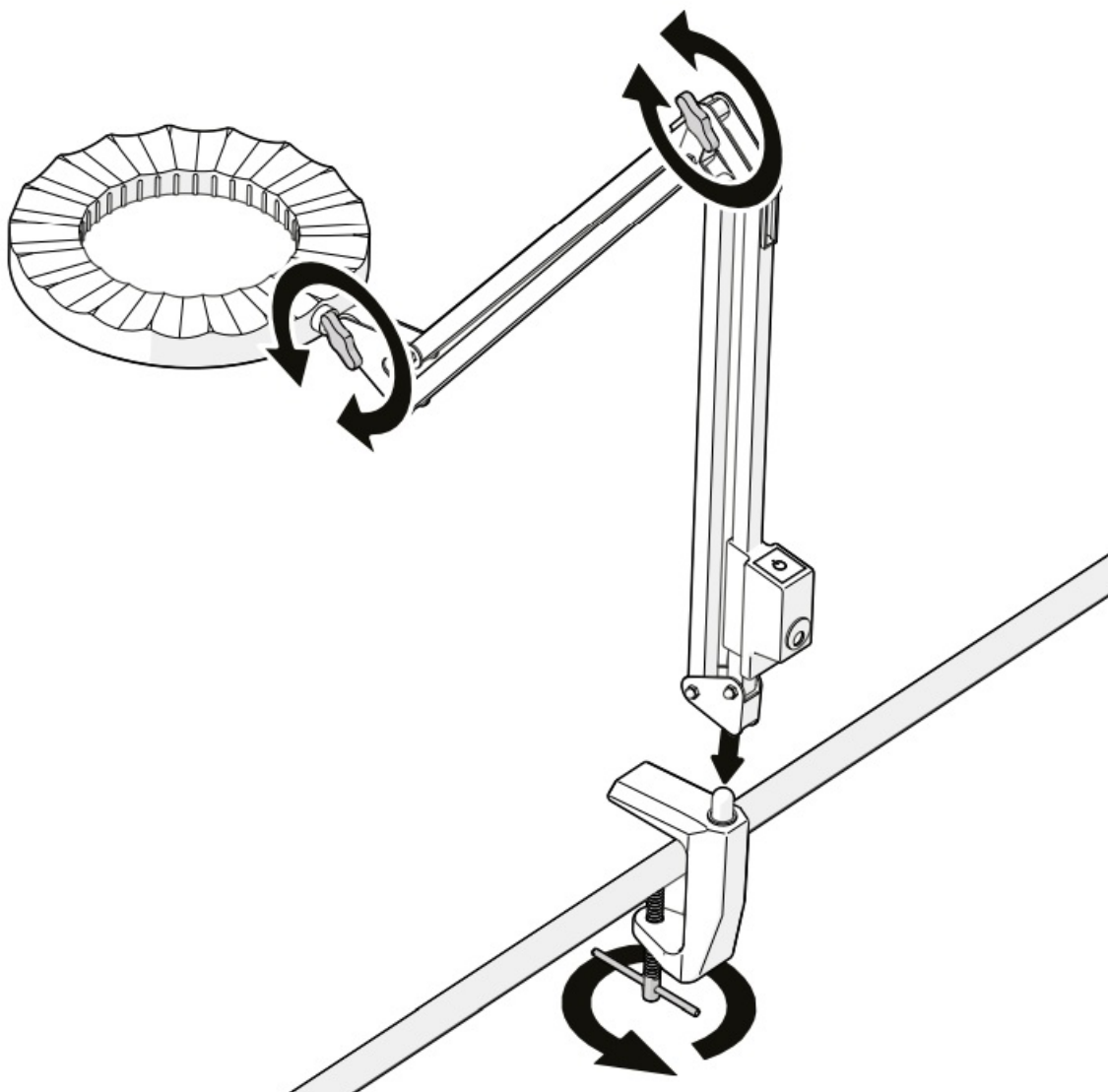

Disposal



■ This symbol indicates that this product should not be thrown away with other household waste throughout the EU. To prevent possible harm to the environment or human health by uncontrolled waste disposal, you are responsible for recycling it so that it can promote the sustainable reuse of raw materials. To return your used product, you can use the regular return and collection systems or contact the store where the product was purchased. They can recycle this product for the environment.

Nedis BV

De Tweeling 28, 5215 MC 's-Hertogenbosch – The Netherlands service@nedis.com

Documents / Resources

	<p>nedis MAGLE2WT Dimmable Magnifier LED Lamp with Clamp [pdf] User Guide MAGLE2WT Dimmable Magnifier LED Lamp with Clamp, MAGLE2WT, Dimmable Magnifier LED Lamp with Clamp, Magnifier LED Lamp with Clamp, LED Lamp with Clamp, Lamp with Clamp, Clamp, Lamp</p>
--	---

References

- [User Manual](#)

Manuals+, Privacy Policy

This website is an independent publication and is neither affiliated with nor endorsed by any of the trademark owners. The "Bluetooth®" word mark and logos are registered trademarks owned by Bluetooth SIG, Inc. The "Wi-Fi®" word mark and logos are registered trademarks owned by the Wi-Fi Alliance. Any use of these marks on this website does not imply any affiliation with or endorsement.