



NCASE M1 Cooling and Noise Performance Instruction Manual

[Home](#) » [NCASE](#) » NCASE M1 Cooling and Noise Performance Instruction Manual 

Contents

- [1 NCASE M1 Cooling and Noise Performance](#)
- [2 Product Specifications](#)
- [3 Frequently Asked Questions \(FAQ\)](#)
 - [3.1 Q: Can I use this case for a gaming PC?](#)
 - [3.2 Q: Are additional accessories included in the package?](#)
 - [3.3 Q: How many case feet are included?](#)
- [4 Documents / Resources](#)
 - [4.1 References](#)

NCASE M1 Cooling and Noise Performance

INSTRUCTION MANUAL

CAUTION: do NOT overtighten screws. Once resistance is encountered, do not tighten more than one-quarter turn. Each fastener is different in length or head-shape, and putting them next to each other is an excellent way to identify them.

Screw-5

M3 Flat Sunk Screw

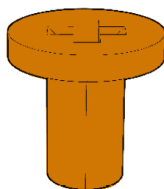

Standoff-6

M3 Female Standoff Screw



ThumbScrew-10

M3 Thumb Screw

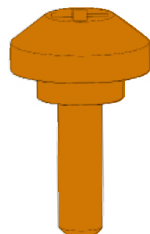

CScrew-8

M3 Countersunk Screw

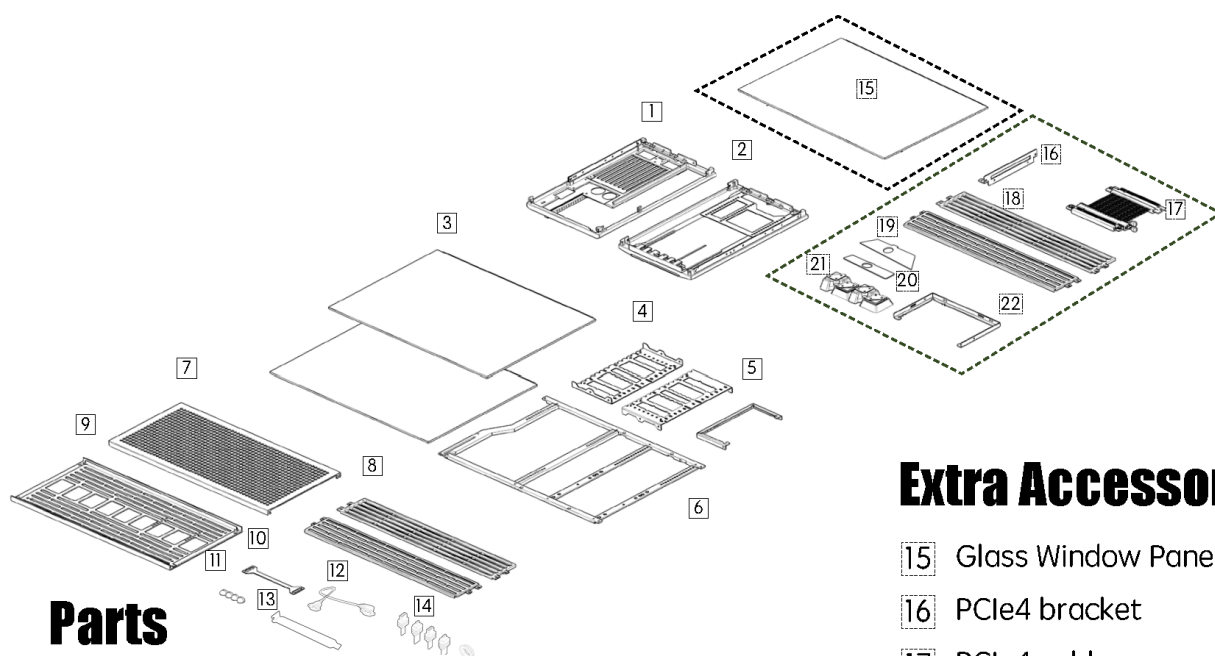
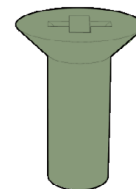

Parts

- | | |
|---------------------|--------------------------|
| 1 Rear Panel | 8 Dual Blade Fan Bracket |
| 2 Front Panel | 9 Bottom Panel |
| 3 Side Panels x2 | 10 Dual 120mm Fan Plate |
| 4 Drive Brackets x2 | 11 Case Feet x4 |
| 5 SFX PSU Bracket | 12 Power Cable |
| 6 Motherboard Tray | 13 PCIe Covers |
| 7 Top Panel | 14 USB IO Cables |

Extra Accessory

- | |
|-----------------------------|
| 15 Glass Window Panel |
| 16 PCIe4 bracket |
| 17 PCIe4 cable |
| 18 Fan + Radiator Bracket |
| 19 Front IO cover (A) |
| 20 Front IO Cover (R) |
| 21 15mm Tall Angled Feet |
| 22 ATX Power Supply Bracket |

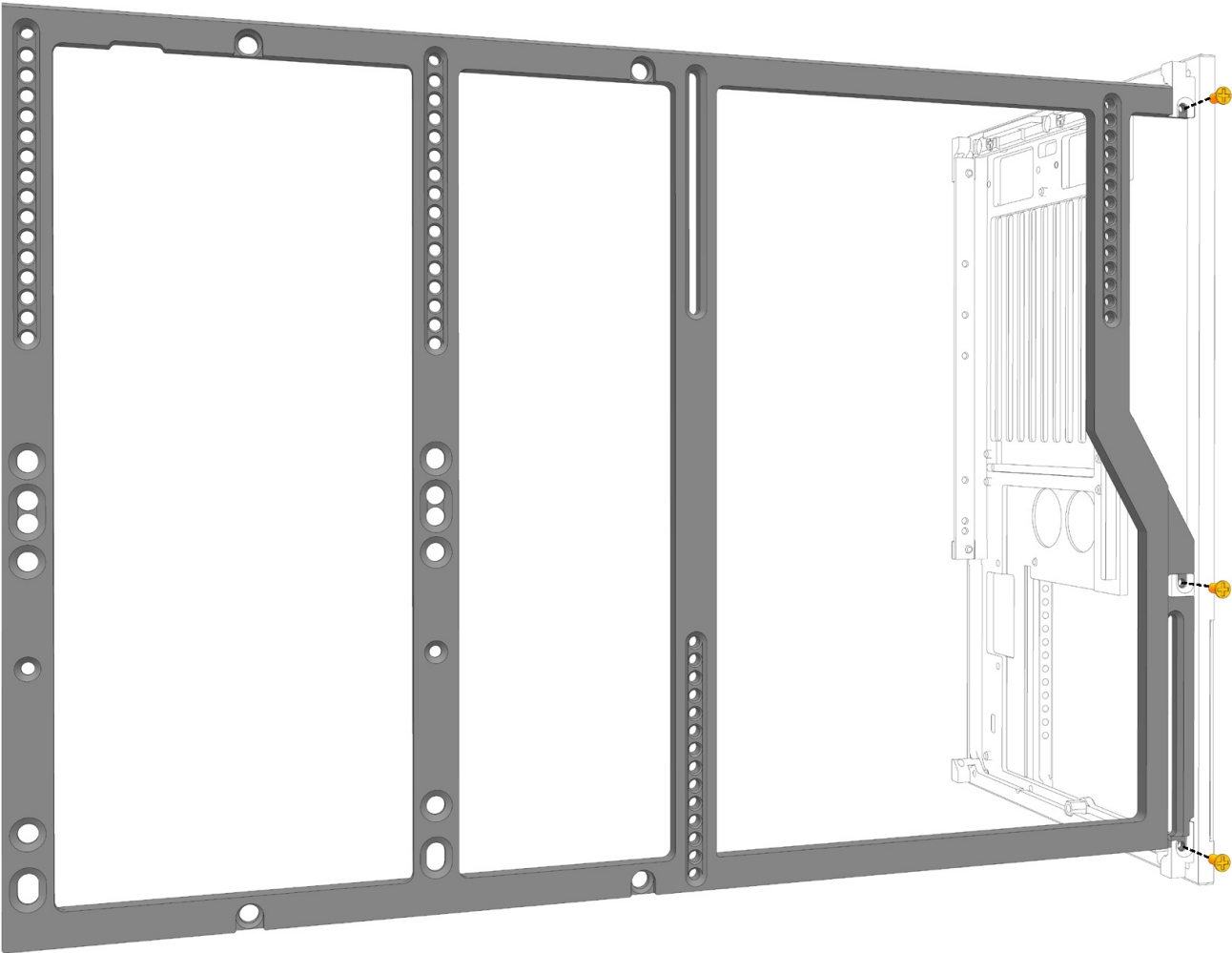

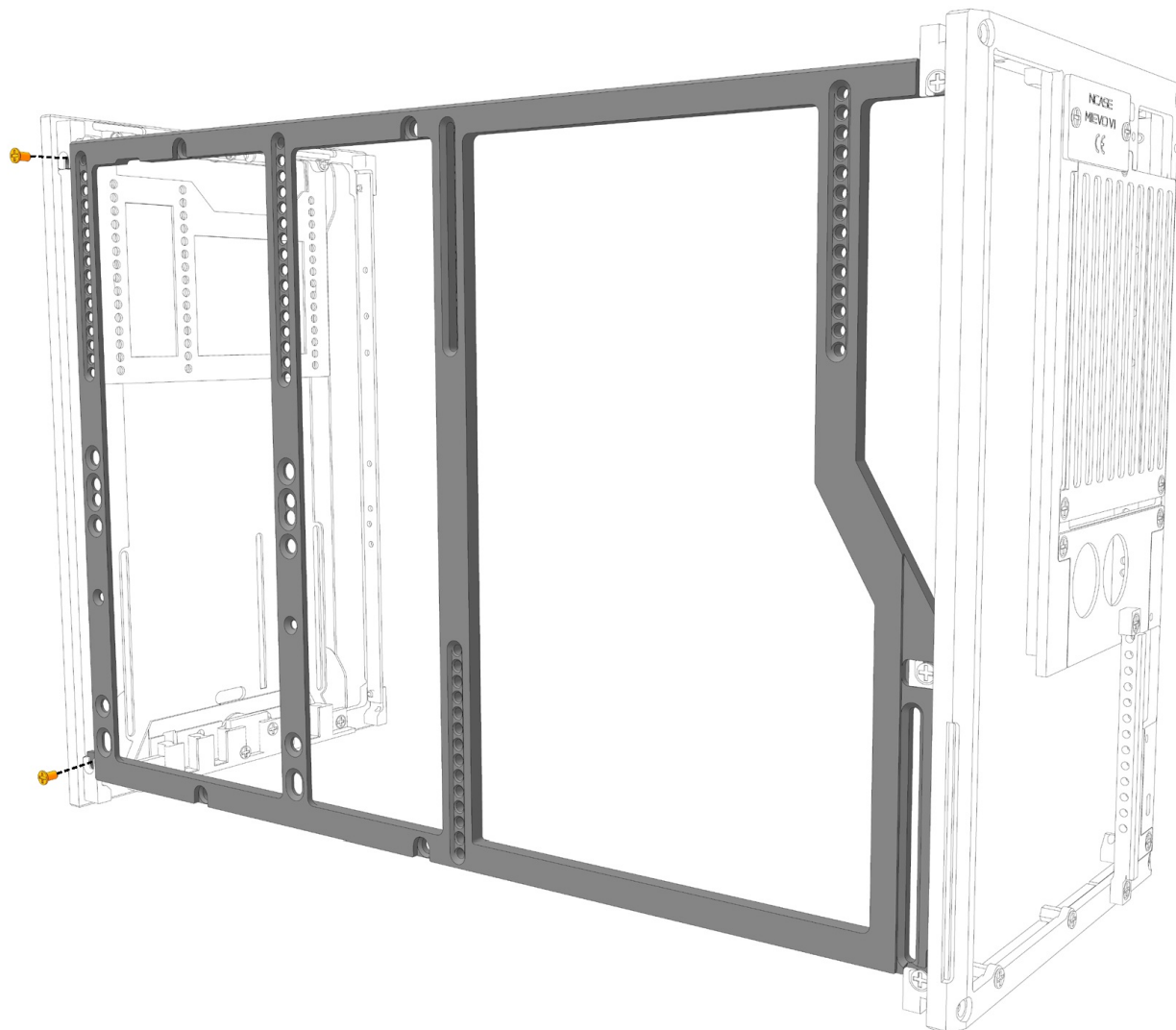

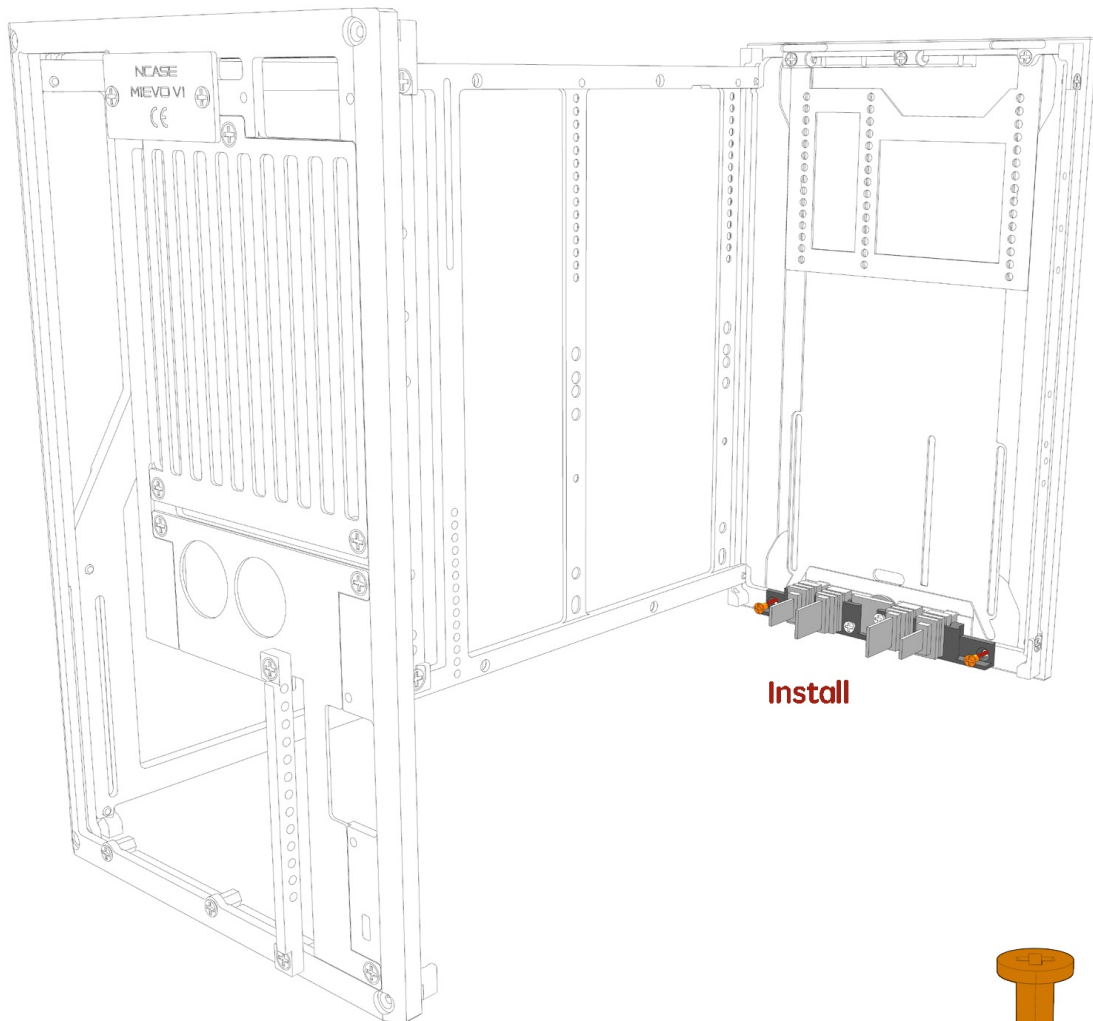
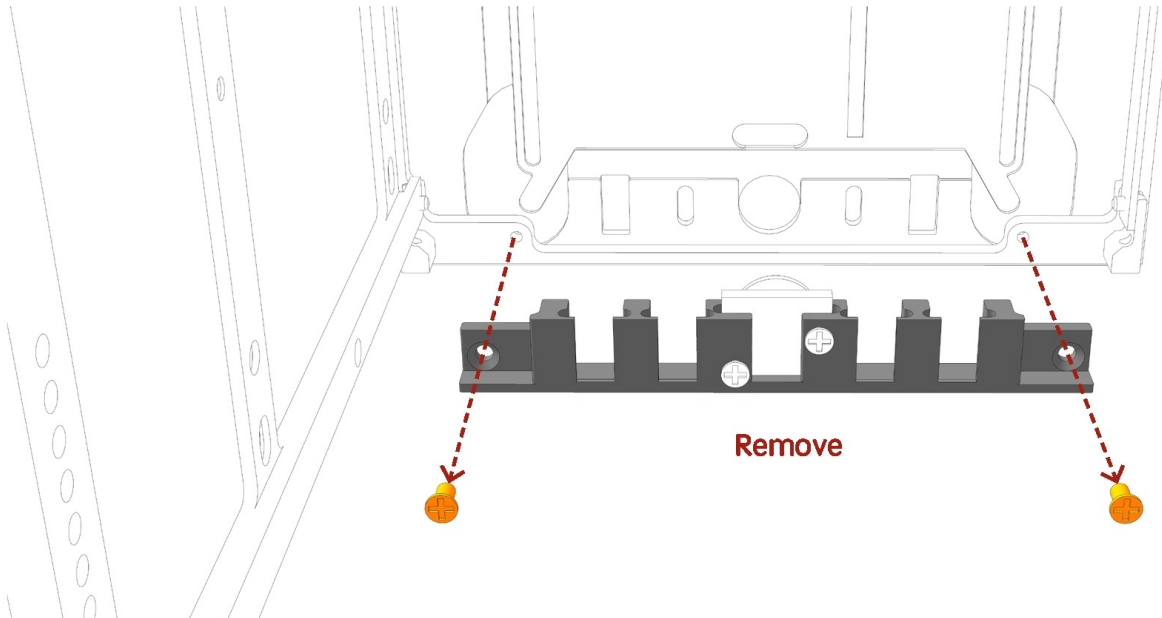

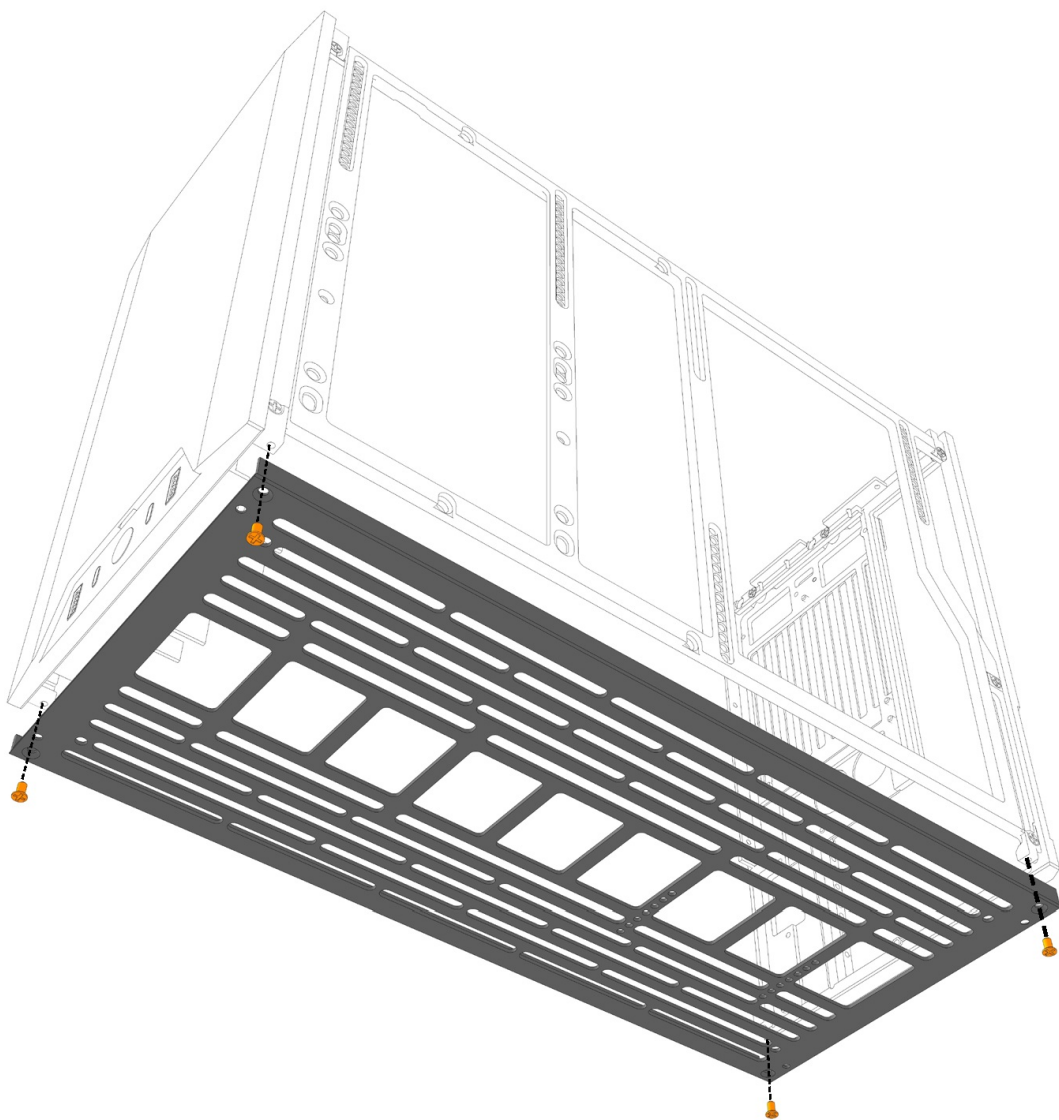

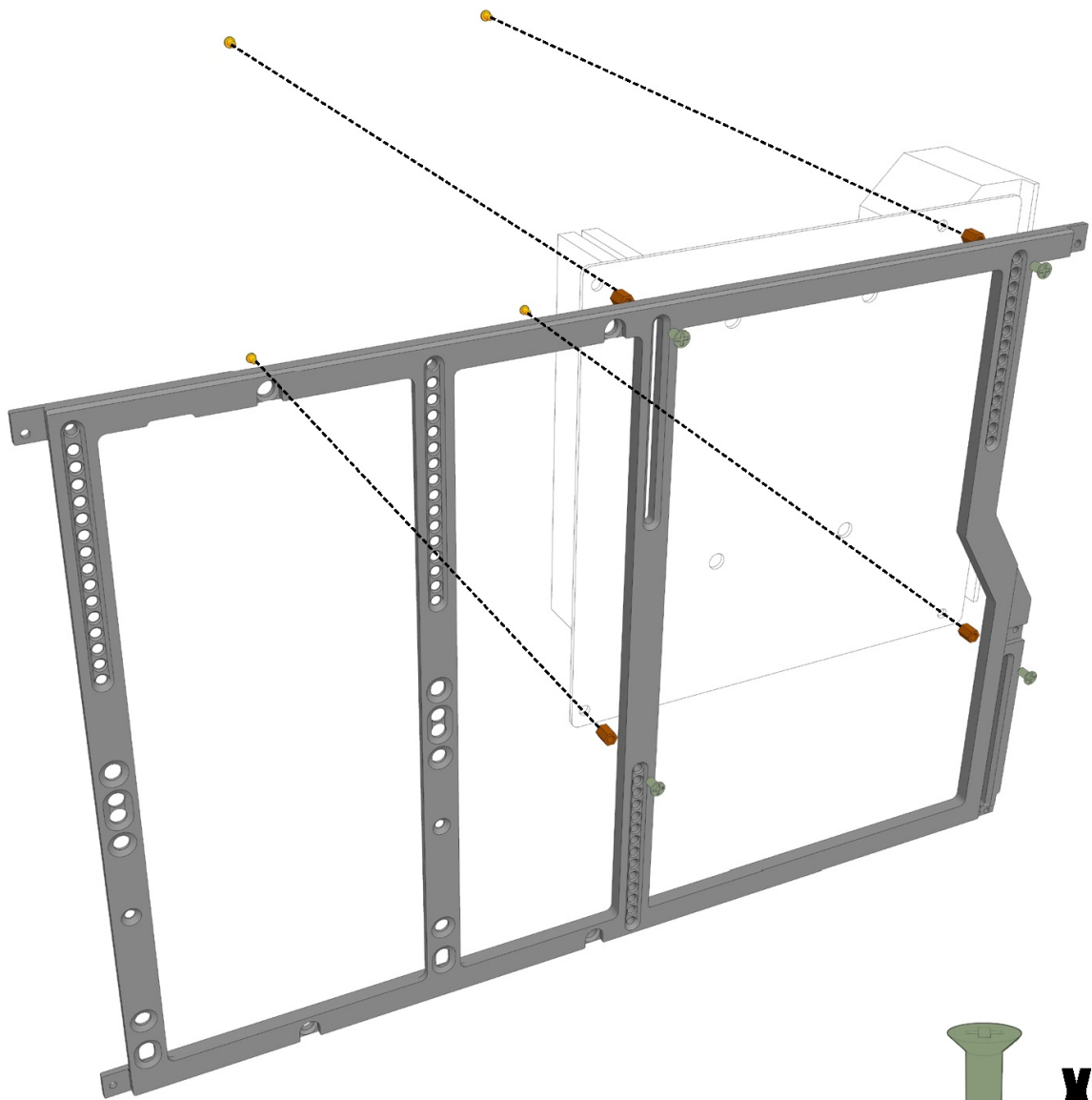

X4

M3-CS-8



X4

M3-FSS-6

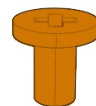

X4

M3-FS-5

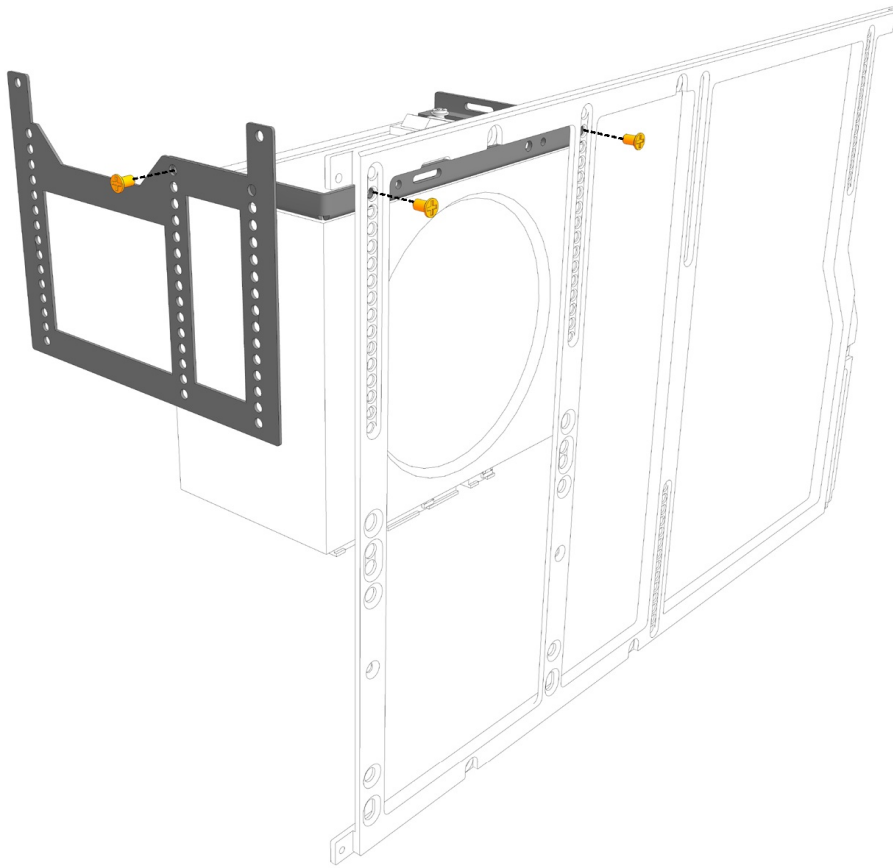

X3

M3-FS-5

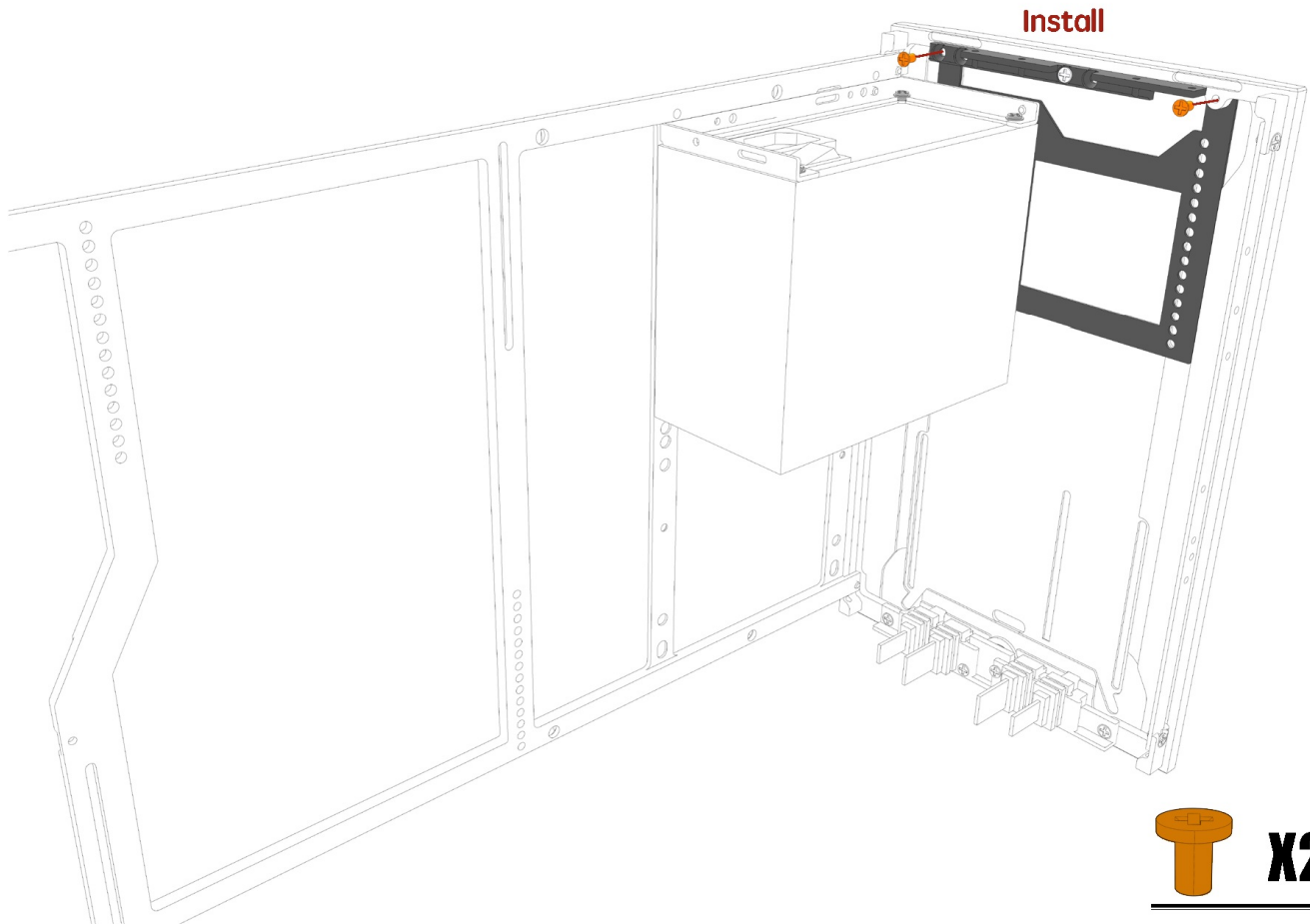

X2

M3-FS-5

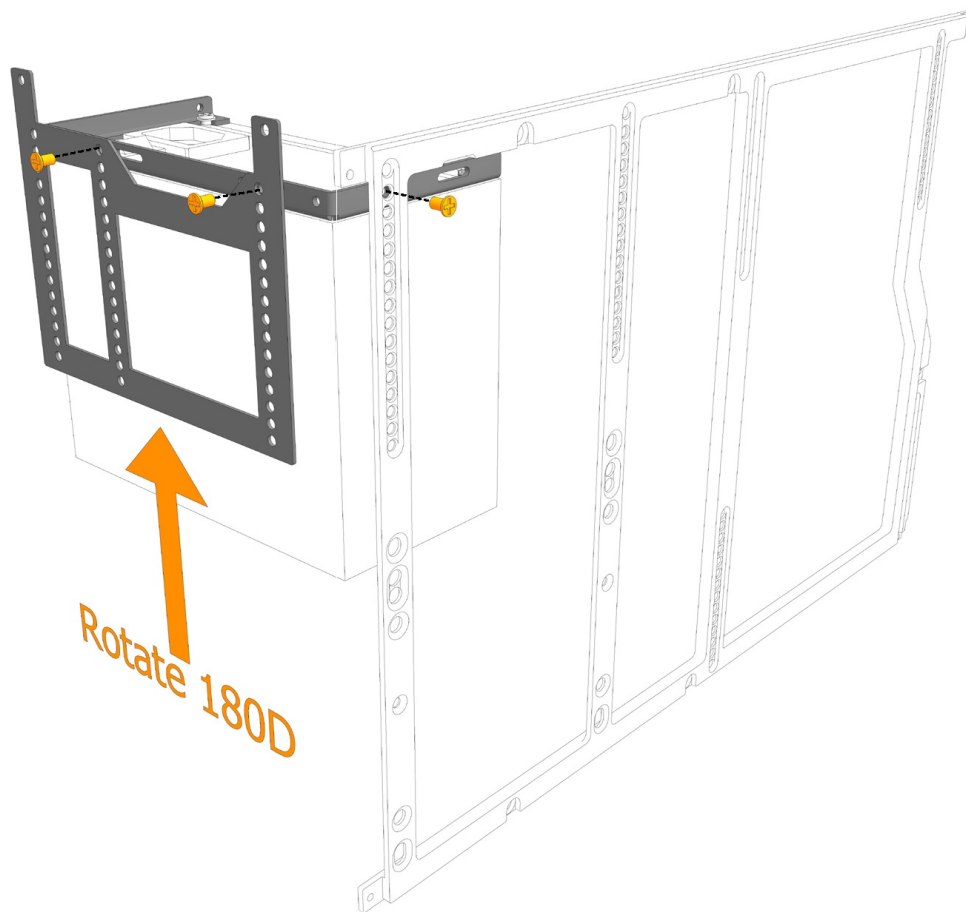

X3

M3-FS-5

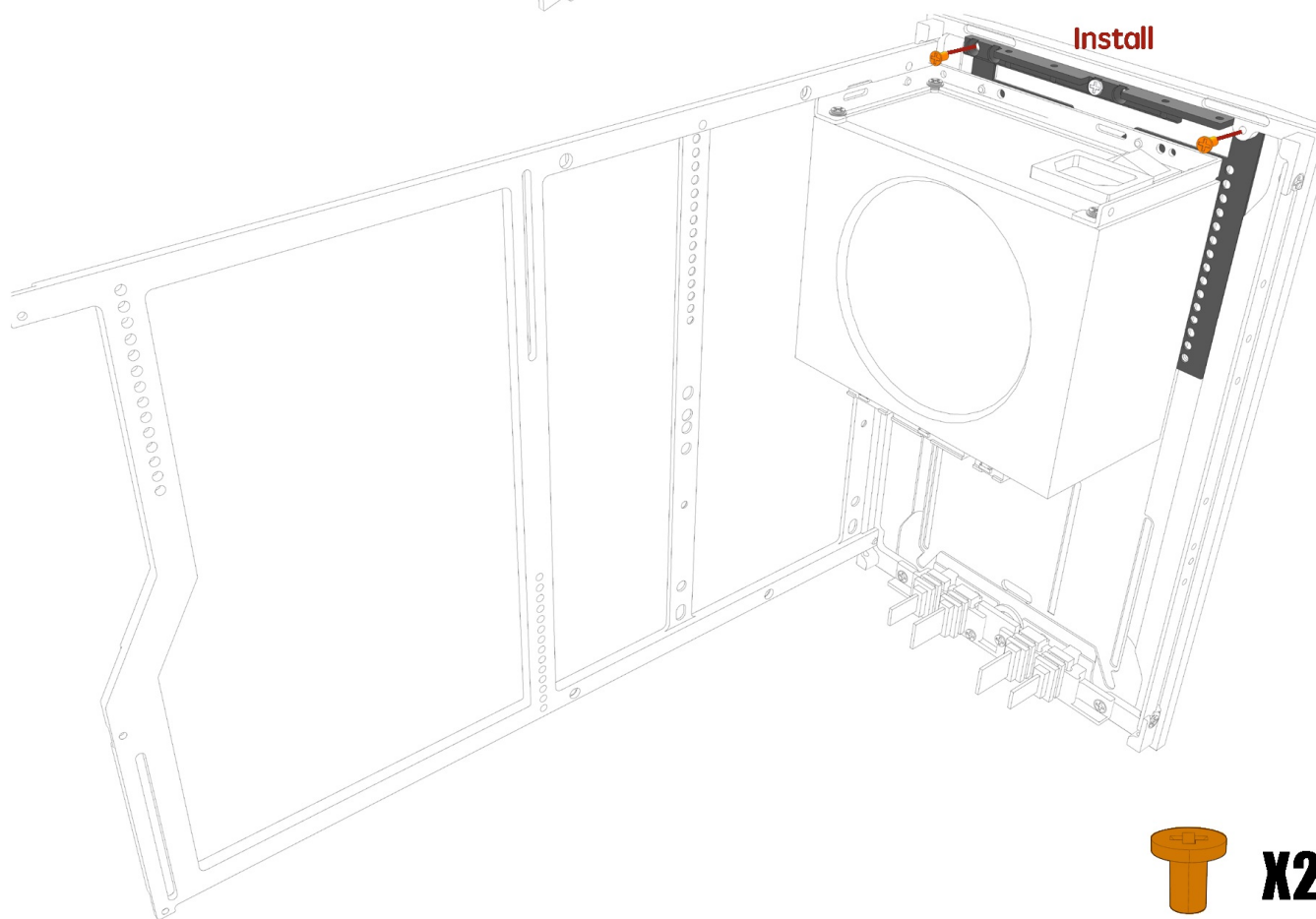

X2

M3-FS-5

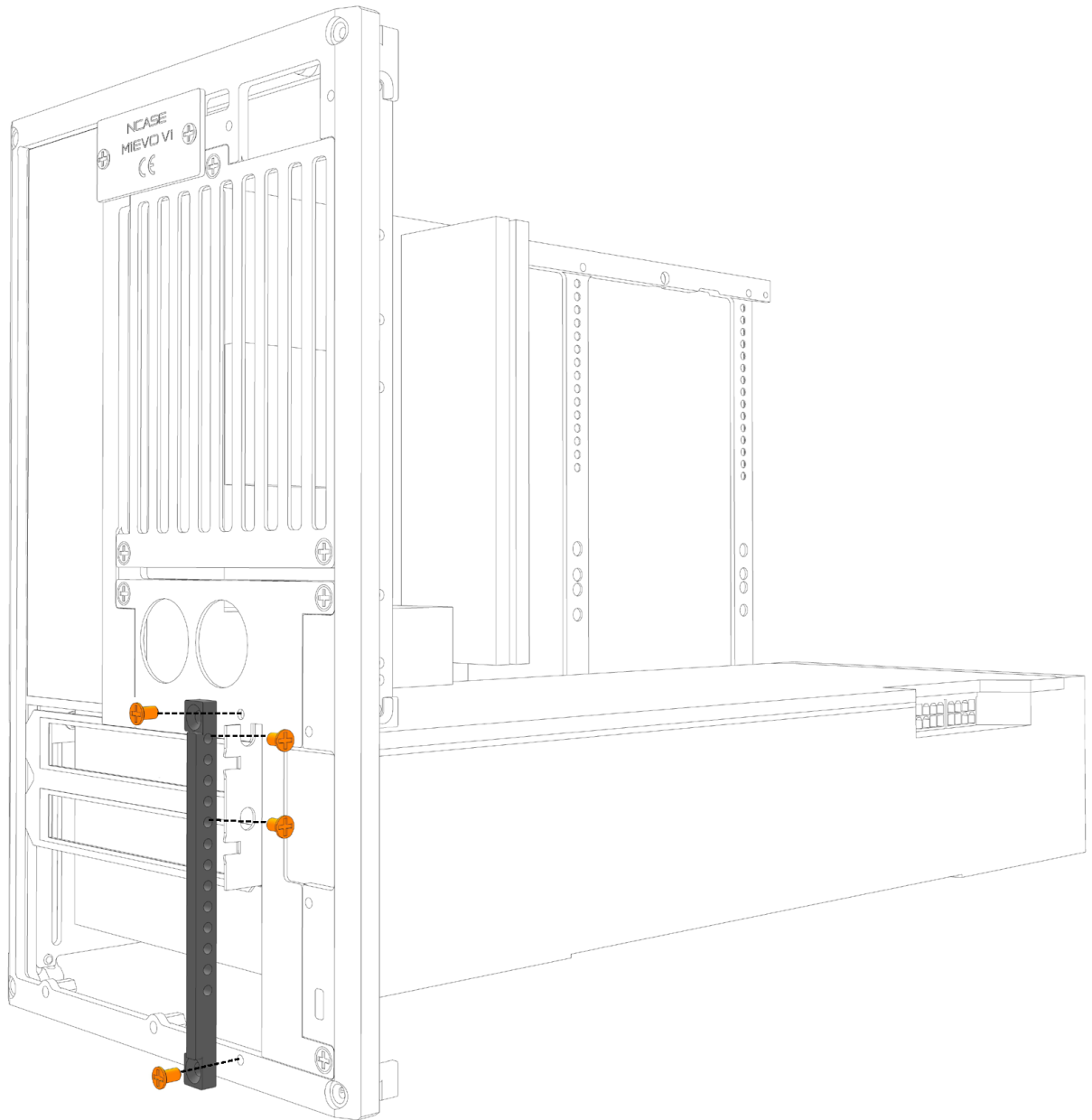

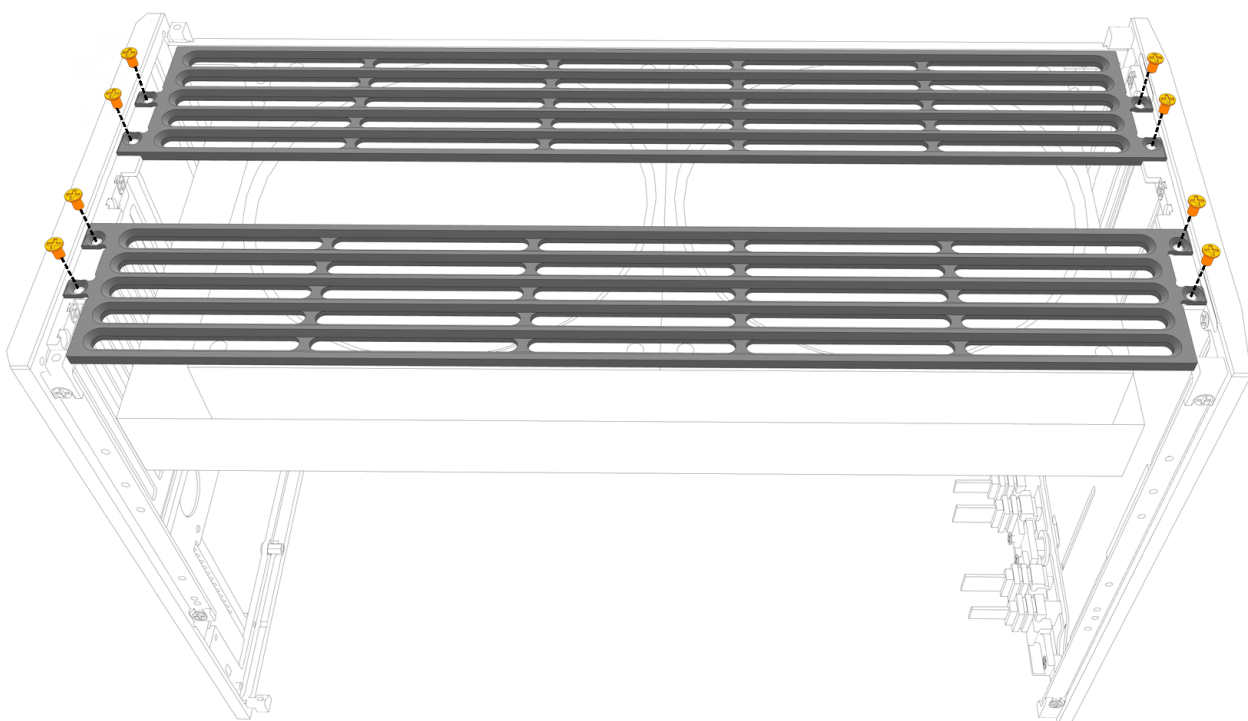
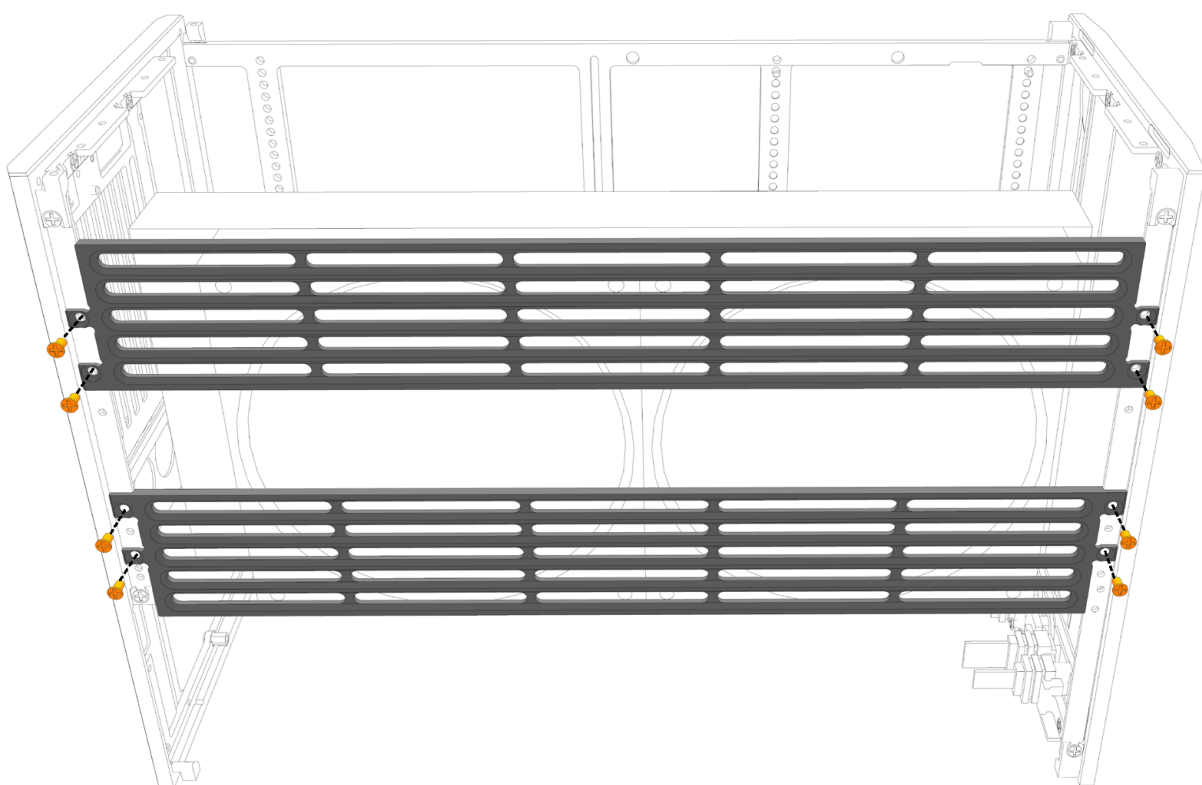

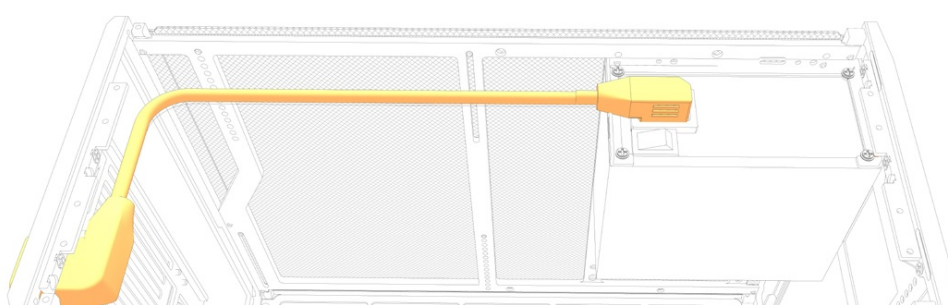
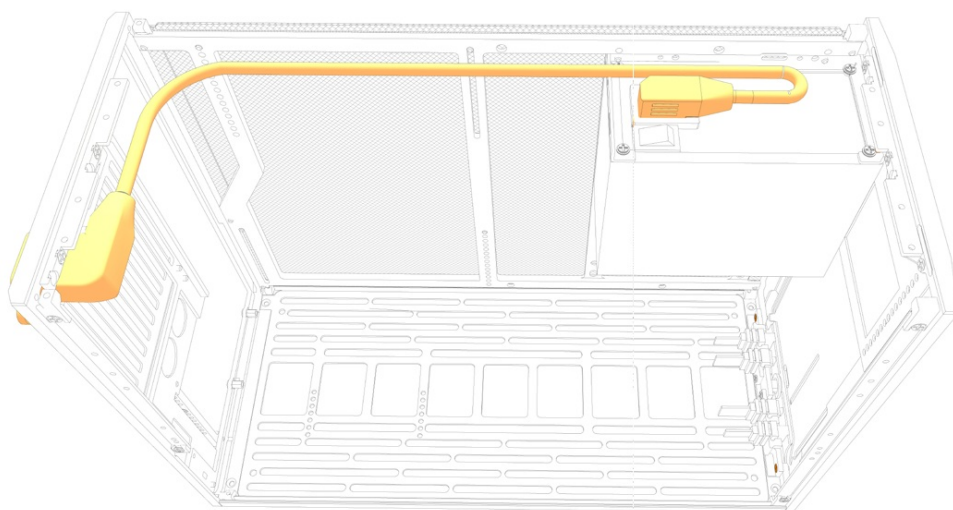
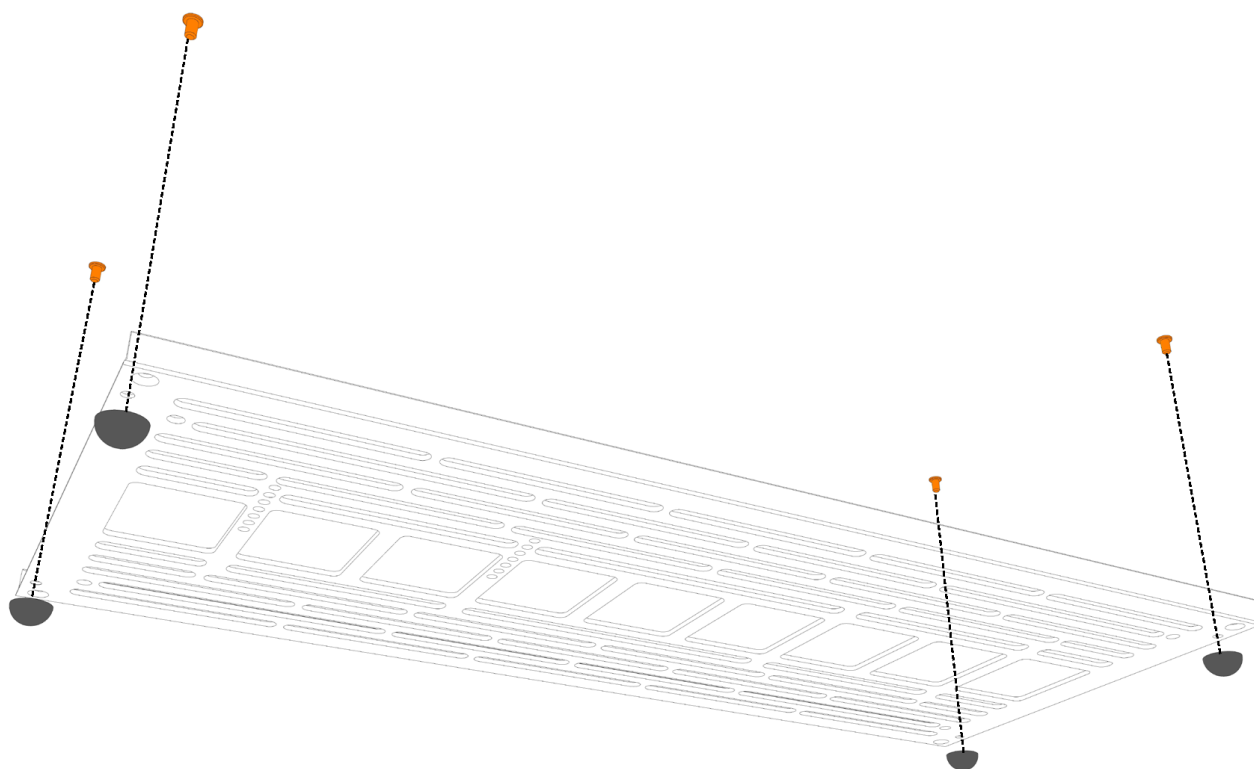

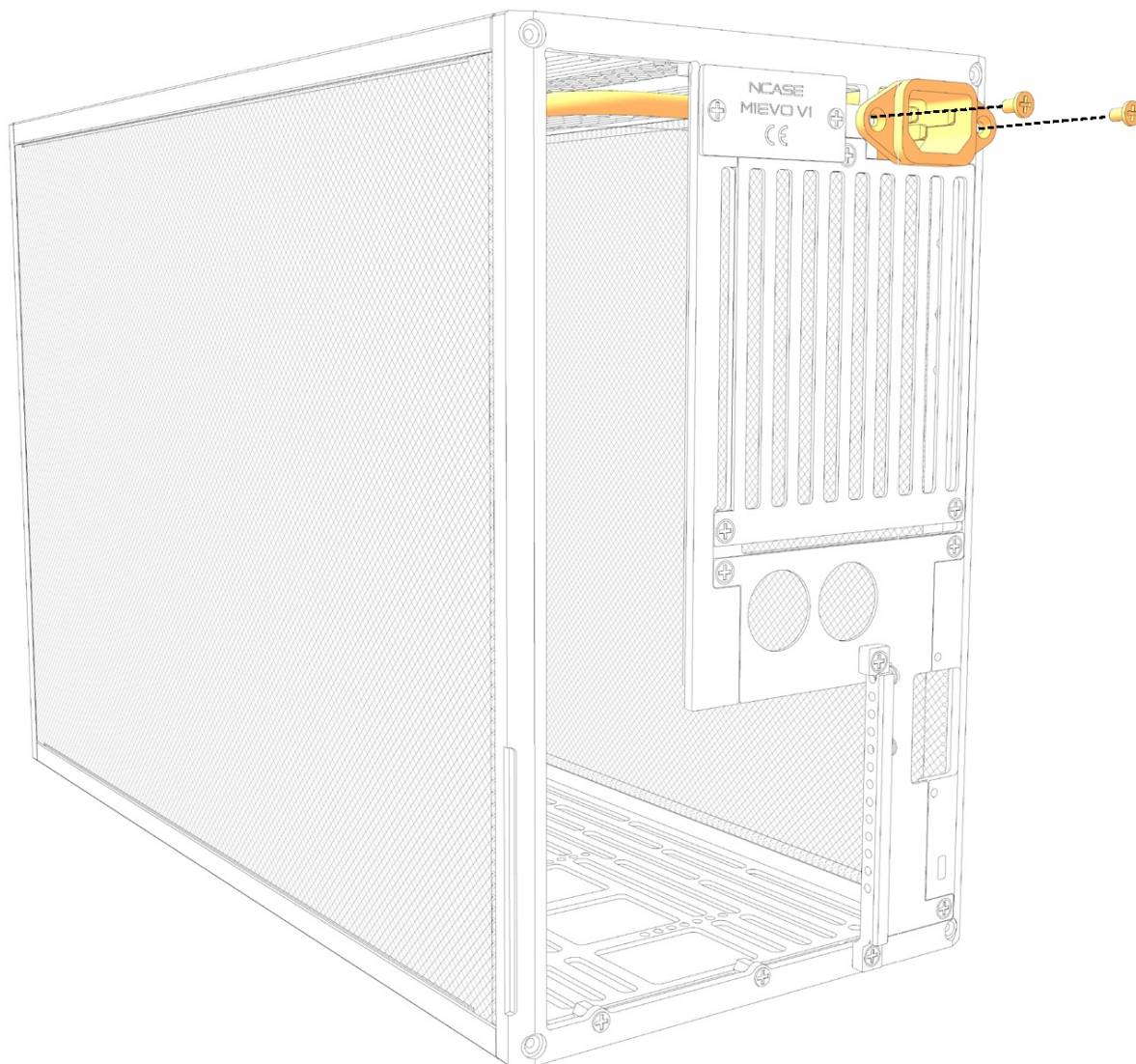
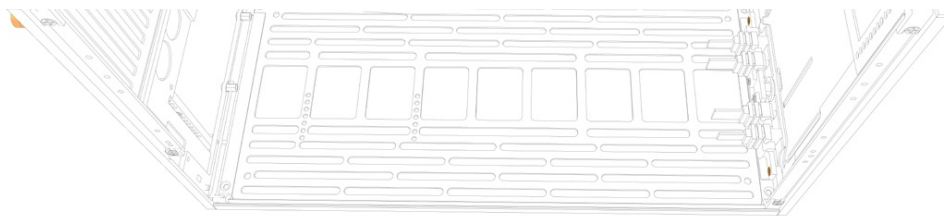

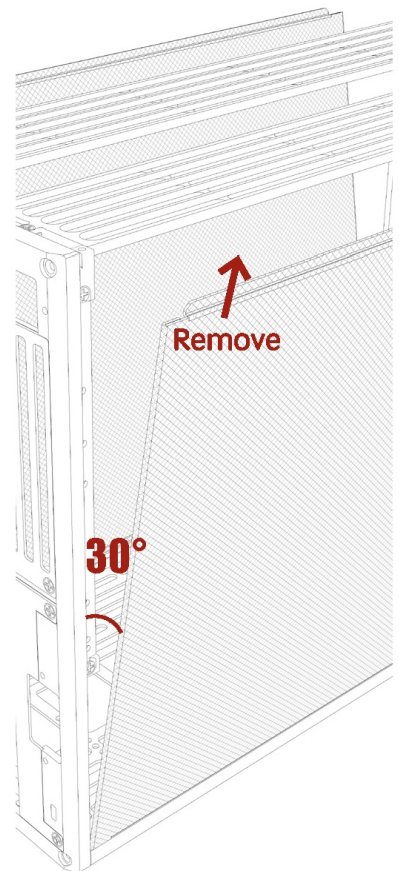
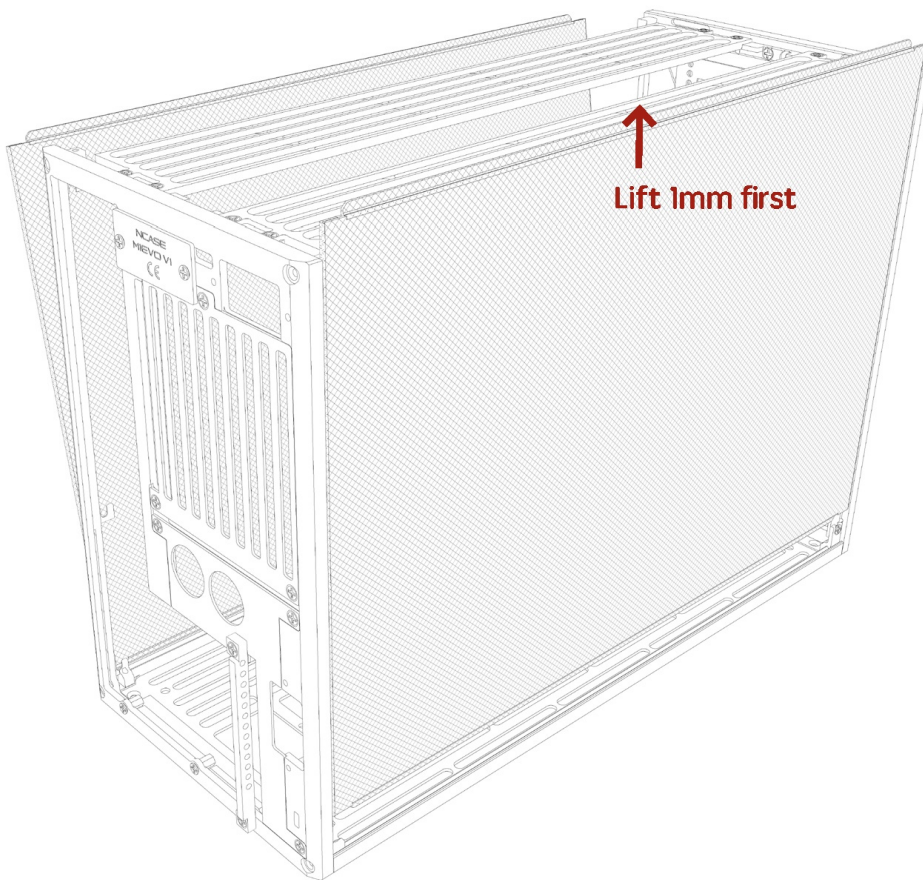
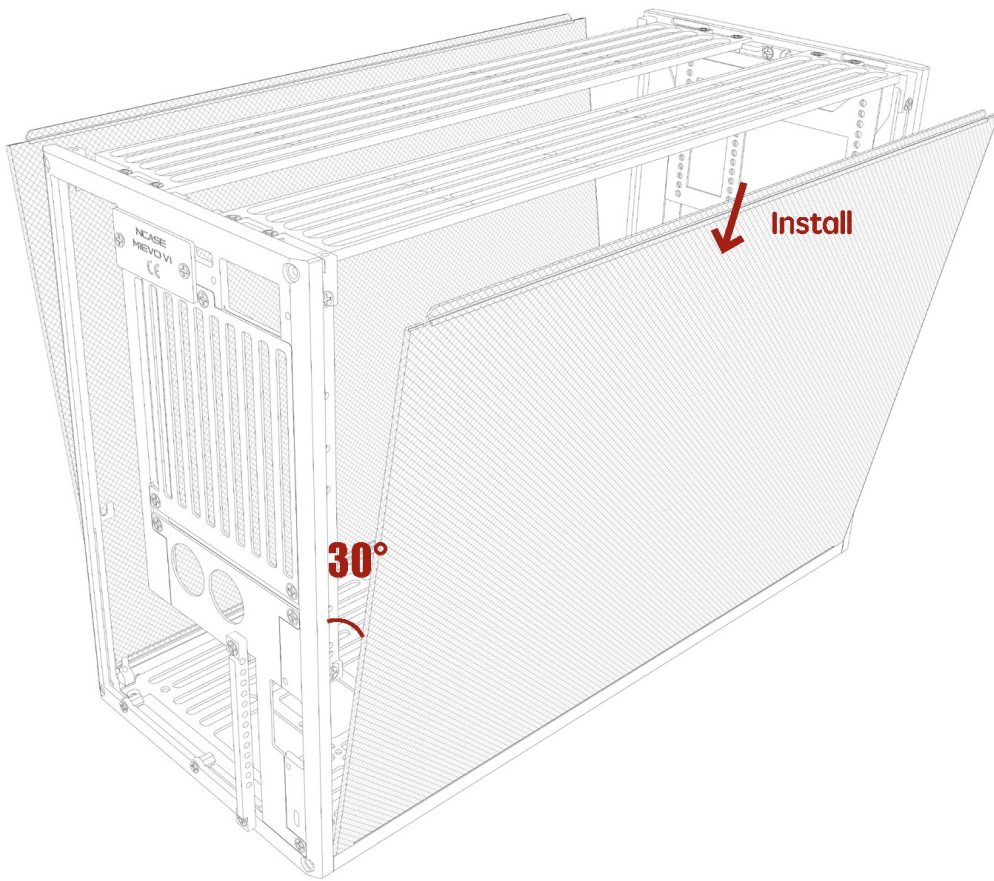

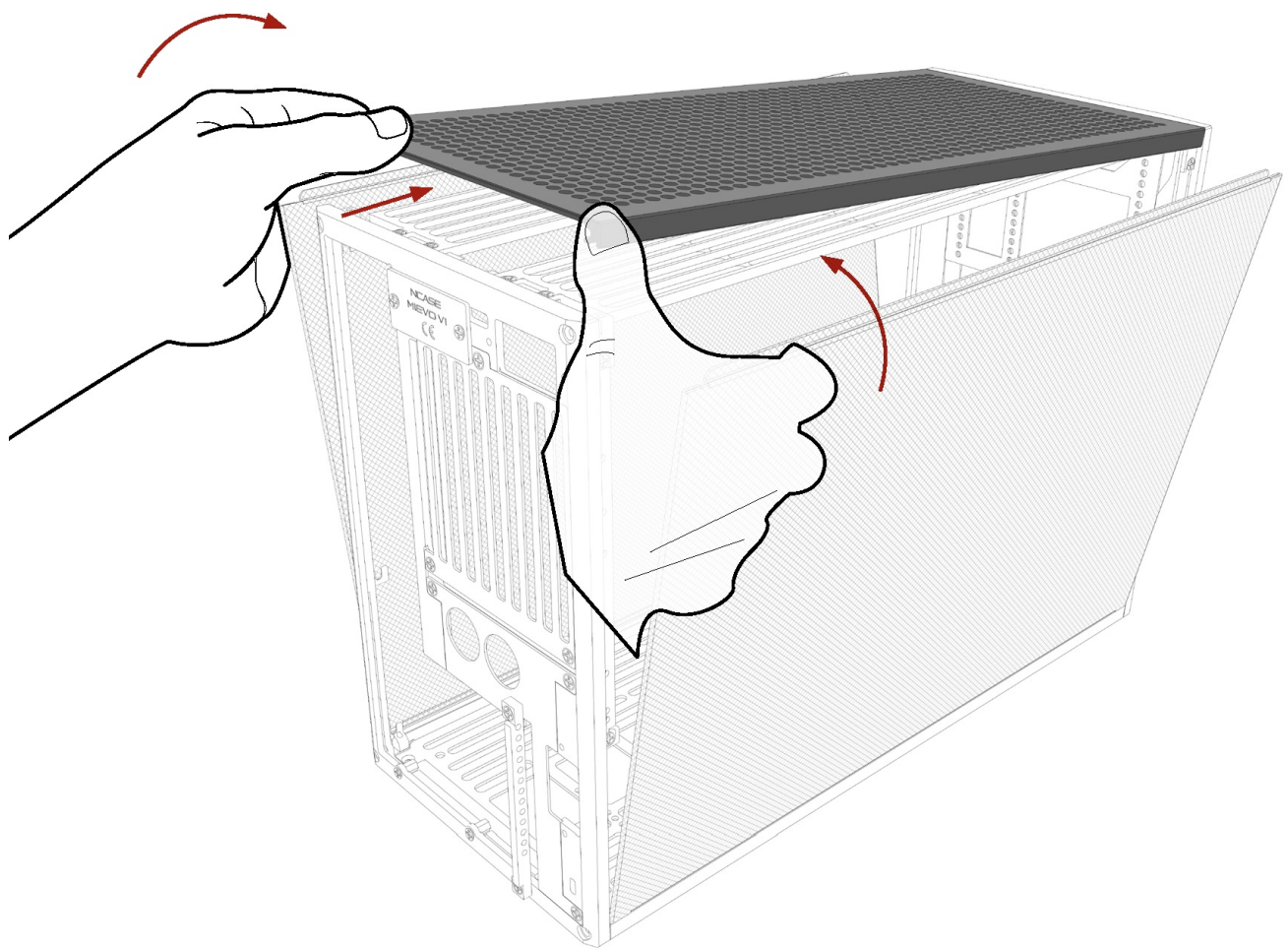

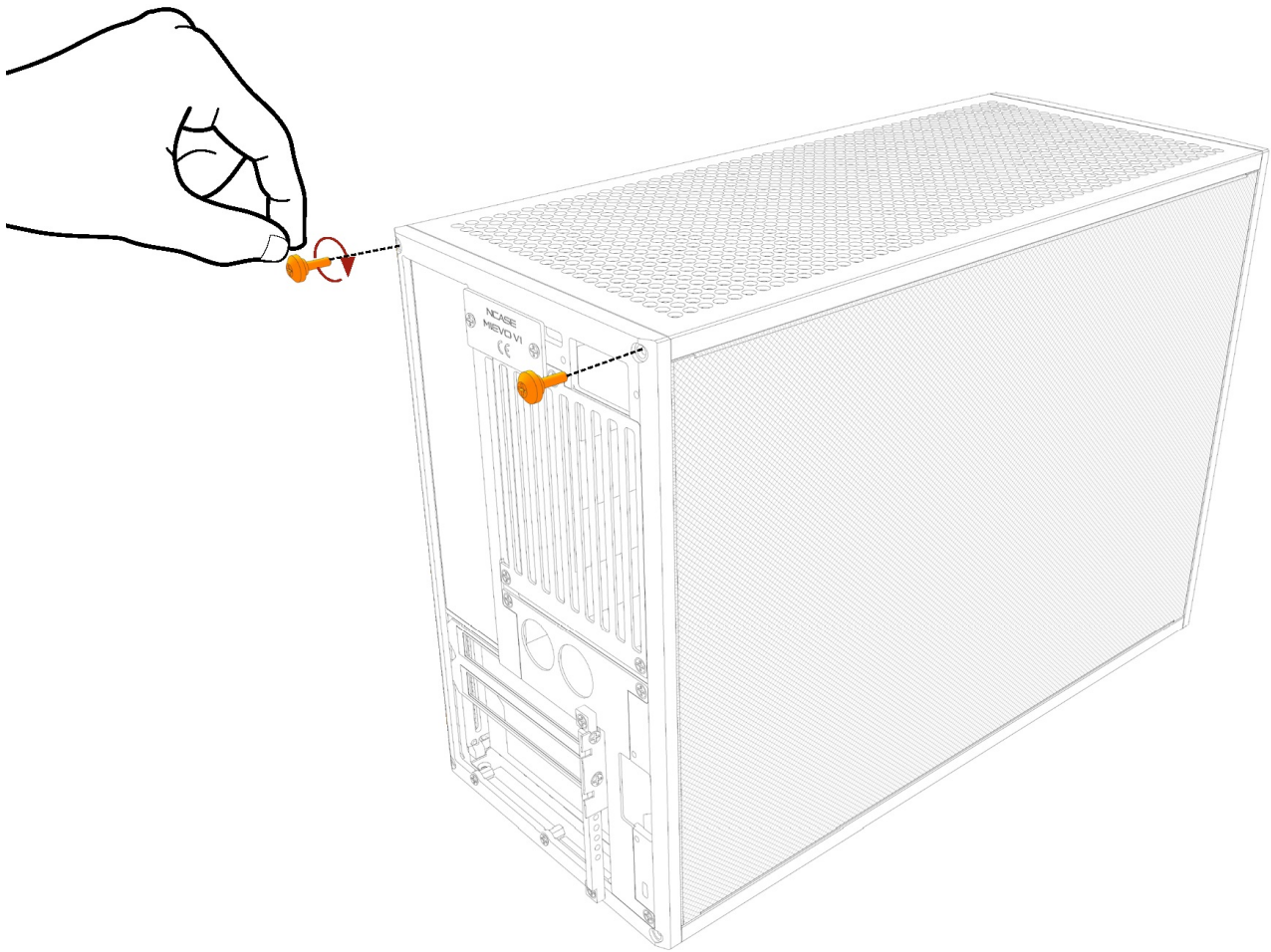

Product Specifications

- Model: M1 Classic Configuration
- Material: Steel
- Color: Black
- Dimensions: 12" x 10" x 8"
- Weight: 5 lbs

Frequently Asked Questions (FAQ)

Q: Can I use this case for a gaming PC?

A: Yes, the M1 Classic Configuration case can be used for building a gaming PC, provided your components fit within the case dimensions.

Q: Are additional accessories included in the package?

A: Yes, the package includes extra accessories like a glass window panel, PCIe4 bracket, PCIe4 cable, fan +

radiator bracket, front IO covers, angled feet, and ATX power supply bracket.

Q: How many case feet are included?

A: The package includes four case feet to provide stability to the chassis.

Documents / Resources

	NCASE M1 Cooling and Noise Performance [pdf] Instruction Manual M1 Cooling and Noise Performance, M1, Cooling and Noise Performance, Noise Performance
---	---

References

- [User Manual](#)

[Manuals+](#), [Privacy Policy](#)

This website is an independent publication and is neither affiliated with nor endorsed by any of the trademark owners. The "Bluetooth®" word mark and logos are registered trademarks owned by Bluetooth SIG, Inc. The "Wi-Fi®" word mark and logos are registered trademarks owned by the Wi-Fi Alliance. Any use of these marks on this website does not imply any affiliation with or endorsement.