

ATEN CE840-AT-G KVM Extender Transmitter Receiver



NBKsmart B0CT4QYHZH Video Calling Smart Camera User Manual

[Home](#) » [NBKsmart](#) » NBKsmart B0CT4QYHZH Video Calling Smart Camera User Manual 

Contents

- [1 NBKsmart B0CT4QYHZH Video Calling Smart Camera](#)
- [2 Appearance](#)
- [3 Add device](#)
- [4 Start video call](#)
- [5 \(additional\) Call other accounts using your device](#)
- [6 Specifications](#)
- [7 FAQ](#)
- [8 Warranty Service](#)
- [9 Documents / Resources](#)
 - [9.1 References](#)
- [10 Related Posts](#)

NBKsmart

NBKsmart B0CT4QYHZH Video Calling Smart Camera



Appearance



1.



MIC

2. PTZ350°
3. Infrared night vision 8 meters
4. 2.8 inch IPS HD screen
5. Call button
6. Call button(2)
7. Reset button
8. SD card max 128GB
9. speaker
10. TypeC power supply

Power on

Im Cam app installation

Please scan the QR code on the right side, or search for "Im Cam" on the App Store or Google Play and download and install it.



Registration and login

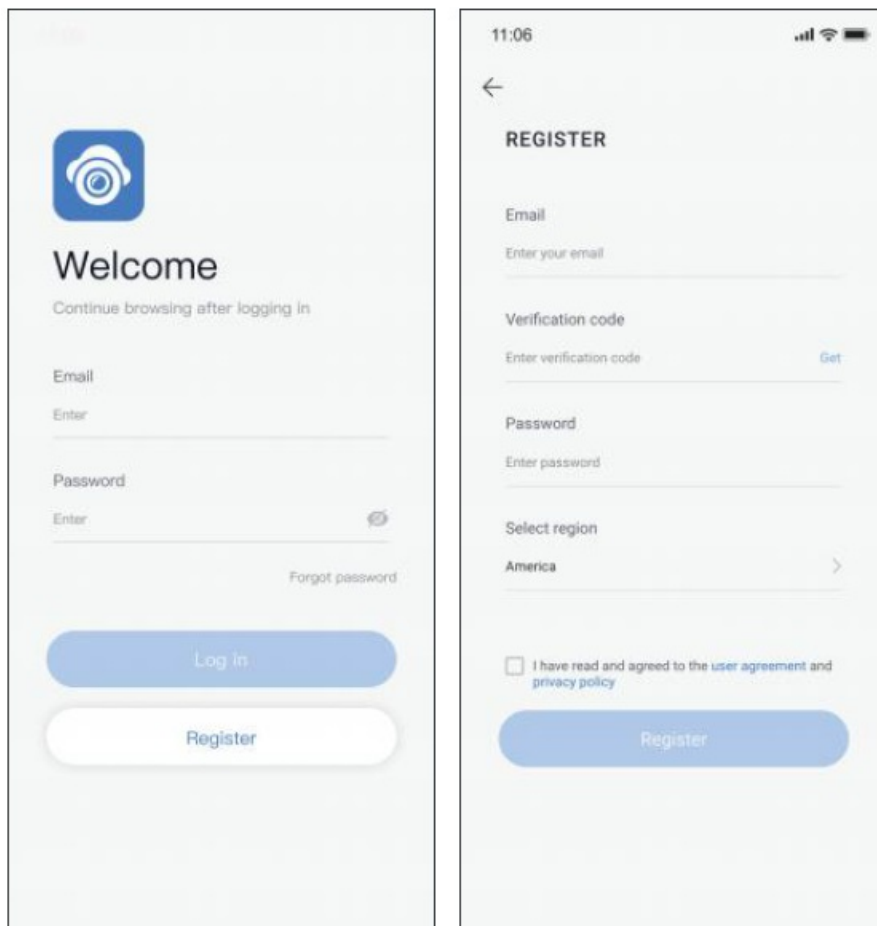

Add device

- After entering the home page, click the “+” button to enter the add device page.

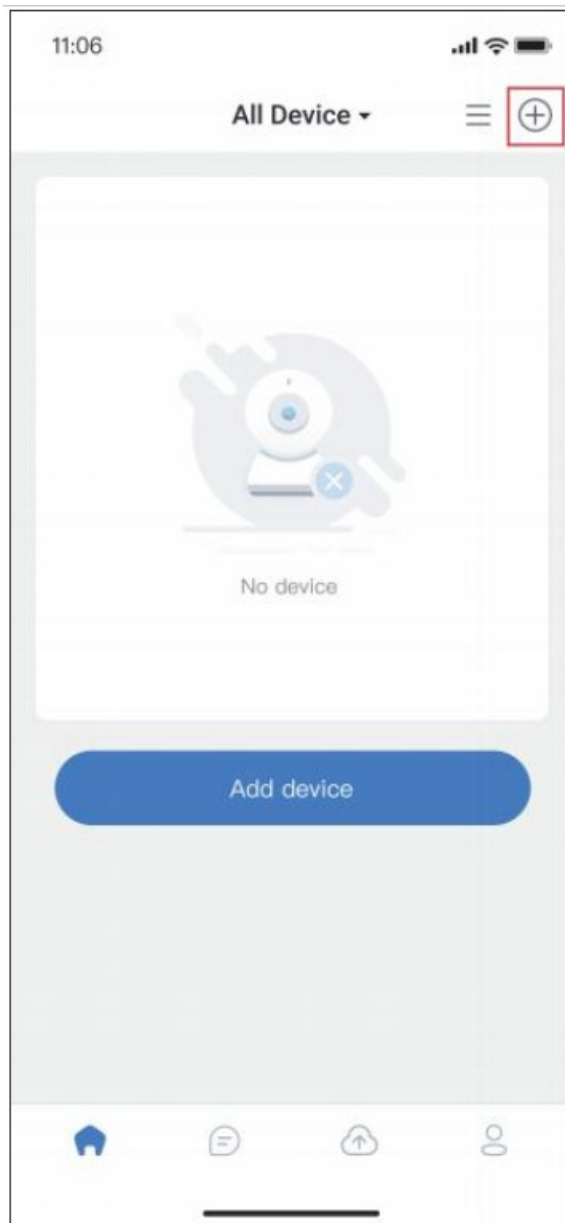

- According to the prompts on the page, make sure the device is in the network pairing state, and then select the pairing method (Please select bluetooth mode) to proceed with the network binding in accordance with the steps.

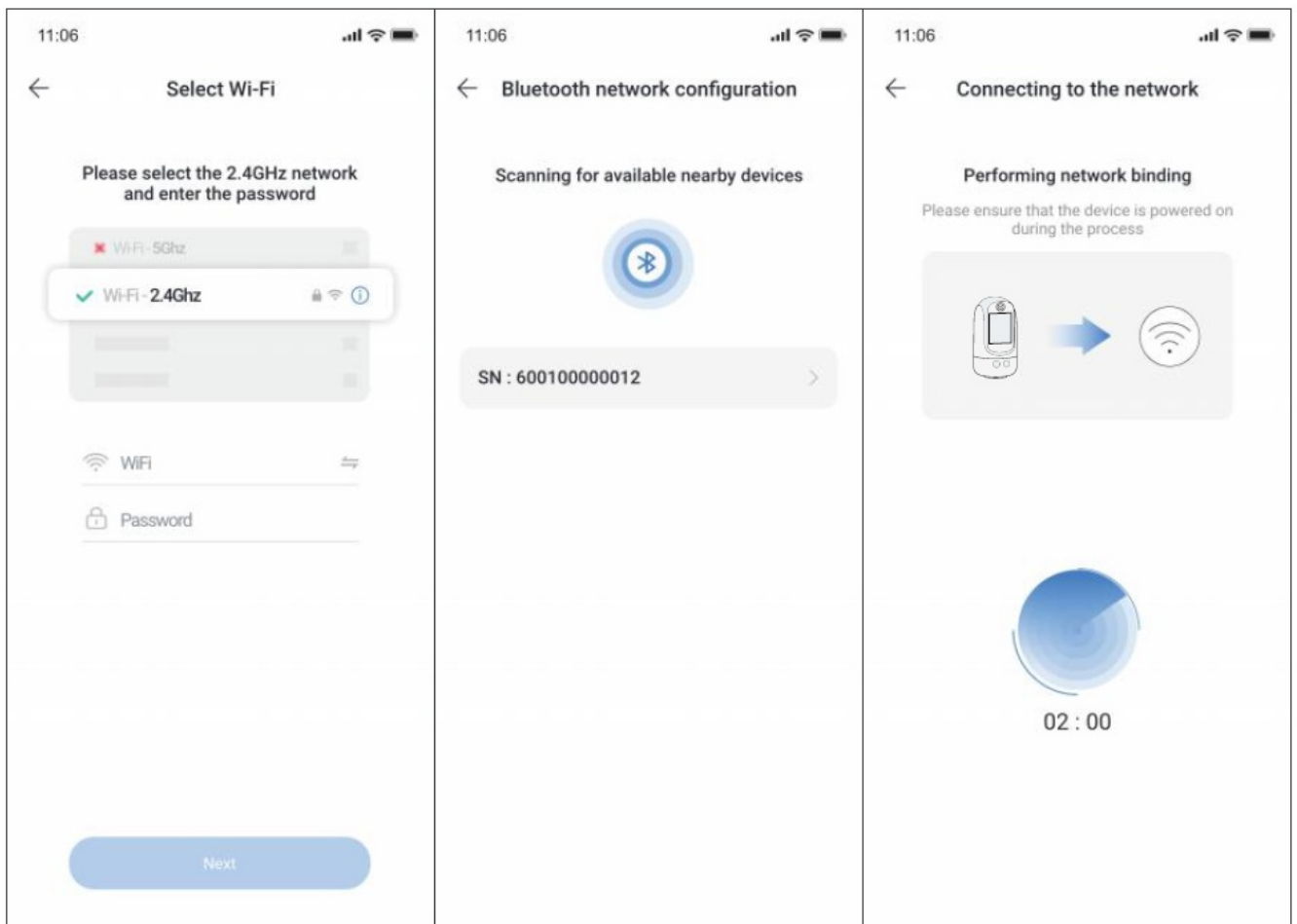

- After the binding is successful, return to the device list. You will be able to see the device that was just bound.

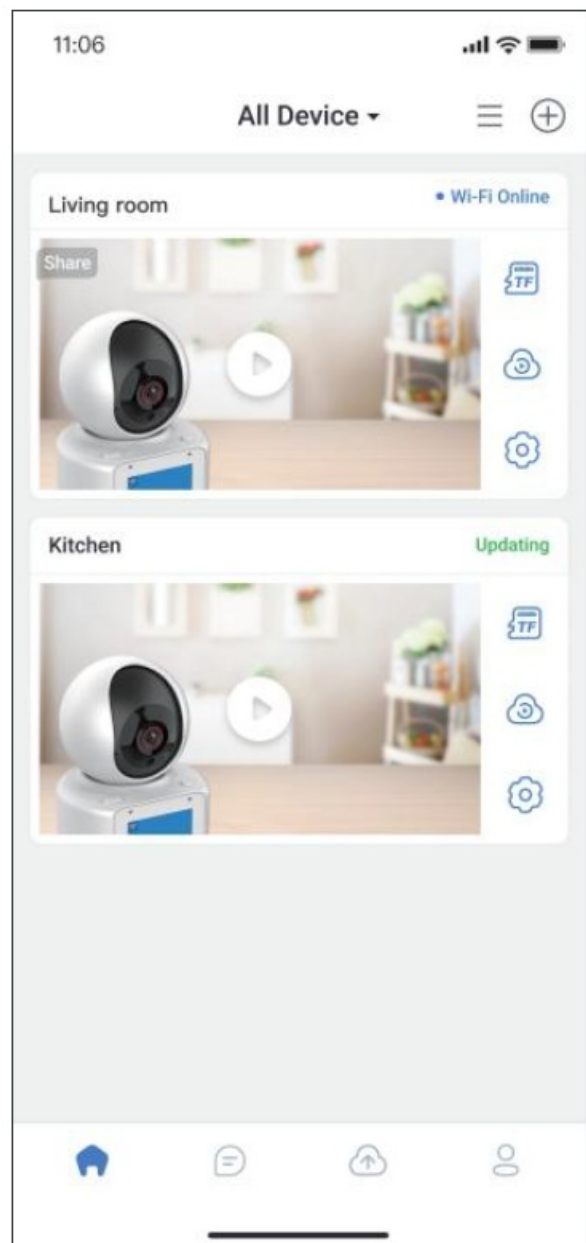
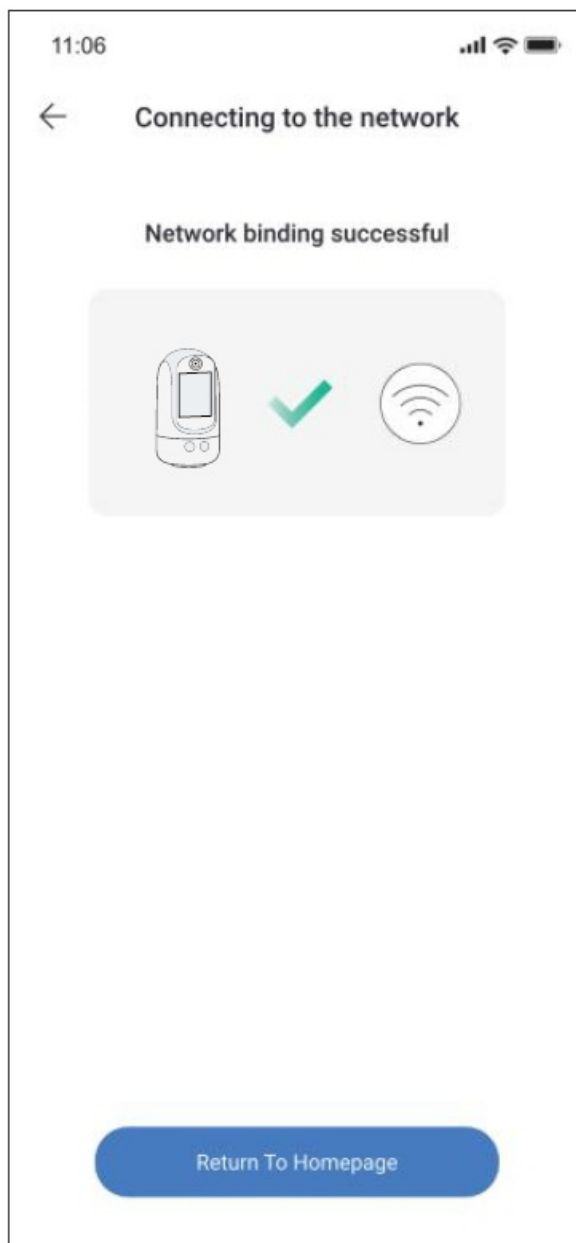

Start video call

- Click on the device image to enter the live video page for the device.

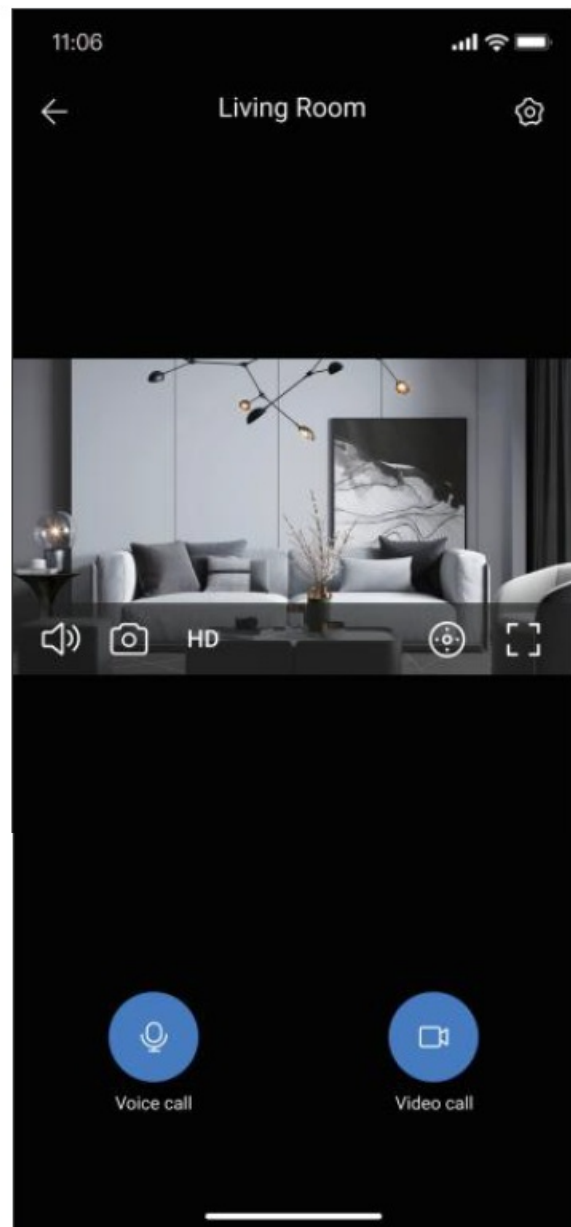
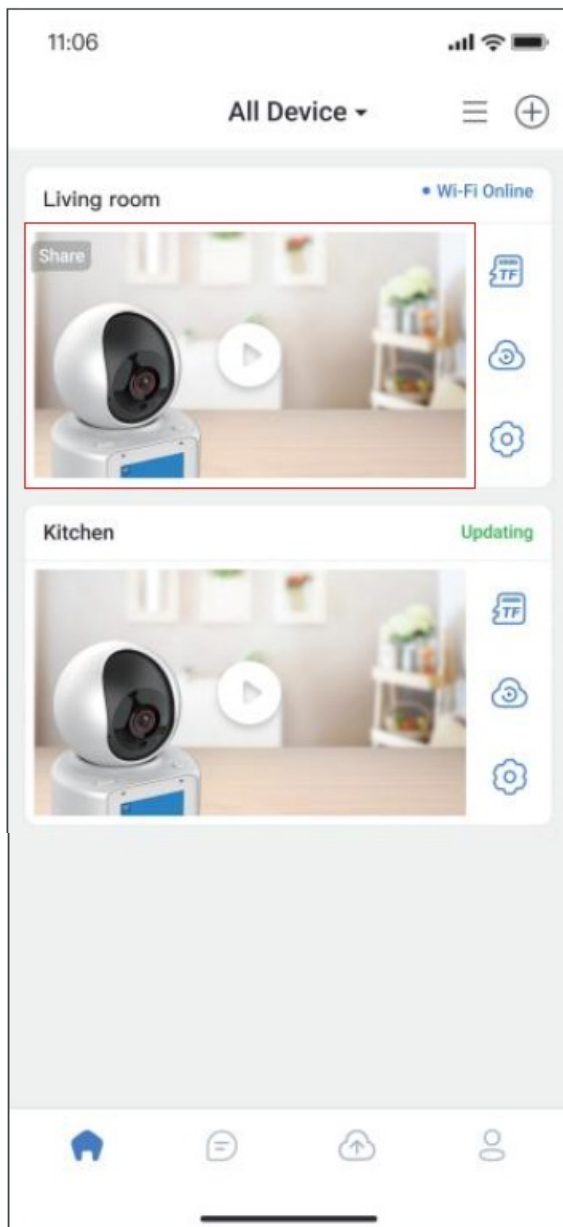

- After clicking “Video Call”, you can start making video calls with the device.

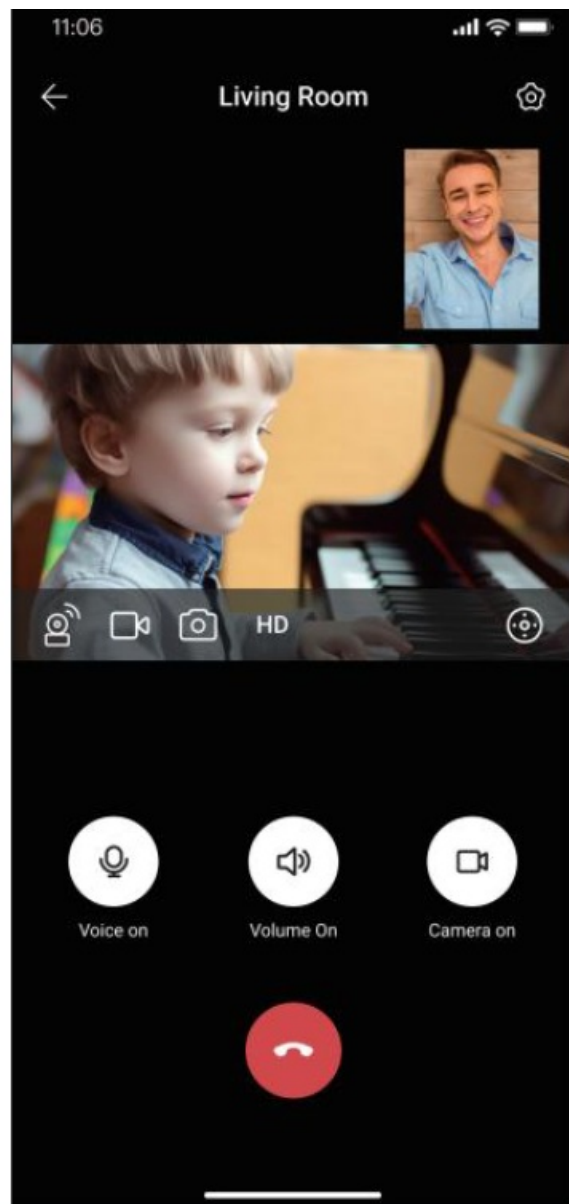
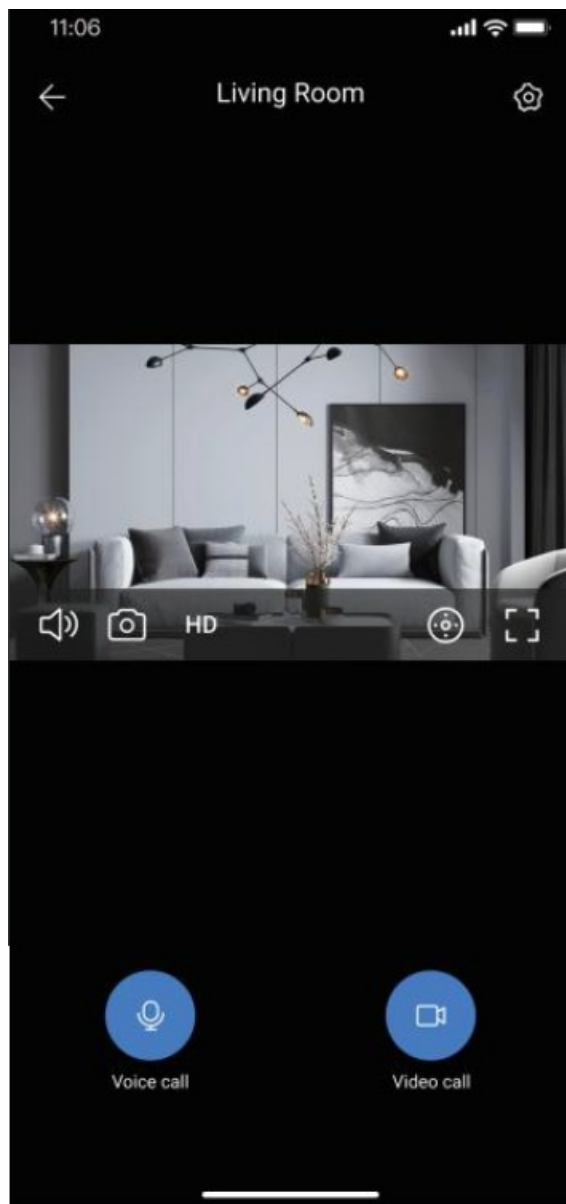

- You can also call the phone by pressing the call button above the device.

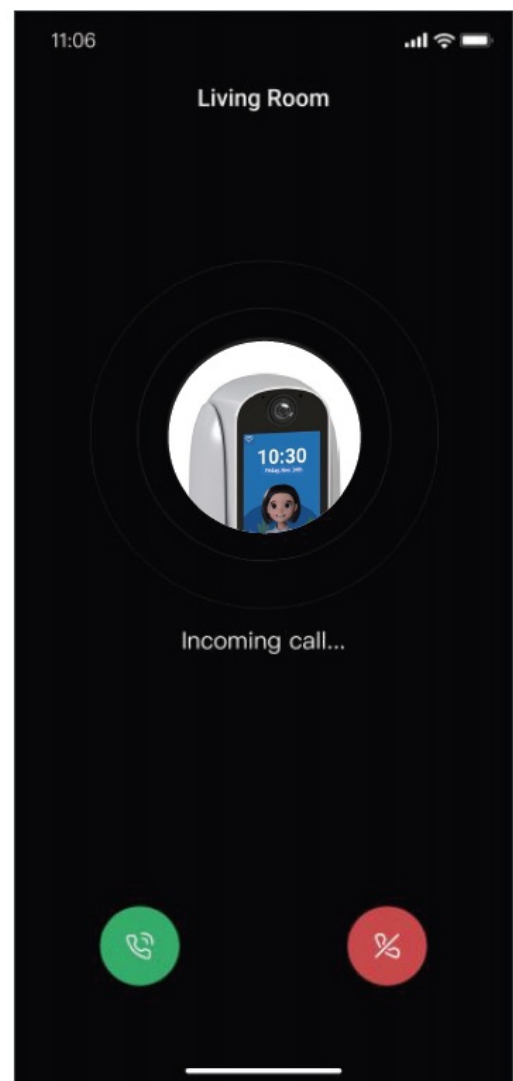
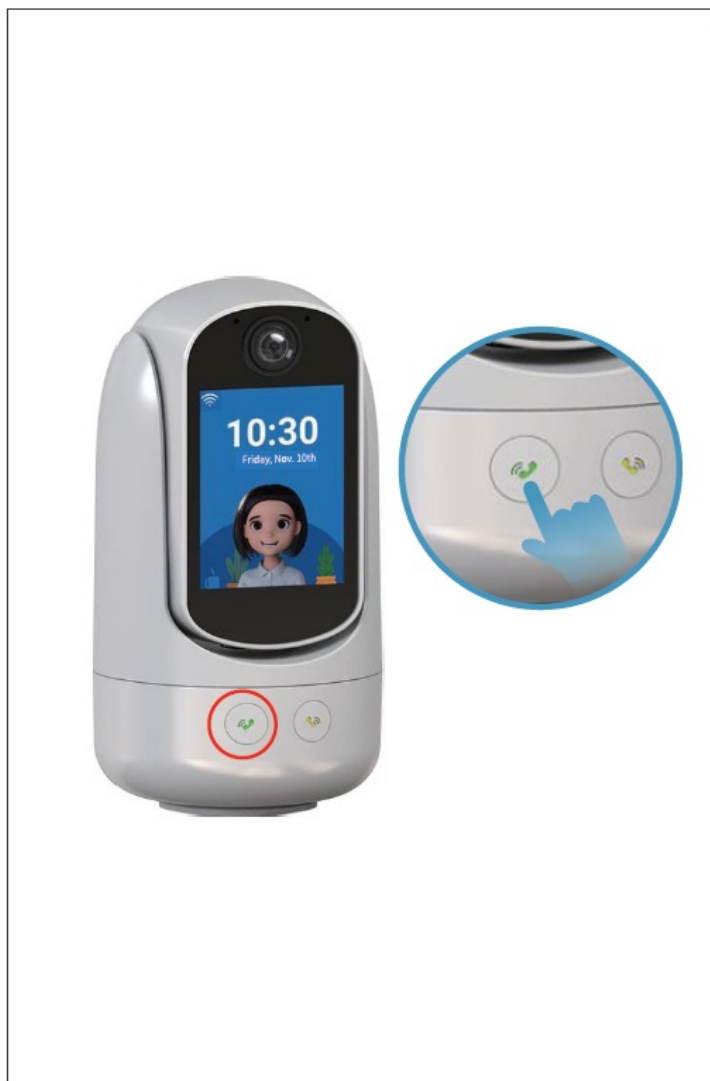

(additional) Call other accounts using your device

- Click 'Settings' to enter the device's settings page.

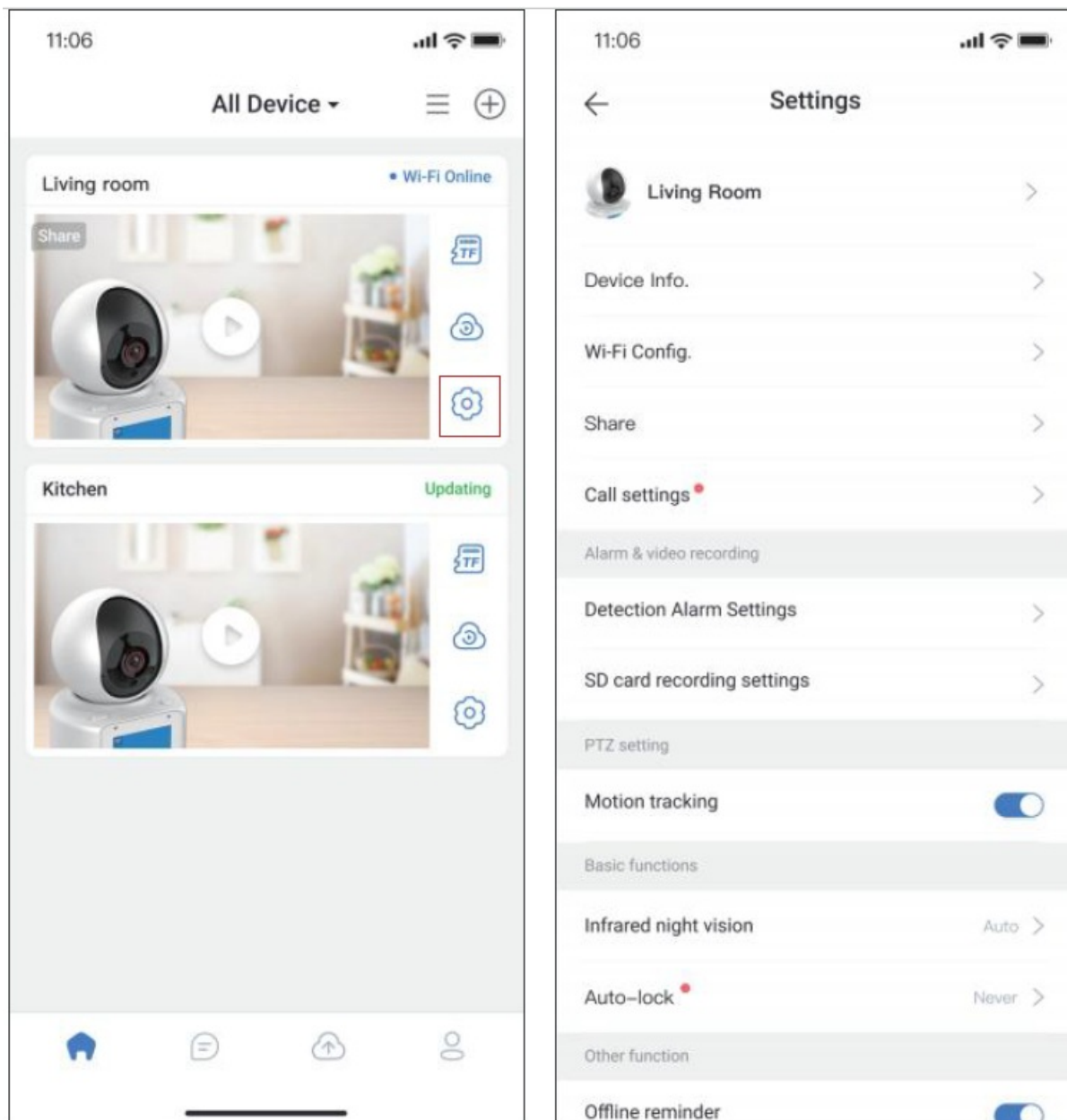

- Click on 'Share with other users' to enter the sharing page.
- Add the accounts you need to call.

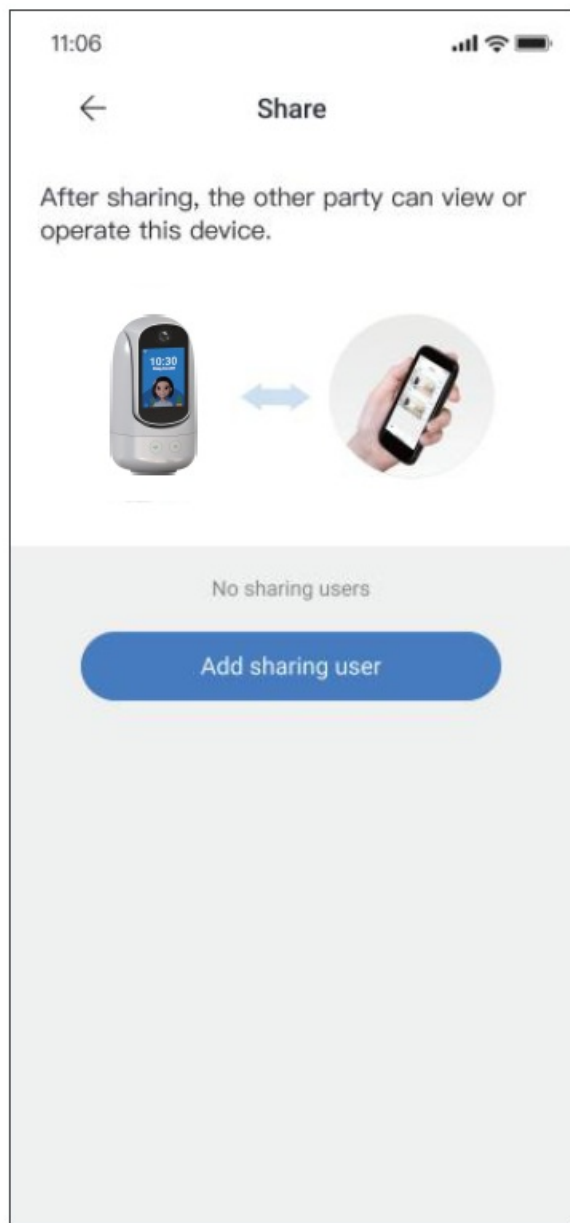

- Press the second call button (located at the bottom right corner of the lens) on the device to make a call to the account you just shared.

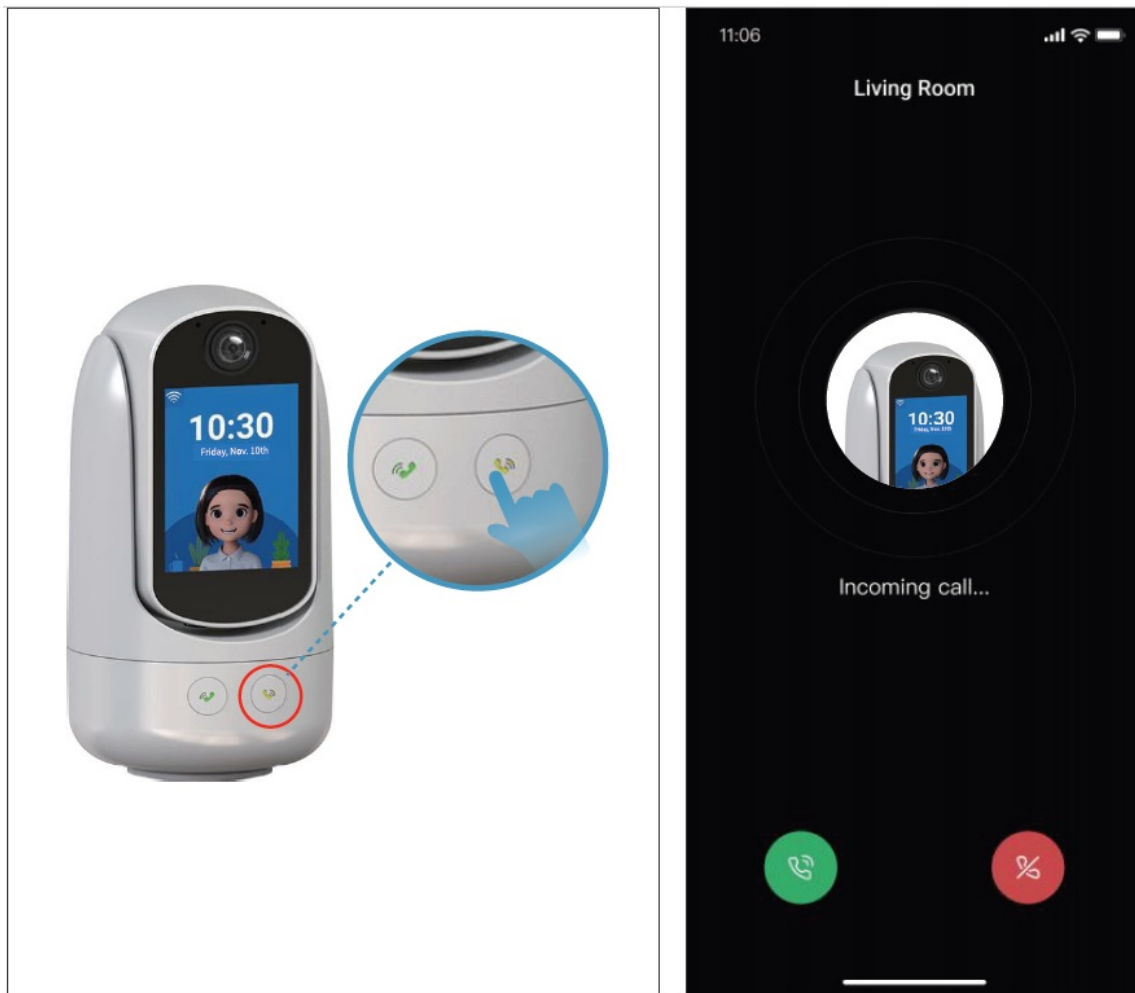

Specifications

CPU	Dual core processor
LCD	IPS 2.8", 240×320
Lens	120° Wide-View
Night Vision Distance	BM
Audio	Pickup distance: 4M
PTZ Rotation	350 degrees horizontally, 85 degrees vertically
AI	Supports human detection, motion detection
Intelligent Alarm	Message push, area alert
TF Card Slot	Support TF card (max 128GB)
Certification	ROSH, CE, GB4943, FCC, UL
Product Size	84 (l)* 84 (W)*153(H)MM

FAQ

What is the lowest bandwidth when viewing the real-time video?

a) To ensure the fluency of video, it is advised that bandwidth isn't lower than 512kbps. b) The flow consumption of video is 2MB/min, and will increase to 2.4MB/min.

Why can't I store videos and read videos properly when I insert the Micro SD(TF) card?

To ensure normal operation of the camera, please insert the following recommended Micro SD(TF) card:
Kingston 16G/32G/64G/128G SanDisk 16G/32G/64G/128G PNY 16G/32G/64G/128G

After-sales Services

To guarantee your interests, please read the content as follows carefully!

Warranty Service

Return Service

Within 7 days since the receipt of goods, we provide a service of refunding or replacement for the quality problem tested and confirmed by sales service engineer.

Replacement Service

Within 30 days since the receipt of goods, we provide a service of replacement and maintenance for the quality problem tested and confirmed by sales service engineer.

Maintenance Service

Within 1 year since the receipt of goods, our company will provide free maintenance for the stoppage according to the warranty clauses.

Timed commitment

Since the day our company received the product, we will repair or replace in 5 days.
(the shipping time will be not included)

Support and Service

1. Before you send the device to us, please contact our after-sale service engineers to confirm product failures.
2. Please fill in the product after-sales service card before mailing the user stub.

Warranty Scope

- Warranty service only apply to the product itself, but the packages and accessories are not included.
- Within 30 days, the performance issue of device should be tested by our company, once confirmed, our company will send you another same model product or repaired good ones. And the defective parts will belong to our company.
- Please take your Invoice and after sale card If you need after sale service, and If you can not provide above certification, the warranty time will be calculated from the date of manufacture.
- The repaired products will add another 30 days warranty time. If you pay for the technical support, to the same performance issue, we will provide you three months warranty service for free since the day It has been repaired, please ask for maintenance certification and keep it.
- The delivery cost of the repaired products should be paid by the sender.
- The promises beyond the after-sale service which made by the dealers, our company take no responsibility.

Special Statement

The Following situations need to be compensated maintenance during warranty period, please be attention.

- Malfunctions or injure caused by abnormal installment, operation and maintenance.
- Without authorization, tear up the barcode.
- The product model and system in the warranty service card are different from the infomiation the product itself.
- Beyond the period of replacement and warranty.
- Malfuncnfons or injure caused by teardown and repair without company's authorization.
- Matfunctions or injure which are not caused by the technology, design, manufacturing and quality.
- Matfunctions or injure caused by force majeure, such as earthquake, fire, flood and thunderstrike.
- Malfunctions or injure caused by accidents or man-made.

Product Repair Way

Please contact the original seller for after-sales service. After purchasing the product, in case the product has problems confirmed by the after-sales service engineer, you can select free services and repairs, goods return and exchange. Relevant warranty period and back freight attribution are as follows: (since the equipment activation date)

Time	Within 7 days	7 days-1 month	With 3 months	1 year under warranty	After warranty
Return guarantee	Exchange	Warranty	Warranty	Warranty	Paid maintenance
Back freight paid by	Seller	Seller	AA	Buyer	Buyer

Commitment deadline: The Company will repair or replace the corresponding products or accessories within 5 days from the receipt day. (Not including posting time)

User Stub

To guarantee your interests, please fill in the stub carefully!

Product Information	Product Name	
	CID	
	Purchase Date	
User Information	Name	
	Phone Number	
	Email	
	Address	



Correct Disposal of this product. This making Indicates that this product should not be disposed with other household wastes throughout the EU. To prevent possible harm to the environment or human health from uncontrolled waste disposal, recycle it responsibly to promote the sustainable reuse of material resources. To return your used device, please use the return and collection systems or contact the retailer where the product

was purchased. They can take this product for environmental safe recycling.

Documents / Resources

<div><div>NBKsmart (wifi)</div><div></div><div>Video Calling Smart Camera User Manual</div></div>	<div>NBKsmart B0CT4QYHZZH Video Calling Smart Camera [pdf] User Manual</div> <div>B0CT4QYHZZH Video Calling Smart Camera, B0CT4QYHZZH, Video Calling Smart Camera, Calli ng Smart Camera, Smart Camera, Camera</div>
--	--

References

- [User Manual](#)

Manuals+, Privacy Policy

This website is an independent publication and is neither affiliated with nor endorsed by any of the trademark owners. The "Bluetooth®" word mark and logos are registered trademarks owned by Bluetooth SIG, Inc. The "Wi-Fi®" word mark and logos are registered trademarks owned by the Wi-Fi Alliance. Any use of these marks on this website does not imply any affiliation with or endorsement.