



nathan james 51301 Liam Storage Unit Instruction Manual

[Home](#) » [NATHAN JAMES](#) » nathan james 51301 Liam Storage Unit Instruction Manual 

nathan james

Let's build the Liam Storage Unit
SKU 51301
Instruction Manual

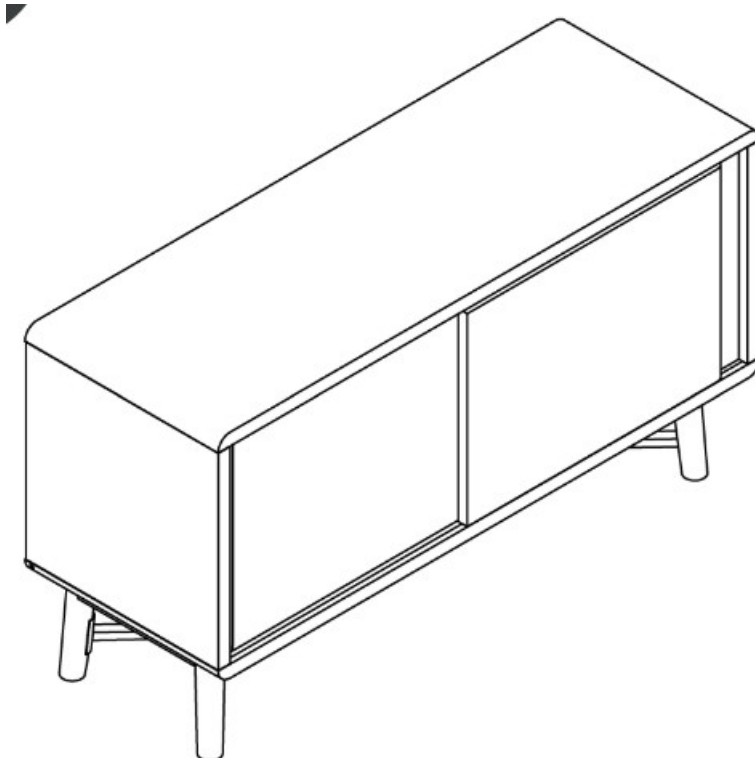

Contents

[1 51301 Liam Storage Unit](#)

[2 What's included](#)

[3 Safety first, fun later](#)

[4 Proper use](#)

[5 Documents / Resources](#)

[5.1 References](#)

[6 Related Posts](#)

51301 Liam Storage Unit

Ok, let's get rolling

This should be easy, just follow our instructions and you will be back to Netflix in no time.

Estimated time for assembly



45:00

What you need

- Some of your favourite bubbly or your preferred relaxant
- Use the packaging carton as a working surface to prevent product damage during assembly



Do not use a drill

Weight Limitation



90

lbs table top

30

lbs per shelf

Toll-free at 1-866-619-1004

Help@nathanjames.com

Nathanjames.com/help

What's included

Description	Qty
A Top Panel	1
B Bottom Unit	1
C Right Side Panel	1
D Left Side Panel	1
E Center Panel	1
F Back Panel	1
G Shelf	2
H Left Door	1
I Right Door	1
J Leg	4
K Metal Stretcher	1
L Metal Stretcher	1

The goods

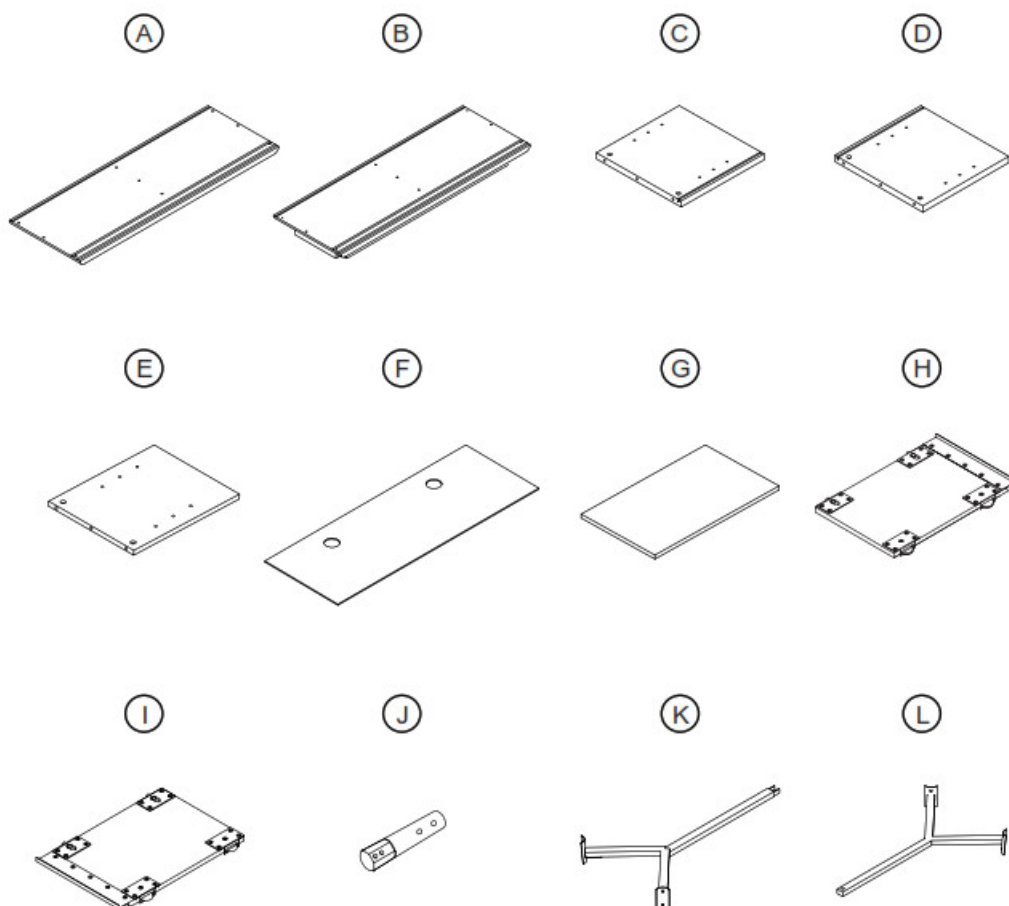

IMPORTANT

1. Do not tighten bolts / screws completely until all bolts / screws are lined up and inserted into holes.

2. Do not over tighten screws and bolts to avoid stripping.
3. Please use hand tools to assemble this product. Do not use power tools.

What's included

Description	Qty
1 M6*24mm Cam Bolt	6
2 M15*9mm Cam Lock	6
3 M8*30mm Wood Dowel	6
4 M6*50mm Bolt	8
5 M4.2*50mm Screw	6
6 Shelf Pin	8
7 M6*12mm Bolt	1
8 M4.2*15mm Screw	8
9 Allen Key	1
10 Flat Washer	8
11 Spring Washer	8
12 Foot Pad	4

The goods

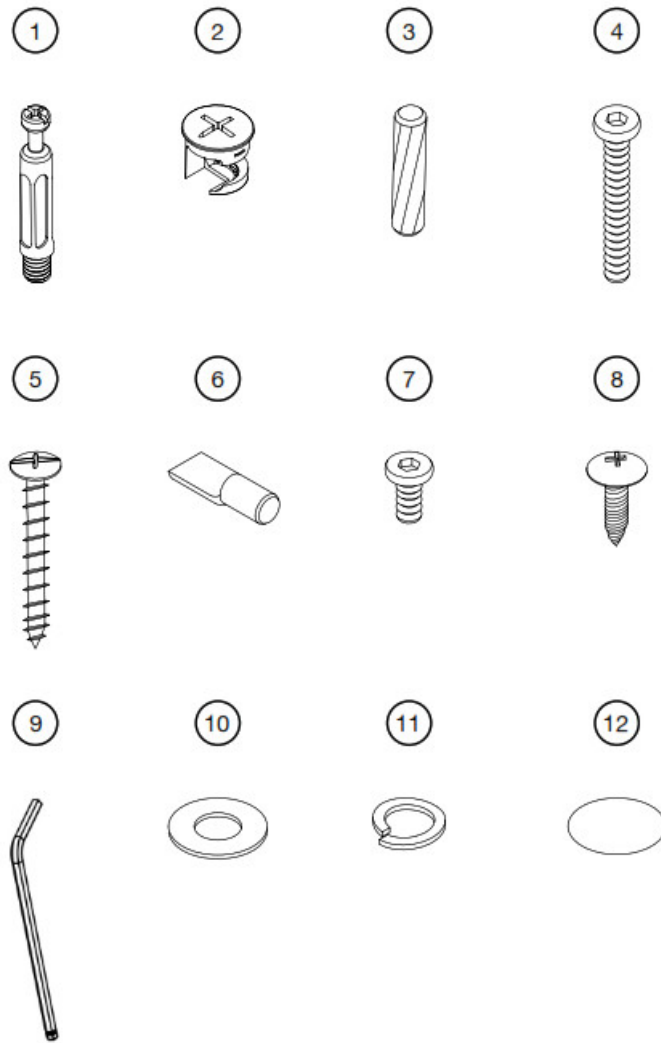

Step 1

How much wood could a woodchuck chuck?...I apologize, please insert wooden dowels into side panels and screw in the cam bolts (1) to the Top Panel (A).

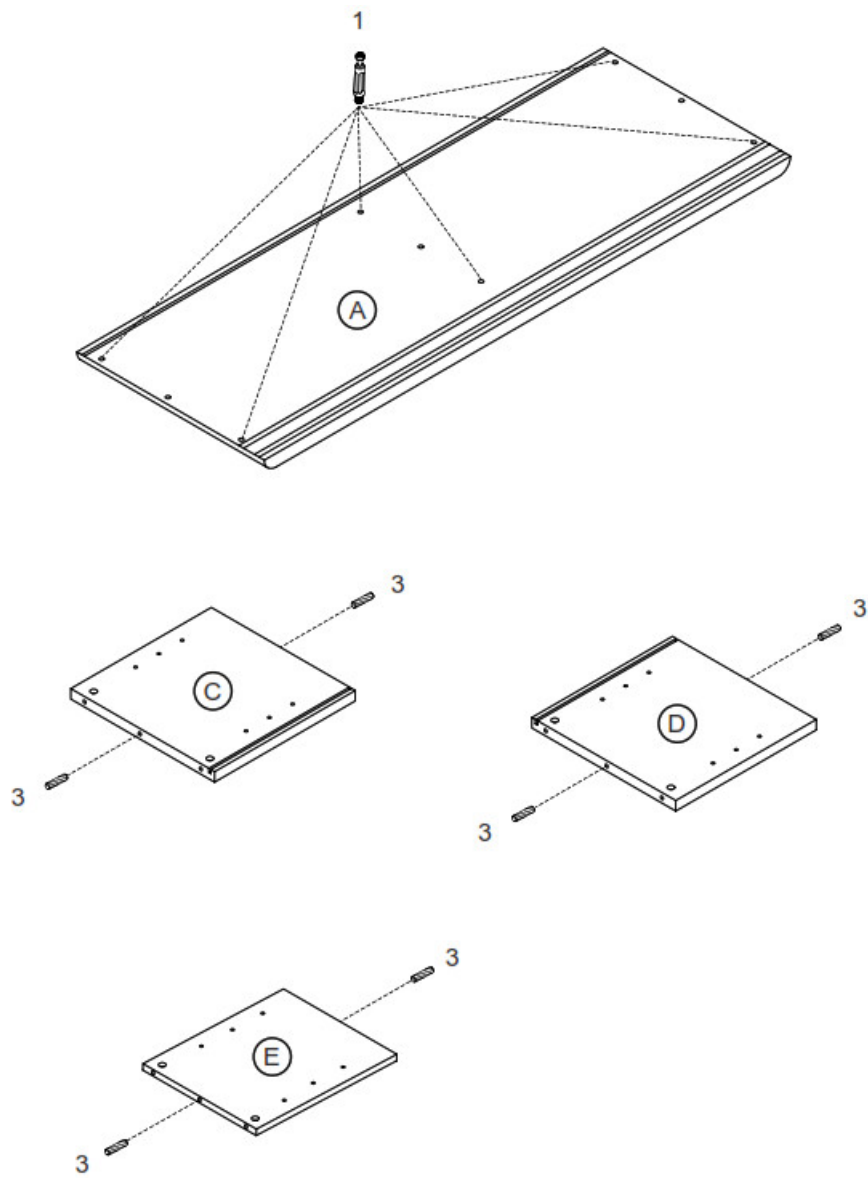

Step 2

Let's get the shelves set up, you're doing great!

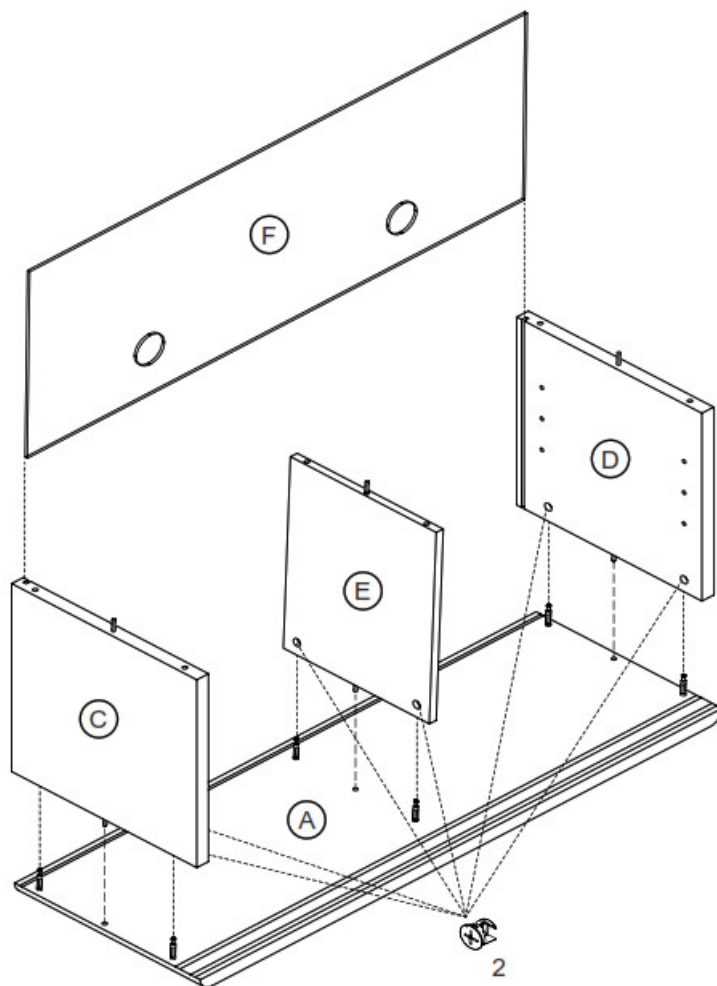

Step 3

If you couldn't tell by now, you've been building it upside down. Time to attach the Bottom Unit (B).

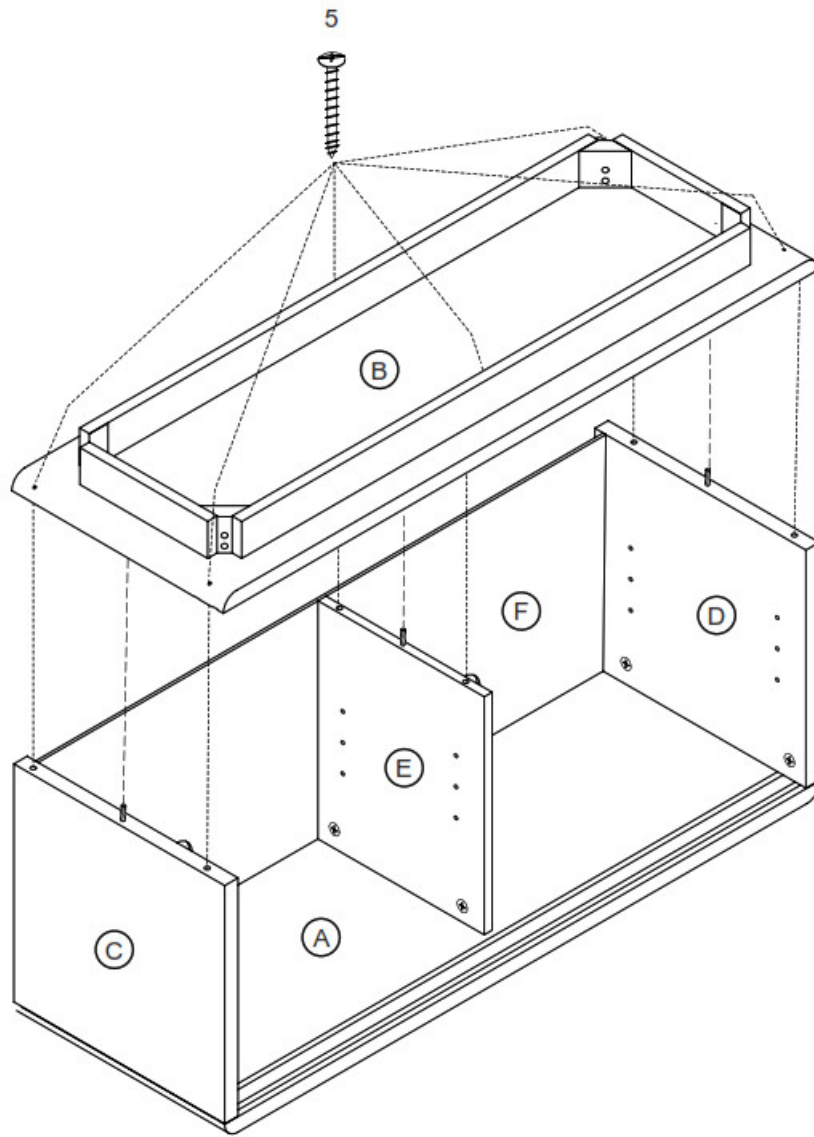

Step 4

Let's get those legs and foot pads secured! You know what they say, never skip leg day!

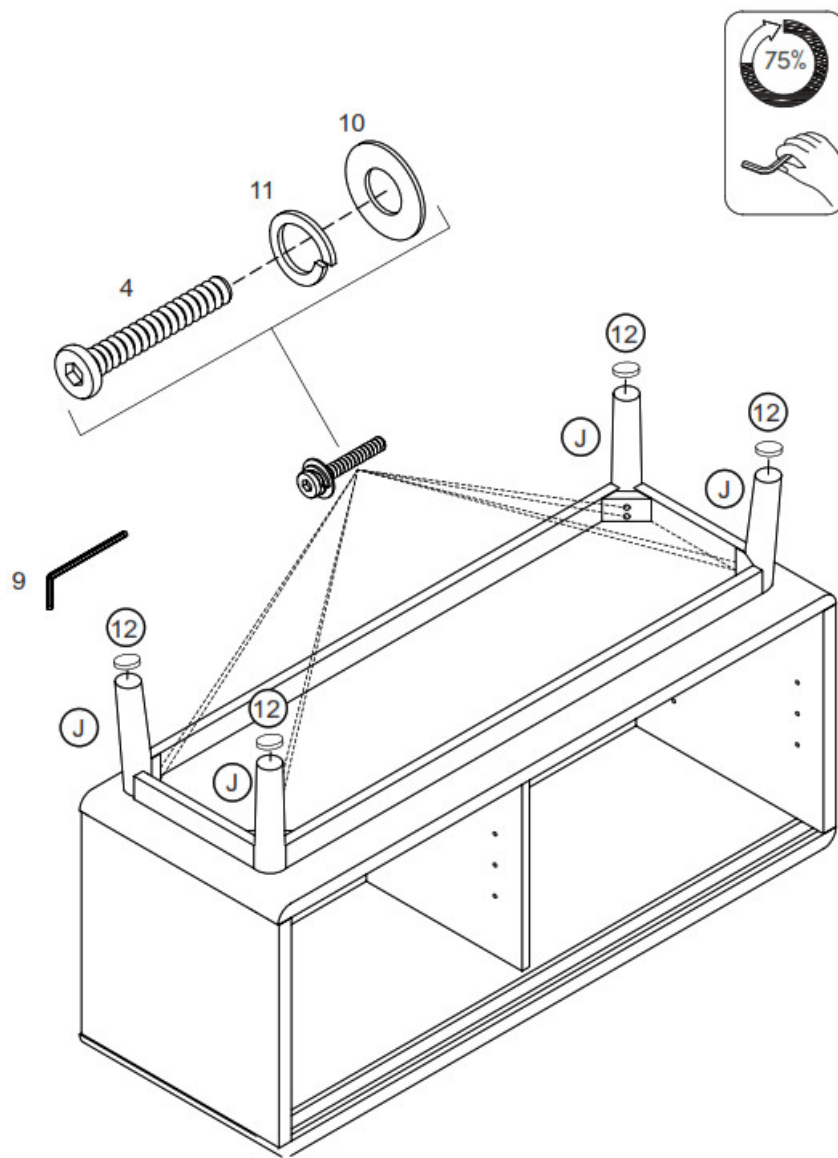

Step 5

Securely attach the metal stretchers.

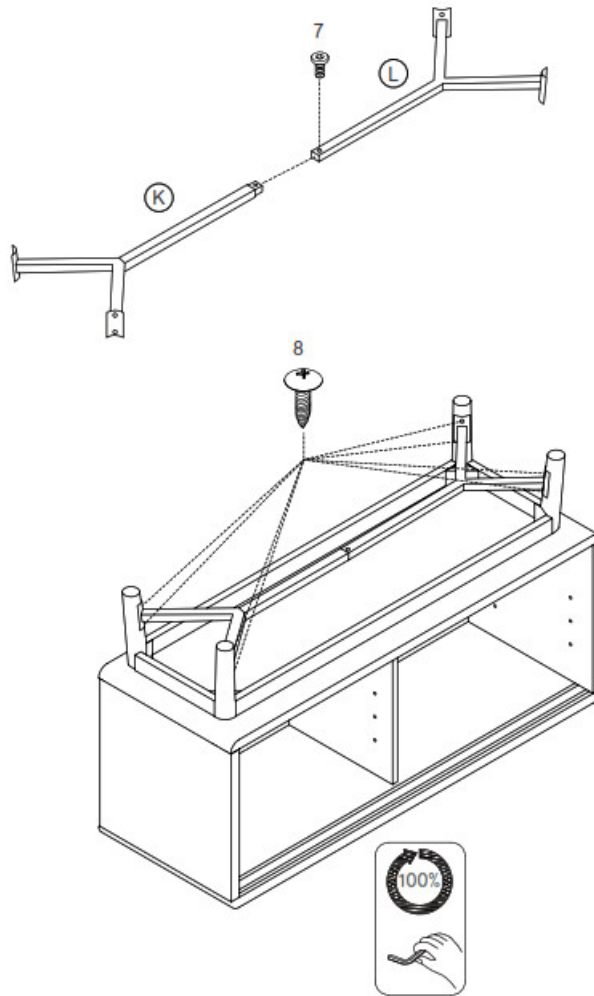

Once Step 5 is complete, you can go back and tighten all the bolts from the previous steps!

Step 6

You're over halfway done! Carefully flip the storage unit over and tighten the shelf pins (6) where you want your shelves to rest.

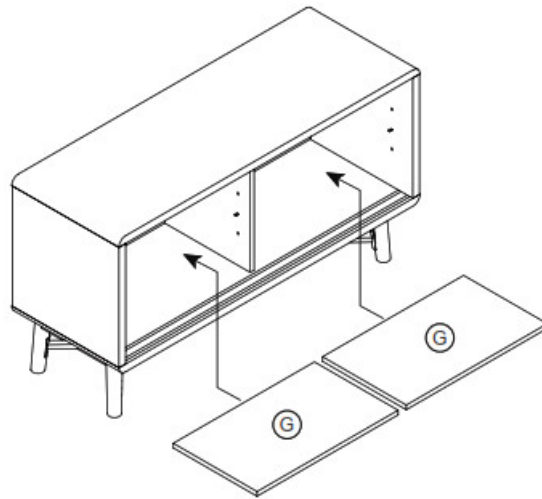
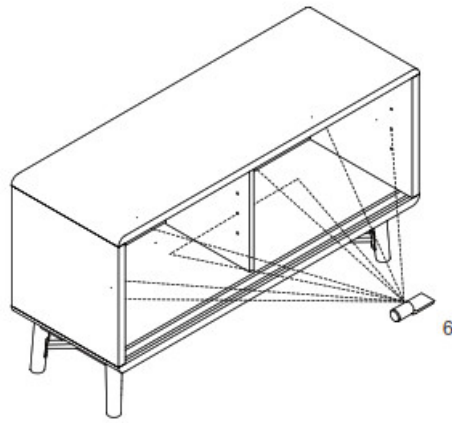

Step 7

Grab the doors (H) and (I) and push down on the side latches on each door to prepare them to get ready to be put on the unit.

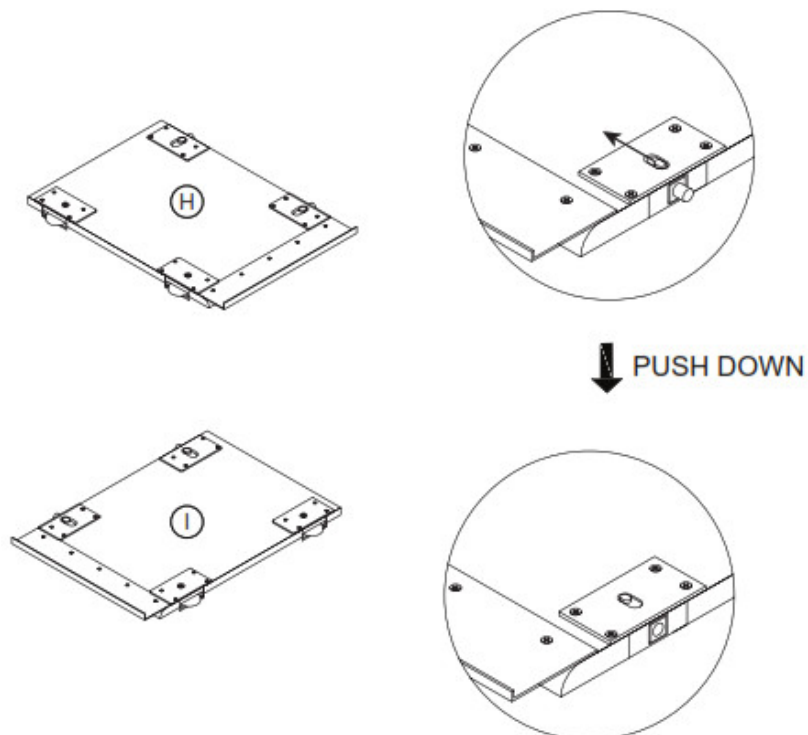

Step 8

Line up door panel's hardware with the guide tracks on the top & bottom panels.

Then push up on the hardware on the back of the panel to set the panel in place.

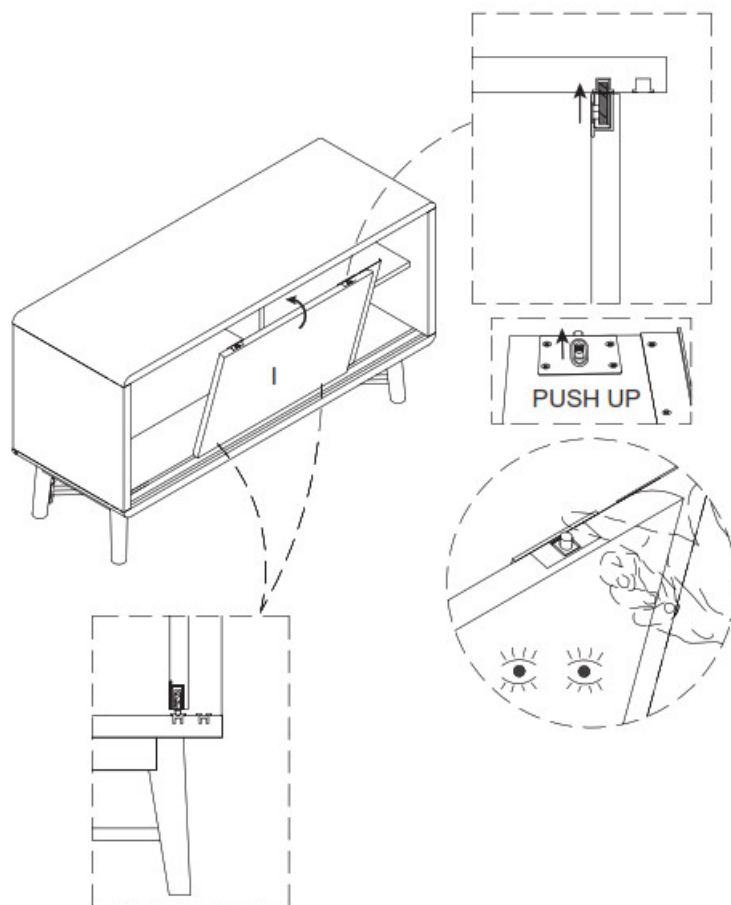

Step 9

Before installing the Right Door (H), move the Left Door (I) all the way to the left.

Next line up door panel's hardware with the guide tracks on the top & bottom panels. Then, push up on the hardware on the back of the panel to set the panel in place.

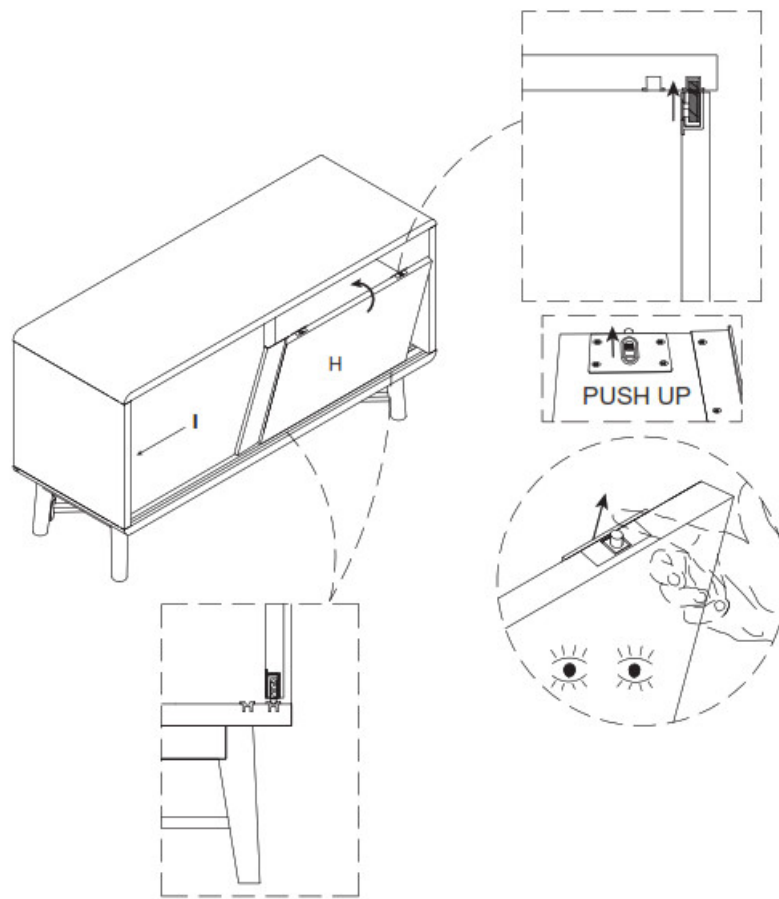

Step 9 cont.

In order to finish setting the Right Door (H) in place, slide the Left Door (I) all the way to the right to be able to access the hardware on the back of the panel to set the panel in place.

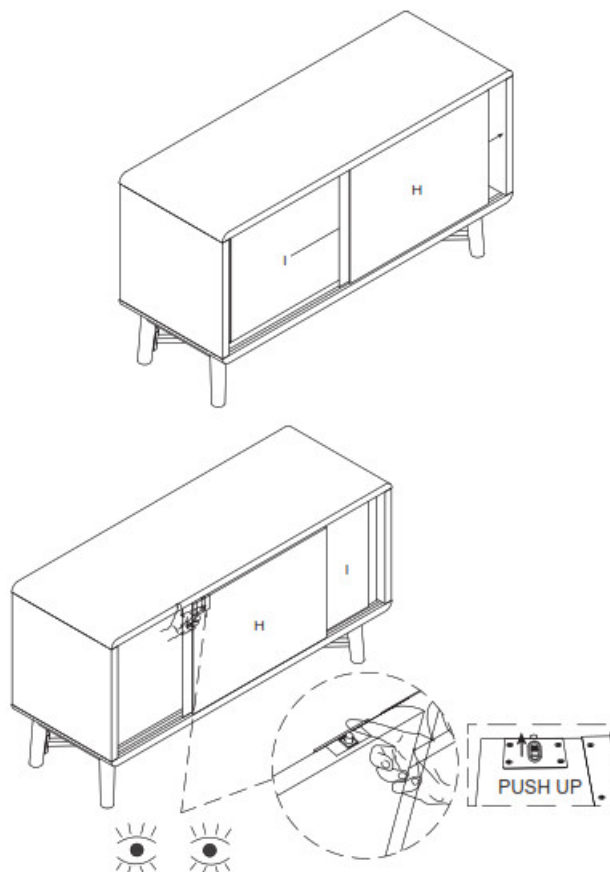

Step 10

Ta-da! We are so proud of you! Chip and Joanna Gaines would be, too. Is it time for pizza??

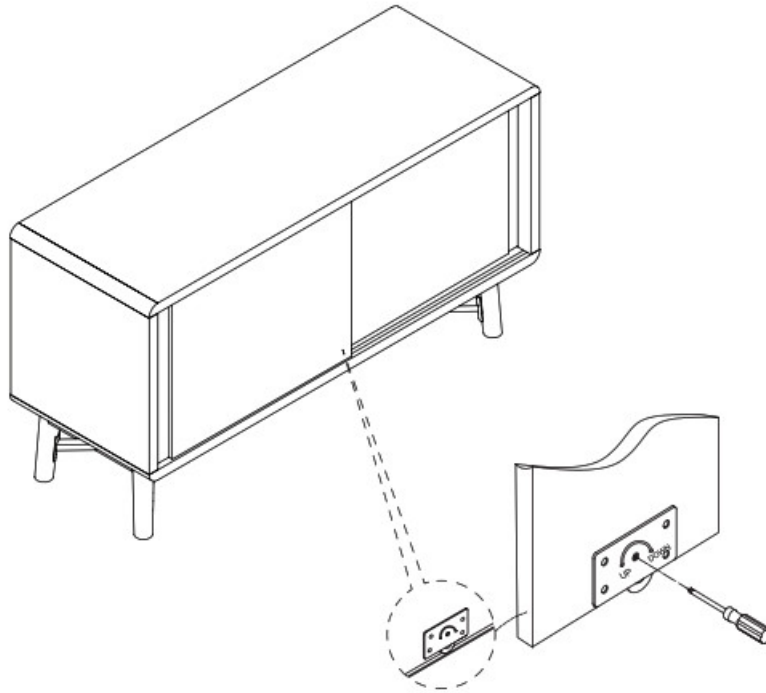

**Helpful Tip:**

If you are experiencing issues with your doors not gliding easily or falling out of the track, you can simply adjust the height of the rollers with a screwdriver for a better, smoother fit.





No heartburn, when we handle the return

Give us a call 1-866-619-1004 or shoot us a message at help@nathanjames.com we will issue you a free replacement with zero hassle.

Our way

	Give us a call
	Replacement
	You

Their way

	Re-package item
	Schedule pick up
	Track package
	Replacement
	You

We really don't want you to go through the hassle of re-packaging your item and sending it back, because let's be honest...nobody has time for that.

Safety first, fun later

We want your Liam Storage Unit to last as long as possible, so we recommend that you tighten the screws 2 weeks after assembly and for added safety check the tightness of all screws every 2 months.

For proper care and treatment of wood please check our website at NathanJames.com/products

Safe use of this product starts with you.

Use this storage unit responsibly with the primary concern for your safety. Follow assembly instructions carefully and inspect product upon receipt and each use.

Nathan James and its parent companies cannot be held legally responsible for any injuries or death resulted from failure to follow instructions or improper use of this product.

Do not modify the structure of this product in any way.

Our products have been tested to meet specific safety measures as they were originally intended to be sold. Any modifications will present the risk of creating significant safety issues which NJ will not be responsible for.

Proper use

DO NOT	use for commercial purposes
DO NOT	place on uneven floor or surface
DO NOT	use as a step-stool or stand on storage unit
DO NOT	put hot serving liquid directly on the unit
DO NOT	leave spilled liquid on the storage unit
DO NOT	use if storage unit is damaged or broken
DO NOT	make temporary repairs
DO NOT	use outdoors

We are only in business if you're happy

For starters, thanks for being you.



Toll-free at 1-866-619-1004



Help@nathanjames.com



NathanJames.com/help

We do our best to ensure your furniture arrives without any problems, but occasionally mistakes happen—as humans we are imperfect beings. In the event that a part is damaged or missing, we will be more than happy to provide you with replacement part(s) for free.

Warranty

This product comes with a lifetime warranty from the date of purchase. Please use your phone to scan the QR code to register your product or visit <https://goo.gl/i9dk3q>

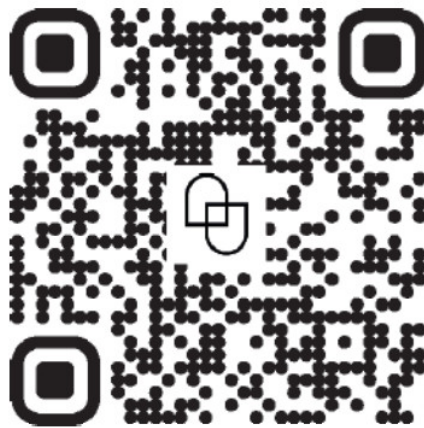

<https://qrcodes.pro/JxgdKe>

Did we do alright? Please spread the love!

If you are happy with your product, tell your friends and family about us or even better leave us a review online. Spreading the word gives us the opportunity to make more people happy and keep our prices low for your next purchase.

nathan james

Brooklyn Burdon
Founder, Nathan James



<https://qrcodes.pro/HAKeCj>

Documents / Resources

	<p>nathan james 51301 Liam Storage Unit [pdf] Instruction Manual 51301, 51301 Liam Storage Unit, Liam Storage Unit, Storage Unit</p>
---	--

References

- [Support : Nathan James](#)
- [Collections](#)
- [Product Warranty | Nathan James](#)

Manuals+,