



natec Fowler 2 Multi-Port Adapter User Manual

[Home](#) » [natec](#) » natec Fowler 2 Multi-Port Adapter User Manual 



FOWLER 2
User Manual

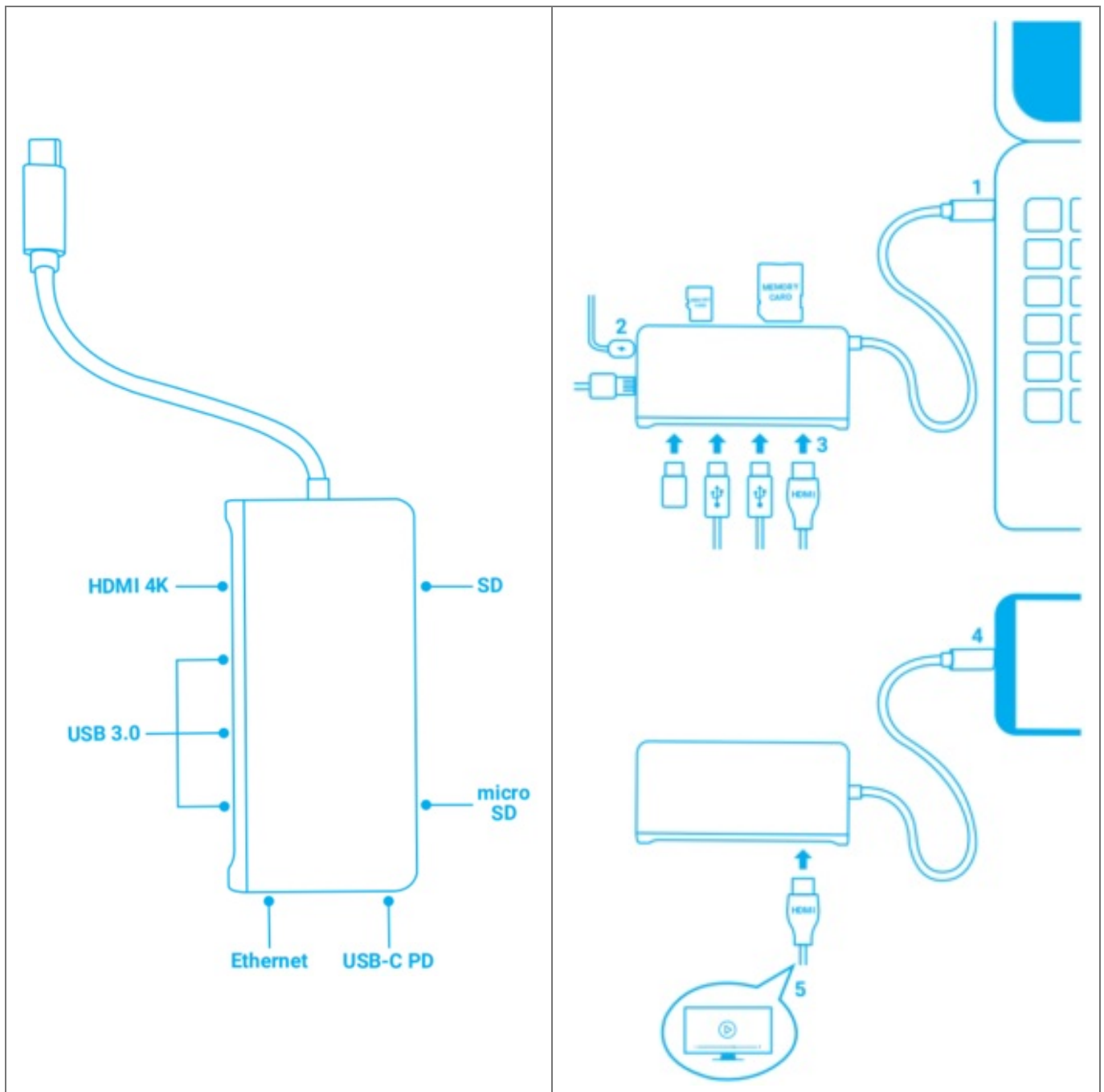

Contents

- [1 INSTRUCTION GUIDE](#)
- [2 REQUIREMENTS](#)
- [3 SAFETY INFORMATION](#)
- [4 GENERAL](#)
- [5 Documents / Resources](#)
 - [5.1 References](#)
- [6 Related Posts](#)

INSTRUCTION GUIDE

1. Plug the multi-port adapter into your computer/laptop via a USB Type-C port.
2. Connect the charger to pass through the PD port to charge your computer.
3. Connect the devices/accessories to the appropriate ports on the adapter (your operating system will

automatically install the required drivers).

4. Connect the multi-port adapter with your smartphone/tablet via its USB Type-C. *
5. Plug an HDMI cable into the adapter to project your phone's display onto your TV.

* Requires a USB Type-C port adapted to video transmission to operate.

REQUIREMENTS

- Laptop/smartphone or another compatible device with a USB-C port.
- Windows® XP/Vista/7/8/10, Linux 2.4 or above, Mac OS X 9.2 or above, Android 4.2 or above.

SAFETY INFORMATION

- Use as directed.
- Non-authorized repairs or taking the device to pieces make the warranty void and may cause the product damage.
- Avoid hitting or friction with a hard object, otherwise, it will lead to grinding surface or other hardware damage.
- Do not use the product in low and high temperatures, in strong magnetic fields, and in a damp or dusty atmosphere.
- Do not drop, knock, or shake the device.
- Rough handling can break it.

GENERAL

- Product covered with a 24-month warranty.
- The safe product conforms to the EU requirements.
- The product is made in accordance with RoHS European standards.
- The WEEE symbol (the crossed-out wheeled bin) using indicates that this product is not home waste. Appropriate waste management aids in avoiding consequences that are harmful to people and the environment and result from dangerous materials used in the device, as well as improper storage and processing. Segregated household waste collection aids recycle materials and components of which the device was made. In order to get detailed information about recycling this product please contact your retailer or local authority.



WWW.NATEC-ZONE.COM



[Visit our website](#)

Documents / Resources



[natec Fowler 2 Multi-Port Adapter](#) [pdf] User Manual
Z31228, 155253, Fowler 2 Multi-Port Adapter, Fowler 2, Multi-Port Adapter

References

- [NATEC | natural born technology](#)

[Manuals+.](#)