



**Contents** [ [hide](#) ]

[1 naki Pulse Single Speaker](#)

[2 Specifications](#)

[3 Features](#)

[4 In the Box](#)

[5 Wizard Setup & Listen](#)

[6 FCC Statement](#)

[7 FAQ](#)

[8 Documents / Resources](#)

[8.1 References](#)



## **naki Pulse Single Speaker**



## Specifications

- Wi-Fi connected audio system
- USB-C power adaptor
- Headphone output
- **Controls:** ON/OFF button, SELECT dial, VOLUME dial

## Welcome

- Thank you for purchasing a Naki Pulse. The Pulse will provide you and your family with hours of education and entertainment from approved music, stories, stations, and shows.
- For more options and choices of content available to hear on your Pulse be sure to visit the Portal at [portal.naki.audio](https://portal.naki.audio) or simply use the QR code. Once you create a free account and link your Pulse, you can add/remove content, use parental controls to limit usage, and more.



- To get the most out of your Pulse please refer to the online user guide which you can find here [support.naki.audio](https://support.naki.audio) or use this QR code.



## Safety

Please refer to the online User Manual for all safety instructions.

## Features

- **The Pulse is an advanced but easy-to-use Wi-Fi connected audio system with the following modes:**
  - Pulse plays pre-approved radio stations and podcasts from around the world.
  - Bluetooth®-In for external music sources, such as from a smartphone, tablet or other media players.
- **The Pulse also provides the following features:**
  - Color screen for easy control and clear information display.
  - Clock with auto-update capability and dual independent alarms with Sleep/Snooze.
  - Multiple network profiles for easy setup and portability.
  - Multiple language options including Hebrew.
  - Rechargeable battery.
  - Hand recess to enable easy carrying.

## In the Box

Carefully remove Pulse from its packaging and place it down on a hard, flat surface. The Pulse should be set upright, in a level position. After you unpack the box, you will find the following items:

1. Pulse
2. USB-C power adaptor (select between US or EU depending on your region)
3. Quick Start Guide

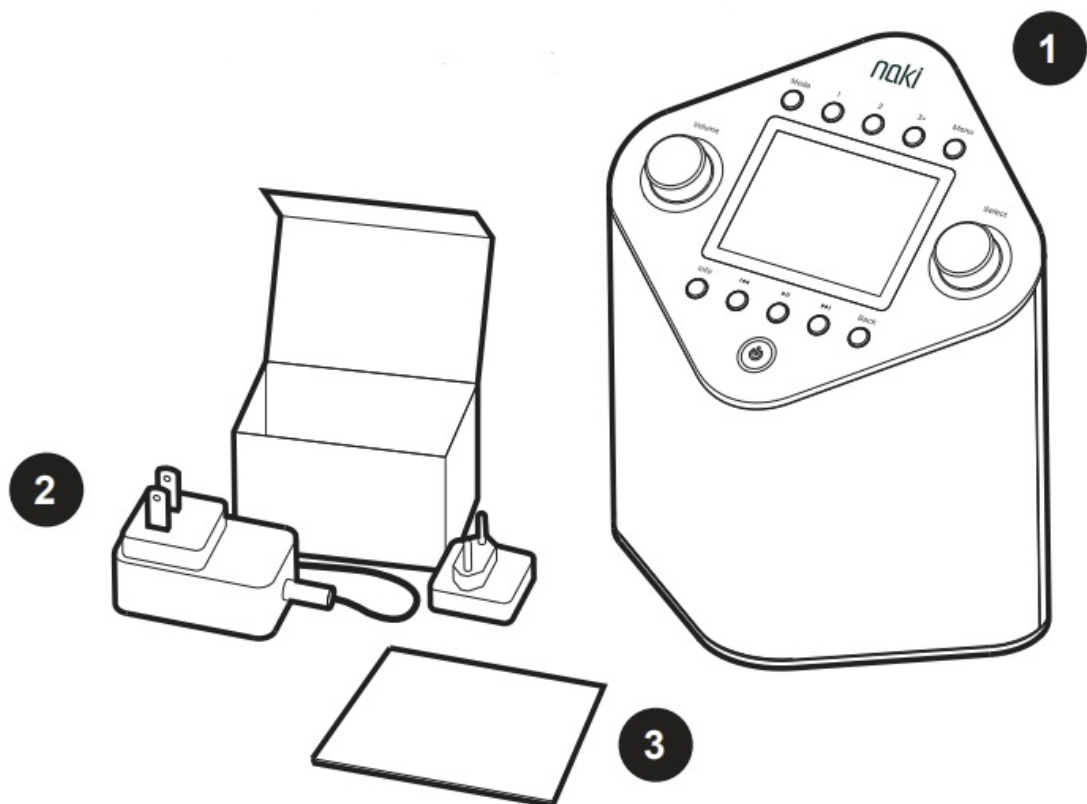

## Controls

Press the ON/OFF button to power on the device. Rotate the SELECT dial to navigate up or down through menus, and click to make a selection. Rotate the VOLUME dial to adjust the volume during playback, or click to mute sound.

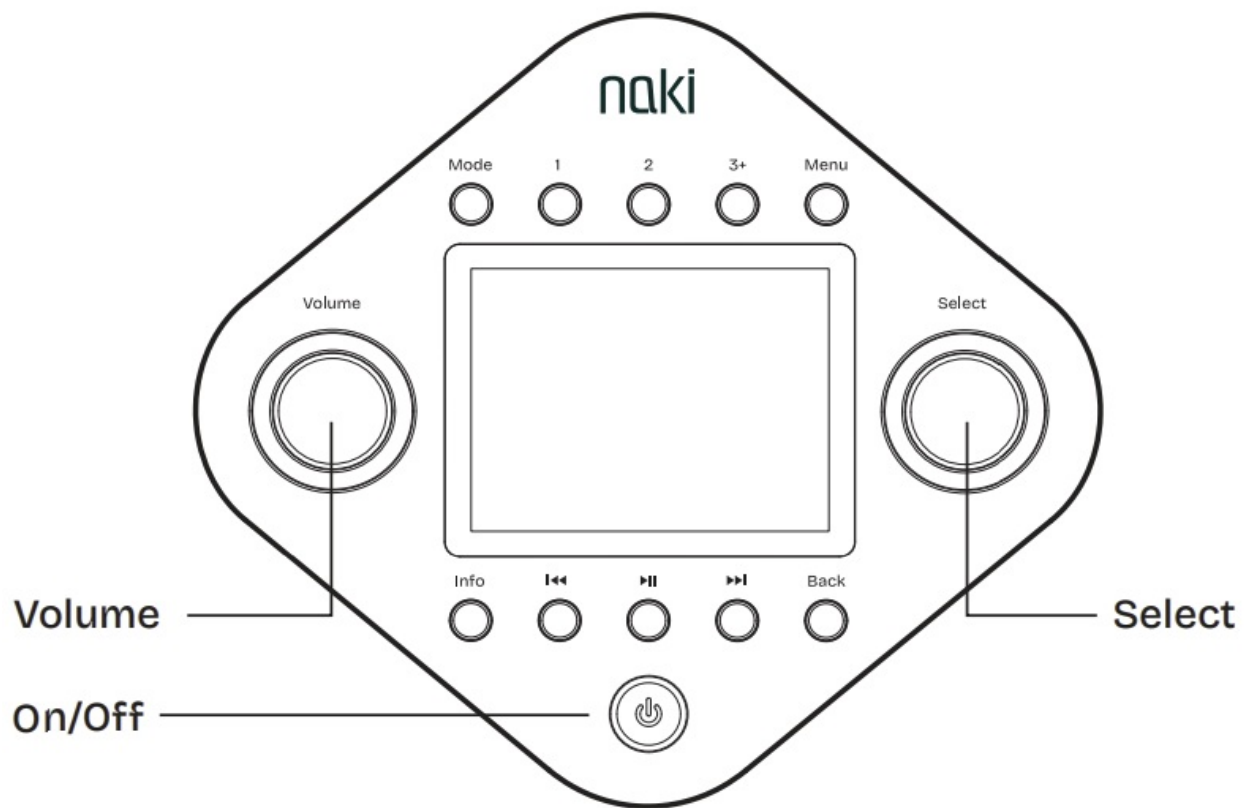

## Connectors

The Pulse has two connectors in the rear, a USB-C to power and charge the battery and jack to plug in wired headphones.

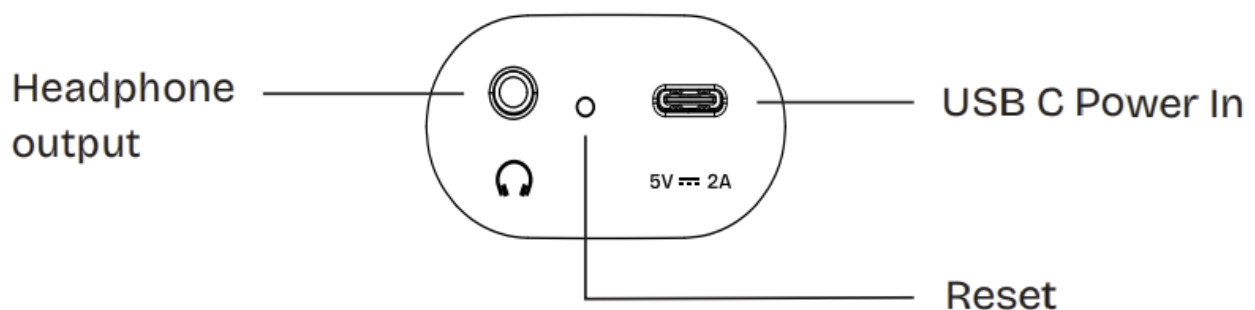

## Wizard Setup & Listen

YOU MUST HAVE A WIFI NETWORK WITH INTERNET ACCESS FOR THE PULSE TO ACCESS CONTENT.

- Plug included power adapter into a 110/220v power source.
- Press the ON/OFF button to power on the Pulse and to start the Setup Wizard, which will display on the screen. Rotate the SELECT dial to navigate through menus, then click the SELECT dial to make a selection.
- Select a time format. Click SELECT dial on the unit's right side to accept.

- Update from Network: Select YES to automatically update the time and date on your Pulse speaker.
- Set Time Zone: Scroll through and locate the time zone of your location, then click SELECT to continue.
- Locate and select your WiFi network, then click SELECT to continue.
- Enter your WiFi password/key by rotating and clicking on the SELECT dial.  
Uppercase/lowercase letters, numbers and symbols are located by scrolling with the SELECT dial. When complete, rotate the SELECT dial until OK is highlighted, then click SELECT to confirm.
- Highlight Content List and click the SELECT dial. Rotate the Select dial to highlight the selection of your choice, and click SELECT dial to start listening.
- Press the ON/OFF button to place the device in Standby mode.

The clock will be displayed. Press and hold the ON/OFF button to power off the device.

## Display

The screen shows various menus, dialogues and displays as described below.

- Mode selection
- Standby (clock)
- Menu
- Now playing
- Information
- Dialogue

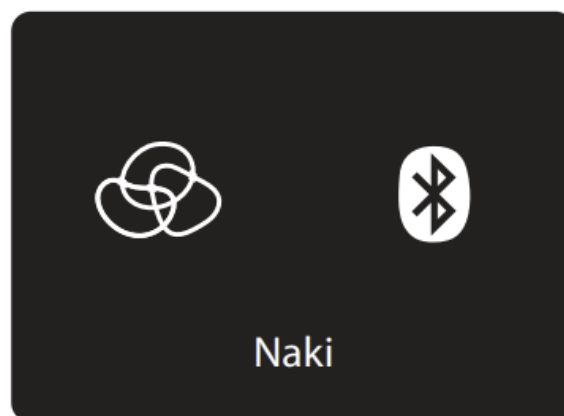

Where there is more text than can fit onto a screen, the text automatically scrolls after a brief pause. The standby screen shows the time and any active alarm times.



## Presets

- To save a preset, press and hold Preset 1 or 2 until PRESET SAVED appears. To recall from preset, press button 1 or button 2.

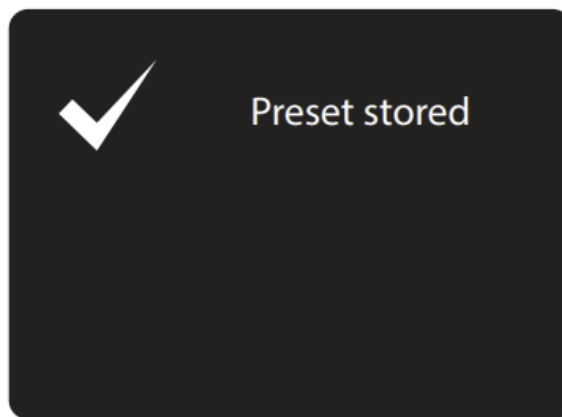

- For additional preset slots, use the 3+ button. To save additional presets, press and hold the 3+ until SAVE TO PRESETS appears.
- Highlight a slot in the menu and click the SELECT dial to save preset to slot.

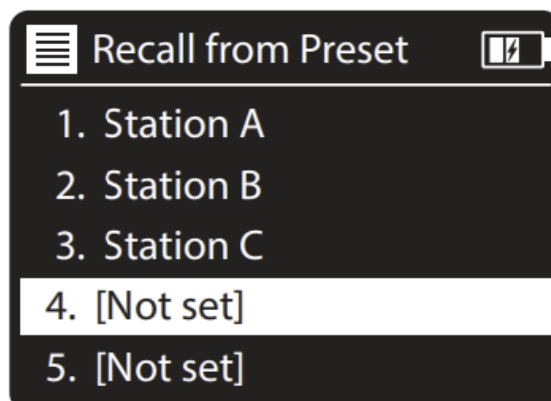

- To recall from Preset, click the 3+ button, use the SELECT dial to highlight a preset, and click the SELECT dial to begin playback.

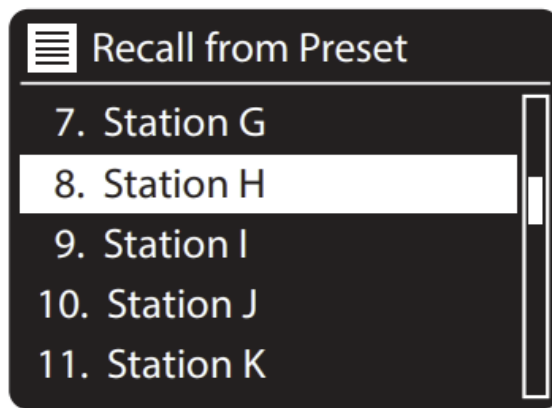

## FCC Statement

This equipment has been tested and found to comply with the limits for a Class B digital device, pursuant to part 15 of the FCC Rules. These limits are designed to provide reasonable protection against harmful interference in a residential installation.

**This device complies with part 15 of the FCC Rules. Operation is subject to the following two conditions:**

1. This device may not cause harmful interference, and
2. This device must accept any interference received, including interference that may cause undesired operation.

This equipment generates, uses and can radiate radio frequency energy and, if not installed and used in accordance with the instructions, may cause harmful interference to radio communications. However, there is no guarantee that interference will not occur in a particular installation. If this equipment does cause harmful interference to radio or television reception, which can be determined by turning the equipment off and on, the user is encouraged to try to correct the interference by one or more of the following measures:

- Reorient or relocate the receiving antenna.
- Increase the separation between the equipment and receiver.
- Connect the equipment to an outlet on a circuit different from that to which the receiver is connected.
- Consult the dealer or an experienced radio/TV technician for help.



Changes or modifications not expressly approved by the party responsible for compliance could void the user’s authority to operate the equipment.

The distance between user and products should be no less than 20cm.

FAQ

**Q: How do I power on the Naki Pulse?**

A: Press the ON/OFF button located on the device.

**Q: How can I adjust the volume on the Pulse?**

A: Rotate the VOLUME dial to adjust the volume or click it to mute the sound.

**Q: What do I need to access content on the Pulse?**

A: Ensure your Pulse is connected to a Wi-Fi network with internet access for content streaming.

Documents / Resources

	<a href="#">naki Pulse Single Speaker [pdf]</a> User Guide NK01, 2AWRTNK01, Pulse Single Speaker, Pulse, Single Speaker, Speaker
---	---

References

- [User Manual](#)

2AWRTNK01, naki, NK01, Pulse, Pulse Single Speaker, Single Speaker, naki speaker

—Previous Post  
[naki PulseMax Double Speaker User Manual](#)

Leave a comment

Your email address will not be published. Required fields are marked \*

Comment \*

Name

Email

Website

☐ Save my name, email, and website in this browser for the next time I comment.

Post Comment

Search:

e.g. whirlpool wrf535swhz

Search

[Manuals+](#) | [Upload](#) | [Deep Search](#) | [Privacy Policy](#) | [@manuals.plus](#) | [YouTube](#)

This website is an independent publication and is neither affiliated with nor endorsed by any of the trademark owners. The "Bluetooth®" word mark and logos are registered trademarks owned by Bluetooth SIG, Inc. The "Wi-Fi®" word mark and logos are registered trademarks owned by the Wi-Fi Alliance. Any use of these marks on this website does not imply any affiliation with or endorsement.