



## 1-BUTTON REMOTE CONTROL

MODEL: CH361



### Contents [ [hide](#) ]

- [1 Overview](#)
- [2 Programming the Remote](#)
- [3 Replacing the Battery](#)
- [4 Replacement Parts](#)
- [5 Additional Resources](#)
- [6 Contact Us](#)
- [7 Documents / Resources](#)
  - [7.1 References](#)

## Overview

Your remote control is compatible with all Chamberlain®, Lift Master®, and Craftsman® garage door openers manufactured after 1997 with the exception of Craftsman Series 100. The images throughout this manual are for reference only and your product may look different.

## **WARNING**

To prevent possible **SERIOUS INJURY** or **DEATH** from a moving gate or garage door:

- ALWAYS keep remote controls out of reach of children. NEVER permit children to operate, or play with the remote control transmitters.
- Activate gate or door ONLY when it can be seen clearly, is properly adjusted and there are no obstructions to door travel.
- ALWAYS keep gate or garage door in sight until completely closed. NEVER permit anyone to cross path of moving gate or door.

**⚠ WARNING:** This product can expose you to chemicals including lead, which are known to the State of California to cause cancer or birth defects or other reproductive harm. For more information go to [www.P65Warnings.ca.gov](http://www.P65Warnings.ca.gov).

Tap the buttons below to navigate to a specific section of the manual.

## **Programming the Remote**

### **Other important information:**

### **Replacing the Battery**

### **Replacement Parts**

### **Additional Resources**

## **Programming the Remote**

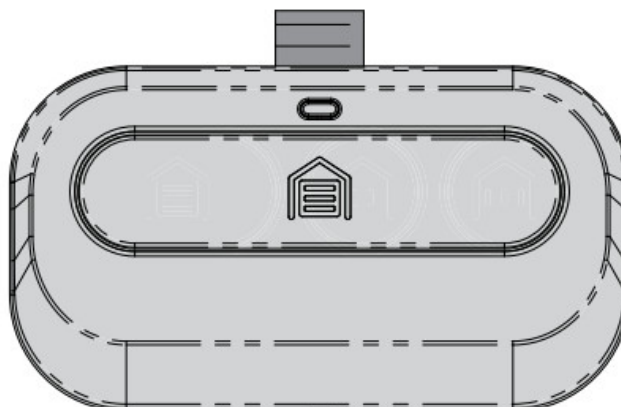

### **01 Prepare:**

-  Read through the Instructions carefully.
- Watch out for time sensitive instructions marked with an hourglass icon.
- Make sure the garage door is clear of ALL obstructions.
- Make sure the garage door opener has a working light. It will be needed for programming.

### 03 Prepare:

- Read through the Instructions carefully.
- Watch out for time sensitive instructions marked with an hourglass icon.
- Make sure the garage door is clear of ALL obstructions.
- Make sure the garage door opener has a working light. It will be needed for programming.

**02. IMPORTANT:** Your garage door opener has a LEARN button that is required to program your remote. Locate and identify the color of your garage door opener's LEARN button (A ladder may be required and you may have to remove a light cover).

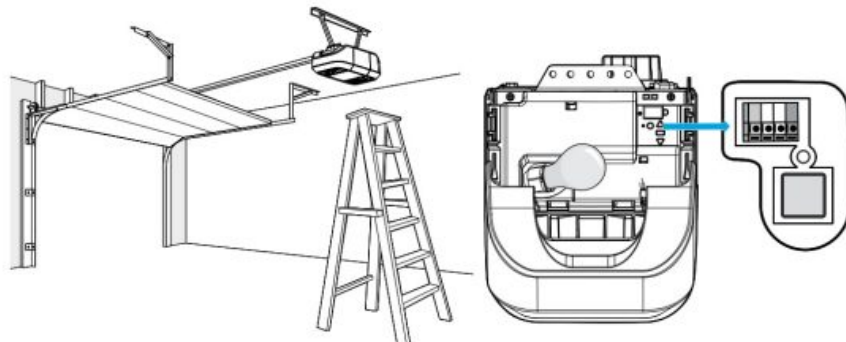

03. For remote programming instructions, tap the LEARN button color icon for your garage door opener **below**.

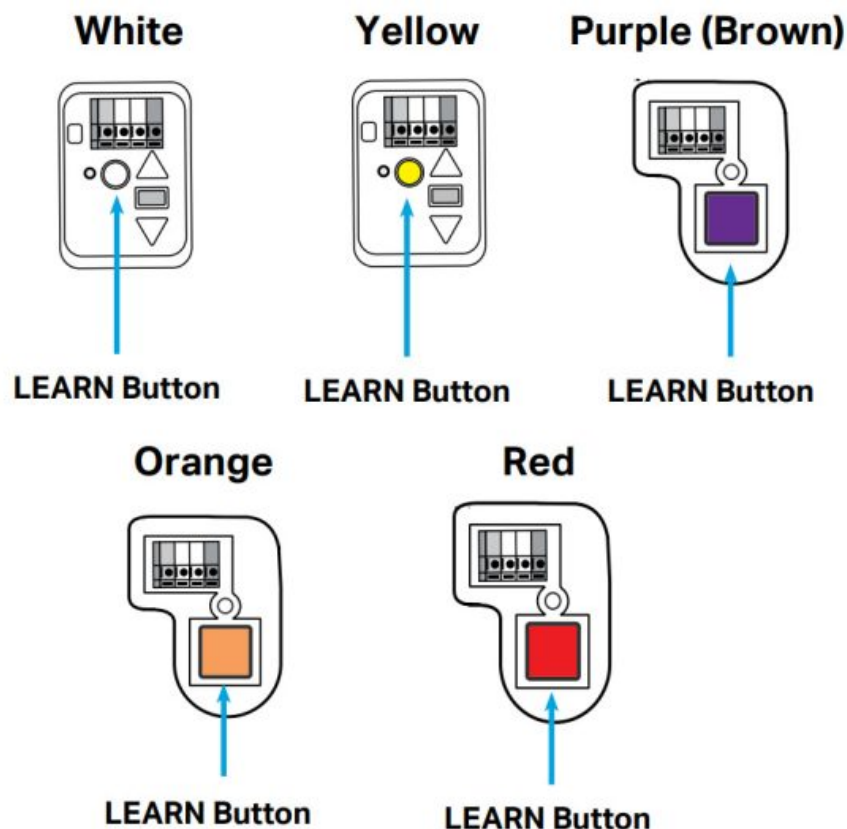

**NOTE:** The color of the purple LEARN button may fade with time and appear brown.

### Options to Program Remote to Garage Door Opener with a Yellow LEARN Button

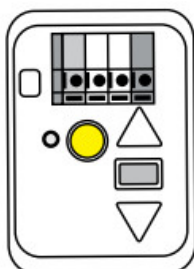

#### Yellow

There are three ways to program your remote to a garage door opener with a yellow LEARN button. Tap your preferred method below.

Option 1: To program your remote using the myQ app, tap the myQ app icon.



**Option 2:** To program your remote using garage door opener's LEARN button, tap the LEARN button icon.

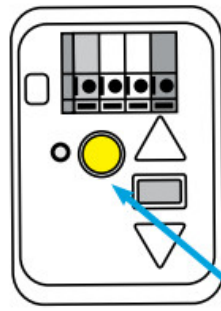

**LEARN Button**

**Option 3:** To program your remote using garage door opener's control panel, tap the control panel icon.

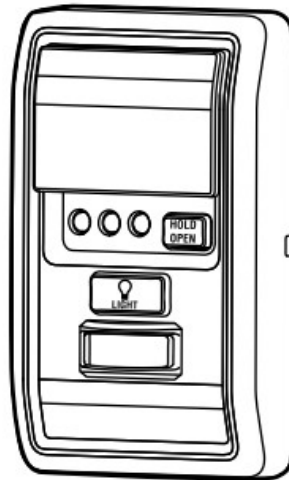

Program Remote to Garage Door Opener Using a Yellow, Purple, Orange, or Red LEARN Button

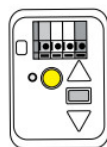

**Yellow**

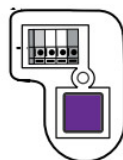

**Purple (Brown)**



**Orange**

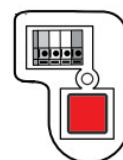

**Red**

**IMPORTANT:** Read through all programming steps before you start.



01 **4 Seconds** Press and release the remote button 6 times within 4 seconds. The remote's red LED will stay on.

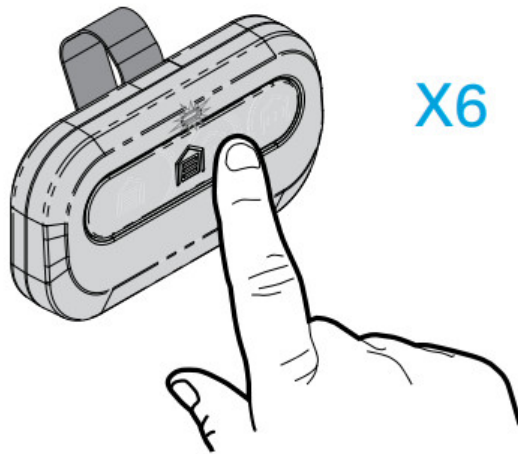

02 Press and immediately release the LEARN button.

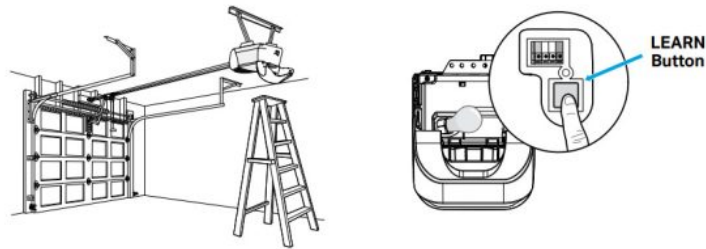

03  Within 20 seconds of pressing the LEARN button, press and release the remote button twice. The red LED will flash **intermittently**.

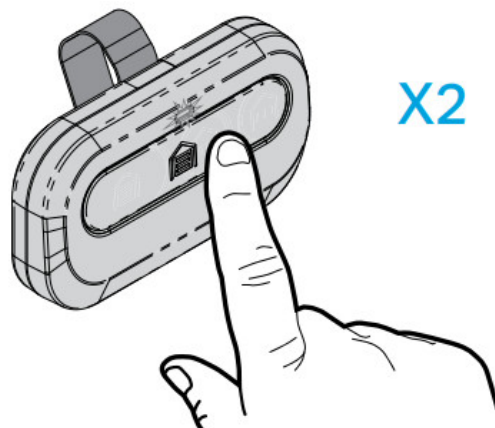

**WARNING:** Your garage door opener light will flash and your garage door will move.

04  When your garage door moves, within 3 seconds, press and release the remote button.

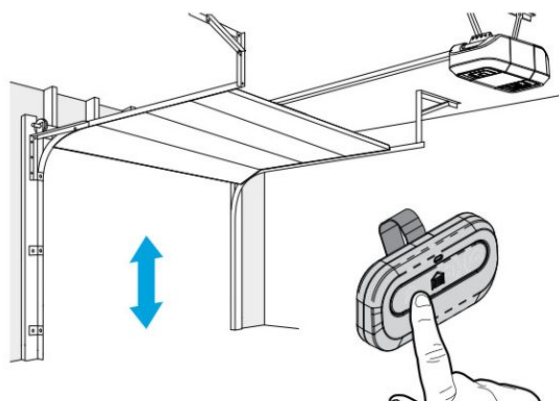

## Program Remote to Garage Door Opener with a Yellow LEARN Button Using the Control Panel

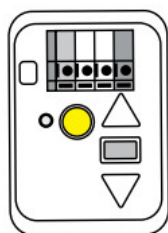

**Yellow**

**IMPORTANT:** Read through all programming steps before you start.



01 4 Seconds Press and release the remote button 6 times within 4 seconds. The remote's red LED will stay on.

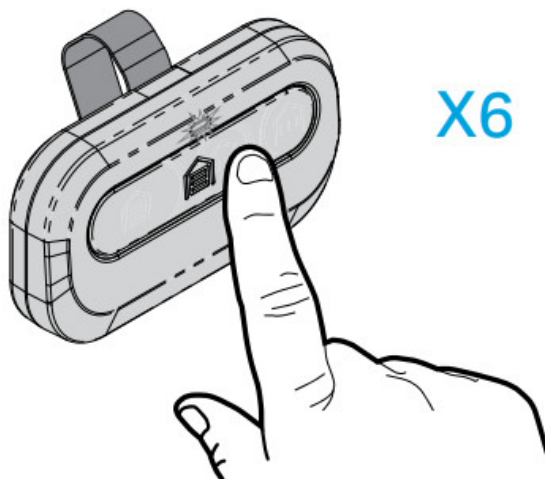

02 Follow the instructions below for your control panel model to set your garage door opener into programming mode.

### Control Panel

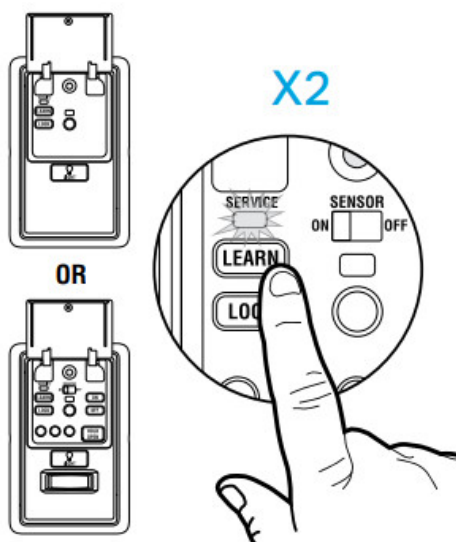

Lift the push bar. Press the LEARN button twice. The LED on the door control panel will

pulse repeatedly.

## Push Button Door Control

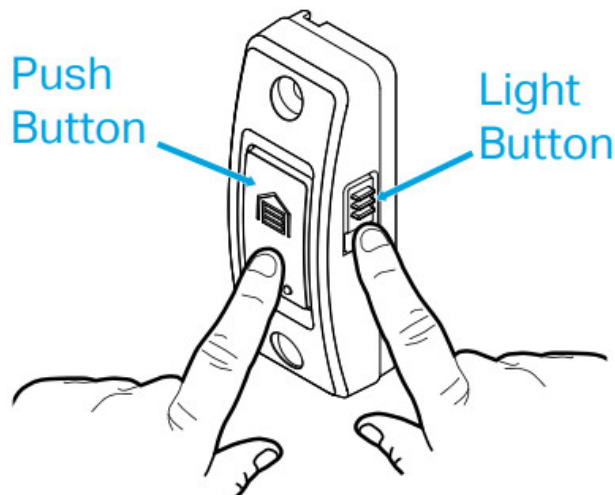

Press and hold the light button, then press and release the push button. The button LED will begin to flash.

## Smart Control Panel

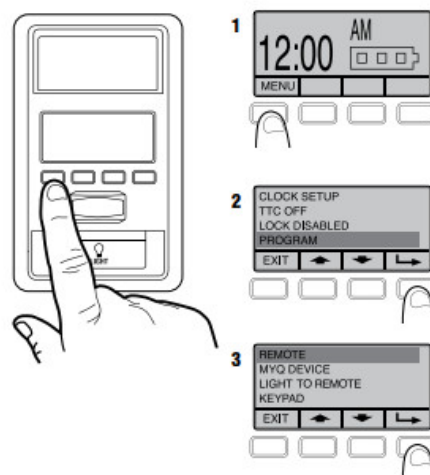

1. Select MENU.
2. Scroll down and select PROGRAM.
3. Scroll down and select REMOTE.

**Do not follow on screen instructions.**

**MOVE DIRECTLY TO STEP 03.**

**03**  Within 20 seconds of completing step 02, press and release the remote button twice. The red LED will flash intermittently.



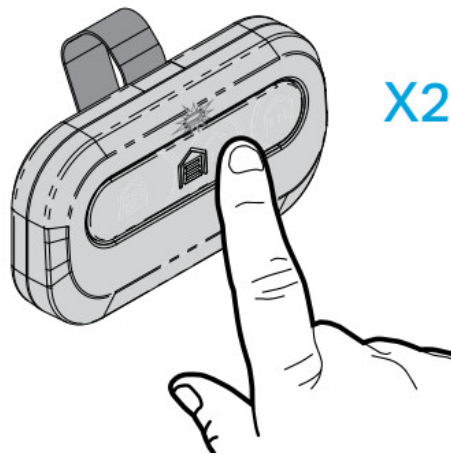

**WARNING:** Your garage door opener light will flash and your garage door will move.

04  When your garage door moves, within 3 seconds, press and release the remote button.

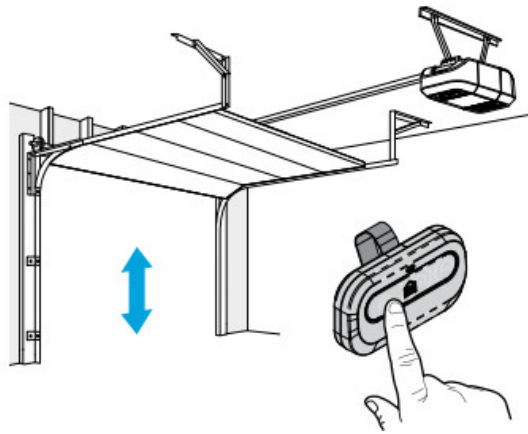

To test your remote has programmed successfully **tap here.**

### Options to Program Remote to Garage Door Opener with a White LEARN Button

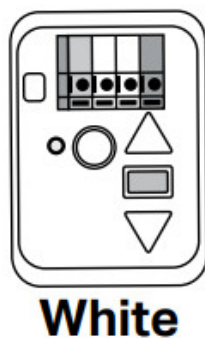

There are three ways to program your remote to a garage door opener with a white LEARN button. Tap your preferred method below.

**Option 1:** To program your remote using the myQ app, tap the myQ app icon.



**Option 2:** To program your remote using garage door opener's LEARN button, tap the LEARN button icon.

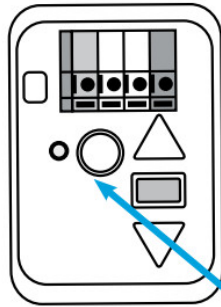

**LEARN Button**

**Option 3:** To program your remote using garage door opener's control panel, tap the control panel icon.



Program Remote to Garage Door Opener with a White or Yellow LEARN Button Using the myQ **App**



**White**



**Yellow**

**HIGHLY RECOMMENDED:** Connect your garage door opener to the myQ app and program your remote to the garage door opener to unlock exciting features that include remote naming, notifications, and access history.

01 Look for a “Wi-Fi” or “Powered by myQ” logo to determine if your garage door opener is myQ compatible.

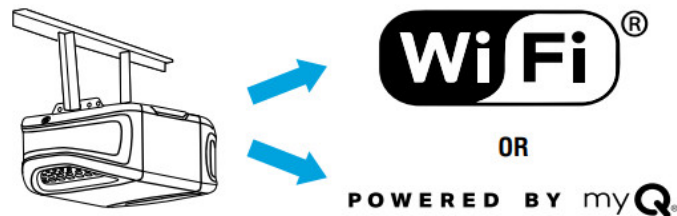

02 Tap or scan the QR code while using your smart device to download the myQ app. Follow the instructions in the app to connect to your garage door opener.



[https://myq.smart.link/j7pdoqigi?device\\_id=device\\_id&qrcode=true&site\\_id=1](https://myq.smart.link/j7pdoqigi?device_id=device_id&qrcode=true&site_id=1)

03 When your garage door opener is connected, scan the QR code on the reverse side of your remote, and follow the programming instructions in the myQ app.

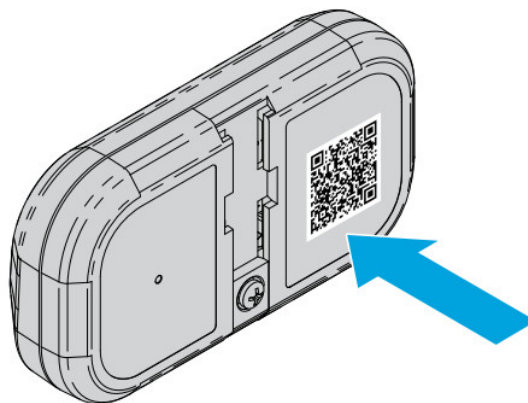

Once your remote is programmed in the myQ app, you can name your remote, view access history, and receive notifications when your remote activates the garage door opener.

**Program Remote to Garage Door Opener with a White LEARN Button Using the**

## LEARN Button

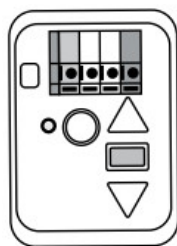

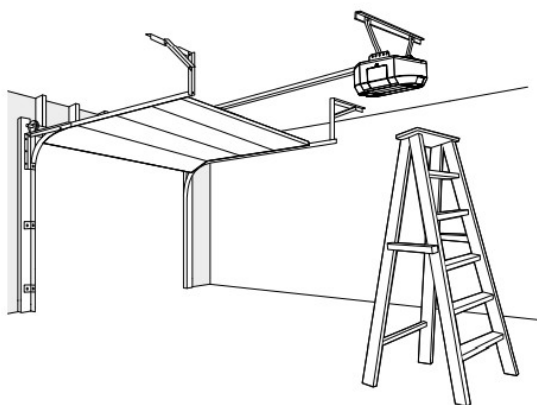

**White**

**IMPORTANT:** Read through all programming steps before you start

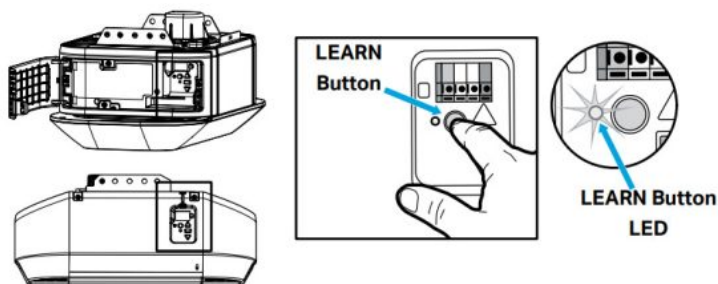

01. Press and immediately release the LEARN button.



02.  Within 30 seconds, press and hold the remote button. Release the button when the garage door opener lights flash and/or two clicks are heard.

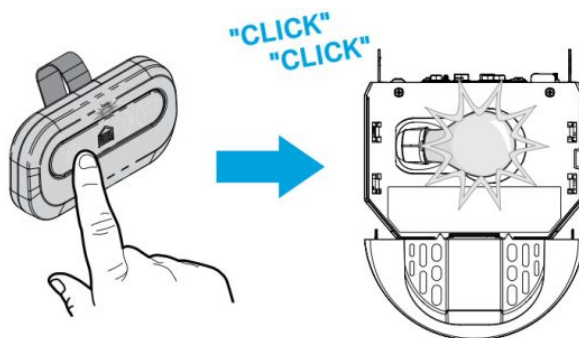

To test your remote has programmed successfully **tap here**.

**Program Remote to Garage Door Opener with a White LEARN Button Using the**

## Control Panel

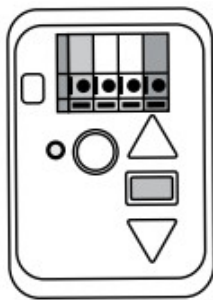

**White**

**IMPORTANT:** Read through all programming steps before you start

01 Follow the instructions below for your control panel model to set your garage door opener into programming mode.

## Control Panel

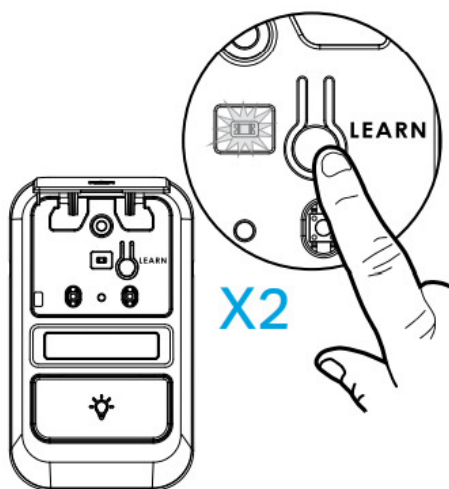

Lift the push bar. Press the LEARN button twice. The LED on the door control panel will pulse repeatedly.

## Push Button Door Control

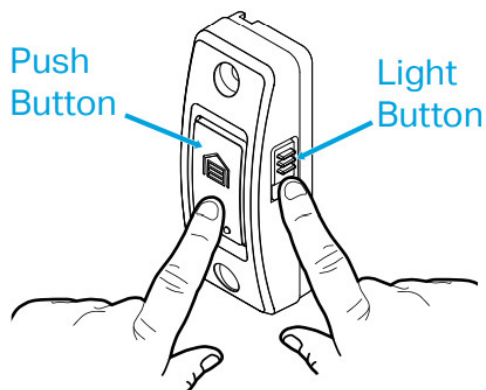

Press and hold the light button, then press and release the push button. The button LED will begin to flash.

## Smart Control Panel

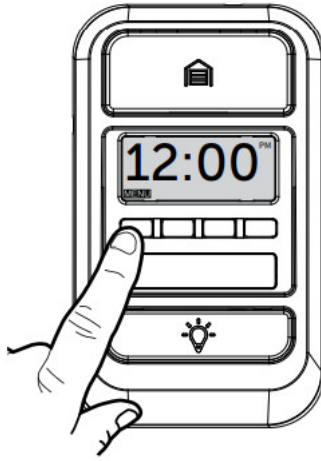

Select MENU, then select PROGRAM and follow on screen instructions.

02.  Within 30 seconds, press and hold the remote button. Release the button when the garage door opener lights flash and/or two clicks are heard.

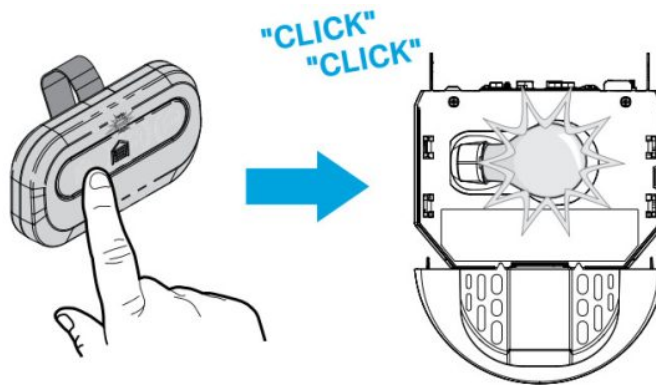

To test your remote has programmed successfully **tap here**.

### Test your Remote has Programmed Successfully

**TEST FOR SUCCESS:** Press the remote button. The garage door opener will activate.

If the garage door opener does not activate, wait for the garage door opener's LEARN button LED to turn off (for a yellow or white LEARN button this could take up to 3 minutes). Then repeat the programming steps, go to **"Programming the Remote"**.

**TROUBLESHOOTING:** If you are trying to program your remote to a garage door opener with a white LEARN button and previously programmed the same remote to a garage door opener with a different color LEARN button, use the programming instructions on **page 5**.

**Please note:** if you use these instructions, the garage door will not move – when the garage door opener lights flash and/or clicks once, the remote has programmed successfully.

## Replacing the Battery

The LEDs on your remote will become dim or stop flashing when the battery is low and needs to be replaced. Replace the battery with only 3V CR2032 coin cell battery.

Dispose of the old battery properly.

To replace the battery, follow the instructions as shown below. Reference the illustration below for each step.

01. On the back side of the remote, using a Phillips #1 screwdriver, unscrew the captive screw until it rotates **freely**.

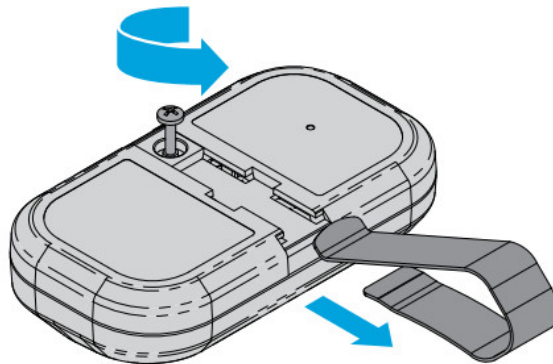

02. With the remote button side up, pry open the remote top housing from the bottom housing (if the housing will not separate, check that the captive screw is rotating freely).

**NOTE:** The logic board could detach from the remote button. If this occurs, carefully replace using the guiding holes in the board.

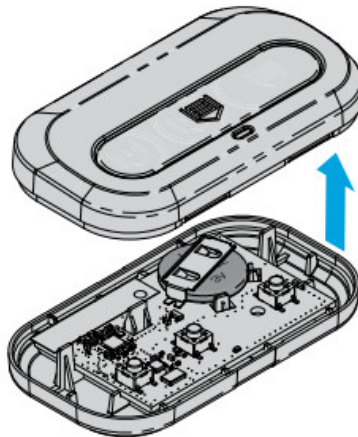

03. With a cotton swab, push the old battery out of its holder in the direction of the nearest edge.

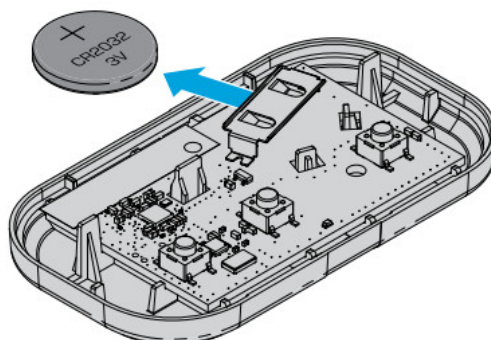



04. Insert the replacement battery positive side up.

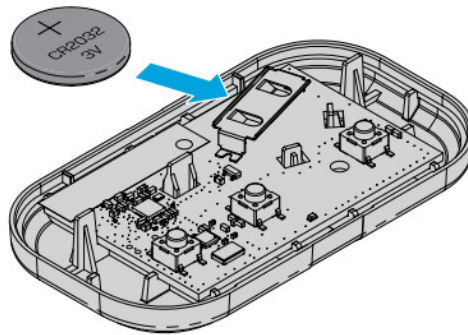

05. Align the remote top and bottom housing so they clip together. Tighten the captive screw until the top and bottom housing no longer shift (do not overtighten the screw to avoid cracking the plastic housing).

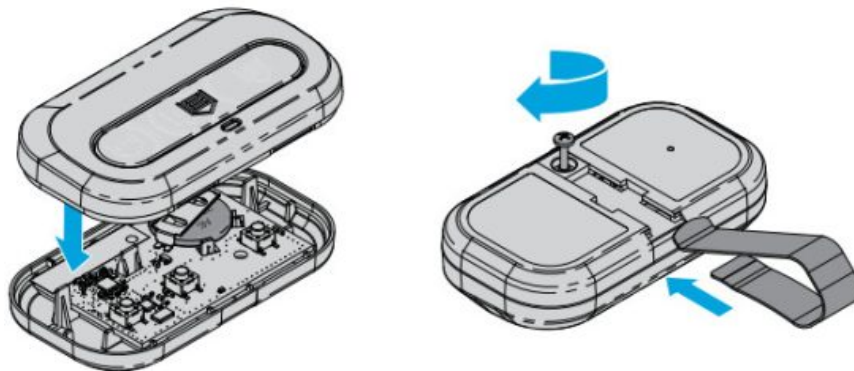

#### WARNING



- INGESTION HAZARD: This product contains a button cell or coin battery.
- DEATH or serious injury can occur if ingested.
- A swallowed button cell or coin battery can cause Internal Chemical Burns in as little as 2 hours.
- KEEP new and used batteries OUT OF REACH of CHILDREN.
- Seek immediate medical attention if a battery is suspected to be swallowed or inserted inside any part of the body.

#### WARNING

- Remove and immediately recycle or dispose of used batteries according to local regulations and keep away from children. Do NOT dispose of batteries in household



trash or incinerate.

- Even used batteries may cause severe injury or death.
- Call a local poison control center for treatment information.
- Battery Type: CR2032
- Battery Voltage: 3 V
- Non-rechargeable batteries are not to be recharged.
- Do not force discharge, recharge, disassemble, heat above (manufacturer's specified temperature rating) or incinerate. Doing so may result in injury due to venting, leakage or explosion resulting in chemical burns.
- Ensure the batteries are installed correctly according to polarity (+ and -).
- Do not mix old and new batteries, different brands or types of batteries, such as alkaline, carbon-zinc, or rechargeable batteries.
- Remove and immediately recycle or dispose of batteries from equipment not used for an extended period of time according to local regulations.
- Always completely secure the battery compartment. If the battery compartment does not close securely, stop using the product, remove the batteries, and keep them away from children.

## Replacement Parts

Description	Part Number
Visor Clip	041-0494-000

## Additional Resources

### One Year Limited Warranty

The Chamberlain Group LLC ("Seller") warrants to the first consumer purchaser of this product that it is free from defect in materials and/or workmanship for a period of 1 year from the date of purchase.

For more information, visit [www.myq.com/warranty](http://www.myq.com/warranty)

## Contact Us

For additional information or assistance, please visit: [support.chamberlaingroup.com](http://support.chamberlaingroup.com)

**NOTICE:** This device complies with part 15 of the FCC rules and Innovation, Science and Economic Development Canada license-exempt RSSs. Operation is subject to the following two conditions: (1) This device may not cause harmful interference, and (2) this device must accept any interference received, including interference that may cause undesired operation. Any changes or modification not expressly approved by the party responsible for compliance could void the user’s authority to operate the equipment.



©2025 The Chamberlain Group LLC  
114-6063-000 (Rev. B)

myQ and the myQ logo are trademarks, service marks, and/or registered trademarks of The Chamberlain Group LLC.  
All other trademarks, service marks and product names used herein are the property of their respective owners.

The Chamberlain Group LLC. 300 Windsor Drive, Oak Brook, IL, 60523, United States  
See [chamberlain.com/patents](https://chamberlain.com/patents)

## Documents / Resources

	<a href="#">myQ CH361 1 Button Remote Control [pdf]</a> Instruction Manual CH361 1 Button Remote Control, CH361, 1 Button Remote Control, Button Remote Control, Remote Control
---	--

## References

- [User Manual](#)

🔍 1-Button Remote Control, Button Remote Control, CH361, CH361 1 Button Remote Control, myQ, Remote

📁 myQ Control

---

Leave a comment

Your email address will not be published. Required fields are marked \*

Comment \*

Name

Email

Website

☐ Save my name, email, and website in this browser for the next time I comment.

**Post Comment**

**Search:**

e.g. whirlpool wrf535swhz

**Search**

[Manuals+](#) | [Upload](#) | [Deep Search](#) | [Privacy Policy](#) | [@manuals.plus](#) | [YouTube](#)

This website is an independent publication and is neither affiliated with nor endorsed by any of the trademark owners. The "Bluetooth®" word mark and logos are registered trademarks owned by Bluetooth SIG, Inc. The "Wi-Fi®" word mark and logos are registered trademarks owned by the Wi-Fi Alliance. Any use of these marks on this website does not imply any affiliation with or endorsement.