

## MYHIXEL II Climax Control Simulation Device Instruction Manual

[Home](#) » [MYHIXEL](#) » MYHIXEL II Climax Control Simulation Device Instruction Manual 

### MYHIXEL II Climax Control Simulation Device Instruction Manual



Congratulations! You have just taken the first step towards improving your sex life. MYHIXEL is an absolute revolution for men that improves their sexual well-being in a natural and enjoyable way: #nextlevel pleasure. The MYHIXEL method combines the anonymized MYHIXEL Play app, with a gamified program and activities to learn how to control ejaculation, along with the advanced MYHIXEL II stimulator device, specifically designed to achieve climax control.

In addition, In MYHIXEL we have a wide range of products and services created especially for you to enjoy your MYHIXEL experience to the fullest and that will make your enjoyment even more complete.

**NOTICE:** Please read these instructions carefully before using your MYHIXEL II device.

## **WARNINGS AND RECOMMENDATIONS FOR USE:**

- MYHIXEL II is a product for adults
- Do not use the product if you have irritated or damaged skin on the penis or penile area. If you feel pain or discomfort during use, stop using the product and contact a specialist. In MYHIXEL CLINIC you can access our platform with different professionals who can help you: <https://myhixel.com/es/pages/myhixel-clinic-consultations>
- It is not advisable to use the device for more than 25 minutes at a time. Specialists recommend not to perform continuous penetration for more than 25 minutes, either through masturbation with the hand, in the context of partner sex, or with a masturbator device.
- Do not touch the stick or the heating base (see point “MYHIXEL II device”) when the heating function has been switched on, as this may cause burns.
- This product should be kept out of the reach of children.
- We recommend not sharing your MYHIXEL II device with anyone for hygienic reasons.
- In the case of using lubricant with your MYHIXEL II device, we advise you to use only water-based lubricant, such as MYHIXEL Lube, specially designed for our products, as other types of lubricants may damage the anatomical sleeve (see point “MYHIXEL II device”).
- It is recommended to dry the anatomical sleeve always in the air, never in the microwave or any other appliance, as it could be damaged.
- During cleaning, disconnect the device from the charging cable/power supply.
- Tampering with the battery is not recommended, as improper handling may cause uncontrolled exothermic reactions. In this case, dispose of the entire product properly and immediately.
- During charging, prevent the device as well as plugs and sockets from coming into contact with liquids, as this may cause damage.
- Do not place the device on cards with magnetic strips, pacemakers, or other mechanical and electronic products, as the magnetic fields may influence their components and operation.
- Disconnect the charging cable from the power supply after each charging process.
- Do not forcibly open the device to perform repairs yourself. Do not insert sharp objects into the device.
- Do not submerge the device in water deeper than 1 meter (If you immerse your device in water, the bluetooth connection with the app will be lost).
- Do not insert the heating base into any body orifice.

## Contents

- 1 WHAT'S IN THE BOX
- 2 MYHIXEL II DEVICE
- 3 INSTRUCTIONS FOR USE OF THE DEVICE
- 4 CLEANING AND STORAGE OF THE DEVICE
- 5 EXEMPTION FROM LIABILITY
- 6 Documents / Resources
  - 6.1 References
- 7 Related Posts

## WHAT'S IN THE BOX

1. MYHIXEL II device

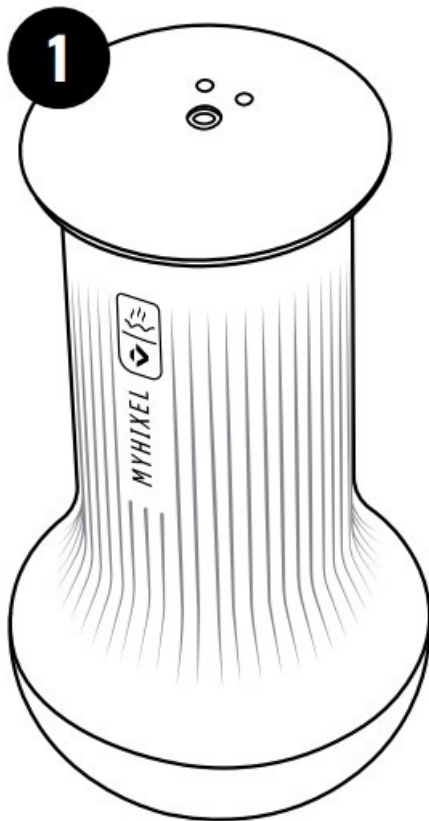

2. Charging cable USB A

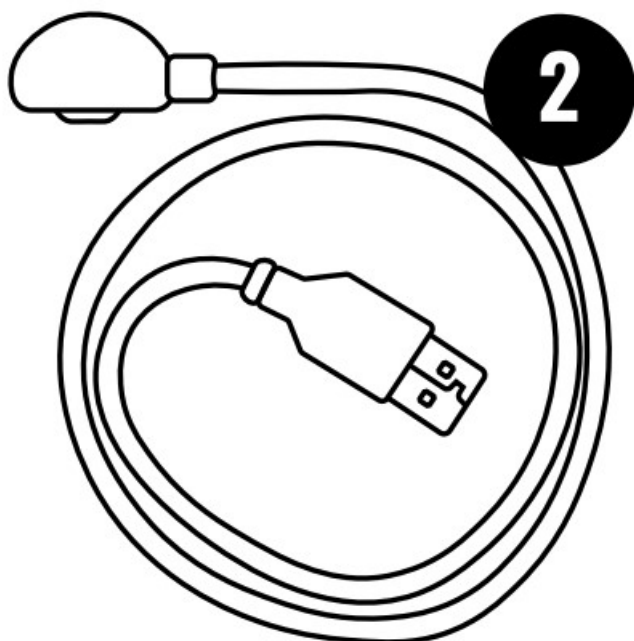

3. Instruction Manual

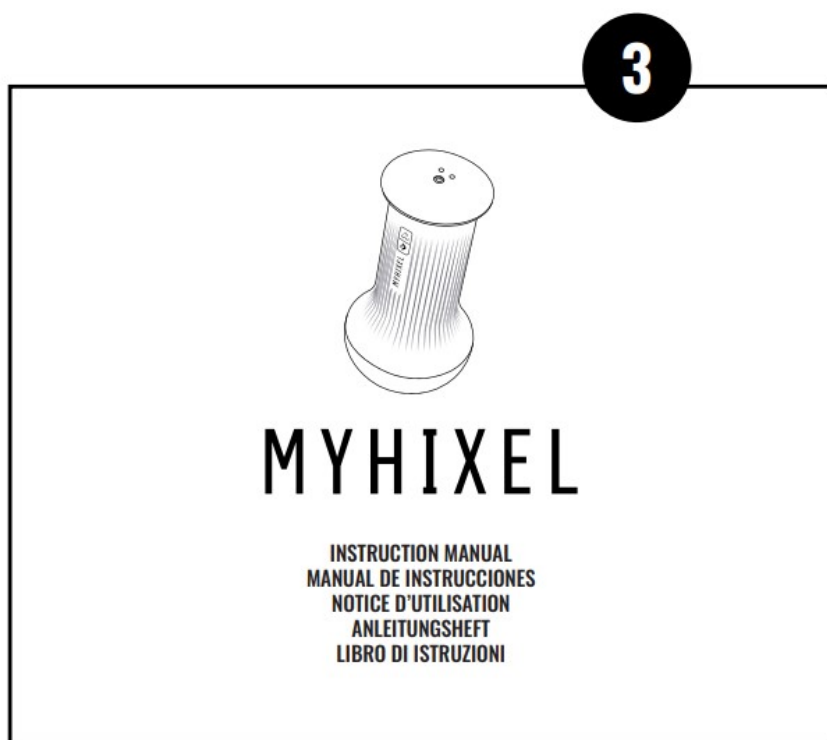

4. MYHIXEL Play app activation card

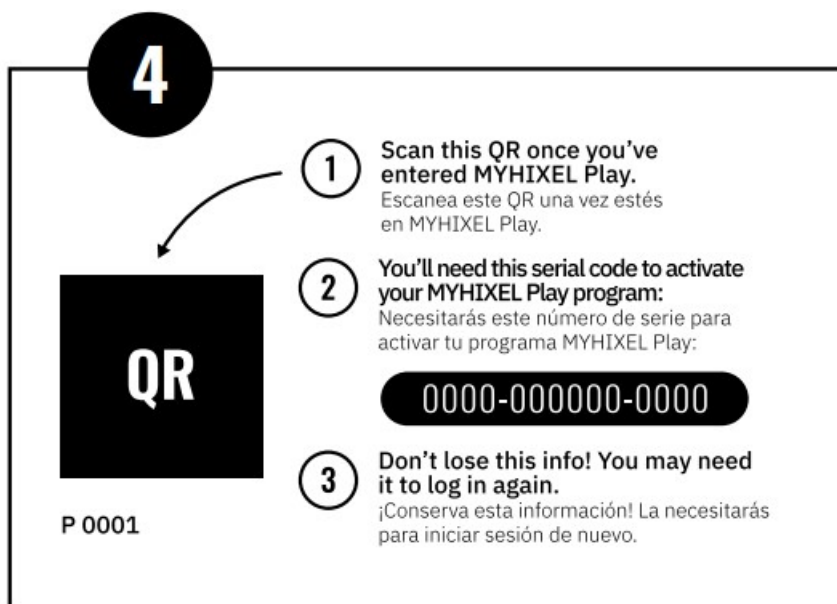

## MYHIXEL II DEVICE

1. Magnetic charging pins
2. Hands free thread
3. Two anti suction holes
4. Vibration & Warming button
5. Power button
6. Integrated vibration motor
7. Inner sleeve canal
8. Sleeve anatomically realistic
9. Heating base and stick
10. Connection magnets

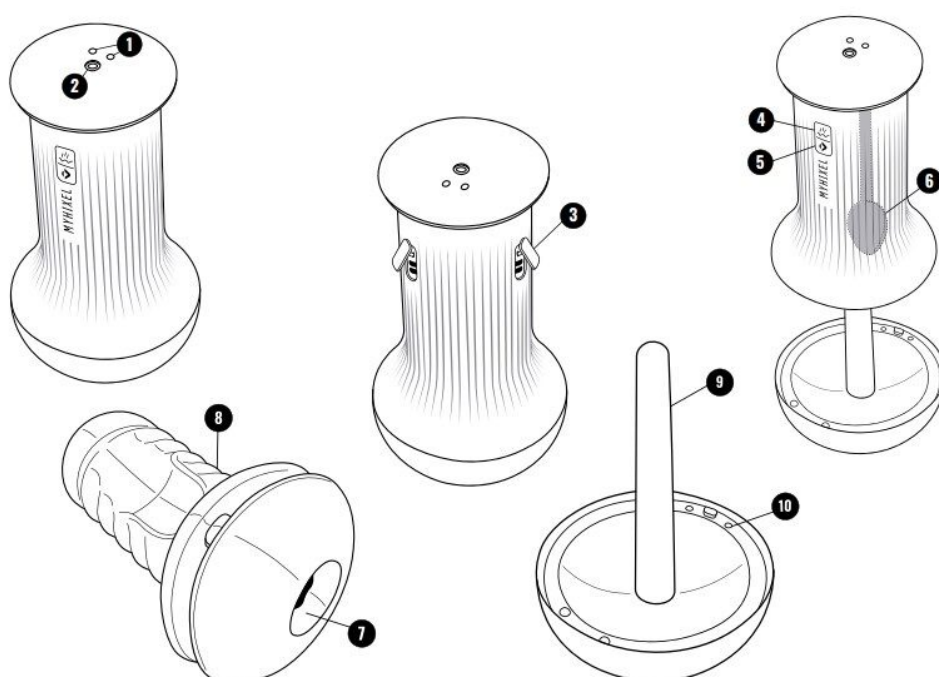

## INSTRUCTIONS FOR USE OF THE DEVICE

1. Open the box and remove your MYHIXEL II device.

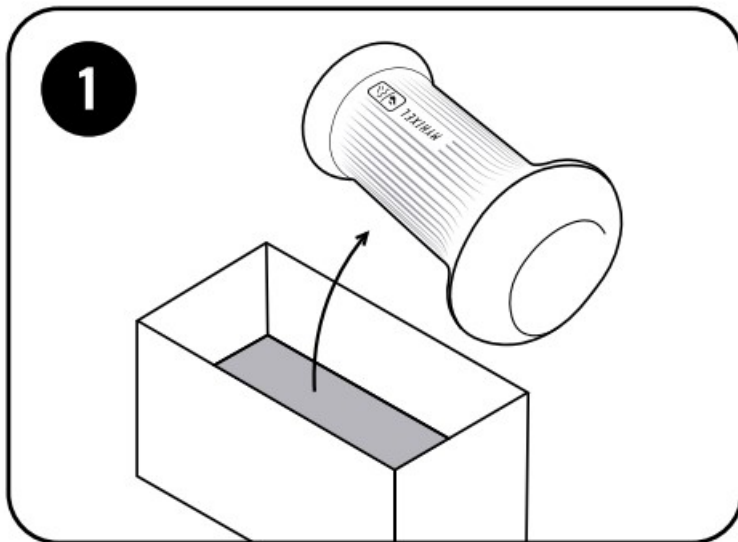

2. Before using it for the first time, it is necessary to fully charge it. Use only the supplied charging cable, connect it to the device as explained in the pictures and plug it into the power supply through a BY adapter for 3-4 hours (you can use the same charger of your cell phone with the cable supplied). If it is not the first time you use it, before charging, make sure that the device is completely dry, paying special attention to the area of the magnetic charging pins.

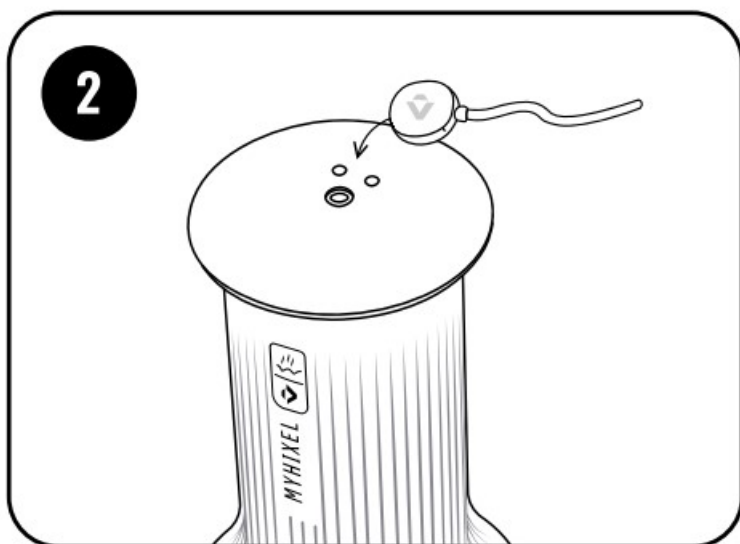

3. Once charged, disconnect it from the power supply, and press button Z for at least two seconds. After this time, both buttons will light up confirming that the device is on.

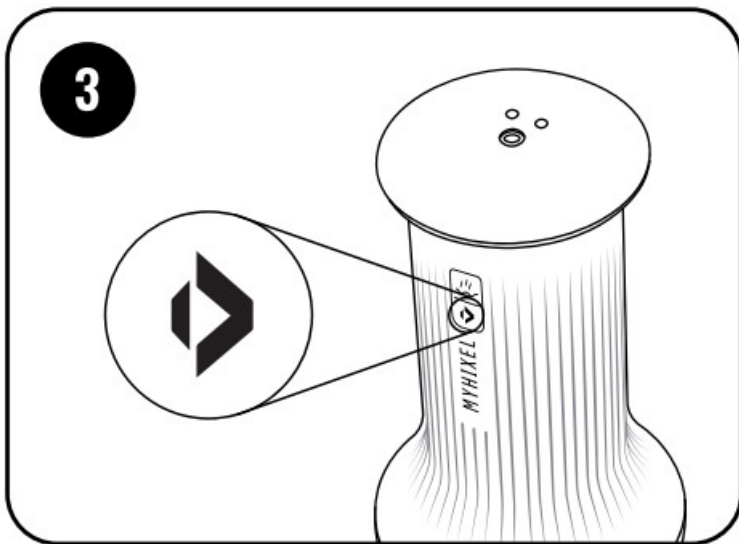

4. How to connect the app with your device. **IMPORTANT:** you will not be able to connect your device to the app via Bluetooth until you have previously activated your MYHIXEL PLAY. Access the URL of your MYHIXEL PLAY activation card to see the complete tutorial.

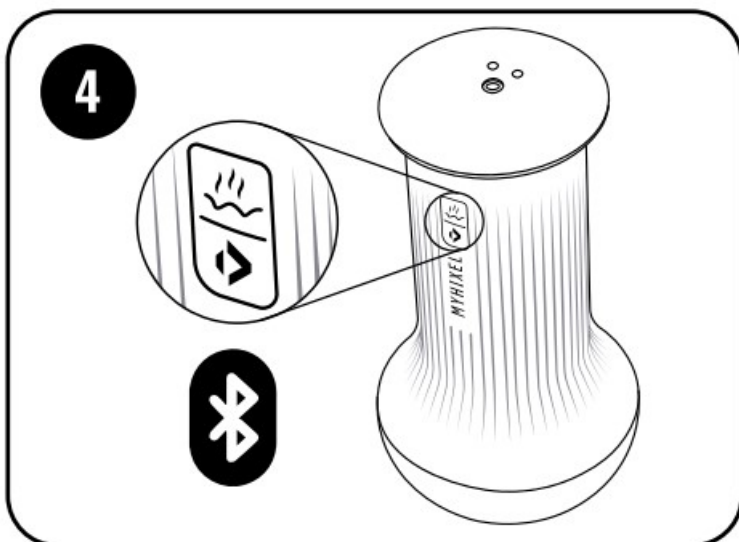

- 4.1** To connect the app to the device via Bluetooth press buttons 1 and 2 at the same time (2 seconds) until they start flashing simultaneously.
- 4.2** Open the MYHIXEL Play app and from the main screen. click Comet Device". Follow the instructions to complete the connection.
5. To start heating the device. press button 1. The LED on the device will light up and start blinking indicating that the device is heating up. After 5 minutes. the LEO will stop flashing. indicating that the proper temperature has been reached. However. unless you remove the heating base or press button 1 again, the device will continue to heat up for an additional 5 minutes (a total of 10 minutes). reaching a higher temperature. At the end of these 10 minutes. it will automatically stop heating. Therefore, if you want to interrupt the heating process before the 10 minutes are up. simply press button 1 again or open the heating base.

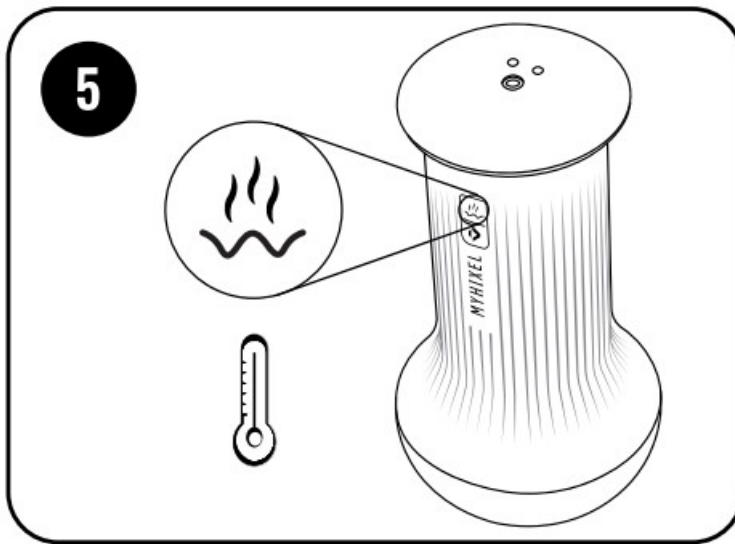

6. Once heated and connected to the App. remove the heating base to gain access to the sleeve. To remove and replace the heating base, always do it directly and vertically, without turning it. Also make sure that the cover fits correctly and the magnetized pins make a connection when closing.

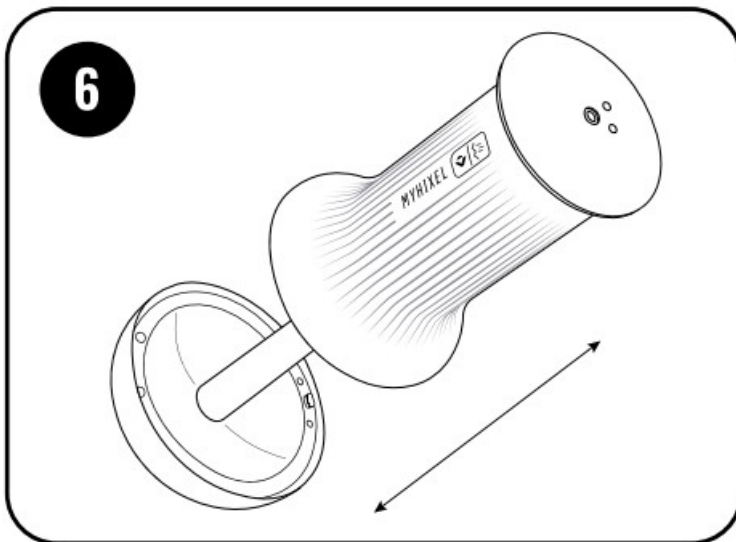

7. We recommend using lubricant with your device. Lubricate the inlet hole and the inner channel of the sleeve liberally. Use a water-based lubricant, such as MYHIXEL tube.

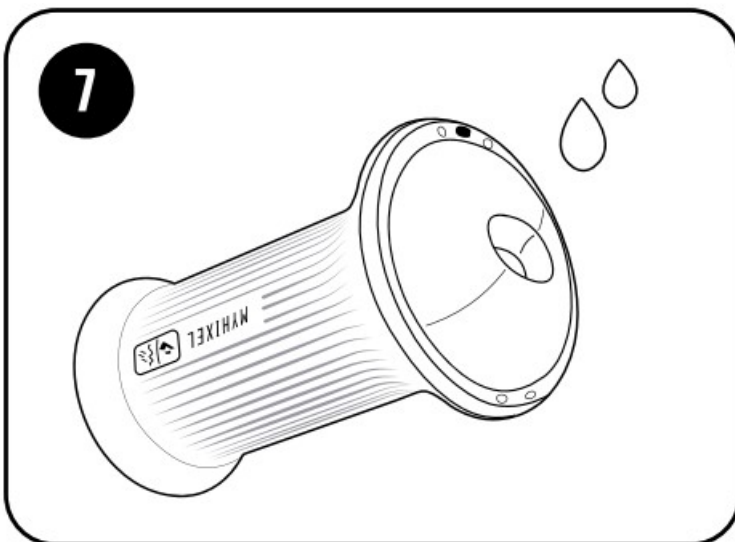

8. **IMPORTANT!** Before using the device, make sure that the two suction tabs (see Point “MYHIXEL II device”) are open so that you can insert your penis easily and without feeling discomfort due to the suction effect.



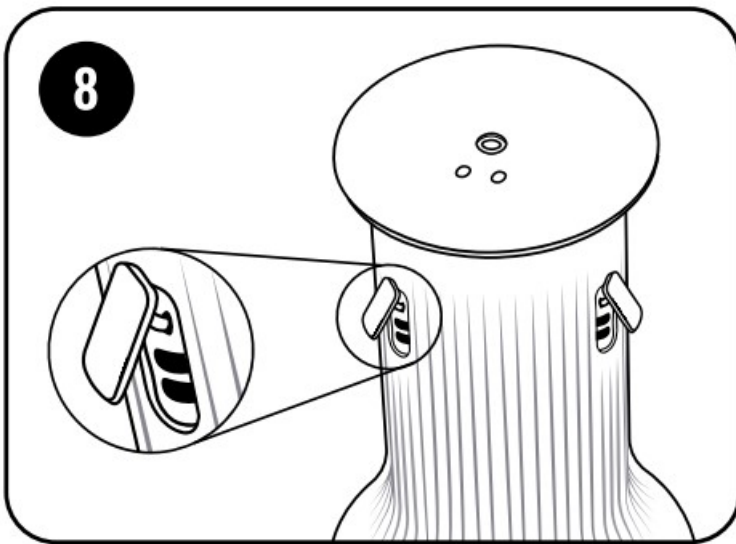

9. The device is ready to use. Insert your penis when it is erect Once you have inserted it, regulate the suction level to your liking according to the suction intensity you prefer. closing one or both of the suction tabs that will allow air to escape. Tip: if you have difficulty opening the side tabs with your fingernail, use the help of a sharp object or something similar.

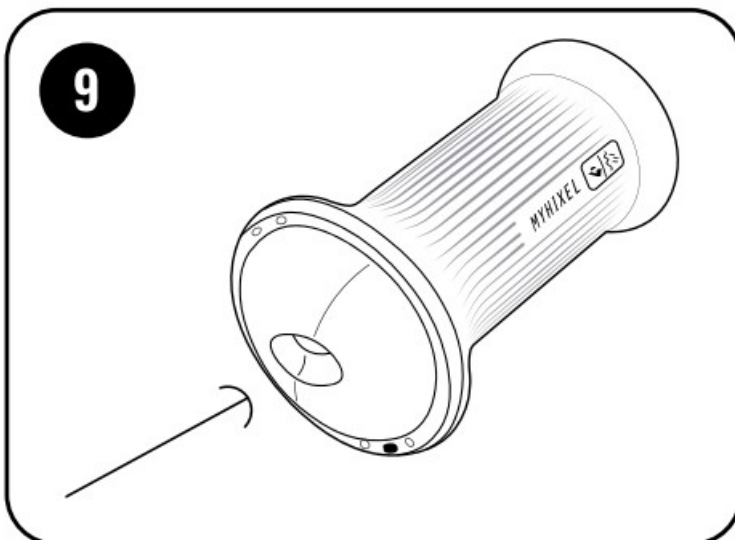

10. Press button 1 to start the device vibrating (the App will tell you when to turn the vibration on and off). Press it again to turn the vibration off. Note that the same button is used to heat and vibrate the device. Whether it heats or vibrates depends respectively on whether the cover is on or off. i.e. it heats with the cover on and vibrates with the cover off.

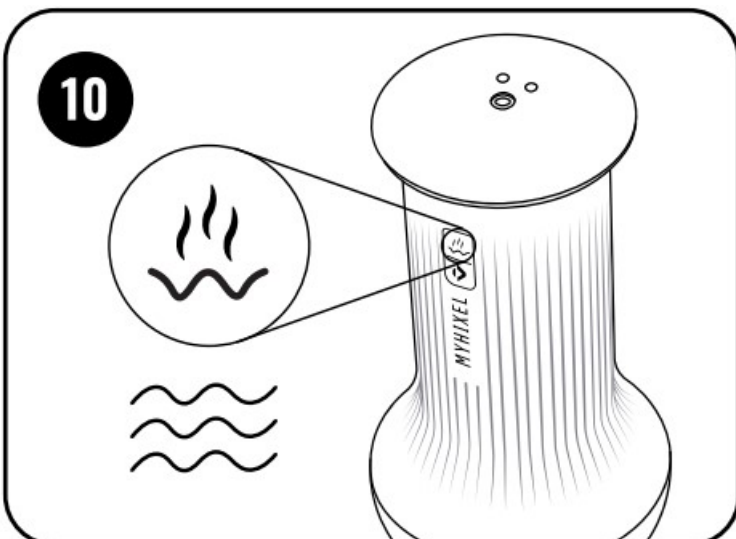

11. If during penetration you have the feeling that the friction is excessive, apply a little more lubricant, as this should be distributed throughout the channel of the sleeve.

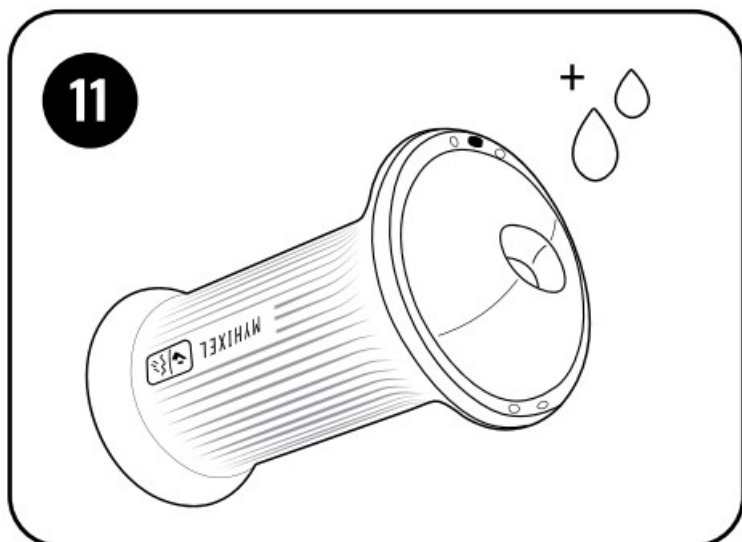





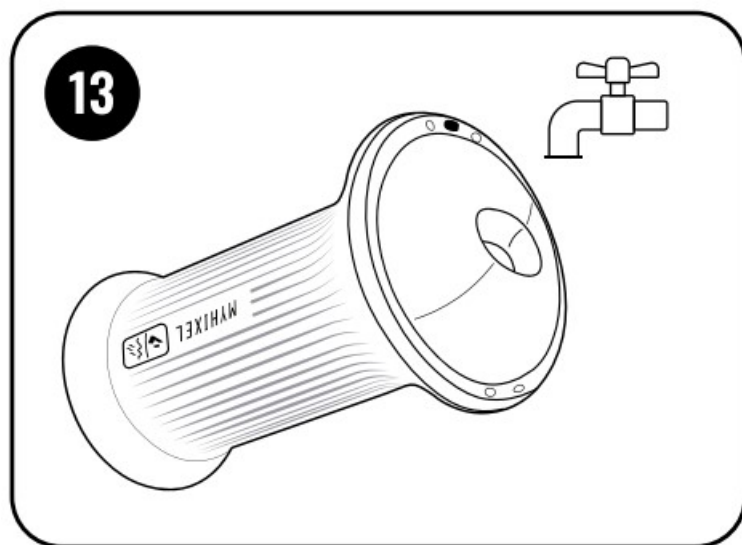

12. Relax and enjoy the activities guided by your program from the MYHIXEL Play app.



13. Once finished, clean your MYHIXEL II device as described in the section "Cleaning and storing the device".



	ON/OFF	PAIRING WITH THE APP (BLUETOOTH)	HEAT/ VIBRATE	CHARGING
				
				
	2 sec	2 sec		
	<ul style="list-style-type: none"> <li>If pressed while on, the ACTION is to turn off, and vice versa.</li> <li>The LED turns off once it is switched on.</li> </ul>	<ul style="list-style-type: none"> <li>While pairing in, both buttons flash simultaneously</li> </ul>	<ul style="list-style-type: none"> <li>If the lid is closed, the ACTION is to heat up.</li> <li>If the lid is open, the ACTION is to vibrate.</li> <li>If it is pressed again, it stops heating or vibrating.</li> <li>While heating, the button flashes</li> <li>Once the temperature is reached, the button switches off.</li> <li>In vibration mode, it remains off.</li> </ul>	<ul style="list-style-type: none"> <li>When the charging cable is connected, button 2 flashes.</li> <li>Turns off when the battery is fully charged.</li> </ul>

## CLEANING AND STORAGE OF THE DEVICE

Clean and store your MYHIXEL II device as detailed below.

Clean and store your MYHIXEL II device as detailed below.

## CLEANING THE SLEEVE

With the heating base removed, use the tabs to uncover the two openings that control the suction level. carefully

remove the sleeve and apply plenty of water (can be cleaned under running water). For best results, you can also apply MYHIXEL Cleaner, specially designed to clean and maintain the MYHIXEL sleeve in excellent condition.

Cleaning with soap or other cleaners is not recommended as it may damage the material. For best results, we recommend that you turn the sleeve inside out.

Once cleaned, allow the sleeve to air dry until no moisture remains.

Remember that you can purchase new replacement sleeves for your device through our website.

## **CLEANING THE CASING**

To proceed to clean the housing, it is necessary to have previously removed the sleeve.

We recommend cleaning the housing by immersing it in water, removing all the lubricant that has remained on it. Remember that it is waterproof up to 1 meter deep thanks to its IPX7 Waterproof system.

If you are going to charge the device right after cleaning it, be sure to dry it well, especially the part of the connectors for charging.

When the sleeve and case are thoroughly dry, reinsert the sleeve back into the case, attach the heating base and store the device in its case or somewhere dry until the next use. For more information, visit this QR, where you can find videos explaining the process:



## **DEVICE STORAGE**

Do not expose your MYHIXEL II device to direct sunlight and avoid extreme heat. You can store your device in its box, where it will be perfectly protected from dust.

Make sure the device is completely dry before storing it.

## **MATERIALS**

Material composition is completely phthalate-free.

- Rubberized acrylonitrile butadiene styrene (ABS) for main body/housing.
- Bronze plated ABS for the cover.
- Thermoplastic elastomer (TPE) for the sleeve.
- Silicone for buttons and inner vibrating part cover.

- Electronic components and 3.7V – 650mA lithium battery with capacity for 3 full uses.

## **EXEMPTION FROM LIABILITY**

Users of the MYHIXEL II device use it at their own risk. Neither MYHIXEL (New Wellness Concept SL) nor its distributors assume any responsibility for the improper use of this product.

MYHIXEL reserves the right to revise this publication and to make changes in content as it deems necessary without obligation to notify anyone. The product may be modified for improvement without prior notice. MYHIXEL assumes no liability for damages due to:

- Non-observance of the Instructions.
- Unintended use.
- Arbitrary modifications.
- Technical modifications.
- Use of unauthorized spare parts.
- Use of unauthorized accessories.

### **FCC warning:**

Any Changes or modifications not expressly approved by the party responsible for compliance could void the user's authority to operate the equipment. This device complies with Part 15 of the FCC Rules. Operation is subject to the following two conditions:

(1) this device may not cause harmful interference, and (2) this device must accept any interference received, including interference that may cause undesired operation.

**Note:** This equipment has been tested and found to comply with the limits for a Class B digital device, pursuant to Part 15 of the FCC Rules. These limits are designed to provide reasonable protection against harmful interference in a residential installation. This equipment generates, uses, and can radiate radio frequency energy, and if not installed and used in accordance with the instructions, may cause harmful interference to radio communications. However, there is no guarantee that interference will not occur in a particular installation. If this equipment does cause harmful interference to radio or television reception, which can be determined by turning the equipment off and on, the user is encouraged to try to correct the interference by one or more of the following measures:

- Reorient or relocate the receiving antenna.
- Increase the separation between the equipment and receiver.
- Connect the equipment into an outlet on a circuit different from that to which the receiver is connected.
- Consult the dealer or an experienced radio/TV technician for help.

The device has been evaluated to meet general RF exposure requirement. The device can be used in portable exposure condition without restriction.

## **Documents / Resources**



**[MYHIXEL MYHIXEL II Climax Control Simulation Device](#)** [pdf] Instruction Manual  
MHX-PA-0006, MHXPA0006, 2A9Z3MHX-PA-0006, 2A9Z3MHXPA0006, MYHIXEL II Climax Control Simulation Device, Climax Control Simulation Device, Control Simulation Device, Simulation Device

## References

- **[MHX MYHIXEL ® Official Site | Men Climax Control Method](#)**