



## My Choice MC169 PowerPac 2 in 1 Blender User Manual

[Home](#) » [My Choice](#) » My Choice MC169 PowerPac 2 in 1 Blender User Manual 

### Contents

- [1 My Choice MC169 PowerPac 2 in 1 Blender](#)
- [2 Instructions](#)
- [3 Parts & Description](#)
  - [3.1 Safety Protection](#)
- [4 How to use](#)
- [5 How to clean and maintain](#)
- [6 PROBLEM-SOLVING](#)
- [7 ENVIRONMENTAL TIP](#)
- [8 SPECIFICATION](#)
- [9 WARRANTY](#)
- [10 Documents / Resources](#)
  - [10.1 References](#)
- [11 Related Posts](#)



**My Choice MC169 PowerPac 2 in 1 Blender**



### **MY CHOICE 2in1 BLENDER WITH 4-SPEED CONTROL SELECTIONS MC169**

The MY CHOICE 2in1 Blender with 4-Speed Control Selections MC169 is a versatile kitchen appliance that can be used as a blender or a grinder. It comes with various parts such as the blender jug, blender blade assembly, motor unit, grinder cup, and grinder blade assembly. Below are the instructions and warnings for using the appliance safely:

#### **Warnings:**

- Read the instruction booklet carefully before using the appliance to ensure safe installation, use, and maintenance.
- Only use the appliance for its intended purpose. Any other use is considered inappropriate and dangerous and may cause damages for which the manufacturer cannot be held responsible.
- Follow the manufacturer's instructions for installation/assembly to prevent damages to persons, animals or objects, for which the manufacturer cannot be held responsible.
- Make sure that the voltage and frequency of the wall socket correspond to the rating of the appliance and that the socket is properly grounded.

- Avoid using adapters and/or extension cables. If their use is absolutely necessary, ensure that they comply with current safety regulations and electrical parameters.
- Do not switch on the appliance using external timers and/or other remote control appliances not specified in the manual.
- Only use original components & accessories provided by the manufacturer. Non-original components & accessories may cause injuries or damage to the appliance and void the warranty.
- Keep packing materials out of the reach of children or disabled persons since they can be potential sources of danger.
- The appliance is not suitable to be used or stored near heat sources (open flame, ovens, heaters, stoves, etc.) and/or in an explosive environment (in the presence of flammable substances such as gas, vapour, mist or dust, in atmospheric conditions when, after ignition, the combustion is spread in the air).
- Place the appliance at a proper distance from objects or surrounding walls to prevent accidental damages. The appliance should not be placed on a surface, or in the vicinity of objects which can be damaged by heat such as carpets or plastics. Never use the appliance near curtains or textiles. If the appliance is operated on wooden furniture, use a protective pad to prevent damage to delicate finishes.

## **Instructions**

1. Before using the appliance, read all instructions carefully.
2. Place the blender jug on the base.
3. Add the ingredients to be blended/grinded into the blender jug or grinder cup.
4. Choose the desired speed by turning the ON/OFF & Speed Rotary Knob to one of the four speed selections.
5. To pulse, press and hold down the Pulse button.
6. After use, turn off and unplug the appliance before disassembling it for cleaning.
7. Clean all removable parts (blender jug, grinder cup, blender blade assembly, and grinder blade assembly) with warm soapy water and a sponge or cloth. Do not immerse the motor unit in water.
8. Wipe the motor unit with a damp cloth and dry it thoroughly before storing.

Following these instructions and warnings will help you to use the MY CHOICE 2in1 Blender with 4-Speed Control Selections MC169 safely and effectively.

## Parts & Description



## Warnings

### ATTENTION :

- Read this booklet carefully it contains important instructions for a safe installation, use and maintenance.
- Important instructions to be kept for future reference.
- The following basic precautions should always be followed when using electrical appliances:

1. Read all instructions before using the appliance.

#### • The Appliance

2. This appliance must be used only for the purpose it was expressly designed; any use NOT complying with the instructions contained in the manual is considered inappropriate and dangerous. The manufacturer is NOT responsible for possible damages caused by the inappropriate and/or unreasonable use.
3. The installation/assembly of the appliance will be made in accordance with the indications of the manufacturer. A wrong procedure may cause damages to persons, animals or objects, for which the manufacturer cannot be considered responsible.
4. Before use, check the integrity of the appliance and power cable. DO NOT operate the appliance at all when

the Motor unit is damaged. If the Motor unit is not damaged, but an accessory (Blender, Filter, Dry Food Mill or Mincer) is damaged, DO NOT operate the Motor unit in conjunction with that accessory. In case you are not sure, contact a qualified person. If the power cable is damaged, it must be replaced by the manufacturer / service agent or a qualified technician in order to avoid a shock hazard.

5. Before powering the appliance make sure the rating (voltage and frequency) corresponding to the grid and the socket is suitable for the plug of the appliance, and that the wall socket is properly grounded.
6. Avoid the use of adapters and/or extension cables; if their use is absolutely necessary, use only materials in compliance with the current safety regulations and according to the electrical parameters of the adapters.
7. The appliance must NOT be switched on using external timers and/or other remote control appliances which are not specified in this manual.
8. Only use original components & accessories provided by the manufacturer. Any non-original components & accessories made by other manufacturers or by the same manufacturer but for other models of the same capacity or otherwise, may cause injuries to persons or damage to the appliance. Doing so will void the warranty and may cause serious injury.
9. The packing materials (plastic bags, expanded polystyrene, etc.) must be kept out of the reach of children or disabled persons since they represent potential sources of danger.

#### • Location

10. This appliance is NOT suitable to be used or stored near heat sources (open flame, ovens, heaters, stoves, etc.) and/or in an explosive environment (in the presence of flammable substances such as gas, vapour, mist or dust, in atmospheric conditions when, after ignition, the combustion is spread in the air). Items containing these substances should never be placed in the appliance, and never be used to clean the appliance to avert the risk of fire or explosion.
11. Place the appliance at a proper distance from the objects or surrounding walls making sure that its functioning will not cause accidental damages. The appliance should NOT be placed on a surface, or in the vicinity of objects, which can be damaged by heat such as carpets or plastics. Never use the appliance near curtains or textiles. If the appliance is operated on wooden furniture, use a protective pad to prevent damage to delicate finishes.
12. Avoid placing the power cable on abrasive or sharp surfaces or in positions where it can be damaged easily. Avoid placing heavy objects on the cable. The cable must NOT be placed under carpets, or covered with throw rugs, runners or similar. Arrange the cable away from the high traffic area, and where it will NOT be tripped over. DO NOT pull or carry the appliance by the cable.
13. DO NOT use or store the appliance outdoors. Store and use the appliance only indoors, or in any case, protected from weathering such as rain, direct radiation of the sun and dust.

#### • Operation

14. If you are using the appliance for the first time, you should:
  - **a.** Clean the exterior of the Motor Unit with a damp cloth. Use a little detergent, if necessary, and wipe dry. The Motor Unit may NOT be immersed in water. Wash the Pole, Plastic Plug, Lid, Blender Jug & Blender Blade assembly, Grinder Cup & Grinder Blade assembly and utensils you wish to use with water & detergent with a non-abrasive sponge. DO NOT use metal scouring pads nor use solvents like paint thinners or acetone. Dry the accessories thoroughly.
  - **Notice:** you should NOT use a dishwasher to clean the appliance.
  - **b.** Place the Motor unit on a flat, dry surface. Assemble the Blender Jug & the Blender Blade assembly, or Grinder Cup & Grinder Blade assembly to the Motor unit according to the instructions listed in the section ("How to Use") below. Check that these accessories are locked into the Motor unit before you

start using the appliance.

- **c.** Make sure the blades are in place and are running smoothly.

- **The Blender**

- **d.** Lock the Blender Jug onto the Motor unit and turn it anti-clockwise. Place food/liquids into the Blender Jug, insert the Plastic Plug into the Lid and place the Lid on top of the Blender Jug, turning it anticlockwise. Turn the ON/OFF & Speed Rotary Knob (henceforth: the Knob) to '0', plug the power cable and switch it on, turn the Knob to '1, 2, 3 or 4' and blend.
- Blend for NOT more than 3 minutes without interruption, resting for 5 minutes with a maximum of 3 cycles before resting for 15 minutes.
- On completion of blending, turn the Knob to '0', switch off the wall switch and unplug the power cable. Wait for the blades to stop turning and turn the Blender Jug with the Blender Blade assembly clockwise from the Motor unit and detach. Remove the Lid from the Blender Jug by turning the Lid clockwise and pour the contents out.
- The Grinder (functions as a Mincer as well)
- **e.** Separate the Grinder Blade assembly from the Grinder Cup by either holding the Grinder Blade assembly (bottom) and turning the Grinder Cup (top) clockwise; or, inverting the Grinder Cup, holding the Grinder Blade assembly and turning the Grinder Cup anti-clockwise. Place ingredients into the Grinder Blade assembly until it is half-full, and then place this onto the Motor unit. Place the Grinder Cup on top of these and turn the Grinder Cup anti-clockwise to tighten. Turn the Knob to '0', plug the power cable, switch it on, turn the Knob to '1, 2, 3 or 4' one by one.
- Grind for NOT more than 30 seconds without interruption, resting for 2 minutes with a maximum of 3 cycles before resting for 15 minutes.
- On completion of grinding, turn the Knob to '0', switch off the wall socket and unplug the power cable. Wait for the blades to stop turning and turn the Grinder Cup with the Grinder Blade assembly (as a pair) clockwise and detach from the Motor unit. Separate the Grinder Blade assembly from the Grinder Cup (as explained above). Extract the grinded/minced food.
- **f.** Make sure to remove any label or protective sheet which may prevent its proper functioning.
- **DO NOT:**
  - cover the appliance during functioning;
  - insert objects or body parts inside the protection cover of the appliance;
  - overload the Blender Jug or Grinder Cup by overfilling it. This is generally below  $\frac{3}{4}$  of the total volume of the container as especially during blending, liquids will churn and may spill out of the container. The jug should contain cut fruits and vegetables NO larger than 1 inch (2.5 cm) in length and thickness and must NOT contain dry food (food with insufficient amount of water, very hard ingredients (such as coffee beans, soybeans, rice, ice cubes or frozen foods), or foods or liquids with a temperature greater than 60 C;
  - allow hands, hair, clothing, curtains, spatulas and any other objects to come into contact with the appliance's motor and accessories to avoid personal injury or damage to the machine when the appliance is in operation;
  - place the appliance in the microwave oven or refrigerator, so as to avoid damaging it;
  - touch the blades as they are VERY SHARP! Hold the base of the Blender Blade assembly or the Grinder Blade assembly while installing, removing or cleaning;
  - operate the appliance for more than 3 minutes for blending and 30 seconds for grinding, without

interruption. Let the appliance rest between processing cycles, blending for 5 minutes and grinding for 5 minutes. After 3 processing cycles, allow an interval of 15 minutes to let the appliance cool down before the next use so as to

- prolong its service life. DO NOT allow the appliance to idle while in operation;
  - turn the ON/OFF & Speed Rotary Knob too hard so as to avoid any damage;
  - detach the Blender Jug or Grinder Cup while the appliance is in operation;
  - leave the appliance unsupervised during operation.
15. During operation, DO NOT touch the appliance with wet body parts, and it is recommended to have between you and the standing surface, an isolating element (for example, wearing shoes with rubber soles).
  16. DO NOT soak the Motor unit in water or other liquids, wash it under the tap, or let any liquid flow into the internal casing of the appliance to prevent electric shock. In case of accidental fall in water, DO NOT try to take it out, but first of all switch the appliance off.
  17. Before plugging & unplugging the appliance, turn the ON/OFF & Speed Knob to '0' (OFF). Plug and unplug the power cable firmly holding it with dry hands. Always unplug the power cable before changing accessories; to avoid overheating; if it is NOT used for a long period and before storing, cleaning or performing any maintenance operation. Remember that the blades may still be moving after the power cable is unplugged! Prior to the latter, leave to cool for at least 10 minutes.
  18. Wash the Pole, Plastic Plug, Lid, Blender Jug & the Blender Blade assembly, Grinder Cup & Grinder Blade assembly and utensils immediately after usage to avoid build-up of bacteria. (Warning: Blades are sharp!).
  19. In the event the mixing of the food items produce bubbles, stop the operation immediately and wait until the production of bubbles ceases before resuming blending.
  20. In case of malfunction or anomaly during the functioning such as smoke coming out of the appliance, switch the appliance off immediately, turn off the power and check the cause of the anomaly, if possible, with the support of a qualified person.
  21. This appliance is NOT intended for commercial use but to be used in households and similar applications, such as:
    - Staff kitchen areas in shops, offices and other working environments;
    - By clients in dormitories hotels, motels and other residential environments;
    - Bed and breakfast type environments
  22. This appliance can be used by children aged from 8 years and above and persons with reduced physical, sensory or mental capabilities or lack of experience and knowledge if they have been given supervision or instruction concerning use of the appliance in a safe way and understand the hazards involved. Children shall NOT play with the appliance. Cleaning and user maintenance shall NOT be made by children unless they are older than 8 and supervised. Keep the appliance and its cable out of reach of children less than 8 years old.
  23. Save these instructions.

## **Safety Protection**

If the appliance overheats, the thermal switch will be activated, leading to the motor being shut off. Turn the ON/OFF & Speed Rotary Knob to '0' (OFF). Switch the appliance off and unplug the power cable from the wall socket. Allow the appliance to cool for at least 15 minutes before using the appliance.

## **How to use**

1. Clean the Motor unit and accessories before using. Refer to the section "How to clean and maintain"

immediately following this section.

2. Place the Base of the Motor unit on a flat, dry and heat-resistant surface.

### 1. The Blender

3. Place the Blender Jug with the Blender Blade assembly on top of the Motor unit and turn it anti-clockwise. Ensure that the Blender Jug has locked tightly in place.

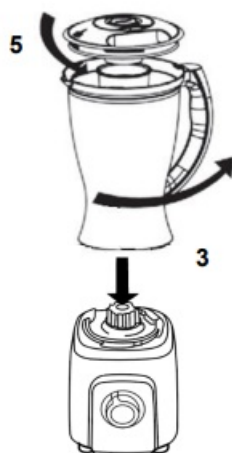

To tighten, turn the  
Blender Blade assembly  
anti-clockwise

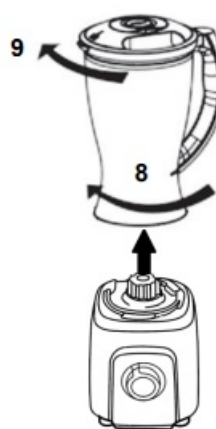

To loosen, turn the  
Blender Blade assembly  
clockwise

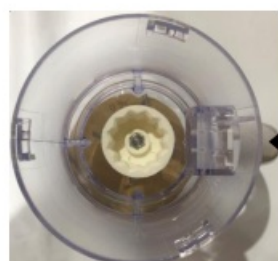

Blender Blade assembly

Fit (A)  
of the  
Blender  
Blade  
assembly  
onto (B)  
of the  
Motor unit

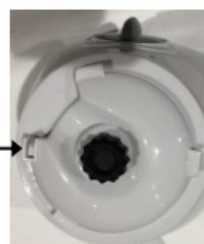

Motor unit

4. Wash the fruit/s and/or vegetables, then peel and cut into no larger than 1 inch (2.5 cm) cubes. Add liquids such as water or milk, then place the cut fruits or vegetables into the Blender Jug, topped off with yoghurt or ice cream if desired. The total volume should exceed the lowest line on the Blender Jug (400 ml). Note: For optimal performance, place the ingredients in the Blender Jug according to the following sequence: Liquids, fresh ingredients, frozen fruits, yoghurt, ice cream.
5. Insert the Plastic Plug into the Lid and place the Lid on top of the Blender Jug, turning it anticlockwise.
6. Turn the ON/OFF & Speed Rotary Knob (henceforth: the Knob) to '0' (OFF). Plug the power cable into the wall socket and switch ON. Turn the Knob '1, 2, 3 or 4' and blend until the desired consistency is achieved. For juices, the speed should be '3'.
  - Place one hand on top of the Lid when blending to stabilise the appliance. DO NOT operate the appliance for more than 3 minutes without interruption. Let the appliance rest for 5 minutes between processing cycles. After 3 processing cycles, allow an interval of 15 minutes to let the appliance cool down before the next use, so as to prolong its service life. DO NOT allow the appliance to idle while in operation.
7. On the completion of blending, turn the Knob to '0', switch off the wall switch and unplug the power cable.
8. Wait for the blades to stop turning, turn the Blender Jug with the Blender Blade assembly clockwise from the Motor unit and detach.
9. Remove the Lid from the Blender Jug by turning the Lid clockwise and pour out the contents.





- only if a Jam occurs: DO NOT continue blending if the blade is jammed.
  - Turn the Knob to '0'. Switch off the wall socket and unplug the power cable.
  - Wait for the blades to stop turning.
  - Insert the Pole into the Plastic Plug and clear the jam. If this does not work, perform the following:
  - Remove the Lid from the Blender Jug by turning the Lid clockwise and clear the jam. (Occasionally, the blockage may require that the Blender Jug be detached from the Motor unit before clearing. Detach the Blender Jug with the Blender Blade assembly from the Motor unit by turning the Blender Jug clockwise).
  - Once the Jam is cleared, (re-attach the Blender Jug with the Blender Blade assembly to the Motor unit by turning the Blender Jug anti-clockwise), re-attach the Lid to the top of the Blender Jug and lock it by turning it anti-clockwise.
  - Perform steps 5 – 9 again.
  - The Grinder (Mincer)
  - (used for grinding dry and hard foodstuffs: spices, coffee beans, seeds, almonds, etc.as well as a mincing meat, garlic, ginger, onions, chillies, etc.)
1. Separate the Grinder Blade assembly from the Grinder Cup. 2 ways to separate Grinder Blade assembly from Grinder Cup:

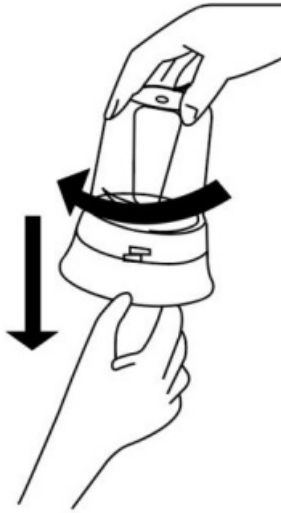

- Holding the Grinder Blade assembly, turn the Grinder Cup clockwise



- Holding the Grinder Blade assembly, turn the Grinder Cup anti-clockwise
2. Place the food ingredients into the Grinder Blade assembly.
  3. Place the Base of the Motor unit on a flat, dry and heat-resistant surface.

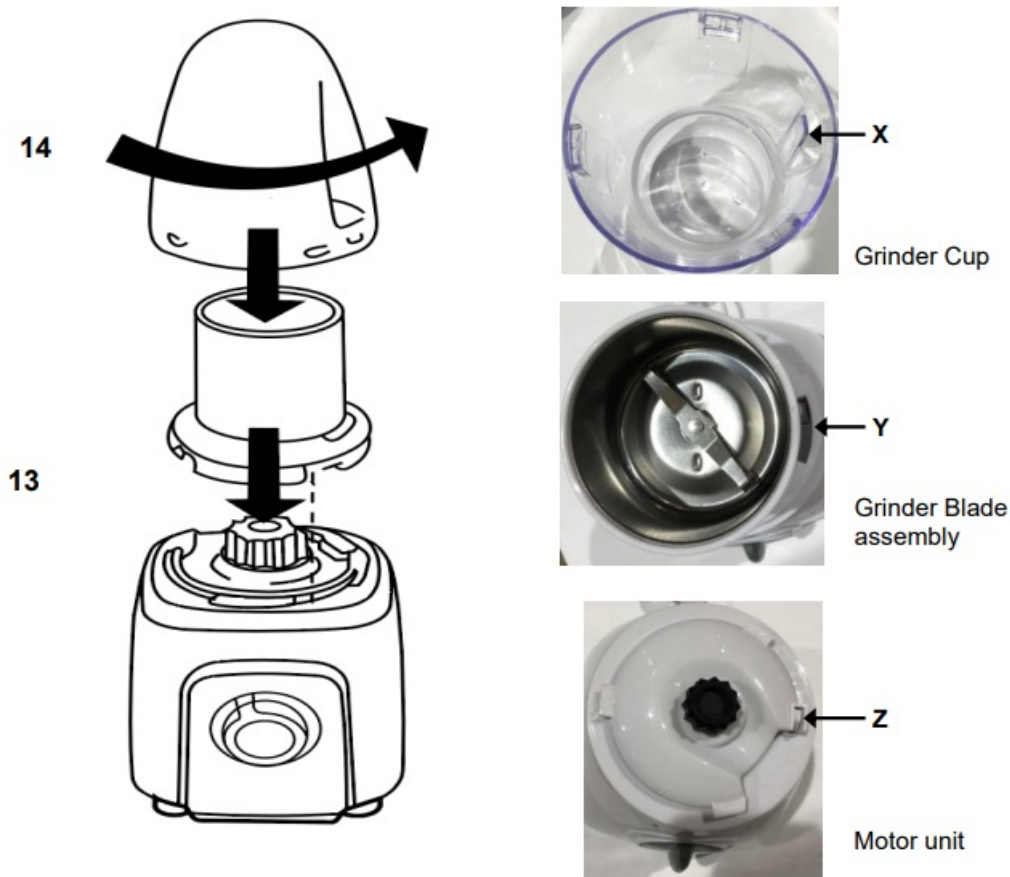

Fit (X) onto (Y) onto (Z) before turning (X) anti-clockwise

4. Attach the Grinder Blade assembly (containing the food ingredients) on top of the Motor unit and ensure that the Grinder Blade assembly has locked tightly.
5. Place the Grinder Cup on top of the Grinder Blade assembly and turn the Grinder Cup anti-clockwise to tighten. Ensure that the Grinder Cup with the Grinder Blade assembly is firmly locked in place.
6. Turn the Knob to '0'. Plug the power cable into the wall socket and switch on. Turn the Knob to ON. Turn the Knob '1, 2, 3 or 4' and grind (mince) until the desired consistency is achieved.
7. DO NOT operate the appliance for more than 30 seconds without interruption. Let the appliance rest for 2 minutes between processing cycles. After 3 processing cycles, allow an interval of 15 minutes to let the appliance cool down before the next use, so as to prolong its service life. DO NOT allow the appliance to idle while in operation.
8. On completion of grinding (mincing), turn the Knob to '0', switch off the wall switch and unplug the power cable.
9. Wait for the blades to stop turning, unscrew the Grinder Cup with the Grinder Blade assembly (as a pair) clockwise from the Motor unit and detach.

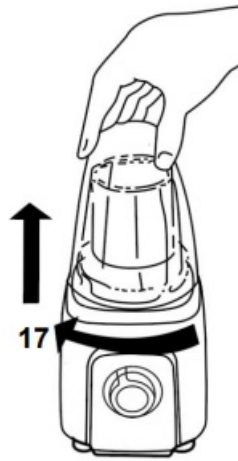

- Invert the Grinder Cup with the Grinder Blade assembly, unscrew the Grinder Blade assembly from the Grinder Cup and detach. The grinded/minced food is left inside the inverted Grinder Cup.



- Holding the Grinder Blade assembly, turn the Grinder Cup anti-clockwise



Grinding chillies



Mincing meat

- only if a Jam occurs: DO NOT continue grinding (mincing) if the blade is jammed.
- Turn the Knob to '0'. Switch off the wall socket and unplug the power cable. Wait for the blades to stop turning.
- Unscrew the Grinder Cup with the Grinder Blade assembly (as a pair) from the Motor unit by turning the Grinder Cup anti-clockwise and detach.
- Invert the Grinder Cup with the Grinder Blade assembly and unscrew the Grinder Blade assembly anti-clockwise and detach. Clear the jam.
- Once the Jam is cleared, replace the food in the Grinder Blade assembly. Perform steps 13 – 18 again.

## How to clean and maintain

1. Turn the ON/OFF & Speed Rotary Knob to '0' (OFF). Switch the product off and unplug the power cable from the wall socket.
2. Before cleaning, please make sure the blades have stopped running.

3. Clean the Motor unit with a damp cloth. DO NOT immerse the Motor unit in water or other liquids, and avoid spraying water, in order to avoid damage or leakage.
4. Wash the Lid, Blender Jug & the Blender Blade assembly, Grinder Cup & Grinder Blade assembly and utensils you wish to use with water & detergent with a non-abrasive sponge. Dry the components with a soft, dry cloth. DO NOT use a steel wire sponge, abrasive cleaners or corrosive liquids such as gasoline or acetone to clean the appliance & accessories.  
Never attempt to sterilise any part of this appliance with hot water or steam by utilising a steamer, frying pan, oven, microwave oven, kettle, etc.
5. Wash the Lid, Blender Jug & the Blender Blade assembly, Grinder Cup & Grinder Blade assembly and utensils immediately after usage to avoid build-up of bacteria. Blades are sharp!
6. Ensure that the appliance & accessories are clean, dry, and placed in dry and well-ventilated storage. Avoid direct sunlight.
7. Reassemble the Grinder Blade assembly to the open end of the Grinder Cup, the Blender Blade assembly to the open end of the Blender Jug, and then place the Blender Jug in the Motor unit before storing.
  - **Auto Clean**
8. Fill the Blender Jug with warm water.
9. Press the Pulse button for a few seconds to clean the Blender Jug and Blender Blade assembly very quickly and safely.

## PROBLEM-SOLVING

Fault symptom	Cause analysis	Troubleshooting
After the Blender Jug or Grinder Cup is installed, the appliance does not work after pressing the switch	The safety lock is not connected	Reconnect the Motor unit and the Blender Jug or Grinder Cup
	The motor is damaged or stuck	Turn the motor shaft. If it still does not work, please send it to the nearest service center for inspection

	Check if the power cable is loose.	If the appliance still does not work, replace it with a new power cable
When using the	It is a normal phenomenon when a new motor is initially used	
appliance for the first few times, the motor gives off an unpleasant		The smell will disappear with the use
smell		
The blades get stuck	The blades are entangled or stuck by ingredients	Remove the Blender Jug or Grinder Cup , take out the ingredients, and cut the ingredients into smaller pieces or put fewer ingredients
		Refer to “only if a Jam occurs” in the “How to Use” section for step-by-step instructions

The appliance stops working after a few processing cycles	The motor was not given enough time to cool down between processing cycles / the motor was allowed to idle while in operation	<p>Wait half an hour before using the appliance. If it still does not work, please send it to the nearest service center for inspection.</p> <p>This is NOT covered by Warranty</p>
---	---	---

## ENVIRONMENTAL TIP

- This appliance, along with all other electronic appliances, should, when it is no longer capable of functioning, be disposed of with the least possible environmental damage according to the local regulations in your area.
- In most cases you can discard the appliance at your local recycling centre.
- **DISPOSAL:** Do not dispose of this product as unsorted municipal waste. Collection of such waste separately for special treatment is necessary.



## SPECIFICATION

MODEL	VOLTAGE	POWER
MC169	220 – 240 V ~50 – 60 Hz	300 W

# WARRANTY

## Warranty Conditions

1. This warranty provides against defective materials and manufacturing faults throughout for two years from the date of purchase of the appliance. The warranty on the Compressor is 10 years subject to the same conditions as above.
2. This warranty also does not cover normal wear and tear, replacement of consumable materials and accessories, and the cost of maintenance of the appliance.
3. This warranty does not cover the repair or replacement of part/s damaged by misuse, accidents, negligence, alterations, or modifications in any way, or repairs done by any repair organisation without the prior consent of PowerPac Electrical Pte Ltd.
4. Repair and service are to be performed at: 5 Changi South Lane #03-01 Singapore 486045. A transport fee will be charged for personal doorstep service.
5. The original purchaser of the appliance must furnish proof of purchase to our Service Centre with the email or number as registered during submission of warranty when this appliance is sent for repair/service. Failure to do so may delay the receipt of said repair/service by the customer.
6. Under no circumstances whatsoever shall the serial number be erased, defaced or altered by the customer and/or his representatives, or the dealer and/or his agents. Failure to ensure this shall invalidate the warranty.
7. This warranty is deemed to be void if the defect is caused by the attack of household pests, fire, lightning, natural disasters, pollution, abnormal voltage or the usage of generators.
8. This warranty is valid in Singapore only.
9. This warranty will be honoured subject to the customer's registration of the warranty inclusive of original invoice or valid purchase receipt. Failure to present these documents will result in denial of service. However, if the customer still requests that the defective appliance be repaired, PowerPac Electrical Pte Ltd may, at its discretion, repair the appliance but impose a labour charge, as well as the costs of the replacement parts, to be borne solely by the customer.
10. Please refer to the attached picture for the location of one of our appliance's serial number, as an example.



- Please complete the on-line registration warranty form available on our website. There is no further requirement to send us any hard copy as part of our efforts to save the environment.
- In accordance with the terms and conditions of this limited warranty as stated above, PowerPac Electrical Pte Ltd, at its expense shall provide free services for the appliance within the warranty period from its date of purchase from our Authorised dealers.

## Documents / Resources



	<p><a href="#">My Choice MC169 PowerPac 2 in 1 Blender</a> [pdf] User Manual</p> <p>MC169 PowerPac 2 in 1 Blender, MC169, PowerPac 2 in 1 Blender, 1 Blender</p>
---	--

References

- [🌐 Parked at Loopia](#)