



# MWE 360 Photo Booth Machine with Software for Parties User Guide

[Home](#) » [MWE](#) » MWE 360 Photo Booth Machine with Software for Parties User Guide 

## Contents

- [1 MWE 360 Photo Booth Machine with Software for Parties](#)
- [2 Component Introduction](#)
- [3 Installation Guide](#)
- [4 Operation Instructions](#)
- [5 Documents / Resources](#)
- [6 Related Posts](#)

# MWE

**MWE 360 Photo Booth Machine with Software for Parties**



## Attention

1. Before using, please check whether the power cord, base LED Strip cord and other items are stuck on the rotating table or not, to prevent the cables from being damaged.
2. For users safety, don't jump hard on the Stage.
3. Don't make the edge of the Stage bear too much weight, better distribute the weight evenly on the stage.
4. The Stage should be adjusted paralleled to the ground by rotating the foot cup before using.
5. Do not stop the rotating rod deliberately when it was running.
6. Do not put heavy objects on the Angle Adjuster and Selfie Telescopic Rod.
7. Children should not use it alone, but must be accompanied by an adult.
8. Pls take off the foot cups when put the photo booth into the flight case for transportation.

## Component Introduction

The attachments received are subject to



## Installation Guide

- **Step1:** Take the Stage out of the package, Do not cut off the black plastic ties, which are used to tie up the wire and control box. install all the 8 Foot Cups and adjust the Stage parallel to the ground. Then connect the AC-DC adapter to the Motor Controller.

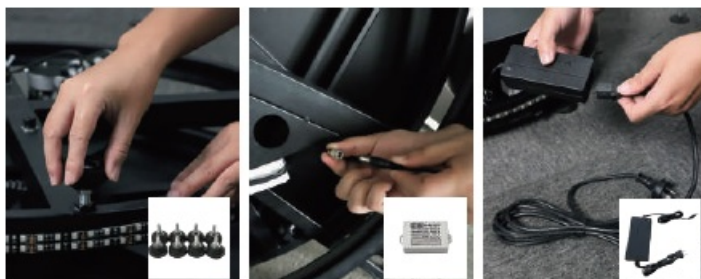

Step 1 Scan it

- **Step 2:** Install the Angle Adjuster, and lock it with Fixed Screw.



Step 2 Scan it

- **Step 3:** Install the Selfie Telescopic Rod.



Step 3 Scan it

- **Step 4:** Stick the LED Strip to the base and connect it to 5V Adapter (for LED Strip).

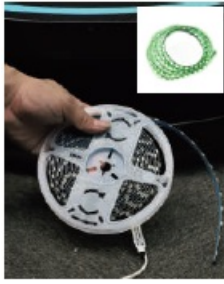

Step 4 Scan it

- **Step 5:** Install Ring Light.



Step 5 Scan it

- **Step 6:** : Install Fixed Bracket and Phone Holders.



Step 6 Scan it

- **Step 7:** Power bank, lithium battery connection and usage(Power Bank and lithium battery are not our standard accessories). The Ring Light should connect with USB port of the power bank. The motor controller should connect with the lithium battery s DC 24V power port. And the LED strip should con-nect with the lithium battery s DC 5V USB port.



Normal Light



Warm Light



Cold Light



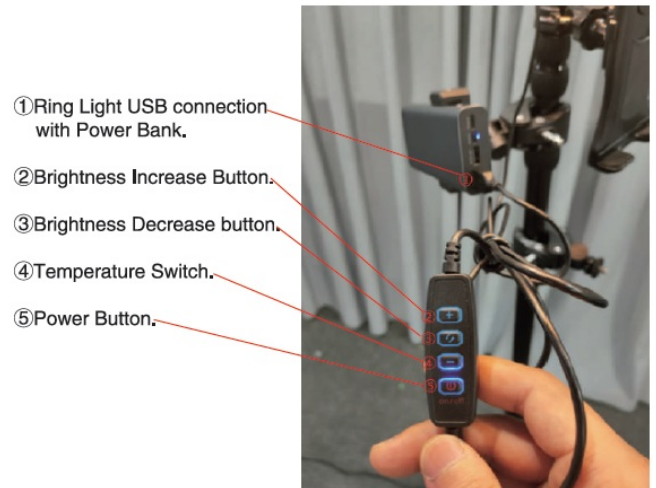
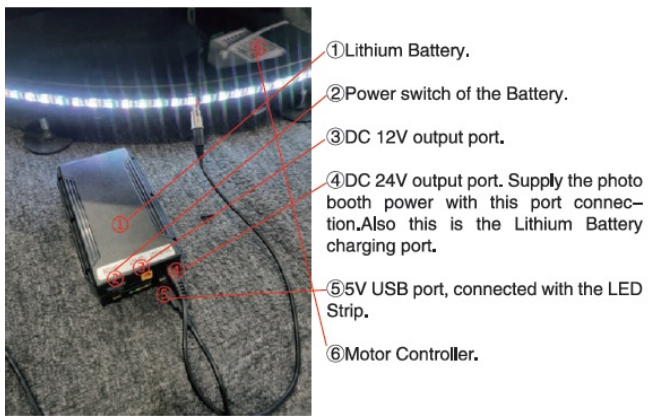

## Operation Instructions

### Remote Control Instructions

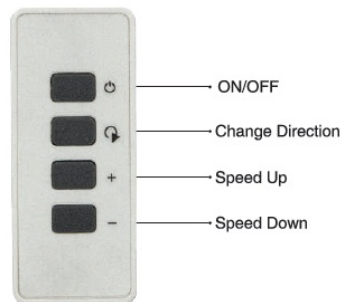

### Lightband Controller Instructions



- Install suitable batteries for all remote controls(CR-2032).
- Power up the AC-DC adapter.
- Plug the two USB(Ring Light& LED Strip) into the power bank and 5V adapter.
- Remote Control Instructions

## Installation Guide

A diagram to explain the overall structure in detail



## Documents / Resources

	<p><b><a href="#">MWE 360 Photo Booth Machine with Software for Parties</a></b> [pdf] User Guide  B0BXJRNSKL, B0BX5882HG, B09M8BDXK9, B09PBH2HSB, B09M8CTWBG, B09KRL1DJR,  B09YR34NLP, B09YR3643S, B09PFVTTJP, B0BX3S74BX, 360 Photo Booth Machine with Soft  ware for Parties, 360, Photo Booth Machine with Software for Parties, 360 Photo Booth Machin  e</p>
---	---