



muvit iO MIOCLF001 Lamp Ceiling With Fan User Manual

[Home](#) » [muvit iO](#) » **muvit iO MIOCLF001 Lamp Ceiling With Fan User Manual** 

Contents

- 1 [muvit iO MIOCLF001 Lamp Ceiling With Fan](#)**
- 2 [SECURITY RECOMENDATIONS](#)**
 - 2.1 [PRODUCT FEATURES](#)**
 - 2.2 [OPERATION OF THE REMOTE CONTROL](#)**
 - 2.3 [INSTALLATION OF THE Wi-Fi LED LAMP WITH FAN](#)**
 - 2.4 [USE OF THE APPLICATION](#)**
- 3 [Wi-Fi CEILING LED LAMP WITH FAN WITH VOICE ASSISTANTS](#)**
 - 3.1 [Quick guide to using Amazon Echo for Wi-Fi Ceiling LED Lamp with fan control](#)**
- 4 [TROUBLESHOOTING AND/OR FREQUENTLY ASKED QUESTIONS](#)**
- 5 [WARRANTY & TECHNICAL ASSISTANCE SERVICE](#)**
- 6 [Documents / Resources](#)**
 - 6.1 [References](#)**
- 7 [Related Posts](#)**

muvit iO

muvit iO MIOCLF001 Lamp Ceiling With Fan



SECURITY RECOMENDATIONS

Important:

Please read instructions and comply with all requirements and warnings provided in the manual before using the product. Failure to comply with the warnings and instructions may result in misuse of the product putting the product and yourself at risk.

Warnings:

1. This product is designed for indoor use. Do not use in high humidity environments.
2. Under no circumstances install the LED Wi-Fi lamp with fan near flammable fuels. During normal use, it may become hot.
3. If the product is damaged when unpacked, please request an exchange at the place of purchase. Before installing the product, make sure that it is in perfect condition.
4. Do not subject the product to external forces.
5. This product should be stored in a cool and dry place and should not be exposed to water and fire.
6. Lighting products such as light bulbs, LED strips or Wi-Fi lamps that are burnt out or no longer in use should be disposed of at specially designated recycling points designated by local authorities.
7. Before installing or uninstalling the product, ensure that the power supply is switched off.
8. This lamp with fan is suitable for ceiling mounting.
9. The voltage used must not exceed 230V.
10. Do not touch the light source or the hot area of the lamp until a few minutes after switching off the lamp.
11. Please do not bring objects with high temperatures or flammable objects near the lamp, this may cause fire or electric shock.
12. If there is any problem of any kind, be sure to turn off the power and contact the dealer.
13. To ensure safety, entrust the electrical installation to a professional for installation and inspection.
14. Do not change the structure of the lamp or replace the parts to avoid accidents or safety hazards.
15. Please follow the steps in the manual strictly to avoid unnecessary trouble.
16. Please keep this manual for future reference.

PRODUCT FEATURES

- Fan power: 20W
- Variable speed: Adjustable from the app (5 from the remote control)
- Modes: Summer and winter (reverse)
- Airflow: 80m³/h
- Motor: DC24V (without brushes)
- Lamp wattage: 40W
- Luminous flux: 4000lm
- Color: CCT (warm white and cool white)
- Temperature: 3000-5500k
- Dimmable: Temperature and bright
- Dimensions: Ø600*170mm
- Voltage: 230V ~ 50/60Hz
- Energy Efficiency: F

OPERATION OF THE REMOTE CONTROL

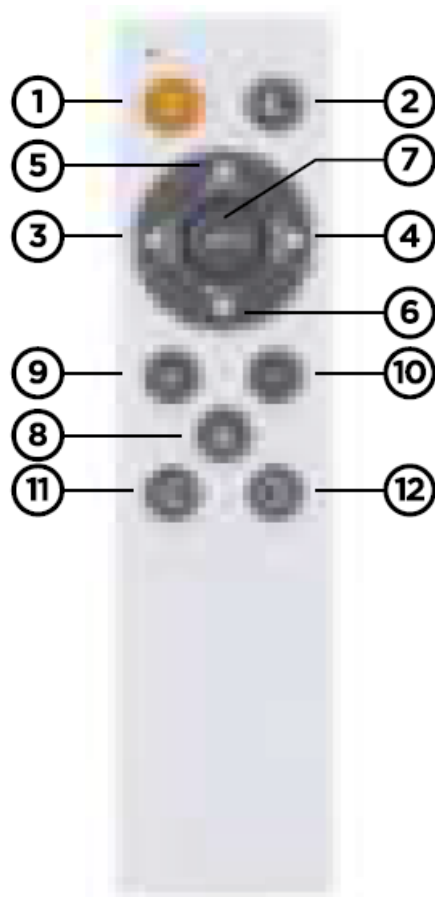

1. ON/OFF: the light is switched on/off.
2. Night light.
3. Warm white colour setting (3000k).
4. Cool white colour setting (5500k) Adjustment is made in stages.
5. Dimmer: brighter.
6. Dimmer: less bright.
7. 100% brightness (4000k).
8. Fan on/off.

9. Wind speed increase (5 gears).
10. Decrease of wind speed (5 gears).
11. Forward and reverse switching of fan blades.
12. Timer function: 1h, 2h, 4h, 8h, and cancellation of the timer by pressing the button for 5s, the fan beeps for 2 seconds.

Note: If the light is switched on via the wall switch, the unit provides the lighting scenario that was last set by the remote unit (memory effect).

INSTALLATION OF THE WI-FI LED LAMP WITH FAN

- **Step 1:** Turn off the power and make sure that the cables are deenergized.
- **Step 2:** Make sure the distance between the floor and ceiling is at least 2.3m for proper fan operation.
- **Step 3:** Loosen the cap screws on the top of the lamp-fan to attach it to the ceiling.
- **Step 4:** Pass the wires through the corresponding holes in the lamp cover.
- **Step 5:** Connect the wires of your old lamp (phase, neutral and earth) to the terminal strip of the ceiling lamp.
- **Step 6:** Fit the upper part of the lamp to the cover that you have previously attached to the ceiling.
- **Step 7:** fix both parts with the supplied screws.
- **Step 8:** Switch on the power supply and check that the lamp is working properly via the remote control or the app.

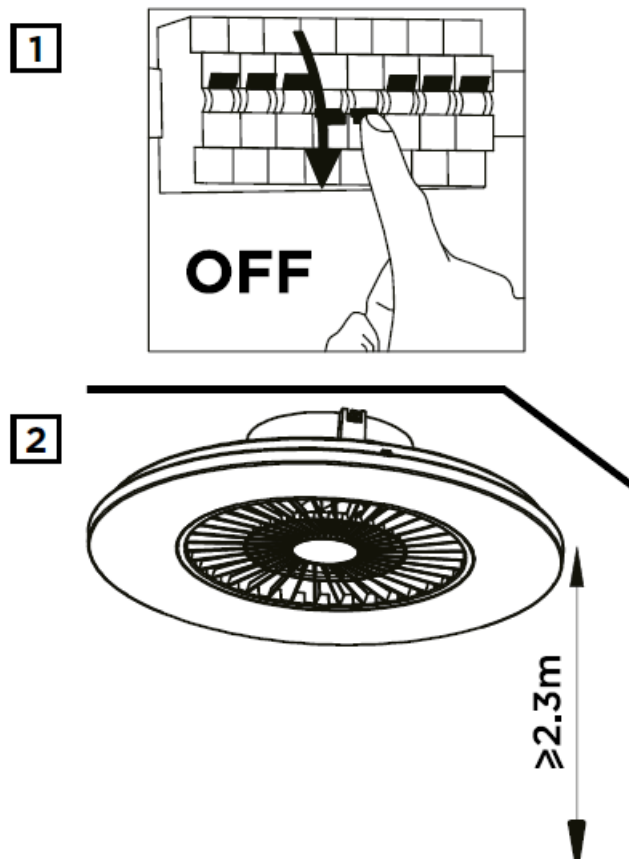

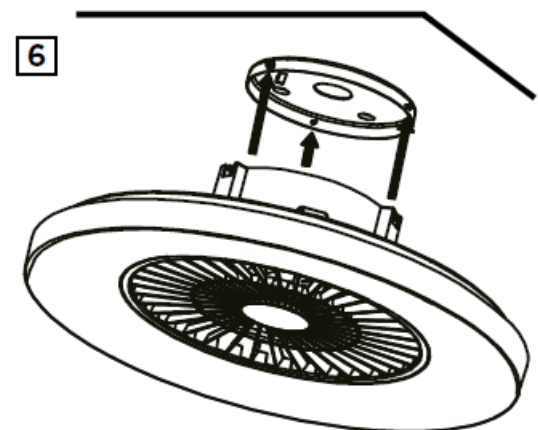
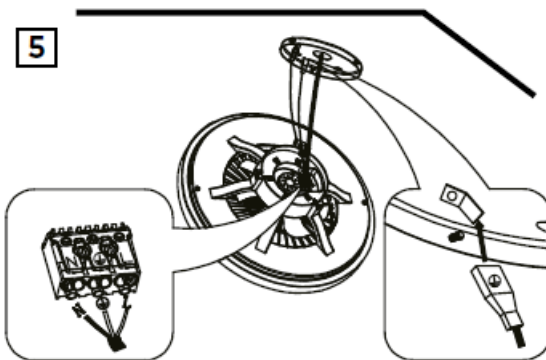
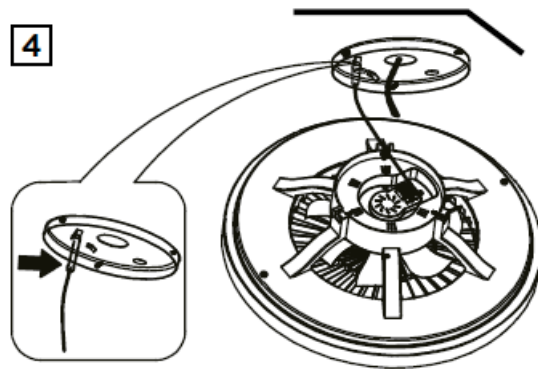
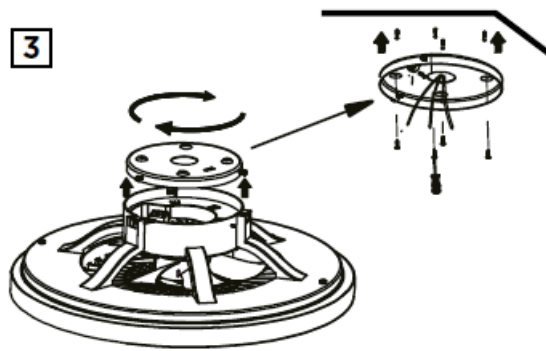

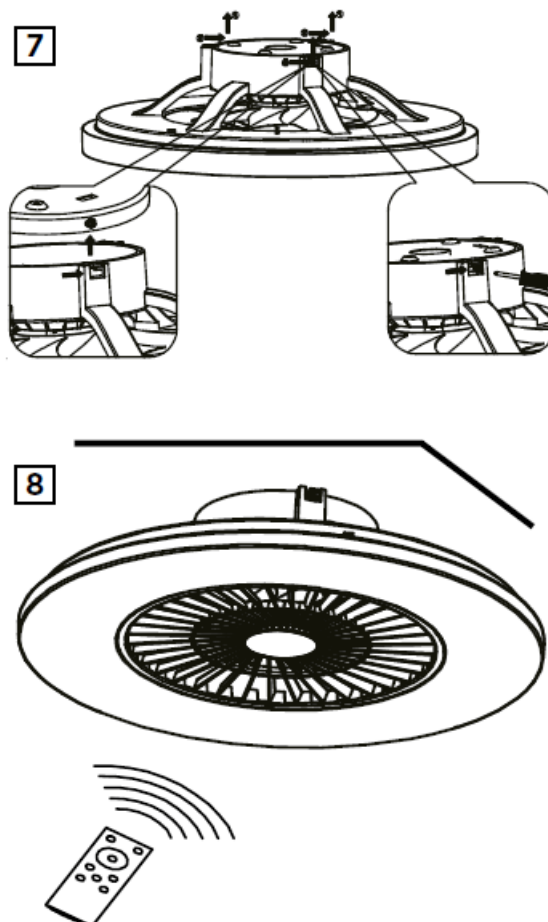

USE OF THE APPLICATION

1. Download the application “muvit iO Home”

To download the app, you can scan the QR code below. You can also search for “muvit iO Home” in the App Store or Google Play.



2. Register

If you do not have an account you will have to create one from within the app. Open the app, select “Create account”; the system will automatically recognise your country, if it is not correct, please change it. Enter your email address and click “Get verification code”; after a few seconds you will receive an email at the same address with a 6- digit PIN code; copy it and then you will have to enter a password of 6 to 20 characters to

create the account. Click “Save” to complete the registration.



3. Add device

Connect via Bluetooth (recommended):

Turn on Bluetooth and Location on your phone. Once the app is open, if the device light is flashing, you will get a screen to say it has detected a new device, hit

“Go to add”, “Add”, select your Wi-Fi network from the app, enter the password and click “Next”. Follow the application steps to finish the installation.



Note: Despite making the connection via Bluetooth, the device will connect to the router's Wi-Fi network, allowing you to control the device from anywhere at any time. If the New Device Detected screen does not appear, close the application completely and open it again.

Connection via EZ Mode (standard):

Activate Phone Location. Once the application is open, press” + “or “Add device”, select the purchased product to enter the installation wizard. Check that it flashes quickly, if not, follow the app prompts to reset it, tick the “Flashing quickly” tick and press “Next”. Enter the password, click “Next” to enter the network connection process and follow the instructions of the application to finish the installation.



Note: Due to possible updates of the application, the installation process of the product may change. Please follow the instructions in the app itself for correct installation.

4. Control of the device

After successfully configuring the device, it will be displayed on the “Devices” page. Click on the device icon to control light on/off, brightness adjustment, temperature, fan on/off and fan speed adjustment.

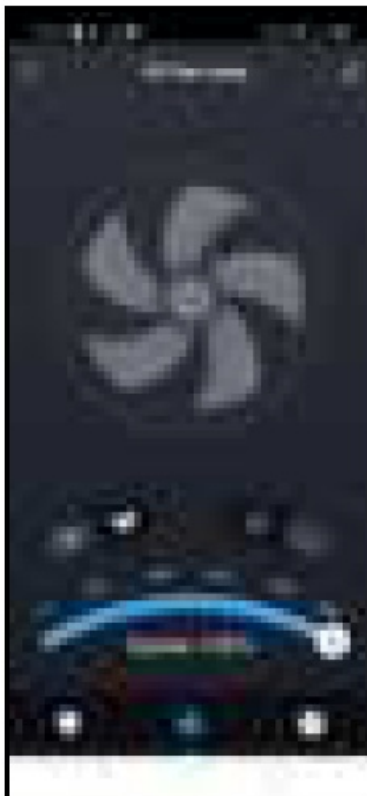

Wi-Fi CEILING LED LAMP WITH FAN WITH VOICE ASSISTANTS

Quick guide to using Amazon Echo for Wi-Fi Ceiling LED Lamp with fan control

Link a “muvit iO Home” account with Alexa

1. Tap “Skills & Games” in the home menu, then search for “muvit iO Home”. Select “muvit iO Home” and tap “ENABLE USE” to activate the skill.

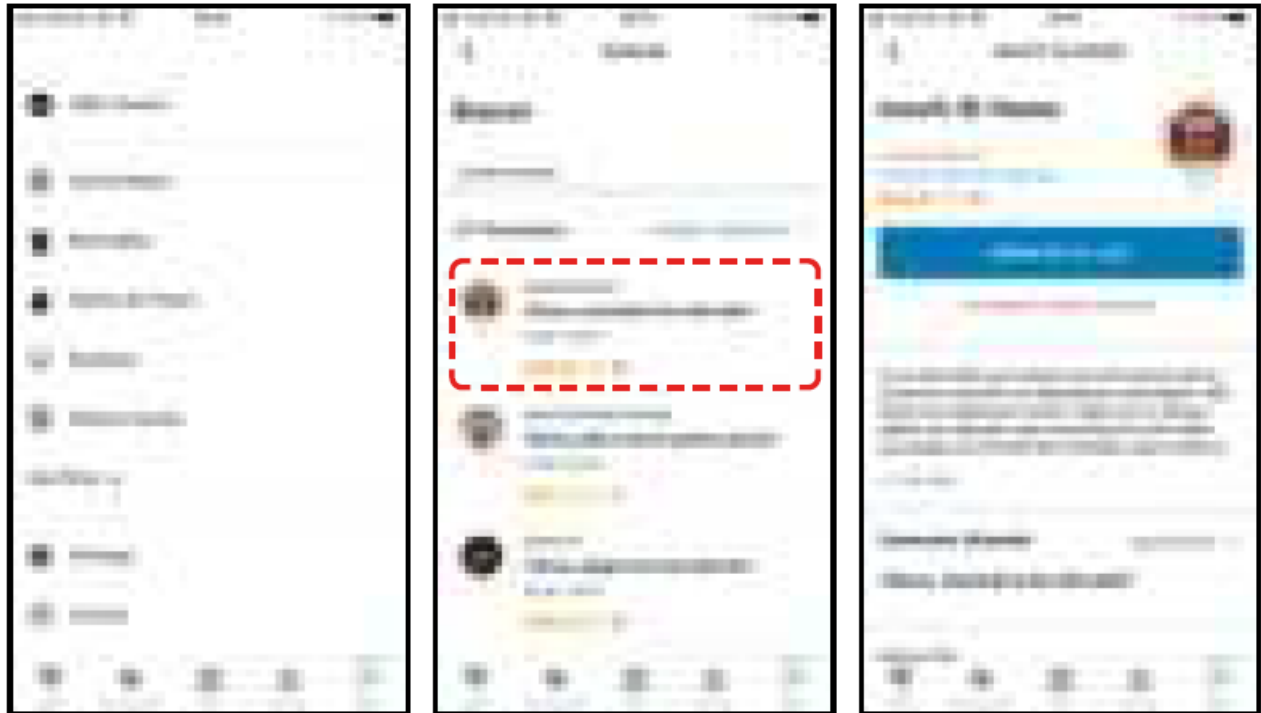

2. You will be redirected to the account link page. Enter your “muvit iO Home” account and your password, don’t forget to select the country/region your account belongs to. Then tap “Link now” to link your muvit iO Home account. The country/region, account and password is the same as the one you used to sign up for the muvit iO Home app. If the application asks you to choose between several applications, you will have to select the “muvit iO Home” App, click “Link now” and then “Authorise” to complete the installation. Tap “X” at the top left of the page to return to the Alexa application.



3. Alexa needs to find your smart devices before it can control them. Click on “DETECT DEVICES”, wait for the search to finish and hit “DONE”.



You can also say “Alexa, discover devices” to Echo. Echo will search for devices that have already been added in the muvit iO Home app.

Note: Everytime you change the device name in the muvit iO Home app, Echo must rediscover the device before controlling it.

Device control via voice commands

You can now control your Smart devices via Alexa. You can use the following commands to control your devices (e.g. living room ceiling lamp):

“Alexa, turn on/off the living room fan”.

Quick guide to using Google Home for Wi-Fi Ceiling LED Lamp with fan control

1. Open the muvit iO Home app, click on “Profile,” Google Assistant”; click on “Get”, “Copy” and go to the Google Home app. Click on “+”, “Configure device”, “Works with Google”. Find the “muvit iO Home” skill and paste the PIN you copied earlier into the muvit app; click on the arrow and click “Authorise”.

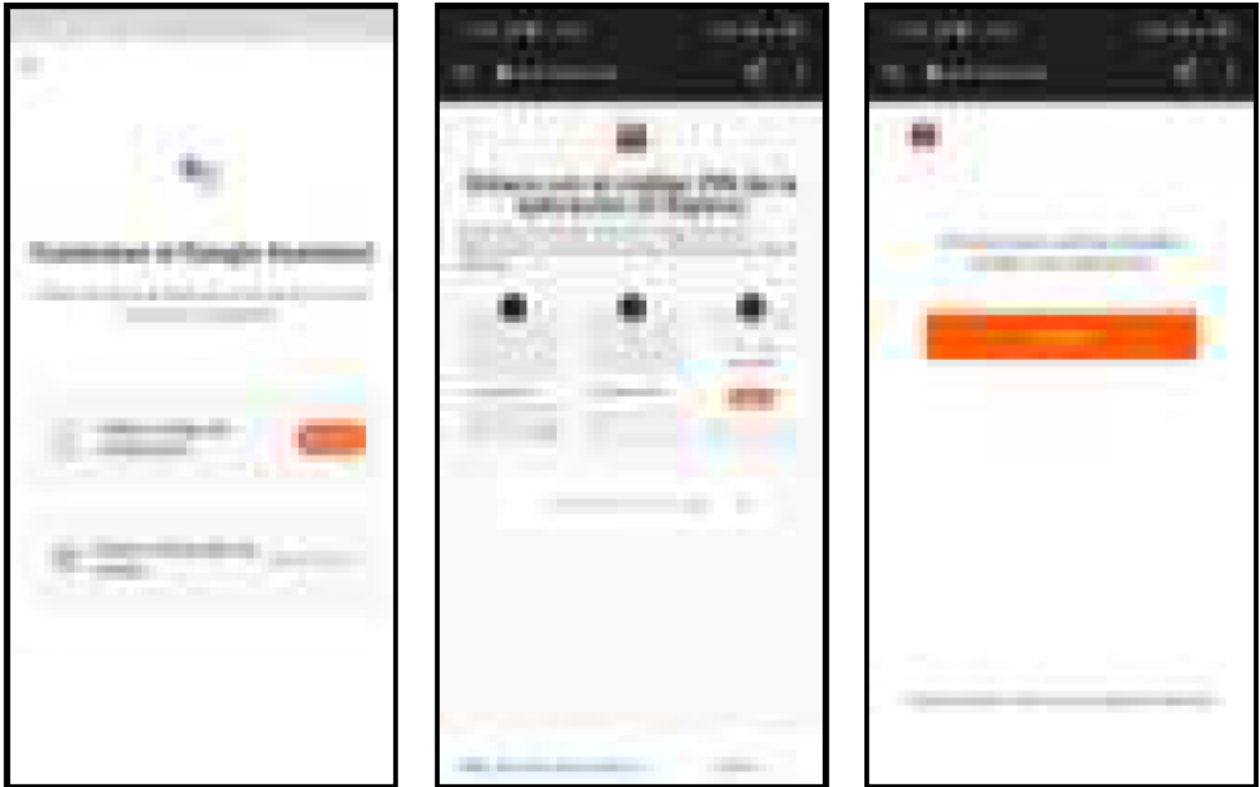

2. Once the account link has been established, you will be able to see all the smart devices in your muvit iO Home app account in the Google Home app. You can assign rooms for each device.

Device control via voice demands

You can now use Google Home to control your smart devices, using voice commands such as: “Ok Google, turn on/off the living room fan”.

TROUBLESHOOTING AND/OR FREQUENTLY ASKED QUESTIONS

1. What should I do if the device configuration process has failed?

- Check that the Wi-Fi Ceiling LED light is on.
- Check if your mobile device is connected to a 2.4 GHz Wi-Fi network.
- Check your network connectivity. Make sure the router is working properly:
- If the router is dual band, select the 2.4GHz network and then add the Wi-Fi LED lamp.
- Set the encryption method to WPA2-PSK and the authorization type to AES, or set both to automatic.
- The wireless mode cannot be 11n only.
- Check for Wi-Fi interference or relocate the Wi-Fi LED lamp to another location within range of the Wi-Fi signal.
- Check if the connected devices of the router reach the maximum allowed limit. Please try to turn off the

Wi-Fi function of some devices and reconfigure the bulb.

- Check if the wireless MAC filtering function of the router is enabled. Remove the device from the filter list and make sure that the router is not prohibiting the connection to the Wi-Fi LED lamp.
- Make sure that the password of your Wi-Fi network entered in the application is correct.
- Make sure the Wi-Fi LED lamp is in pairing mode: the light flashes white (twice per second) for quick mode configuration and white (once every 3 seconds) for AP mode configuration.
- Repeat the configuration process.
- Factory reset the Wi-Fi LED bulb and try to add it again.

2. Can I control the device via 2G/3G/4G mobile network?

The LED Wi-Fi lamp and the mobile device must be under the same Wi-Fi network when the LED Wi-Fi lamp is added for the first time. After successful configuration of the device, you can control it remotely via 2G/3G/4G mobile network.

3. How can I share my device with my family?

Open the application, go to "Profile" -> "Share device" -> "Sent", tap "Add shared device", now you can share the device with added family members.

4. How to reset this device?

Factory reset: after installing the ceiling lamp, switch on, switch off for 3 seconds, switch on, switch off again for 3 seconds and switch on for factory reset until the light flashes rapidly.

Lamp status indicator lights:

- Fast flashing (twice per second): Fast mode setting is initiated.
- Slow flashing (once every three seconds): AP mode setting is initiated.

WARRANTY & TECHNICAL ASSISTANCE SERVICE

Terms and Conditions

Innov8 Iberia guarantees the hardware and software* included in this product for the term of three (3) years in all its parts, against any defect of manufacture and operation from the date of delivery to the final consumer and without any cost for this one.

To make this warranty effective, no further requirements should be demanded than the shipment of this product together with this warranty and the invoice or proof of purchase.

*Warranty on software applicable to the software that contains the physical product, not on the control application (APP) within the consumer's mobile devices.

The warranty may be claimed at the place of purchase.

This warranty shall not be valid in the following cases:

When the details on the warranty or proof of purchase do not match the product.

When the product has been used in other than normal conditions or if it is used in disregard of the instruction manual accompanying this warranty document.

When the product has been opened or altered by unauthorized personnel.

SIMPLIFIED DECLARATION OF CONFORMITY

Under the present document, innov8 Iberia S.L. declares that the type of radio equipment, Wi-Fi Ceiling LED light with fan model MIOCLF001, is in conformity with the EMC (2014/30/EU) on Electromagnetic Compatibility, LVD (2014/35/EU) on Low Voltage, RED (2014/53/EU) on Radio Equipment, and RoHS (2011/65/EU) on the use of certain hazardous substances in electrical and electronic equipment, as well as EU Regulation 2019-2020 on Energy Labelling of light sources and EU Regulation 2019/2020 on Ecodesign requirements for light sources and independent control mechanisms under Directive 2009/125/EC.

The full text of the EU declaration of conformity is available on the following website: https://media.innov8iberia.com/DDC/MIOCLF001/DOC_MIOCLF001_EN.pdf

Product distributed by:

Ascendeo France
Address: 61, rue Emile Zola 69150 Decines-Charpieu.

After-sales service:

Email: ea@ascendeo.com





Environmental care and waste disposal:

Electrical and electronic equipment (EEE) and batteries contain materials, components and substances that can be hazardous to humans and the environment, when waste disposal is not carried out correctly.

Both electrical and electronic equipment and batteries must be marked with this symbol, which means that these products cannot be disposed of together with normal household waste, but must be separated.

To this end, all cities have set up collection systems where the disposal of electrical and electronic equipment and batteries can be handed in free of charge at the local recycling station or other collection system. For more information, please contact your local technical department.

Documents / Resources

<div><div>muvi<i>t</i> iO</div><div><div> MANUAL DE INSTRUCCIONES</div><div> MANUAL DE INSTRUÇÕES</div><div> USER MANUAL</div><div> MANUEL D'INSTRUCTIONS</div></div></div>	<div><div>muvi<i>t</i> iO MIOCLF001 Lamp Ceiling With Fan [pdf] User Manual</div><div>MIOCLF001 Lamp Ceiling With Fan, MIOCLF001, Lamp Ceiling With Fan, Ceiling With Fan, Fan</div></div>
---	--

References

-  [demais.Com](https://www.demais.com)