



muvit iO E27 Smart LED Filament Bulb User Manual

[Home](#) » [muvit iO](#) » **muvit iO E27 Smart LED Filament Bulb User Manual** 

Contents

- [1 muvit iO E27 Smart LED Filament Bulb](#)
- [2 SECURITY RECOMMENDATIONS](#)
- [3 PRODUCT INFORMATION](#)
- [4 USE OF THE APPLICATION](#)
- [5 TROUBLESHOOTING](#)
- [6 WARRANTY & TECHNICAL ASSISTANCE SERVICE](#)
- [7 SIMPLIFIED DECLARATION OF CONFORMITY](#)
- [8 Documents / Resources](#)
 - [8.1 References](#)
- [9 Related Posts](#)

muvit iO

muvit iO E27 Smart LED Filament Bulb



Thank you for purchasing the MIOBULB013 LED Wi-Fi bulb. Our goal is to provide our customers with quality products to build a more comfortable and better life. We hope you enjoy your new product.

SECURITY RECOMMENDATIONS

Important:

Please read the instructions and comply with all requirements and warnings provided in the manual before using the product. Failure to comply with the warnings and instructions may result in misuse of the product putting the product and yourself at risk.

Warnings:

1. This product is designed for indoor use. Do not use it in high humidity environments.
2. Under no circumstances install the LED Wi-Fi bulb near flammable fuels. During normal use, it may become hot.
3. If the product is damaged when unpacked, please request an exchange at the place of purchase. Before installing the product, make sure it is in perfect condition.
4. Do not subject the product to external forces.
5. This product should be stored in a cool and dry place and should not be exposed to water and fire.
6. Lighting products such as bulbs or LED strips that are burnt out or no longer in use should be disposed of at specially designated recycling points designated by local authorities.
7. Before installing or uninstalling the product, make sure that the power supply is switched off.

PRODUCT INFORMATION

- **Input voltage:** AC100V~250V 50/60Hz
- **Power:** 5W
- **Incandescent bulb equivalent:** 40W
- **Luminous flux:** 470Lm
- **Features:** Wi-Fi remote control, dimmable, programmable and scene creation.
- **LED color:** Warm White
- **Base:** E27
- **Compatible with Wi-Fi:** 802.11n 2.4GHz/20dBm (100mW)
- **Box content:** 1*bulb, 1*Manual

USE OF THE APPLICATION

Download the application “muvit iO Home”.

To download the app, you can scan the QR code below. You can also search for “muvit iO Home” in the App Store or Google Play.



Register

If you do not have an account you will have to create one from within the app. Open the app, select “Create account”; the system will automatically recognise your country, if it is not correct, please change it. Enter your email address and click “Get verification code”; after a few seconds you will receive an email at the same address with a 6-digit PIN code; copy it and then you will have to enter a password of 6 to 20 characters to create the account. Click “Save” to complete the registration.

The screenshot shows the 'Register' screen of the app. At the top, there is a back arrow and the title 'Register'. Below the title, there is a dropdown menu with 'Spain' selected. Underneath is an 'Email Address' input field. Below that is a checkbox labeled 'I agree with [Privacy Policy](#) and [Service Agreement](#)'. At the bottom, there is a large, light brown button labeled 'Get verification code'.

The screenshot shows the 'Enter verification code' screen of the app. At the top, there is a back arrow and the title 'Enter verification code'. Below the title, there are six input boxes for the verification code. Below the input boxes, there is a message: 'A verification code has been sent to your email: sac@innovisiberia.com Resend (54s)'. Below the message, there is a link that says 'Didn't get a code?'.

Add device

Connect via Bluetooth (recommended):

Turn on Bluetooth and Location on your phone. Once the app is open press “+” or “Add device” if the device light is flashing, you will get a screen to say it has detected a new device, hit “Go to add”, “Add”, select your Wi-Fi network from the app, enter the password and click “Next”. Follow the application steps to finish the installation.

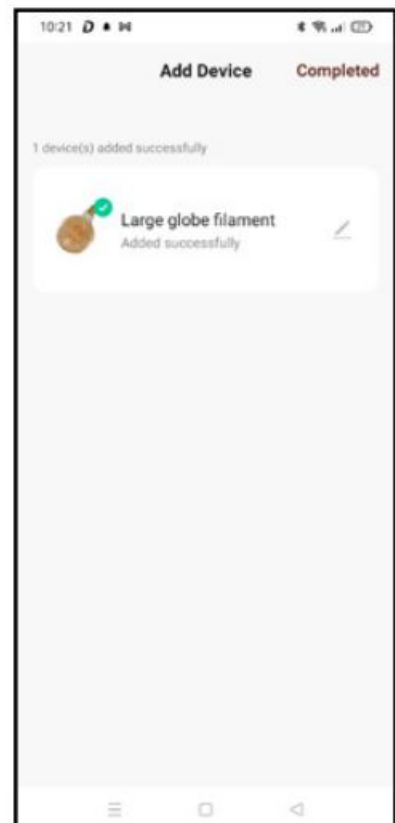
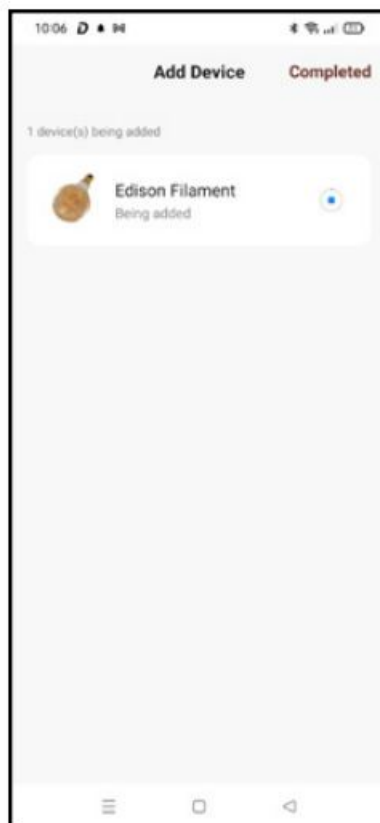
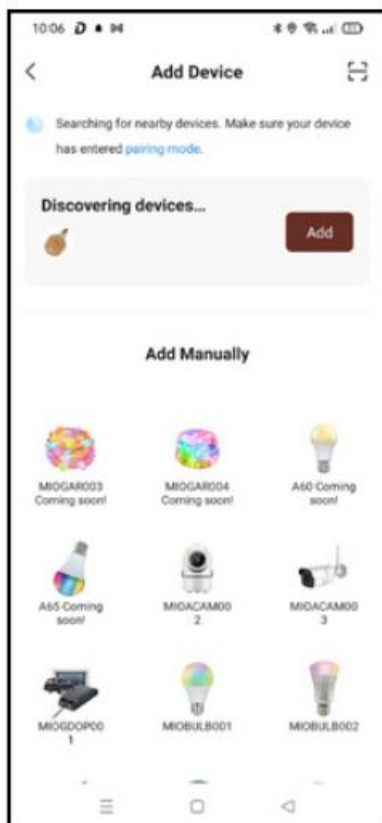

Note: Despite making the connection via Bluetooth, the device will connect to the router's Wi-Fi network, allowing you to control the device from anywhere at any time. If the New Device Detected screen does not appear, close the application completely and open it again.

Connection via EZ Mode (standard):

Activate Phone Location. Once the application is open, press "+" or "Add device", select the purchased product to enter the installation wizard. Check that it flashes quickly, if not, follow the app prompts to reset it, tick the "Flashing quickly" tick and press "Next". Enter the password, click "Next" to enter the network connection process and follow the instructions of the application to finish the installation.

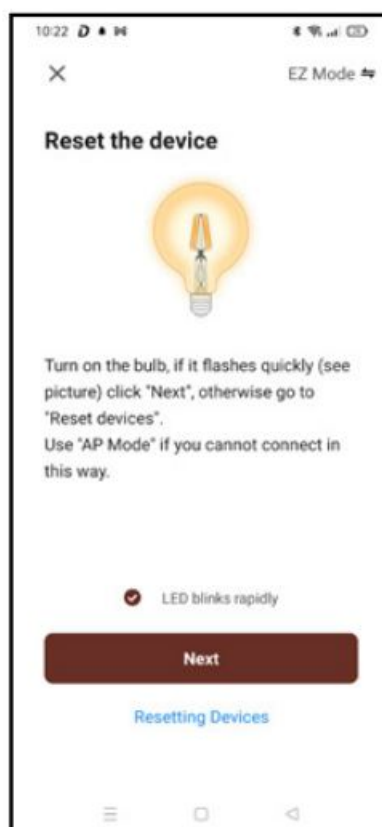

Note: Due to possible updates of the application, the installation process of the product may change. Please follow the instructions in the app itself for correct installation.

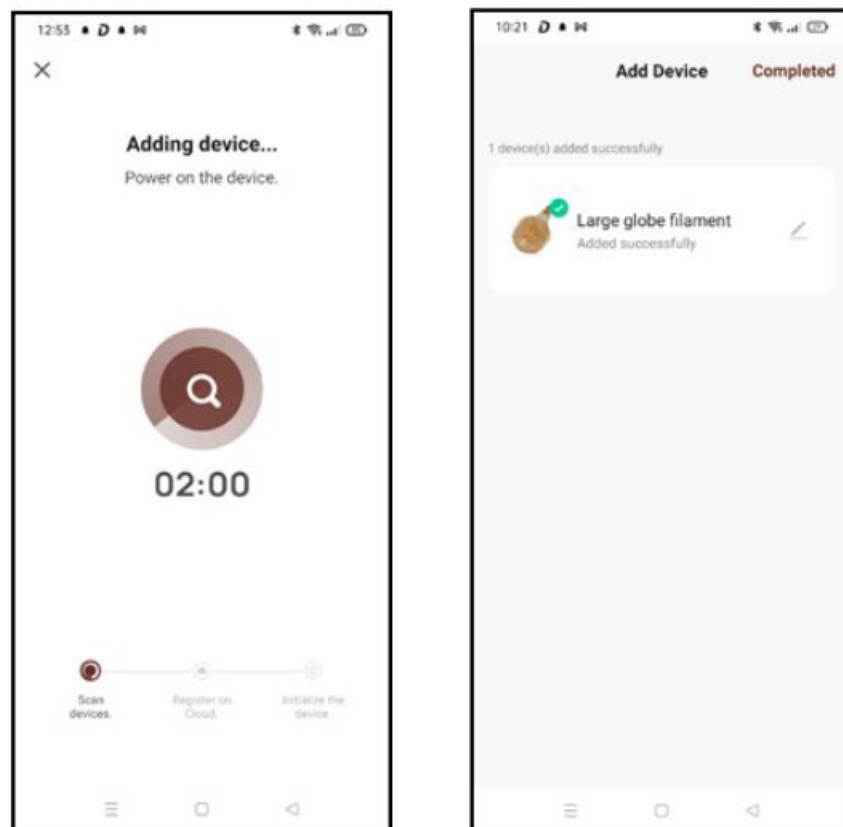

Control of the device

After successfully configuring the device, it will be displayed on the “Devices” page. Click on the device icon to control on/off, temperature/brightness setting and timers.

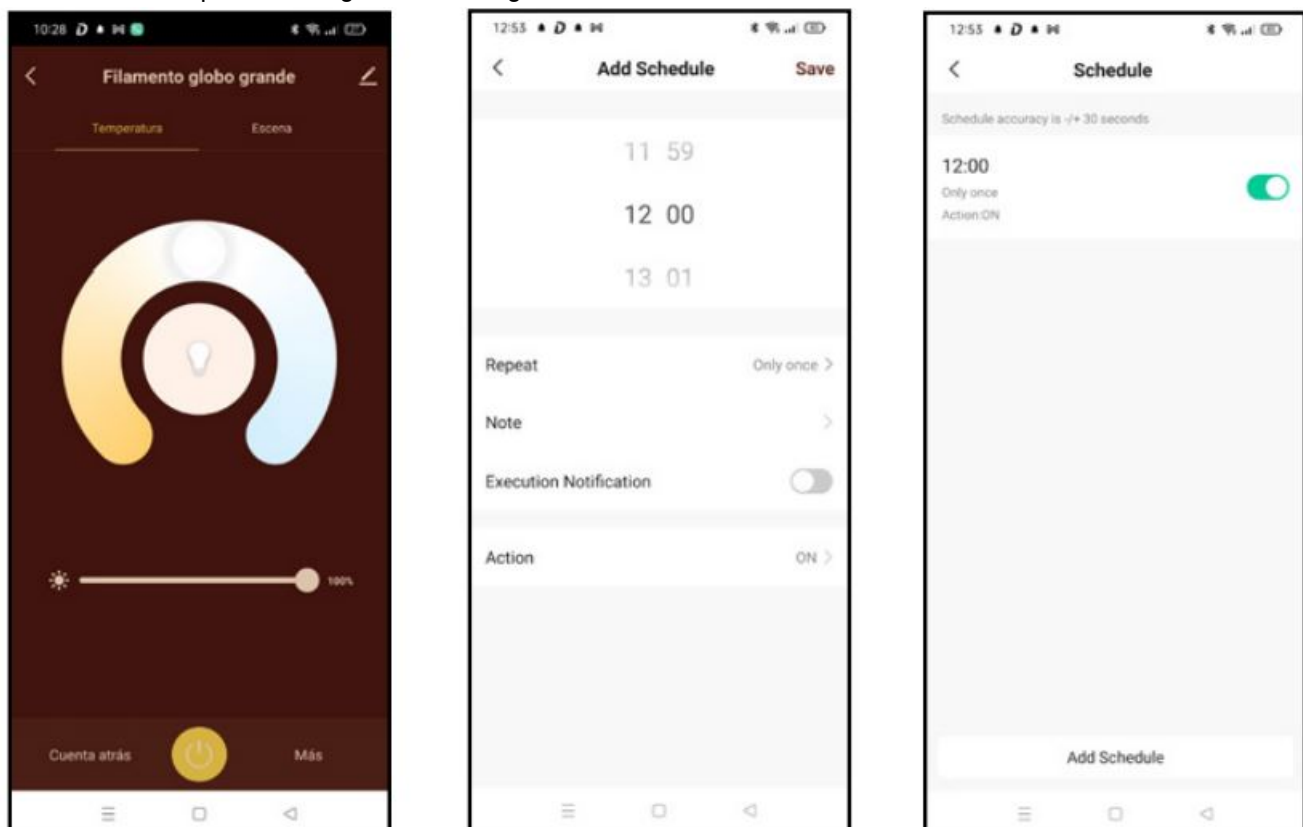

OPERATION OF THE WI-FI LED BULB WITH VOICE ASSISTANTS

Quick guide to using Amazon echo for Wi-Fi smart bulb control

Link a “muvit iO Home” account with Alexa

1. Tap “Skills & Games” in the home menu, then search for “muvit iO Home”. Select “muvit iO Home” and tap “ENABLE USE” to activate the skill.

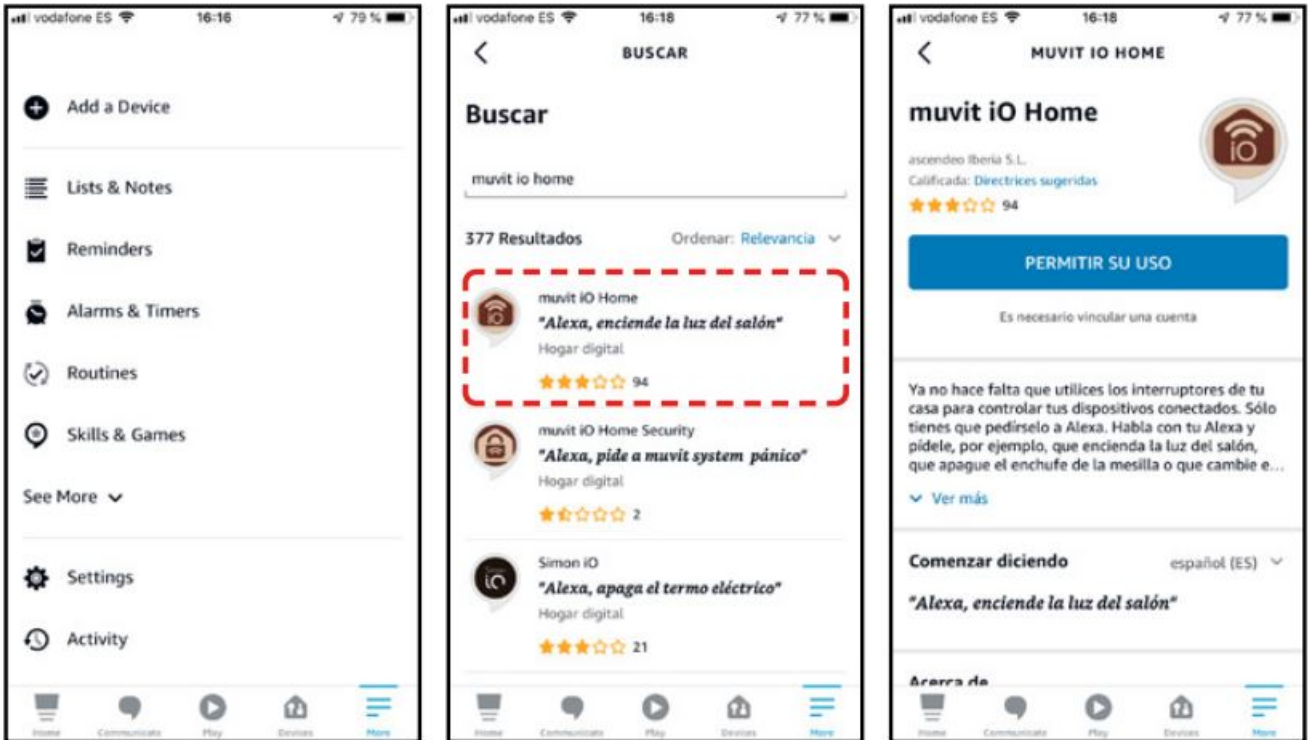

2. You will be redirected to the account link page. Enter your “muvit iO Home” account and your password, don’t forget to select the country/region your account belongs to. Then tap “Link now” to link your muvit iO Home account. The country/region, account and password is the same as the one you used to sign up for the muvit iO Home app. If the application asks you to choose between several applications, you will have to select the “muvit iO Home” App, click “Link now” and then “Authorise” to complete the installation. Tap “X” at the top left of the page to return to the Alexa application.

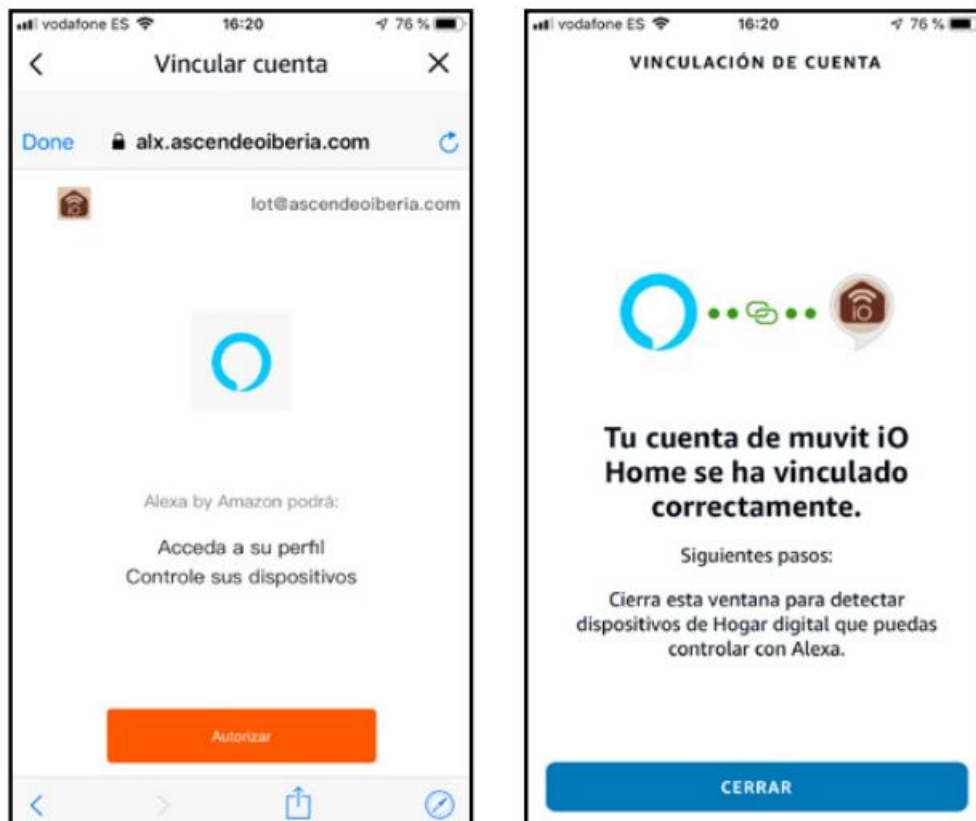

3. Alexa needs to find your smart devices before it can control them. Click on “DETECT DEVICES”, wait for the search to finish and hit “DONE”.

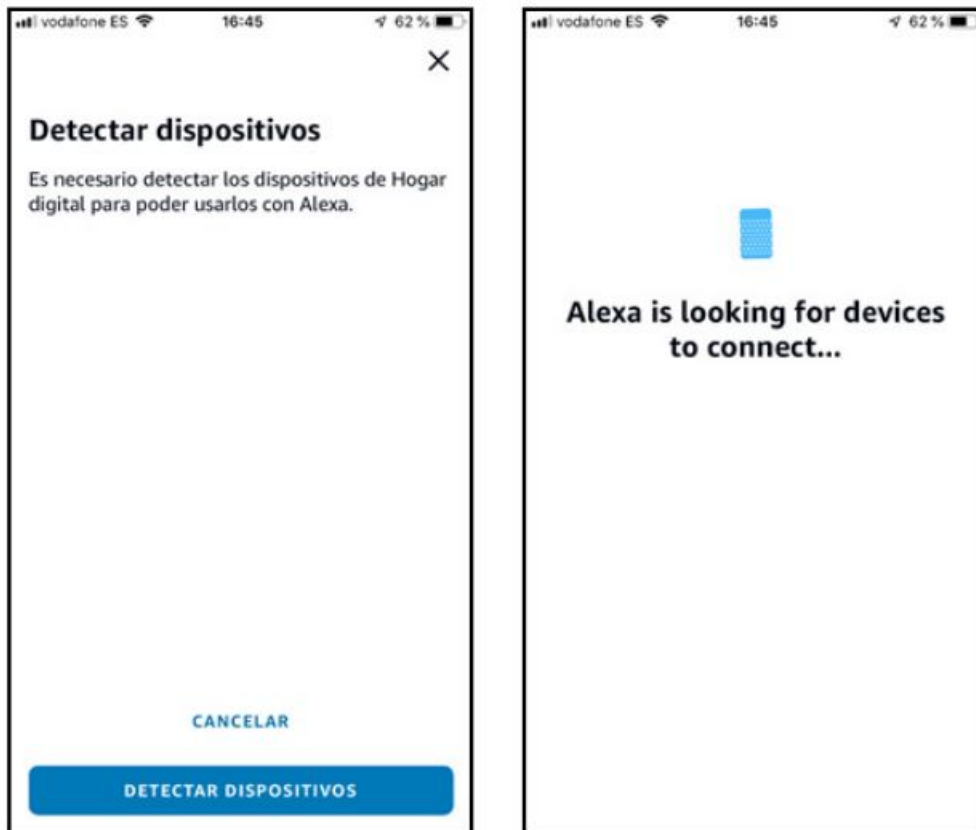

You can also say “Alexa, discover devices” to Echo. Echo will search for devices that have already been added in the muvit iO Home app.

Note: Each time you change the device name in the muvit iO Home app, Echo must rediscover the device before controlling it.

Device control via voice commands

You can now control your smart devices via Alexa. You can use the following commands to control your devices (e.g. living room light bulb): “Alexa, turn on/off living room light bulb”.

Quick guide to using Google Home to control the Wi-Fi LED Light Bulb

1. Open the muvit iO Home app, click on “Profile”, “Google Assistant”; click on “Get”, “Copy” and go to the Google Home app. Click on “+”, “Configure device”, “Works with Google”. Find the “muvit iO Home” skill and paste the PIN you copied earlier into the muvit app; click on the arrow and click “Authorise”.

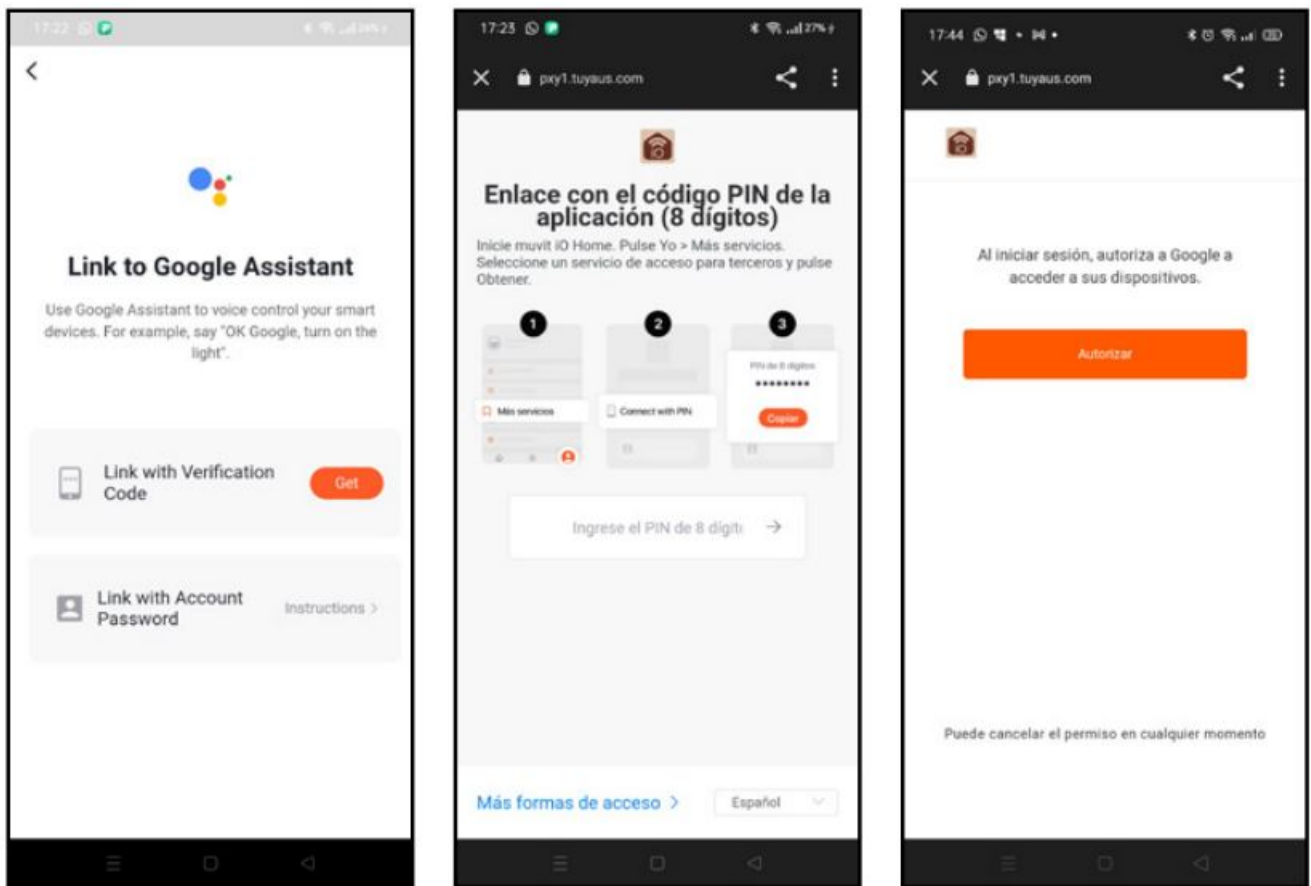

2. Once the account link has been established, you will be able to see all the smart devices in your muvit iO Home app account in the Google Home app. You can assign rooms for each device.

Device control via voice commands

You can now use Google Home to control your smart devices, using voice commands such as: "Ok Google, turn on/off the living room light".

TROUBLESHOOTING

What should I do if the device configuration process has failed?

- Check that the Wi-Fi LED light bulb is on.
- Check if your mobile device is connected to a 2.4 GHz Wi-Fi network.
- Check your network connectivity. Make sure the router is working properly. If the router is dual band, select the 2.4GHz network and then add the Wi-Fi LED bulb.
- Set the encryption method to WPA2-PSK and the authorization type to AES, or set both to automatic.
- The wireless mode cannot be 11n only.
- Check for Wi-Fi interference or relocate the Wi-Fi LED bulb to another location within range of the Wi-Fi signal.
- Check if the connected devices of the router reach the maximum allowed limit. Please try to turn off the Wi-Fi function of some devices and reconfigure the bulb.
- Check if the wireless MAC filtering function of the router is enabled. Remove the device from the filter list and make sure that the router is not prohibiting the connection to the Wi-Fi LED bulb.
- Make sure that the password of your Wi-Fi network entered in the application is correct.
- Make sure the Wi-Fi LED bulb is in pairing mode: the light flashes white (twice per second) for quick mode configuration and white (once every 3 seconds) for AP mode configuration.
- Repeat the configuration process.

- Factory reset the Wi-Fi LED bulb and try to add it again.

Can I control the device via 2G/3G/4G Mobile network?

The LED Wi-Fi bulb and the mobile device must be under the same Wi-Fi network when the LED Wi-Fi bulb is added for the first time. After successful configuration of the device, you can control it remotely via 2G/3G/4G mobile network.

How can I share my device with my family?

Open the application, go to "Profile" -> "Share device" -> "Sent", tap "Add shared device", now you can share the device with added family members.

How to reset this device?

Factory reset: after installing the bulb in a socket, switch on, switch off for 3 seconds, switch on, switch off again for 3 seconds and switch on for factory reset until the light flashes rapidly.

Lamp status indicator lights:

- Fast flashing (twice per second): Fast mode setting is initiated.
- Slow flashing (once every three seconds): AP mode setting is initiated.

WARRANTY & TECHNICAL ASSISTANCE SERVICE

Terms and Conditions

innov8 Iberia guarantees the hardware and software* included in this product for the term of three (3) years in all its parts, against any defect of manufacture and operation from the date of delivery to the final consumer and without any cost for this one. To make this warranty effective, no further requirements should be demanded than the shipment of this product together with this warranty and the invoice or proof of purchase. The warranty may be claimed at the place of purchase. *Warranty on software applicable to the software that contains the physical product, not on the control application (App) within the consumer's mobile devices.

This warranty shall not be valid in the following cases:

When the details on the warranty or proof of purchase do not match the product. When the product has been used in other than normal conditions or if it is used in disregard of the instruction manual accompanying this warranty document. When the product has been opened or altered by unauthorised personnel.

SIMPLIFIED DECLARATION OF CONFORMITY

Under the present document, innov8 Iberia S.L. declares that the type of radio equipment, LED WiFi bulb E27 model MIOBULB013, is in conformity with the EMC (2014/30/EU) on Electromagnetic Compatibility, LVD (2014/35/EU) on Low Voltage, RED (2014/53/EU) on Radio Equipment, and RoHS (2011/65/EU) on the use of certain hazardous substances in electrical and electronic equipment, as well as EU Regulation 2019-2020 on Energy Labelling of light sources and EU Regulation 2019/2020 on Ecodesign requirements for light sources and independent control mechanisms under Directive 2009/125/EC. The full text of the EU declaration of conformity is available on the following website:

https://media.innov8iberia.com/DDC/MIOBULB013/DOC_MIOBULB013_EN.pdf

Product distributed by:

Ascendeo France

Address: 61, rue Emile Zola 69150 Decines-Charpieu.

After-sales service:

Email: ea@ascendeo.com

Environmental care and waste disposal:

Electrical and electronic equipment (EEE) and batteries contain materials, components and substances that can be hazardous to humans and the environment, when waste disposal is not carried out correctly. Both electrical

and electronic equipment and batteries must be marked with this symbol, which means that these products cannot be disposed of together with normal household waste, but must be separated. To this end, all cities have set up collection systems where the disposal of electrical and electronic equipment and batteries can be handed in free of charge at the local recycling station or another collection system. For more information, please contact your local technical department.

Documents / Resources

| | |
|---|--|
|  | <p>muvit iO E27 Smart LED Filament Bulb [pdf] User Manual</p> <p>E27 Smart LED Filament Bulb, E27, Smart LED Filament Bulb, LED Filament Bulb, Filament Bulb, Bulb</p> |
|---|--|

References

- [demais.Com](https://www.demais.com)