



MUTOH XPJ-1341SR-P Display Printer Instruction Manual

[Home](#) » [MUTOH](#) » MUTOH XPJ-1341SR-P Display Printer Instruction Manual 

Contents

- [1 MUTOH XPJ-1341SR-P Display Printer](#)
- [2 Product Information](#)
- [3 Product Usage Instructions](#)
- [4 Printer use conditions](#)
- [5 Items required](#)
- [6 Preparations](#)
- [7 Put in Maintenance Mode](#)
- [8 Clean the print head circumference](#)
- [9 Clean the nozzle plate](#)
- [10 Clean the cleaning wiper and around the capping unit](#)
- [11 End the user maintenance](#)
- [12 Documents / Resources](#)
- [13 Related Posts](#)

MUTOH

MUTOH XPJ-1341SR-P Display Printer



Product Information

The product is a printer with the model number XPJ-1341SR-P. It has specific use conditions and operating environment requirements.

Operating Environment

- **Temperature:** 20°C to 32°C
- **Humidity:** 40% to 60%

Storage Environment

- **Temperature:** 5°C to 40°C
- **Humidity:** 20% to 80%

If the printer is stored above 32°C, the storage period allowed is up to 4 days or less than a week. If it's stored below 32°C and not used for over a week, certain actions need to be taken.

Product Usage Instructions

Power Off Procedure for Storage

If the printer is stored below 32°C and not used for over a week:

1. Run a nozzle check once a week. If there are missing nozzles, perform cleaning.
2. If unable to perform the nozzle check, use the Longstore menu to perform a head washing and then power off the printer. The storage period with power off must be up to one month.
3. Refer to the "Nozzle Check and Cleaning" section in the printer's operation manual for detailed instructions.
4. Refer to the "Longstore" section in the printer's operation manual for detailed instructions on using the Longstore menu.

Maintenance Procedures

Maintenance should be performed once a week before starting work or when prompted by a message on the operation panel.

In case of the following problems, maintenance should be performed immediately:

- Nozzle missing or deflection persists even after several cleaning attempts.
- The accumulated ink sticking to the print head hits a print and causes smears.
- The nozzle got clogged due to the accumulated ink removed from the print head, causing the nozzle to miss or deflect.

Items required for maintenance:

- Maintenance cleaner (Optional consumables)
- Plastic cup
- Cleaning stick
- Vinyl gloves
- Personal goggles

Preparation:

- Wear protective gloves and goggles.
- Pour some maintenance cleaner into the plastic cup and dip the cleaning stick into the cleaner.
- If the cleaning stick gets dirty during maintenance, rinse it in the cleaner.

Maintenance Mode and Print Head Cleaning

Part 1: Put in Maintenance Mode

1. Press the [Menu] key on the operation panel.
2. Press the [+] key on the right menu.
3. Press the [Enter] key on the right menu.
4. The menu number (*) may vary depending on the printer model. Press the [Enter] key on the right menu.
5. The carriage will move to the left side of the printer.
6. When the message appears, open the maintenance cover and perform maintenance. Make sure to complete this maintenance within 10 minutes while the printer is in CR maintenance state.

Part 2: Clean the Print Head Circumference

1. Open the maintenance cover L.
2. Manually move the carriage until you can see the parts around the print head. Do not push the carriage hard to avoid damage.
3. Look at the underside of the carriage and use the cleaning stick to remove the ink and dust sticking to the highlighted areas in gray in the illustration (avoid touching the nozzles and nozzle plate).
4. If the dirt or sticking ink cannot be removed completely, use a polyester knit wipe dampened with maintenance

cleaner to clean it (optional consumables).

Please contact your local MUTOH dealer to order maintenance parts.

Part name:

Maintenance cleaner, Maintenance kit, Cleaning stick, Polyester knit wipe

Part numbers and quantities per box:

- **Maintenance cleaner:** VJ-ULVA1-ML500 (1)
- **Maintenance kit:** VJ-PH-MAINTKIT (1)
- **Cleaning stick:** RH2 Clean Stick (100)
- **Polyester knit wipe:** PJ-POLYNITW2 (300)

Please follow the instructions on this sheet to perform maintenance. Inadequate maintenance will cause nozzle clogs or damage to the print head or reduce the cleaning performance of your printer.

- When using UMS21 ink, please purchase the designated maintenance cleaner (VJ-ULVA1-ML500) and a maintenance kit (VJ-PH-MAINTKIT).
- Always wear protective gloves during maintenance work to avoid contact with maintenance cleaners and ink.

Printer use conditions

Operating environment		Temperature 20°C to 32°C Humidity 40 to 60
Storage environment		Temperature 5°C to 40°C Humidity 20 to 80
		When stored above 32°C: Storage period allowed: up to 4 days
If you're not using the printer for	less than a week	Power off the printer (when stored below 32°C)
	over a week	a) Run a nozzle check once a week. Perform cleaning if there are nozzles missing. See the section "Nozzle Check" and "Cleaning" in your printer's operation manual b) If you are unable to perform a) Use the "Longstore" menu to perform a head washing and then power off the printer. The storage period with power off must be up to one month. See the section "Longstore" in your printer's operation manual

When to perform maintenance

- Once a week before your work
- When this message is prompted on the operation panel
 - Perform CR Maint.

In case the following problems appear, you should perform maintenance immediately:

- Nozzle missing or deflection persists even after several cleaning attempts.
- The accumulated ink sticking to the print head hits a print and causes smears.
- The nozzle got clogged due to the accumulated ink removed from the print head, causing the nozzle to miss or deflection.

Items required

- **a.** Maintenance cleaner (Optional consumables)
- **b.** Plastic cup
- **c.** Cleaning stick
- **d.** Vinyl gloves
- **e.** Personal goggles

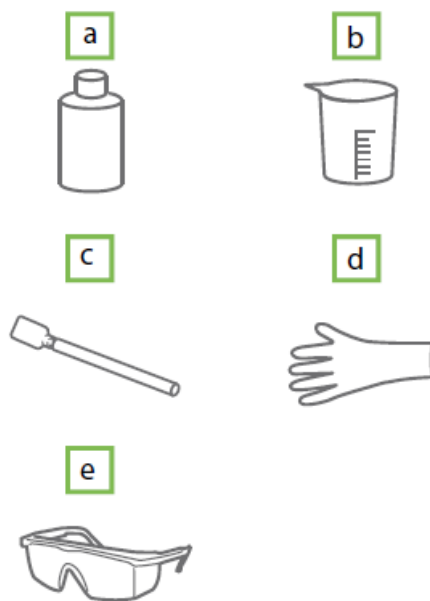

- **(a) Use the designated cleaner.**

Items (b) to (d) are included in the maintenance kit.

Preparations

- Wear protective gloves and goggles.
- Pour some maintenance cleaner into the plastic cup and dip the cleaning stick into the cleaner.
 - [If gets dirty during maintenance] Rinse the stick in the cleaner.





Note

Please contact your local MUTOH dealer to order maintenance parts.

Part name/Part number/Quantity (per box)

- Maintenance cleaner
 - VJ-ULVA1-ML500 1
- Maintenance kit
 - VJ-PH-MAINTKIT 1
- Cleaning stick
 - RH2 Clean Stick 100
- Polyester knit wipe
 - PJ-POLYNITW2 300

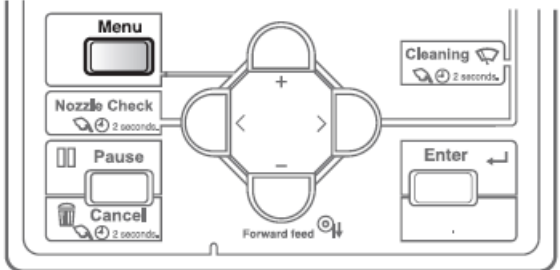
Put in Maintenance Mode

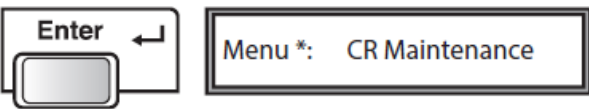
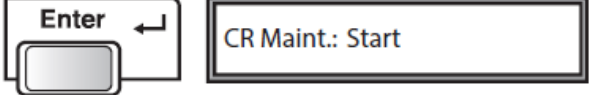
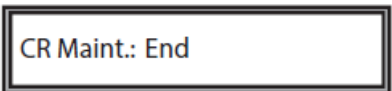
1	Press the [Menu] key on the operation panel.	
2	Press the [+] key on the menu on the right.	
3	Press the [Enter] key on the menu on the right. Menu number (*) varies depending on the printer being used.	
4	Press the [Enter] key on the menu on the right. The carriage moves to the left side of the printer.	
5	When the message on the right appears, open the maintenance cover and perform maintenance. Make sure to complete this maintenance within 10 minutes while the printer is in CR maintenance state.	

Clean the print head circumference

1. Open the maintenance cover L. You will clean the parts around the print head using the cleaning stick.

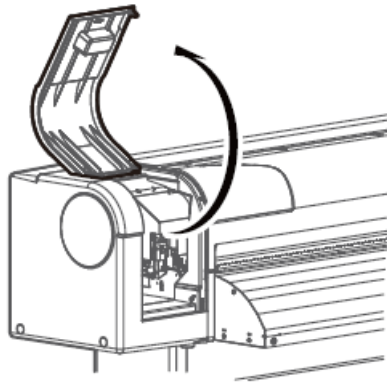

2. Manually move the carriage until you can see the parts around the print head. Do not push the carriage hard to avoid damage.

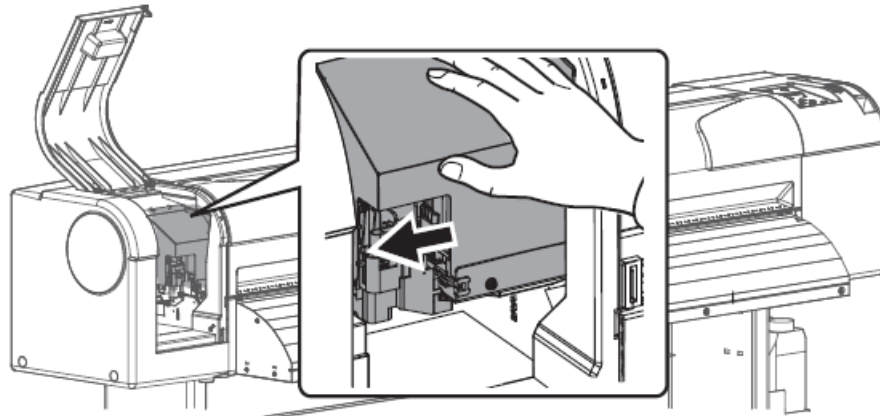

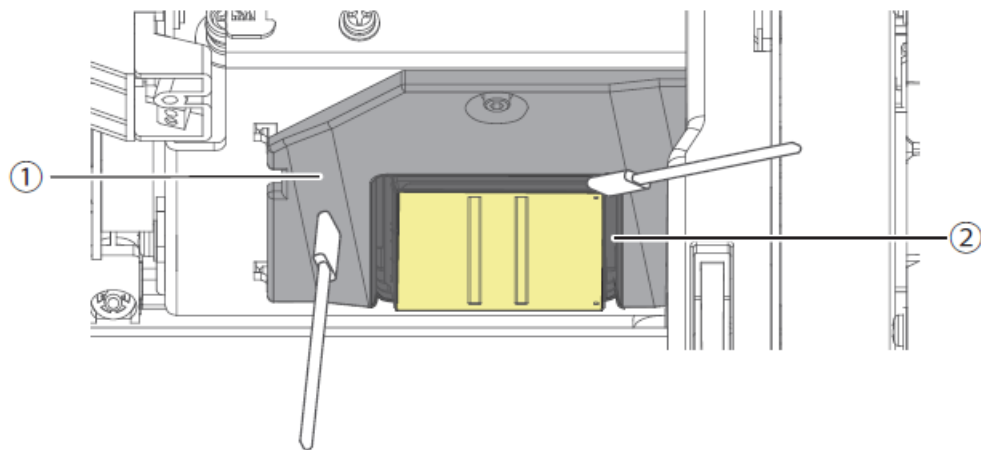

3. Look at the underside of the carriage and use the cleaning stick to remove the ink and dust sticking to the area highlighted in gray in the illustration below:

-  Do not touch the nozzles and the nozzle plate (yellow)



Clean these parts

-  ①...Head guide (gray plastic part)
-  ②...gap between ① and around the nozzle plate

If the dirt or the sticking ink cannot be removed completely, use a polyester knit wipe (optional consumables) dampened with maintenance cleaner to clean it.

Clean the nozzle plate

Clean the nozzle plate (only when the ink is sticking to the plate)

1. This maintenance is required only when you see the ink sticking to the nozzle plate. Use the cleaning stick to clean the dirt on the nozzle plate.

-  ...Ink sticking to the plate. Most likely it sticks to the area that contacts with the capping unit and the gap between Head guide and around the nozzle plate

Nozzle plate

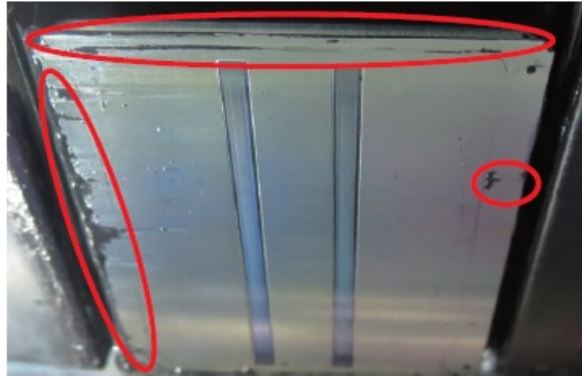

2.  **Do not touch the nozzles (yellow).**

- If you accidentally touched the nozzles, run a nozzle check after the maintenance and make sure all nozzles are clear.
- Try cleaning several times until the dirt or the sticking ink is removed.
- Do not use items other than cleaning sticks.

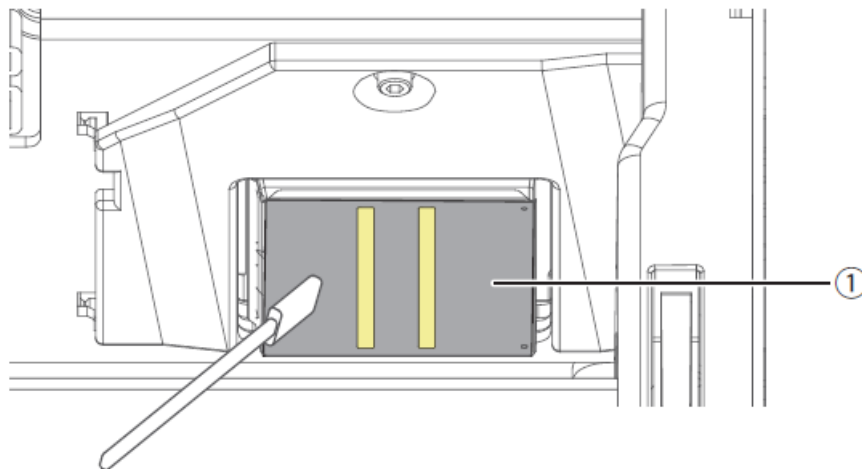

-  **Clean these parts**

① ... Nozzle plate (silver metal part)

3. Close the maintenance cover L.

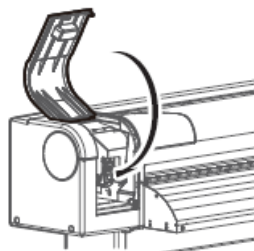

Clean the cleaning wiper and around the capping unit

1. Open the front cover.

Use the cleaning stick to clean these parts:

- cleaning wiper
- rubber part of the capping unit

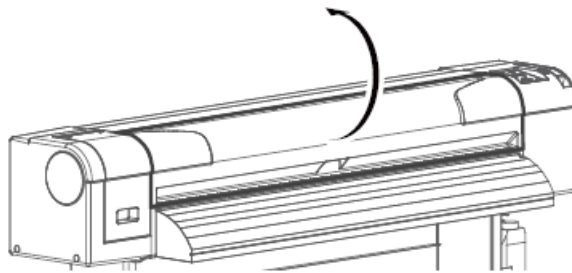

2. Use the cleaning stick to wipe off ink and dust sticking to the cleaning wiper.

Clean the left side of the cleaning wiper (black rubber) to remove dirt.

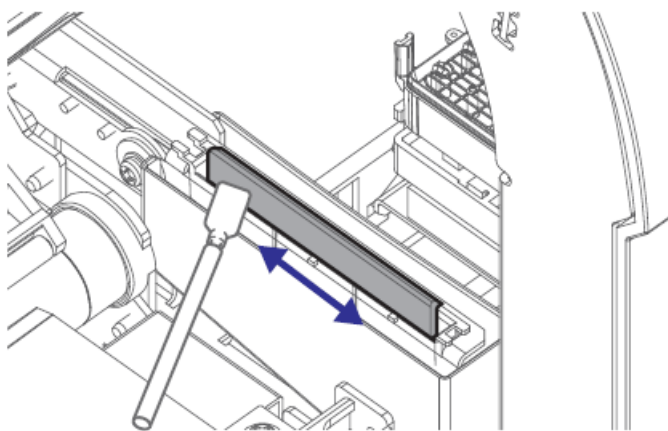

Clean the right side of the cleaning wiper to remove dirt.

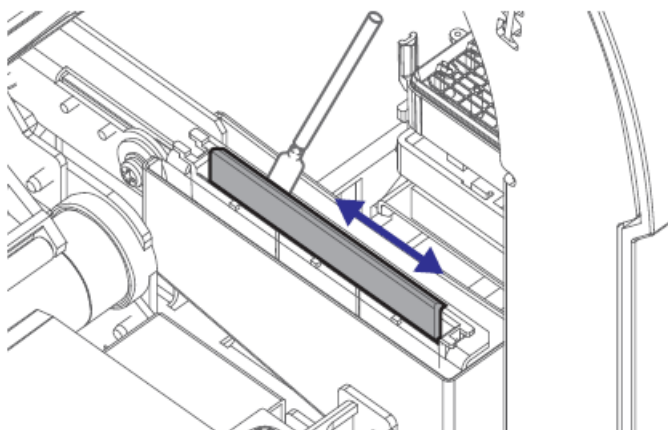

**If the dirt or the sticking ink cannot be removed completely, use a polyester knit wipe (optional consumables) dampened with maintenance cleaner to clean it.*

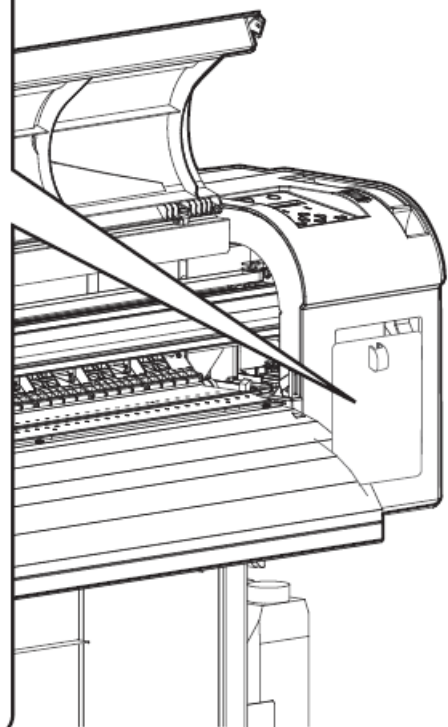

3. Next, you will clean the parts around the capping unit.

Remove the maintenance cover R

1. Turn the tab on the cover to the left.
2. Then push it down to open the cover.
3. Remove the maintenance cover R from the printer.

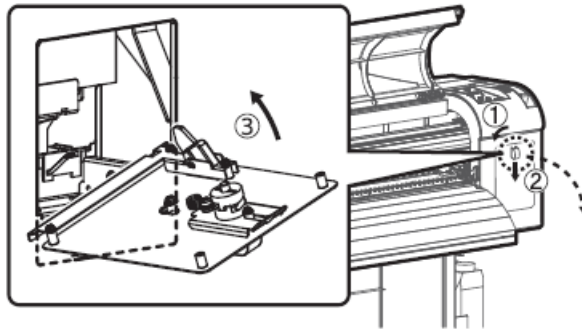

4. Use the cleaning stick to clean the rubber part around the capping unit and the edge of the rubber part to remove the sticking ink and dust.

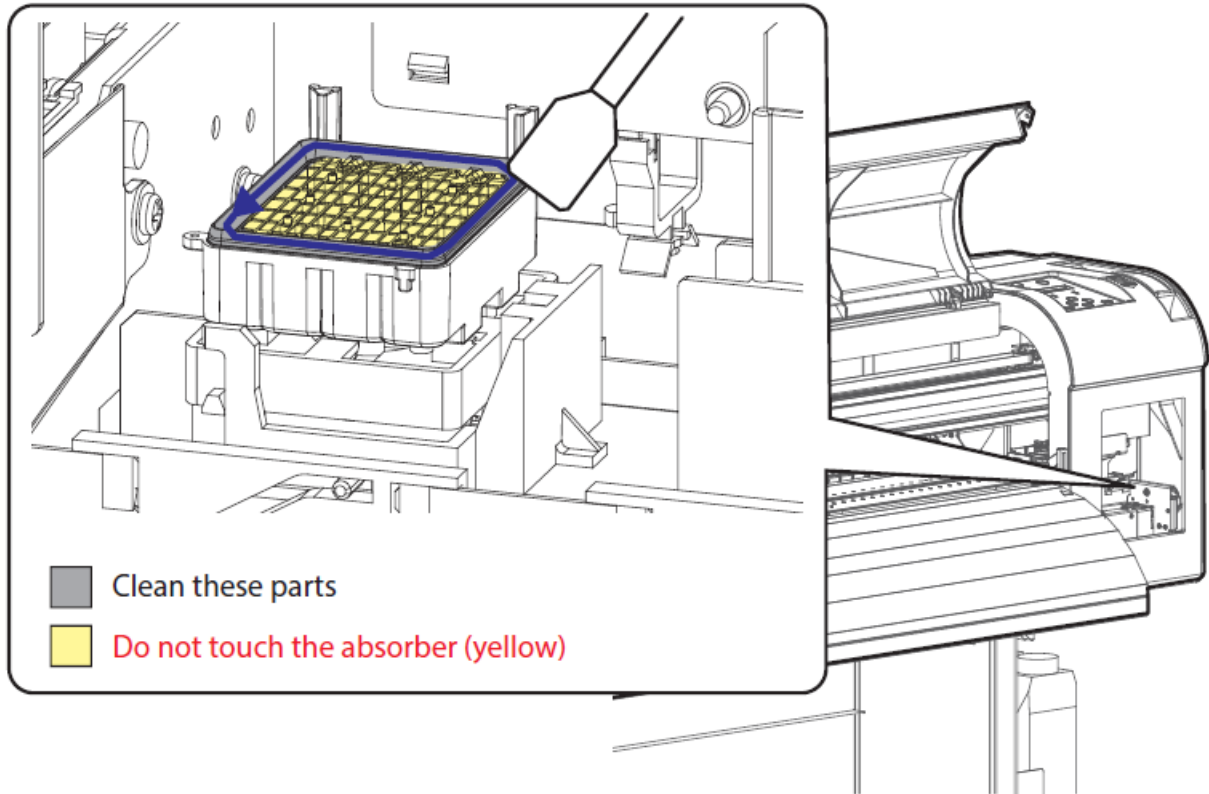

5. Close the maintenance cover R.

Remove the maintenance cover R

1. Attach the maintenance cover R to the printer.
2. While turning the tab to the left, push it down and close the cover.
3. Turn the tab to the right.

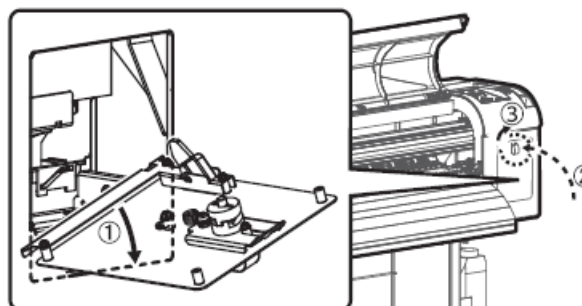

End the user maintenance

1. Once the maintenance is done, close the front cover and press the [Enter] key on the operation panel.

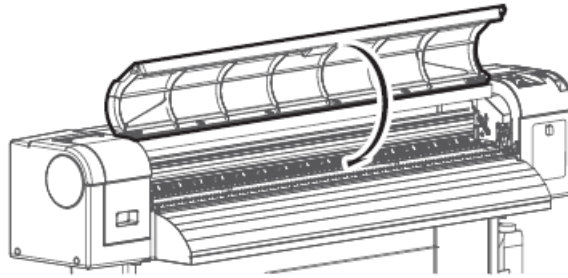

2. Put the cleaning stick back in the maintenance cleaner to store.

To keep the wiper and the capping unit always clean,

- Make sure to replace it with a new cleaning stick every week.
- Do not use the cleaning stick if the ink on the stick gets dried.
- Put a plastic bag or plastic wrap over the plastic cup with maintenance cleaner to keep out dust.
- Make sure to refresh the maintenance cleaner in the plastic cup every week.

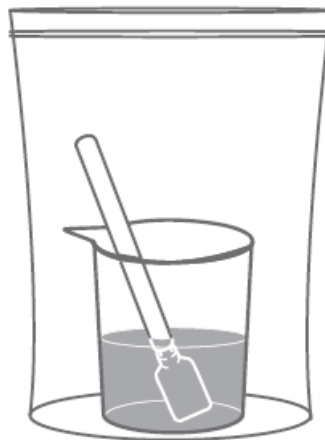

Note

Used cleaning sticks and the maintenance cleaner remaining in the plastic cup are industrial waste. Dispose of them in accordance with your local waste regulations.

Documents / Resources

	<p>MUTOH XPJ-1341SR-P Display Printer [pdf] Instruction Manual XPJ-1341SR Pro, XPJ-1341SR-P Display Printer, Display Printer, Printer</p>
---	---