



MUSOTOKU MK-2 Power Unit Dual USB-C Model Instructions

[Home](#) » [Musotoku](#) » MUSOTOKU MK-2 Power Unit Dual USB-C Model Instructions 

Contents

- [1 MUSOTOKU MK-2 Power Unit Dual USB-C Model](#)
- [2 OVERVIEW](#)
- [3 FOOTSWITCH MODES](#)
- [4 OVERCURRENT](#)
- [5 STOPWATCH TIMER](#)
- [6 Documents / Resources](#)
 - [6.1 References](#)



MUSOTOKU MK-2 Power Unit Dual USB-C Model



OVERVIEW

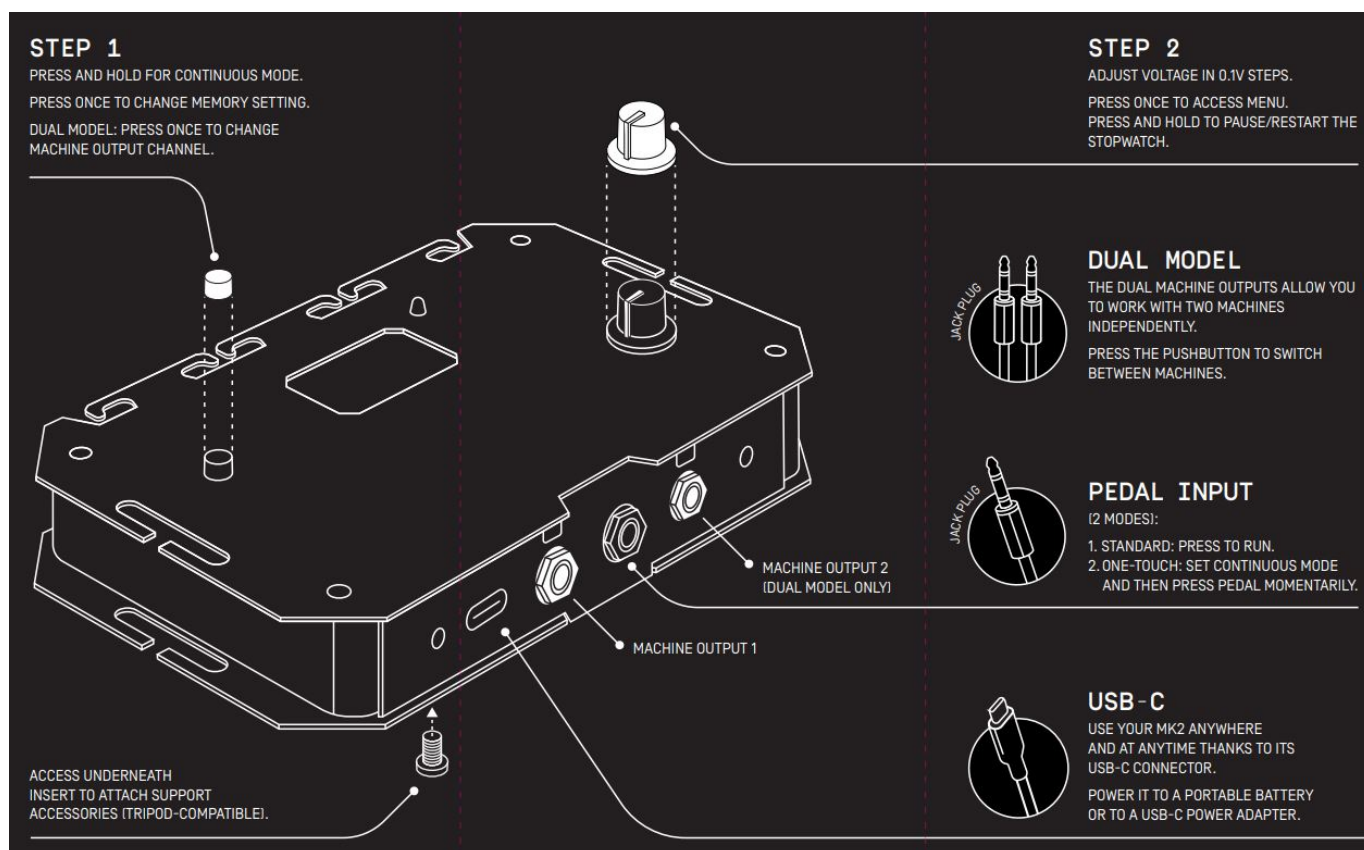

CAUTION!

- DO NOT SHORT THE OUTPUT.
- WORKS ONLY WITH USB-C POWER ADAPTERS OF 5W OR MORE 5V OUTPUT.
- HANDLE WITH CARE. DO NOT DROP OR HIT THE POWER SUPPLY.
- DO NOT SCREW OR INSERT ANY OBJECT LARGER THAN 1CM INSIDE THE TRIPOD NUT.
- DO NOT SOAK OR CLEAN UNDER WATER.
- CLEAN ONLY WITH A DAMP CLOTH AND AVOID DROPPING LIQUIDS INSIDE.
- DO NOT BRAG ABOUT YOUR NEW MUSOTOKU TO YOUR STUDIO MATES ~ THERE IS NO NEED, THEY WILL ASK YOU ABOUT IT ANYWAY.

CONTACT

FEEL FREE TO DROP US A LINE IF YOU HAVE ANY QUESTIONS OR SOMETHING.

SUPPORT@MUSOTOKU.COM

INSTAGRAM:MUSOTOKU [MUSOTOKU.COM](https://www.musotoku.com)

POWER

This MUSOTOKU power supply is capable of delivering 5A of output power to your machine and up to 10A peak. Expect absolute stability and no fluctuation on your lines.

DUAL MODEL

Works with two machines independently. Press the push button to change between machine channels 1 and 2. Each machine output has its own memory setting. There is a led next to each machine connector that indicates the current active output.

USB-C

Works only with USB-C Power adapters of 60W or more (20V output). Works with 60W power bank battery compatible with Laptops.

NITRO

The NITRO function is an extra injection of power to your machine for a brief pulse of 0.5 seconds after pressing the footswitch. The NITRO pulse will make your machine start faster and be more reliable. To access the NITRO menu just push the top of the analog dial and navigate to NITRO. The NITRO pulse is not dangerous for your machine, as the voltage profile is always adapted to your machine. This NITRO function has been updated to a new special profile that is 100% compatible with brushless motors. The NITRO feature is enabled independently for each channel, so you can customize your setting per machine on the DUAL model.

FOOTSWITCH MODES

STANDARD MODE: The machine will run when the footswitch is pressed and will stop when it is released. **MAINTAINED or CONTINUOUS MODE:** No footswitch needed. Just press and hold the push button until you hear a double beep. To stop the machine, just repeat the action. **ONE-TOUCH MODE:** Use the CONTINUOUS mode together with the footswitch and the machine will turn itself ON/OFF with each press of the footswitch.

OVERCURRENT

This MUSOTOKU power supply continuously monitors your machine's health to avoid overheating. If a short circuit is detected on the clipcord or the machine, your MUSOTOKU power supply will immediately stop, displaying a warning message (OVERCURRENT). Carefully inspect your cable and/or the machine before resuming work.

AUTO POWER~OFF

There is no power switch on this MUSOTOKU power supply. After 1 hour of no operation, it will switch off automatically. To turn it on again, just press the footswitch or any control on the power supply and it will turn on immediately.

STOPWATCH TIMER

The stopwatch timer counts minutes and hours to help you track your tattoo work. To operate it, go to the TIMER menu by pressing the analog dial and then navigating to TIMER. You can then choose between PLAY/STOP/RESET. There is also a shortcut to toggle the PLAY/STOP action by pressing and holding the analog dial. When the timer is stopped, it will flash periodically. The maximum timer count is 9 hours.

Documents / Resources

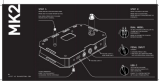
	MUSOTOKU MK-2 Power Unit Dual USB-C Model [pdf] Instructions MK-2, MK-2 Power Unit Dual USB-C Model, Power Unit Dual USB-C Model, Unit Dual USB-C Model, Dual USB-C Model, USB-C Model, Model
---	--

References

-  [Musotoku - Designers and builders of tattoo tools](#)