

MUNBYN ITPP130B Bluetooth Label Printer



MUNBYN ITPP130B Bluetooth Label Printer User Manual

[Home](#) » [MUNBYN](#) » MUNBYN ITPP130B Bluetooth Label Printer User Manual 

Contents

- [1 MUNBYN ITPP130B Bluetooth Label Printer](#)
- [2 Product Information](#)
- [3 Product Usage Instructions](#)
- [4 Product Introduction](#)
- [5 Product features](#)
- [6 Set Up The Printer](#)
- [7 Pro Tips](#)
- [8 FAQ](#)
- [9 LED Status](#)
- [10 Feeder Button Instruction](#)
- [11 Specification](#)
- [12 Safety Notices](#)
- [13 FCC Statement](#)
- [14 Tech Support](#)
- [15 Documents / Resources](#)
 - [15.1 References](#)

MUNBYN

MUNBYN ITPP130B Bluetooth Label Printer



Product Information

Specifications:

- Version: 1.01
- Product: Label Printer
- Model: RealWriter 130 Bluetooth
- Website: munbyn.biz/130BD

Product Usage Instructions

1. Setup:

Ensure the label printer is charged or connected to a power source. Turn on the device and pair it with your Bluetooth-enabled device following the instructions in the user manual.

2. Printing Labels:

Load the label rolls into the printer according to the instructions provided. Use the compatible label design software to create and send print jobs to the printer via Bluetooth.

3. Maintenance:

Regularly clean the printer's print head and rollers to ensure optimal performance. Refer to the user manual for detailed maintenance guidelines.

FAQ:

• Q: How can I download user manuals in other languages?

A: You can access the link provided in the manual or scan the QR code to download user manuals in various languages.

• Q: Where can I find additional support or troubleshooting tips?

A: Visit the FAQ page at munbyn.biz/130B-FAQ for FAQs, troubleshooting tips, and support information.

Product Introduction

What's in the package?



- A. Printer
- B. USB Flash Drive
- C. USB Cable
- D. Power Adapter
- E. Power Cord
- F. User Manual
- G. Quick Tips
- H. Labels

If contents are missing or damaged, please contact us.

Product features

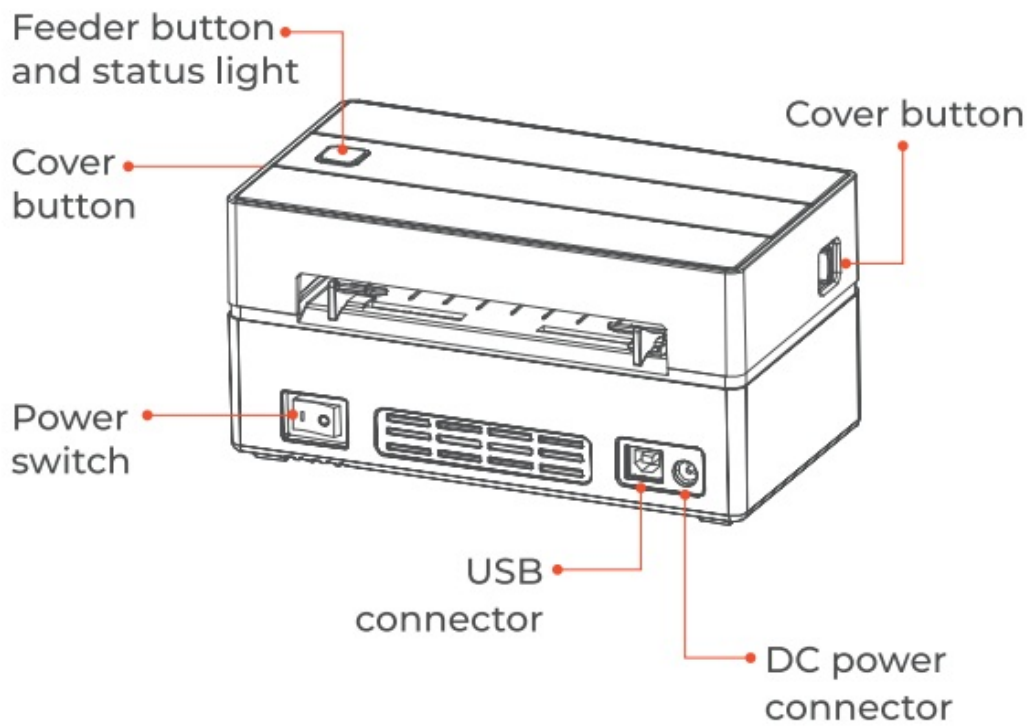

Set Up The Printer

Recommend:

Watch the short setup video at: <https://munbyn.biz/130Bvideo>

Quick printer connection

•

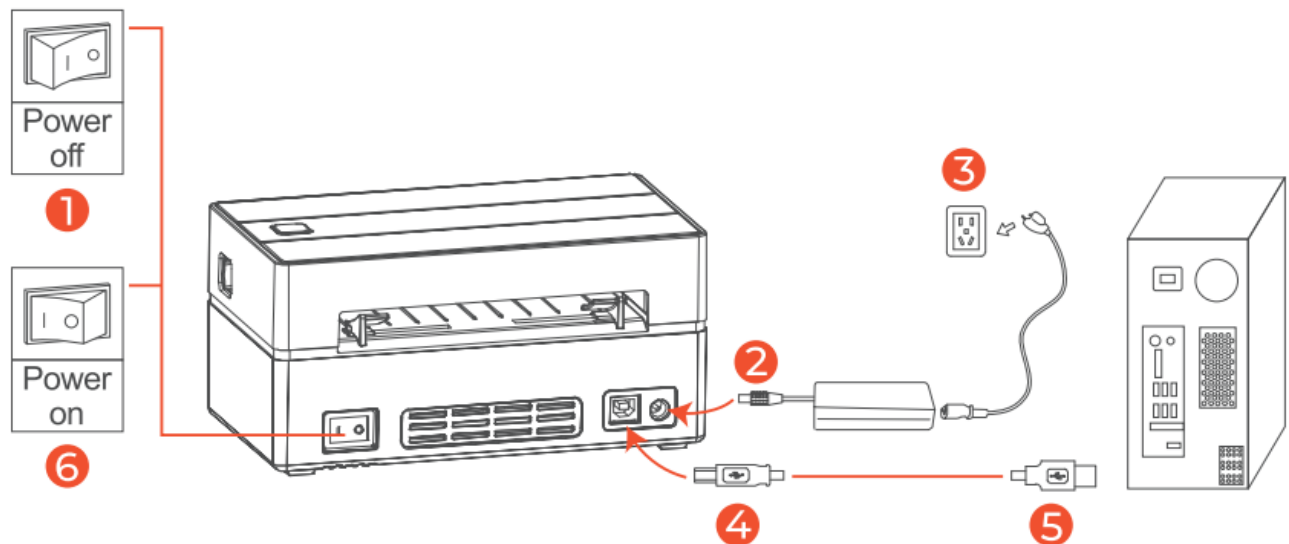

Please follow the sequence of the above picture to operate.

Label setup

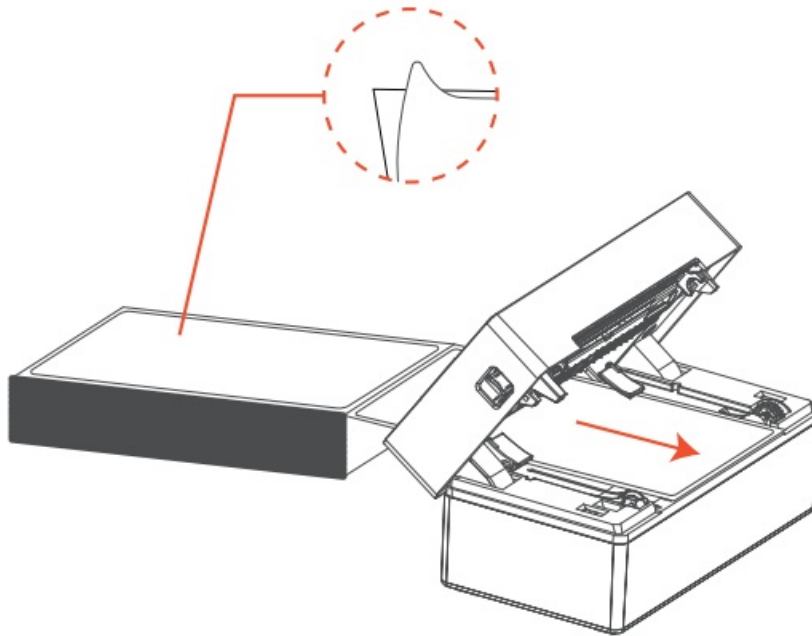
**Automatic label identification:**

Load no less than 4 consecutive labels into the printer. Once the paper is stable, press and hold feeder button, until you hear a “beep”. Then, the printer will automatically label identification calibrate the label.

Bluetooth connection for Smart phone/Tablet

The printer is suitable for bluetooth of mobile phones and tablets, not compatible with bluetooth of computers, And the printer cannot be connected directly via the Bluetooth of the device, it needs to be connected using the Munbyn Print APP.

Connect the printer through the Munbyn Print APP

1. Search “Munbyn Print” on App Store or Google Play to get the App or scan the QR code below to download



2. Scan the QR code tutorial below to set it up



3. If your mobile needs a PIN password, please enter “0000”.

Note: Due to the mobile phone system requirements, the app needs to access your location services information, you get a notification requesting permission. You need to enable CPS and confirm authorization (Android on y).

USB connection for Laptop/PC

- Follow step (2.1 Quick printer connection) to connect the computer and printer using the USB cable.
- Download the printer driver from the following URL or insert the USB flash drive into your computer, and follow the steps (2.41-2.42) to complete the installation.

Note: For the latest driver, please visit: <https://munbyn.biz/130BD>

Windows Driver Installation

Downloaded software from the web address or insert the USB flash drive into your computer, open the driver installation package, Click on the .exe file for Windows computers, and follow the steps below to install

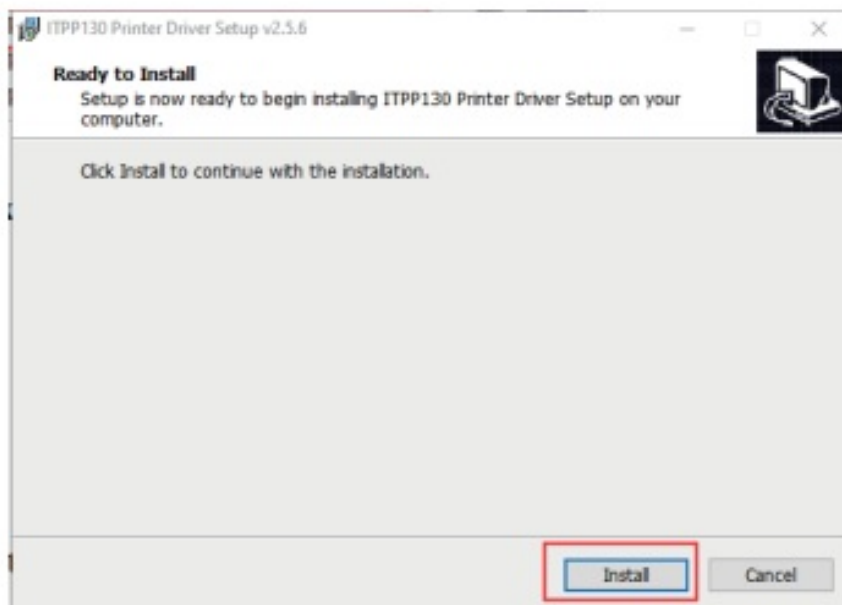
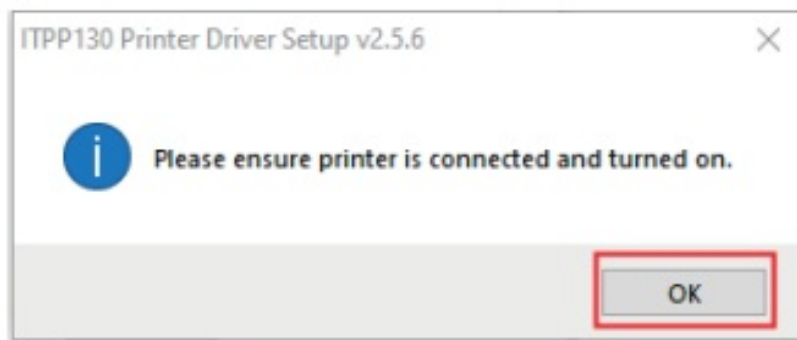
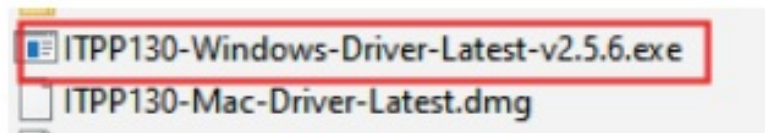

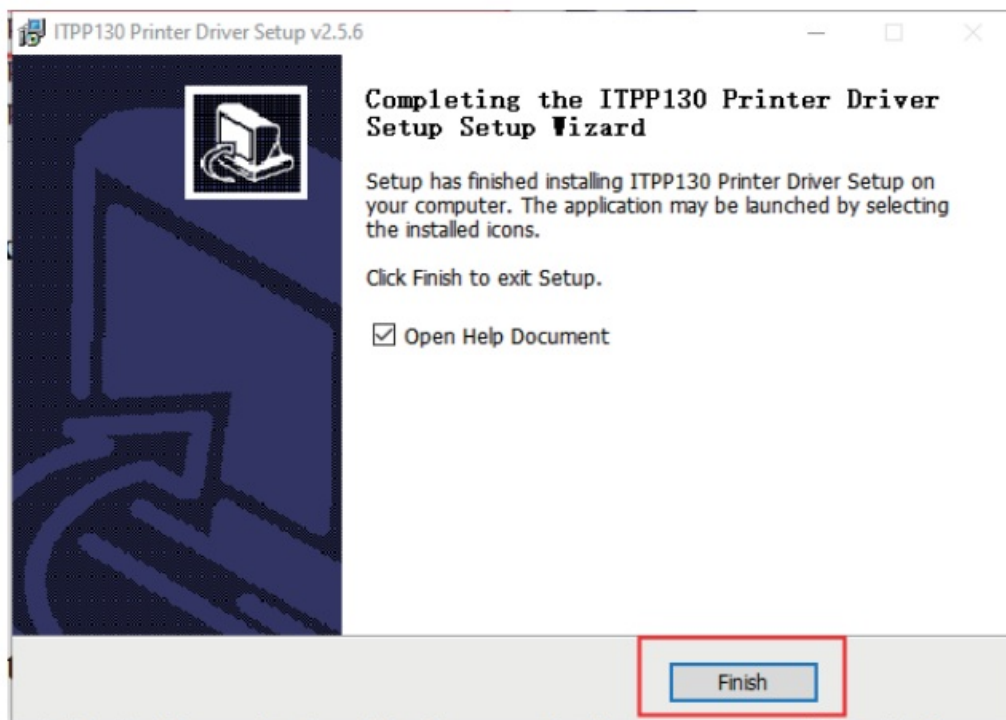

Mac Driver Installation

Downloaded software from the web address or insert the USB flash drive into the computer, open the driver installation package, click the .dmg file of the Mac computer, and follow the steps below to install

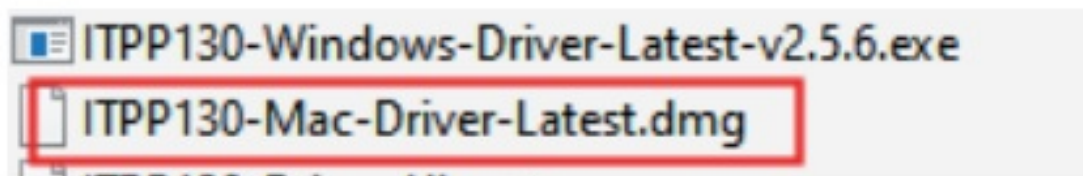

1、 Open and Install Driver



ITPP130Printer
_V1.5.6_signed.pkg

2、 FAQ



ITPP130 FAQ.pdf

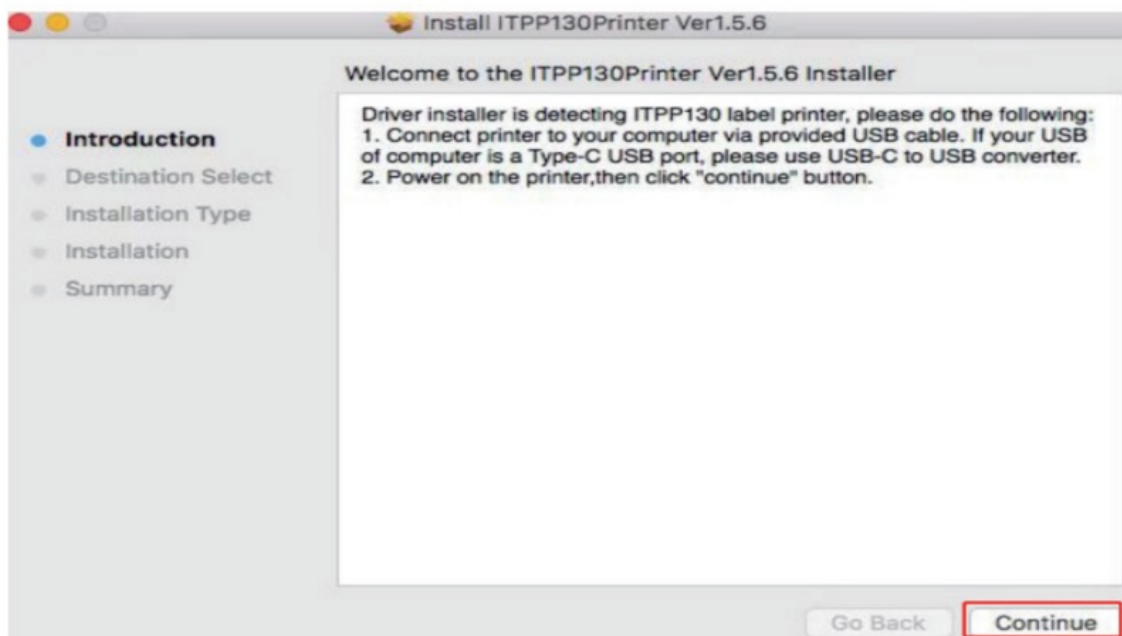

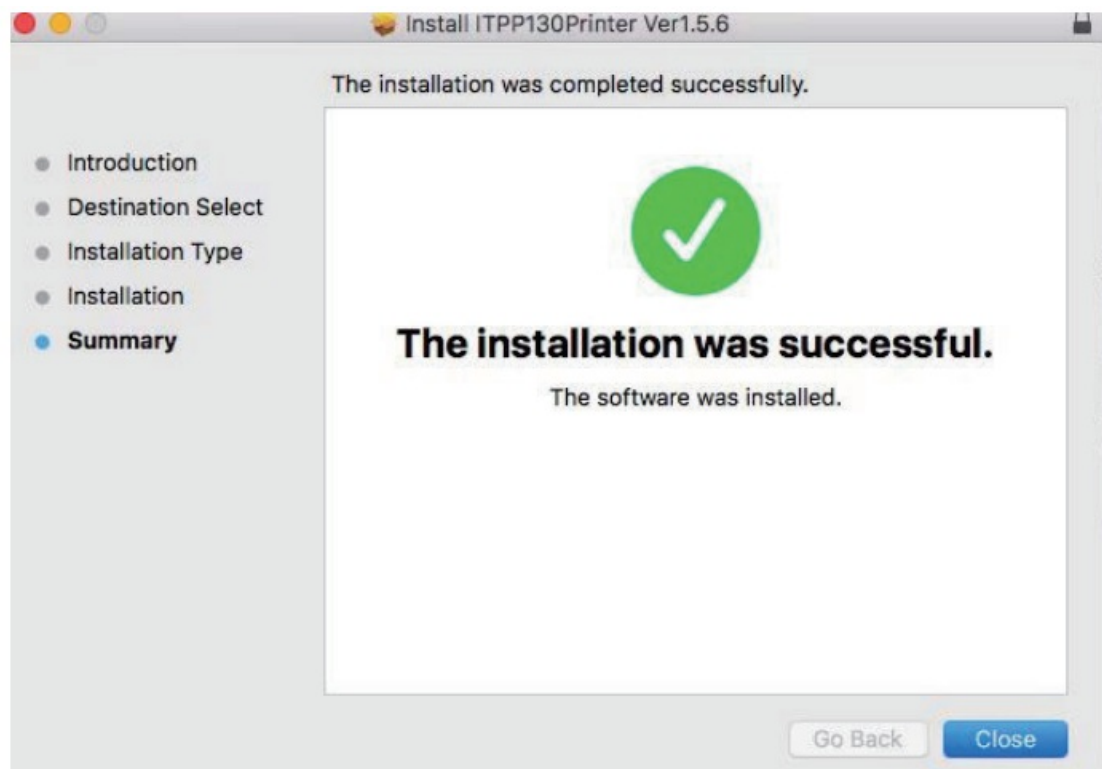
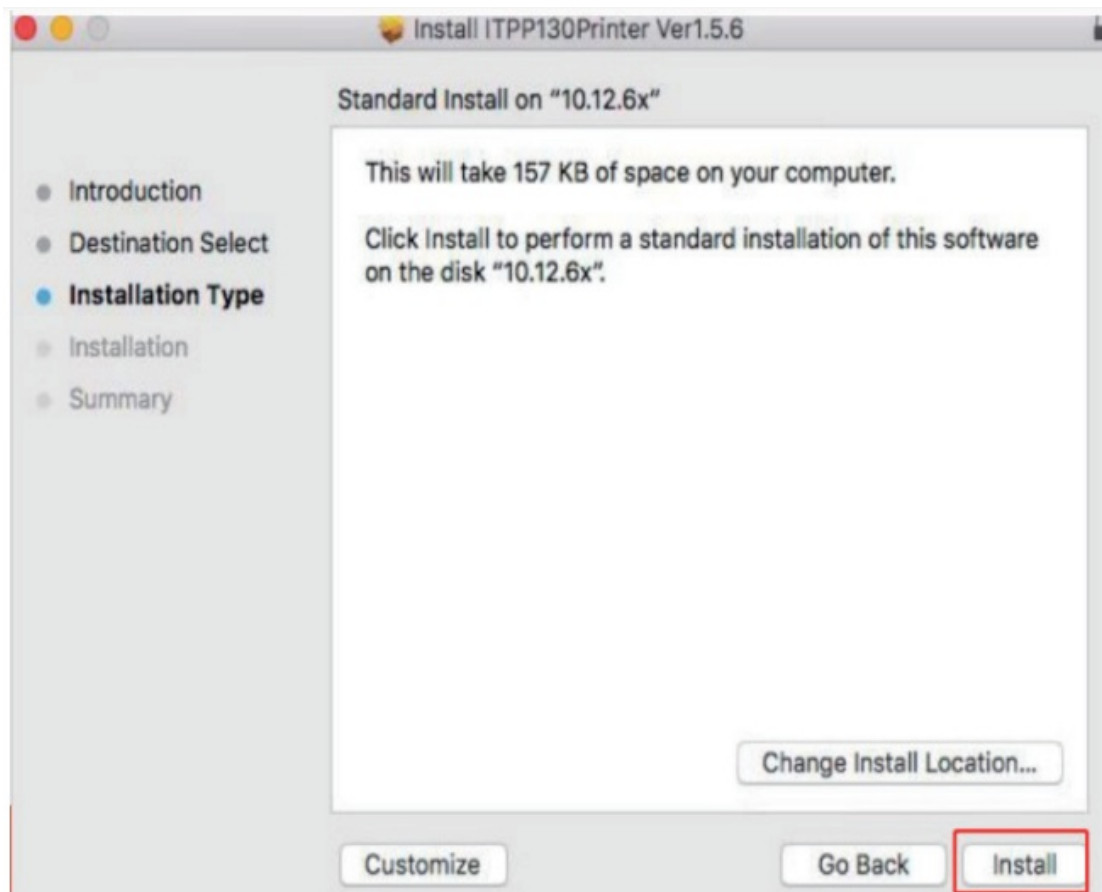

Pro Tips

- Anytime you change your label, run the automatic label identification.
- Press the feeder button on the printer to skip a blank label.
- To run a self-test, press and hold the feeder button until you hear two short beeps.
- To ensure your printing quality, please use MUNBYN labels. If you use other brands' label paper, please run "automatic label identification" before printing.

- Regularly clean the printer head.
- If the paper is jammed and the red light flashes, run Automatic label identification. Insert Munbyn into the same USB port on your computer every time.
- This will avoid creating duplicate copies of the printer in your operating system.

FAQ

FAQ file, please visit: <https://munbyn.biz/130B-FAQ>

LED Status

Light	Description	Troubleshoot
Blue	Normal operation	
Green	Bluetooth connected	
Flashing Red (every 2 seconds)	Label paper is not identified	Run automatic label identification
Flashing Red (every 1 second)	Cover is not closed	Check that the cover is completely closed
Flashing Blue and Red	Printer head is overheated	Printer will automatically resume once the printer head has cooled down

Feeder Button Instruction

Printer status	Feeder button	Function
Standby	Press and hold on until you hear one beep	Automatic label identification
Standby	Press and hold on until you hear five beeps	Reset Printer

Specification

Method	Direct Thermal
Resolution	203 dpi
Max Printing Speed	150 mm/s
Paper Width	40-110 mm (1.57-4.3inches)
Paper Thickness	0.06-0.25 mm
Power Adapter	24V / 2.5A
Printing Life	TPH 50Km
Operating Environment	Temperature: 0 to 45 °C Humidity: 10-90% (non condensing)
Storage Environment	Temperature: -10 to 50 °C Humidity: 10-80% (non condensing)
Connection	Bluetooth / USB
Weight	1.76 lbs/0.8kg
Dimensions	182x99x87mm(L*W*H)

Safety Notices

- The printer head can become very hot after printing labels. Do not touch the printer head.
- Do not bend the power cord excessively or place objects on the cord.
- Do not use the printer if you find any irregularities as these could result in fire or electrocution.
- Keep the printer out of reach of children.
- Use only approved accessories and do not try to disassemble, repair the unit by yourself.
- Keep the printer away from water and other objects that could penetrate the components.
- Please unplug the printer when it is not in use for long periods.

FCC Statement

Changes or modifications not expressly approved by the party responsible for compliance could void the user's authority to operate the equipment. This equipment has been tested and found to comply with the limits for a Class B digital device pursuant to Part 15 of the FCC Rules. These limits are designed to provide reasonable protection against harmful interference in a residential installation. This equipment generates uses and can radiate radio frequency energy and, if not installed and used in accordance with the instructions, may cause harmful interference to radio communications. However, there is no guarantee that interference will not occur in a particular installation. If this equipment does cause harmful interference to radio or television reception, which can be determined by turning the equipment Off and on, the user is encouraged to try to correct the interference by one or more of the following measures:

- Reorient or relocate the receiving antenna.
- Increase the separation between the equipment and receiver.
- Connect the equipment into an outlet on a circuit different from that to which the receiver is connected.
- Consult the dealer or an experienced radio/TV technician for help. This device complies with part 15 of the FCC rules. Operation is subject to the following two

Tech Support

E-mail: support@munbyn.com

Whatsapp: +861335 295 0490

Phone: +1 650 206 2250

Skype: munbyn Support Time: Monday to Friday 24 hours.

Support Time: Monday to Friday 24 hours. MUNBYN provides 24 months warranty and lifetime free service. If you encounter any issues with the product, please contact the MUNBYN team to promptly receive troubleshooting tips or a replacement.



You can access the link below or scan the QR code to download user manuals in other languages.



Other Languages: munbyn.biz/130bminorlang

Documents / Resources

	MUNBYN ITPP130B Bluetooth Label Printer [pdf] User Manual ITPP130B Bluetooth Label Printer, ITPP130B, Bluetooth Label Printer, Label Printer, Printer
---	--

References

- [ITPP130B - pCloud](#)
- [ITPP130B Label Printer Frequently Asked Questions.pdf - pCloud](#)
- [130B-Driver.zip - pCloud](#)
- [User Manual](#)

This website is an independent publication and is neither affiliated with nor endorsed by any of the trademark owners. The "Bluetooth®" word mark and logos are registered trademarks owned by Bluetooth SIG, Inc. The "Wi-Fi®" word mark and logos are registered trademarks owned by the Wi-Fi Alliance. Any use of these marks on this website does not imply any affiliation with or endorsement.