



MTI BASICS MBLX6636 Tubs Instructions

[Home](#) » [MTI BASICS](#) » MTI BASICS MBLX6636 Tubs Instructions 



**BASICS MBLX6636 Tubs
Instruction Manual**



MTI BASICS® Tubs
MBLX6636
66.5" x 36" x 23.5"

Contents

1 GENERAL SPECIFICATIONS:

2 IMPORTANT ORDERING & INSTALLATION INFORMATION:

3 Documents / Resources

4 Related Posts

GENERAL SPECIFICATIONS:

Installation: Freestanding

Material: Acrylic

Soaker Weight: 125 lbs / 57 kg

Maximum Fill: 80 gal to overflow

NOTE: Filling this tub to the maximum may require an above average size or dedicated water heater.

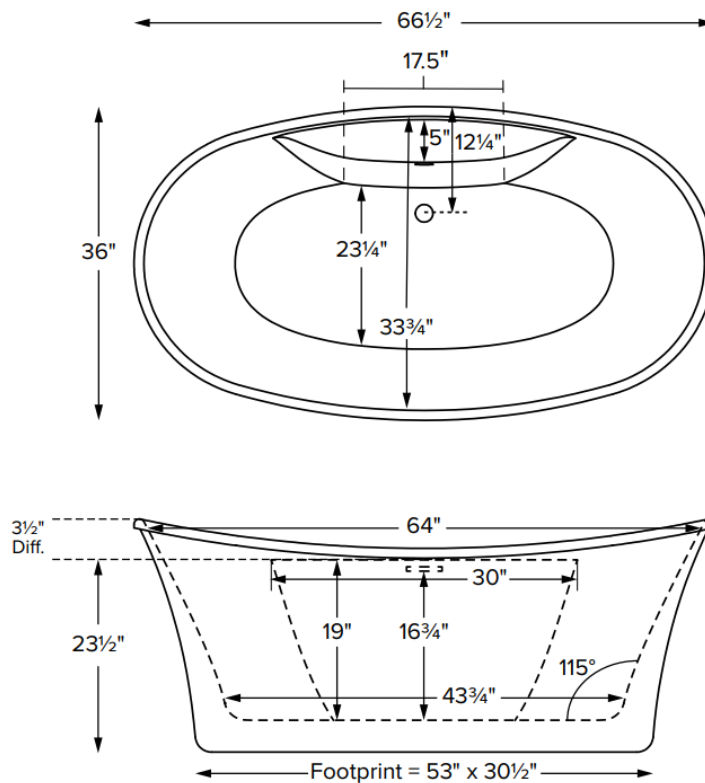

IMPORTANT ORDERING & INSTALLATION INFORMATION:

- This tub model includes an access panel as a standard feature for drain, optional Virtual Spout, and on select models, valve set installation.
- Access panel is visibly located behind the waste and overflow. Please consider access panel visibility before ordering and when planning final installation position.



- This tub cannot be ordered without an access panel.

- Access panel dimensions vary according to tub model and design. Tubs featuring an integrated faucet deck for valve installation will have a larger opening and panel size for easier installation.
- The Virtual Spout is installed below the water level of the tub. MTI supplies a Wilkins dual check valve and an Acme in-wall atmospheric vent to prevent backsiphonage. However, some areas of the country require additional backflow prevention when water is introduced to the bath below the water level. Please check local codes.
- Options listed cannot be combined with Designer Collection options.
- Before discarding tub crate, check for accessories that may be packaged inside.
- All product measurements are +1/2".
- Specifications and configurations are subject to change without notice.
- Measurements herein supersede all others published prior to publication date below.

PACKAGE	PACKAGE CONTENTS	PART #
Soaker	Soaking bath – No jets. Includes pre-leveled foam base and white integrated slotted overflow with matching toe tap drain.	MBSLX6636
Soaker With Virtual Spout	Soaking bath – No jets. Includes Virtual Spout integrated high-flow tub filler (see important ordering information), pre-leveled foam base and white integrated slotted overflow with matching toe tap drain.	MBSLX6636VS

OPTIONS (Must be ordered at time of purchase)

Standard White (no charge)

Quick Ship/Priority

Soaker (QSHIPMTIS)

ACCESSORIES.

Pillows

Soft Pillow

White (MBPSW) Black (MBPSB)

Roll-Up Pillow

Light Aqua (MBPRUC) Black (MBRUB)

CSA # MTIS-LX6636

©2021 by MTI Baths, Inc. Modification Rights Reserved

Documents / Resources

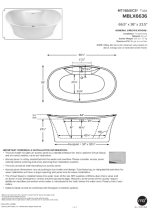
	<p>MTI BASICS MBLX6636 Tubs [pdf] Instructions MBLX6636 Tubs, MBLX6636, Tubs</p>
---	---