



MT HELMETS MT-FF110B Solid A1 Gloss Black User Guide

[Home](#) » [MT Helmets](#) » MT HELMETS MT-FF110B Solid A1 Gloss Black User Guide 



REVENGE 2 S
USER GUIDE
MT-FF110B
+ mthelmets.com

Contents

- [1 MT-FF110B Solid A1 Gloss Black](#)
- [2 Product Details](#)
- [3 Safety](#)
- [4 Ventilations & Shield/Visor](#)
- [5 “UCS”](#)
- [6 Maintenance & Warranty](#)
- [7 Documents / Resources](#)
 - [7.1 References](#)

MT-FF110B Solid A1 Gloss Black

REVENGE 2 S

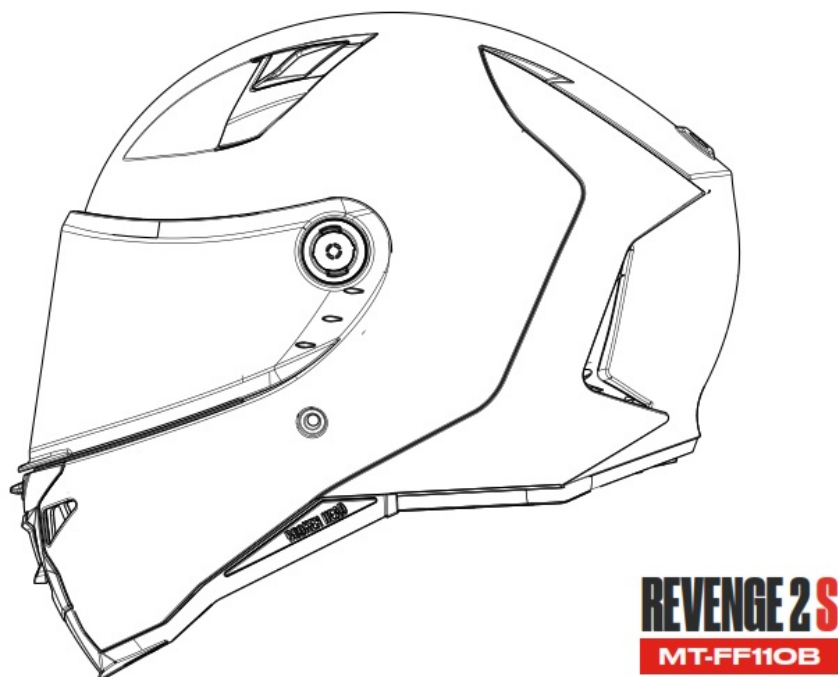

Shells

Developed by MT HELMETS based on the revolutionary new HIRP technology. Two shell sizes to optimize weight, fit and comfort.

Ventilation system

The helmet features four air intakes located at the front, which enable the influx of cool air, while the rear spoiler allows excellent evacuation of hot air.

MT-V-14B Shield

The pivoting mechanism system of the MT-V-14B shield guarantees a uniform seal all around and allows the screen to be replaced quickly and easily with just one hand.

Liner

The interior padding is not only made of hypoallergenic fabric that is removable and washable, but it also keeps you cool and dry in spring/summer and warm in cooler temperatures.

Deflector

The deflector prevents circulating air from entering the helmet. It also helps to further reduce road noise inside the helmet.

IMPORTANT

 For your safety, it is important that you read the entire user's manual and its warnings.

Product Details

Introduction

Congratulations on your choice of a model made by MT HELMETS. This helmet combines the latest technology, engineering and design available today and is an excellent investment for your comfort and protection. Although wearing a helmet has been proven

to significantly reduce the risk of injury or harm, please remember that no helmet can protect you from all possible or potential impacts, even if it is made with state-of-the-art materials and technology. The following information will assist you in the enjoyment and proper maintenance of your helmet.

Sustainability

At MT HELMETS, we are committed to creating helmets that are as environmentally friendly as possible. For this reason, helmet parts can be easily replaced, thus extending their life.

Purpose

The main function of a helmet is to protect your head from impact in the event of an accident. To achieve this, the helmet encapsulates your head with materials designed to absorb and mitigate the force of impact. Additionally, it is engineered to offer comfort while riding at a given speed and in a variety of weather conditions. However, there is a downside to every helmet: it decreases your hearing sensitivity, peripheral vision and mobility to some extent, while providing protection and comfort.

Fit

For maximum safety, it is vital that your MT HELMETS helmet fits properly on your head, with the retention strap correctly and securely fastened. Keep your chin firmly in place, grasp the back of the helmet with both hands and try to roll the helmet forward. If you can move the helmet towards your eyes, the size is not correct, so try a smaller one.

Shield/Visor

MT helmet shields provide protection against the weather, small flying objects and wind.

Tinted visors are available to protect your eyes from excessive sunlight. Additionally, the helmet's internal sun visor allows for an immediate adjustment of light intensity.

 **Caution!** Never use a smoked or darkened shield/visor in low-visibility riding. Not only is it unsafe, it is also illegal in many countries.

Never use a shield/visor that is scratched or wet with condensation. MT Helmets shields are supplied with an anti-scratch treatment.

Ventilation System

Ventilation systems are designed and engineered to maximize your comfort in a wide range of temperatures. Explore the air vents on your helmet. Some vents have multiple positions, allowing partial opening and partial closing, thus controlling airflow in and out.

Helmet ventilation systems should be kept in good condition, and free of dirt, insects or other items that may interfere with proper airflow. Good airflow plays an important role, especially during physical effort or in hot weather. Optimum ventilation also helps reduce the possibility of fogging up the visor.

 **Caution!** The aeroacoustic values may vary depending on the type of motorcycle, clothing, position and size of the body.

Retention System

Once the chinstrap is opened, you need to take both sections of the strap and keep them slightly separated in order to facilitate the passage of your head. When performing this movement, it is recommended to keep the two sections of the strap away from your thumbs so that they are properly positioned.

Position the parts that make up the retention system and secure them according to the appropriate recommendations for each the helmet. Check that the tension, and therefore the positioning of the helmet, is correct.

How to take off your helmet

Release the retention chinstrap, hold the two sections slightly apart as explained in the previous paragraph and remove the helmet.

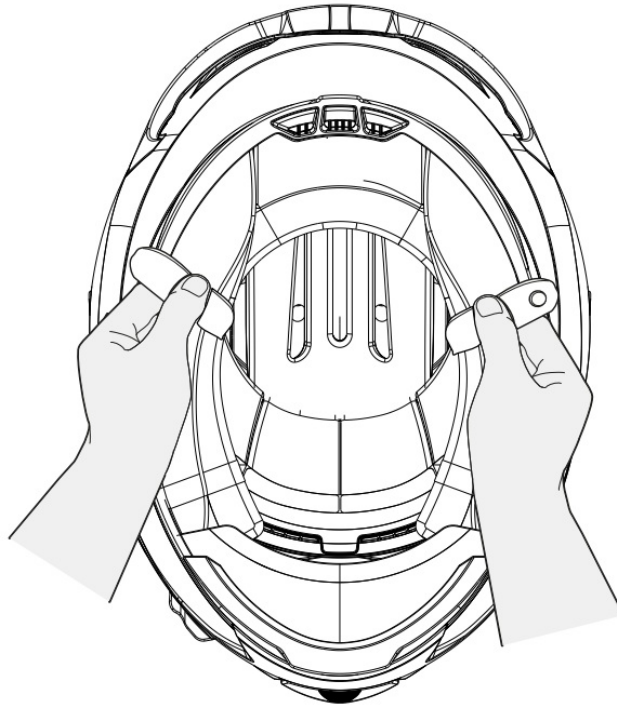

How to adjust the micrometric closure system

The micrometric closure allows for easy and precise adjustment of the chinstrap length.

1. Pass the end of the strap into the micrometric mechanism.
2. Drag the strap until it is snug and firmly positioned on the chin.

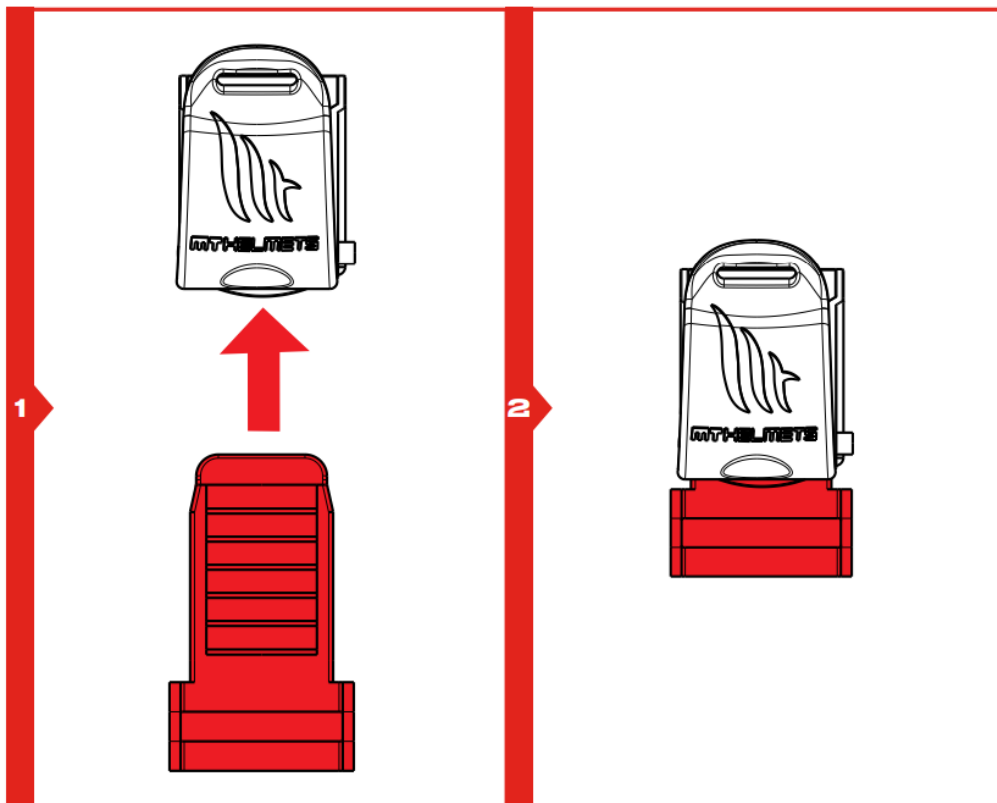

Warning. Do not wear the helmet without securing and adjusting the chinstrap beforehand, as this can affect its ability to function correctly.

Safety

Removing the side pads

There are 3 snaps that hold the side pads in place.

1. Gently lift the side pad away from the shell in order to release the snaps.
2. Grasp the side pad from its centre and gently pull on the chinstrap.

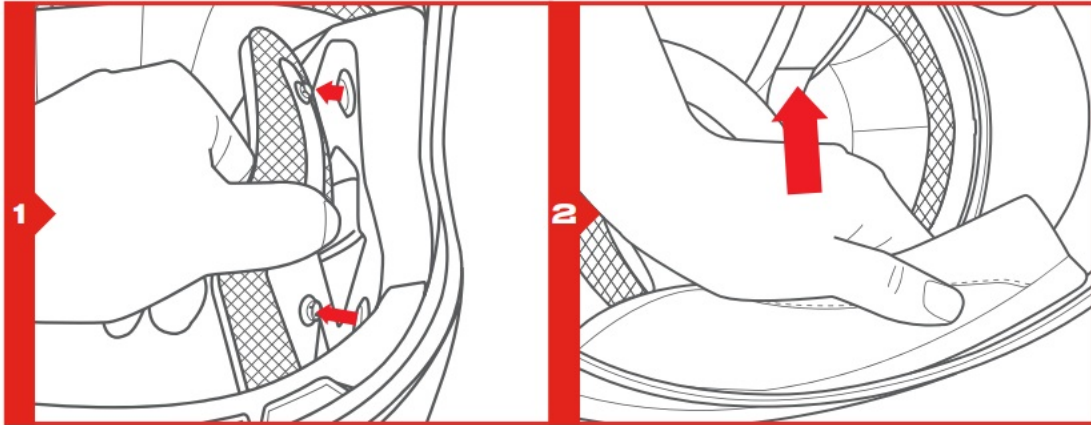

Liner Removal

1. Pull on the rear part of the liner until the two snaps holding it are released.
2. Pull the front part of the liner until the tabs are completely separated from the shell.

Once both steps are completed, the liner will be completely detached from the helmet.

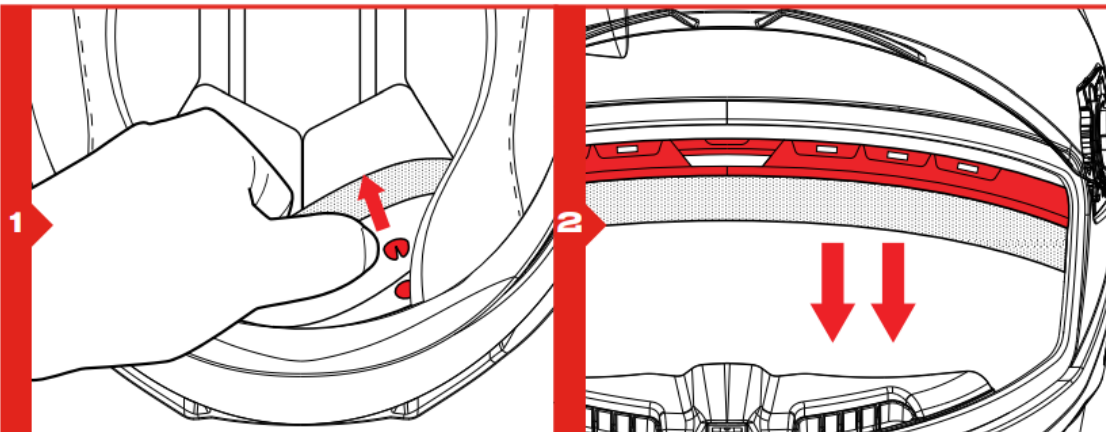

Chin Guard Removal

Pull on the chin guard protector until the flap is released from its slot.

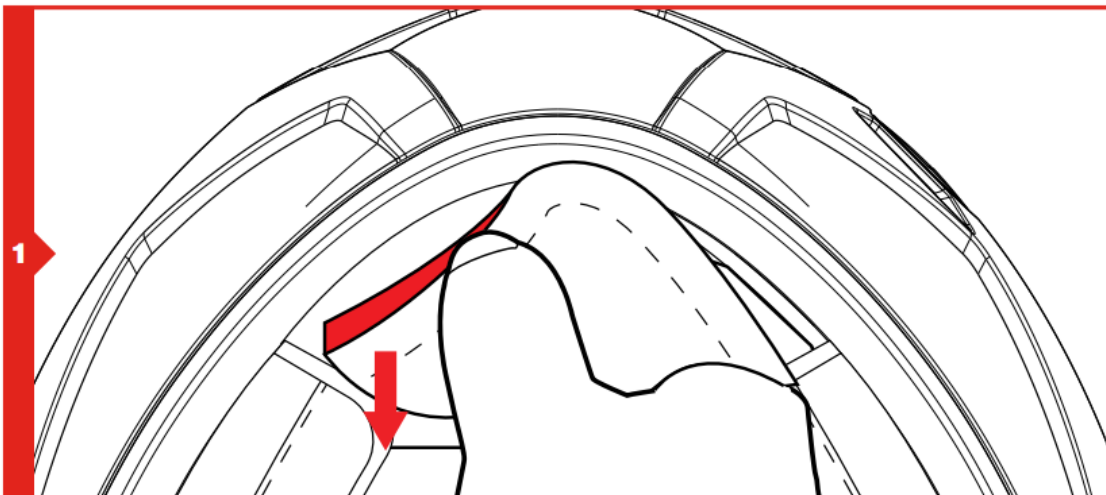

Installing the side pads

1. Pass the strap through the opening of the pad at cheek level.
2. Align and slide the plastic cheek pad plate into place between the shell and the EPS. Attach the 3 male snaps

of the side pad to the 3 female snaps on the inside of the shell and press them together.

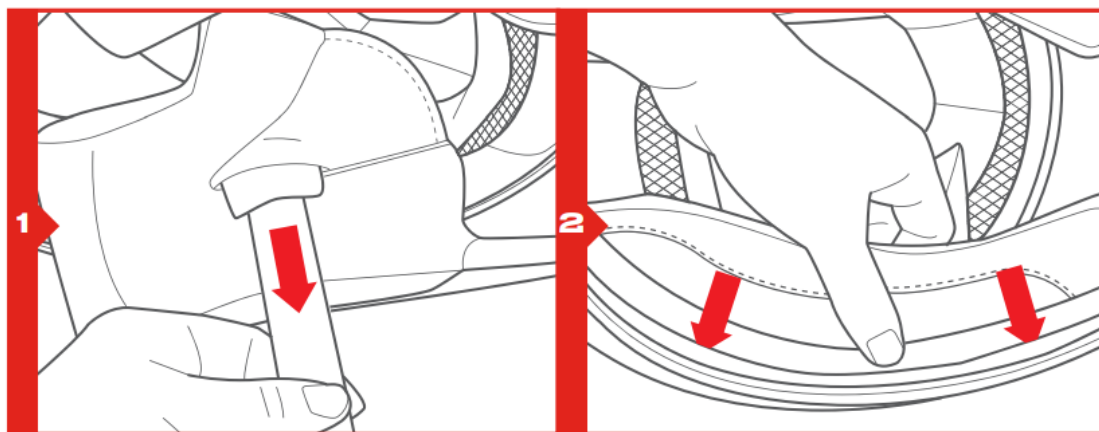

Operation of the front air inlets

1. To activate direct ventilation to the screen, move down the tab marked in red. The vents marked in green are responsible for directing the air towards the exit marked in blue.
2. To deactivate the air intake, move up the activation tab marked in red. Slide down the air intake lock mechanism to activate the incoming airflow.

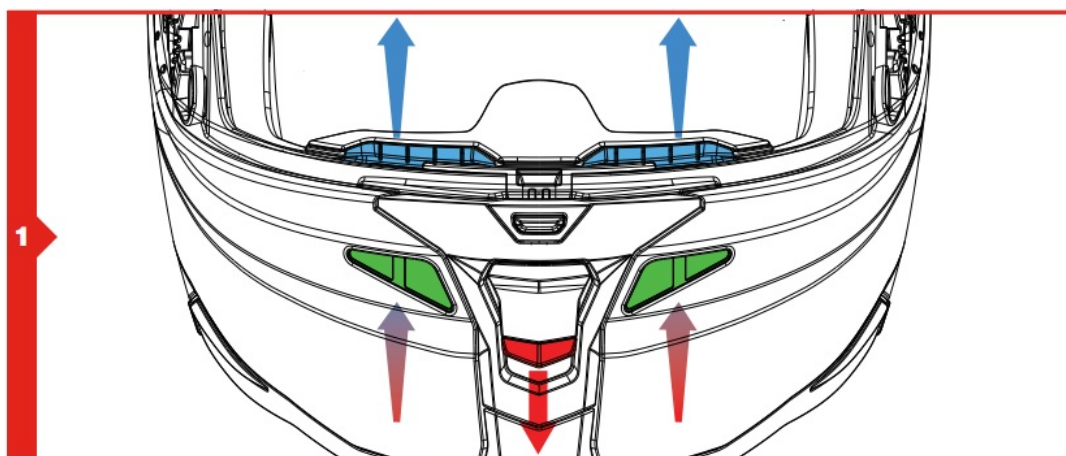

Operation of the front air inlets

1. To activate the direct air intake into the helmet, move down the tab marked in red. The air will enter through the part marked in green. This system is directly related to the screen air intake mechanism, and it can't be activated independently.
2. To deactivate the air intake, move up the activation tab marked in red.

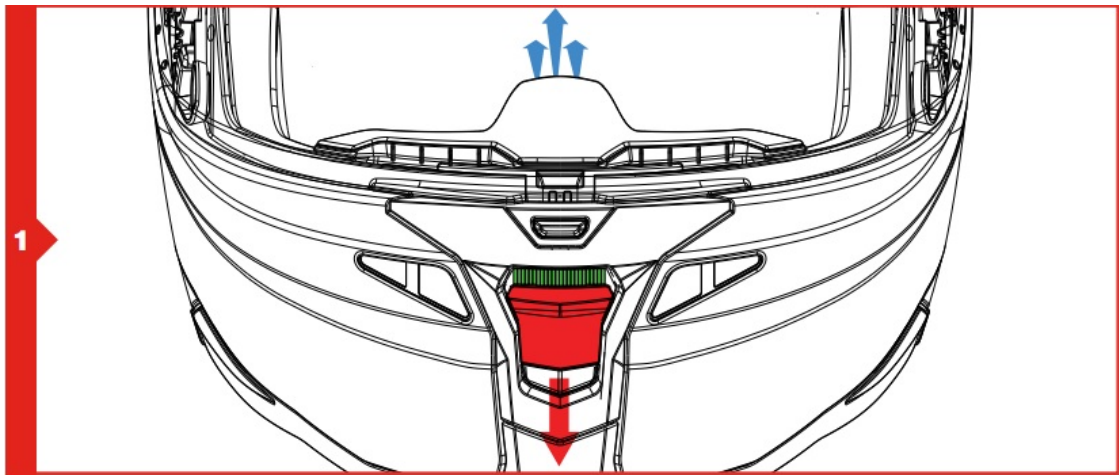

Operation of the upper air inlets

1. Slide backwards the air intake lock mechanism to activate the incoming airflow.
2. Slide it forwards until you hear a click, to deactivate the incoming airflow.

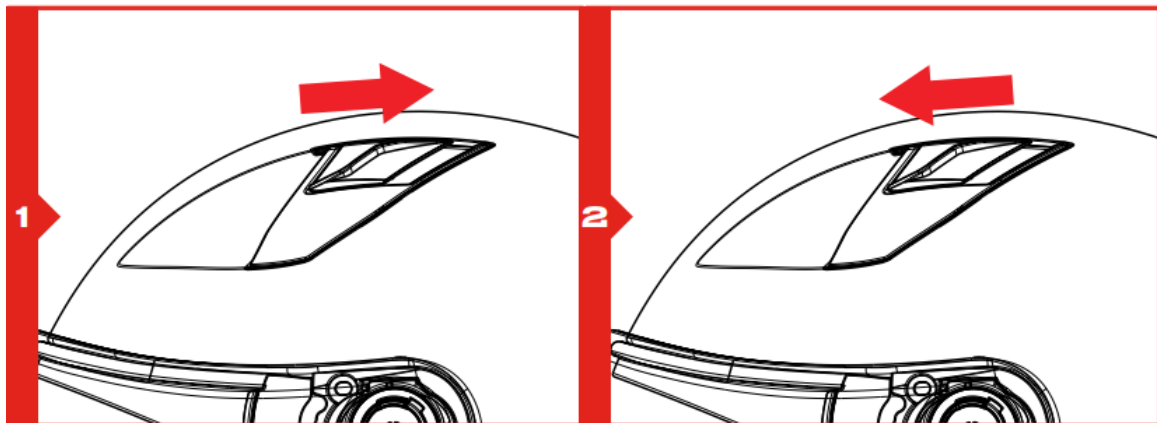

Shield/Visor operation

The shield closes with an optimal airtight seal. This feature is enabled by the front button that locks the screen.

1. Push the front button to release the shield from its sealed position allowing it to be raised.
2. Lower the shield until you hear a click, confirming that it is sealed again.

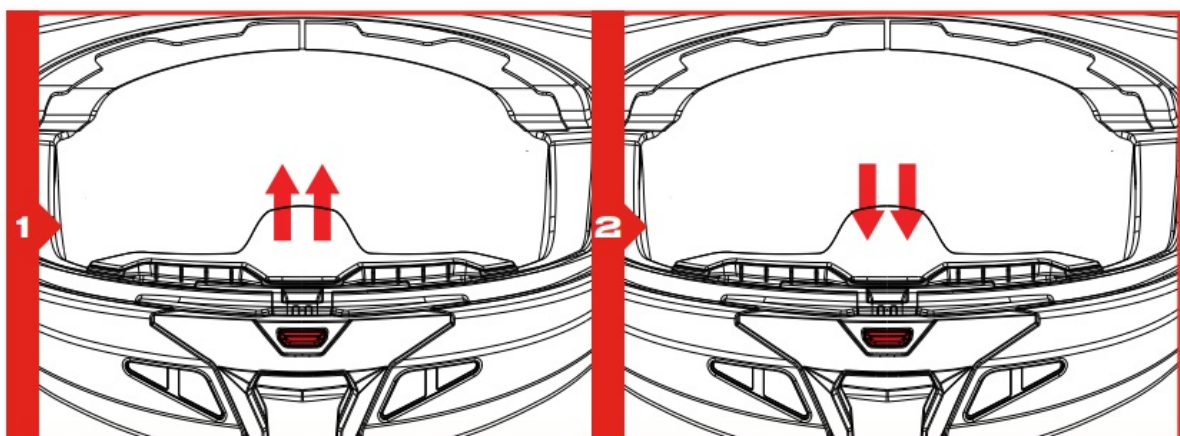

Ventilations & Shield/Visor

Disassembling the Shield/Visor

1. Lift up the shield to its maximum raised position.
2. Press the central button to release the shield.

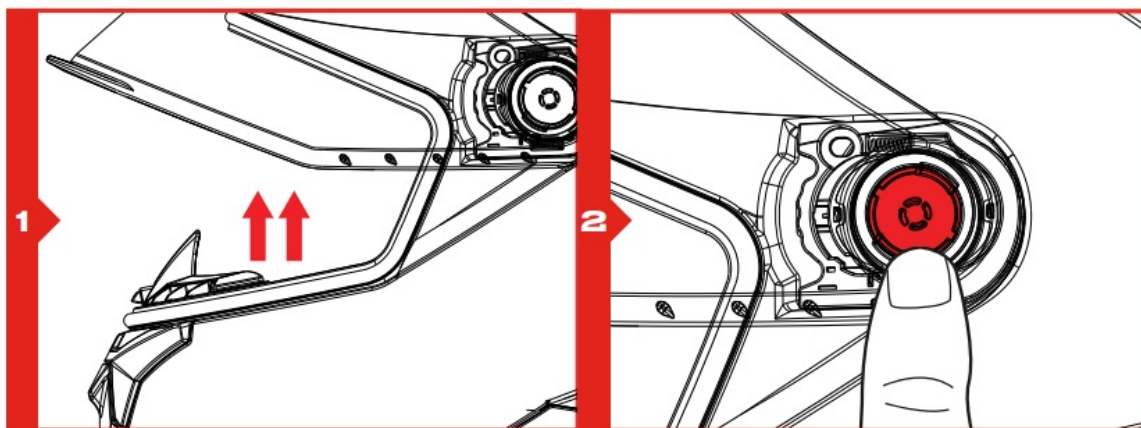

Assembling the Shield/Visor

1. Align the shield with the mounting position.
2. Press the shield on the sides of the button until you hear a click.

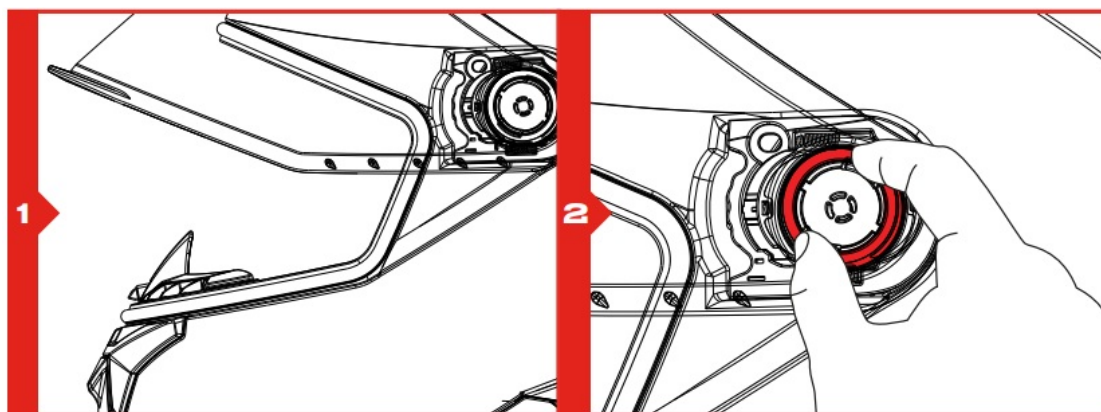

Intercom Housing. Compatible with UCS*

1. Remove the screws from the cover in order to remove it and insert UCS systems into the housing.
2. Once inserted, the screws should be placed back in their original position.

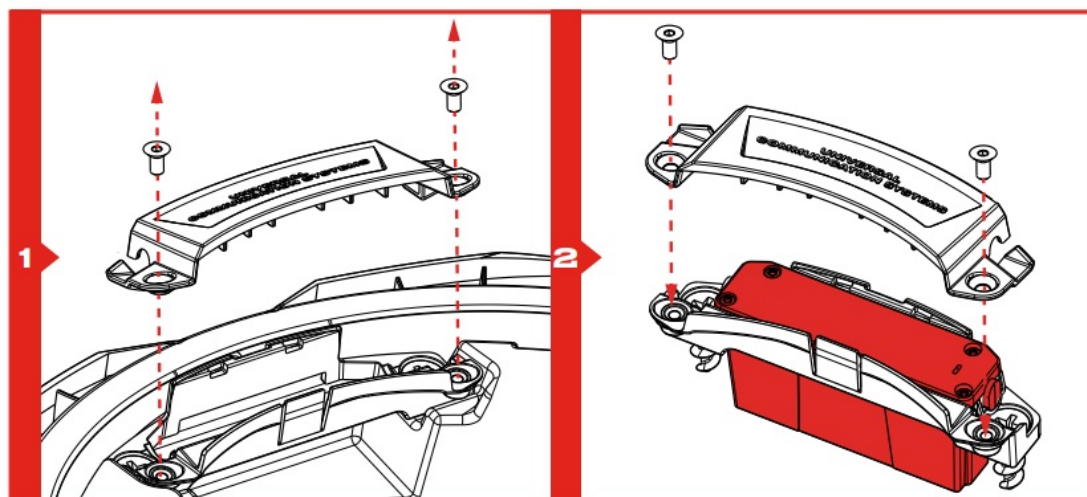

*UCS, Universal Communication System.

“UCS”

Maintenance

No component of your helmet can be damaged by water. Wash it with a mild detergent in lukewarm water and let it air dry. It is recommended to wash by hand. Do not place liner parts in the dryer: excess heat can damage the foam and liners. The shield can be cleaned with mild soap and water. The shell of your helmet should be cleaned with water.

Warnings

Do not ride without first carefully fastening your helmet. Do not clean your helmet with petroleum products, solvents, benzene, thinners or abrasive cleaning products. Do not paint your helmet, otherwise your warranty will be invalidated. Do not drop your helmet from any height onto a hard surface. This may cause damage to the finish of your helmet and/or diminish its protective qualities. Do not place your helmet on the mirror of your motorcycle: the strong pressure from the edge of the mirror compresses and damages the shock absorbing liner of the helmet. Do not place your helmet on the motorcycle seat or fuel tank. It could easily roll off and hit the ground causing irreparable damage. It is best to place the helmet on a flat surface or, failing that, on the ground so that it cannot roll or fall. Do not use your helmet if the shield is scratched. This can affect your vision, especially when riding at night. Do not modify any part of your helmet, drill holes in the shell, or cut or press on the shock absorbing liner. The installation of sound systems, loudspeakers and microphones reduces the ability of your helmet to protect you and is therefore not recommended. Do not reuse your helmet if it has been dropped or involved in an accident. Replace it even if the damage is not visible to the naked eye. Do not wear dark or tinted shields/visors in dark or poor visibility riding conditions. Do not place interiors or pads in the dryer after washing. Allow to air dry. Do not attempt to remove, change or replace the shield while riding your motorcycle. Fluorescent and/or glossy finishes fade over time and with exposure to sunlight. This is normal and is not covered by the warranty.

Maintenance & Warranty

Warranty

If you have a warranty claim, please go to mthelmets.com/warranty



Documents / Resources

	<p>MT HELMETS MT-FF110B Solid A1 Gloss Black [pdf] User Guide MT-FF110B Solid A1 Gloss Black, MT-FF110B, Solid A1 Gloss Black, A1 Gloss Black, Gloss Black, Black</p>
---	---

References

- [User Manual](#)

Manuals+, Privacy Policy

This website is an independent publication and is neither affiliated with nor endorsed by any of the trademark owners. The "Bluetooth®" word mark and logos are registered trademarks owned by Bluetooth SIG, Inc. The "Wi-Fi®" word mark and logos are registered trademarks owned by the Wi-Fi Alliance. Any use of these marks on this website does not imply any affiliation with or endorsement.