

MSI Center Update LED Firmware User Guide

[Home](#) » [MSI](#) » MSI Center Update LED Firmware User Guide 

Contents

- [1 MSI Center Update LED Firmware](#)
- [2 Updating LED firmware with MSI Center](#)
- [3 Updating LED firmware with LED Firmware Tool](#)
- [4 Documents / Resources](#)
 - [4.1 References](#)
- [5 Related Posts](#)



MSI Center Update LED Firmware

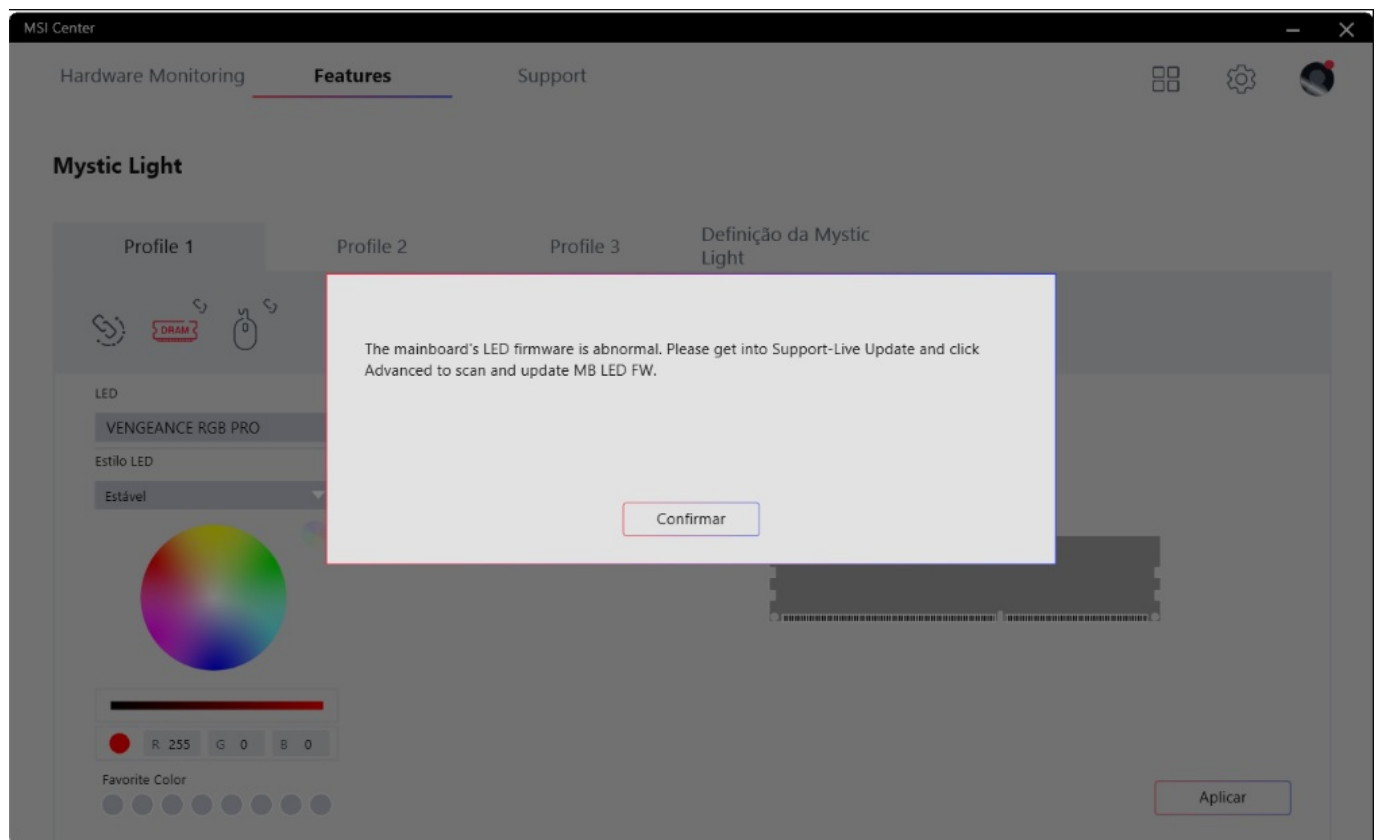

Updating LED firmware with MSI Center

Follow the steps below to update the firmware of LED controller (including heatsink LEDs, JRGBs, JARGB_V2s and the other onboard LEDs) with MSI Center.

Important

If your device is working properly, please do not update the firmware.

1. Shutdown the system and remove all the ARGB cables that connect to JARGB_V2 connectors of the motherboard.

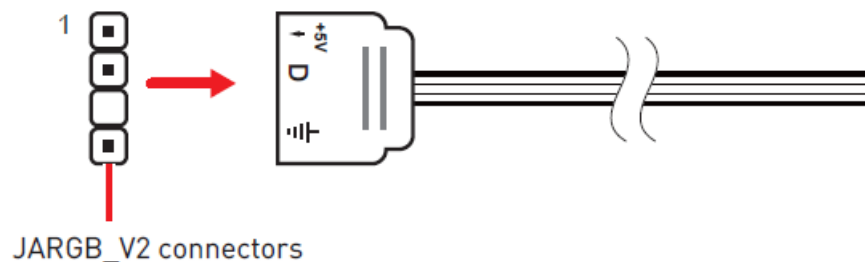

2. Discharge before turning on.
 - A. Flip the power switch to the O position.
 - B. Unplug the power cord from the power supply unit.

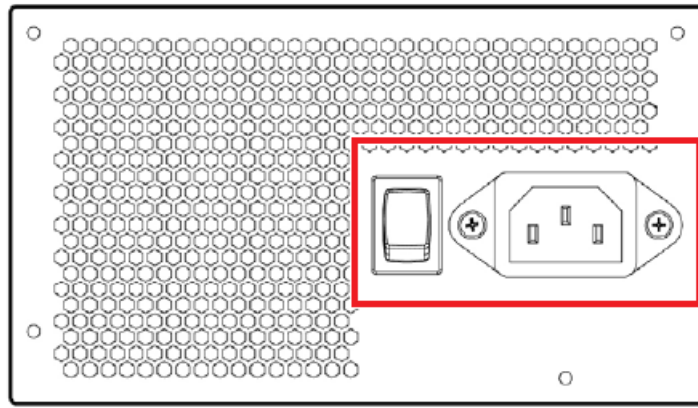

C. Press and hold the CLEAR CMOS button for 3 seconds and wait for 3 minutes, or use a jumper cap to short the JBAT1 pins for 3 minutes and then remove the jumper cap.

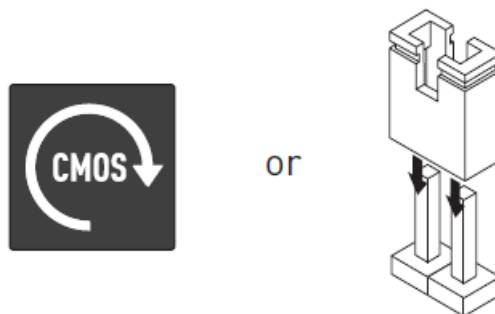

- D. Plug in the power cord and flip the power switch to the I position.
3. Boot into the Windows 10 / Windows 11 operating system.
 4. Download and Install MSI Center from the below link
<https://www.microsoft.com/store/productId/9NVMNJCR03XV>
 5. Close all 3rd party software that will read smbus.(EX : CPUID HWMonitor / AIDA64 / HWiNFO)
 6. Go to MSI Center > Support > Live Update and click Advanced to scan.

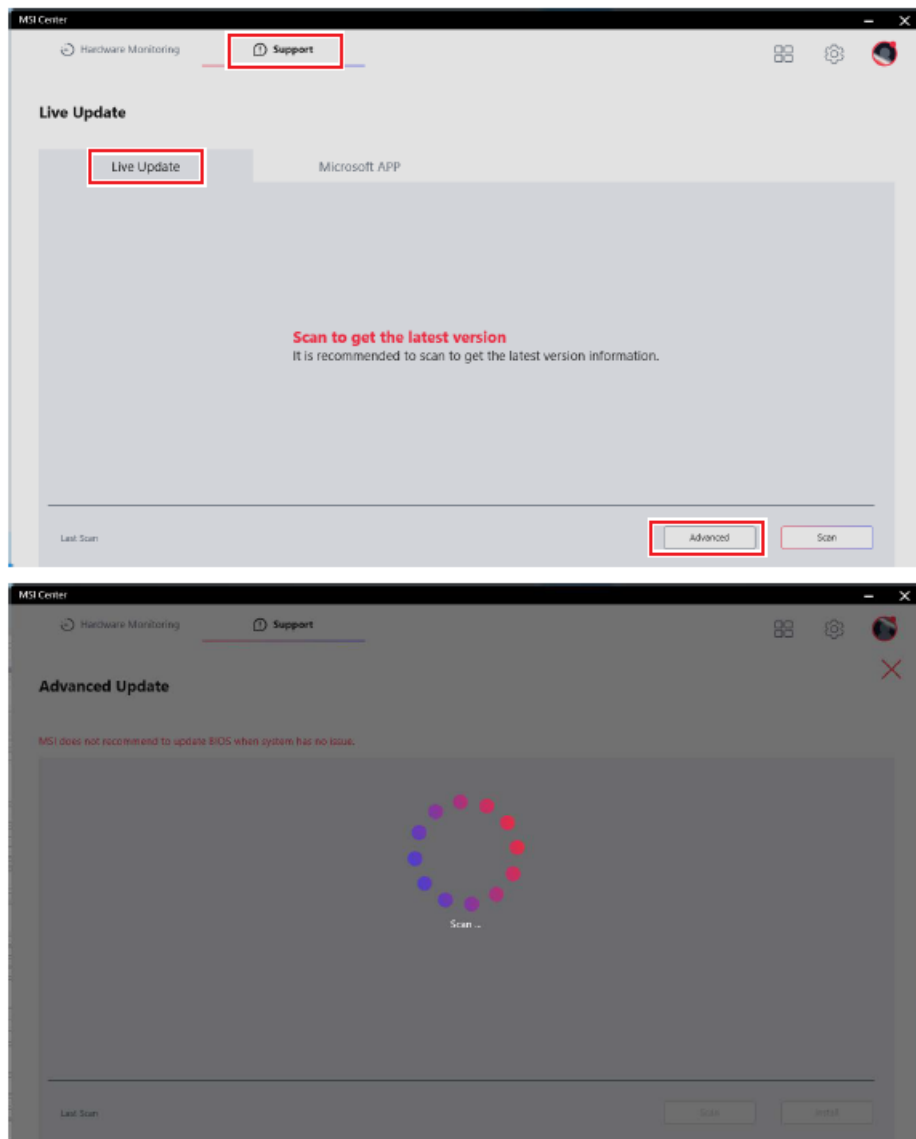

7. After scanning, Live Update will tell whether any update is available, select LED FW Update (XXXX) and press Install to proceed.

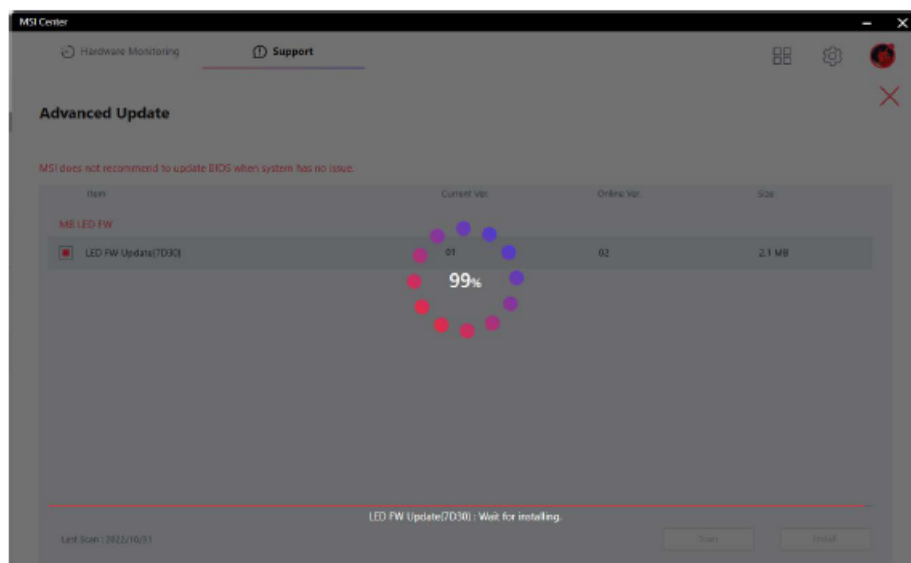
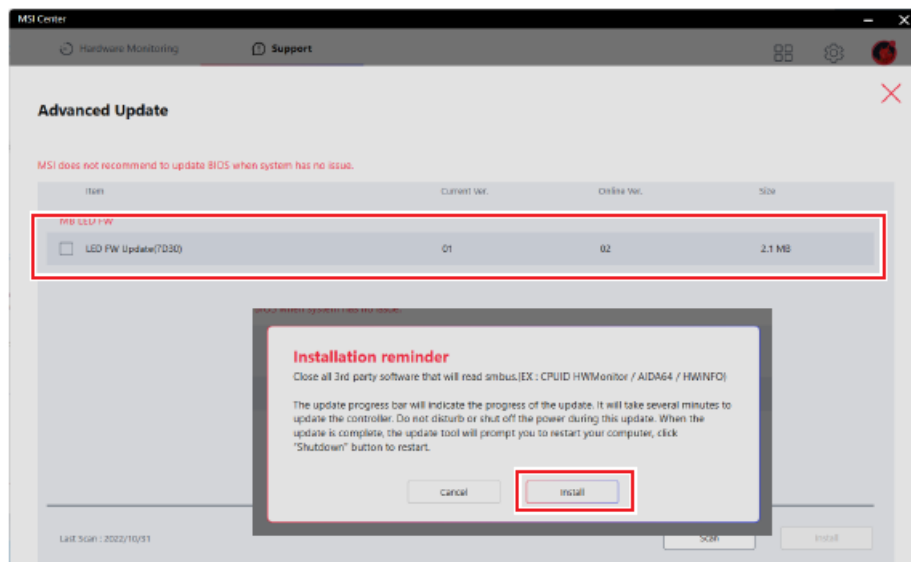

8. Follow the instruction to shut down computer, unplug power cord for 3 minutes.

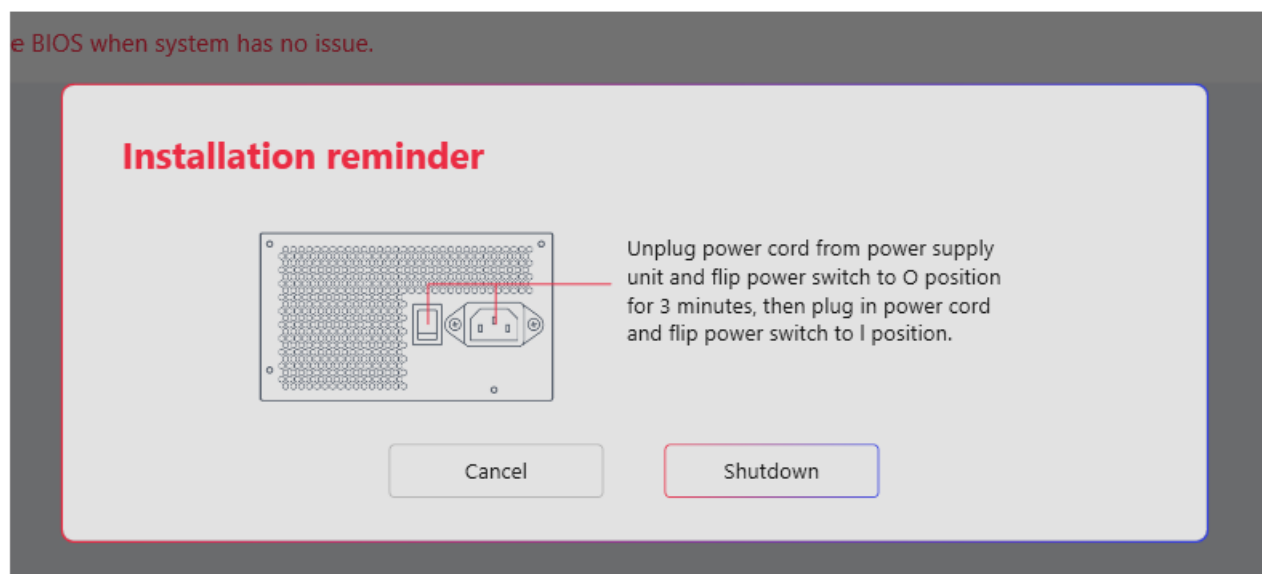

9. Reconnect all ARGB devices and power on.

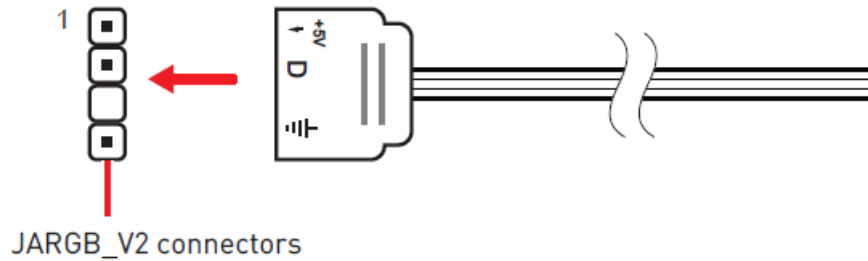

Updating LED firmware with LED Firmware Tool

Follow the steps below to update the firmware of LED controller (including heatsink LEDs, JRGBs, JARGB_V2s and the other onboard LEDs) with LED Firmware Tool.

Important

If your device is working properly, please do not update the firmware.

1. Shutdown the system and remove all the ARGB cables that connect to JARGB_V2 connectors of the motherboard.

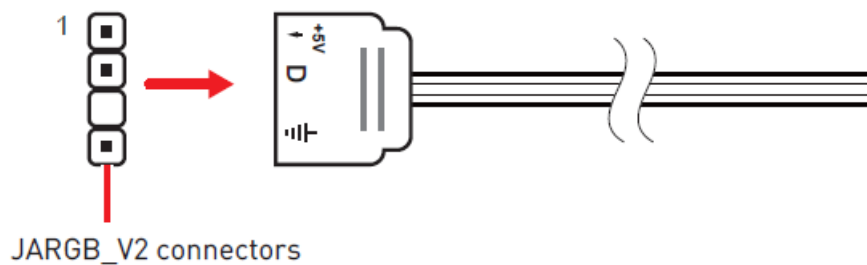

2. Discharge before turning on.
 - A. Flip the power switch to the O position.
 - B. Unplug the power cord from the power supply unit.

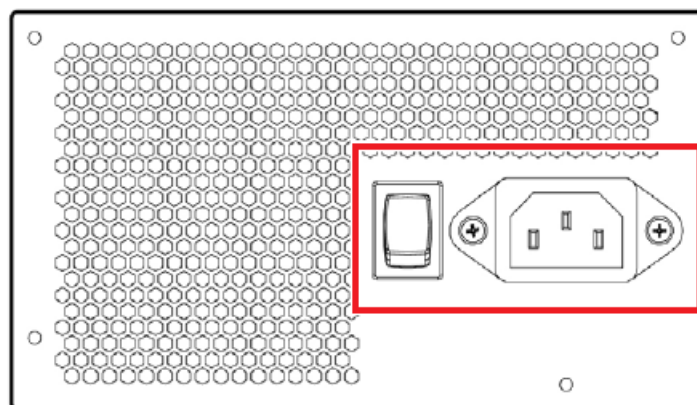

- C. Press and hold the CLEAR CMOS button for 3 seconds and wait for 3 minutes, or use a jumper cap to short the JBAT1 pins for 3 minutes and then remove the jumper cap.



or

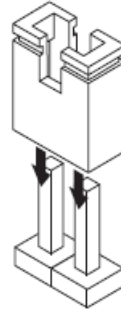

- D. Plug in the power cord and flip the power switch to the I position.
3. Boot into the Windows 10 / Windows 11 operating system.
4. Download LED Firmware Tool from MSI website at <http://msi.com>
5. Close all 3rd party software that will read smbus.(EX : CPUID HWMonitor / AIDA64 / HWiNFO)
6. Unzip file 7xxx_v000x.zip
7. Double-click on MSI_LED_UdapteTool.exe under 7xxx_v000x folder.
8. Click on Update button to update LED controller firmware.
9. The update progress bar will indicate the progress of the update. It will take several minutes to update the controller. Do not disturb or shut off the power during this update. When the update is complete, the update tool will prompt you to restart your computer, click Yes button to restart.

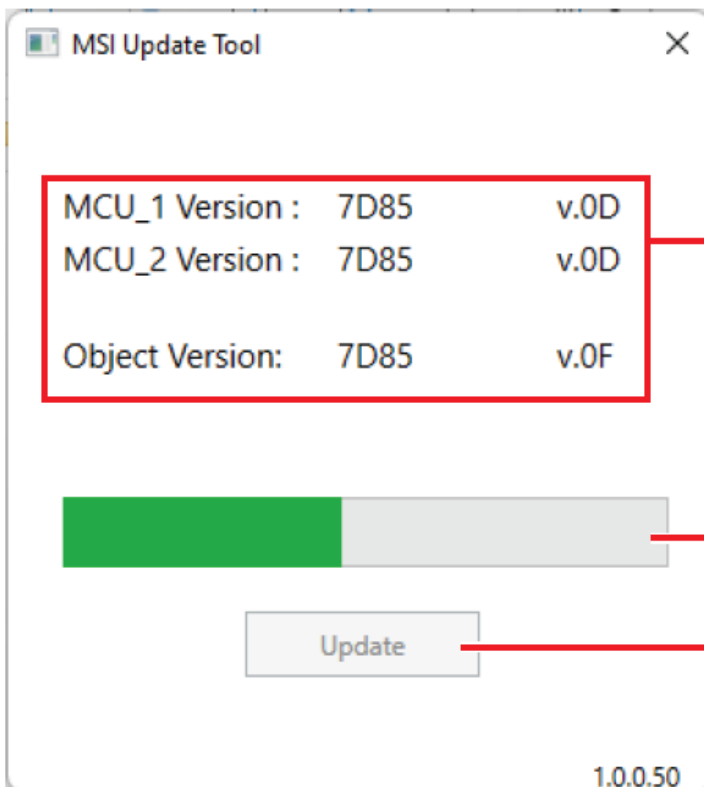

MCU Version: Only need to update when the Object Version is newer than the MCU Version.

Update progress bar

LED FW update button

10. Shutdown the system and reconnect all ARGB devices.

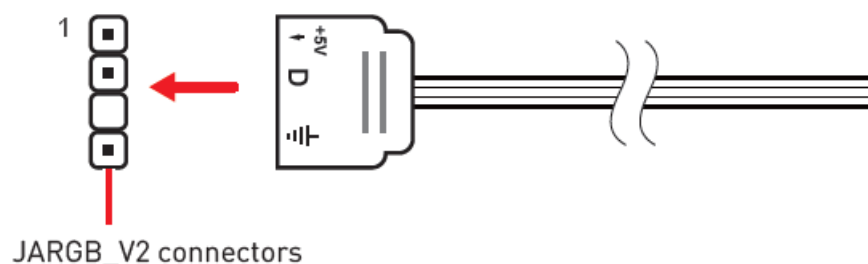

11. Power on the system.

Documents / Resources

 MSI Center Update LED Firmware <small>User Guide Version: 1.0 Copyright © 2019 MSI All rights reserved.</small>	msi MSI Center Update LED Firmware [pdf] User Guide MSI Center Update LED Firmware, Center Update LED Firmware, Update LED Firmware, LED Firmware, MSI Center Update, Center Update
--	--

References

-  [MSI - Redirect](#)
-  [Microsoft Apps](#)