



msi DP10 13M Intel Core i5 1340P Barebone User Guide

[Home](#) » [MSI](#) » msi DP10 13M Intel Core i5 1340P Barebone User Guide 



QUICK GUIDE

Contents

- [1 DP10 13M Intel Core i5 1340P Barebone](#)
- [2 Documents / Resources](#)
 - [2.1 References](#)

DP10 13M Intel Core i5 1340P Barebone

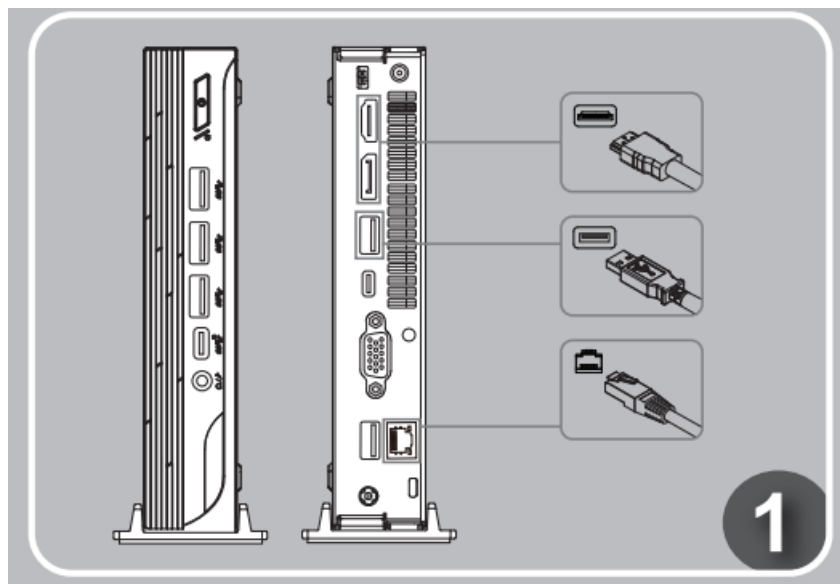

1. Connect the cables of keyboard, mouse, LAN, monitor, etc,

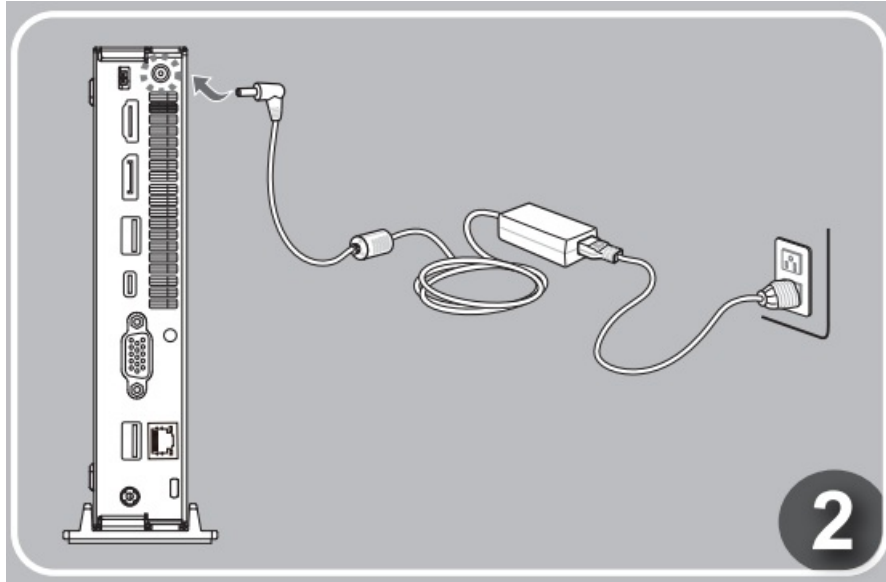

2. Connect the power cord to the system and electrical outlet,

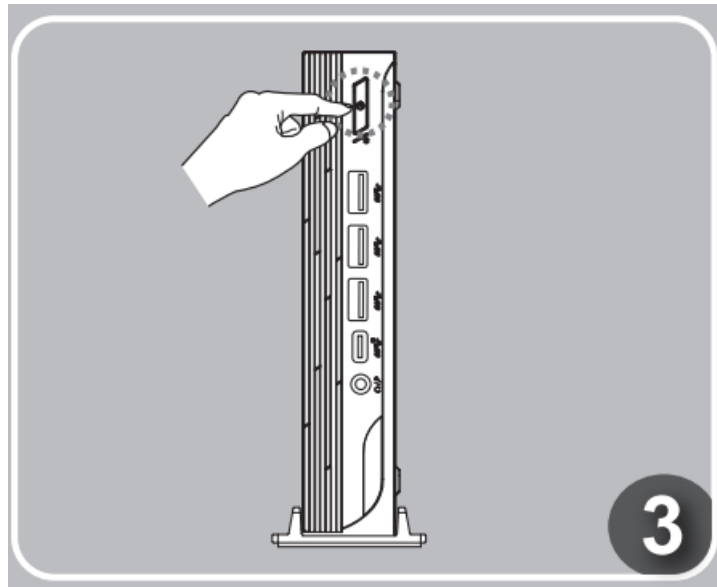

3. Press the power button to power on the system,



* Please make sure the system has been grounded to earth through the AC power cord and the electrical outlet before powering on the system.

* Do not use any sharp objects on the display.

* The illustrations are for reference only.

* The Limited Warranty applies only to Products manufactured by or for MSI. All contents are subject to change without notice. All the trademarks are the property of their respective owners.





* Please refer to the following link or scan the QR code for product warranty registration.

<https://account.msi.com/services/warranty-book>



| | | |
|---|---|---|
|  |  |  |
| http://www.msi.com | https://www.youtube.com/user/MSIGamingGlobal | https://www.facebook.com/msigaming |



| Warranty | MSI Reward Program | MyMSI Membership | Shout out |
|---|---|---|---|
|  |  |  |  |
| https://account.msi.com/services/warranty-book | http://msi.gm/rewards?r=qr | https://www.msi.com/re-direct/app/MyMSI | http://msi.gm/shoutoutcolorbox |
| Please scan the QR code for product warranty registration | Join MSI Reward Program Now | Download MyMSI Membership App | Shout out for MSI |

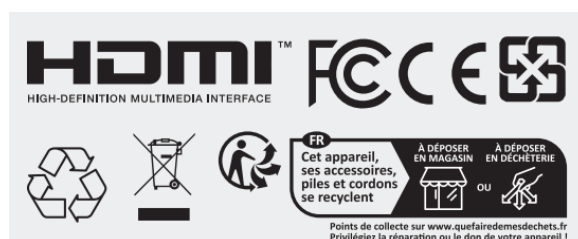

Documents / Resources

| | |
|---|--|
|  | <p>msi DP10 13M Intel Core i5 1340P Barebone [pdf] User Guide</p> <p>DP10, DP10 13M Intel Core i5 1340P Barebone, 13M Intel Core i5 1340P Barebone, Intel Core i5 1340P Barebone, Core i5 1340P Barebone, 1340P Barebone, Barebone</p> |
|---|--|

References

- [User Manual](#)