



MRCOOL RG57A6 Remote Control Air Conditioner User Manual

[Home](#) » [MrCOOL](#) » MRCOOL RG57A6 Remote Control Air Conditioner User Manual 

Contents

- 1 MRCOOL RG57A6 Remote Control Air Conditioner
- 2 Remote Control Specifications & Quick Start Guide
- 3 Handling the Remote Controller
 - 3.1 Inserting and Replacing Batteries
- 4 Buttons and Functions
- 5 Remote Screen Indicators
- 6 How to Use Basic Functions
- 7 Setting the Timer
- 8 How To Use Advanced Functions
- 9 DIY® E-Star™ Remote Controller
 - 9.1 Buttons and Functions
- 10 Remote Screen Indicators
- 11 How to Use Basic Functions
- 12 Setting the Timer
- 13 How to Use Advanced Functions
- 14 Documents / Resources
 - 14.1 References
- 15 Related Posts



MRCOOL RG57A6 Remote Control Air Conditioner



Remote Control Specifications & Quick Start Guide

Model	DIY® E-Star™: RG10A4(D1)/BGEFU1 Easy Pro™: RG10A (DS2)/BGEFU1
Rated Voltage	3.0V (Dry Batteries R03/LR03 x 2)
Signal Receiving Range	26.25 ft. (8m)
Operational Temperature Range	23°F ~ 140°F (-5°C ~ 60°C)

Quick Start Guide

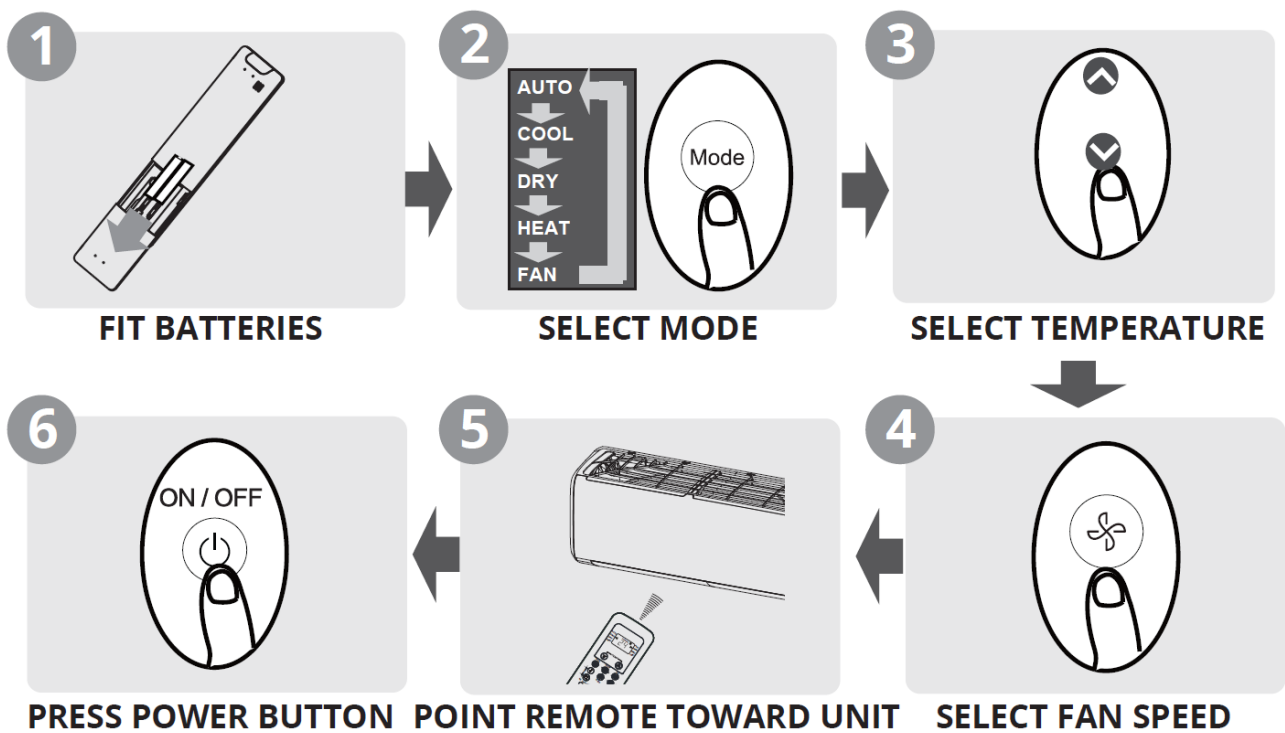

NOT SURE WHAT A FUNCTION DOES?

Refer to the How to Use Basic Functions and How to Use Advanced Functions sections of this manual for more detailed instructions of how to operate the unit.

SPECIAL NOTE

- Button designs on your remote may differ slightly from the example shown.
If the indoor unit is not equipped with a particular function, but your remote controller has a button for it, pressing that function's button on the remote control will have no effect.
- When there are differences between the "Remote Controller Manual" and the "USER'S MANUAL" when it comes to function description, the description of "USER'S MANUAL" should take precedence.

Handling the Remote Controller

Inserting and Replacing Batteries

Your air conditioning unit may come with two batteries (some units). Install the batteries in the remote control before use by following the steps below:

1. Slide the back cover from the remote control downward to expose the battery compartment.
2. Insert the batteries, making sure to match the (+) and (-) designations on the end of the batteries with the symbols inside the battery compartment.
3. Reinstall the back cover by sliding it back into place.

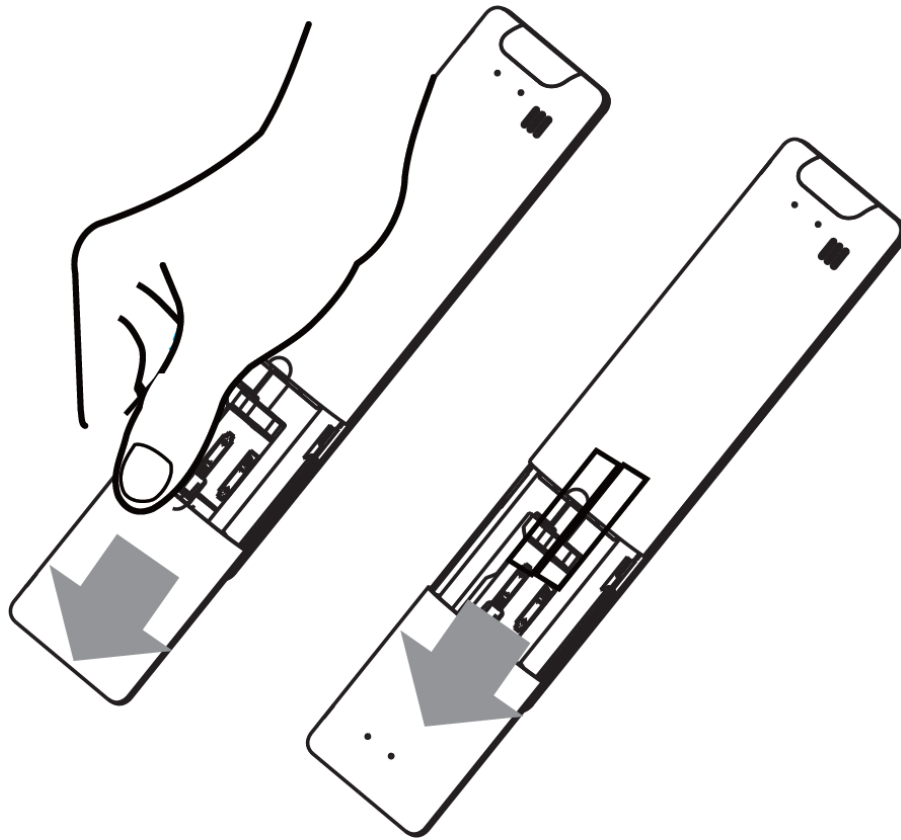

BATTERY NOTES

For optimum product performance:

- Do not mix old and new batteries, or batteries of different types.
- Do not leave batteries in the remote control if the device will not be used for more than 2 months.

BATTERY DISPOSAL

DO NOT dispose of batteries as unsorted municipal waste. Refer to local laws for proper disposal of batteries.

TIPS FOR USING REMOTE CONTROL

- The remote control must be used within 26 ft (8 m) of the unit.
- The unit will beep when remote signal is received.
- Curtains, other materials and direct sunlight can interfere with the infrared signal receiver. Remove batteries if the remote will not be used more than 2 months.

NOTES FOR USING REMOTE CONTROL

The device should comply with the local national regulations.

- In Canada, it should comply with CAN ICES-3(B)/NMB-3(B).
- In the USA, this device complies with part 15 of the FCC Rules. Operation is subject to the following two conditions:
 1. This device may not cause harmful interference, and
 2. this device must accept any interference received, including interference that may cause undesired operation.

This equipment has been tested and found to comply with the limits for a Class B digital device, pursuant to part 15 of the FCC Rules. These limits are designed to provide reasonable protection against harmful interference in a residential installation. This equipment generates, uses, and radiates radio frequency energy. If it is not installed and used in accordance with the instructions, may cause harmful interference to radio communications. However, there is no guarantee that interference will not occur in a particular installation. If this equipment does cause harmful interference to radio or television reception, which can be determined by turning the equipment off and on, the user is encouraged to try to correct the interference by using one or more of the following measures:

- Reorient or relocate the receiving antenna.
- Increase the separation between the equipment and receiver.
- Connect the equipment into an outlet on a circuit different from that to which the receiver is connected.
- Consult the dealer or an experienced radio/TV technician for help.
- Changes or modifications not approved by the party responsible for compliance could void user's authority to operate the equipment.

Buttons and Functions

Before you begin using your new air conditioner, make sure to familiarize yourself with its remote control. The following is a brief introduction to the remote control itself. For instructions on how to operate your air conditioner, refer to the How to Use Basic Functions section of this manual.

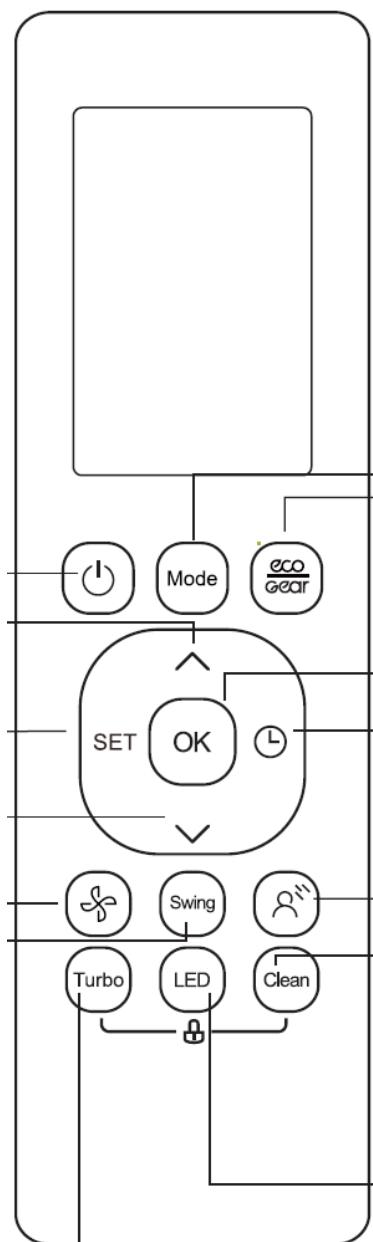

- **ON/OFF**

Turns the unit on or off.

- **TEMP** Increases temperature in 1°F (1°C) increments. Maximum Temperature setting is 86°F (30°C).

NOTE: Press together & buttons at the same time for 3 seconds will alternate the temperature display between °C & °F.

- **SET**

Scrolls through operation The selected symbol will flash on the display window, press the OK button to confirm.

- **Sleep Follow Me AP Mode** The selected symbol will flash on the display window, press the OK button to confirm.

- **TEMP**

Decreases temperature in 1°F (1°C) increments Minimum temperature setting is 60°F (16°C).

- **FAN SPEED**

Selects fan speeds in the following sequence: AU 20% 40% 60%

80% 100% Press the TEMP or button to increase or decrease the fan speed in 1% increments.

- **SWING**

Starts and stops the horizontal louver movement. Hold down for 2 seconds to initiate vertical louver auto swing feature.

- **MODE**

Scrolls through operation modes in the following sequence:

AUTO COOL DRY HEAT FAN

NOTE: HEAT mode is not supported by the cooling-only version.

- **ECO/GEAR**

Press this button to enter the energy efficient modes which can be selected in the following sequence:

ECO GEAR (75%) GEAR (50%) Previous setting mode ECO

- **OK**

Used to confirm the selected functions.

- **TIMER**

Used to set the timer to turn the unit on or off at a specified time.

- **BREEZE AWAY**

This feature keeps direct airflow from blowing directly on the occupants of the room.

NOTE: This feature is only available in COOL, FAN, and DRY modes.

- **CLEAN**

Used to start/stop the Self-Clean or Active Clean function (Model dependent, please refer to the USER'S OPERATION & INSTALLATION MANUAL).

- **LED**

Turns the indoor unit's LED display and air conditioner buzzer on and off (model dependent), to create a quiet environment.

- **TURBO**

Enables unit to reach the preset temperature in the shortest possible time.

Remote Screen Indicators

Information that is displayed when the remote controller is turned on.

- Breeze Away display (some units)
- Active clean feature display
- Sleep mode display
- Follow me feature display
- Wireless control feature display(some units)
- Low battery detection display (If flashes)

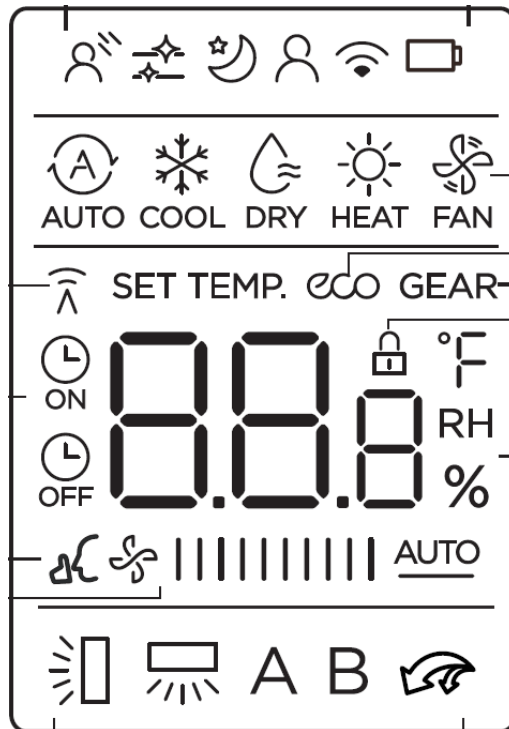

Transmission: This indicator lights up when the remote transmits a signal to the indoor unit.

- TIMER ON display
- TIMER OFF display
- Silence:

This indicator lights up when the Silence function is activated.

- ECO display

Displays when GEAR feature is activated

- GEAR display

Displays when ECO feature is activated

- LOCK display

Displays when LOCK feature is activated

- Horizontal louver

swing display

- Vertical louver

auto swing display

- TURBO MODE display

Not available for this unit.

- Temperature/Timer/Fan speed display

Displays the set temperature by default, or fan speed or timer setting when using

- **FAN SPEED:**

Displays selected fan speed:

Silence

LOW

MED

HIGH

AUTO

2%-20%

21%-40%

41%-60%

61%-80%

81%-100%

1%

NOTE: The fan speed cannot be adjusted in AUTO or DRY mode.

- **Display Mode**

Displays the current mode, including:

- **TIMER ON/OFF functions.**

Temperature range:

60-86°F (16-30°C)/

68°F-82°F (20-28°C)

(model dependent)

- **Timer setting range:**

0-24 hours

- **Fan speed setting range:**

AU – 100%

This display is blank when
operating in FAN mode.

Not all the models can display the fan speed values between AU-100%.

NOTE: All indicators shown are for demonstration purposes. During actual operation, only the relative and active functions will be shown in the display window.

How to Use Basic Functions

ATTENTION! Please ensure the unit is plugged in and power is available before operation.

AUTO Mode

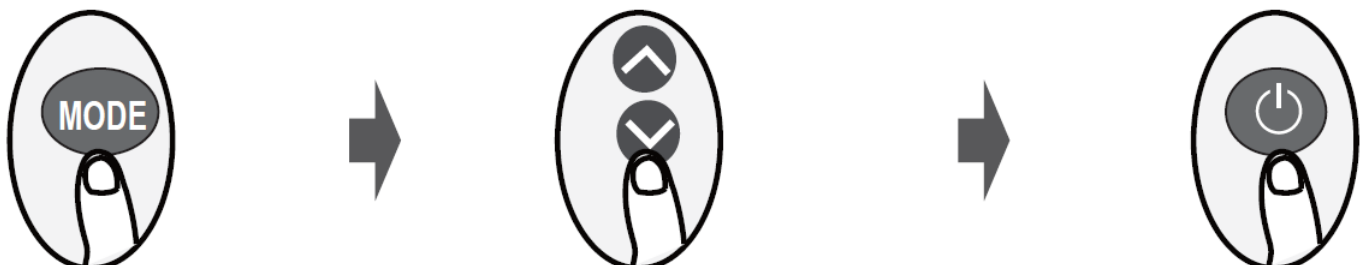

1. Select AUTO mode
2. Set your desired temperature
3. Turn on the air conditioner

NOTE:

- In AUTO mode, the unit will automatically select COOL, FAN, or HEAT function based on the set temperature.
- In AUTO mode, fan speed cannot be set or adjusted by the user.

COOL or HEAT Mode

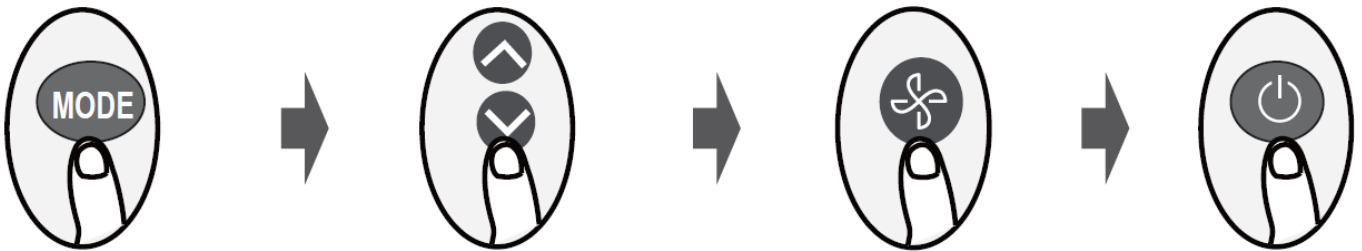

1. Select COOL/HEAT mode
2. Set the temperature
3. Set the fan speed
4. Turn on the air conditioner

DRY Mode

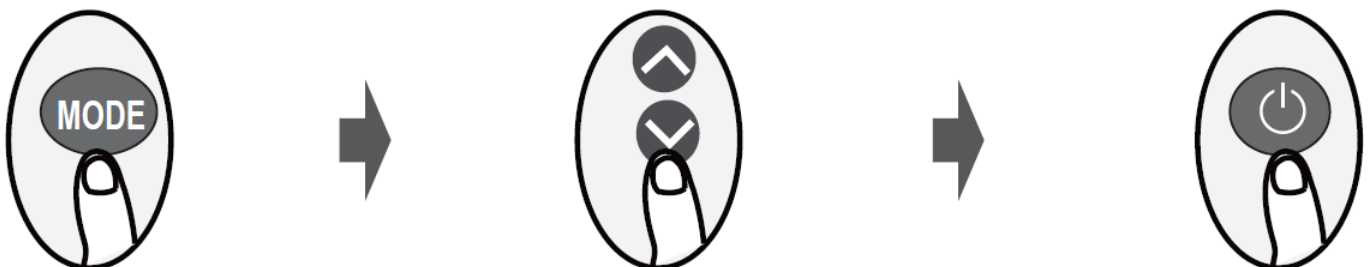

1. Select DRY mode
2. Set your desired temperature
3. Turn on the air conditioner

NOTE: In DRY mode, fan speed cannot be set because it is automatically controlled.

FAN Mode

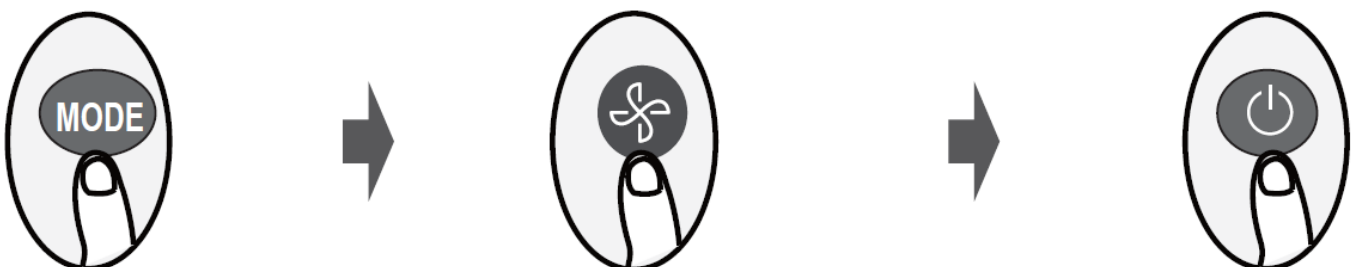

1. Select FAN mode
2. Set the fan speed
3. Turn on the air conditioner

NOTE: In FAN mode, the temperature cannot be set or adjusted. As a result, no temperature reading will display on the remote screen.

Setting the Timer

TIMER ON/OFF – Set the amount of time after which the unit will automatically turn on/off.

TIMER ON setting

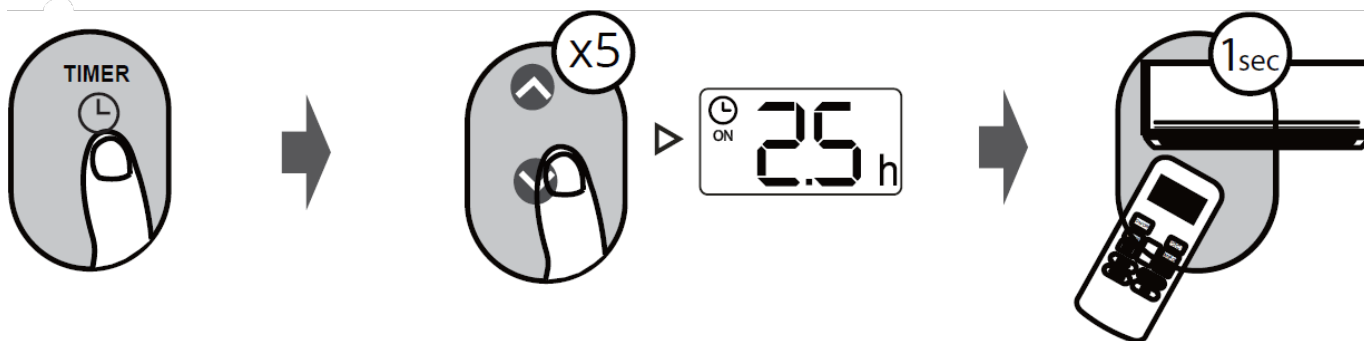

1. Press TIMER button to initiate the ON time sequence.
2. Press Temperature UP or DOWN button to set the desired time to turn ON the unit.
3. Point remote control at the unit and wait 1 second, the TIMER ON will be activated. 1sec

TIMER OFF setting

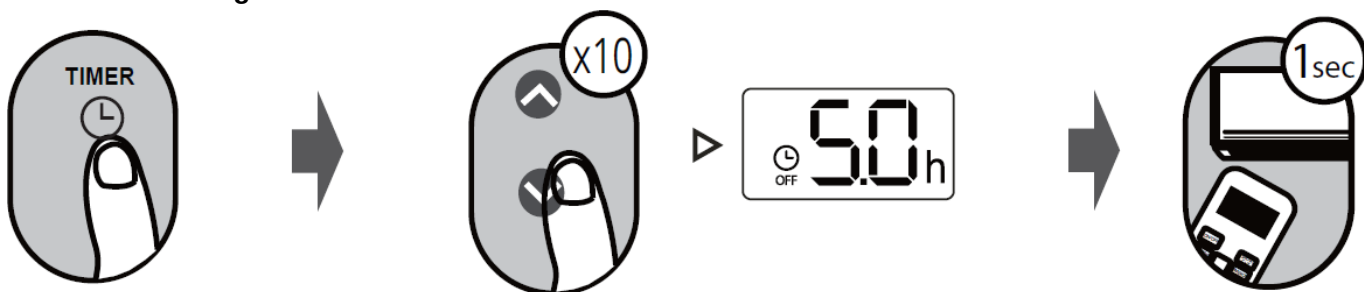

1. Press TIMER button to initiate the OFF time sequence.
2. Press Temperature UP or DOWN button to set the desired time to turn OFF the unit.
3. Point remote control at the unit and wait 1 sec, the TIMER OFF will be activated. 1sec.

NOTE:

- When setting the TIMER ON or TIMER OFF, the time will increase by 30 minutes increments with each press, up to 10 hours. After 10 hours and up to 24, it will increase in 1 hour increments. (For example, press 5 times to get 2.5h, and press 10 times to get 5h,) The timer will revert to 0.0 after 24.
- Cancel either function by setting its timer to 0.0h.

TIMER ON & OFF setting (example)

NOTE: Keep in mind that the time periods you set for both functions refer to hours after the current time.

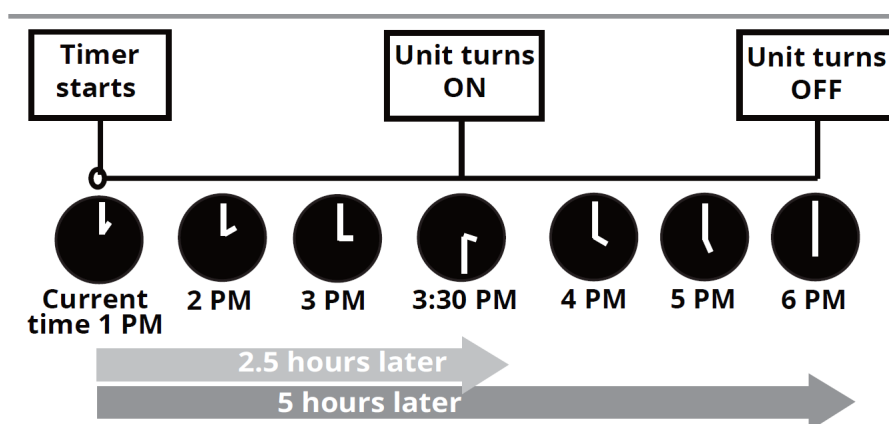
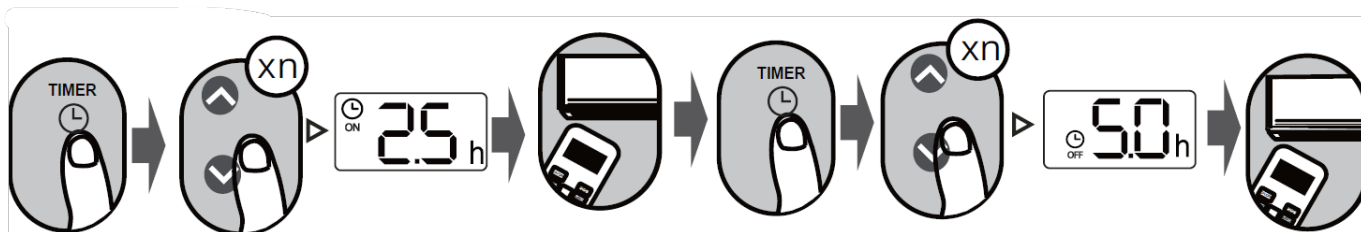

Example: If current time is 1:00PM, and the timer is set using the above steps, the unit will turn on 2.5 hours later (3:30PM) and then turn off at 6:00PM (5 hours after the timer is originally set).

How To Use Advanced Functions

Swing function

Press the SWING button

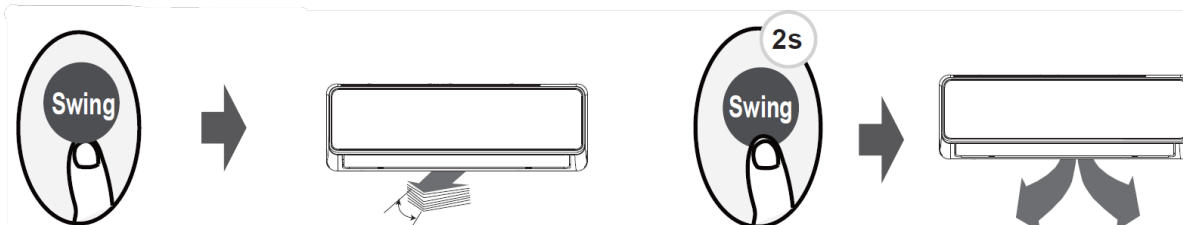

- The horizontal louver will swing up and down automatically when pressing SWING button. Press it again to make it stop.
- Keep pressing the SWING button more than 2 seconds, this will activate the vertical louver swing function (Model dependent).

Airflow direction

If continue to press the SWING button, five different airflow directions can be set. The louver can be moved to a different angle each time you press the button. Continue pressing the button until the desired setting is reached.

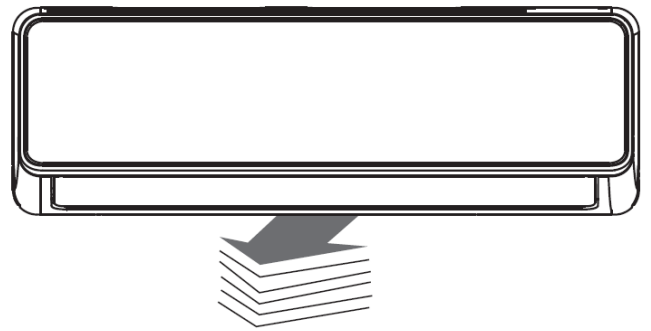
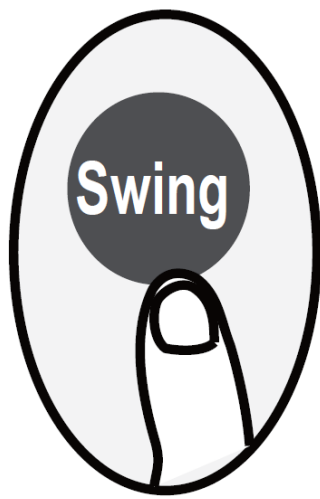

NOTE: When the unit is off, press and hold the MODE and SWING buttons together for one second, the louver will move to an extreme angle to make it easier to clean. Press and hold the MODE and SWING buttons together again for one second to reset the louver to its original position (Model dependent).

LED Display

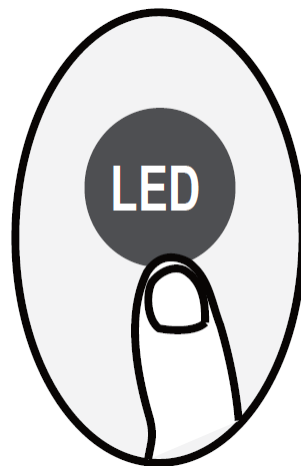

- Press LED button
- Press the LED button to either turn on or off the display on the indoor unit.

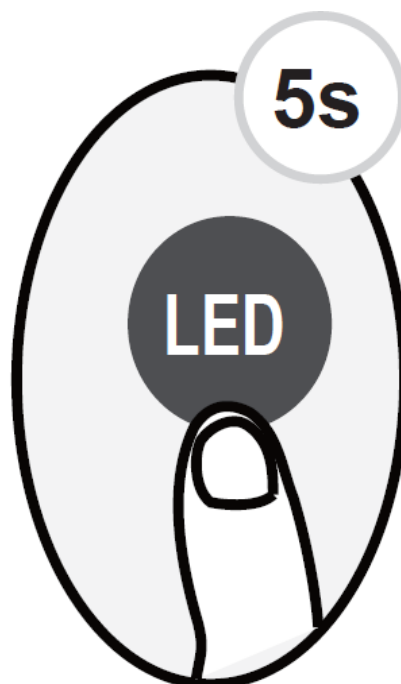

- Press and hold the LED button more than 5 seconds (some units).

- Press and hold the LED button more than 5 seconds, to make the display of the indoor unit show the actual room temperature. Press and hold the LED button for more than 5 seconds again and the display will revert back to the set temperature.

ECO/GEAR function



Pressing the iECO/GEAR button will allow you to select the energy efficiency modes in the following sequence: ECO GEAR (75%) GEAR (50%) Previous setting mode ECO.

NOTE: This function is only available under the COOL mode.

ECO operation:

Under COOL mode, press this button and the remote controller will automatically adjust the temperature to 75°F (24°C), fan speed off of AUTO to save energy. However, this only occurs when the set temperature is less than 75°F (24°C). If the set temperature is above 75°F (24°C), pressing the ECO button will cause the fan speed to change to AUTO and the set temperature will remain unchanged.

NOTE:

- Pressing the ECO/GEAR button, modifying the mode, or adjusting the set temperature to less than 75°F (24°C), will stop ECO operation.
- Under ECO operation, the set temperature should be 75°F (24°C) or above, or it may result in insufficient cooling. If the cooling feels insufficient, press the ECO button again to turn off this feature.

GEAR operation:

Press the ECO/GEAR button to enter the GEAR operation as following:

75% (up to 75% electrical energy consumption)

50% (up to 50% electrical energy consumption)

Previous setting mode.

Under GEAR operation, the display on the remote controller will alternate between electrical energy consumption reading and the set temperature.

Silence function

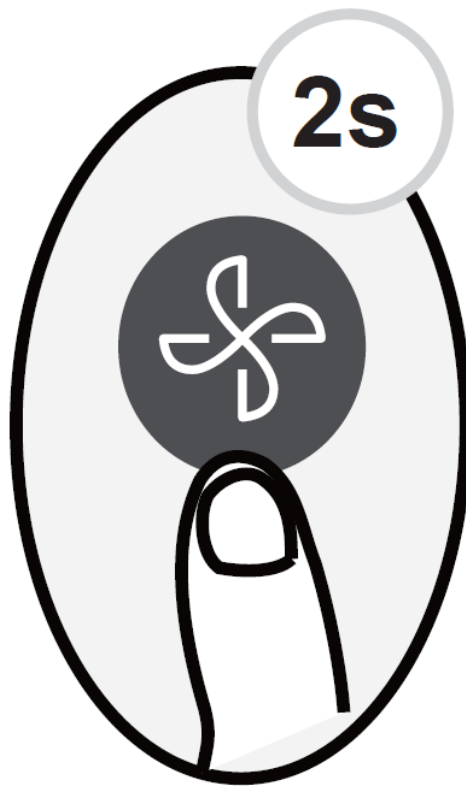

Pressing the FAN button for more than 2 seconds will activate or disable the Silence function (some units). Due to low frequency operation of compressor, this function could result in insufficient cooling and heating capacity. Pressing the ON/OFF, MODE, SLEEP, TURBO or CLEAN button while the system is operating with the silence function activated will cancel it.

FP function

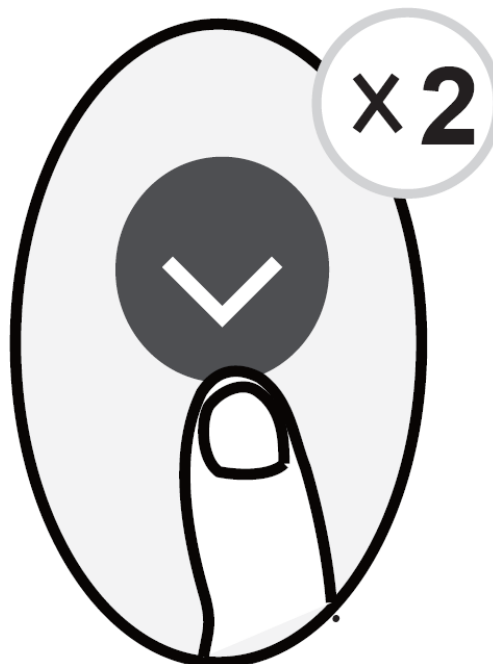

Using this function will cause the unit to operate with a high fan speed setting (while the compressor is on) with temperature automatically set to the lowest setting, 46°F (8°C), in order to achieve faster cooling.

NOTE: The function listed below is for heat pump air conditioners only. Press the button 2 times within one second while in HEAT Mode and the temperature will be set to 60°F (16°C) or 68°F (20°C) (dependent on model) and the FP function will be activated. Pressing the On/Off, Sleep, Mode, Fan or Temperature buttons while operating this function will cancel it.

LOCK function

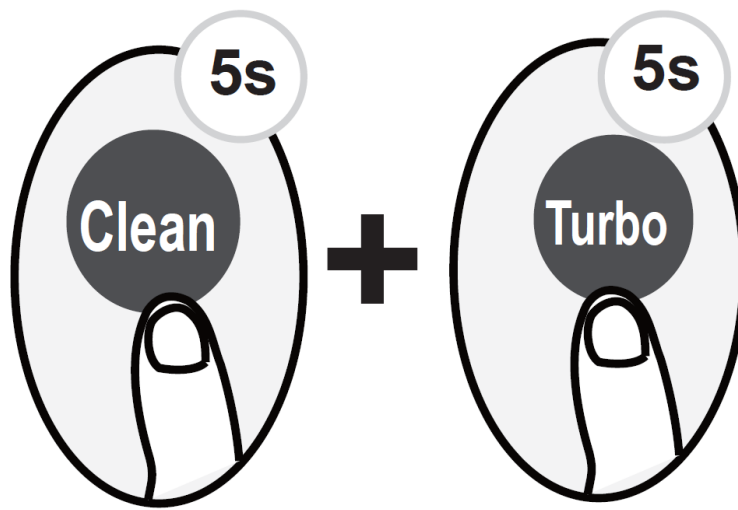

Pressing the CLEAN and TURBO buttons at the same time for more than 5 seconds will activate the LOCK function. With this feature activated no buttons pressed will respond, except when these two buttons are pressed again for two seconds in order to disable the LOCK function.

Clean Function (some units)

Press CLEAN button



Airborne bacteria can grow in the moisture that condenses around heat exchanger in the unit. With regular use, most of this moisture is evaporated from the unit. By pressing the CLEAN button, your unit will clean itself automatically. After cleaning has been completed, the unit will turn off automatically. Pressing the CLEAN button mid-cycle will cancel the operation and turn off the unit. You can use the CLEAN function as often as you like.

NOTE: You can only activate this function in COOL or DRY mode.

TURBO Function

Press TURBO button

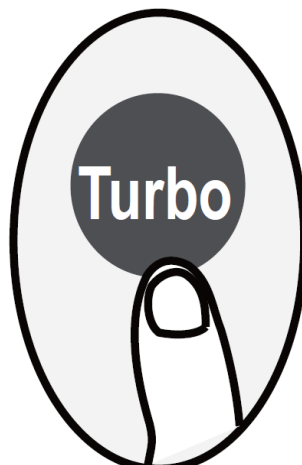

When the TURBO button is pressed while the unit is in COOL mode, the unit will blow cool air with highest fan setting to speed up the cooling process. When the TURBO button is pressed while the unit is in HEAT mode, for units with electric heat elements, the electric heater will activate and speed up the heating process.

SET function

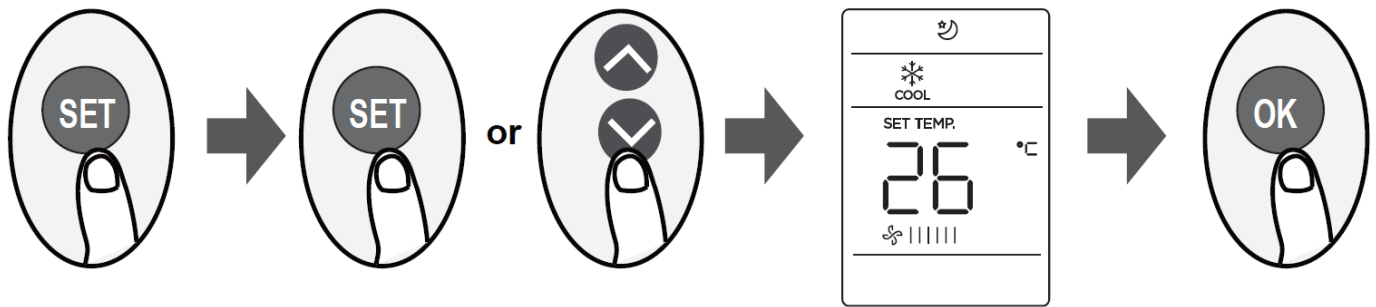

- Press the SET button to enter the function setting, then press the SET button or the TEMP or buttons to select the desired function. The selected symbol will flash on the display, press the OK button to confirm and this will activate the selected function.
- To cancel the selected function, just perform the same procedures as above.
- Press the SET button to scroll through operation functions as follows:

Breeze Away Sleep Follow Me AP mode:

If your remote controller has a Breeze Away button or Sleep button, you cannot use the SET button to select the Breeze Away or Sleep feature.

Breeze Away function (some units): This feature keeps airflow from being blown directly on the occupants of the room.

NOTE: This feature is available under COOL, FAN and DRY modes only.

Sleep function :

The SLEEP function is used to decrease energy use while you sleep (temperature settings needed to stay comfortable during sleep differ from the settings needed while awake). This function can only be activated via the remote control. For further details, please refer to the Sleep Operation section of your unit's USER MANUAL.

NOTE: The SLEEP function is not available in FAN or DRY mode.

AP function () (some units):

Choose AP mode to use the wireless network configuration. For some units, it does not work by pressing the SET button. To enter the AP mode, continuously press the LED button seven times within 10 seconds.

Follow me function :

The FOLLOW ME function enables the remote control to measure the temperature at the location it currently is and send this signal to the air conditioning unit in a 3 minute interval. When using AUTO, COOL, or, HEAT modes, measuring the ambient temperature from the remote control (instead of from the indoor unit itself) will enable the air conditioner to optimize the temperature where you currently are and ensure maximum comfort.

NOTE: Press and hold the TURBO button for seven seconds to start or stop the memory feature of the FOLLOW ME function.

- If the memory feature is activated, "ON" will display for 3 seconds on the screen.
- If the memory feature is stopped, "OF" will display for 3 seconds on the screen.
- While the memory feature is activated, press the ON/OFF button, shift the mode or power failure will not cancel the Follow Me function.

Buttons and Functions

Before you begin using your new air conditioner, make sure to familiarize yourself with its remote control. The following is a brief introduction to the remote control itself. For instructions on how to operate your air conditioner, refer to the How to Use Basic Functions section of this manual.

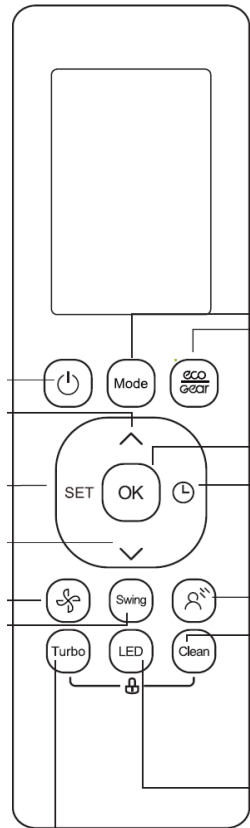

- **ON/OFF**

Turns the unit on or off.

- **TEMP** Increases temperature in 1°F (1°C) increments. Maximum Temperature setting is 86°F (30°C).

NOTE: Press together & buttons at the same time for 3 seconds will alternate the temperature display between °C & °F.

- **SET**

Scrolls through operation The selected symbol will flash on the display window, press the OK button to confirm.

- **Sleep Follow Me AP Mode** The selected symbol will flash on the display window, press the OK button to confirm.

- **TEMP**

Decreases temperature in 1°F (1°C) increments Minimum temperature setting is 60°F (16°C).

- **FAN SPEED**

Selects fan speeds in the following sequence: AU 20% 40% 60%

80% 100% Press the TEMP or button to increase or decrease the fan speed in 1% increments.

- **SWING**

Starts and stops the horizontal louver movement. Hold down for 2 seconds to initiate vertical louver auto swing feature.

- **MODE**

Scrolls through operation modes in the following sequence:

AUTO COOL DRY HEAT FAN

NOTE: HEAT mode is not supported by the cooling-only version.

- **ECO/GEAR**

Press this button to enter the energy efficient modes which can be selected in the following sequence:

ECO GEAR (75%) GEAR (50%) Previous setting mode ECO

- **OK**

Used to confirm the selected functions.

- **TIMER**

Used to set the timer to turn the unit

on or off at a specified time.

- **BREEZE AWAY**

This feature keeps direct airflow from blowing directly on the occupants of the room.

NOTE: This feature is only available in COOL, FAN, and DRY modes.

- **CLEAN**

Used to start/stop the Self-Clean or Active Clean function (Model dependent, please refer to the USER'S OPERATION & INSTALLATION MANUAL).

- **LED**

Turns the indoor unit's LED display and air conditioner buzzer on and off (model dependent), to create a quiet environment.

- **TURBO**

Enables unit to reach the preset temperature in the shortest possible time.

NOTE: Press and hold the temperature & buttons at the same time for 3 seconds and it will alternate the temperature display between °F and C° readings.

Remote Screen Indicators

Information that is displayed when the remote controller is turned on.

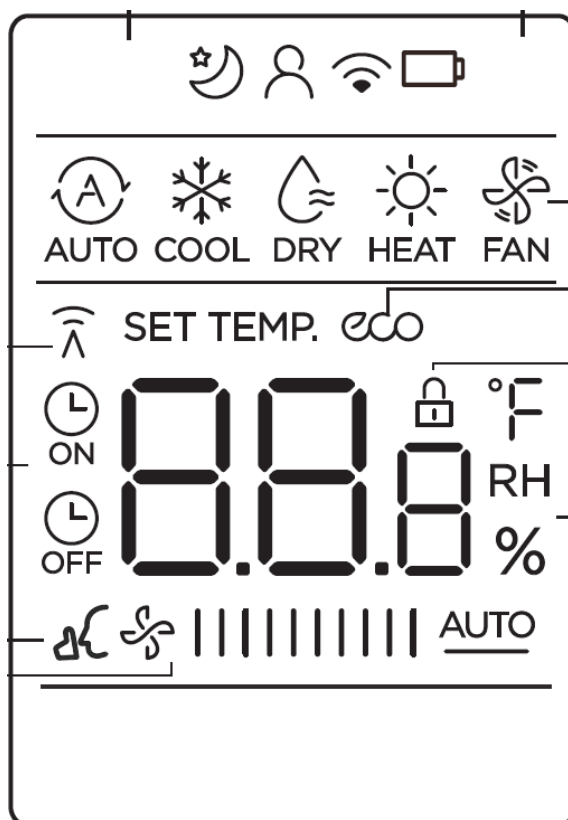

- Sleep mode display
- Follow me feature display
- Wireless control feature display
- Low battery detection display (If flashes)
- Transmission:

This indicator lights up when the remote transmits a signal to the indoor unit.

- TIMER ON display
- TIMER OFF display
- Silence:

This indicator lights up when the Silence function is activated.

- FAN SPEED:

Displays selected fan speed:

Silence

LOW

MED

HIGH

AUTO

NOTE: The fan speed cannot be adjusted in AUTO or DRY mode.

- MODE display

Displays the current mode, including:

- ECO display (some units) Displays when ECO feature is activated.
- LOCK display

Displays when LOCK feature is activated.

- Temperature/Timer/Fan speed display

Displays the set temperature by default, or fan speed or timer setting when using TIMER ON/OFF functions.

- Temperature range:

62- 86°F (17-30°C)/ 68°F-82°F (20-28°C)(model dependent)

- Timer setting range:

0- 24 hours

This display is blank when operating in FAN mode.

NOTE: All indicators shown are for demonstration purposes. During actual operation, only the relative and active functions will be shown in the display window.

How to Use Basic Functions

ATTENTION! Please ensure the unit is plugged in and power is available before operation.

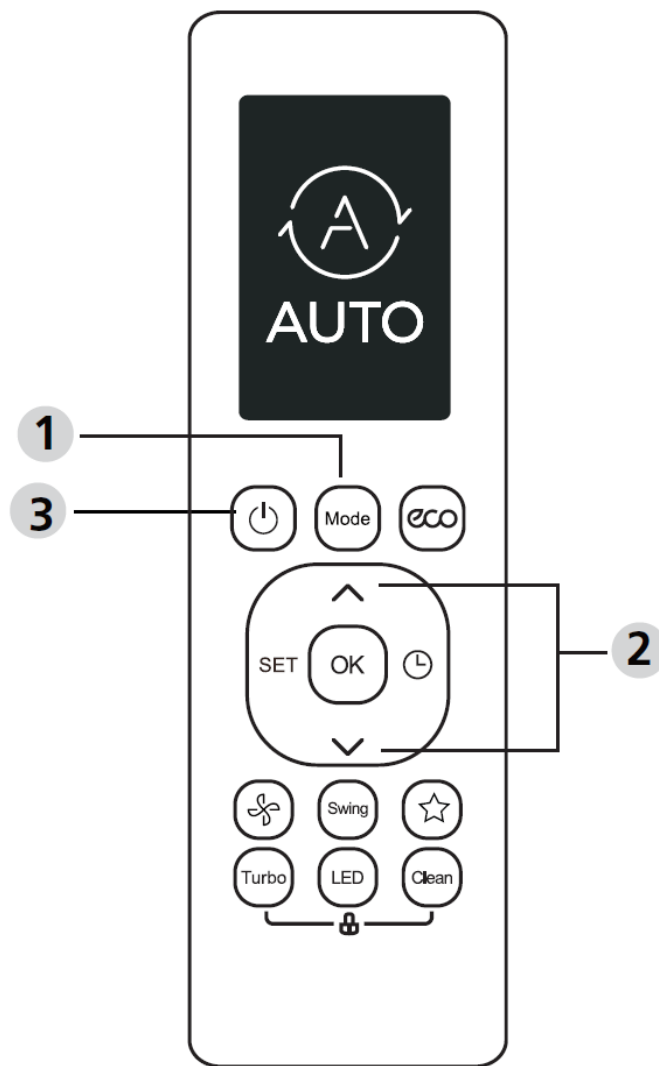

SETTING TEMPERATURE

The operating temperature range for units is 62-86°F (17-30°C) or 68-82°F (20-28°C) (model dependent). You can increase or decrease the set temperature in 1°F (1°C) increments by using the the Temperature or buttons on the remote.

AUTO Mode

In AUTO mode, the unit will automatically select the COOL, FAN, or HEAT operating mode based on the set temperature. To select AUTO mode follow these steps:

1. Press the MODE button and select AUTO mode.
2. Set your desired temperature using the TEMPERATURE or buttons.
3. Press the ON/OFF button to start the unit.

NOTE: FAN speed cannot be set or adjusted in AUTO mode.

COOL Mode

To select COOL Mode follow these steps:

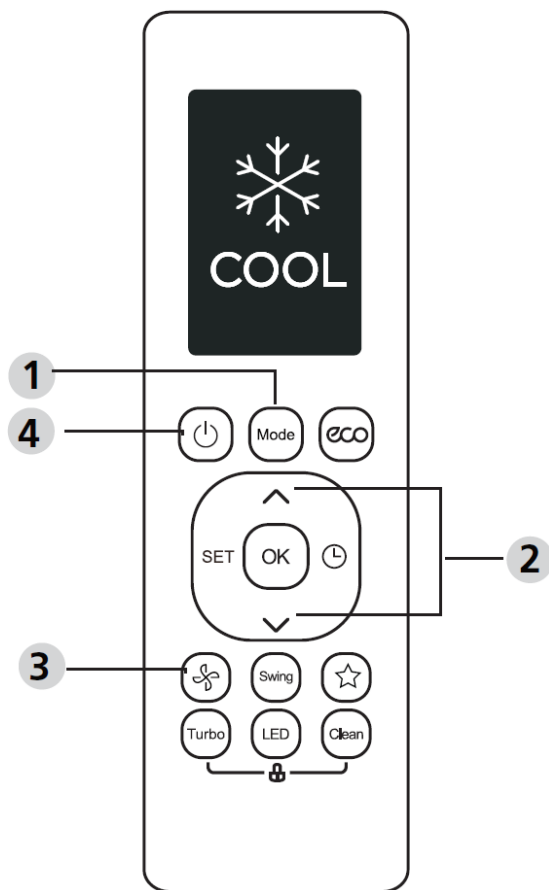

1. Press the MODE button and select COOL mode.
2. Set your desired temperature using the TEMPERATURE or buttons.
3. Press the FAN button to select the desired fan speed: AUTO, LOW, MED, or HIGH.
4. Press the ON/OFF button to start the unit.

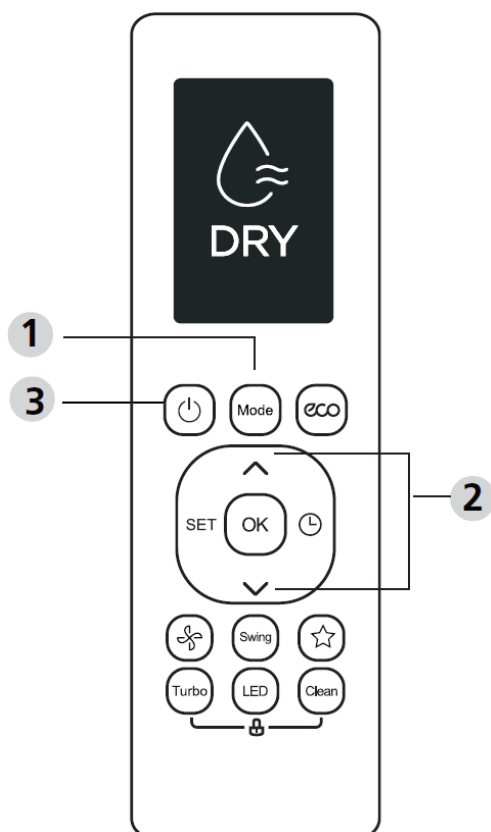

DRY Mode (dehumidifying function)

In DRY mode, the unit acts as a dehumidifier. To select DRY mode follow these steps:

1. Press the MODE button and select DRY mode.
2. Set your desired temperature using the **TEMPERATURE or buttons.**
3. Press the ON/OFF button to start the unit.

NOTE: FAN speed cannot be set or adjusted in DRY mode.

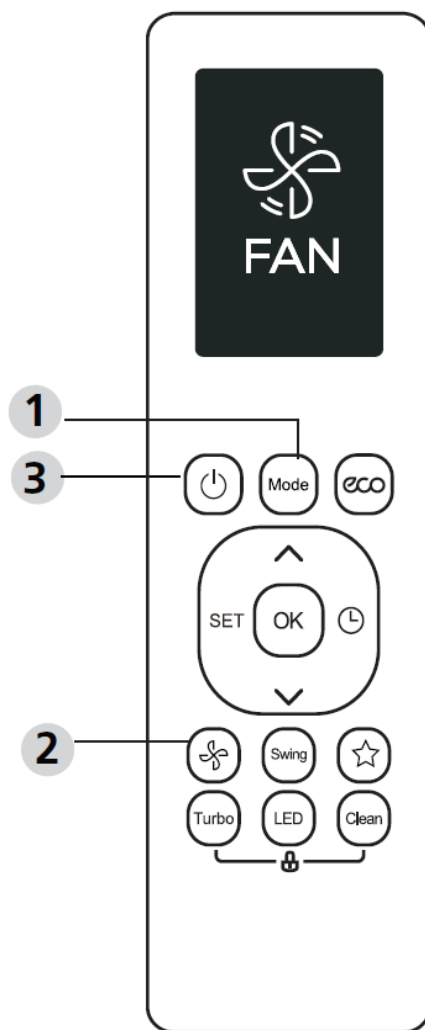

FAN Mode

1. Press the MODE button and select FAN mode.
2. Press FAN button to select the desired the fan speed: AUTO, LOW, MED, or HIGH.
3. Press the ON/OFF button to start the unit.

NOTE: The temperature cannot be set or adjusted in FAN mode. As a result of this, the remote control.

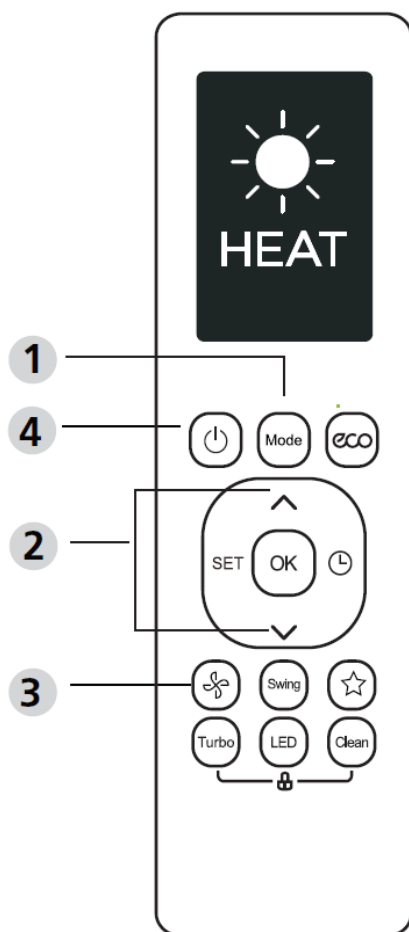

HEAT Mode

To select HEAT mode follow these steps:

1. Press the MODE button and select HEAT mode.
2. Set your desired temperature using the **TEMPERATURE or buttons.**
3. Press the FAN button to select the desired fan speed: AUTO, LOW, MED, or HIGH.
4. Press the ON/OFF button to start the unit.

NOTE: As the outdoor temperature drops, the performance of the unit's HEAT function may be affected. If this occurs, we recommend using other heating appliances in conjunction with the unit.

Setting the Timer

TIMER ON/OFF – Set the amount of time after which the unit will automatically turn on/off.

TIMER ON setting

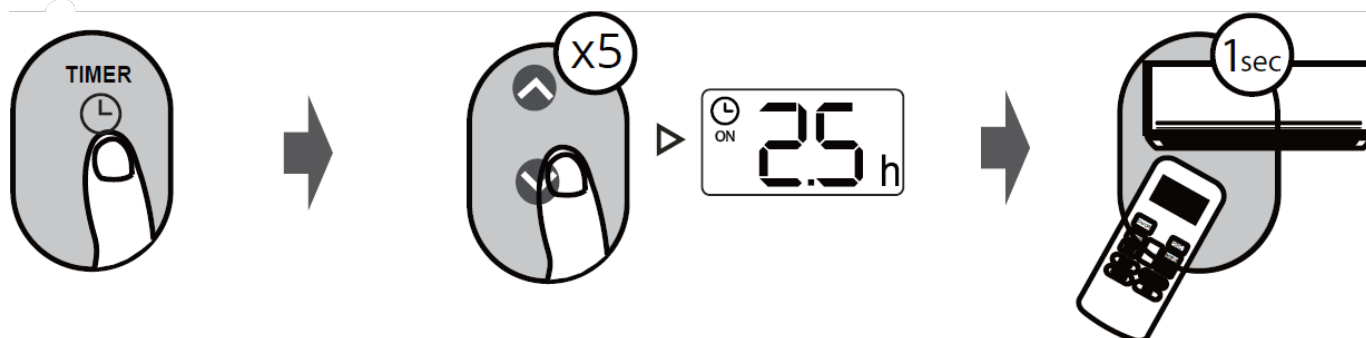

1. Press TIMER button to initiate the ON time sequence.
2. Press Temperature UP or DOWN button to set the desired time to turn ON the unit.
3. Point remote control at the unit and wait 1 second, the TIMER ON will be activated. 1sec

TIMER OFF setting

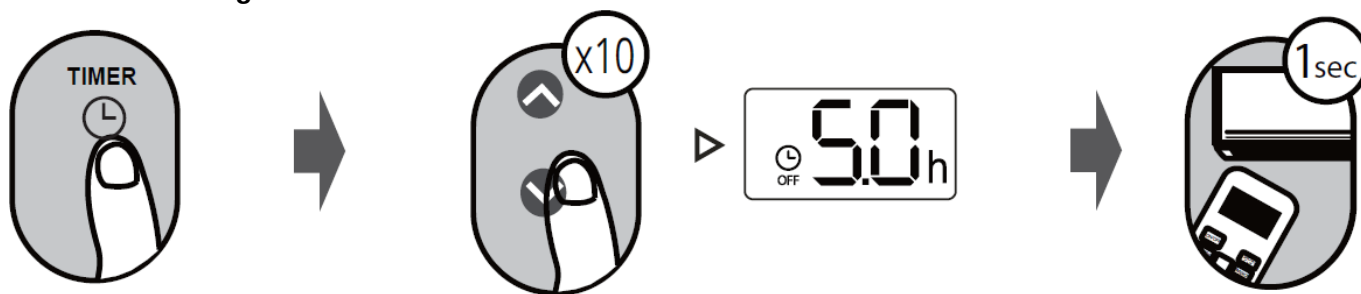

1. Press TIMER button to initiate the OFF time sequence.
2. Press Temperature UP or DOWN button to set the desired time to turn OFF the unit.
3. Point remote control at the unit and wait 1 sec, the TIMER OFF will be activated. 1sec.

NOTE:

- When setting the TIMER ON or TIMER OFF, the time will increase by 30 minutes increments with each press, up to 10 hours. After 10 hours and up to 24, it will increase in 1 hour increments. (For example, press 5 times to get 2.5h, and press 10 times to get 5h,) The timer will revert to 0.0 after 24.
- Cancel either function by setting its timer to 0.0h.

TIMER ON & OFF setting (example)

NOTE: Keep in mind that the time periods you set for both functions refer to hours after the current time.

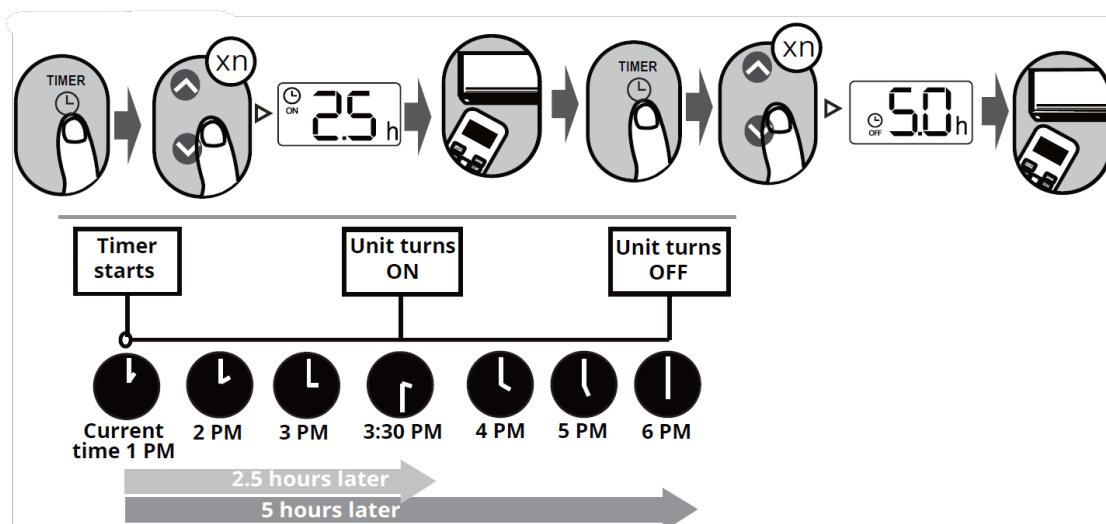

Example: If current time is 1:00PM, and the timer is set using the above steps, the unit will turn on 2.5 hours later (3:30PM) and then turn off at 6:00PM (5 hours after the timer is originally set).

How to Use Advanced Functions

Swing function

Press the SWING button

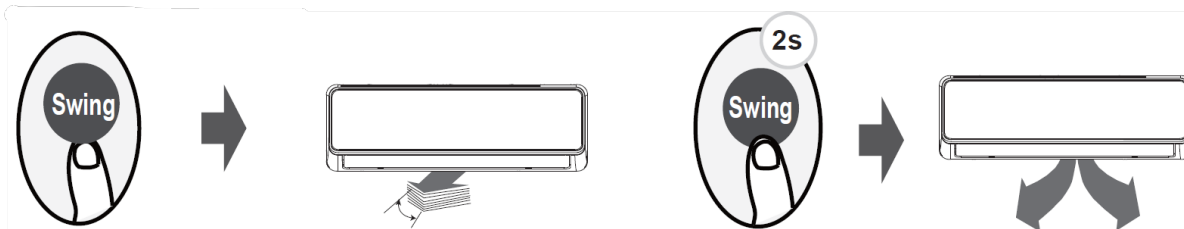

- The horizontal louver will swing up and down automatically when pressing SWING button. Press it again to make it stop.
- Keep pressing the SWING button more than 2 seconds, this will activate the vertical louver swing function (Model dependent).

Airflow direction

If continue to press the SWING button, five different airflow directions can be set. The louver can be moved to a different angle each time you press the button. Continue pressing the button until the desired setting is reached.

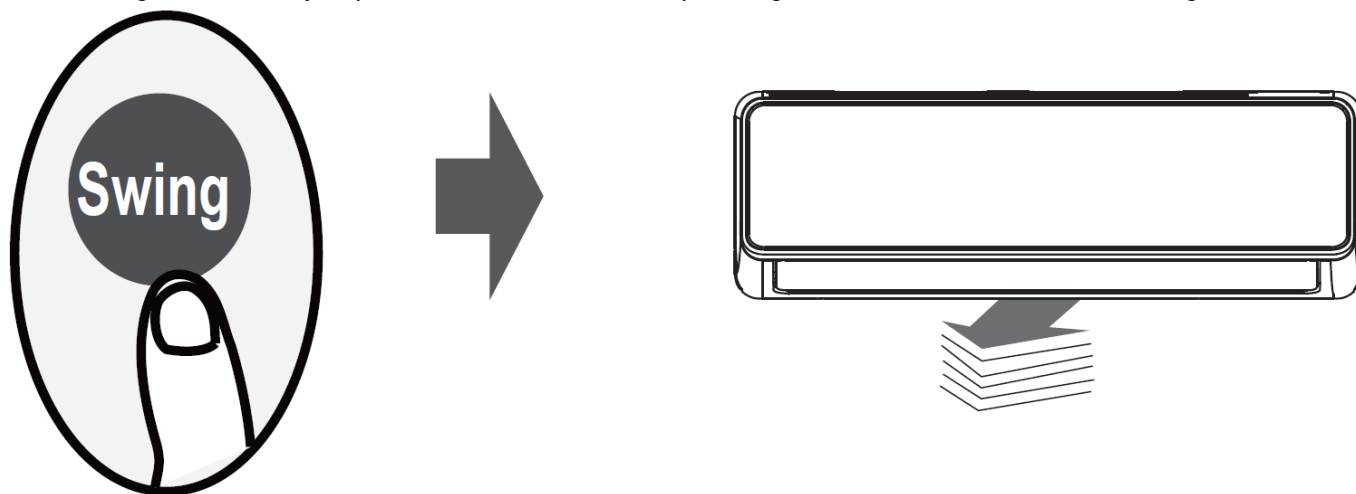

NOTE: When the unit is off, press and hold the MODE and SWING buttons together for one second, the louver will move to an extreme angle to make it easier to clean. Press and hold the MODE and SWING buttons together again for one second to reset the louver to its original position (Model dependent).

LED Display

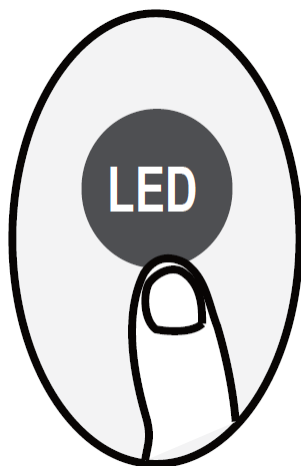

- Press LED button
- Press the LED button to either turn on or off the display on the indoor unit.

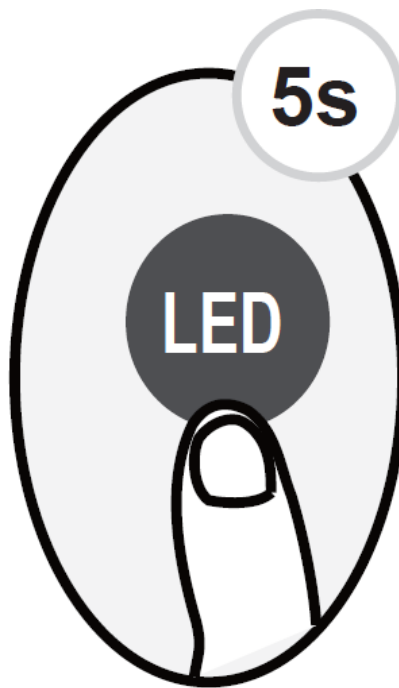

- Press and hold the LED button more than 5 seconds (some units).
- Press and hold the LED button more than 5 seconds, to make the display of the indoor unit show the actual room temperature. Press and hold the LED button for more than 5 seconds again and the display will revert back to the set temperature.

ECO/GEAR function



Pressing the iECO/GEAR button will allow you to select the energy efficiency modes in the following sequence: ECO GEAR (75%) GEAR (50%) Previous setting mode ECO.

NOTE: This function is only available under the COOL mode.

ECO operation:

Under COOL mode, press this button and the remote controller will automatically adjust the temperature to 75°F (24°C), fan speed off of AUTO to save energy. However, this only occurs when the set temperature is less than 75°F (24°C). If the set temperature is above 75°F (24°C), pressing the ECO button will cause the fan speed to change to AUTO and the set temperature will remain unchanged.

NOTE:

- Pressing the ECO/GEAR button, modifying the mode, or adjusting the set temperature to less than 75°F (24°C), will stop ECO operation.

- Under ECO operation, the set temperature should be 75°F (24°C) or above, or it may result in insufficient cooling. If the cooling feels insufficient, press the ECO button again to turn off this feature.

LOCK function

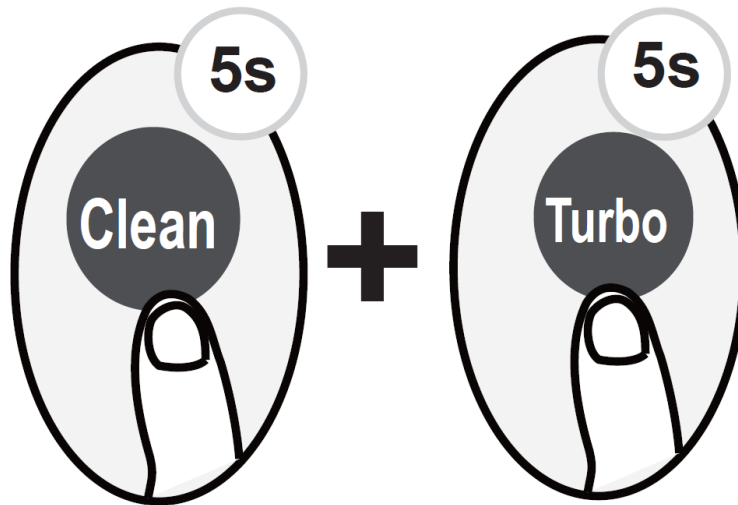

Pressing the CLEAN and TURBO buttons at the same time for more than 5 seconds will activate the LOCK function. With this feature activated no buttons pressed will respond, except when these two buttons are pressed again for two seconds in order to disable the LOCK function.

SHORTCUT function

Press SHORTCUT button(some units) to revert to previous settings:

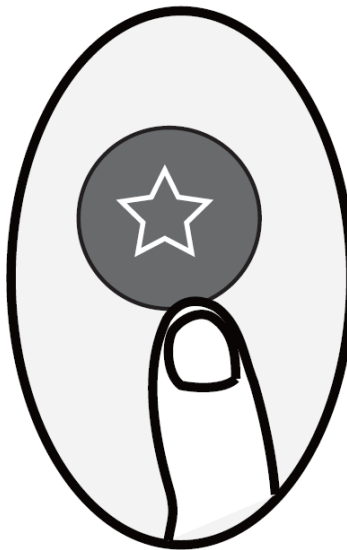

Pressing the SHORTCUT button when the remote controller is on will cause the system to automatically revert back to the previous settings including the operating mode, set temperature, fan speed level, and the sleep feature (if activated).

If the SHORTCUT button is pressed for more than 2 seconds, the system will automatically restore the current operation settings including the operating mode, set temperature, fan speed level and sleep feature (if activated).

Clean Function (some units)

Press CLEAN button



Airborne bacteria can grow in the moisture that condenses around heat exchanger in the unit. With regular use, most of this moisture is evaporated from the unit. By pressing the CLEAN button, your unit will clean itself automatically. After cleaning has been completed, the unit will turn off automatically. Pressing the CLEAN button mid-cycle will cancel the operation and turn off the unit. You can use the CLEAN function as often as you like.

NOTE: You can only activate this function in COOL or DRY mode.

TURBO Function

Press TURBO button

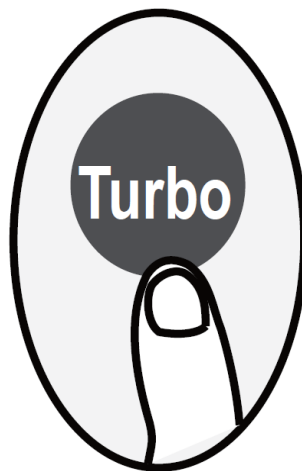

When the TURBO button is pressed while the unit is in COOL mode, the unit will blow cool air with highest fan setting to speed up the cooling process. When the TURBO button is pressed while the unit is in HEAT mode, for units with electric heat elements, the electric heater will activate and speed up the heating process.

SET function

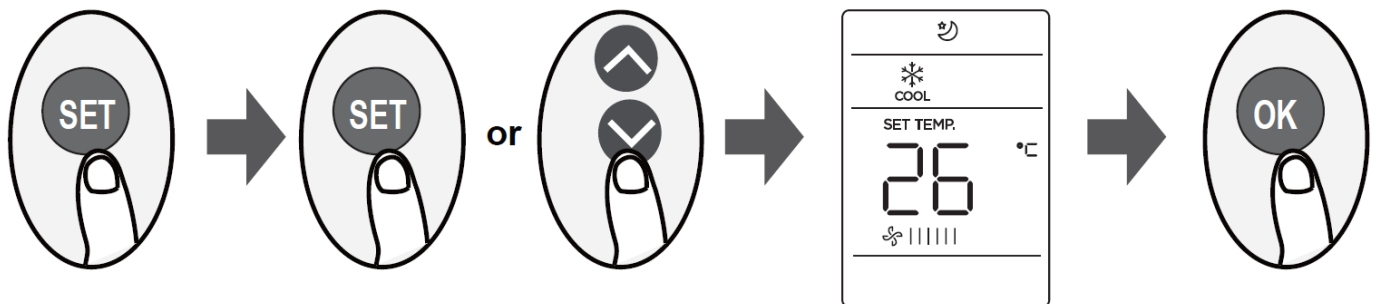

- Press the SET button to enter the function setting, then press the SET button or the TEMP or buttons to select the desired function. The selected symbol will flash on the display, press the OK button to confirm and this will activate the selected function.

- To cancel the selected function, just perform the same procedures as above.
- Press the SET button to scroll through operation functions as follows:

Sleep function :

The SLEEP function is used to decrease energy use while you sleep (temperature settings needed to stay comfortable during sleep differ from the settings needed while awake). This function can only be activated via the remote control. For further details, please refer to the Sleep Operation section of your unit's USER MANUAL.

NOTE: The SLEEP function is not available in FAN or DRY mode.

AP function (some units):

Choose AP mode to use the wireless network configuration. For some units, it does not work by pressing the SET button. To enter the AP mode, continuously press the LED button seven times within 10 seconds.

Follow me function :

The FOLLOW ME function enables the remote control to measure the temperature at the location it currently is and send this signal to the air conditioning unit in a 3 minute interval. When using AUTO, COOL, or, HEAT modes, measuring the ambient temperature from the remote control (instead of from the indoor unit itself) will enable the air conditioner to optimize the temperature where you currently are and ensure maximum comfort.

NOTE: Press and hold the TURBO button for seven seconds to start or stop the memory feature of the FOLLOW ME function.

Due to updates and constantly improving performance, the information and instructions within this manual are subject to change without notice. Please visit www.mrcool.com/documentation to ensure you have the latest version of this manual.

Documents / Resources

	<p>MRCOOL RG57A6 Remote Control Air Conditioner [pdf] User Manual RG57A6, BGEFU1, Remote Control Air Conditioner, Air Conditioner</p>
---	---

References

- [MRCOOL – Comfort Made Simple](#)
- [MRCOOL – Comfort Made Simple](#)
- [Documentation – MRCOOL](#)