



MRCOOL RG10F2(D2)-BGEFU1 Hyper Heat Remote Control User Manual

[Home](#) » [MrCOOL](#) » MRCOOL RG10F2(D2)-BGEFU1 Hyper Heat Remote Control User Manual 

Contents

- [1 MRCOOL RG10F2\(D2\)-BGEFU1 Hyper Heat Remote Control](#)
- [2 Product Information](#)
- [3 Product Usage Instructions](#)
- [4 Remote Control Specifications & Quick Start Guide](#)
- [5 Handling the Remote Controller](#)
- [6 BATTERY DISPOSAL](#)
- [7 AHU Remote Controller](#)
- [8 Remote Screen Indicators](#)
- [9 How to Use Basic Functions](#)
- [10 Setting The Timer](#)
- [11 How To Use Advanced Functions](#)
- [12 Documents / Resources](#)

MRCOOL®

MRCOOL RG10F2(D2)-BGEFU1 Hyper Heat Remote Control



Product Information

The AHU Remote Control is a device used to control the AHU (Air Handling Unit) of the air conditioning unit. It is the model number RG10F2(D2)/BGEFU1 and is designed for use with the air conditioning units from MrCool Heat Pumps. It operates at a rated voltage of 3.0V and requires two dry batteries (R03/LR03) for power. The remote control has a signal-receiving range of 26.25 ft (8m) and can operate within an operational temperature range specified by the manufacturer.

Product Usage Instructions

Handling the Remote Controller

1. Inserting and Replacing Batteries:

- Slide the back cover of the remote control downward to expose the battery compartment.
- Insert the batteries, ensuring that the (+) and (-) designations on the end of the batteries match the symbols inside the battery compartment.
- Reinstall the back cover by sliding it back into place.

2. Battery Notes:

- Replace batteries if they are depleted or not functioning properly.
- Remove batteries from the remote control if it will not be used for more than 2 months.
- Dispose of batteries according to local laws for proper disposal.
- Avoid storing the remote control in areas with high temperatures or humidity, as it may affect battery performance.

AHU Remote Controller Buttons and Functions

The AHU Remote Controller has several buttons and functions for controlling the air conditioning unit. Familiarize yourself with the following:

- ON/OFF: Turns the unit on or off.
- SET: Scroll through operation functions in the following sequence: Follow Me, AP Mode. The selected symbol

will flash on the display window, press the OK button to confirm.

- Other buttons and functions: Refer to the How to Use Basic Functions section of the manual for detailed instructions on operating the unit.

Due to updates and constantly improving performance, the information and instructions within this manual are subject to change without notice. Please visit www.mrcool.com/documentation to ensure you have the latest version of this manual.

Version Date: 02-21-22

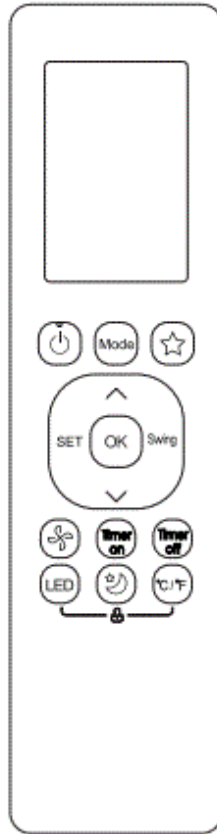

AHU Remote Controller
Model #: RG10F2(D2)/BGEFU1

Remote Control Specifications & Quick Start Guide

Model	AHU: RG10F2(D2)/BGEFU1
Rated Voltage	3.0V (Dry Batteries R03/LR03 x 2)
Signal Receiving Range	26.25 ft. (8m)
Operational Temperature Range	23°F ~ 140°F (-5°C ~ 60°C)

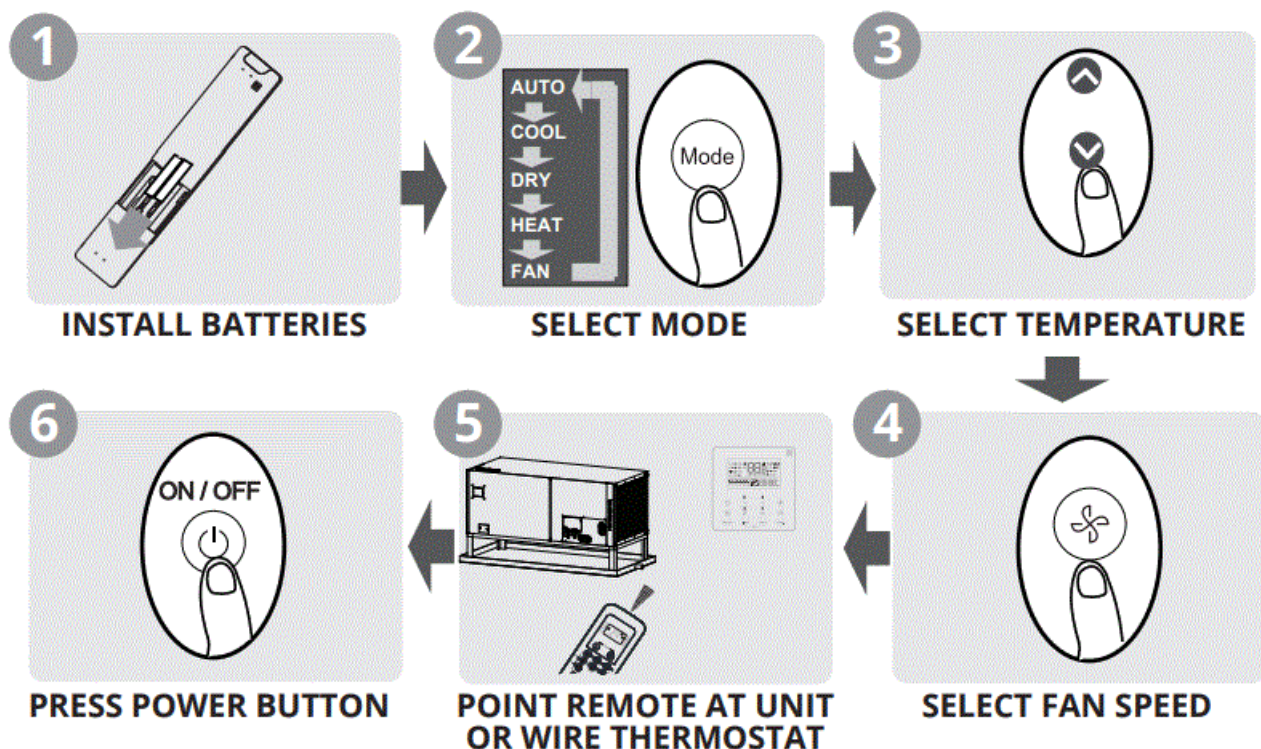

NOT SURE WHAT A FUNCTION DOES?

Refer to the How to Use Basic Functions and How to Use Advanced Functions sections of this manual for more detailed instructions of how to operate the unit.

SPECIAL NOTE

- Button designs on your remote may differ slightly from the example shown.
- If the indoor unit is not equipped with a particular function, but your remote controller has a button for it, pressing that function's button on the remote control will have no effect. When there are differences between the "Remote Controller
- Manual" and the "USER'S MANUAL" when it comes to function description, the description of "USER'S MANUAL" should take precedence.

Handling the Remote Controller

Inserting and Replacing Batteries

Your air conditioning unit may come with two batteries (some units). Install the batteries in the remote control before use by following the steps below:

1. Slide the back cover from the remote control downward to expose the battery compartment.
2. Insert the batteries, making sure to match the (+) and (-) designations on the end of the batteries with the symbols inside the battery compartment.
3. Reinstall the back cover by sliding it back into place.

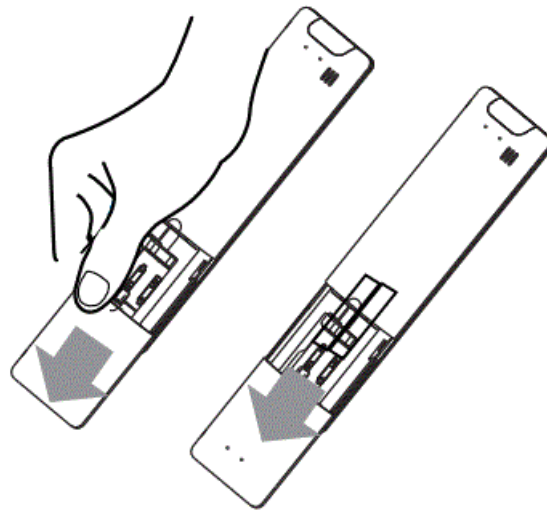

BATTERY NOTES

For optimum product performance:

- Do not mix old with new batteries or with batteries of different types.
- Do not leave batteries in the remote control if the device will not be used for more than 2 months.

BATTERY DISPOSAL

- DO NOT dispose of batteries as unsorted municipal waste. Refer to local laws for proper disposal of batteries.

TIPS FOR USING REMOTE CONTROL

- The remote control must be used within 26 ft (8 m) of the unit.
- The unit will beep when a remote signal is received.
- Curtains, other materials, and direct sunlight can interfere with the infrared signal receiver. Remove batteries if the remote will not be used more than 2 months.

NOTES FOR USING REMOTE CONTROL

The device should comply with the local and national regulations.

- In Canada, it should comply with CAN ICES-3(B)/NMB-3(B).
- In the USA, this device complies with part 15 of the FCC Rules. Operation is subject to the following two conditions:

1. This device may not cause harmful interference, and
2. this device must accept any interference received, including interference that may cause undesired operation.

This equipment has been tested and found to comply with the limits for a Class B digital device, pursuant to part 15 of the FCC Rules. These limits are designed to provide reasonable protection against harmful interference in a residential installation. This equipment generates, uses, and radiates radio frequency energy. If it is not installed and used in accordance with the instructions, it may cause harmful interference to radio communications. However, there is no guarantee that interference will not occur in a particular installation. If this equipment does cause harmful interference to radio or television reception, which can be determined by turning the equipment off

and on, the user is encouraged to try to correct the interference by using one or more of the following measures:

- Reorient or relocate the receiving antenna.
- Increase the separation between the equipment and receiver.
- Connect the equipment into an outlet on a circuit different from that to which the receiver is connected.
- Consult the dealer or an experienced radio/TV technician for help.
- Changes or modifications not approved by the party responsible for compliance could void user's authority to operate the equipment.

AHU Remote Controller

Buttons and Functions

Before you begin using your new air conditioner, make sure to familiarize yourself with its remote control. The following is a brief introduction to the remote control itself. For instructions on how to operate your air conditioner, refer to the How to Use Basic Functions section of this manual.

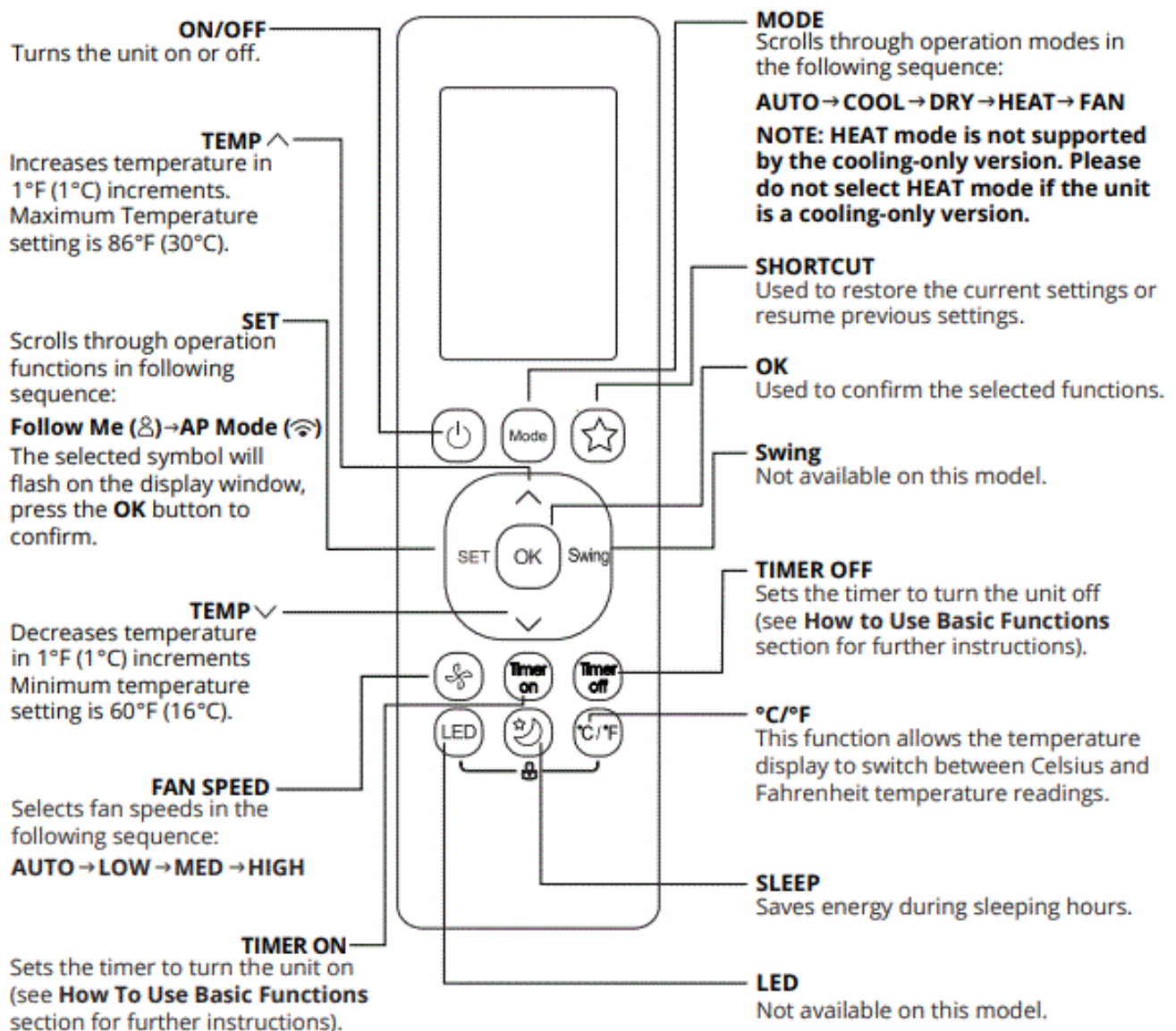

NOTE: Some of the buttons on the remote controller may have labels for features that are not available on the unit it is being used on. However, these buttons may be used to activate other features. Please refer to the How to Use Basic Functions and How to Use Advanced Functions sections of this manual for more information.

Remote Screen Indicators

Remote Screen Indicators

Information that is displayed when the remote controller is turned on.

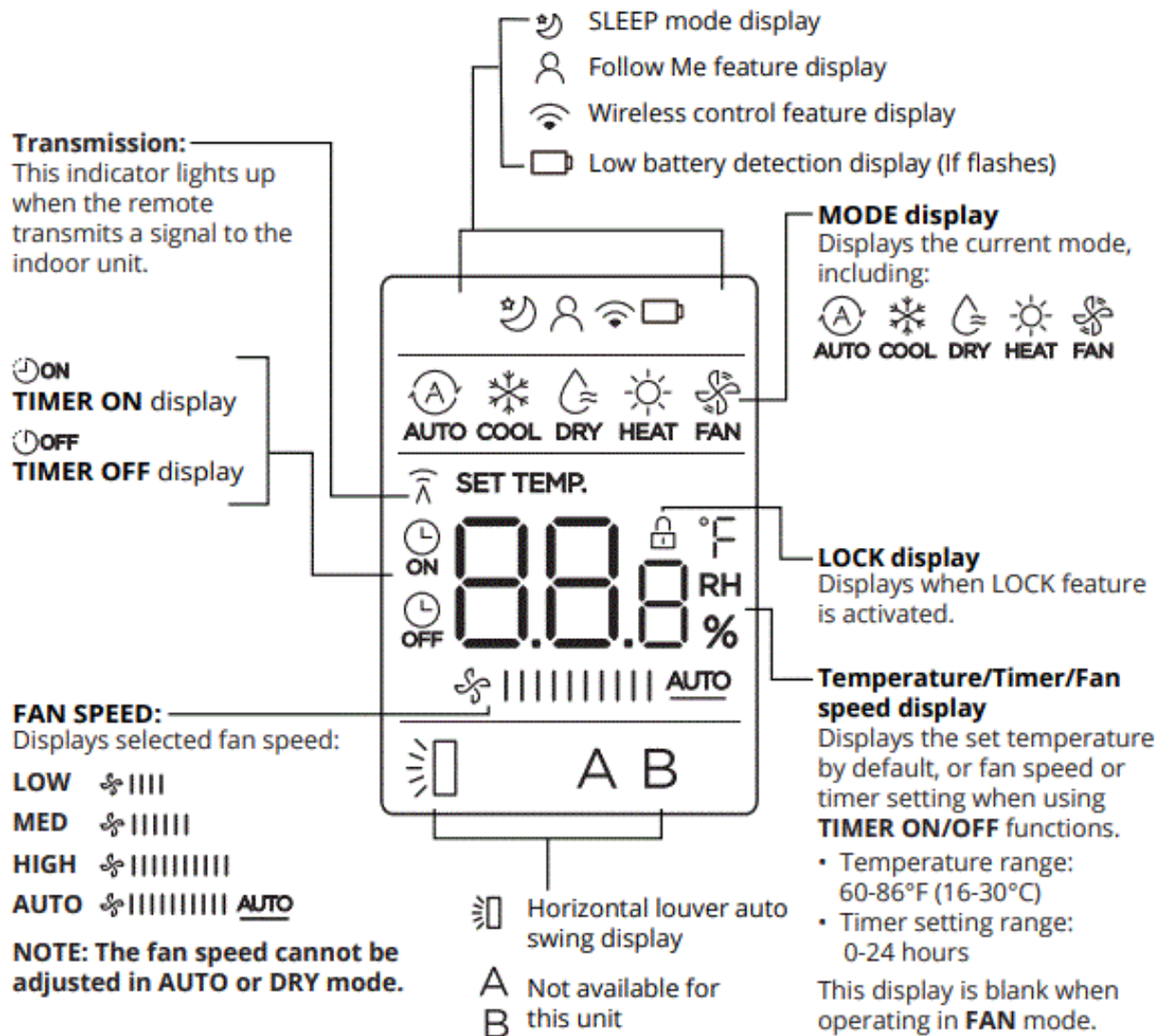

NOTE: All indicators shown are for demonstration purposes. During actual operation, only the relative and active functions will be shown in the display window.

How to Use Basic Functions

ATTENTION

Please ensure the unit has power before operation is attempted.

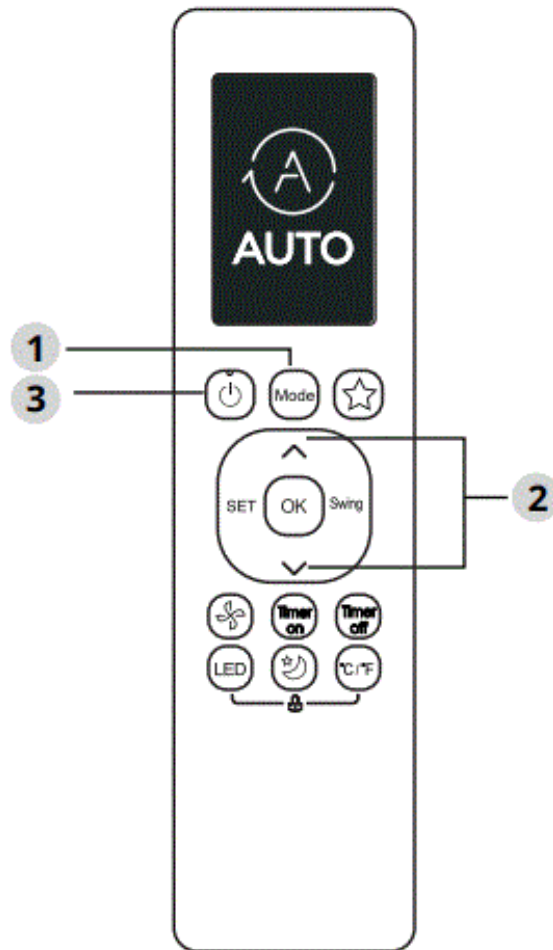

SETTING TEMPERATURE

- The operating temperature range for units is 60-86°F (16-30°C) or 68-82°F (20-28°C) (model dependent). You can increase or decrease the set temperature in 1°F (1°C) increments by using the the Temperature or buttons on the remote.

AUTO Mode

- In AUTO mode, the unit will automatically select the COOL, FAN, or HEAT operating mode based on the set temperature. To select AUTO mode follow these steps:

1. Press the MODE button and select AUTO mode.
2. Set your desired temperature using the TEMPERATURE or buttons.
3. Press the ON/OFF button to start the unit.

NOTE: FAN speed cannot be set or adjusted in AUTO mode.

COOL Mode

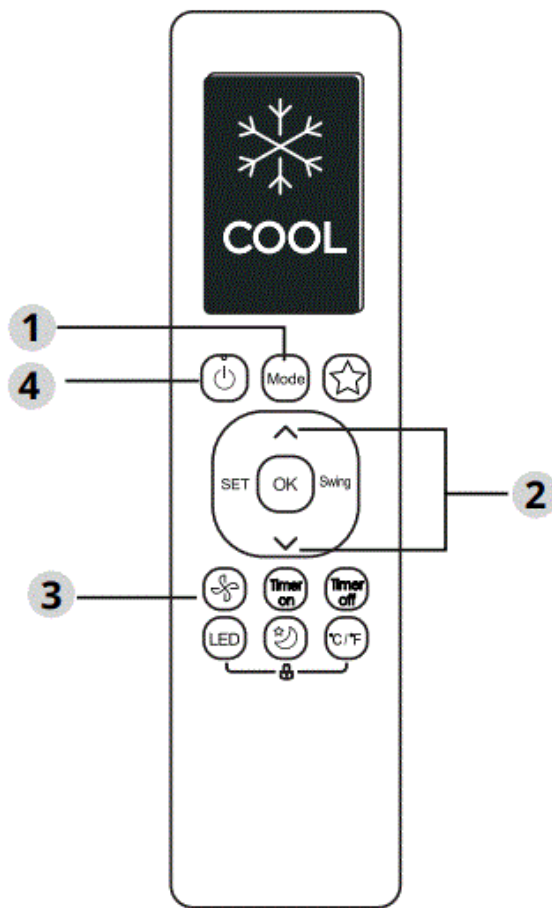

To select COOL Mode follow these steps:

1. Press the MODE button and select COOL mode.
2. Set your desired temperature using the TEMPERATURE or buttons.
3. Press the FAN button to select the desired fan speed: AUTO, LOW, MED, or HIGH.
4. Press the ON/OFF button to start the unit.

DRY Mode (dehumidifying function)

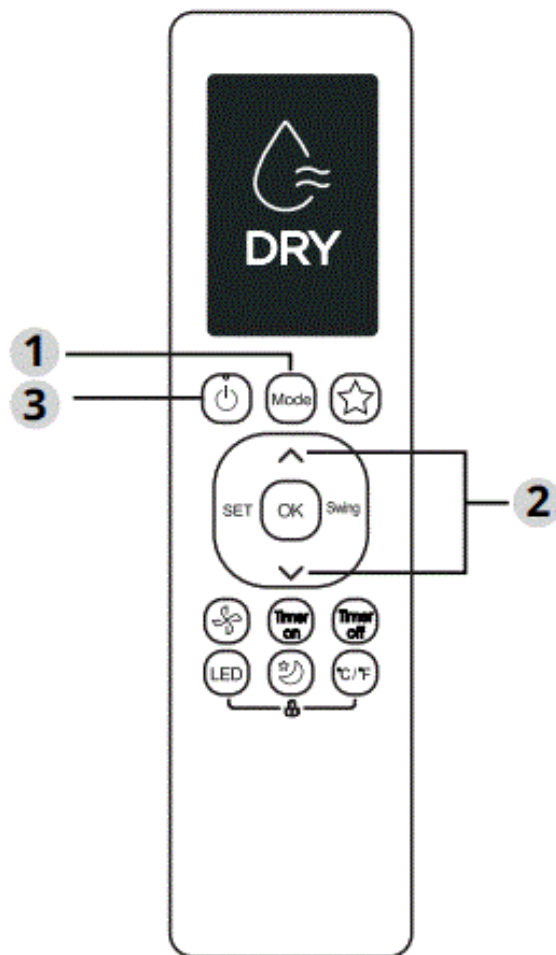

In DRY mode, the unit acts as a dehumidifier. To select DRY mode follow these steps:

1. Press the MODE button and select DRY mode.
2. Set your desired temperature using the TEMPERATURE or buttons.
3. Press the ON/OFF button to start the unit.

NOTE: FAN speed cannot be set or adjusted in DRY mode.

FAN Mode

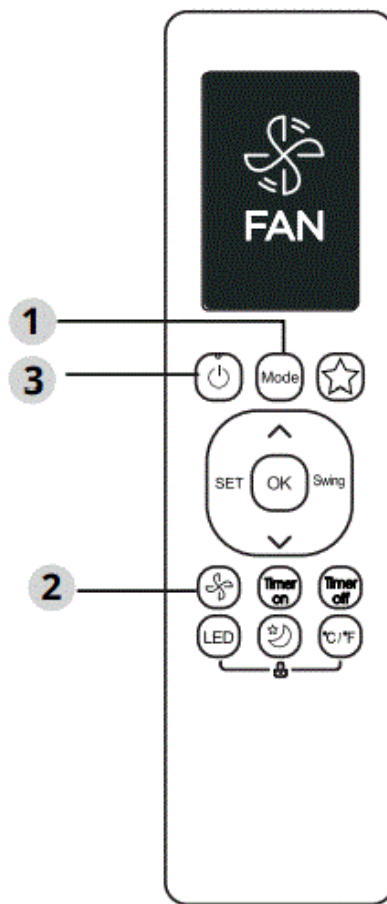

1. Press the MODE button and select FAN mode.
2. Press FAN button to select the desired the fan speed: AUTO, LOW, MED, or HIGH .
3. Press the ON/OFF button to start the unit.

NOTE: The temperature cannot be set or adjusted in FAN mode. As a result of this, the remote control LCD display will not display the temperature.

HEAT Mode

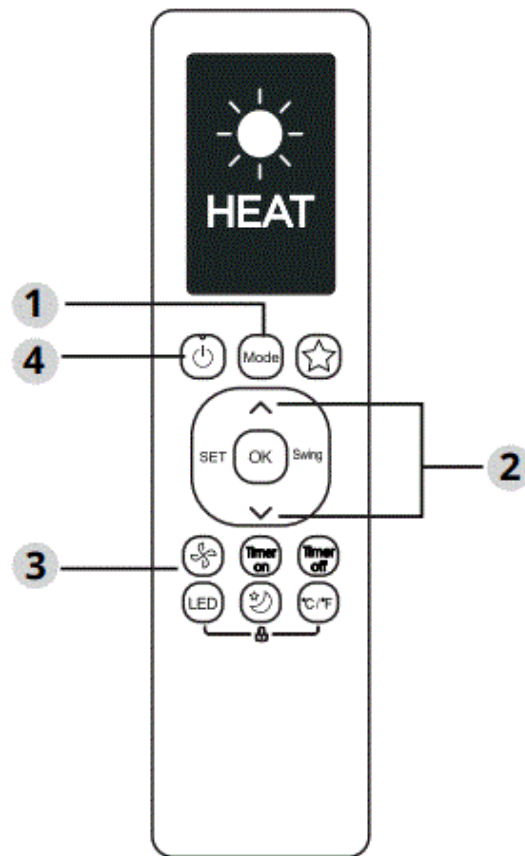

To select HEAT mode follow these steps:

1. Press the MODE button and select HEAT mode.
2. Set your desired temperature using the TEMPERATURE or buttons.
3. Press the FAN button to select the desired fan speed: AUTO, LOW, MED, or HIGH.
4. Press the ON/OFF button to start the unit.

NOTE: As the outdoor temperature drops, the performance of the unit's HEAT function may be affected. If this occurs, we recommend using other heating appliances in conjunction with the unit.

Setting The Timer

TIMER ON/OFF – Set the amount of time after which the unit will automatically turn on/off.

TIMER ON setting

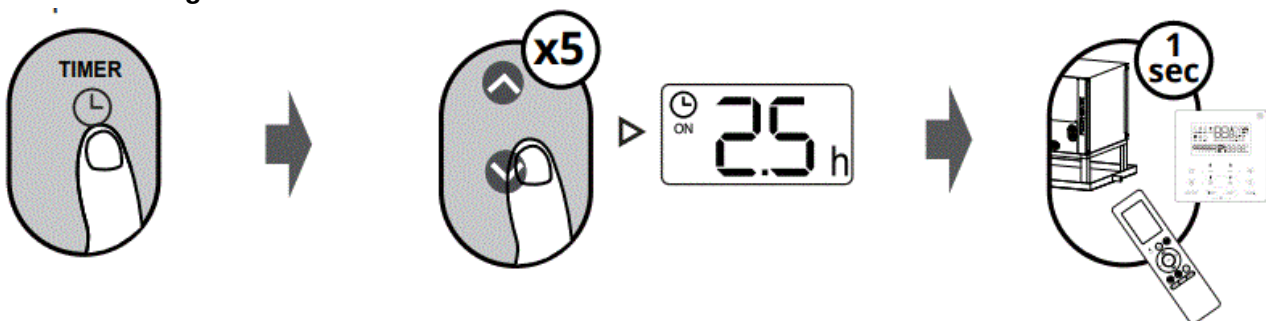

- Press the TIMER button to initiate the ON time sequence.
- Press the Temperature UP or DOWN button to set the desired time to turn ON the unit.
- Point the remote control at the unit or thermostat and wait for 1 second, the TIMER ON will be activated.

TIMER OFF setting

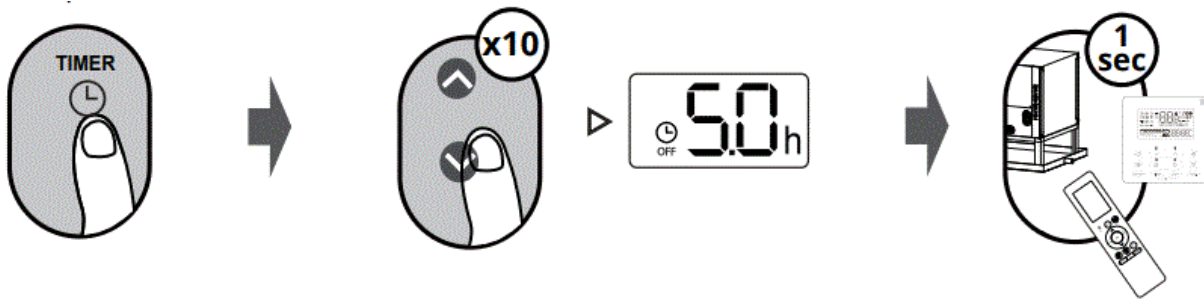

- Press the TIMER button to initiate the OFF time sequence.
- Press the Temperature UP or DOWN button to set the desired time to turn the unit.
- Point the remote control at the unit or thermostat and wait 1 sec, the TIMER OFF will be activated.

NOTE:

- When setting the TIMER ON or TIMER OFF, the time will increase by 30-minute increments with each press, up to 10 hours. After 10 hours and up to 24, it will increase in 1 hour increments. (For example, press 5 times to get 2.5h, and press 10 times to get 5h,) The timer will revert to 0.0 after 24.
- Cancel either function by setting its timer to 0.0h.

TIMER ON & OFF setting (example)

NOTE: Keep in mind that the time periods you set for both functions refer to hours after the current time.

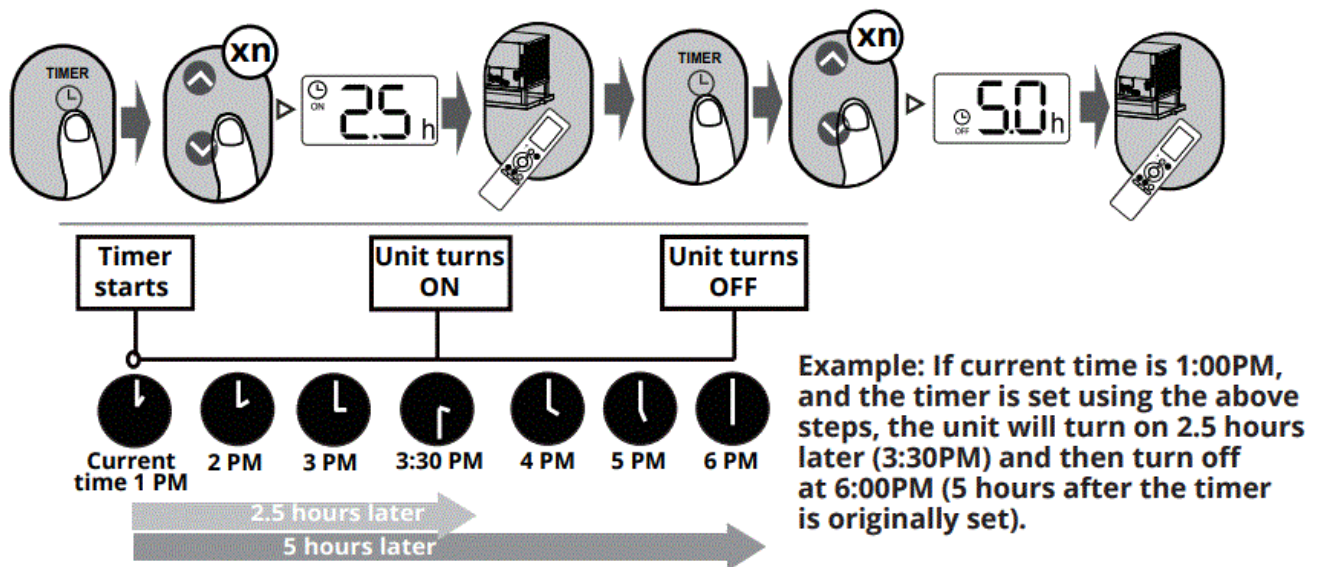

How To Use Advanced Functions

SHORTCUT function

Press the SHORTCUT button (some units) to revert to the previous settings:

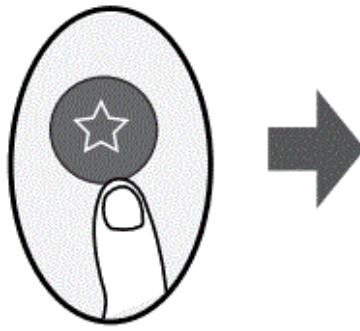

- Pressing the SHORTCUT button when the remote controller is on will cause the system to automatically revert back to the previous settings including the operating mode, set temperature, fan speed level, and the sleep feature (if activated).
- If the SHORTCUT button is pressed for more than 2 seconds, the system will automatically restore the current operation settings including the operating mode, set temperature, fan speed level and sleep feature (if activated).

°C/°F (some models)

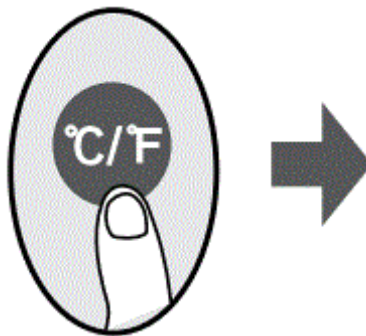

- Press the °C/°F button (some units) to alternate the temperature display between Celsius and Fahrenheit.

LOCK function

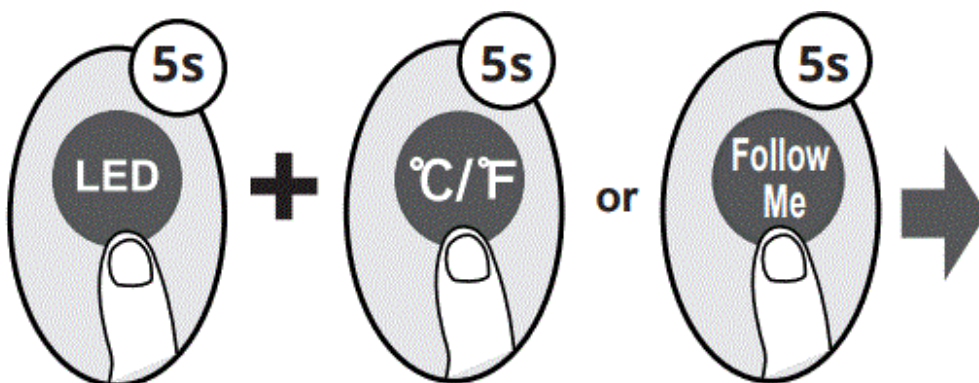

- Press LED button and °C/°F button (Follow Me button on some models) at the same time for 5 seconds or more to activate the LOCK function. None of the buttons will respond when this function is activated. Pressing the buttons together again for a duration of two seconds will disable the LOCK function.

SLEEP function

Press the SLEEP button to activate the sleep function:

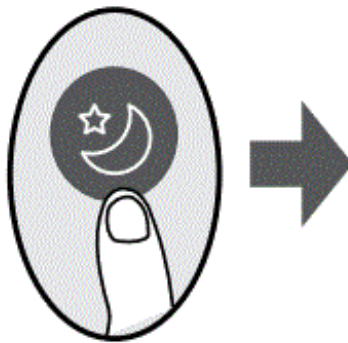

- The SLEEP function is used to decrease the energy of the unit while you sleep. (The same temperature settings are not needed to stay comfortable while sleeping.) This function can only be activated by the remote control.

For further details on the SLEEP function please refer to the User's Manual.

NOTE: The SLEEP function is not available in FAN or DRY mode.

SET function

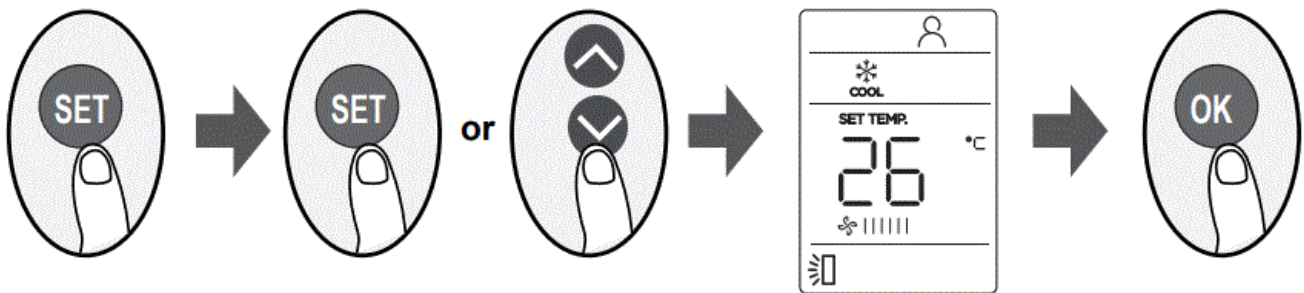

- Press the SET button to enter the function setting, then press the SET button or the TEMP or buttons to select the desired function. The selected symbol will flash on the display, press the OK button to confirm and this will activate the selected function.
- To cancel the selected function, just perform the same procedures as above.
- Press the SET button to scroll through operation functions as follows:

Follow Me* ()

*[]: If your remote controller has a Follow Me button, you cannot use the SET button to select

Follow Me function ():

The Follow Me function enables the remote control to measure the temperature at the location it currently is and send this signal to the air conditioning unit in a 3-minute interval. When using AUTO, COOL, or, HEAT modes, measuring the ambient temperature from the remote control (instead of from the indoor unit itself) will enable the air conditioner to optimize the temperature where you currently are and ensure maximum comfort.

NOTE:

The air handler may be equipped with AP mode, which allows the unit to use the wireless network configuration. However, the air handler does not respond to the AP mode signal from the remote controller. The wired thermostat must be used to activate this feature if so equipped.

Due to updates and constantly improving performance, the information and instructions within this manual are subject to change without notice. Please visit www.mrcool.com/documentation to ensure you have the latest version of this manual.

Version Date: 12-22-21

Documents / Resources

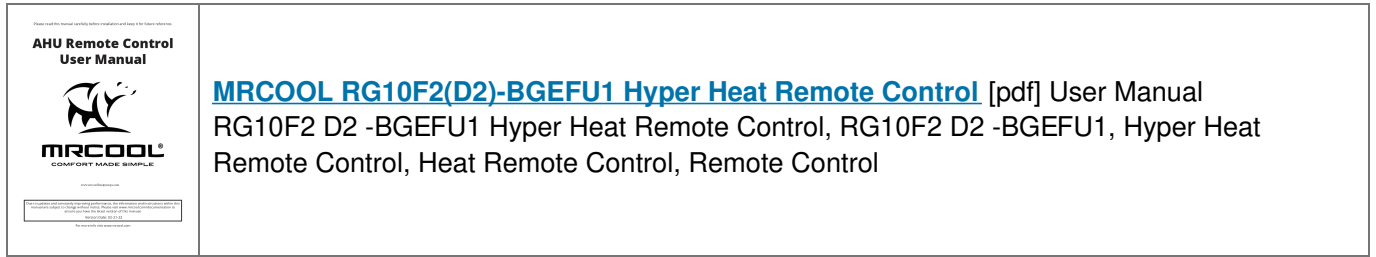

Manuals+,