



Mpow MS1 TWS Earbuds USer Manual BH443A

[Home](#) » [MPow](#) » Mpow MS1 TWS Earbuds USer Manual BH443A 

USER MANUAL



TWS Earbuds
Mpow MS1 / BH443A

Contents

- 1 PACKING LIST
- 2 DIAGRAM
- 3 POWER ON
- 4 POWER OFF
- 5 PAIRING
- 6 MUSIC
- 7 INCOMING CALL
- 8 RESET
- 9 CHARGING
- 10 CORRECT DISPOSAL OF THIS PRODUCT
- 11 FCC STATEMENT
- 12 FCC Radiation Exposure Statement
- 13 Related Posts

PACKING LIST

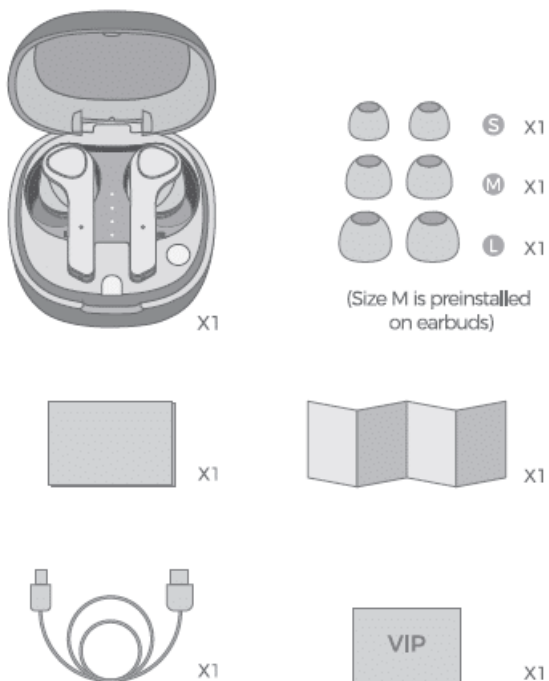

DIAGRAM

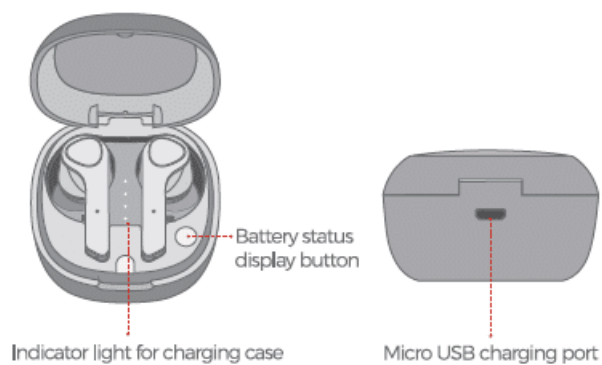

POWER ON

Mode 1 (Auto)

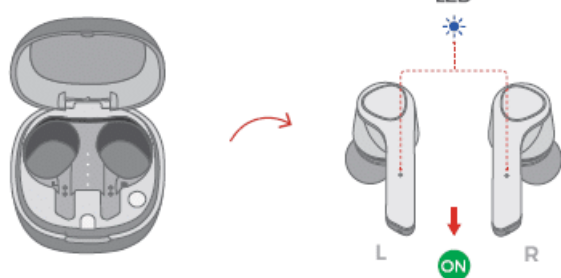

Mode 2 (Manual)

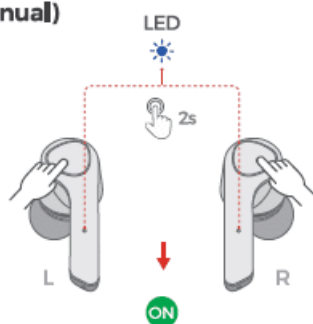

1. The earphones automatically turn on (with blue LED light flashing) and start pairing when they are taken out from the charging case.
2. In the shutdown status and when the earphones are not in the charging case, simultaneously press and hold the MFB of both earbuds for 2 seconds to power on (with the blue LED light flashing).

POWER OFF

Mode 1 (Auto)

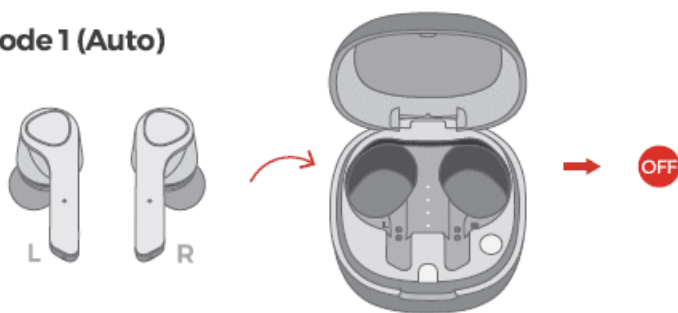

Mode 2 (Manual)

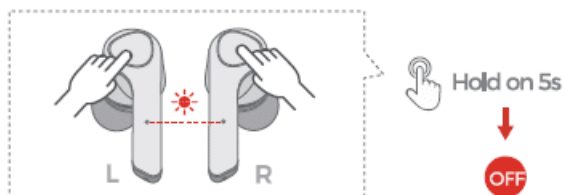

1. Put the earphones back in the charging case and the 'll shutdown automatically.
2. If the earphones are not in the charging case, just press and hold the MFB of both earbuds for 5 seconds to power them off' (Mode 2 cannot be conducted during music playing or calling.)

PAIRING

Mode 1

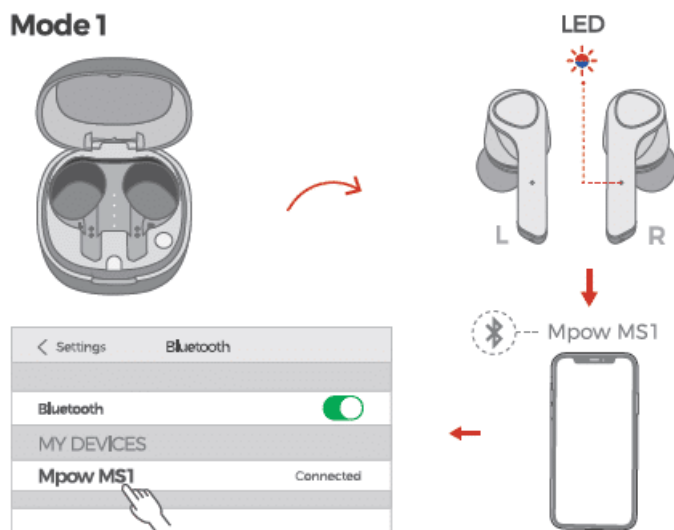

Mode 2

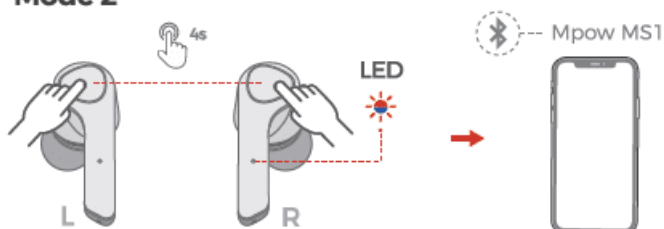

1. The earphones automatically start pairing (with the red and blue LED light flashing quickly on the right earbud) when they are taken out from the charging case, and choose "Mpow MS1" on your device.
2. Manually Switch to Pairing – When both earbuds are not in the charging case and in the state of power-off (keep pressing both MFB for 5 seconds 1D tum them off). Keep pressing both MFB for 4 seconds to re-enter into pairing mode in which LED flashes blue and red alternately. Finally, choose "Mpow MS1" on your device.

MUSIC

Volume Up/ Down

Volume+: press and hold the MFB button of Right earbud to turn up the volume increasingly.

Volume-: press and hold the MFB button of Left earbud to turn down the volume decreasingly.

Next/Previous Track

Next Track: double touch the MFB of Right earbud.

Previous Track: double touch the MFB of Left earbud.

Play/ Pause

Touch the MFB of either earbud once.

INCOMING CALL

Answer/ Hang Up

Touch the MFB of either earbud once.

Reject

Press and hold the MFB of either earbud for 1 second.

Activate Siri

Triple-touch the MFB of either earbud.

RESET

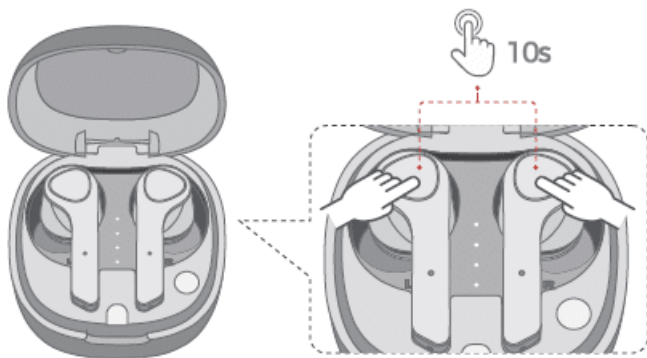

In the state of charging, simultaneously press and hold the MFB of both earbuds for 10 seconds. The LED light will flash blue, which means that the paired information is cleared successfully.

CHARGING

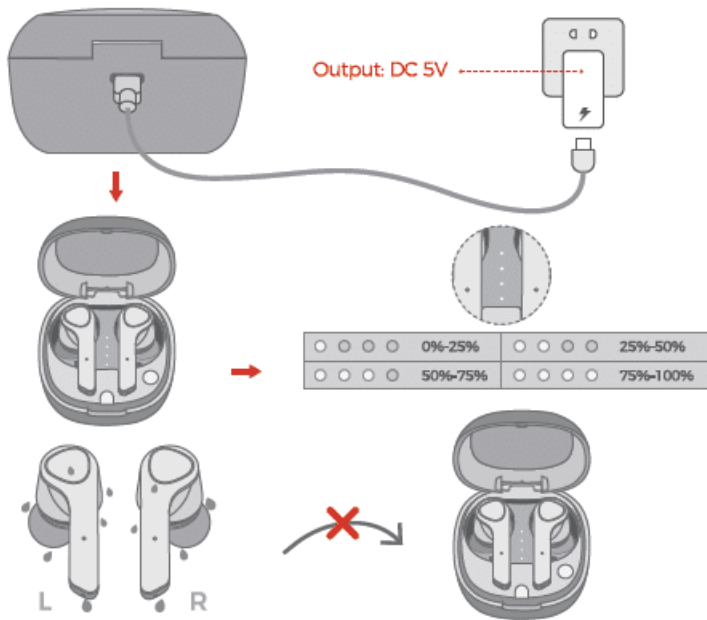

Do not put the earbuds in the charging case when the earbuds are wet.

CORRECT DISPOSAL OF THIS PRODUCT

(Waste Electrical& Electronic Equipment)



This Marking shown on the product or its literature indicate that it should not be disposed with other household wastes at the end of its working life.

To prevent possible harm to the environment or human health from uncontrolled waste disposal, please separate this from other types of wastes and recycle it responsibly to promote the sustainable reuse of material resources. Household user should contact either the retailer where they purchased this product or their local government office, for details of where and how they can take this item for environmentally safe recycling. Business users should contact their supplier and check the terms and conditions of the purchase contact This product should not be mixed with other commercial wastes for disposal contact either the retailer where they purchased this product or their local government office, for details of where and how they can take this item for environmentally safe recycling.

Business users should contact their supplier and check the terms and conditions of the purchase contact This product should not be mixed with other commercial wastes for disposal.

FCC STATEMENT

Any Changes or modifications not expressly approved by the party responsible for compliance could void the users authority to operate the equipment This device complies with part 15 of the FCC Rules Operation is subject to the following two conditions:

- (1) This device may not cause harmful interference, and
- (2) this device must accept any interference received. including interference that may cause undesired operation.

FCC Radiation Exposure Statement

This equipment complies with FCC radiation exposure limits set forth for an uncontrolled environment.

[Mpow-MS1-TWS-Earbuds-BH443A-Manual-Optimized](#)

Optimized PDF

[Mpow-MS1-TWS-Earbuds-BH443A-Manual-Original](#)

Download

Questions about your Manual? Post in the comments!

[Manuals+.](#)