



MPOW MDots User Manual MPBH510AB

[Home](#) » [MPow](#) » MPOW MDots User Manual MPBH510AB 

MPOW MDOTS TRUE WIRELESS EARBUDS *MODEL: BH510A*



Contents

- [1 PACKING LIST](#)
- [2 DIAGRAM](#)
- [3 POWER ON](#)
- [4 POWER OFF](#)
- [5 PAIRING](#)
- [6 MUSIC](#)
- [7 INCOMING CALL](#)
- [8 RESET](#)
- [9 CHARGING](#)
- [10 CORRECT DISPOSAL OF THIS PRODUCT](#)
- [11 Related Posts](#)

PACKING LIST

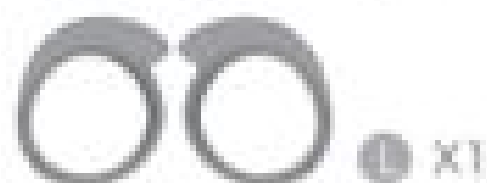
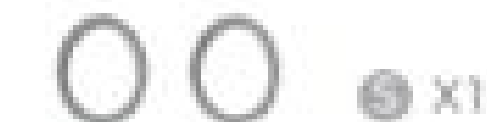

(Size M is preinstalled on earbuds)

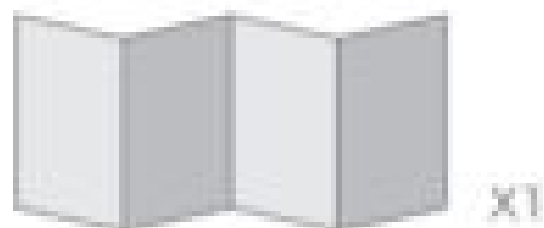
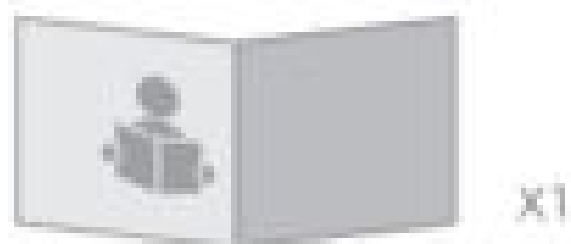

DIAGRAM



LED light



Micro USB charging port



POWER ON

Mode 1

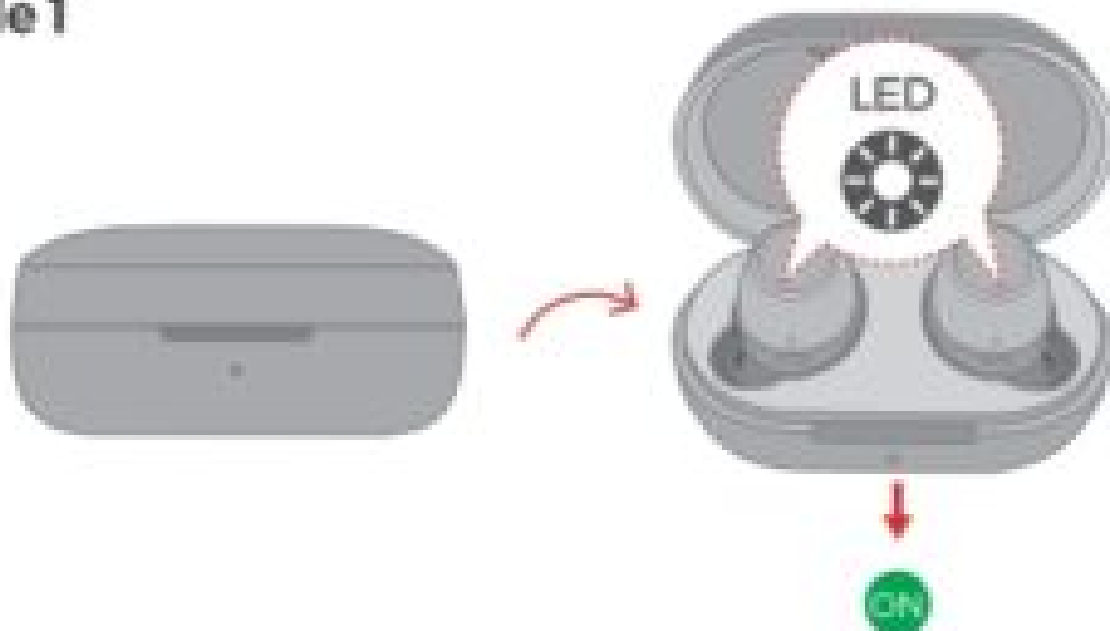

Mode 2

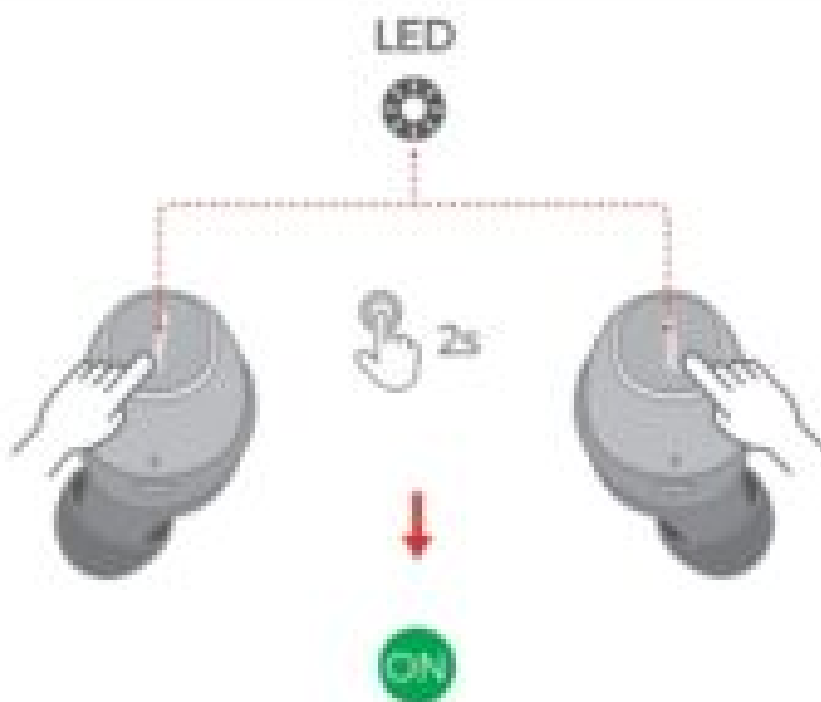

Mode 1: The earphones automatically turn on (with white LED light flashing and start pairing when you open the charging case.)

Mode 2: In the shutdown status and when the earphones are not in the charging case, simultaneously press and hold the MFB of both earbuds for 2 seconds to power on (with the white LED light flashing).

POWER OFF

Mode 1

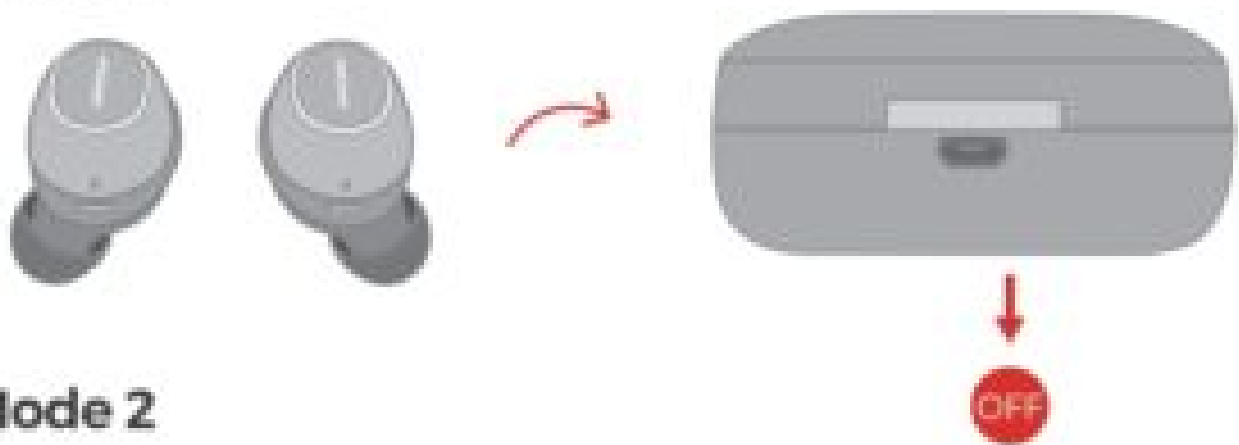

Mode 2



Mode 1: Put the earphones back in the charging case and close the case to turn them off.

Mode 2: If the earphones are not in the charging case, just press and hold the MFB of both earbuds for 5 seconds to power them off. (Mode;2 cannot be conducted during music playing or calling).

PAIRING

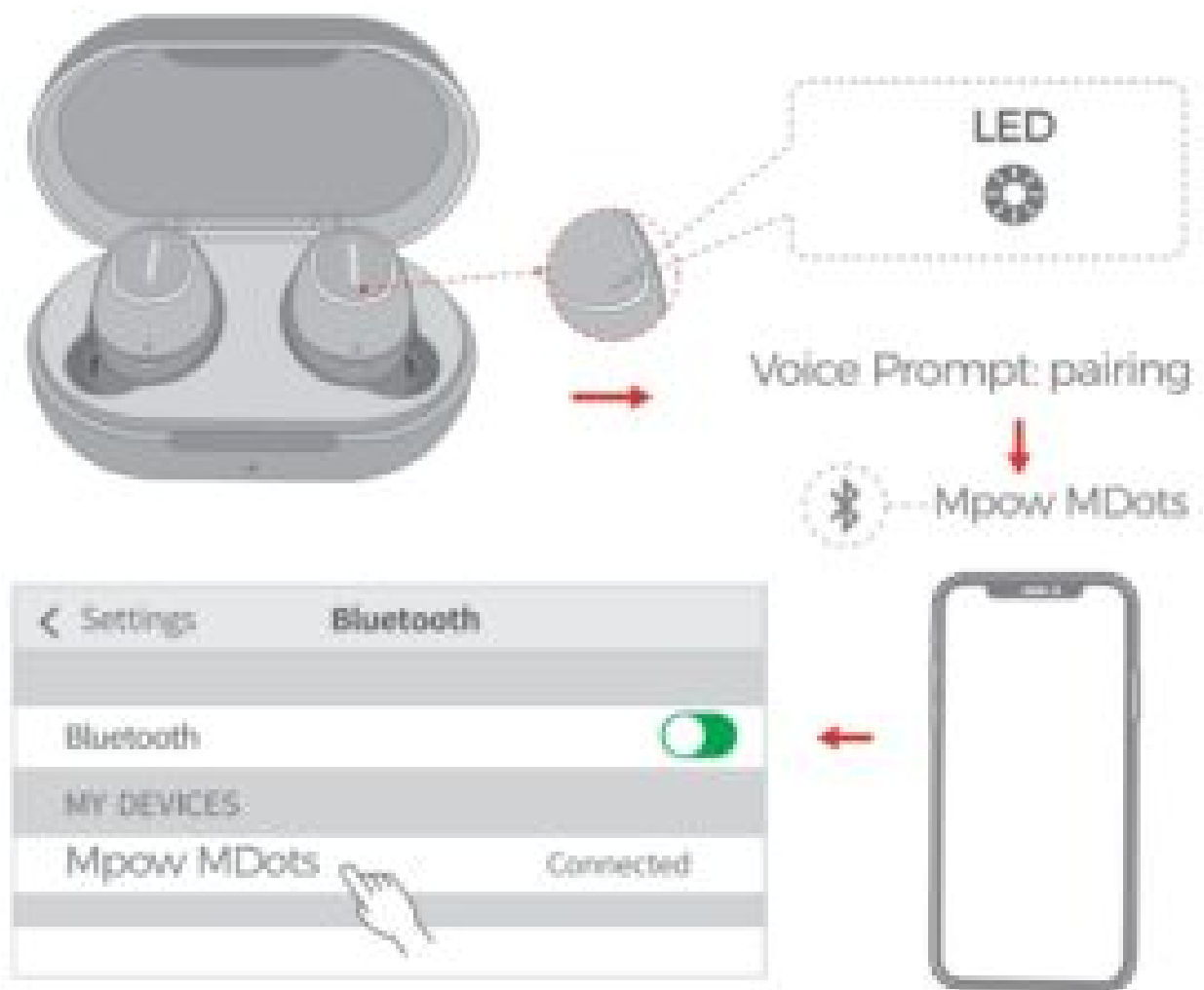

1. Open the charging case, they will automatically enter the pairing mode in which the LED light lashes white twice per second, and then select "Mpow MDots".

Note: The earbud will reconnect to the paired device by priority. If you want to pair to the second smartphone, please disconnect Bluetooth of the paired smartphone.

MUSIC

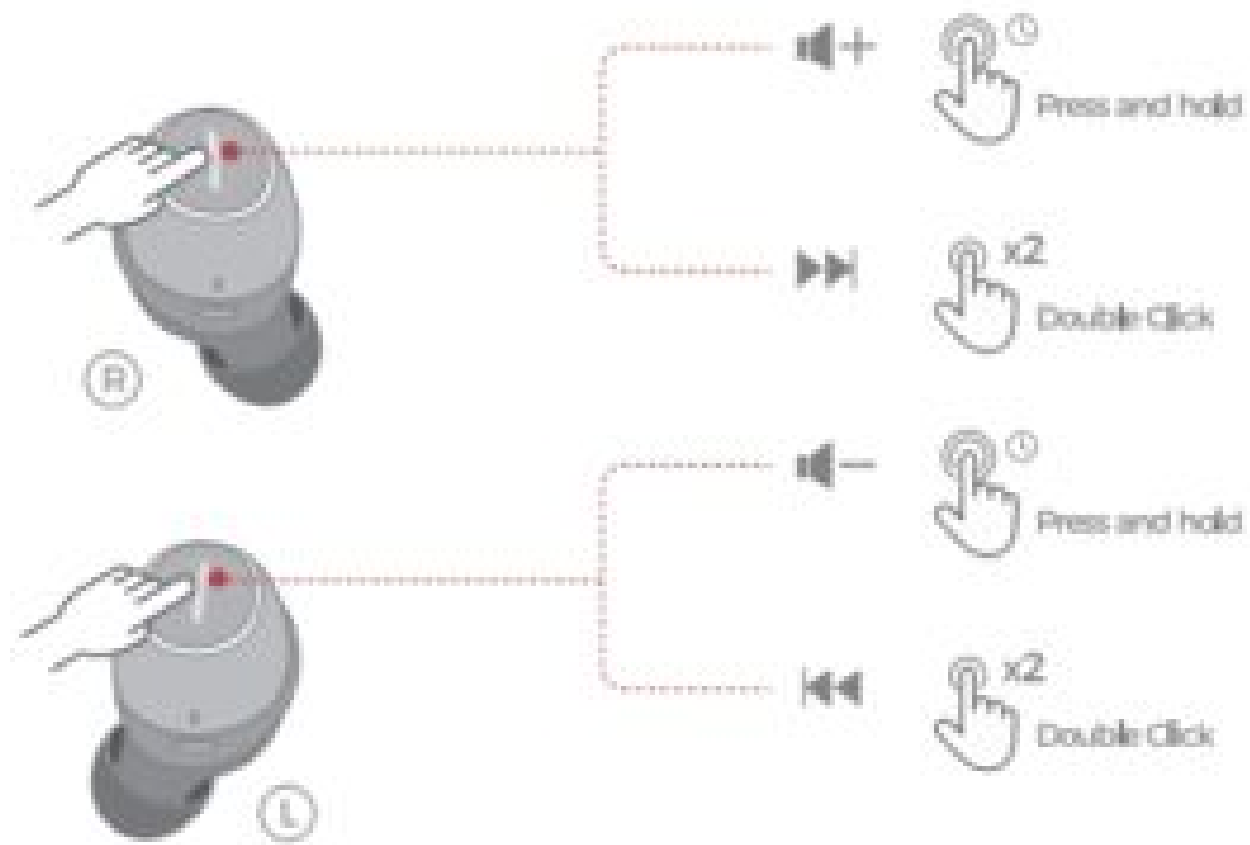

INCOMING CALL

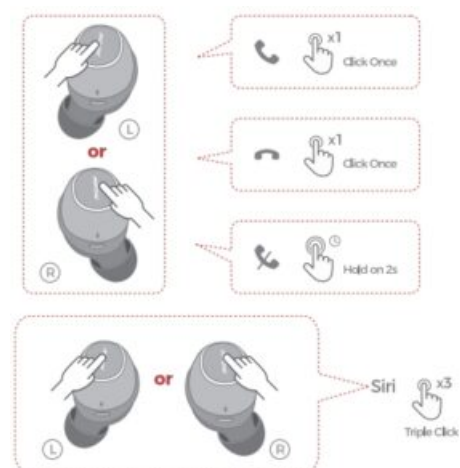

RESET



1. Take out both earbuds from the charging case.
2. Turn off both earbuds by keeping pressing them for 5 seconds.
3. Press and hold both earbuds for 10 seconds to clear the paired information.
4. The LED will flash red and white alternately 3 times.
5. Reset successfully.
6. Put both earbuds into the charging case to re-enter into pairing mode.

CHARGING

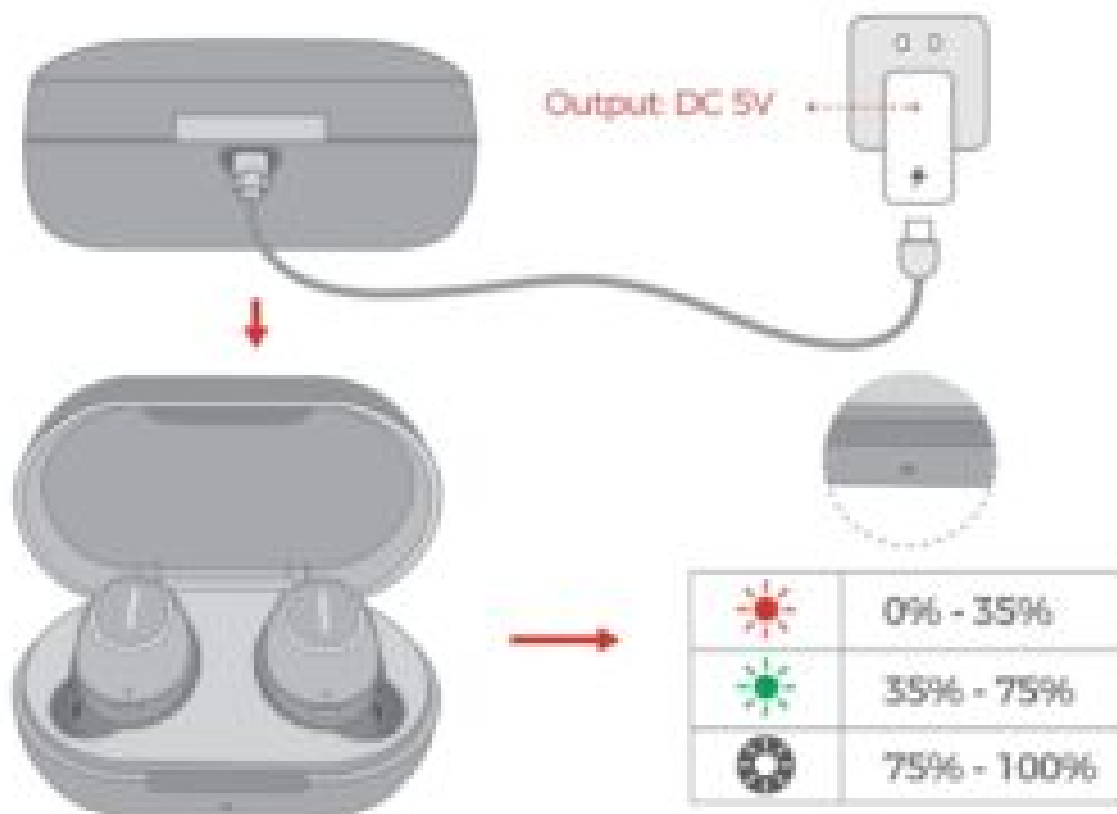

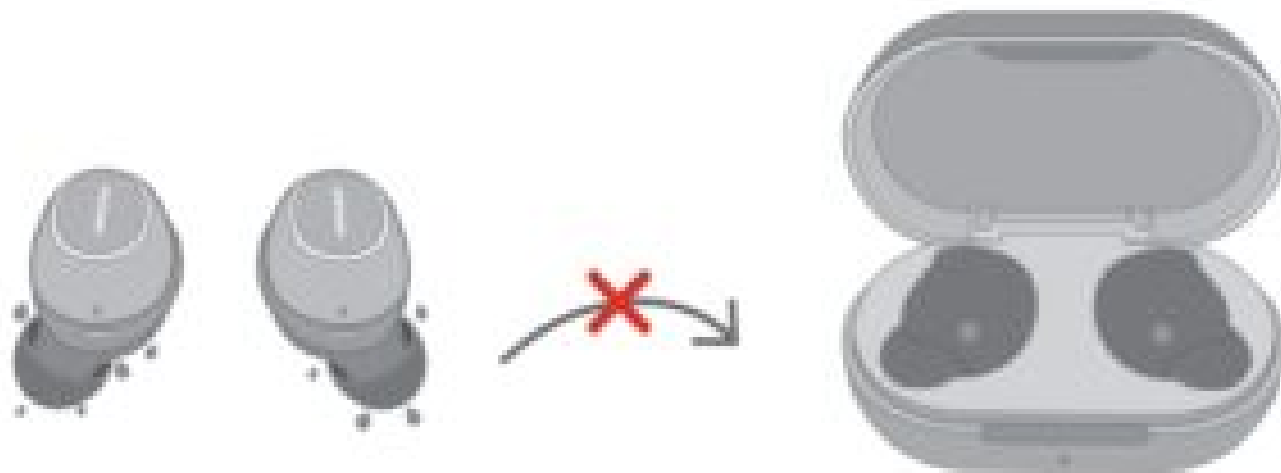

Do not put the earbuds in the charging case when the earbuds are wet.

CORRECT DISPOSAL OF THIS PRODUCT



(Waste Electrical and Electronic Equipment)

This Marking shown on the product or its literature indicate that should not be disposed with other household wastes at the end of its working life.

To prevent possible harm to the environment or human health from uncontrolled waste disposal, please separate this from other types of wastes and recycle it responsibly to promote the sustainable reuse of material resources Household user should contact either the retailer where they purchased this product or the local government office, for details of where and how they can take this item for environmentally safe recycling.

Business users should contact their supplier and check the terms and conditions of the purchase contract. This product should not be mixed with other commercial wastes for disposal

MPOW MDots User Manual MPBH510AB – [Optimized PDF](#)

MPOW MDots User Manual MPBH510AB – [Original PDF](#)