



MOULTRIE Ranch Series Broadcast Feeder Kit Instruction Manual

[Home](#) » [MOULTRIE](#) » MOULTRIE Ranch Series Broadcast Feeder Kit Instruction Manual 

Contents

- [1 MOULTRIE Ranch Series Broadcast Feeder Kit](#)
- [2 A. ASSEMBLE THE FEEDER KIT](#)
- [3 B. CONFIGURING AND TESTING FEEDER](#)
- [4 FCC COMPLIANCE](#)
- [5 Documents / Resources](#)
 - [5.1 References](#)
- [6 Related Posts](#)

MOULTRIE Ranch Series Broadcast Feeder Kit

INSTRUCTIONS MANUAL

Thank you for your purchase of a Moultrie Ranch Series Broadcast Feeder Kit. Please read this sheet before operating the unit. If you should have any questions about this product or any other Moultrie product, please contact us using the information on the back of this sheet. Allow us to better serve you by activating your 1-year warranty online at <http://www.moultriefeeders.com/warranty>

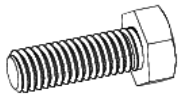

Bolt
M6 x 1 x 18
Qty. 5



Flat Washer
M6
Qty. 8*

** 3 only required if mounting
to a hopper other than
Moultrie Ranch Series*



Wingnut
M6 x 1
Qty. 2

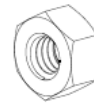

Hex Nut
M6 x 1
Qty. 3**

*** only required if mounting to a hopper
other than Moultrie Ranch Series*

A. ASSEMBLE THE FEEDER KIT

1. Remove all hardware from packaging
2. Insert the vertical supports into the guides on the side of the feeder kit.

ONE-HOLE SUPPORT: Insert one-hole support into the left-hand side support guide with tab facing away from the spin plate.

TWO-HOLE SUPPORT: Insert two-hole support into the right-hand side support guide with tab facing towards the spin plate.

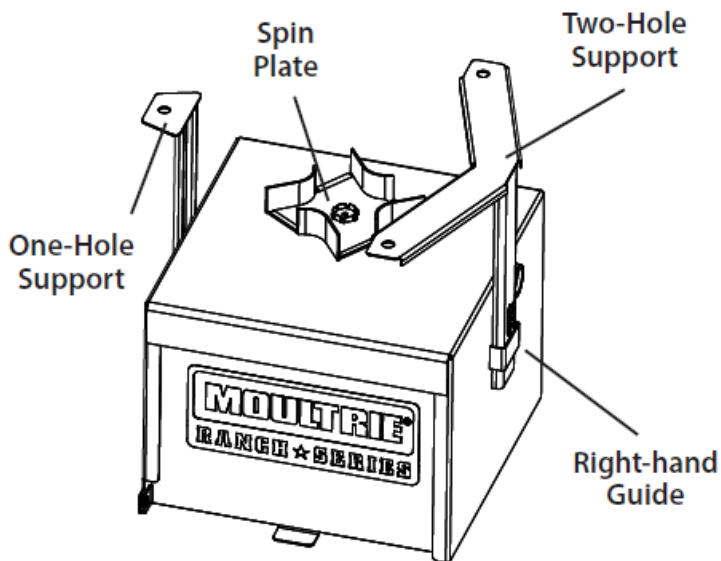

3. While holding the tab on the bottom of the door, pull up and then back towards you to unhook it from the door guides.

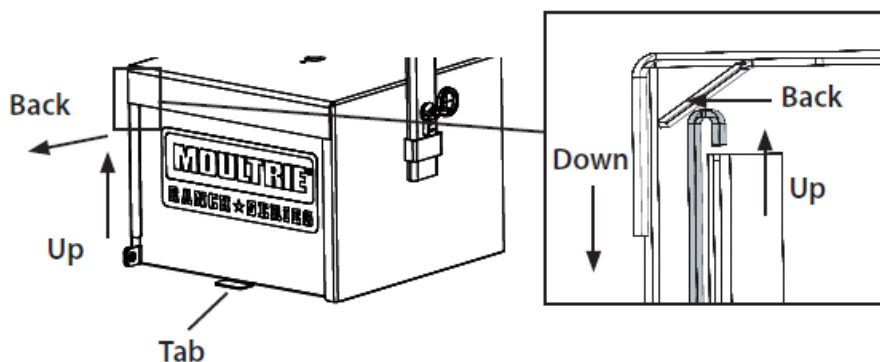

HOT TIP:

Slide the door down to the bottom of the kit, from there you can either hang the door on the keeper tabs or remove it entirely.

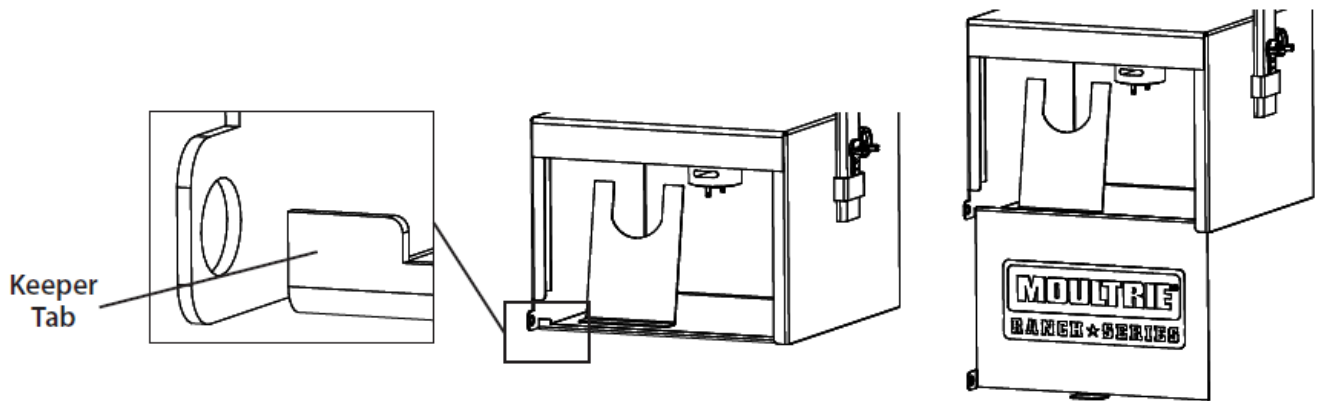

4. From the inside of the feeder kit, remove the timer from the stand for clearance and thread (1) M6 bolt into each welded nut and tighten, ensuring that the bolts pass through the vertical support adjustment slots.

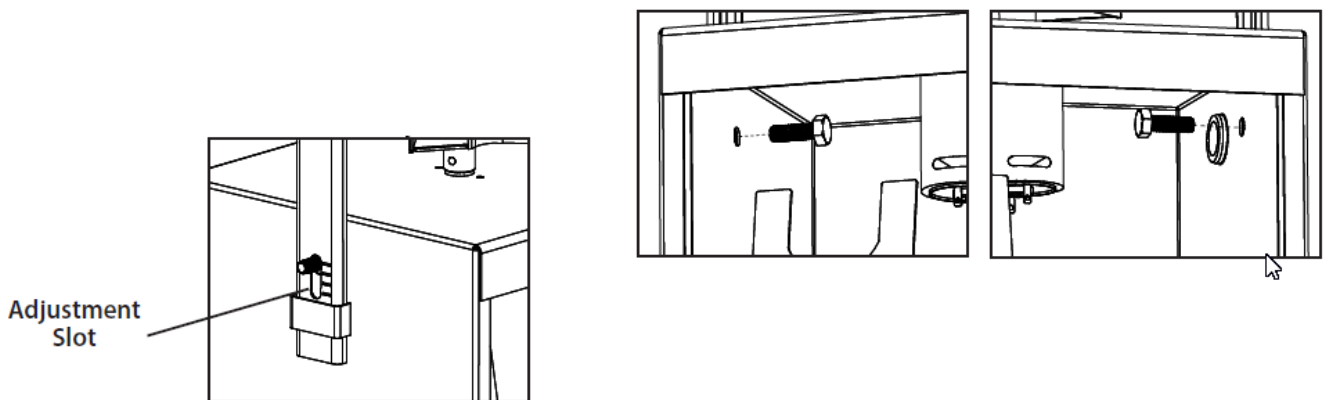

Place (1) flat washer and (1) wingnut on both protruding bolts on the outside of the feeder kit and hand tighten the wingnut.

The feeder kit can be moved up/down to accommodate various feed types.

(The position where the top notch is even with the mounting bolt is recommended for feeding corn)

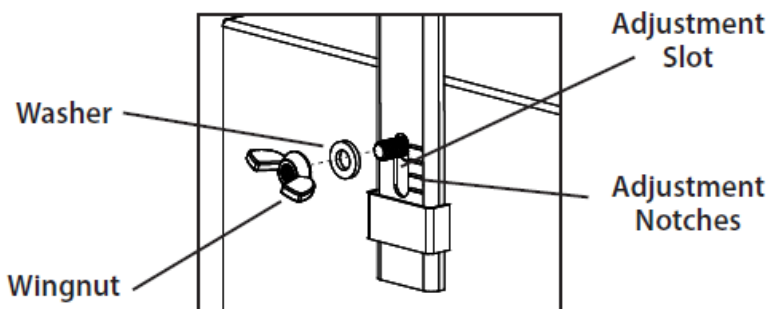

5. Place the mounting plate onto the top of the vertical supports with the funnel facing downwards, and all 3 bolt holes aligned.

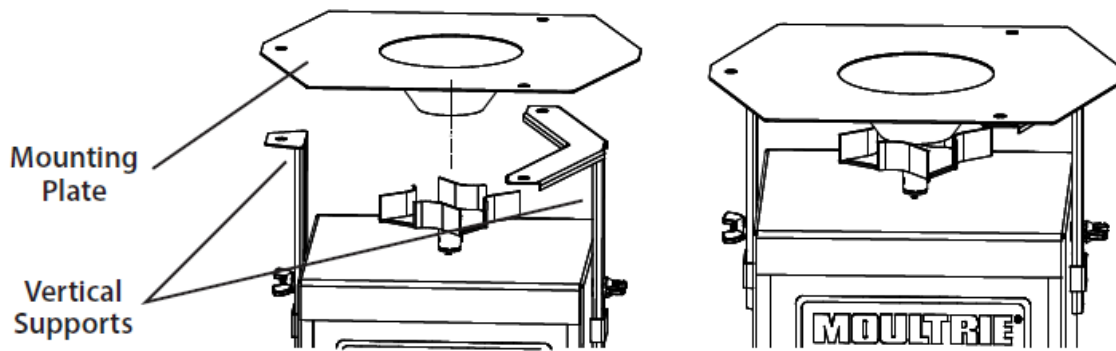

6. The kit is now ready to be installed to your hopper. Align the (3) pre-installed nuts in the bottom of the hopper with the (3) holes in the mounting plate and vertical supports, then secure the kit using (3) Flat Washers and (3) Hex Bolts.

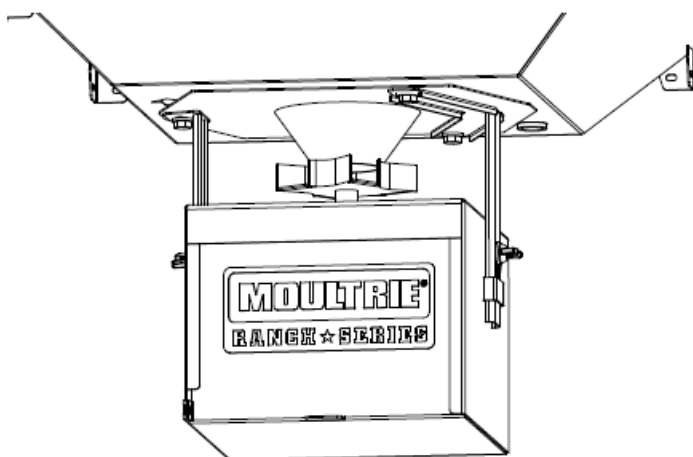
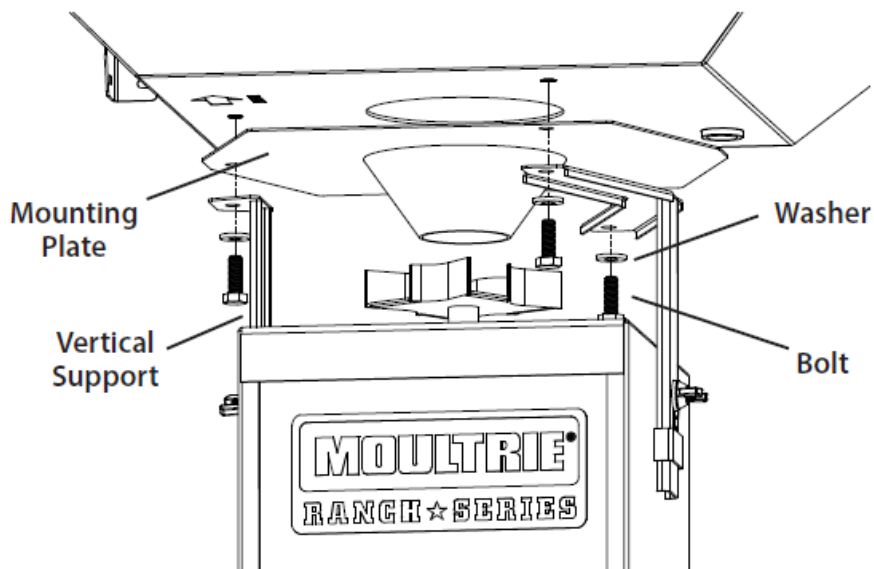

B. CONFIGURING AND TESTING FEEDER

1. INSTALL BATTERY: Open Kit by removing carabiner clip and remove door. Install a 12V 7ah battery (Moultrie rechargeable battery MCA-13093) by attaching the Red Wire Connector to the positive (+) terminal and the Black Wire Connector to the negative (-) terminal, making sure that the leads do not touch.

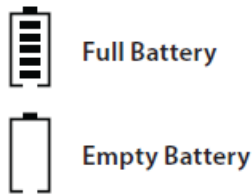

Note: Make sure the rubber protectors are around the wire connectors after installation onto the battery and that the wire connectors are firmly seated on the battery posts and have a snug fit. This helps protect the connectors from touching which can cause damage.

CAUTION: DO NOT REVERSE POLARITY OF THE BATTERY LEADS. DO NOT LET THE BATTERY LEADS COME IN CONTACT WITH ONE ANOTHER WHILE

CONNECTED TO A BATTERY. DO NOT LET THE BATTERY TERMINALS CONTACT THE SIDE OF THE FEEDER KIT. THIS CAN CAUSE PERSONAL INJURY OR PROPERTY DAMAGE. IN NO EVENT SHALL PRADCO BE LIABLE FOR ANY DIRECT, INDIRECT, PUNITIVE, INCIDENTAL, SPECIAL CONSEQUENTIAL DAMAGES, TO PROPERTY OR LIFE, WHATSOEVER ARISING OUT OF OR CONNECTED WITH THE USE OR MISUSE OF THIS PRODUCT. YOUR USE OF THIS PRODUCT IS AT YOUR OWN RISK.

2. SET CURRENT TIME: Press the PROGRAM button and SET CURRENT TIME will appear. Press UP or DOWN to set the hour, then press RIGHT to go to the minutes. Press UP or DOWN to set the minutes. Press the BACK button to return to the Main Menu , or press PROGRAM to proceed through the settings.

NOTE: The timer is capable up to 10 feed times, each 1-60 seconds each, and each can operate on any day of the week where each day can be toggled ON/OFF.

3. SET CURRENT DAY: Press the PROGRAM button until the Set Current Day screen appears. Press LEFT or RIGHT to select the current day. Press BACK to return to the Main Menu, or press PROGRAM to proceed through the settings.

4. SET EST. FEED REMAINING: Press the PROGRAM button until the Est. Feed Remaining screen appears. Press UP or DOWN to select the amount of feed you have in the feeder. Press BACK to return to the Main Menu, or press PROGRAM to proceed through the settings.

5. SET FEED TIME: Press the PROGRAM button until the desired Feed Timer appears at the top of the screen. Press the DOWN button until the feed time is flashing. Press PROGRAM to enter edit mode. Press UP or DOWN

to set the hour. Press the RIGHT button to go over to the minutes. Press UP or DOWN to set the minutes. Press PROGRAM or BACK to return to the Feed Timer. The factory settings include two feeder times 7am and 6pm, each for 6 seconds.

6. SET DAYS OF THE WEEK: After setting the feed time, press UP so the days of the week start flashing. Press PROGRAM to enter edit mode. By default all days should be enabled. Press LEFT or RIGHT to highlight the desired day. Press DOWN to disable the selected day. Press UP to re-enable the selected day. Once all desired days are selected, press PROGRAM or BACK to return to the Feed Timer.

7. SET RUN DURATION: Press DOWN and LEFT until the RUN DURATION seconds are flashing. Press PROGRAM to enter edit mode. Press UP or DOWN to set desired feed duration. Press PROGRAM or BACK to return to the Feed Timer.

8. SET MOTOR SPEED: Press UP or DOWN until the motor speed setting is flashing at the bottom of the screen. Press PROGRAM to enter edit mode. Press RIGHT or LEFT to select the desired motor setting. Press PROGRAM or BACK to return to the Feed Timer.

When the Feed Timer is blinking at the top of the screen, press PROGRAM or RIGHT to advance to the next feed timer. Repeat for all required feed times.

9. TEST FEEDER: Press the BACK button to reach the Main Menu. Press the TEST button to enter the Test Mode. The Test Duration will appear (this will be the same as the duration as Feed Timer 1). Press UP or DOWN to set the Test Duration. Press PROGRAM. Press RIGHT or LEFT to select desired motor speed. Press PROGRAM to perform test.

After a 5 second countdown, the test will commence.

To secure the kit with the door installed, place the carabiner clip through the locking tabs at the lower left corner of the door.

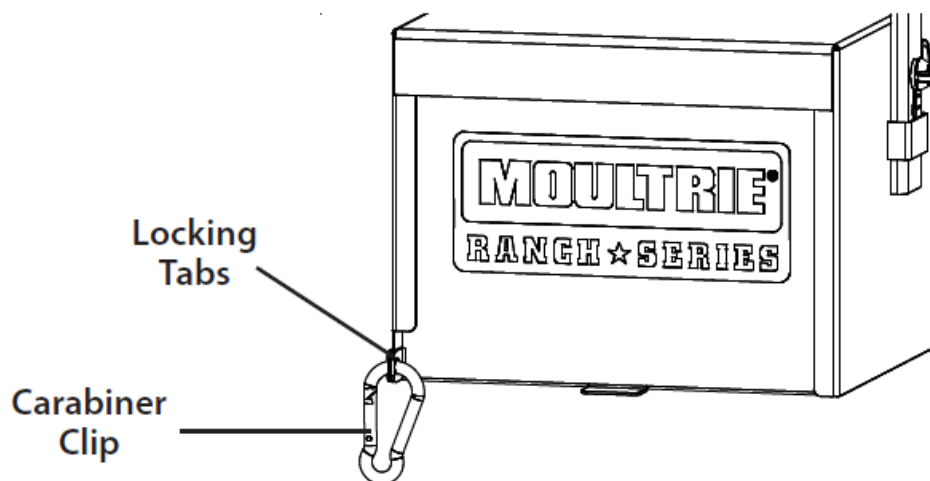

FCC COMPLIANCE

This device complies with part 15 of the FCC Rules. Operation is subject to the following two conditions: (1) This device may not cause harmful interference, and (2) this device must accept any interference received, including interference that may cause undesired operation.

For devices approved under Part 15, the user's manual or instruction manual for an intentional or unintentional radiator shall caution the user about changes or modifications to the device (Section 15.21).

NOTE: This equipment has been tested and found to comply with the limits for a Class B digital device, pursuant to part 15 of the FCC Rules. These limits are designed to provide reasonable protection against harmful interference in a residential installation. This equipment generates, uses and can radiate radio frequency energy and, if not installed and used in accordance with the instructions, may cause harmful interference to radio communications. However, there is no guarantee that interference will not occur in a particular installation. If this equipment does cause harmful interference to radio or television reception, which can be determined by turning the equipment off and on, the user is encouraged to try to correct the interference by one or more of the following measures:

- Reorient or relocate the receiving antenna.
- Increase the separation between the equipment and receiver.
- Connect the equipment into an outlet on a circuit different from that to which the receiver is connected.
- Consult the dealer or an experienced radio/TV technician for help.

Our Service Department will gladly answer any questions you have. www.moultriefeeders.com/support

Documents / Resources

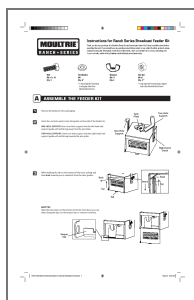

[MOULTRIE Ranch Series Broadcast Feeder Kit](#) [pdf] Instruction Manual
MFG-15042, 053695150420, Ranch Series, Ranch Series Broadcast Feeder Kit, Broadcast Feeder Kit, Feeder Kit, Kit

References

- [User Manual](#)

[Manuals+](#), [Privacy Policy](#)

This website is an independent publication and is neither affiliated with nor endorsed by any of the trademark owners. The "Bluetooth®" word mark and logos are registered trademarks owned by Bluetooth SIG, Inc. The "Wi-Fi®" word mark and logos are registered trademarks owned by the Wi-Fi Alliance. Any use of these marks on this website does not imply any affiliation with or endorsement.